



FORM F-106

RECEIVED

DEC 23 1976

COL. OIL &amp; GAS CONS. COMM.

R. 55W

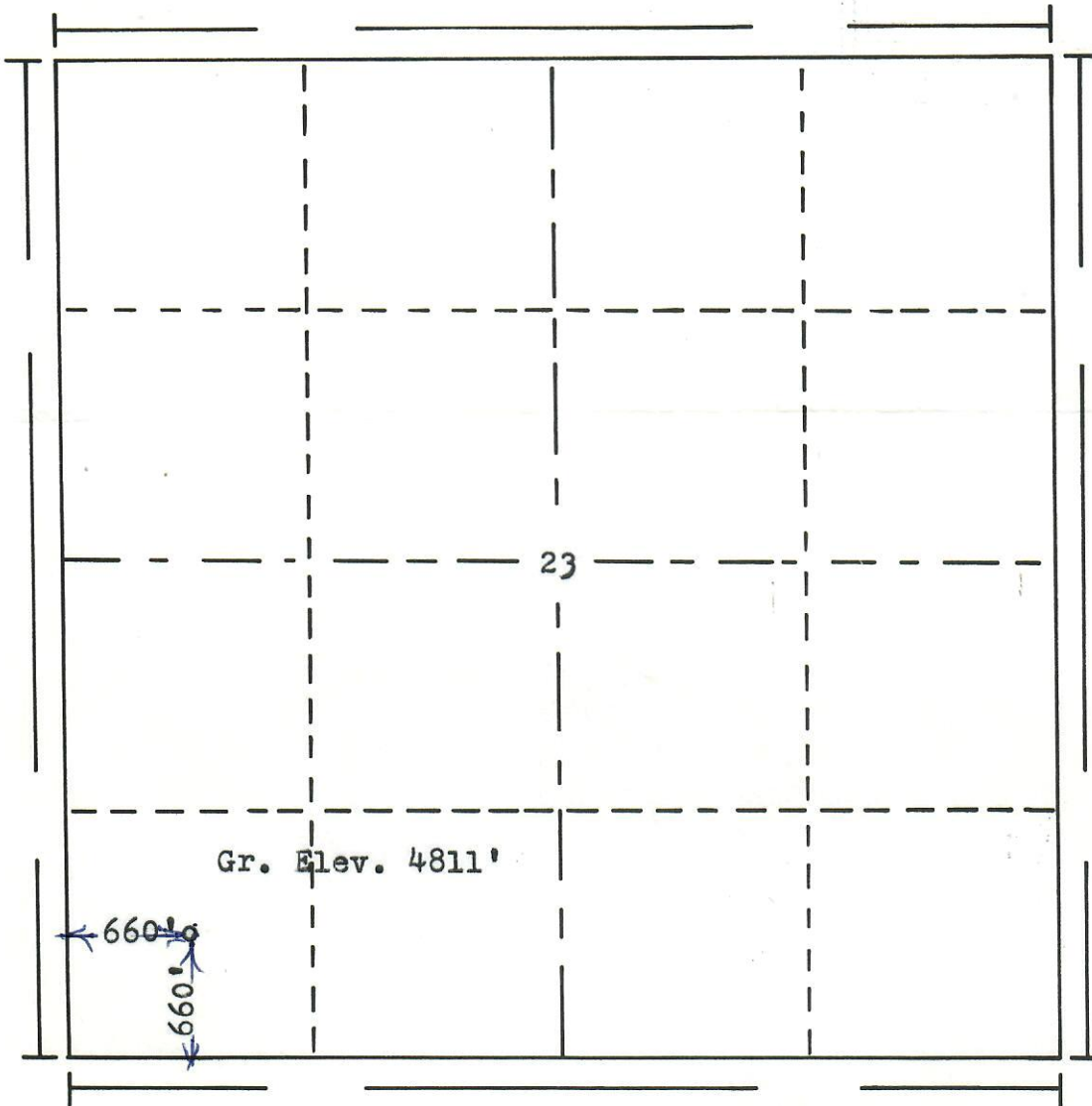
T.  
12  
N

Scale... 1" = 1000'

Powers Elevation Company, Inc. of Denver, Colorado  
has in accordance with a request from Michelle  
for Appollo Enterprises & Exeter Drlg. & Exploration Co.  
determined the location of No.1 Ross  
to be CSW SW Section 23 Township 12N  
Range 55W of the 6th Principal Meridian  
Logan County, Colorado

I hereby certify that this plat is an  
accurate representation of a correct  
survey showing the location of



00290846

Date: 12-16-76

W. J. H. H. H.  
Licensed Land Surveyor No. 2853  
State of Colorado