

# Pad Layout Drawing

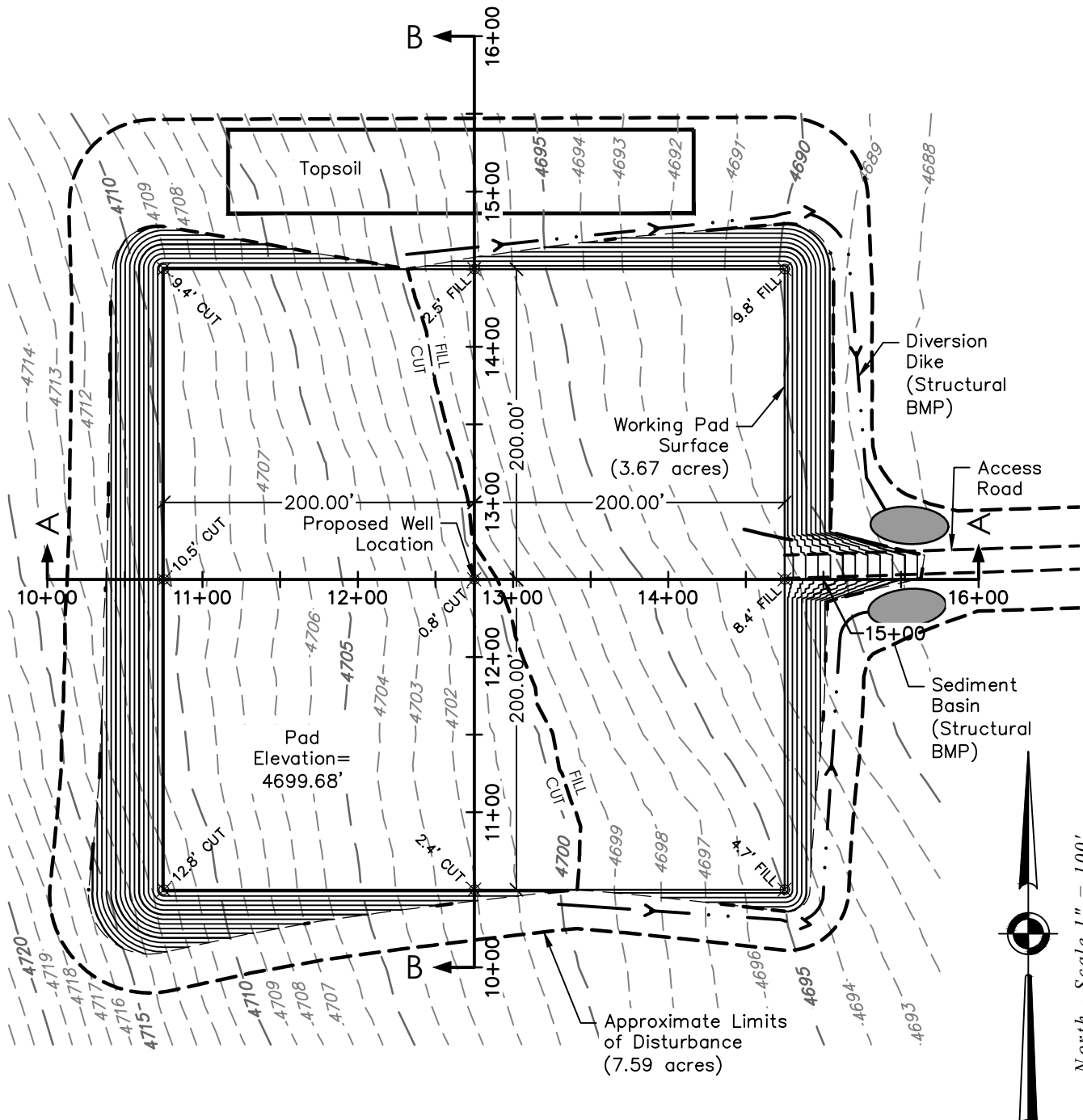

## Notes:

- Elevations based on NAVD 88 Datum.
- A 15% allowance is made for compaction loss.

Access Road Disturbance = 0.6 Acres  
Off-Location Flowline Disturbance = 0.5 Acres

Pad Dim: 400' x 400' Pad Grade: 4699.68'				
Estimated Earthwork (Cubic Yards)				
Cut	Fill	Compaction Loss	Topsoil	Excess
21,196	15,046	2,257	3,889	4
Cut includes 6" topsoil depth				

G:\Projects\21-1047-00 Oil Pads (PLS)\04 Drawings\Exhibits\04\_Revenant #1\Revenant #1 - C&F Exhibit.dwg October 22, 2021 - 9:18am

Well Name:

**Revenant #1**

S07-T03S-R51W-6 PM

Washington County, CO

Field Date  
07.27.2020

Party Chief  
BAB

Survey Tech  
N/A

Proj. Manager  
BAB

Prepared for:

Project#: 21013.001

**St Croix Operating, LLC**

PLS Corporation  
532 West 66th Street  
Loveland, Colorado 80538  
970.669.2100 - info@plscorporation.com

# Pad Cross-Sections

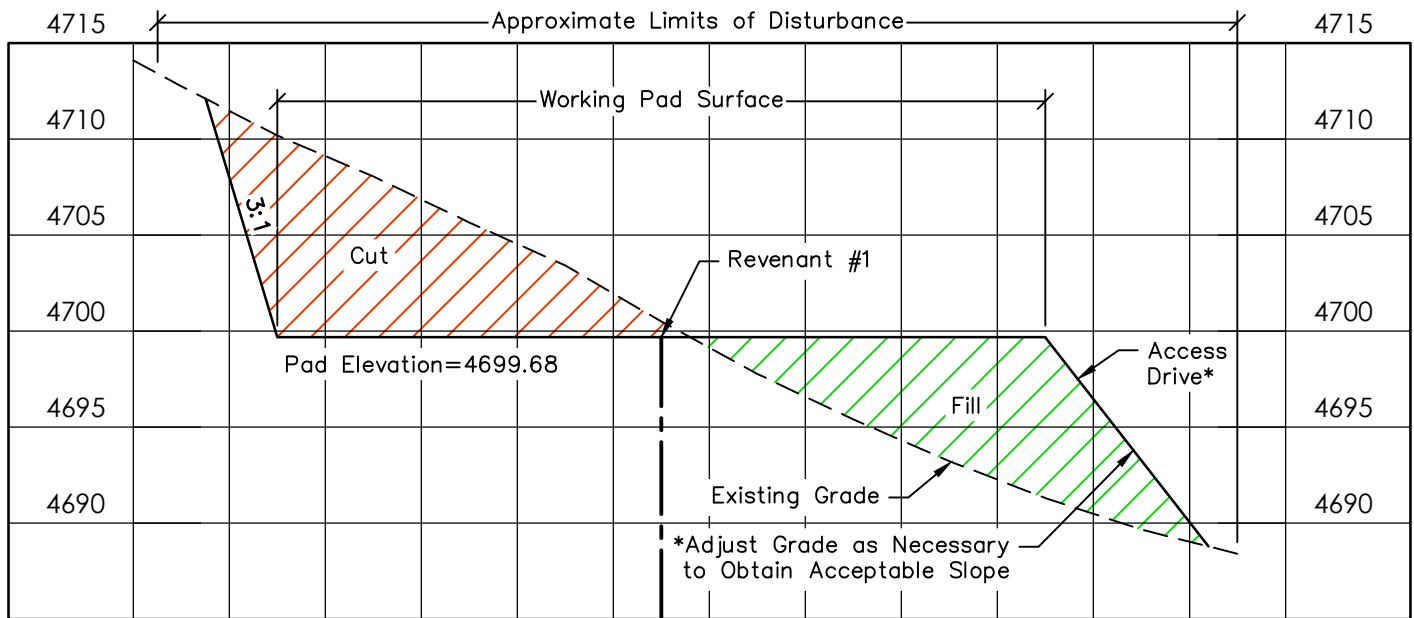

SECTION A-A

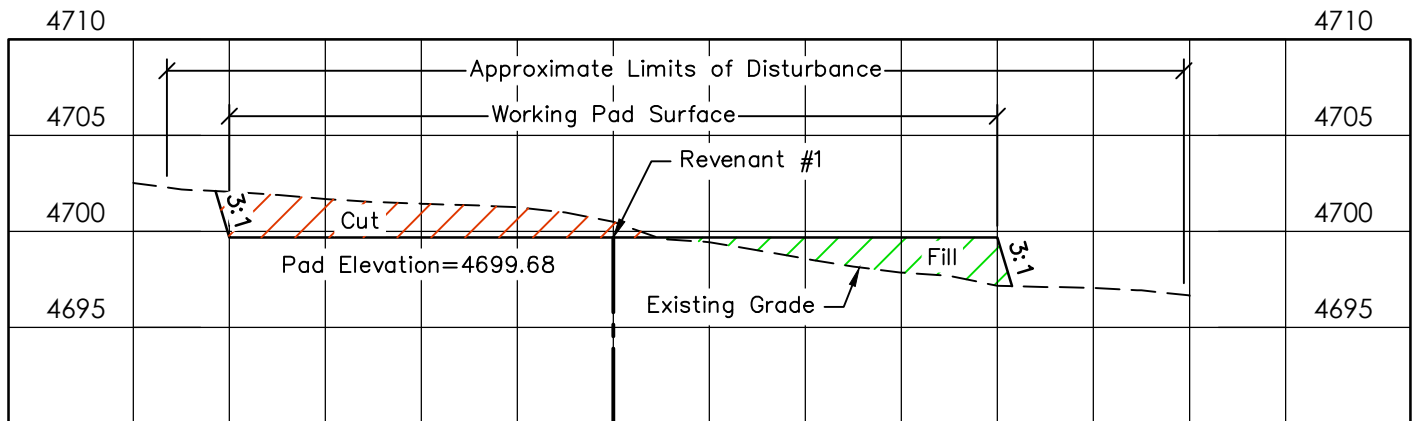

SECTION B-B

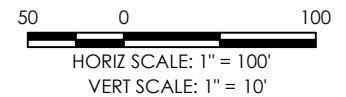

G:\Projects\21-1047-00 Oil Pads (PLS)\04 Drawings\Exhibits\04\_Revenant #1\Revenant #1 - C&F Exhibit.dwg October 22, 2021 - 12:28pm

Well Name: <b>Revenant #1</b>	Field Date <b>07.27.2021</b>	Prepared for: <b>Project#: 21013.001</b>  <b>St Croix Operating, LLC</b>  PLS Corporation 532 West 66th Street Loveland, Colorado 80538 970.669.2100 - info@plscorporation.com
S07-T03S-R51W-6 PM	Party Chief <b>BAB</b>	
Washington County, CO	Survey Tech <b>N/A</b>	
	Proj. Manager <b>BAB</b>	

# Rig Layout Drawing

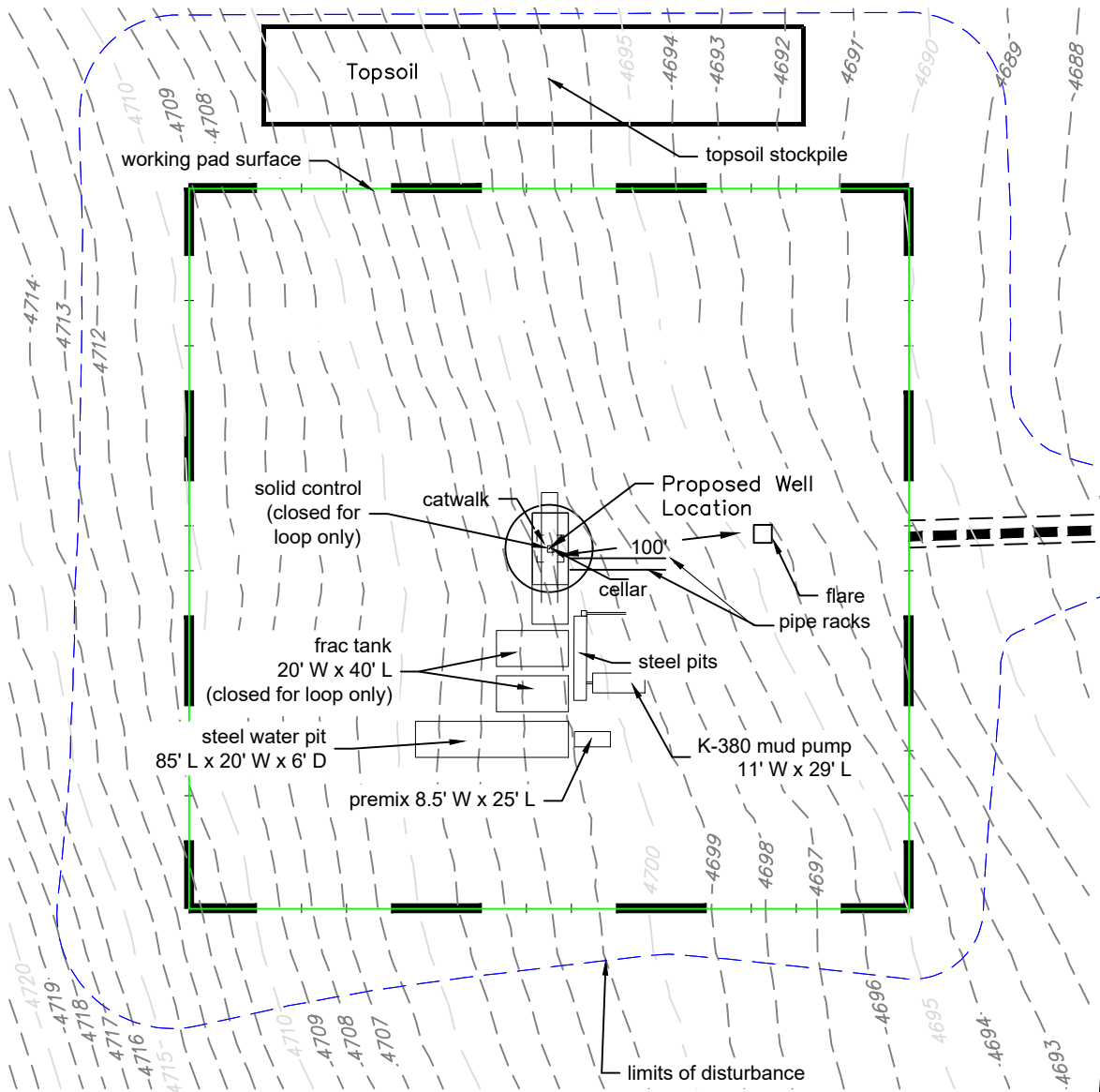

C:\Users\bahor\OneDrive\for Brett\21013\dwg\21013\_rlg\_layout1.dwg November 03, 2021 - 11:47am

Well Name: <b>Revenant #1</b>	Field Date <b>10.07.2021</b>	Prepared for: Project#: <b>21013.001</b>
Section 07-T3S-R51W-6th PM, NW-NE	Party Chief <b>BAB</b>	<b>St. Croix Operating, Inc.</b>
Washington County, Colorado	Proj. Manager <b>BAB</b>	
	Drawing Date <b>11.02.2021</b>	PLS Corporation 532 West 66th Street Loveland, Colorado 80538 970.669.2100 office - info@plscorporation.com

# Interim Reclamation Map

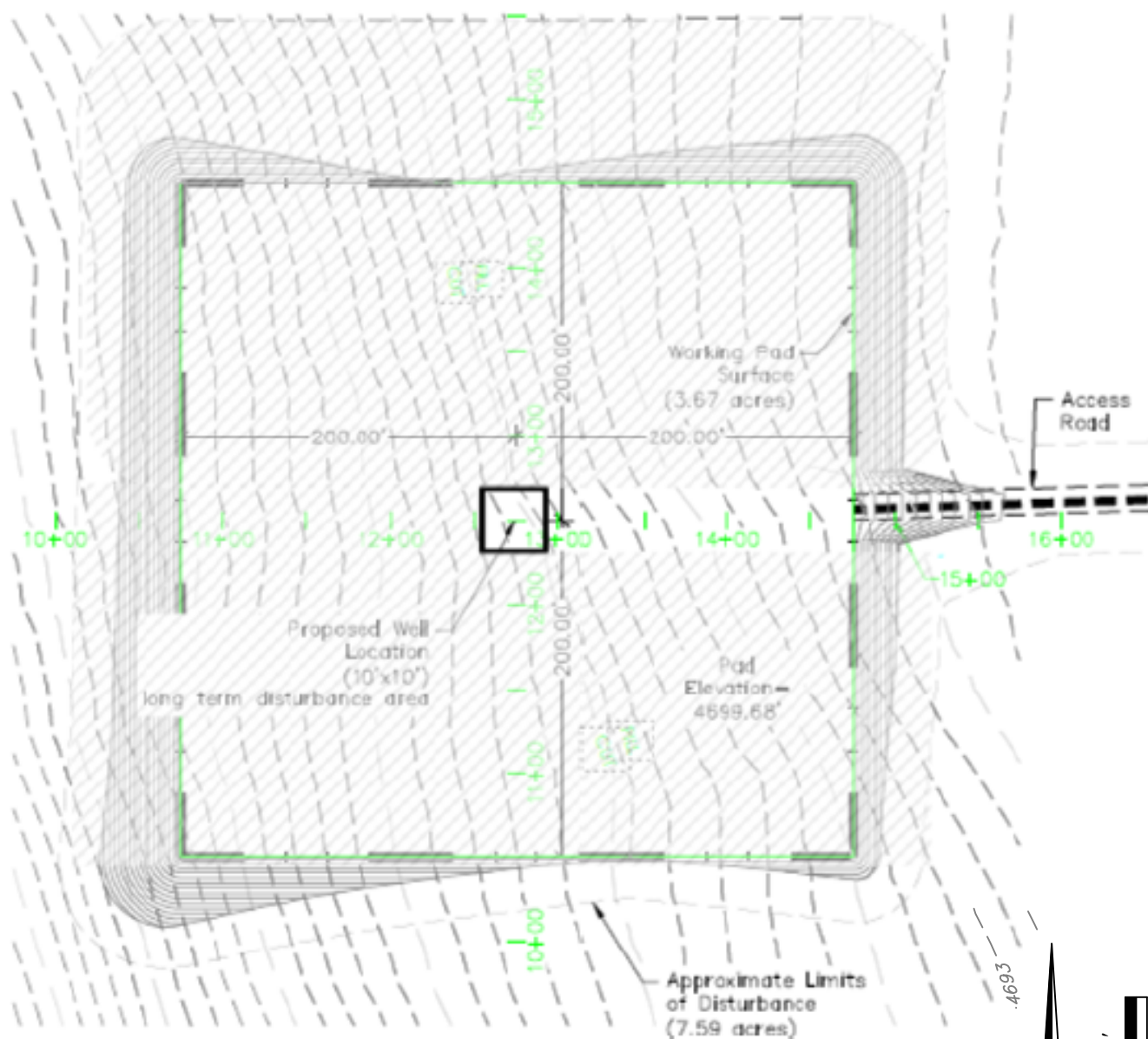

Post-Interim Reclamation Disturbance = 0.002 acres  
 Off-Location Flowline Long-Term Disturbance = 0 acres  
 Access Road Long-Term Disturbance = 0.6 acres

C:\Users\bahor\OneDrive\for Brett\21013\dwg\21013\_Interim\_rec\_map.dwg November 03, 2021 - 12:33pm

Well Name: <b>Revenant #1</b>	Field Date <b>10.07.2021</b>	Prepared for: <b>St. Croix Operating, Inc.</b>  PLS Corporation 532 West 66th Street Loveland, Colorado 80538 970.669.2100 office - info@plscorporation.com
Section 07-T3S-R51W-6th PM, NW-NE	Party Chief <b>BAB</b>	
Washington County, Colorado	Proj. Manager <b>BAB</b>	
	Drawing Date <b>11.02.2021</b>	