



FORM F-106

RECEIVED

AUG 24 1977

COLORADO OIL & GAS CONS. COM.

RECEIVED

AUG 22 1977

TOLTEK DRILLING

R. 55W

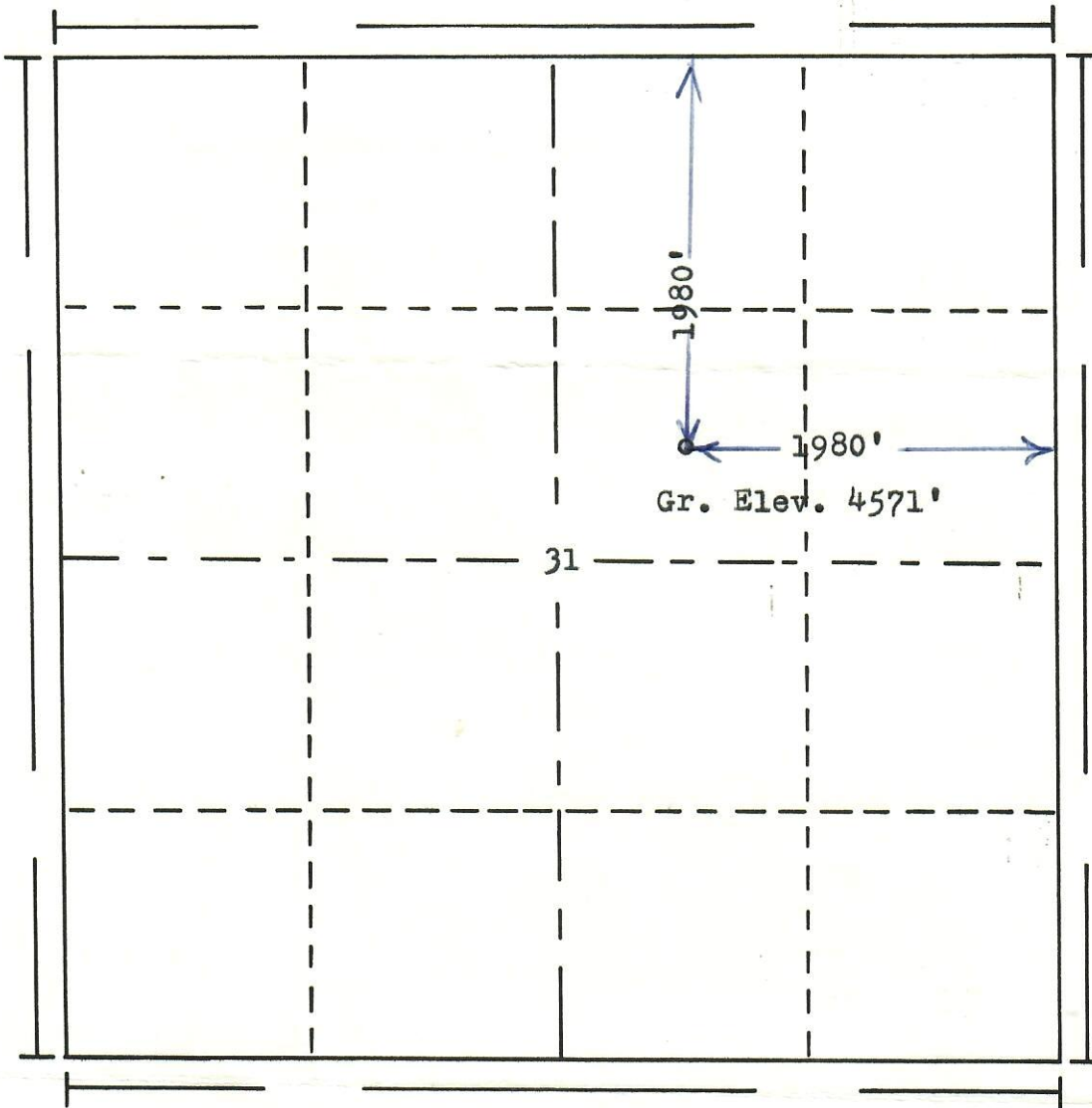

T.  
12  
N

Scale... 1" = 1000'

**Powers Elevation Company, Inc. of Denver, Colorado**  
has in accordance with a request from Shirley  
for Toltek Drlg. Co.  
determined the location of No.1 Baschen  
to be CSW NE Section 31 Township 12N  
Range 55W of the 6th Principal Meridian  
Logan County, Colorado



00290971

I hereby certify that this plat is an  
accurate representation of a correct  
survey showing the location of

Date: 8-19-77

*Robert D. Herring*  
Licensed Land Surveyor No. 2853  
State of Colorado

RECEIVED  
AUG 22 1977  
TOLTEK DRILLING

3-23-78  
Reg. #5  
+ Plugging  
CV

Ge