



RECEIVED

DEC - 2 1968

COLO. OIL & GAS CONS. COMM.

R. 55W.

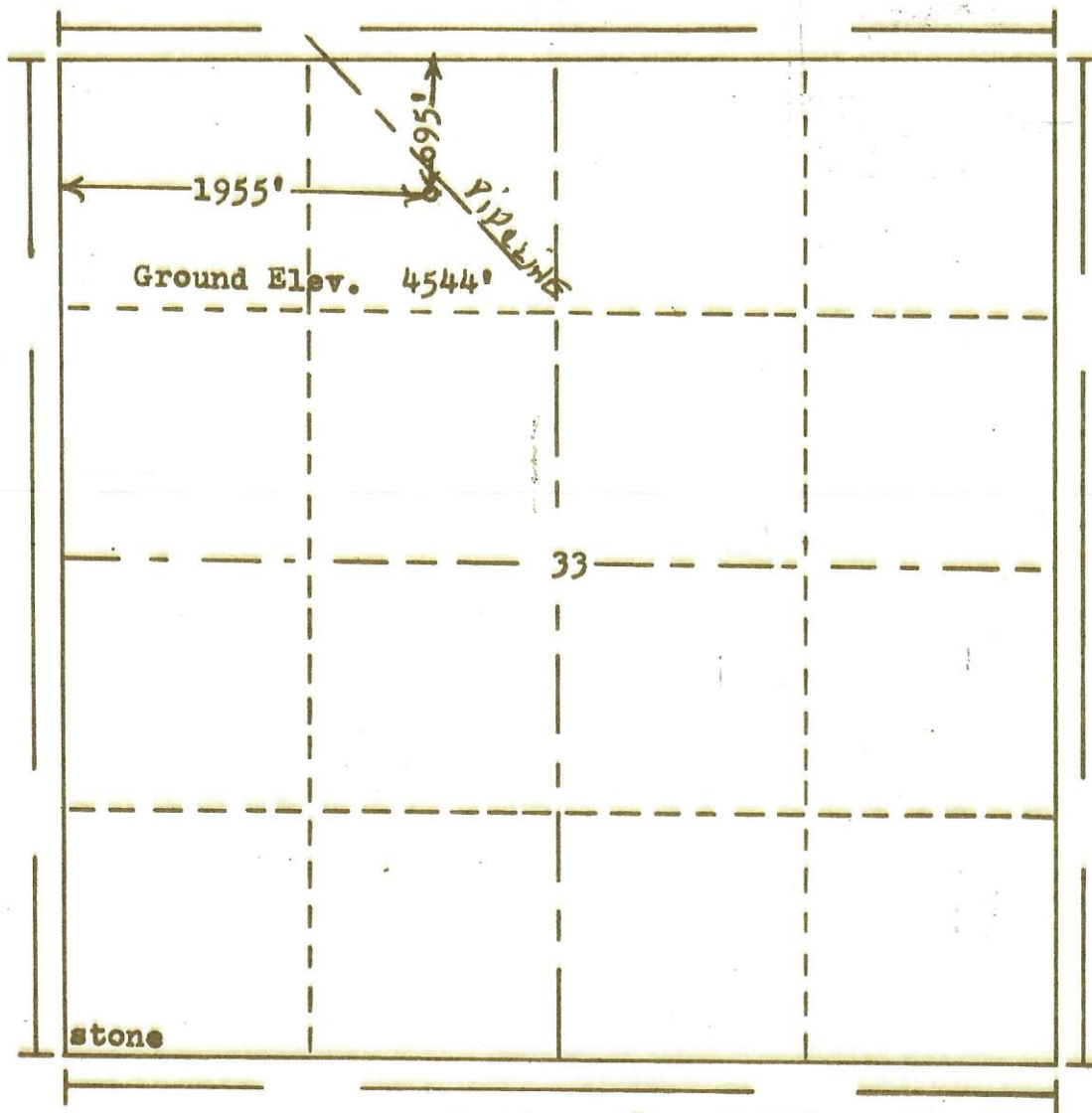

Scale... 1" = 1000'

Powers Elevation Company, Inc. of Denver, Colorado
has in accordance with a request from Mr. Phillips
for Petroleum Inc.

determined the location of No. 1 Nelson "0"
to be 695'FN & 1955'FW Section 33 Township 12N
Range 55W of the 6th Principal Meridian
Logan County, Colorado

I hereby certify that this plat is an
accurate representation of a correct
survey showing the location of

Date: 10-11-68

Billy G. Hollen
Licensed Land Surveyor No. 2853
State of Colorado