

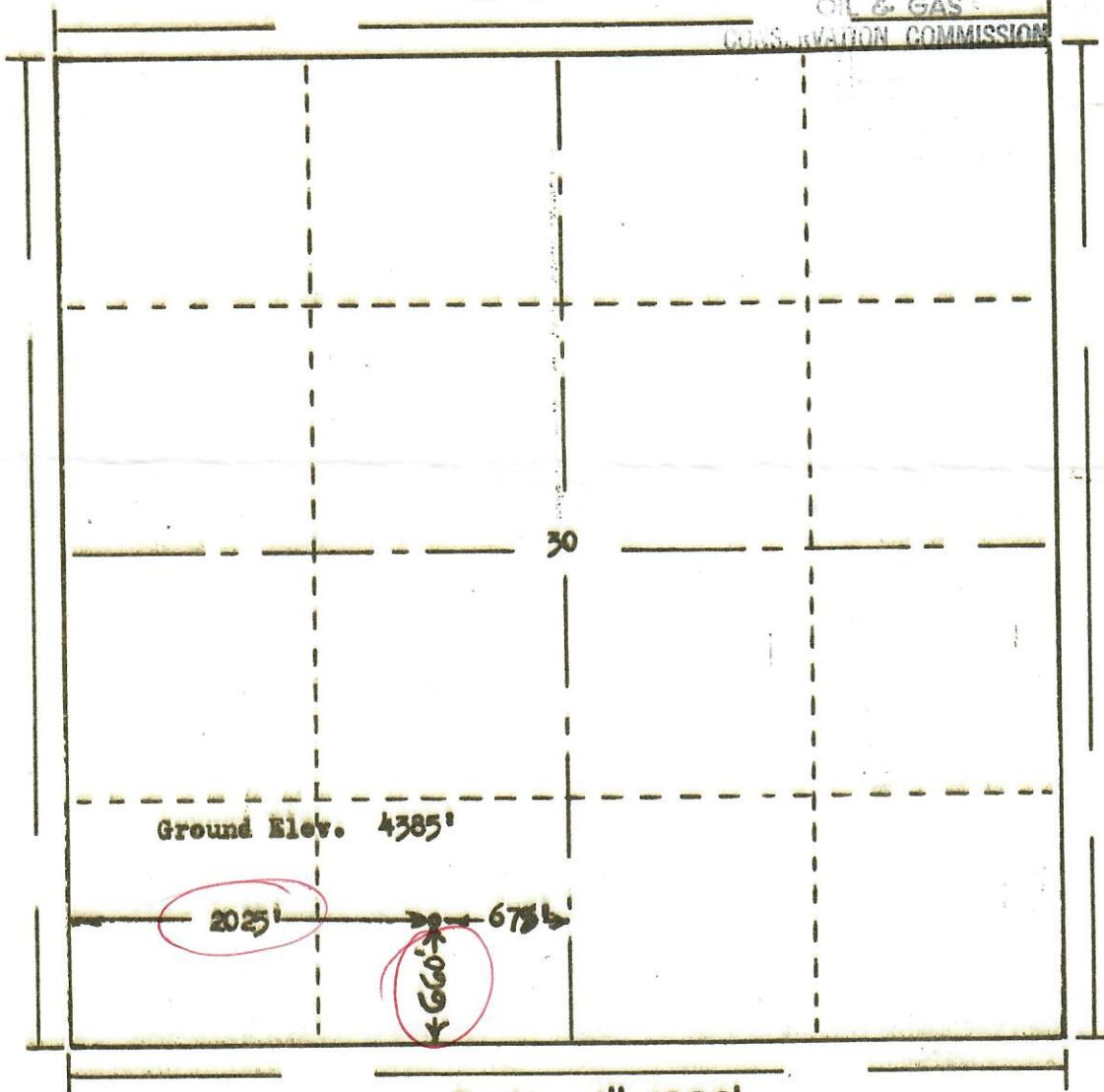

00238924

RECEIVED
NOV 19 1965

R. 54W

OIL & GAS
CONSERVATION COMMISSIONT.
9
N

Scale ... 1" = 1000'

Powers Surveyors, Inc. of Denver, Colorado
has in accordance with a request from Mr. Couch
for Bander & Couch determined the
Location of No. 1-A Warneke
to be CSE SW Section 30 Township 9N
Range 54W of the 6th Principal Meridian
Logan County, Colorado

I hereby certify that this plat is an
accurate representation of a correct
survey showing the location of

Date: 11-12-65

Billy G. Holloway
Licensed Land Surveyor No. 2852
State of Colorado

65 479