

● = PROPOSED WELLHEAD.  
 ◆ = ENTRY POINT.  
 ○ = BOTTOM HOLE LOCATION.  
 ▲ = SECTION CORNERS  
 LOCATED. (NAD 83)  
 △ = SECTION CORNERS  
 RE-ESTABLISHED.  
 (Not Set on Ground.)  
 (NAD 83)

The map displays a 12-acre tract in Weld County, Colorado, divided into 12 lots. The tract is bounded by Adams County to the north and west, and Broomfield County to the east. The map shows lot boundaries with bearings and distances, monument locations with their coordinates and elevations, and a circular area labeled 'RIO 26C' with a graded ground elevation of 5068 feet. The map is oriented with North at the top and includes a north arrow. The survey is dated 2003 and was conducted by a professional surveyor. The map also shows the location of the 'Entry Point' and 'Bottom Hole Location' within the tract.

**Lot 12 Details:**

- Section Corner Re-Established Using Survey Data From Others. UELS Has Not Field Verified The Position. Lat: 39.986463° Long: 104.949847°
- 1995 Alum. Cap. #28664, 0.5' Below Ground Lat: 39.979222° Long: 104.949877°
- 2004 Alum. Cap. #23524 Flush W/ Ground Lat: 39.979652° Long: 104.959422°
- 2003 Alum. Cap. #23524, 0.5' Below Ground in Monument Box Lat: 39.972015° Long: 104.959420°
- 1995 Alum. Cap. #28664, 0.3' Below Ground Lat: 39.971979° Long: 104.949850°

**Lot 6 Details:**

- 1994 Alum. Cap. #13482, 0.5' Below Ground Lat: 39.993514° Long: 104.940308°
- 1995 Alum. Cap. #28664, 0.6' Below Ground in Monument Box Lat: 39.986361° Long: 104.940227°
- 1998 Alum. Cap. #24667, 0.6' Below Ground in Monument Box Lat: 39.986351° Long: 104.931443°
- 2013 Alum. Cap. #36073, 0.4' Below Ground in Monument Box Lat: 39.993589° Long: 104.922102°

**Lot 1 Details:**

- 1996 Alum. Cap. #6973, 0.6' Below Ground in Monument Box Lat: 40.000335° Long: 104.951977°
- 1993 Alum. Cap. #6973, 0.4' Below Ground in Monument Box Lat: 40.000329° Long: 104.961409°
- 1999 Alum. Cap. #26606, 0.5' Below Ground in Mon. Box Lat: 40.000329° Long: 104.959313°
- 1999 Alum. Cap. #23027, 0.5' Below Ground in Monument Box Lat: 40.000340° Long: 104.923692°
- 2001 Alum. Cap. #23027, 0.5' Below Ground in Monument Box Lat: 40.000340° Long: 104.933115°
- 1999 Alum. Cap. #23027, 0.6' Below Ground in Monument Box Lat: 40.000340° Long: 104.923692°
- 2005 Alum. Cap. #27269 Flush W/ Ground Lat: 40.000424° Long: 104.914245°

**Other Features:**

- Entry Point:** Located at the intersection of Lot 1 and Lot 12.
- Bottom Hole Location:** Located at the intersection of Lot 12 and Lot 6.
- RIO 26C:** A circular area with a graded ground elevation of 5068 feet.
- Section Line:** A vertical line running through the center of the tract.

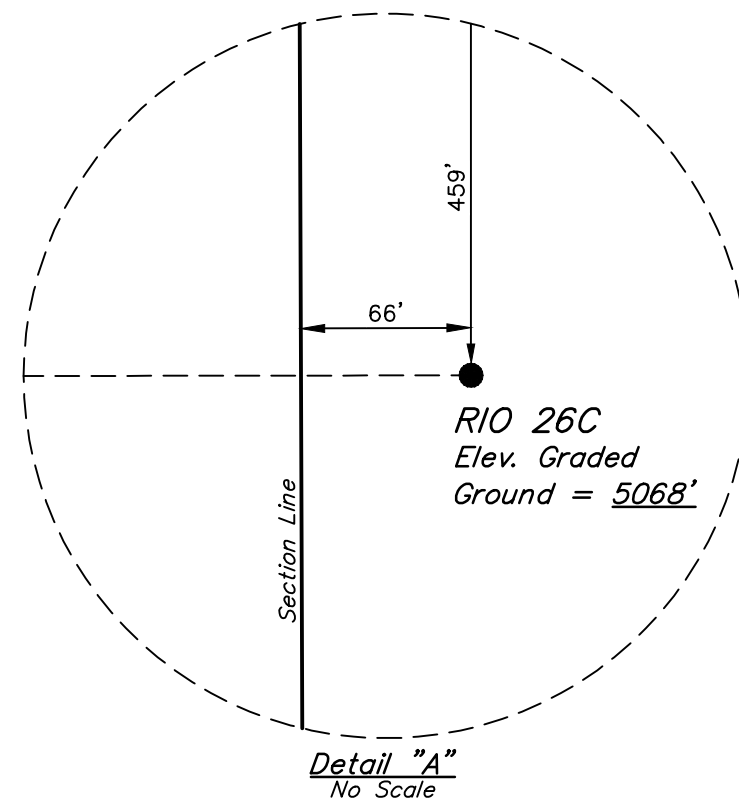

CERTIFICATE

THIS IS TO CERTIFY THAT THE ABOVE PLAN WAS PREPARED FROM THE  
NOTES OF ACTUAL SURVEYS MADE BY ME OR UNDER MY SUPERVISION,  
AND THAT THE SAME ARE TRUE AND CORRECT TO THE BEST OF MY  
KNOWLEDGE AND BELIEF.

REGISTERED LAND SURVEYOR  
REGISTRATION NO. 28285  
STATE OF COLORADO



NAD 83 (SURFACE LOCATION)	NAD 83 (ENTRY POINT)	NAD 83 (BOTTOM HOLE LOCATION)
LATITUDE = 39°59'56.69" (39.999080°)	LATITUDE = 39°59'56.67" (39.999074°)	LATITUDE = 39°58'23.67" (39.973242°)
LONGITUDE = 104°56'24.35" (104.940097°)	LONGITUDE = 104°56'59.58" (104.949884°)	LONGITUDE = 104°56'59.95" (104.949986°)

**BASIS OF ELEVATION**  
OPUS SOLUTION GENERATED NAVD 88



**UELS, LLC**  
Corporate Office \* 85 South 200 East  
Vernal, UT 84078 \* (435) 789-1017

**PDC ENERGY INC.**

**RIO 26C**  
**NW 1/4 NW 1/4, SECTION 6, T1S, R67W, 6th P.M**  
**ADAMS COUNTY, COLORADO**

<b>SURVEYED BY</b>	GREG WEIMER	03-30-20	<b>SCALE</b>
<b>DRAWN BY</b>	P.M.	09-07-22	1" = 100'

## WELL LOCATION PLAT