

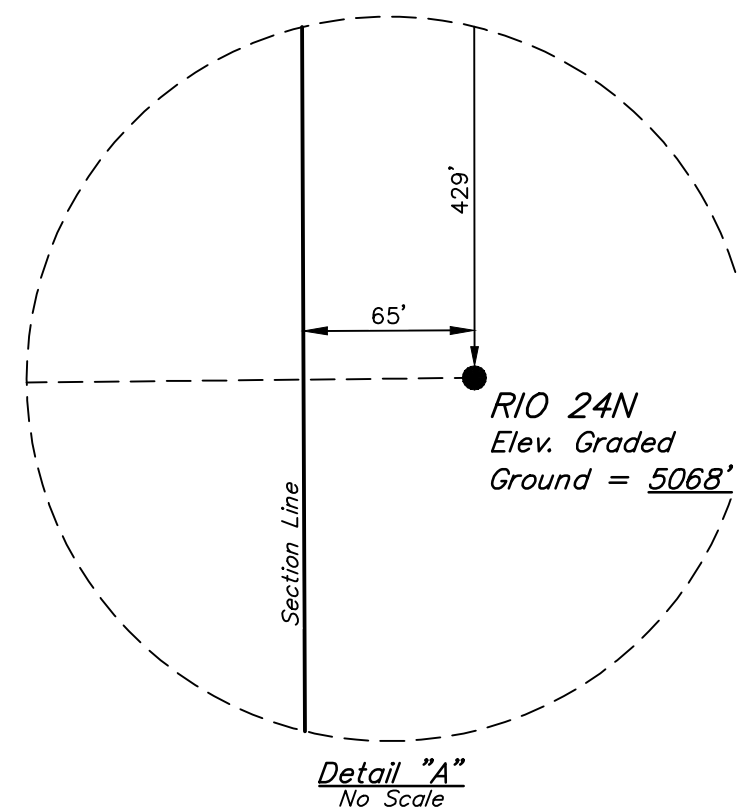

● = PROPOSED WELLHEAD.
 ◆ = ENTRY POINT.
 ○ = BOTTOM HOLE LOCATION.
 ▲ = SECTION CORNERS
 LOCATED. (NAD 83)
 △ = SECTION CORNERS
 RE-ESTABLISHED.
 (Not Set on Ground.)
 (NAD 83)

[illegible]

CERTIFICATE

THIS IS TO CERTIFY THAT THE ABOVE MAP WAS PREPARED FROM THE
NOTES OF ACTUAL SURVEYS MADE BY ME OR UNDER MY SUPERVISION
AND THAT THE SAME ARE TRUE AND CORRECT TO THE BEST OF MY
KNOWLEDGE AND BELIEF.



CERTIFICATE
 ABOVE MAP WAS PREPARED FROM PL
 MADE IN MY OFFICE UNDER MY SUPERVISI
 AND CORRECT TO THE BEST OF MY
 28285
 REGISTERED LAND SURVEYOR
 REGISTRATION NO. 28285
 STATE OF COLORADO
 08-02



PDOP = 1.3

NAD 83 (SURFACE LOCATION)	NAD 83 (ENTRY POINT)	NAD 83 (BOTTOM HOLE LOCATION)
LATITUDE = 39°59'56.99" (39.999163°)	LATITUDE = 39°59'56.66" (39.999073°)	LATITUDE = 39°58'23.70" (39.973249°)
LONGITUDE = 104°56'24.36" (104.940100°)	LONGITUDE = 104°57'06.52" (104.951811°)	LONGITUDE = 104°57'06.88" (104.951912°)

BASIS OF ELEVATION
OPUS SOLUTION GENERATED NAVD 88



UELS, LLC
Corporate Office * 85 South 200 East
Vernal, UT 84078 * (435) 789-1017

PDC ENERGY INC.

RIO 24N
NW 1/4 NW 1/4, SECTION 6, T1S, R67W, 6th P.M.
ADAMS COUNTY, COLORADO

SURVEYED BY	GREG WEIMER	03-30-20	SCALE
DRAWN BY	P.M.	09-07-22	1" = 1000'

WELL LOCATION PLAT