

LEGEND:

- BROOMFIELD CO.
ADAMS CO.

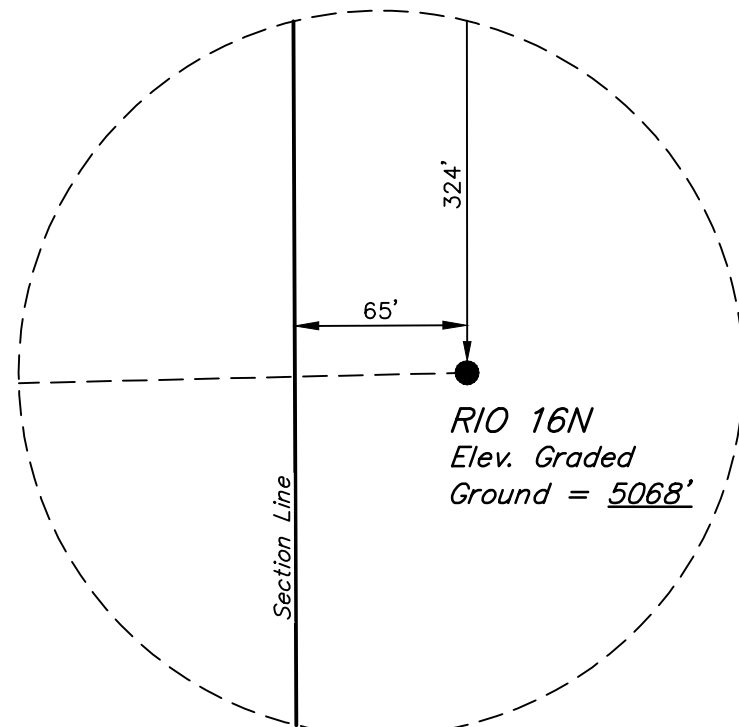

CERTIFICATE
 ABOVE RETURN WAS PREPARED FOR YOU AND
 MADE BY ME OR UNDER MY SUPERVISION
 AND IS ACCURATE TO THE BEST OF MY KNOWLEDGE.
 48285
 REGISTERED LAND SURVEYOR
 REGISTRATION NO. 28285
 STATE OF OREGON 95-06-22
 NATIONAL LAND SURVEYORS

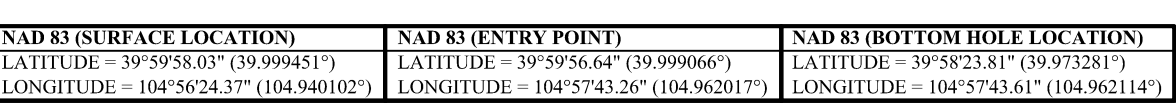

RIO 16N
NW 1/4 NW 1/4, SECTION 6, T1S, R67W, 6th P.M.
ADAMS COUNTY, COLORADO

SURVEYED BY	GREG WEIMER	03-30-20	SCALE
DRAWN BY	P.M.	09-07-22	1" = 1000'
WELL LOCATION PLAT			