



RECEIVED N

MAR 5 1976

COLO. OIL & GAS CONS. CO. M.

R. 55W

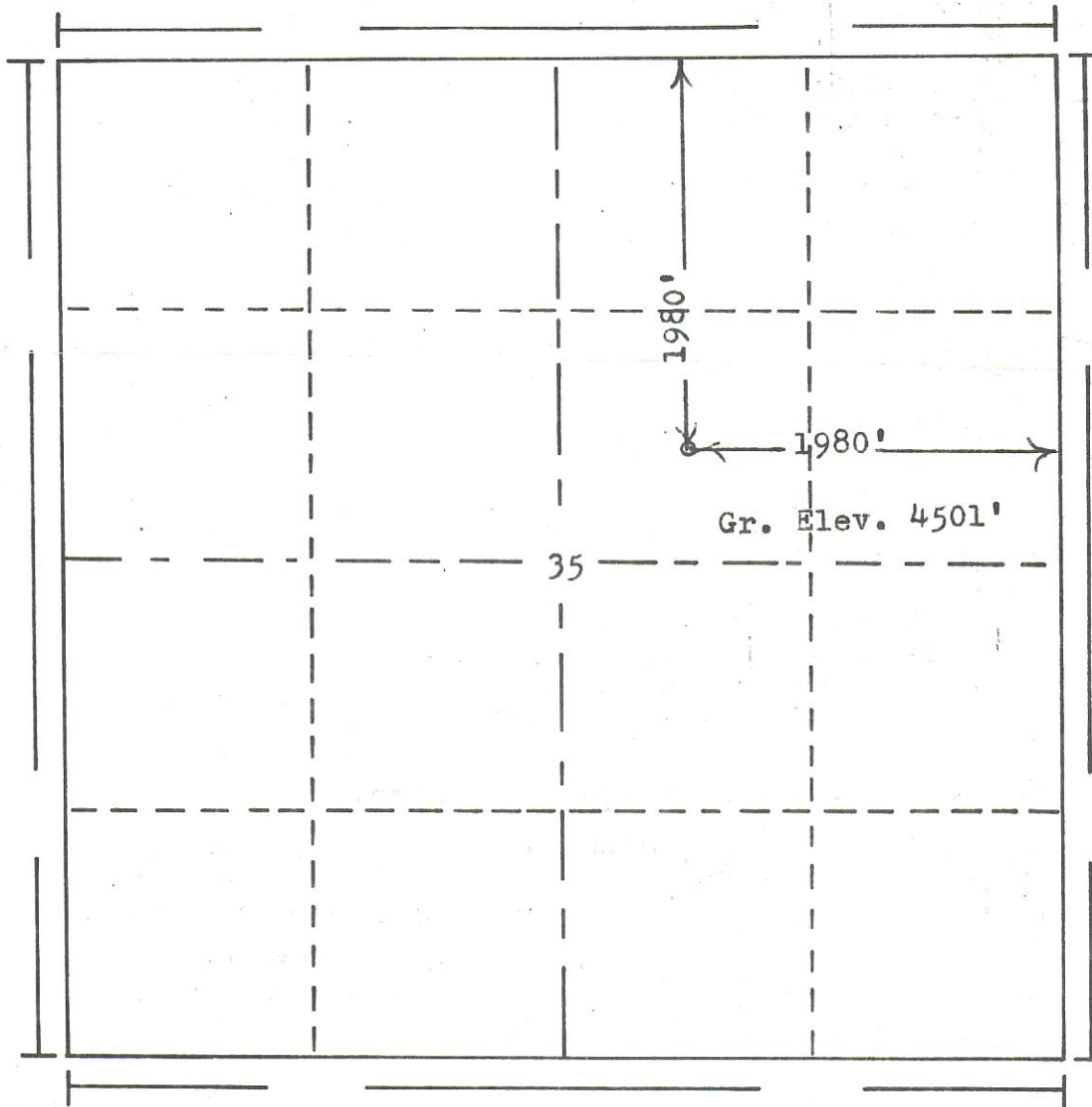
T.
12
N

Scale... 1" = 1000'

Powers Elevation Company, Inc. of Denver, Colorado
has in accordance with a request from Donna Bendixen
for Nebco Exploration & Production Co.

determined the location of No.1 Hatch
to be CSW NE Section 35 Township 12N
Range 55W of the 6th Principal Meridian
Logan County, Colorado

I hereby certify that this plat is an
accurate representation of a correct
survey showing the location of

Date: 2-26-76

Billy J. Hellyer
Licensed Land Surveyor No. 2853
State of Colorado

76 155