

CONFLUENCE RESOURCES

Location: COLORADO Slot: SLOT#15 CANAL 22-2-2L (185°FSL & 1321°FWL,SEC.22)
Field: WELD COUNTY (NAD83, TRUE NORTH) Well: CANAL 22-2-2L
Facility: SEC.22-T01N-R65W Wellbore: CANAL 22-2-2L PWB

Plot reference wellpath is CANAL 22-2-2L PWP Rev-A.0	Grid System: NAD83 / Lambert Colorado SP, Northern Zone (501), US feet
True vertical depths are referenced to Rig (23) (KB)	North Reference: True north
Reference wellpath measured depths are referenced to Rig (23) (KB)	Scale: True distance
Rig (23) (KB) to Mean Sea Level: 5118 feet	Coordinates are in feet referenced to Slot
Mean Sea Level to Mud line (At Slot: SLOT#15 CANAL 22-2-2L (185°FSL & 1321°FWL,SEC.22)): 0 feet	Depths are in feet
Offset wellpath MDs are referenced to each path's default MD datum	Created by: painsetr on 2021-09-01; Database: WellArchitectDB

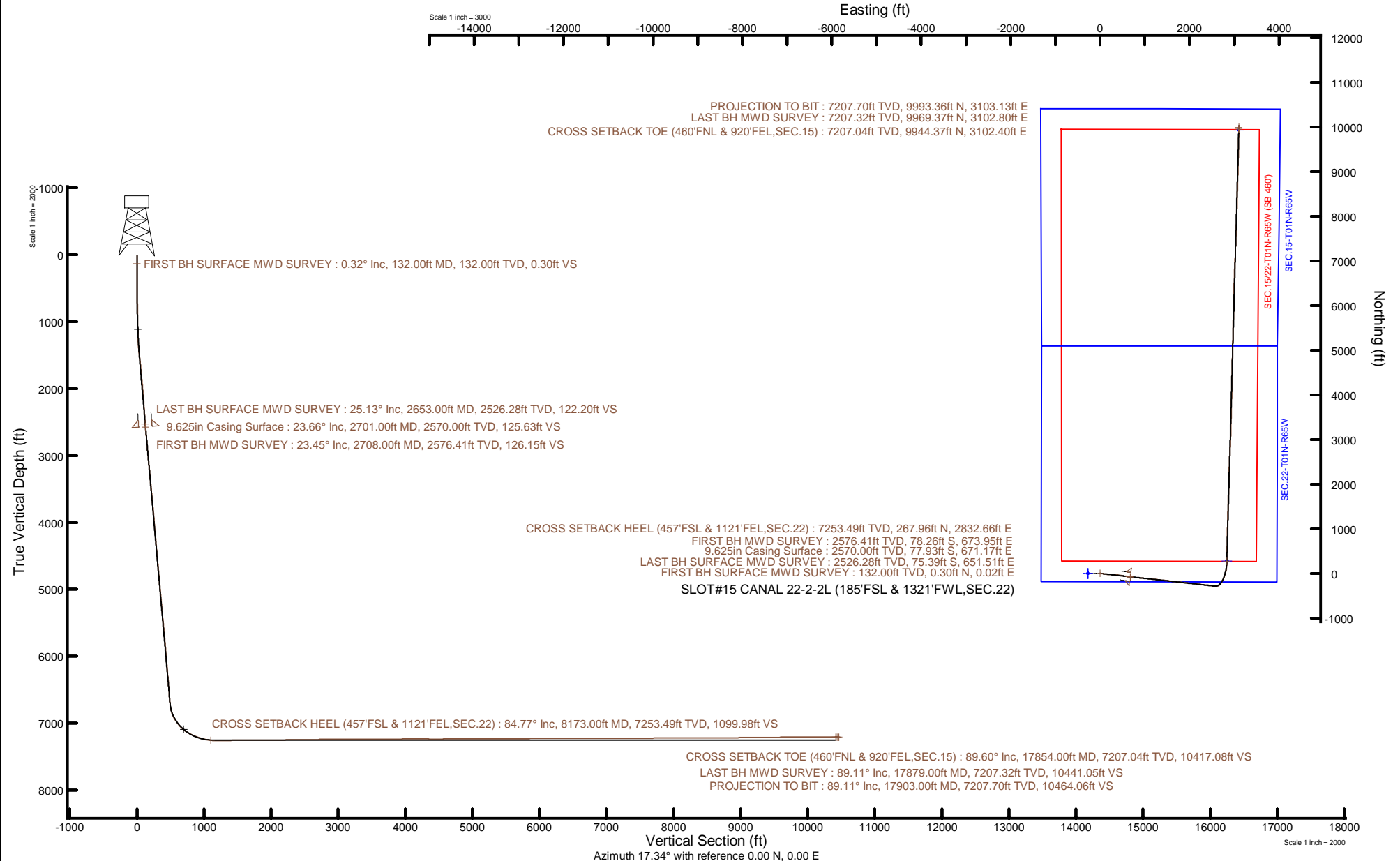

Actual Wellpath Report

CANAL 22-2-2L AWP

Page 1 of 11

REFERENCE WELLPATH IDENTIFICATION

Operator	CONFLUENCE RESOURCES	Well	CANAL 22-2-2L
Field	WELD COUNTY (NAD83, TRUE NORTH)	API	0512351591
Facility	SEC.22-T01N-R65W	Wellbore	CANAL 22-2-2L AWB
Slot	SLOT#15 CANAL 22-2-2L (185'FSL & 1321'FWL,SEC.22)		

REPORT SETUP INFORMATION

Projection System	NAD83 / Lambert Colorado SP, Northern Zone (501), US feet	Software System	WellArchitect® 6.0
North Reference	True	User	Painsetr
Scale	0.999964	Report Generated	9/1/2021 at 10:53:29 AM
Convergence at slot	0.55° East	Database	WellArchitectDB

WELLPATH LOCATION

	Local coordinates		Grid coordinates		Geographic coordinates	
	North[ft]	East[ft]	Easting[US ft]	Northing[US ft]	Latitude	Longitude
Slot Location	0.00	274.44	3236657.88	1254964.75	40.0301700°	-104.6548700°
Facility Reference Pt			3236383.46	1254962.14	40.0301700°	-104.6558500°
Field Reference Pt			3230456.90	1245096.09	40.0032400°	-104.6773400°

WELLPATH DATUM

Calculation method	Minimum curvature	Rig (23') (KB) to Facility Vertical Datum	5118.00ft
Horizontal Reference Pt	Slot	Rig (23') (KB) to Mean Sea Level	5118.00ft
Vertical Reference Pt	Rig (23') (KB)	Rig (23') (KB) to Mud Line at Slot (SLOT#15 CANAL 22-2-2L (185'FSL & 1321'FWL,SEC.22))	5118.00ft
MD Reference Pt	Rig (23') (KB)	Section Origin	N 0.00, E 0.00 ft
Field Vertical Reference	Mean Sea Level	Section Azimuth	17.34°

REFERENCE WELLPATH IDENTIFICATION

Operator	CONFLUENCE RESOURCES	Well	CANAL 22-2-2L
Field	WELD COUNTY (NAD83, TRUE NORTH)	API	0512351591
Facility	SEC.22-T01N-R65W	Wellbore	CANAL 22-2-2L AWB
Slot	SLOT#15 CANAL 22-2-2L (185'FSL & 1321'FWL,SEC.22)		

WELLPATH DATA (206 stations) † = interpolated, ‡ = extrapolated station

MD [ft]	Inclination [°]	Azimuth [°]	TVD [ft]	Vert Sect [ft]	North [ft]	East [ft]	Grid East [US ft]	Grid North [US ft]	Latitude	Longitude	DLS [°/100ft]	Comments
0.00†	0.000	4.020	0.00	0.00	0.00	0.00	3236657.88	1254964.75	40.0301700	-104.6548700	0.00	
23.00	0.000	4.020	23.00	0.00	0.00	0.00	3236657.88	1254964.75	40.0301700	-104.6548700	0.00	
132.00	0.320	4.020	132.00	0.30	0.30	0.02	3236657.90	1254965.05	40.0301708	-104.6548699	0.29	FIRST BH SURFACE MWD SURVEY
227.00	0.220	79.060	227.00	0.64	0.60	0.22	3236658.09	1254965.36	40.0301717	-104.6548692	0.36	
317.00	0.500	22.990	317.00	1.11	1.00	0.54	3236658.41	1254965.75	40.0301727	-104.6548681	0.47	
407.00	0.730	44.830	406.99	2.01	1.77	1.10	3236658.96	1254966.53	40.0301748	-104.6548661	0.36	
497.00	1.030	81.110	496.98	2.88	2.30	2.30	3236660.16	1254967.07	40.0301763	-104.6548618	0.69	
587.00	2.160	93.510	586.95	3.64	2.32	4.80	3236662.65	1254967.11	40.0301764	-104.6548529	1.31	
676.00	4.010	97.150	675.81	4.59	1.83	9.56	3236667.42	1254966.67	40.0301750	-104.6548359	2.09	
766.00	5.830	100.980	765.48	5.66	0.57	17.17	3236675.04	1254965.48	40.0301716	-104.6548087	2.05	
856.00	7.050	93.900	854.91	7.45	-0.68	27.17	3236685.05	1254964.33	40.0301681	-104.6547730	1.61	
945.00	7.990	100.080	943.14	9.50	-2.13	38.71	3236696.60	1254962.98	40.0301641	-104.6547318	1.39	
1034.00	9.630	103.460	1031.09	10.78	-4.95	52.04	3236709.96	1254960.30	40.0301564	-104.6546842	1.93	
1124.00	11.480	100.230	1119.57	12.40	-8.29	68.17	3236726.12	1254957.11	40.0301472	-104.6546266	2.16	
1213.00	13.440	98.800	1206.47	15.03	-11.45	87.11	3236745.09	1254954.13	40.0301386	-104.6545589	2.23	
1303.00	15.630	99.540	1293.58	18.23	-15.06	109.41	3236767.42	1254950.74	40.0301287	-104.6544793	2.44	
1392.00	17.670	93.030	1378.85	23.20	-17.76	134.72	3236792.76	1254948.28	40.0301212	-104.6543889	3.10	
1482.00	19.540	90.350	1464.15	30.97	-18.57	163.42	3236821.46	1254947.73	40.0301190	-104.6542865	2.28	
1571.00	21.970	90.430	1547.36	40.16	-18.79	194.95	3236852.99	1254947.82	40.0301184	-104.6541738	2.73	
1660.00	23.800	92.510	1629.36	49.60	-19.70	229.55	3236887.59	1254947.24	40.0301159	-104.6540503	2.25	
1750.00	24.580	95.250	1711.46	58.17	-22.21	266.33	3236924.40	1254945.08	40.0301090	-104.6539190	1.52	
1840.00	25.440	95.520	1793.02	66.05	-25.78	304.21	3236962.31	1254941.87	40.0300992	-104.6537837	0.96	
1929.00	27.150	97.110	1872.81	73.57	-30.14	343.39	3237001.53	1254937.89	40.0300873	-104.6536438	2.08	
2019.00	26.730	98.260	1953.04	80.41	-35.58	383.80	3237041.98	1254932.83	40.0300723	-104.6534995	0.74	
2108.00	26.250	97.860	2032.69	86.81	-41.15	423.10	3237081.34	1254927.63	40.0300570	-104.6533591	0.58	
2197.00	25.890	97.900	2112.64	93.24	-46.51	461.85	3237120.13	1254922.64	40.0300423	-104.6532208	0.40	
2287.00	25.720	99.880	2193.67	99.00	-52.57	500.55	3237158.89	1254916.96	40.0300257	-104.6530826	0.98	
2376.00	24.950	98.410	2274.11	104.42	-58.62	538.15	3237196.54	1254911.26	40.0300091	-104.6529483	1.12	
2465.00	24.130	98.400	2355.07	110.16	-64.03	574.71	3237233.15	1254906.21	40.0299942	-104.6528178	0.92	
2555.00	24.120	98.650	2437.21	115.80	-69.48	611.09	3237269.58	1254901.10	40.0299792	-104.6526879	0.11	

REFERENCE WELLPATH IDENTIFICATION

Operator	CONFLUENCE RESOURCES	Well	CANAL 22-2-2L
Field	WELD COUNTY (NAD83, TRUE NORTH)	API	0512351591
Facility	SEC.22-T01N-R65W	Wellbore	CANAL 22-2-2L AWB
Slot	SLOT#15 CANAL 22-2-2L (185'FSL & 1321'FWL,SEC.22)		

WELLPATH DATA (206 stations)

MD [ft]	Inclination [°]	Azimuth [°]	TVD [ft]	Vert Sect [ft]	North [ft]	East [ft]	Grid East [US ft]	Grid North [US ft]	Latitude	Longitude	DLS [°/100ft]	Comments
2645.00	25.070	98.050	2519.04	121.65	-74.92	648.15	3237306.69	1254896.02	40.0299643	-104.6525555	1.09	
2653.00	25.130	97.920	2526.28	122.20	-75.39	651.51	3237310.05	1254895.58	40.0299630	-104.6525435	1.02	LAST BH SURFACE MWD SURVEY
2708.00	23.450	96.610	2576.41	126.15	-78.26	673.95	3237332.52	1254892.92	40.0299552	-104.6524634	3.21	FIRST BH MWD SURVEY
2784.00	24.570	96.140	2645.84	132.04	-81.69	704.68	3237363.28	1254889.78	40.0299457	-104.6523536	1.50	
2874.00	24.790	95.700	2727.62	139.48	-85.56	742.06	3237400.69	1254886.27	40.0299351	-104.6522202	0.32	
2964.00	24.840	95.650	2809.31	147.11	-89.30	779.65	3237438.31	1254882.89	40.0299248	-104.6520859	0.06	
3054.00	24.710	95.270	2891.02	154.88	-92.89	817.19	3237475.89	1254879.66	40.0299150	-104.6519519	0.23	
3143.00	24.680	95.520	2971.88	162.57	-96.38	854.21	3237512.94	1254876.52	40.0299054	-104.6518197	0.12	
3233.00	24.770	95.180	3053.63	170.39	-99.89	891.69	3237550.45	1254873.36	40.0298957	-104.6516859	0.19	
3322.00	24.460	95.780	3134.54	178.01	-103.43	928.59	3237587.38	1254870.18	40.0298860	-104.6515541	0.45	
3411.00	24.590	95.470	3215.51	185.51	-107.05	965.36	3237624.18	1254866.91	40.0298761	-104.6514228	0.21	
3501.00	24.600	94.830	3297.35	193.42	-110.42	1002.66	3237661.51	1254863.90	40.0298668	-104.6512896	0.30	
3590.00	24.130	95.750	3378.42	201.09	-113.80	1039.22	3237698.10	1254860.87	40.0298576	-104.6511590	0.68	
3679.00	23.790	96.110	3459.75	208.24	-117.53	1075.17	3237734.08	1254857.48	40.0298473	-104.6510307	0.42	
3768.00	24.760	95.390	3540.88	215.59	-121.19	1111.58	3237770.52	1254854.16	40.0298372	-104.6509007	1.14	
3858.00	24.670	95.570	3622.64	223.32	-124.79	1149.03	3237808.01	1254850.93	40.0298274	-104.6507669	0.13	
3946.00	24.780	95.210	3702.57	230.94	-128.24	1185.68	3237844.68	1254847.82	40.0298179	-104.6506361	0.21	
4036.00	24.590	95.930	3784.35	238.61	-131.89	1223.09	3237882.12	1254844.53	40.0298079	-104.6505025	0.40	
4125.00	24.730	96.250	3865.23	245.85	-135.83	1260.01	3237919.08	1254840.94	40.0297970	-104.6503706	0.22	
4215.00	24.250	97.120	3947.13	252.75	-140.17	1297.07	3237956.17	1254836.95	40.0297851	-104.6502383	0.67	
4304.00	24.470	96.030	4028.21	259.61	-144.37	1333.53	3237992.67	1254833.10	40.0297736	-104.6501081	0.56	
4394.00	24.510	97.010	4110.11	266.61	-148.61	1370.60	3238029.78	1254829.22	40.0297620	-104.6499757	0.45	
4484.00	24.600	96.040	4191.98	273.63	-152.86	1407.76	3238066.97	1254825.32	40.0297503	-104.6498431	0.46	
4573.00	24.450	96.560	4272.95	280.70	-156.91	1444.48	3238103.73	1254821.62	40.0297392	-104.6497119	0.30	
4662.00	25.290	96.880	4353.69	287.60	-161.29	1481.65	3238140.94	1254817.59	40.0297271	-104.6495792	0.96	
4751.00	25.450	96.520	4434.11	294.64	-165.74	1519.52	3238178.85	1254813.50	40.0297149	-104.6494440	0.25	
4841.00	24.670	96.460	4515.64	301.82	-170.05	1557.40	3238216.76	1254809.56	40.0297031	-104.6493087	0.87	
4930.00	24.960	96.510	4596.42	308.85	-174.27	1594.51	3238253.92	1254805.69	40.0296915	-104.6491762	0.33	
5020.00	25.420	96.290	4677.86	316.12	-178.54	1632.58	3238292.02	1254801.79	40.0296797	-104.6490402	0.52	
5109.00	24.430	96.720	4758.57	323.17	-182.79	1669.84	3238329.32	1254797.89	40.0296681	-104.6489072	1.13	

Actual Wellpath Report

CANAL 22-2-2L AWP

Page 4 of 11

REFERENCE WELLPATH IDENTIFICATION

Operator	CONFLUENCE RESOURCES	Well	CANAL 22-2-2L
Field	WELD COUNTY (NAD83, TRUE NORTH)	API	0512351591
Facility	SEC.22-T01N-R65W	Wellbore	CANAL 22-2-2L AWB
Slot	SLOT#15 CANAL 22-2-2L (185'FSL & 1321'FWL,SEC.22)		

WELLPATH DATA (206 stations)

MD [ft]	Inclination [°]	Azimuth [°]	TVD [ft]	Vert Sect [ft]	North [ft]	East [ft]	Grid East [US ft]	Grid North [US ft]	Latitude	Longitude	DLS [°/100ft]	Comments
5198.00	25.420	96.270	4839.28	330.23	-187.03	1707.11	3238366.63	1254794.01	40.0296564	-104.6487741	1.13	
5288.00	25.380	95.490	4920.58	337.90	-190.98	1745.51	3238405.06	1254790.42	40.0296456	-104.6486370	0.37	
5377.00	25.510	96.320	5000.95	345.48	-194.91	1783.54	3238443.13	1254786.85	40.0296348	-104.6485012	0.43	
5466.00	25.360	95.860	5081.32	352.93	-198.97	1821.55	3238481.17	1254783.16	40.0296236	-104.6483654	0.28	
5556.00	25.370	95.770	5162.64	360.64	-202.88	1859.91	3238519.56	1254779.62	40.0296129	-104.6482285	0.04	
5646.00	25.200	96.390	5244.02	368.14	-206.95	1898.13	3238557.82	1254775.91	40.0296017	-104.6480920	0.35	
5736.00	25.170	96.580	5325.47	375.35	-211.27	1936.19	3238595.92	1254771.95	40.0295898	-104.6479561	0.10	
5826.00	24.850	96.160	5407.03	382.59	-215.50	1974.00	3238633.77	1254768.09	40.0295782	-104.6478211	0.41	
5915.00	25.380	95.830	5487.61	390.02	-219.44	2011.57	3238671.37	1254764.50	40.0295674	-104.6476869	0.62	
6005.00	24.750	95.870	5569.14	397.62	-223.33	2049.50	3238709.33	1254760.98	40.0295567	-104.6475515	0.70	
6095.00	24.710	96.290	5650.88	404.97	-227.31	2086.94	3238746.81	1254757.35	40.0295458	-104.6474178	0.20	
6185.00	24.710	96.200	5732.64	412.21	-231.41	2124.34	3238784.24	1254753.61	40.0295345	-104.6472842	0.04	
6275.00	24.790	96.180	5814.37	419.49	-235.47	2161.80	3238821.74	1254749.90	40.0295234	-104.6471505	0.09	
6364.00	24.750	97.180	5895.19	426.39	-239.81	2198.83	3238858.81	1254745.92	40.0295114	-104.6470182	0.47	
6455.00	24.430	97.660	5977.93	432.92	-244.70	2236.38	3238896.40	1254741.39	40.0294980	-104.6468842	0.41	
6544.00	24.560	96.950	6058.92	439.35	-249.39	2272.98	3238933.05	1254737.05	40.0294851	-104.6467535	0.36	
6634.00	24.720	96.920	6140.73	446.12	-253.92	2310.23	3238970.33	1254732.87	40.0294727	-104.6466205	0.18	
6724.00	24.720	97.300	6222.48	452.80	-258.58	2347.57	3239007.72	1254728.57	40.0294599	-104.6464871	0.18	
6814.00	24.850	97.040	6304.19	459.47	-263.28	2385.01	3239045.20	1254724.22	40.0294470	-104.6463534	0.19	
6903.00	24.880	96.760	6384.94	466.25	-267.78	2422.16	3239082.39	1254720.08	40.0294346	-104.6462208	0.14	
6993.00	24.820	97.150	6466.61	473.06	-272.36	2459.70	3239119.97	1254715.86	40.0294220	-104.6460867	0.19	
7083.00	24.720	97.050	6548.33	479.77	-277.02	2497.12	3239157.43	1254711.55	40.0294092	-104.6459531	0.12	
7172.00	24.510	97.540	6629.24	486.23	-281.73	2533.89	3239194.24	1254707.20	40.0293963	-104.6458218	0.33	
7262.00	24.860	96.640	6711.02	492.92	-286.36	2571.19	3239231.58	1254702.91	40.0293835	-104.6456886	0.57	
7351.00	25.130	78.390	6791.80	505.56	-284.72	2608.34	3239268.71	1254704.91	40.0293880	-104.6455559	8.64	
7441.00	28.630	61.280	6872.19	530.38	-270.49	2646.04	3239306.27	1254719.50	40.0294271	-104.6454213	9.40	
7530.00	35.450	42.970	6947.76	569.14	-241.25	2682.46	3239342.41	1254749.08	40.0295073	-104.6452913	13.26	
7620.00	40.950	32.950	7018.53	621.17	-197.33	2716.35	3239375.88	1254793.32	40.0296279	-104.6451702	9.19	
7709.00	48.000	26.110	7082.03	682.05	-143.06	2746.82	3239405.83	1254847.88	40.0297769	-104.6450614	9.57	
7800.00	58.000	20.840	7136.75	754.20	-76.44	2775.52	3239433.89	1254914.77	40.0299597	-104.6449589	11.92	



Actual Wellpath Report

CANAL 22-2-2L AWP

Page 5 of 11



REFERENCE WELLPATH IDENTIFICATION

Operator	CONFLUENCE RESOURCES	Well	CANAL 22-2-2L
Field	WELD COUNTY (NAD83, TRUE NORTH)	API	0512351591
Facility	SEC.22-T01N-R65W	Wellbore	CANAL 22-2-2L AWB
Slot	SLOT#15 CANAL 22-2-2L (185'FSL & 1321'FWL,SEC.22)		

WELLPATH DATA (206 stations) † = interpolated, ‡ = extrapolated station

MD [ft]	Inclination [°]	Azimuth [°]	TVD [ft]	Vert Sect [ft]	North [ft]	East [ft]	Grid East [US ft]	Grid North [US ft]	Latitude	Longitude	DLS [°/100ft]	Comments
7889.00	67.850	16.600	7177.23	833.30	-1.46	2800.79	3239458.45	1254989.98	40.0301656	-104.6448686	11.85	
7978.00	69.390	9.690	7209.71	915.89	79.19	2819.59	3239476.48	1255070.80	40.0303869	-104.6448014	7.43	
8068.00	76.230	2.950	7236.32	1000.16	164.54	2828.95	3239485.03	1255156.24	40.0306212	-104.6447680	10.43	
8158.00	83.710	1.410	7251.98	1085.63	253.04	2832.31	3239487.54	1255244.76	40.0308642	-104.6447560	8.48	
8173.00†	84.770	1.320	7253.49	1099.98	267.96	2832.66	3239487.75	1255259.68	40.0309051	-104.6447547	7.09	CROSS SETBACK HEEL (457'FSL & 1121'FEL,SEC.22)
8247.00	90.000	0.880	7256.86	1170.93	341.84	2834.08	3239488.47	1255333.57	40.0311079	-104.6447496	7.09	
8337.00	90.830	1.420	7256.21	1257.36	431.82	2835.89	3239489.42	1255423.56	40.0313549	-104.6447431	1.10	
8426.00	90.650	1.080	7255.06	1342.86	520.79	2837.83	3239490.51	1255512.54	40.0315992	-104.6447361	0.43	
8516.00	90.060	1.200	7254.50	1429.29	610.77	2839.62	3239491.44	1255602.53	40.0318462	-104.6447297	0.67	
8605.00	90.280	1.360	7254.24	1514.82	699.75	2841.61	3239492.58	1255691.52	40.0320904	-104.6447226	0.31	
8695.00	90.060	1.360	7253.97	1601.34	789.72	2843.75	3239493.86	1255781.51	40.0323374	-104.6447149	0.24	
8785.00	89.940	1.540	7253.97	1687.90	879.69	2846.02	3239495.28	1255871.50	40.0325844	-104.6447067	0.24	
8875.00	90.120	1.350	7253.93	1774.46	969.67	2848.29	3239496.69	1255961.48	40.0328314	-104.6446986	0.29	
8965.00	90.800	1.280	7253.20	1860.96	1059.64	2850.36	3239497.90	1256051.47	40.0330783	-104.6446912	0.76	
9055.00	90.740	1.490	7251.99	1947.48	1149.60	2852.53	3239499.22	1256141.44	40.0333253	-104.6446834	0.24	
9145.00	90.830	1.700	7250.76	2034.10	1239.56	2855.04	3239500.86	1256231.42	40.0335722	-104.6446744	0.25	
9235.00	90.800	1.500	7249.48	2120.72	1329.52	2857.55	3239502.52	1256321.39	40.0338192	-104.6446654	0.22	
9324.00	90.890	1.830	7248.17	2206.40	1418.47	2860.14	3239504.26	1256410.36	40.0340634	-104.6446561	0.38	
9413.00	90.830	1.670	7246.83	2292.11	1507.42	2862.85	3239506.13	1256499.33	40.0343075	-104.6446464	0.19	
9502.00	90.770	1.510	7245.59	2377.76	1596.38	2865.32	3239507.75	1256588.30	40.0345517	-104.6446375	0.19	
9592.00	90.620	1.470	7244.50	2464.34	1686.34	2867.66	3239509.23	1256678.28	40.0347987	-104.6446291	0.17	
9681.00	90.740	1.140	7243.44	2549.87	1775.31	2869.69	3239510.41	1256767.26	40.0350429	-104.6446218	0.39	
9771.00	90.740	1.360	7242.28	2636.34	1865.28	2871.65	3239511.51	1256857.24	40.0352899	-104.6446148	0.24	
9861.00	90.680	1.390	7241.16	2722.86	1955.25	2873.81	3239512.82	1256947.22	40.0355368	-104.6446071	0.07	
9950.00	90.680	1.290	7240.11	2808.41	2044.22	2875.89	3239514.05	1257036.20	40.0357811	-104.6445996	0.11	
10040.00	90.090	1.830	7239.50	2895.01	2134.18	2878.34	3239515.64	1257126.18	40.0360280	-104.6445908	0.89	
10129.00	90.250	2.640	7239.24	2980.94	2223.11	2881.81	3239518.27	1257215.14	40.0362721	-104.6445784	0.93	
10219.00	90.460	2.570	7238.68	3067.97	2313.02	2885.90	3239521.50	1257305.08	40.0365189	-104.6445637	0.25	
10308.00	89.910	2.580	7238.39	3154.04	2401.93	2889.90	3239524.65	1257394.02	40.0367630	-104.6445494	0.62	
10398.00	89.940	2.280	7238.51	3241.01	2491.84	2893.72	3239527.61	1257483.97	40.0370098	-104.6445357	0.33	

REFERENCE WELLPATH IDENTIFICATION

Operator	CONFLUENCE RESOURCES	Well	CANAL 22-2-2L
Field	WELD COUNTY (NAD83, TRUE NORTH)	API	0512351591
Facility	SEC.22-T01N-R65W	Wellbore	CANAL 22-2-2L AWB
Slot	SLOT#15 CANAL 22-2-2L (185'FSL & 1321'FWL,SEC.22)		

WELLPATH DATA (206 stations)

MD [ft]	Inclination [°]	Azimuth [°]	TVD [ft]	Vert Sect [ft]	North [ft]	East [ft]	Grid East [US ft]	Grid North [US ft]	Latitude	Longitude	DLS [°/100ft]	Comments
10487.00	90.000	2.350	7238.56	3326.96	2580.77	2897.31	3239530.36	1257572.92	40.0372539	-104.6445229	0.10	
10577.00	90.550	2.790	7238.13	3413.99	2670.68	2901.35	3239533.53	1257662.86	40.0375007	-104.6445084	0.78	
10667.00	90.650	2.980	7237.18	3501.14	2760.56	2905.88	3239537.21	1257752.78	40.0377475	-104.6444922	0.24	
10757.00	90.980	2.550	7235.90	3588.23	2850.45	2910.22	3239540.69	1257842.69	40.0379942	-104.6444767	0.60	
10847.00	89.910	2.250	7235.20	3675.18	2940.36	2913.99	3239543.60	1257932.64	40.0382410	-104.6444632	1.23	
10936.00	89.910	2.640	7235.34	3761.19	3029.28	2917.79	3239546.55	1258021.59	40.0384851	-104.6444496	0.44	
11026.00	89.850	1.350	7235.53	3847.98	3119.23	2920.92	3239548.83	1258111.55	40.0387320	-104.6444383	1.43	
11116.00	91.050	1.060	7234.83	3934.43	3209.20	2922.81	3239549.86	1258201.54	40.0389790	-104.6444315	1.37	
11205.00	90.430	1.630	7233.68	4019.98	3298.17	2924.90	3239551.10	1258290.52	40.0392232	-104.6444240	0.95	
11294.00	89.660	1.420	7233.61	4105.61	3387.14	2927.27	3239552.62	1258379.50	40.0394675	-104.6444155	0.90	
11384.00	90.030	1.300	7233.85	4192.13	3477.11	2929.40	3239553.90	1258469.49	40.0397144	-104.6444079	0.43	
11473.00	89.600	1.190	7234.14	4277.65	3566.09	2931.34	3239554.99	1258558.48	40.0399587	-104.6444009	0.50	
11563.00	89.780	1.290	7234.62	4364.12	3656.07	2933.29	3239556.08	1258648.47	40.0402057	-104.6443939	0.23	
11652.00	89.910	1.390	7234.87	4449.67	3745.04	2935.37	3239557.31	1258737.46	40.0404499	-104.6443865	0.18	
11742.00	90.280	1.410	7234.72	4536.21	3835.01	2937.57	3239558.65	1258827.44	40.0406969	-104.6443786	0.41	
11831.00	89.970	1.250	7234.52	4621.76	3923.99	2939.63	3239559.87	1258916.43	40.0409412	-104.6443712	0.39	
11921.00	90.180	1.380	7234.40	4708.26	4013.97	2941.70	3239561.08	1259006.42	40.0411882	-104.6443637	0.27	
12010.00	90.090	1.210	7234.19	4793.79	4102.94	2943.71	3239562.24	1259095.41	40.0414324	-104.6443565	0.22	
12100.00	90.060	1.230	7234.08	4880.25	4192.92	2945.62	3239563.30	1259185.40	40.0416794	-104.6443496	0.04	
12189.00	89.910	0.650	7234.10	4965.63	4281.91	2947.09	3239563.91	1259274.39	40.0419237	-104.6443444	0.67	
12279.00	89.940	0.930	7234.22	5051.90	4371.90	2948.33	3239564.29	1259364.39	40.0421707	-104.6443399	0.31	
12369.00	90.060	1.100	7234.22	5138.28	4461.89	2949.92	3239565.03	1259454.38	40.0424177	-104.6443342	0.23	
12458.00	90.250	1.270	7233.98	5223.76	4550.87	2951.76	3239566.02	1259543.37	40.0426620	-104.6443276	0.29	
12548.00	90.120	1.500	7233.69	5310.30	4640.84	2953.94	3239567.34	1259633.36	40.0429090	-104.6443198	0.29	
12637.00	90.370	1.820	7233.31	5395.98	4729.80	2956.51	3239569.07	1259722.34	40.0431532	-104.6443105	0.46	
12727.00	90.550	1.300	7232.58	5482.59	4819.77	2958.96	3239570.66	1259812.32	40.0434001	-104.6443017	0.61	
12816.00	90.740	1.700	7231.58	5568.20	4908.73	2961.29	3239572.14	1259901.29	40.0436443	-104.6442934	0.50	
12905.00	90.550	1.550	7230.58	5653.87	4997.69	2963.82	3239573.82	1259990.27	40.0438885	-104.6442843	0.27	
12995.00	90.830	1.610	7229.50	5740.48	5087.65	2966.30	3239575.44	1260080.24	40.0441355	-104.6442754	0.32	
13084.00	90.680	1.390	7228.32	5826.10	5176.61	2968.63	3239576.93	1260169.22	40.0443797	-104.6442671	0.30	

REFERENCE WELLPATH IDENTIFICATION

Operator	CONFLUENCE RESOURCES	Well	CANAL 22-2-2L
Field	WELD COUNTY (NAD83, TRUE NORTH)	API	0512351591
Facility	SEC.22-T01N-R65W	Wellbore	CANAL 22-2-2L AWB
Slot	SLOT#15 CANAL 22-2-2L (185'FSL & 1321'FWL,SEC.22)		

WELLPATH DATA (206 stations)

MD [ft]	Inclination [°]	Azimuth [°]	TVD [ft]	Vert Sect [ft]	North [ft]	East [ft]	Grid East [US ft]	Grid North [US ft]	Latitude	Longitude	DLS [°/100ft]	Comments
13174.00	90.680	1.490	7227.25	5912.65	5266.57	2970.89	3239578.33	1260259.20	40.0446266	-104.6442590	0.11	
13264.00	90.950	1.570	7225.97	5999.23	5356.53	2973.29	3239579.87	1260349.17	40.0448736	-104.6442503	0.31	
13353.00	89.780	1.560	7225.41	6084.88	5445.50	2975.72	3239581.46	1260438.15	40.0451178	-104.6442416	1.31	
13442.00	89.750	1.290	7225.77	6170.47	5534.47	2977.94	3239582.82	1260527.14	40.0453620	-104.6442337	0.31	
13531.00	89.570	359.980	7226.30	6255.71	5623.46	2978.92	3239582.96	1260616.13	40.0456063	-104.6442301	1.49	
13621.00	89.970	1.220	7226.66	6341.89	5713.45	2979.87	3239583.05	1260706.13	40.0458533	-104.6442267	1.45	
13710.00	90.030	1.610	7226.66	6427.48	5802.42	2982.06	3239584.39	1260795.11	40.0460976	-104.6442188	0.44	
13799.00	90.220	1.260	7226.47	6513.07	5891.40	2984.29	3239585.78	1260884.10	40.0463418	-104.6442108	0.45	
13889.00	90.150	1.010	7226.18	6599.49	5981.38	2986.07	3239586.70	1260974.09	40.0465888	-104.6442044	0.29	
13978.00	90.310	1.800	7225.82	6685.07	6070.35	2988.26	3239588.03	1261063.07	40.0468331	-104.6441966	0.91	
14068.00	90.310	2.040	7225.33	6771.83	6160.30	2991.27	3239590.19	1261153.04	40.0470800	-104.6441858	0.27	
14157.00	89.970	1.170	7225.12	6857.50	6249.26	2993.76	3239591.84	1261242.02	40.0473242	-104.6441768	1.05	
14247.00	89.850	1.130	7225.26	6943.93	6339.24	2995.57	3239592.79	1261332.01	40.0475712	-104.6441703	0.14	
14337.00	90.030	1.160	7225.35	7030.36	6429.23	2997.37	3239593.73	1261422.01	40.0478182	-104.6441639	0.20	
14426.00	90.090	1.450	7225.26	7115.89	6518.20	2999.40	3239594.91	1261511.00	40.0480624	-104.6441566	0.33	
14516.00	89.850	1.110	7225.31	7202.38	6608.18	3001.41	3239596.06	1261600.98	40.0483094	-104.6441494	0.46	
14605.00	89.690	1.540	7225.66	7287.93	6697.15	3003.47	3239597.27	1261689.97	40.0485537	-104.6441420	0.52	
14694.00	90.090	3.300	7225.83	7373.92	6786.07	3007.22	3239600.18	1261778.92	40.0487978	-104.6441285	2.03	
14784.00	90.830	2.420	7225.11	7461.06	6875.95	3011.71	3239603.81	1261868.84	40.0490445	-104.6441124	1.28	
14873.00	90.950	2.320	7223.73	7547.03	6964.87	3015.39	3239606.64	1261957.78	40.0492886	-104.6440993	0.18	
14963.00	90.800	1.950	7222.35	7633.87	7054.79	3018.75	3239609.14	1262047.73	40.0495354	-104.6440873	0.44	
15052.00	91.020	2.280	7220.94	7719.74	7143.72	3022.03	3239611.58	1262136.68	40.0497795	-104.6440755	0.45	
15142.00	90.340	2.170	7219.87	7806.62	7233.65	3025.52	3239614.21	1262226.63	40.0500264	-104.6440630	0.77	
15231.00	90.340	2.190	7219.34	7892.52	7322.58	3028.91	3239616.75	1262315.59	40.0502705	-104.6440508	0.02	
15321.00	90.250	2.560	7218.88	7979.47	7412.50	3032.64	3239619.62	1262405.54	40.0505173	-104.6440375	0.42	
15411.00	90.030	2.210	7218.66	8066.42	7502.42	3036.38	3239622.51	1262495.49	40.0507642	-104.6440241	0.46	
15500.00	90.000	2.410	7218.64	8152.37	7591.35	3039.97	3239625.25	1262584.44	40.0510083	-104.6440112	0.23	
15590.00	89.850	2.080	7218.76	8239.27	7681.28	3043.50	3239627.92	1262674.40	40.0512552	-104.6439986	0.40	
15679.00	90.150	2.550	7218.76	8325.22	7770.21	3047.09	3239630.66	1262763.35	40.0514993	-104.6439857	0.63	
15769.00	90.310	2.820	7218.39	8412.30	7860.11	3051.31	3239634.02	1262853.29	40.0517461	-104.6439706	0.35	

REFERENCE WELLPATH IDENTIFICATION

Operator	CONFLUENCE RESOURCES	Well	CANAL 22-2-2L
Field	WELD COUNTY (NAD83, TRUE NORTH)	API	0512351591
Facility	SEC.22-T01N-R65W	Wellbore	CANAL 22-2-2L AWB
Slot	SLOT#15 CANAL 22-2-2L (185'FSL & 1321'FWL,SEC.22)		

WELLPATH DATA (206 stations) † = interpolated, ‡ = extrapolated station

MD [ft]	Inclination [°]	Azimuth [°]	TVD [ft]	Vert Sect [ft]	North [ft]	East [ft]	Grid East [US ft]	Grid North [US ft]	Latitude	Longitude	DLS °/100ft	Comments
15859.00	90.520	1.300	7217.74	8499.11	7950.05	3054.54	3239636.40	1262943.25	40.0519929	-104.6439590	1.70	
15948.00	90.310	1.070	7217.10	8584.59	8039.03	3056.38	3239637.39	1263032.24	40.0522372	-104.6439524	0.35	
16038.00	90.490	1.400	7216.47	8671.06	8129.00	3058.32	3239638.48	1263122.22	40.0524842	-104.6439454	0.42	
16127.00	90.060	1.410	7216.04	8756.64	8217.97	3060.51	3239639.81	1263211.21	40.0527284	-104.6439376	0.48	
16217.00	90.250	1.220	7215.80	8843.14	8307.95	3062.57	3239641.02	1263301.20	40.0529754	-104.6439302	0.30	
16307.00	90.710	1.540	7215.04	8929.67	8397.92	3064.74	3239642.33	1263391.18	40.0532224	-104.6439224	0.62	
16397.00	90.550	1.380	7214.05	9016.23	8487.89	3067.03	3239643.76	1263481.16	40.0534693	-104.6439141	0.25	
16486.00	90.620	1.780	7213.15	9101.88	8576.85	3069.48	3239645.37	1263570.14	40.0537135	-104.6439053	0.46	
16576.00	90.620	1.660	7212.17	9188.55	8666.80	3072.19	3239647.21	1263660.11	40.0539605	-104.6438957	0.13	
16665.00	90.460	1.490	7211.33	9274.20	8755.76	3074.63	3239648.81	1263749.09	40.0542047	-104.6438869	0.26	
16754.00	89.910	1.590	7211.05	9359.84	8844.73	3077.02	3239650.35	1263838.07	40.0544489	-104.6438783	0.63	
16844.00	91.320	1.570	7210.08	9446.45	8934.69	3079.51	3239651.98	1263928.04	40.0546958	-104.6438694	1.57	
16933.00	90.650	1.110	7208.55	9531.99	9023.65	3081.59	3239653.21	1264017.02	40.0549400	-104.6438619	0.91	
17023.00	90.650	1.910	7207.53	9618.57	9113.61	3083.96	3239654.72	1264107.00	40.0551870	-104.6438534	0.89	
17112.00	90.220	1.420	7206.85	9704.26	9202.57	3086.54	3239656.46	1264195.97	40.0554312	-104.6438441	0.73	
17201.00	90.340	1.600	7206.42	9789.88	9291.54	3088.89	3239657.96	1264284.96	40.0556754	-104.6438357	0.24	
17290.00	90.310	1.740	7205.91	9875.57	9380.50	3091.48	3239659.71	1264373.93	40.0559196	-104.6438264	0.16	
17380.00	90.280	1.800	7205.45	9962.27	9470.46	3094.26	3239661.63	1264463.91	40.0561666	-104.6438164	0.07	
17469.00	90.090	0.810	7205.16	10047.80	9559.43	3096.29	3239662.81	1264552.90	40.0564108	-104.6438092	1.13	
17558.00	89.970	0.760	7205.12	10133.12	9648.42	3097.51	3239663.18	1264641.89	40.0566551	-104.6438048	0.15	
17648.00	89.290	0.760	7205.70	10219.37	9738.41	3098.70	3239663.51	1264731.89	40.0569021	-104.6438005	0.76	
17738.00	89.480	1.030	7206.66	10305.69	9828.40	3100.11	3239664.06	1264821.88	40.0571491	-104.6437954	0.37	
17827.00	90.120	1.240	7206.97	10391.15	9917.38	3101.87	3239664.98	1264910.87	40.0573934	-104.6437891	0.76	
17854.00†	89.596	1.012	7207.04	10417.08	9944.37	3102.40	3239665.25	1264937.86	40.0574675	-104.6437871	2.12	CROSS SETBACK TOE (460'FNL & 920'FEL,SEC.15)
17879.00	89.110	0.800	7207.32	10441.05	9969.37	3102.80	3239665.41	1264962.86	40.0575361	-104.6437857	2.12	LAST BH MWD SURVEY
17903.00‡	89.110	0.800	7207.70	10464.06	9993.36	3103.13	3239665.51	1264986.86	40.0576020	-104.6437845	0.00	PROJECTION TO BIT



Actual Wellpath Report

CANAL 22-2-2L AWP

Page 9 of 11



REFERENCE WELLPATH IDENTIFICATION

Operator	CONFLUENCE RESOURCES	Well	CANAL 22-2-2L
Field	WELD COUNTY (NAD83, TRUE NORTH)	API	0512351591
Facility	SEC.22-T01N-R65W	Wellbore	CANAL 22-2-2L AWB
Slot	SLOT#15 CANAL 22-2-2L (185'FSL & 1321'FWL,SEC.22)		

HOLE & CASING SECTIONS - Ref Wellbore: CANAL 22-2-2L AWB Ref Wellpath: CANAL 22-2-2L AWP

String/Diameter	Start MD [ft]	End MD [ft]	Interval [ft]	Start TVD [ft]	End TVD [ft]	Start N/S [ft]	Start E/W [ft]	End N/S [ft]	End E/W [ft]
9.625in Casing Surface	23.00	2701.00	2678.00	23.00	2570.00	0.00	0.00	-77.93	671.17

TARGETS

Name	TVD [ft]	North [ft]	East [ft]	Grid East [US ft]	Grid North [US ft]	Latitude	Longitude	Shape
SEC.15/22-T01N-R65W (SB 460')	6.50	0.00	-274.44	3236383.46	1254962.14	40.0301700	-104.6558500	polygon
	2D Polygon: dimensions not calculated							
SEC.15-T01N-R65W	10.00	0.00	-274.44	3236383.46	1254962.14	40.0301700	-104.6558500	polygon
	2D Polygon: dimensions not calculated							
SEC.22-T01N-R65W	10.00	0.00	-274.44	3236383.46	1254962.14	40.0301700	-104.6558500	polygon
	2D Polygon: dimensions not calculated							
CANAL 22-2-2L BHL REV-1(470'FNL & 920'FEL,SEC.15)	7249.00	9934.36	3101.60	3239664.55	1264927.85	40.0574400	-104.6437900	point
CANAL 22-2-2L LP REV-1(470'FSL & 1120'FEL,SEC.22)	7249.00	280.66	2833.98	3239488.94	1255272.40	40.0309400	-104.6447500	point

REFERENCE WELLPATH IDENTIFICATION

Operator	CONFLUENCE RESOURCES	Well	CANAL 22-2-2L
Field	WELD COUNTY (NAD83, TRUE NORTH)	API	0512351591
Facility	SEC.22-T01N-R65W	Wellbore	CANAL 22-2-2L AWB
Slot	SLOT#15 CANAL 22-2-2L (185'FSL & 1321'FWL,SEC.22)		

WELLPATH COMPOSITION - Ref Wellbore: CANAL 22-2-2L AWB Ref Wellpath: CANAL 22-2-2L AWP

Start MD [ft]	End MD [ft]	Positional Uncertainty Model	Log Name/Comment	Wellbore	Survey Date
23.00	2653.00	BH NaviTrak (2019) (Axial)	BH NaviTrak (2019) (Axial) 13-1/2" <132 - 2653>	CANAL 22-2-2L AWB	8/30/2021
2653.00	17903.00	BH AutoTrak Curve/eXpress (2019) (Short spacing)	BH AutoTrak Curve (2019) (Short spacing) 8-1/2" <2708 - 17879>	CANAL 22-2-2L AWB	8/30/2021

REFERENCE WELLPATH IDENTIFICATION

Operator	CONFLUENCE RESOURCES	Well	CANAL 22-2-2L
Field	WELD COUNTY (NAD83, TRUE NORTH)	API	0512351591
Facility	SEC.22-T01N-R65W	Wellbore	CANAL 22-2-2L AWB
Slot	SLOT#15 CANAL 22-2-2L (185'FSL & 1321'FWL,SEC.22)		

WELLPATH COMMENTS

MD [ft]	Inclination [°]	Azimuth [°]	TVD [ft]	Comment
132.00	0.320	4.020	132.00	FIRST BH SURFACE MWD SURVEY
2653.00	25.130	97.920	2526.28	LAST BH SURFACE MWD SURVEY
2708.00	23.450	96.610	2576.41	FIRST BH MWD SURVEY
8173.00	84.770	1.320	7253.49	CROSS SETBACK HEEL (457'FSL & 1121'FEL,SEC.22)
17854.00	89.596	1.012	7207.04	CROSS SETBACK TOE (460'FNL & 920'FEL,SEC.15)
17879.00	89.110	0.800	7207.32	LAST BH MWD SURVEY
17903.00	89.110	0.800	7207.70	PROJECTION TO BIT