



FIGURES

Figure 1: Site Location Topographic Map

Figure 2: Soil Analytical Parameters Map (09/06/22)

Figure 3: Polycyclic Aromatic Hydrocarbons Parameters Map (09/06/22)

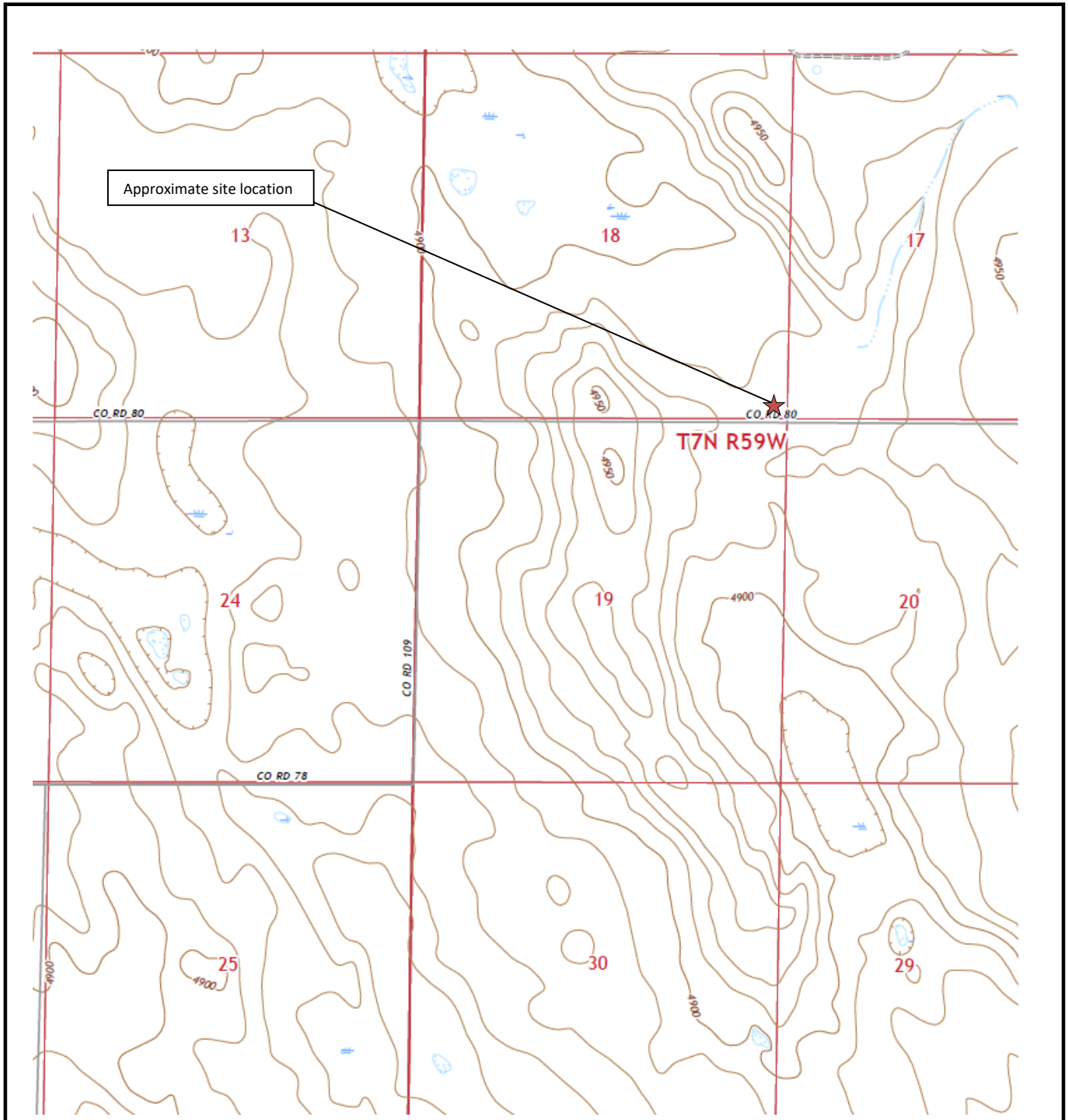

Topographic Site Location Map
 Dyer 6" (CR80/CR109)
 Historic Line Release
 40.567932 / -104.012487
 SE¼ SEC.18 T7N R59W 6PM
 Weld County, Colorado
 Spill ID 482848



EAGLE
 ENVIRONMENTAL
 CONSULTING, INC.

Source: USGS 7.5 Minute Topographic
 Map, Keota SE, CO Quadrangle 2022

Figure 1

LEGEND

- APPROXIMATE EXCAVATION BOUNDARY
- SS-02 APPROXIMATE LOCATION OF SOIL SAMPLES FIELD SCREENED ONLY, WITH PHOTOIONIZATION DETECTOR
- SS-02 APPROXIMATE LOCATION OF SOIL SAMPLES SUBMITTED FOR LABORATORY ANALYSIS

PARAMETERS

SAMPLE ID
DATE
B = BENZENE (mg/kg)
T = TOLUENE (mg/kg)
E = ETHYLBENZENE (mg/kg)
X = TOTAL XYLENES (mg/kg)
G = TPH-GRO (mg/kg)
D = TPH-DRO (mg/kg)
O = TPH-ORO (mg/kg)
1,2,4-TMB = 1,2,4 TRIMETHYLBENZENE (mg/kg)
1,3,5-TMB = 1,3,5 TRIMETHYLBENZENE (mg/kg)

mg/kg = MILLIGRAMS PER KILOGRAM

TPH-GRO = TOTAL PETROLEUM HYDROCARBONS - GASOLINE RANGE ORGANICS
TPH-DRO = TOTAL PETROLEUM HYDROCARBONS - DIESEL RANGE ORGANICS
TPH-ORO = TOTAL PETROLEUM HYDROCARBONS - OIL RANGE ORGANICS

NOTE:
VALUES PRESENTED WITH A LESS THAN SYMBOL (<) DID NOT CONTAIN CONCENTRATIONS AT OR ABOVE LABORATORY REPORTING LIMITS

VALUES PRESENTED IN **BOLD** TYPEFACE CONTAIN CONCENTRATIONS EXCEEDING THE APPLICABLE COGCC TABLE 915-1 REGULATORY RESIDENTIAL SOIL SCREENING LEVEL LIMITS FOR THAT COMPOUND.

COGCC - COLORADO OIL AND GAS CONSERVATION COMMISSION

BACKGROUND: GOOGLE EARTH AERIAL IMAGERY SEPTEMBER 2013

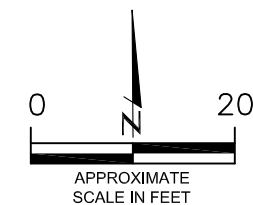

SOIL ANALYTICAL MAP
DYER 6" (CR80/CR109)
HISTORIC LINE RELEASE ASSESSMENT
40.567932, -104.012487
SE 1/4 SEC.18 T7N R59W 6PM
WELD COUNTY, COLORADO
SPILL ID # 482848

DATE:
09/09/22
DRAWN BY:
DAC
FIG.
NO. 2

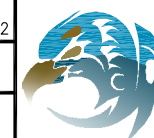

EAGLE
ENVIRONMENTAL
CONSULTING, INC.
8000 W 44th Ave, Wheat Ridge, CO 80033
Ph: 303-433-0479 • F: 303-325-5449

Buried Tallgrass Energy Partners Line

Overhead Power Line

Buried DCP Midstream Line

Buried Fiber Optic Line

W-SS-03@11'
08/31/22
B = <0.0020
T = <0.0050
E = <0.0050
X = <0.010
G = <0.50
D = <50
O = <50
1,2,4-TMB = <0.0050
1,3,5-TMB = <0.0050

N-SS-03@11'
08/31/22
B = <0.0020
T = <0.0050
E = <0.0050
X = <0.010
G = <0.50
D = <50
O = <50
1,2,4-TMB = <0.0050
1,3,5-TMB = <0.0050

SC-SS-01@7.5'
08/30/22
B = 1.2
T = 4.3
E = 1.5
X = 5.7
G = **320**
D = **370**
O = <50
1,2,4-TMB = 2.3
1,3,5-TMB = 0.88

SC-SS-01@13'
08/31/22
B = <0.0020
T = <0.0050
E = <0.0050
X = <0.010
G = <0.50
D = <50
O = <50
1,2,4-TMB = <0.0050
1,3,5-TMB = <0.0050

E-SS-02@10'
08/31/22
B = <0.0020
T = <0.0050
E = <0.0050
X = <0.010
G = <0.50
D = <50
O = <50
1,2,4-TMB = <0.0050
1,3,5-TMB = <0.0050

SE-SS-01@10'
09/06/22
B = <0.0020
T = <0.0050
E = <0.0050
X = <0.010
G = <0.50
D = <50
O = <50
1,2,4-TMB = <0.0050
1,3,5-TMB = <0.0050

SW-SS-01@10'
09/06/22
B = <0.0020
T = <0.0050
E = <0.0050
X = <0.010
G = <0.50
D = <50
O = <50
1,2,4-TMB = <0.0050
1,3,5-TMB = <0.0050

FL-SS-01@13'
09/06/22
B = <0.0020
T = <0.0050
E = <0.0050
X = <0.010
G = <0.50
D = <50
O = <50
1,2,4-TMB = <0.0050
1,3,5-TMB = <0.0050

LEGEND

- APPROXIMATE EXCAVATION BOUNDARY
- APPROXIMATE LOCATION OF SOIL SAMPLES FIELD SCREENED ONLY, WITH PHOTOIONIZATION DETECTOR
- APPROXIMATE LOCATION OF SOIL SAMPLES SUBMITTED FOR LABORATORY ANALYSIS

PARAMETERS

SAMPLE ID
DATE
POLYCYCLIC AROMATIC HYDROCARBONS (PAHs)

NOTE:
CONCENTRATIONS PRESENTED IN mg/kg

mg/kg = MILLIGRAMS PER KILOGRAM

NOTE:
VALUES PRESENTED WITH A LESS THAN SYMBOL (<) DID NOT CONTAIN CONCENTRATIONS AT OR ABOVE LABORATORY REPORTING LIMITS

VALUES PRESENTED IN **BOLD** VALUES CONTAIN CONCENTRATIONS THAT EXCEED COGCC TABLE 915-1 RESIDENTIAL SOIL SCREENING LEVEL REGULATORY LIMITS FOR THAT COMPOUND.

VALUES PRESENTED WITH ASTERISK (*) EXCEED COGCC TABLE 915-1 PROTECTION OF GROUNDWATER SOIL SCREENING LEVELS FOR THAT COMPOUND.

COGCC - COLORADO OIL AND GAS CONSERVATION COMMISSION

BACKGROUND: GOOGLE EARTH AERIAL IMAGERY SEPTEMBER 2013

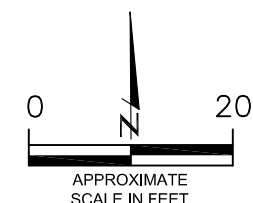

POLYCYCLIC AROMATIC HYDROCARBONS MAP

DYER 6" (CR80/CR109)
HISTORIC LINE RELEASE ASSESSMENT
40.567932, -104.012487
SE¼ SE¼ SEC.18 T7N R59W 6PM
WELD COUNTY, COLORADO
SPILL ID # 482848

DATE:
09/09/22
DRAWN BY:
DAC
FIG.
NO. 3

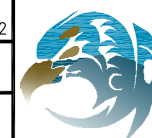

EAGLE
ENVIRONMENTAL
CONSULTING, INC.
8000 W 44th Ave, Wheat Ridge, CO 80033
Ph: 303-433-0479 • F: 303-325-5449

Buried Tallgrass Energy Partners Line

Overhead Power Line

Buried DCP Midstream Line

Buried Fiber Optic Line

N-SS-03@11'
08/31/22
1-Methylnaphthalene = <0.00500
2-Methylnaphthalene = <0.00500
Acenaphthene = <0.00500
Anthracene = <0.00500
Benzo(a)anthracene = <0.00500
Benzo(a)pyrene = <0.00500
Benzo(b)fluoranthene = <0.00500
Benzo(k)fluoranthene = <0.00500
Chrysene = <0.00500
Dibenzo(a,h)anthracene = <0.00500
Fluoranthene = <0.00500
Fluorene = <0.005000
Indeno(1,2,3-CD)pyrene = <0.00500
Naphthalene = <0.0038
Pyrene = <0.00500

SC-SS-01@7.5'
08/30/22
1-Methylnaphthalene = 4.15*
2-Methylnaphthalene = 4.73*
Acenaphthene = 0.147
Anthracene = <0.00500
Benzo(a)anthracene = <0.00500
Benzo(a)pyrene = <0.00500
Benzo(b)fluoranthene = <0.00500
Benzo(k)fluoranthene = <0.00500
Chrysene = 0.0560
Dibenzo(a,h)anthracene = <0.00500
Fluoranthene = 0.0165
Fluorene = <0.500
Indeno(1,2,3-CD)pyrene = <0.00500
Naphthalene = 0.56*
Pyrene = 0.0183

SC-SS-01@13'
08/31/22
1-Methylnaphthalene = <0.00500
2-Methylnaphthalene = <0.00500
Acenaphthene = <0.00500
Anthracene = <0.00500
Benzo(a)anthracene = <0.00500
Benzo(a)pyrene = <0.00500
Benzo(b)fluoranthene = <0.00500
Benzo(k)fluoranthene = <0.00500
Chrysene = <0.00500
Dibenzo(a,h)anthracene = <0.00500
Fluoranthene = <0.00500
Fluorene = <0.005000
Indeno(1,2,3-CD)pyrene = <0.00500
Naphthalene = <0.0038
Pyrene = <0.00500

E-SS-02@10'
08/31/22
1-Methylnaphthalene = <0.00500
2-Methylnaphthalene = <0.00500
Acenaphthene = <0.00500
Anthracene = <0.00500
Benzo(a)anthracene = <0.00500
Benzo(a)pyrene = <0.00500
Benzo(b)fluoranthene = <0.00500
Benzo(k)fluoranthene = <0.00500
Chrysene = <0.00500
Dibenzo(a,h)anthracene = <0.00500
Fluoranthene = <0.00500
Fluorene = <0.005000
Indeno(1,2,3-CD)pyrene = <0.00500
Naphthalene = <0.0038
Pyrene = <0.00500

W-SS-03@11'
08/31/22
1-Methylnaphthalene = <0.00500
2-Methylnaphthalene = <0.00500
Acenaphthene = <0.00500
Anthracene = <0.00500
Benzo(a)anthracene = <0.00500
Benzo(a)pyrene = <0.00500
Benzo(b)fluoranthene = <0.00500
Benzo(k)fluoranthene = <0.00500
Chrysene = <0.00500
Dibenzo(a,h)anthracene = <0.00500
Fluoranthene = <0.00500
Fluorene = <0.005000
Indeno(1,2,3-CD)pyrene = <0.00500
Naphthalene = <0.0038
Pyrene = <0.00500

SW-SS-01@10'
09/06/22
1-Methylnaphthalene = <0.00500
2-Methylnaphthalene = <0.00500
Acenaphthene = <0.00500
Anthracene = <0.00500
Benzo(a)anthracene = <0.00500
Benzo(a)pyrene = <0.00500
Benzo(b)fluoranthene = <0.00500
Benzo(k)fluoranthene = <0.00500
Chrysene = <0.00500
Dibenzo(a,h)anthracene = <0.00500
Fluoranthene = <0.00500
Fluorene = <0.005000
Indeno(1,2,3-CD)pyrene = <0.00500
Naphthalene = <0.0038
Pyrene = <0.00500

SE-SS-01@10'
09/06/22
1-Methylnaphthalene = <0.00500
2-Methylnaphthalene = <0.00500
Acenaphthene = <0.00500
Anthracene = <0.00500
Benzo(a)anthracene = <0.00500
Benzo(a)pyrene = <0.00500
Benzo(b)fluoranthene = <0.00500
Benzo(k)fluoranthene = <0.00500
Chrysene = <0.00500
Dibenzo(a,h)anthracene = <0.00500
Fluoranthene = <0.00500
Fluorene = <0.005000
Indeno(1,2,3-CD)pyrene = <0.00500
Naphthalene = <0.0038
Pyrene = <0.00500

FL-SS-01@13'
09/06/22
1-Methylnaphthalene = <0.00500
2-Methylnaphthalene = <0.00500
Acenaphthene = <0.00500
Anthracene = <0.00500
Benzo(a)anthracene = <0.00500
Benzo(a)pyrene = <0.00500
Benzo(b)fluoranthene = <0.00500
Benzo(k)fluoranthene = <0.00500
Chrysene = <0.00500
Dibenzo(a,h)anthracene = <0.00500
Fluoranthene = <0.00500
Fluorene = <0.005000
Indeno(1,2,3-CD)pyrene = <0.00500
Naphthalene = <0.0038
Pyrene = <0.00500



TABLES

Table 1: Photoionization Detector Readings Summary

Table 2: Soil Analytical Parameters Summary

Table 3: Polycyclic Aromatic Hydrocarbons Parameters Summary

TABLE 1
PHOTOIONIZATION DETECTOR READING SUMMARY
DYER 6" (CR80/CR109)
HISTORICAL LINE RELEASE
IMPACT ASSESSMENT
40.567932, -104.012487
SE 1/4 SE 1/4 SEC. 18 T7N R59W 6PM
WELD COUNTY, COLORADO
SPILL ID - 482848

Sample Location (Latitude/Longitude)	Date	Approximate Depth (feet)	PID Reading (ppm-v)	Lab Submission (Y/N)
SC-SS-01 @ 7.5' (40.567932, -104.012487)	08/30/22	7.5	253.7	Y
N-SS-01 @ 7.5' (40.567940, -104.012485)	08/30/22	7.5	1012	N
N-SS-02 @ 7.5' (40.567976, -104.012492)	08/30/22	7.5	84	N
E-SS-01 @ 7.5' (40.567934, -104.012453)	08/30/22	7.5	262.7	N
S-SS-01 @ 7.5' (40.567923, -104.012493)	08/30/22	7.5	375.1	N
W-SS-01 @ 7.5' (40.567937, -104.012507)	08/30/22	7.5	948.7	N
W-SS-02 @ 7.5' (40.567945, -104.012563)	08/30/22	7.5	15.8	N
SC-SS-01 @ 13' (40.567932, -104.012487)	08/31/22	13	52.8	Y
N-SS-03 @ 11' (40.567972, -104.012490)	08/31/22	11	132.8	Y
E-SS-02 @ 10' (40.567942, -104.012433)	08/31/22	10	67.0	Y
W-SS-03 @ 11' (40.567947, -104.012553)	08/31/22	11	39.3	Y
FL-SS-01 @ 13' (40.567913, -104.012486)	09/06/22	13	99.8	Y
SW-SS-01 @ 10' (40.567898, -104.012516)	09/06/22	10	26.4	Y
SE-SS-01 @ 10' (40.567896, -104.012455)	09/06/22	10	44.8	Y
NOTES: (Y/N) = Yes or No PID = photoionization detector				
ppm-v = parts per million by volume				

TABLE 2
SOIL ANALYTICAL RESULTS SUMMARY
DYER 6" (CR80/CR109)
HISTORICAL LINE RELEASE
IMPACT ASSESSMENT
40.567932, -104.012487
SE 1/4 SE 1/4 SEC. 18 T7N R59W 6PM
WELD COUNTY, COLORADO
SPILL ID - 482848

Sample Location (Latitude/Longitude)	Date	Approximate Depth (feet)	PID Reading (ppm-v)	Benzene (mg/kg)	Toluene (mg/kg)	Ethylbenzene (mg/kg)	Total Xylenes (mg/kg)	TPH-GRO (mg/kg)	TPH-DRO (mg/kg)	TPH-RRO (mg/kg)	1,2,4-TMB (mg/kg)	1,3,5-TMB (mg/kg)
COGCC Table 915-1 Residential Screening Levels (mg/kg)				1.20	490	5.8	58	500			30	27
COGCC Table 915-1 Protection of Groundwater Soil Screening Levels				0.0026	0.69	0.78	9.9	--			0.0081	0.0087
SC-SS-01 @ 7.5' (40.567932, -104.012487)	08/30/22	7.5	253.7	1.2*	4.3*	1.5*	5.7	320	370	<50	2.3*	0.88*
SC-SS-01 @ 13' (40.567932, -104.012487)	08/31/22	13	52.8	<0.0020	<0.0050	<0.0050	<0.010	<0.50	<50	<50	<0.0050	<0.0050
N-SS-03 @ 11' (40.567972, -104.012490)	08/31/22	11	132.8	<0.0020	<0.0050	<0.0050	<0.010	<0.50	<50	<50	<0.0050	<0.0050
E-SS-02 @ 10' (40.567942, -104.012433)	08/31/22	10	67.0	<0.0020	<0.0050	<0.0050	<0.010	<0.50	<50	<50	<0.0050	<0.0050
W-SS-03 @ 11' (40.567947, -104.012553)	08/31/22	11	39.3	<0.0020	<0.0050	<0.0050	<0.010	<0.50	<50	<50	<0.0050	<0.0050
FL-SS-01 @ 13' (40.567913, -104.012486)	09/06/22	13	99.8	<0.0020	<0.0050	<0.0050	<0.010	<0.50	<50	<50	<0.0050	<0.0050
SW-SS-01 @ 10' (40.567898, -104.012516)	09/06/22	10	26.4	<0.0020	<0.0050	<0.0050	<0.010	<0.50	<50	<50	<0.0050	<0.0050
SE-SS-01 @ 10' (40.567896, -104.012455)	09/06/22	10	44.8	<0.0020	<0.0050	<0.0050	<0.010	<0.50	<50	<50	<0.0050	<0.0050
NOTES: COGCC = Colorado Oil and Gas Conservation Commission ppm-v = parts per million by volume TPH-DRO = Total Petroleum Hydrocarbons - Diesel Range Organics TPH-RRO = Total Petroleum Hydrocarbons - Residual Range Organics Values presented with a less than symbol (<) did not contain concentrations at or above the laboratory reporting limit. Values presented in BOLD contained concentrations exceeding COGCC Table 915-1 Residential Soil Screening Levels Regulatory Limits. Values with asterisk (*) exceed COGCC Table 915-1 Protection of Groundwater Soil Screening Levels for that compound												
				PID = Photoionization Detector	mg/kg = milligrams per kilogram			mmhos/cm = millimhos per centimeter				
				mg/L = milligrams per liter	SAR = Sodium Adsorption Ratio							
				TPH-GRO = Total Petroleum Hydrocarbons - Gasoline Range Organics								
				1,3,5-TMB = 1,3,5-Trimethylbenzene	1,2,4-TMB = 1,2,4-Trimethylbenzene							

TABLE 3
POLYCYCLIC AROMATIC HYDROCARBONS ANALYTICAL RESULTS SUMMARY
DYER 6" (CR80/CR109)
HISTORICAL LINE RELEASE
IMPACT ASSESSMENT
40.567932, -104.012487
SE 1/4 SE 1/4 SEC. 18 T7N R59W 6PM
WELD COUNTY, COLORADO
SPILL ID - 482848

Sample Location (Latitude/Longitude)	Date	Approximate Depth (feet)	PID Reading (ppm- v)	1-Methyl- naphthalene (mg/kg)	2-Methyl- naphthalene (mg/kg)	Acenaphthene (mg/kg)	Anthracene (mg/kg)	Benzo(a)-anthracene (mg/kg)	Benzo(a)- pyrene (mg/kg)	Benzo(b)- fluoranthene (mg/kg)	Benzo(k)- fluoranthene (mg/kg)	Chrysene (mg/kg)	Dibenzo(a,h)- anthracene (mg/kg)	Fluoranthene (mg/kg)	Fluorene (mg/kg)	Indeno(1,2,3- cd)-pyrene (mg/kg)	Naphthalene (mg/kg)	Pyrene (mg/kg)
COGCC Table 915-1 Residential Screening Levels				18	24	360	1,800	1.1	0.11	1.1	11	110	0.11	240	240	1.1	2	180
COGCC Table 915-1 Protection of Groundwater Soil Screening Levels				0.006	0.019	0.55	5.8	0.011	0.24	0.3	2.9	9	0.096	8.9	0.54	0.98	0.0038	1.3
SC-SS-01 @ 7.5' (40.567932, -104.012487)	08/30/22	7.5	253.7	4.15*	4.73*	0.147	<0.00500	<0.00500	<0.00500	<0.00500	<0.00500	0.0560	<0.00500	0.0165	<0.500	<0.00500	0.56*	0.0183
SC-SS-01 @ 13' (40.567932, -104.012487)	08/31/22	13	52.8	<0.00500	<0.00500	<0.00500	<0.00500	<0.00500	<0.00500	<0.00500	<0.00500	<0.00500	<0.00500	<0.00500	<0.00500	<0.00500	<0.0038	<0.00500
N-SS-03 @ 11' (40.567972, -104.012490)	08/31/22	11	132.8	<0.00500	<0.00500	<0.00500	<0.00500	<0.00500	<0.00500	<0.00500	<0.00500	<0.00500	<0.00500	<0.00500	<0.00500	<0.00500	<0.0038	<0.00500
E-SS-02 @ 10' (40.567942, -104.012433)	08/31/22	10	67.0	<0.00500	<0.00500	<0.00500	<0.00500	<0.00500	<0.00500	<0.00500	<0.00500	<0.00500	<0.00500	<0.00500	<0.00500	<0.00500	<0.0038	<0.00500
W-SS-03 @ 11' (40.567947, -104.012553)	08/31/22	11	39.3	<0.00500	<0.00500	<0.00500	<0.00500	<0.00500	<0.00500	<0.00500	<0.00500	<0.00500	<0.00500	<0.00500	<0.00500	<0.00500	<0.0038	<0.00500
FL-SS-01 @ 13' (40.567913, -104.012486)	09/06/22	13	99.8	<0.00500	<0.00500	<0.00500	<0.00500	<0.00500	<0.00500	<0.00500	<0.00500	<0.00500	<0.00500	<0.00500	<0.00500	<0.00500	<0.0038	<0.00500
SW-SS-01 @ 10' (40.567898, -104.012516)	09/06/22	10	26.4	<0.00500	<0.00500	<0.00500	<0.00500	<0.00500	<0.00500	<0.00500	<0.00500	<0.00500	<0.00500	<0.00500	<0.00500	<0.00500	<0.0038	<0.00500
SE-SS-01 @ 10' (40.567896, -104.012455)	09/06/22	10	44.8	<0.00500	<0.00500	<0.00500	<0.00500	<0.00500	<0.00500	<0.00500	<0.00500	<0.00500	<0.00500	<0.00500	<0.00500	<0.00500	<0.0038	<0.00500

NOTES:
COGCC = Colorado Oil and Gas Conservation Commission PID = Photoionization Detector mg/kg = milligrams per kilogram ppm-v = parts per million by volume
Values presented with a less than symbol (<) did not contain concentrations at or above the laboratory reporting limit.
Values presented in BOLD contained concentrations exceeding COGCC Table 915-1 Residential Soil Screening Levels Regulatory Limits. Values with asterisk (*) exceed COGCC Table 915-1 Protection of Groundwater Soil Screening Levels for that compound

Dyer 6" (CR80/CR109) – Spill ID 482848

Historical Release Assessment & Remediation Activities – August-September 2022

DCP Midstream Partners, LP (DCP Operating Company, LP)



ATTACHMENT A

Photo Log

PHOTO LOG
DYER 6" (CR80/CR109)
HISTORICAL LINE RELEASE
IMPACT ASSESSMENT
40.567932, -104.012487
SE 1/4 SE 1/4 SEC. 18 T7N R59W 6PM
WELD COUNTY, COLORADO
SPILL ID 482848



EAGLE
ENVIRONMENTAL
CONSULTING, INC.

8000 W 44th Ave, Wheat Ridge, CO 80033
Ph: 303-433-0479 • F: 303-325-5449



Source Point Replacement - 08/30/22



Looking ENE

Line failure replacement

No staining, light odor in bottom of trench

Pinhole Failures in Gas Line - 08/30/22



Looking down WNW

6" gas gathering line segment removed

Excavation Beneath Source Point – 08/31/22



Looking E

Delineating vertical impact extents beneath source point

No staining, no odor at depth

Excavating North Side of Line - 08/31/22



Looking N

Delineating horizontal impact extents on the north side of DCP's line

No staining, no odor

Excavating South Side of Line – 09/06/22



Looking ESE

Delineating horizontal impact extents on the south side of DCP's line, fiber optic line exposed

No staining, no odor



ATTACHMENT B

Laboratory Analytical Reports

Summit Scientific

4653 Table Mountain Drive, Golden, Colorado 80403

303.277.9310

September 08, 2022

Chandler Cole

Eagle Environmental Consulting

8000 W 44th Ave

Wheat Ridge, CO 80033

RE: DCP - Dyer 6" (CR80/CR109)

Work Order #2208427

Enclosed are the results of analyses for samples received by Summit Scientific on 08/30/22 16:35. If you have any questions concerning this report, please feel free to contact me.

Sincerely,



Mikayla Axtell For Paul Shrewsbury
President



Eagle Environmental Consulting
8000 W 44th Ave
Wheat Ridge CO, 80033

Project: DCP - Dyer 6" (CR80/CR109)

Project Number: [none]
Project Manager: Chandler Cole

Reported:
09/08/22 10:14

ANALYTICAL REPORT FOR SAMPLES

Sample ID	Laboratory ID	Matrix	Date Sampled	Date Received
SC-SS-01@7.5'	2208427-01	Soil	08/30/22 08:36	08/30/22 16:35

Summit Scientific

The results in this report apply to the samples analyzed in accordance with the chain of custody document. This analytical report must be reproduced in its entirety.

S_2

4653 Table Mountain Drive ♦ Golden, Colorado 80403

Page

of

Project Manager: Chandler Cole / David Castro

E-Mail: cecole@dep.mt.gov; drastro@eagle-enviro.com

swweathers@depnids tram. com; diploccia@eagle-enviro. com

Project Name: Dyer 6" (CR60/CR109)

Project Number:

www.s2scientific.com

S₂

Sample Receipt Checklist

S2 Work Order# 2208427

Client: DCP / Eagle Client Project ID: Dyer 6" (CR80/CR109)Shipped Via: H.D./P.U./FedEx/UPS/USPS/Other ☐ Airbill #: ☐
☒ ☐ ☐ ☐ ☐
Matrix (Check all that apply) Air ☐ Soil/Solid ☒ Water ☐ Other ☐Temp (°C) 0.5 Thermometer # 2

	Yes	No	N/A	Comments (if any)
If samples require cooling, is the temperature < 6°C? ⁽¹⁾ NOTE: If samples are delivered the same day of sampling, this requirement is met if there is evidence that cooling has begun.	<input checked="" type="checkbox"/>	<input type="checkbox"/>	<input type="checkbox"/>	On ice.
If custody seals are present, are they intact? ⁽¹⁾	<input checked="" type="checkbox"/>	<input type="checkbox"/>	<input type="checkbox"/>	
Are samples due within 48 hours present?	<input checked="" type="checkbox"/>	<input type="checkbox"/>	<input type="checkbox"/>	Same day
Are water samples with short hold times present? Note the short hold analysis in the comments column - pH, Nitrate/Nitrite, Ferrous Iron (Fe ²⁺), Hexavalent Chromium (Cr ⁶⁺ , Cr VI), COD/BOD, Total Coliform, E. Coli, Total Residual Chlorine (TRC), Dissolved Oxygen	<input type="checkbox"/>	<input checked="" type="checkbox"/>	<input type="checkbox"/>	
Is a chain-of-custody (COC) form present and filled out Completely? ⁽¹⁾	<input checked="" type="checkbox"/>	<input type="checkbox"/>	<input type="checkbox"/>	
Is the COC properly relinquished by the client w/ date and time recorded? ⁽¹⁾	<input checked="" type="checkbox"/>	<input type="checkbox"/>	<input type="checkbox"/>	
Were all samples received intact? ⁽¹⁾	<input checked="" type="checkbox"/>	<input type="checkbox"/>	<input type="checkbox"/>	
Was adequate sample volume provided? ⁽¹⁾	<input checked="" type="checkbox"/>	<input type="checkbox"/>	<input type="checkbox"/>	
Does the COC agree with the number and type of sample bottles received? ⁽¹⁾	<input checked="" type="checkbox"/>	<input type="checkbox"/>	<input type="checkbox"/>	
Do the sample IDs on the bottle labels match the COC? ⁽¹⁾	<input checked="" type="checkbox"/>	<input type="checkbox"/>	<input type="checkbox"/>	
For volatiles in water – is there headspace present? If yes, contact client and note in narrative.	<input type="checkbox"/>	<input type="checkbox"/>	<input checked="" type="checkbox"/>	
Are samples preserved that require preservation (excluding cooling)? ⁽¹⁾ Note the type of preservative in the comments column – HCl, H ₂ SO ₄ , NaOH, HNO ₃ , etc.	<input type="checkbox"/>	<input type="checkbox"/>	<input checked="" type="checkbox"/>	
If samples are acid preserved for metals, is the pH ≤ 2? ⁽¹⁾ Record the pH in Comments.	<input type="checkbox"/>	<input type="checkbox"/>	<input checked="" type="checkbox"/>	
If dissolved metals are requested, were samples field filtered?	<input type="checkbox"/>	<input type="checkbox"/>	<input checked="" type="checkbox"/>	

Additional Comments (if any):

⁽¹⁾ If NO, then contact the client before proceeding with analysis and note in case narrative.

Jack Brewer
Custodian Printed Name

8/30/22
Date/Time



Eagle Environmental Consulting
8000 W 44th Ave
Wheat Ridge CO, 80033

Project: DCP - Dyer 6" (CR80/CR109)

Project Number: [none]
Project Manager: Chandler Cole

Reported:
09/08/22 10:14

SC-SS-01@7.5'
2208427-01 (Soil)

Summit Scientific

Volatile Organic Compounds by EPA Method 8260B

Date Sampled: **08/30/22 08:36**

Analyte	Result	Reporting Limit	Units	Dilution	Batch	Prepared	Analyzed	Method	Notes
Benzene	1.2	0.020	mg/kg	10	BFH0656	08/30/22	08/30/22	EPA 8260B	
Toluene	4.3	0.050	"	"	"	"	"	"	
Ethylbenzene	1.5	0.050	"	"	"	"	"	"	
Xylenes (total)	5.7	0.10	"	"	"	"	"	"	
1,2,4-Trimethylbenzene	2.3	0.050	"	"	"	"	"	"	
1,3,5-Trimethylbenzene	0.88	0.050	"	"	"	"	"	"	
Naphthalene	0.56	0.0038	"	1	"	"	"	"	
Gasoline Range Hydrocarbons	320	0.50	"	"	"	"	"	"	

Date Sampled: **08/30/22 08:36**

Analyte	Result	Reporting Limit	Units	Dilution	Batch	Prepared	Analyzed	Method	Notes
Surrogate: 1,2-Dichloroethane-d4		139 %	50-150		"	"	"	"	
Surrogate: Toluene-d8		112 %	50-150		"	"	"	"	
Surrogate: 4-Bromofluorobenzene		93.6 %	50-150		"	"	"	"	

Extractable Petroleum Hydrocarbons by 8015

Date Sampled: **08/30/22 08:36**

Analyte	Result	Reporting Limit	Units	Dilution	Batch	Prepared	Analyzed	Method	Notes
C10-C28 (DRO)	370	50	mg/kg	1	BFH0657	08/30/22	08/30/22	EPA 8015M	
C28-C36 (ORO)	ND	50	"	"	"	"	"	"	

Date Sampled: **08/30/22 08:36**

Analyte	Result	Reporting Limit	Units	Dilution	Batch	Prepared	Analyzed	Method	Notes
Surrogate: o-Terphenyl		120 %	30-150		"	"	"	"	

PAH by EPA Method 8270D SIM

Summit Scientific

The results in this report apply to the samples analyzed in accordance with the chain of custody document. This analytical report must be reproduced in its entirety.



Eagle Environmental Consulting
8000 W 44th Ave
Wheat Ridge CO, 80033

Project: DCP - Dyer 6" (CR80/CR109)

Project Number: [none]
Project Manager: Chandler Cole

Reported:
09/08/22 10:14

SC-SS-01@7.5'
2208427-01 (Soil)

Summit Scientific

PAH by EPA Method 8270D SIM

Date Sampled: **08/30/22 08:36**

Analyte	Result	Reporting Limit	Units	Dilution	Batch	Prepared	Analyzed	Method	Notes
Acenaphthene	0.147	0.00500	mg/kg	1	BFH0665	08/31/22	08/31/22	EPA 8270D SIM	
Anthracene	ND	0.00500	"	"	"	"	"	"	
Benzo (a) anthracene	ND	0.00500	"	"	"	"	"	"	
Benzo (a) pyrene	ND	0.00500	"	"	"	"	"	"	
Benzo (b) fluoranthene	ND	0.00500	"	"	"	"	"	"	
Benzo (k) fluoranthene	ND	0.00500	"	"	"	"	"	"	
Chrysene	0.0560	0.00500	"	"	"	"	"	"	
Dibenz (a,h) anthracene	ND	0.00500	"	"	"	"	"	"	
Fluoranthene	0.0165	0.00500	"	"	"	"	"	"	
Fluorene	ND	0.500	"	100	"	"	09/01/22	"	
Indeno (1,2,3-cd) pyrene	ND	0.00500	"	1	"	"	08/31/22	"	
Pyrene	0.0183	0.00500	"	"	"	"	"	"	
1-Methylnaphthalene	4.15	0.500	"	100	"	"	09/01/22	"	
2-Methylnaphthalene	4.73	0.500	"	"	"	"	"	"	

Date Sampled: **08/30/22 08:36**

Analyte	Result	Reporting Limit	Units	Dilution	Batch	Prepared	Analyzed	Method	Notes
Surrogate: 2-Methylnaphthalene-d10	106 %	40-150	"	"	"	"	08/31/22	"	
Surrogate: Fluoranthene-d10	51.5 %	40-150	"	"	"	"	"	"	

Total Metals by EPA 6020B Hot Water Soluble Extraction

Date Sampled: **08/30/22 08:36**

Analyte	Result	Reporting Limit	Units	Dilution	Batch	Prepared	Analyzed	Method	Notes
Boron	0.0434	0.0100	mg/L	1	BFH0650	08/30/22	09/01/22	EPA 6020B	

Total Metals by EPA 6020B

Date Sampled: **08/30/22 08:36**

Analyte	Result	Reporting Limit	Units	Dilution	Batch	Prepared	Analyzed	Method	Notes
---------	--------	-----------------	-------	----------	-------	----------	----------	--------	-------

Summit Scientific

The results in this report apply to the samples analyzed in accordance with the chain of custody document. This analytical report must be reproduced in its entirety.



Eagle Environmental Consulting
8000 W 44th Ave
Wheat Ridge CO, 80033

Project: DCP - Dyer 6" (CR80/CR109)

Project Number: [none]
Project Manager: Chandler Cole

Reported:
09/08/22 10:14

SC-SS-01@7.5'
2208427-01 (Soil)

Summit Scientific

Total Metals by EPA 6020B

Arsenic	2.07	0.233	mg/kg dry	1	BFH0660	08/30/22	09/01/22	EPA 6020B
Barium	113	0.466	"	"	"	"	"	"
Cadmium	ND	0.233	"	"	"	"	"	"
Copper	3.59	0.466	"	"	"	"	"	"
Lead	5.50	0.233	"	"	"	"	"	"
Nickel	3.64	0.466	"	"	"	"	"	"
Selenium	0.475	0.303	"	"	"	"	"	"
Silver	ND	0.0233	"	"	"	"	"	"
Zinc	14.8	0.466	"	"	"	"	"	"

Hexavalent Chromium by EPA Method 7196

Date Sampled: **08/30/22 08:36**

Analyte	Result	Reporting Limit	Units	Dilution	Batch	Prepared	Analyzed	Method	Notes
Chromium, Hexavalent	ND	0.30	mg/kg dry	1	BFH0671	08/31/22	09/01/22	EPA 7196A	

Soluble Nutrients by EPA 6020/USDA60 6(2) - Saturated Paste Extraction

Date Sampled: **08/30/22 08:36**

Analyte	Result	Reporting Limit	Units	Dilution	Batch	Prepared	Analyzed	Method	Notes
Calcium	63.8	0.0582	mg/L dry	1	BF10007	09/01/22	09/03/22	EPA 6020B	
Magnesium	14.3	0.0582	"	"	"	"	"	"	
Sodium	18.0	0.0582	"	"	"	"	"	"	

Calculated Analysis

Date Sampled: **08/30/22 08:36**

Analyte	Result	Reporting Limit	Units	Dilution	Batch	Prepared	Analyzed	Method	Notes
Sodium Adsorption Ratio	0.530	0.00100	units	1	BF10092	09/06/22	09/06/22	Calculation	

Physical Parameters by APHA/ASTM/EPA Methods

Summit Scientific

The results in this report apply to the samples analyzed in accordance with the chain of custody document. This analytical report must be reproduced in its entirety.



Eagle Environmental Consulting
8000 W 44th Ave
Wheat Ridge CO, 80033

Project: DCP - Dyer 6" (CR80/CR109)
Project Number: [none]
Project Manager: Chandler Cole

Reported:
09/08/22 10:14

SC-SS-01@7.5'
2208427-01 (Soil)

Summit Scientific

Physical Parameters by APHA/ASTM/EPA Methods

Date Sampled: **08/30/22 08:36**

Analyte	Result	Reporting Limit	Units	Dilution	Batch	Prepared	Analyzed	Method	Notes
% Solids	85.9		%	1	BFH0658	08/30/22	08/31/22	Calculation	

Specific Conductance by EPA Method 120.1, Saturated Paste Extraction

Date Sampled: **08/30/22 08:36**

Analyte	Result	Reporting Limit	Units	Dilution	Batch	Prepared	Analyzed	Method	Notes
Specific Conductance (EC)	0.627	0.0100	mmhos/cm	1	BFH0055	09/02/22	09/03/22	EPA 120.1	

Physical Parameters by APHA/ASTM/EPA Methods, Saturated Paste Extraction

Date Sampled: **08/30/22 08:36**

Analyte	Result	Reporting Limit	Units	Dilution	Batch	Prepared	Analyzed	Method	Notes
pH	7.72		pH Units	1	BFH0054	09/02/22	09/02/22	EPA 9045D	

Summit Scientific

The results in this report apply to the samples analyzed in accordance with the chain of custody document. This analytical report must be reproduced in its entirety.



Eagle Environmental Consulting
8000 W 44th Ave
Wheat Ridge CO, 80033

Project: DCP - Dyer 6" (CR80/CR109)

Project Number: [none]
Project Manager: Chandler Cole

Reported:
09/08/22 10:14

Volatile Organic Compounds by EPA Method 8260B - Quality Control

Summit Scientific

Analyte	Reporting			Spike	Source		%REC		RPD	
	Result	Limit	Units	Level	Result	%REC	Limits	RPD	Limit	Notes

Batch BFH0656 - EPA 5030 Soil MS

Blank (BFH0656-BLK1)

Prepared: 08/30/22 Analyzed: 08/31/22

Benzene	ND	0.0020	mg/kg							
Toluene	ND	0.0050	"							
Ethylbenzene	ND	0.0050	"							
Xylenes (total)	ND	0.010	"							
1,2,4-Trimethylbenzene	ND	0.0050	"							
1,3,5-Trimethylbenzene	ND	0.0050	"							
Naphthalene	ND	0.0038	"							
Gasoline Range Hydrocarbons	ND	0.50	"							
Surrogate: 1,2-Dichloroethane-d4	0.0369		"	0.0400		92.2	50-150			
Surrogate: Toluene-d8	0.0385		"	0.0400		96.2	50-150			
Surrogate: 4-Bromofluorobenzene	0.0356		"	0.0400		89.1	50-150			

LCS (BFH0656-BS1)

Prepared: 08/30/22 Analyzed: 08/31/22

Benzene	0.0559	0.0020	mg/kg	0.0750		74.6	70-130			
Toluene	0.0624	0.0050	"	0.0750		83.2	70-130			
Ethylbenzene	0.0664	0.0050	"	0.0750		88.6	70-130			
m,p-Xylene	0.135	0.010	"	0.150		89.8	70-130			
o-Xylene	0.0634	0.0050	"	0.0750		84.5	70-130			
1,2,4-Trimethylbenzene	0.0618	0.0050	"	0.0750		82.4	70-130			
1,3,5-Trimethylbenzene	0.0636	0.0050	"	0.0750		84.8	70-130			
Naphthalene	0.0704	0.0038	"	0.0750		93.8	70-130			
Surrogate: 1,2-Dichloroethane-d4	0.0333		"	0.0400		83.2	50-150			
Surrogate: Toluene-d8	0.0384		"	0.0400		96.0	50-150			
Surrogate: 4-Bromofluorobenzene	0.0360		"	0.0400		89.9	50-150			

Matrix Spike (BFH0656-MS1)

Source: 2208425-03

Prepared: 08/30/22 Analyzed: 08/31/22

Benzene	0.0816	0.0020	mg/kg	0.0750	ND	109	70-130			
Toluene	0.0644	0.0050	"	0.0750	ND	85.8	70-130			
Ethylbenzene	0.0682	0.0050	"	0.0750	ND	91.0	70-130			
m,p-Xylene	0.137	0.010	"	0.150	ND	91.6	70-130			
o-Xylene	0.0652	0.0050	"	0.0750	ND	86.9	70-130			
1,2,4-Trimethylbenzene	0.0644	0.0050	"	0.0750	ND	85.8	70-130			
1,3,5-Trimethylbenzene	0.0664	0.0050	"	0.0750	ND	88.5	70-130			
Naphthalene	0.0664	0.0038	"	0.0750	ND	88.6	70-130			
Surrogate: 1,2-Dichloroethane-d4	0.0354		"	0.0400		88.5	50-150			
Surrogate: Toluene-d8	0.0407		"	0.0400		102	50-150			
Surrogate: 4-Bromofluorobenzene	0.0359		"	0.0400		89.7	50-150			

Summit Scientific

The results in this report apply to the samples analyzed in accordance with the chain of custody document. This analytical report must be reproduced in its entirety.



Eagle Environmental Consulting
8000 W 44th Ave
Wheat Ridge CO, 80033

Project: DCP - Dyer 6" (CR80/CR109)

Project Number: [none]
Project Manager: Chandler Cole

Reported:
09/08/22 10:14

Volatile Organic Compounds by EPA Method 8260B - Quality Control

Summit Scientific

Analyte	Reporting			Spike	Source		%REC		RPD	
	Result	Limit	Units	Level	Result	%REC	Limits	RPD	Limit	Notes

Batch BFH0656 - EPA 5030 Soil MS

Matrix Spike Dup (BFH0656-MSD1)		Source: 2208425-03			Prepared: 08/30/22 Analyzed: 08/31/22					
Benzene	0.0722	0.0020	mg/kg	0.0750	ND	96.2	70-130	12.3	30	
Toluene	0.0663	0.0050	"	0.0750	ND	88.4	70-130	2.98	30	
Ethylbenzene	0.0688	0.0050	"	0.0750	ND	91.8	70-130	0.832	30	
m,p-Xylene	0.139	0.010	"	0.150	ND	92.4	70-130	0.804	30	
o-Xylene	0.0672	0.0050	"	0.0750	ND	89.6	70-130	3.08	30	
1,2,4-Trimethylbenzene	0.0662	0.0050	"	0.0750	ND	88.2	70-130	2.80	30	
1,3,5-Trimethylbenzene	0.0666	0.0050	"	0.0750	ND	88.8	70-130	0.406	30	
Naphthalene	0.0815	0.0038	"	0.0750	ND	109	70-130	20.4	30	
Surrogate: 1,2-Dichloroethane-d4		0.0377	"	0.0400		94.4	50-150			
Surrogate: Toluene-d8		0.0384	"	0.0400		95.9	50-150			
Surrogate: 4-Bromofluorobenzene		0.0390	"	0.0400		97.5	50-150			

Summit Scientific

The results in this report apply to the samples analyzed in accordance with the chain of custody document. This analytical report must be reproduced in its entirety.



Eagle Environmental Consulting
8000 W 44th Ave
Wheat Ridge CO, 80033

Project: DCP - Dyer 6" (CR80/CR109)
Project Number: [none]
Project Manager: Chandler Cole

Reported:
09/08/22 10:14

Extractable Petroleum Hydrocarbons by 8015 - Quality Control
Summit Scientific

Analyte	Reporting			Spike	Source		%REC		RPD	
	Result	Limit	Units	Level	Result	%REC	Limits	RPD	Limit	Notes

Batch BFH0657 - EPA 3550A

Blank (BFH0657-BLK1)

Prepared: 08/30/22 Analyzed: 08/31/22

C10-C28 (DRO)	ND	50	mg/kg
C28-C36 (ORO)	ND	50	"

LCS (BFH0657-BS1)

Prepared: 08/30/22 Analyzed: 08/31/22

C10-C28 (DRO)	550	50	mg/kg	500	110	70-130
---------------	-----	----	-------	-----	-----	--------

Matrix Spike (BFH0657-MS1)

Source: 2208425-03

Prepared: 08/30/22 Analyzed: 08/31/22

C10-C28 (DRO)	426	50	mg/kg	500	12.6	82.7	70-130
---------------	-----	----	-------	-----	------	------	--------

Matrix Spike Dup (BFH0657-MSD1)

Source: 2208425-03

Prepared: 08/30/22 Analyzed: 08/31/22

C10-C28 (DRO)	418	50	mg/kg	500	12.6	81.0	70-130	2.04	20
---------------	-----	----	-------	-----	------	------	--------	------	----

Summit Scientific

The results in this report apply to the samples analyzed in accordance with the chain of custody document. This analytical report must be reproduced in its entirety.



Eagle Environmental Consulting
8000 W 44th Ave
Wheat Ridge CO, 80033

Project: DCP - Dyer 6" (CR80/CR109)

Project Number: [none]
Project Manager: Chandler Cole

Reported:
09/08/22 10:14

PAH by EPA Method 8270D SIM - Quality Control

Summit Scientific

Analyte	Reporting			Spike		Source		%REC		RPD	
	Result	Limit	Units	Level		Result	%REC	Limits	RPD	Limit	Notes

Batch BFH0665 - EPA 5030 Soil MS

Blank (BFH0665-BLK1)

Prepared & Analyzed: 08/31/22

Acenaphthene	ND	0.00500	mg/kg								
Anthracene	ND	0.00500	"								
Benzo (a) anthracene	ND	0.00500	"								
Benzo (a) pyrene	ND	0.00500	"								
Benzo (b) fluoranthene	ND	0.00500	"								
Benzo (k) fluoranthene	ND	0.00500	"								
Chrysene	ND	0.00500	"								
Dibenz (a,h) anthracene	ND	0.00500	"								
Fluoranthene	ND	0.00500	"								
Fluorene	ND	0.00500	"								
Indeno (1,2,3-cd) pyrene	ND	0.00500	"								
Pyrene	ND	0.00500	"								
1-Methylnaphthalene	ND	0.00500	"								
2-Methylnaphthalene	ND	0.00500	"								
Surrogate: 2-Methylnaphthalene-d10	0.0372		"	0.0333		112		40-150			
Surrogate: Fluoranthene-d10	0.0286		"	0.0333		85.8		40-150			

LCS (BFH0665-BS1)

Prepared & Analyzed: 08/31/22

Acenaphthene	0.0360	0.00500	mg/kg	0.0333		108		31-137			
Anthracene	0.0340	0.00500	"	0.0333		102		30-120			
Benzo (a) anthracene	0.0381	0.00500	"	0.0333		114		30-120			
Benzo (a) pyrene	0.0167	0.00500	"	0.0333		50.0		30-120			
Benzo (b) fluoranthene	0.0279	0.00500	"	0.0333		83.8		30-120			
Benzo (k) fluoranthene	0.0170	0.00500	"	0.0333		51.1		30-120			
Chrysene	0.0269	0.00500	"	0.0333		80.7		30-120			
Dibenz (a,h) anthracene	0.0323	0.00500	"	0.0333		96.8		30-120			
Fluoranthene	0.0335	0.00500	"	0.0333		100		30-120			
Fluorene	0.0332	0.00500	"	0.0333		99.5		30-120			
Indeno (1,2,3-cd) pyrene	0.0318	0.00500	"	0.0333		95.4		30-120			
Pyrene	0.0391	0.00500	"	0.0333		117		35-142			
1-Methylnaphthalene	0.0249	0.00500	"	0.0333		74.8		35-142			
2-Methylnaphthalene	0.0219	0.00500	"	0.0333		65.6		35-142			
Surrogate: 2-Methylnaphthalene-d10	0.0233		"	0.0333		70.0		40-150			
Surrogate: Fluoranthene-d10	0.0283		"	0.0333		85.0		40-150			

Summit Scientific

The results in this report apply to the samples analyzed in accordance with the chain of custody document. This analytical report must be reproduced in its entirety.



Eagle Environmental Consulting
8000 W 44th Ave
Wheat Ridge CO, 80033

Project: DCP - Dyer 6" (CR80/CR109)

Project Number: [none]
Project Manager: Chandler Cole

Reported:
09/08/22 10:14

PAH by EPA Method 8270D SIM - Quality Control

Summit Scientific

Analyte	Reporting			Spike		Source		%REC		RPD	
	Result	Limit	Units	Level		Result	%REC	Limits	RPD	Limit	Notes

Batch BFH0665 - EPA 5030 Soil MS

Matrix Spike (BFH0665-MS1)

Source: 2208438-01

Prepared & Analyzed: 08/31/22

Acenaphthene	0.0197	0.00500	mg/kg	0.0333	ND	59.1	31-137				
Anthracene	0.0239	0.00500	"	0.0333	ND	71.6	30-120				
Benzo (a) anthracene	0.0214	0.00500	"	0.0333	0.00420	51.6	30-120				
Benzo (a) pyrene	0.0179	0.00500	"	0.0333	ND	53.7	30-120				
Benzo (b) fluoranthene	0.0162	0.00500	"	0.0333	ND	48.5	30-120				
Benzo (k) fluoranthene	0.0160	0.00500	"	0.0333	ND	47.9	30-120				
Chrysene	0.0216	0.00500	"	0.0333	0.00234	57.9	30-120				
Dibenz (a,h) anthracene	0.0133	0.00500	"	0.0333	ND	40.0	30-120				
Fluoranthene	0.0250	0.00500	"	0.0333	ND	75.1	30-120				
Fluorene	0.0215	0.00500	"	0.0333	ND	64.5	30-120				
Indeno (1,2,3-cd) pyrene	0.0142	0.00500	"	0.0333	ND	42.7	30-120				
Pyrene	0.0149	0.00500	"	0.0333	ND	44.8	35-142				
1-Methylnaphthalene	0.0218	0.00500	"	0.0333	ND	65.5	15-130				
2-Methylnaphthalene	0.0199	0.00500	"	0.0333	ND	59.6	15-130				
Surrogate: 2-Methylnaphthalene-d10	0.0212		"	0.0333		63.6	40-150				
Surrogate: Fluoranthene-d10	0.0291		"	0.0333		87.3	40-150				

Matrix Spike Dup (BFH0665-MSD1)

Source: 2208438-01

Prepared & Analyzed: 08/31/22

Acenaphthene	0.0223	0.00500	mg/kg	0.0333	ND	66.9	31-137	12.3	30		
Anthracene	0.0268	0.00500	"	0.0333	ND	80.5	30-120	11.7	30		
Benzo (a) anthracene	0.0260	0.00500	"	0.0333	0.00420	65.6	30-120	19.6	30		
Benzo (a) pyrene	0.0175	0.00500	"	0.0333	ND	52.4	30-120	2.43	30		
Benzo (b) fluoranthene	0.0149	0.00500	"	0.0333	ND	44.8	30-120	7.98	30		
Benzo (k) fluoranthene	0.0158	0.00500	"	0.0333	ND	47.5	30-120	0.705	30		
Chrysene	0.0207	0.00500	"	0.0333	0.00234	55.1	30-120	4.39	30		
Dibenz (a,h) anthracene	0.0145	0.00500	"	0.0333	ND	43.4	30-120	8.09	30		
Fluoranthene	0.0280	0.00500	"	0.0333	ND	84.1	30-120	11.3	30		
Fluorene	0.0217	0.00500	"	0.0333	ND	65.0	30-120	0.689	30		
Indeno (1,2,3-cd) pyrene	0.0157	0.00500	"	0.0333	ND	47.0	30-120	9.62	30		
Pyrene	0.0150	0.00500	"	0.0333	ND	45.1	35-142	0.549	30		
1-Methylnaphthalene	0.0231	0.00500	"	0.0333	ND	69.3	15-130	5.68	50		
2-Methylnaphthalene	0.0147	0.00500	"	0.0333	ND	44.0	15-130	30.1	50		
Surrogate: 2-Methylnaphthalene-d10	0.0214		"	0.0333		64.2	40-150				
Surrogate: Fluoranthene-d10	0.0318		"	0.0333		95.5	40-150				

Summit Scientific

The results in this report apply to the samples analyzed in accordance with the chain of custody document. This analytical report must be reproduced in its entirety.



Eagle Environmental Consulting
8000 W 44th Ave
Wheat Ridge CO, 80033

Project: DCP - Dyer 6" (CR80/CR109)

Project Number: [none]
Project Manager: Chandler Cole

Reported:
09/08/22 10:14

Total Metals by EPA 6020B Hot Water Soluble Extraction - Quality Control
Summit Scientific

Analyte	Reporting			Spike	Source	%REC		RPD		
	Result	Limit	Units	Level	Result	%REC	Limits	RPD	Limit	Notes

Batch BFH0650 - EPA 3050B

Blank (BFH0650-BLK1)

Prepared: 08/30/22 Analyzed: 09/01/22

Boron ND 0.0100 mg/L

LCS (BFH0650-BS1)

Prepared: 08/30/22 Analyzed: 09/01/22

Boron 5.13 0.0100 mg/L 5.00 103 80-120

Duplicate (BFH0650-DUP1)

Source: 2208338-16

Prepared: 08/30/22 Analyzed: 09/01/22

Boron 0.158 0.0100 mg/L 0.159 0.263 20

Matrix Spike (BFH0650-MS1)

Source: 2208338-16

Prepared: 08/30/22 Analyzed: 09/01/22

Boron 5.24 0.0100 mg/L 5.00 0.159 102 75-125

Matrix Spike Dup (BFH0650-MSD1)

Source: 2208338-16

Prepared: 08/30/22 Analyzed: 09/01/22

Boron 5.39 0.0100 mg/L 5.00 0.159 105 75-125 2.72 25

Summit Scientific

The results in this report apply to the samples analyzed in accordance with the chain of custody document. This analytical report must be reproduced in its entirety.



Eagle Environmental Consulting
8000 W 44th Ave
Wheat Ridge CO, 80033

Project: DCP - Dyer 6" (CR80/CR109)

Project Number: [none]
Project Manager: Chandler Cole

Reported:
09/08/22 10:14

Total Metals by EPA 6020B - Quality Control

Summit Scientific

Analyte	Reporting			Spike Level	Source		%REC		RPD	
	Result	Limit	Units		Result	%REC	Limits	RPD	Limit	Notes

Batch BFH0660 - EPA 3050B

Blank (BFH0660-BLK1)

Prepared: 08/30/22 Analyzed: 09/01/22

Arsenic	ND	0.200	mg/kg wet
Barium	ND	0.400	"
Cadmium	ND	0.200	"
Copper	ND	0.400	"
Lead	ND	0.200	"
Nickel	ND	0.400	"
Selenium	ND	0.260	"
Silver	ND	0.0200	"
Zinc	ND	0.400	"

LCS (BFH0660-BS1)

Prepared: 08/30/22 Analyzed: 09/01/22

Arsenic	41.7	0.200	mg/kg wet	80-120
Barium	40.9	0.400	"	80-120
Cadmium	2.10	0.200	"	80-120
Copper	39.7	0.400	"	80-120
Lead	18.9	0.200	"	80-120
Nickel	39.5	0.400	"	80-120
Selenium	4.15	0.260	"	80-120
Silver	2.05	0.0200	"	80-120
Zinc	42.8	0.400	"	80-120

Duplicate (BFH0660-DUP1)

Source: 2208358-05

Prepared: 08/30/22 Analyzed: 09/01/22

Arsenic	2.46	0.213	mg/kg dry	2.35	4.42	20
Barium	53.0	0.426	"	51.6	2.71	20
Cadmium	0.0955	0.213	"	0.0924	3.26	20
Copper	5.33	0.426	"	5.24	1.69	20
Lead	4.10	0.213	"	4.03	1.58	20
Nickel	5.13	0.426	"	5.01	2.41	20
Selenium	0.481	0.277	"	0.383	22.6	20
Silver	0.0198	0.0213	"	0.0188	5.27	20
Zinc	19.8	0.426	"	19.4	2.03	20

QR-04

Summit Scientific

The results in this report apply to the samples analyzed in accordance with the chain of custody document. This analytical report must be reproduced in its entirety.



Eagle Environmental Consulting
8000 W 44th Ave
Wheat Ridge CO, 80033

Project: DCP - Dyer 6" (CR80/CR109)

Project Number: [none]
Project Manager: Chandler Cole

Reported:
09/08/22 10:14

Total Metals by EPA 6020B - Quality Control

Summit Scientific

Analyte	Reporting			Spike	Source		%REC		RPD	
	Result	Limit	Units	Level	Result	%REC	Limits	RPD	Limit	Notes

Batch BFH0660 - EPA 3050B

Matrix Spike (BFH0660-MS1)

Source: 2208358-05

Prepared: 08/30/22 Analyzed: 09/01/22

Arsenic	45.0	0.213	mg/kg dry	2.35	75-125
Barium	89.8	0.426	"	51.6	75-125
Cadmium	2.37	0.213	"	0.0924	75-125
Copper	45.4	0.426	"	5.24	75-125
Lead	23.7	0.213	"	4.03	75-125
Nickel	46.0	0.426	"	5.01	75-125
Selenium	3.94	0.277	"	0.383	75-125
Silver	2.22	0.0213	"	0.0188	75-125
Zinc	61.0	0.426	"	19.4	75-125

Matrix Spike Dup (BFH0660-MSD1)

Source: 2208358-05

Prepared: 08/30/22 Analyzed: 09/01/22

Arsenic	45.2	0.213	mg/kg dry	2.35	75-125	0.525	25
Barium	92.0	0.426	"	51.6	75-125	2.42	25
Cadmium	2.42	0.213	"	0.0924	75-125	2.10	25
Copper	45.7	0.426	"	5.24	75-125	0.554	25
Lead	24.1	0.213	"	4.03	75-125	1.74	25
Nickel	46.0	0.426	"	5.01	75-125	0.0737	25
Selenium	4.00	0.277	"	0.383	75-125	1.28	25
Silver	2.27	0.0213	"	0.0188	75-125	2.12	25
Zinc	60.9	0.426	"	19.4	75-125	0.207	25

Summit Scientific

The results in this report apply to the samples analyzed in accordance with the chain of custody document. This analytical report must be reproduced in its entirety.



Eagle Environmental Consulting
8000 W 44th Ave
Wheat Ridge CO, 80033

Project: DCP - Dyer 6" (CR80/CR109)

Project Number: [none]
Project Manager: Chandler Cole

Reported:
09/08/22 10:14

Hexavalent Chromium by EPA Method 7196 - Quality Control
Summit Scientific

Analyte	Reporting			Spike	Source		%REC		RPD	
	Result	Limit	Units	Level	Result	%REC	Limits	RPD	Limit	Notes

Batch BFH0671 - 3060A Mod

Blank (BFH0671-BLK1)

Prepared: 08/31/22 Analyzed: 09/01/22

Chromium, Hexavalent ND 0.30 mg/kg wet

LCS (BFH0671-BS1)

Prepared: 08/31/22 Analyzed: 09/01/22

Chromium, Hexavalent 26.1 0.30 mg/kg wet 25.0 104 80-120

Duplicate (BFH0671-DUP1)

Source: 2208358-19

Prepared: 08/31/22 Analyzed: 09/01/22

Chromium, Hexavalent ND 0.30 mg/kg dry ND 20

Matrix Spike (BFH0671-MS1)

Source: 2208358-19

Prepared: 08/31/22 Analyzed: 09/01/22

Chromium, Hexavalent 32.7 0.30 mg/kg dry 27.3 ND 120 75-125

Matrix Spike Dup (BFH0671-MSD1)

Source: 2208358-19

Prepared: 08/31/22 Analyzed: 09/01/22

Chromium, Hexavalent 32.9 0.30 mg/kg dry 27.3 ND 120 75-125 0.667 20

Summit Scientific

The results in this report apply to the samples analyzed in accordance with the chain of custody document. This analytical report must be reproduced in its entirety.



Eagle Environmental Consulting
8000 W 44th Ave
Wheat Ridge CO, 80033

Project: DCP - Dyer 6" (CR80/CR109)

Project Number: [none]
Project Manager: Chandler Cole

Reported:
09/08/22 10:14

Soluble Nutrients by EPA 6020/USDA60 6(2) - Saturated Paste Extraction - Quality Control

Summit Scientific

Analyte	Result	Reporting		Spike Level	Source		%REC		RPD	
		Limit	Units		Result	%REC	Limits	RPD	Limit	Notes

Batch BFI0007 - General Preparation

Blank (BFI0007-BLK1)

Prepared: 09/01/22 Analyzed: 09/03/22

Calcium	ND	0.0500	mg/L wet
Magnesium	ND	0.0500	"
Sodium	ND	0.0500	"

LCS (BFI0007-BS1)

Prepared: 09/01/22 Analyzed: 09/03/22

Calcium	5.44	0.0500	mg/L wet	5.00	109	70-130
Magnesium	5.47	0.0500	"	5.00	109	70-130
Sodium	5.55	0.0500	"	5.00	111	70-130

Summit Scientific

The results in this report apply to the samples analyzed in accordance with the chain of custody document. This analytical report must be reproduced in its entirety.



Eagle Environmental Consulting
8000 W 44th Ave
Wheat Ridge CO, 80033

Project: DCP - Dyer 6" (CR80/CR109)

Project Number: [none]
Project Manager: Chandler Cole

Reported:
09/08/22 10:14

Physical Parameters by APHA/ASTM/EPA Methods - Quality Control

Summit Scientific

Analyte	Result	Reporting		Spike Level	Source		%REC		RPD	
		Limit	Units		Result	%REC	Limits	RPD	Limit	Notes

Batch BFH0658 - General Preparation

Duplicate (BFH0658-DUP1)		Source: 2208358-01		Prepared: 08/30/22 Analyzed: 08/31/22	
% Solids	93.5		%	93.8	0.327 20

Summit Scientific

The results in this report apply to the samples analyzed in accordance with the chain of custody document. This analytical report must be reproduced in its entirety.



Eagle Environmental Consulting
8000 W 44th Ave
Wheat Ridge CO, 80033

Project: DCP - Dyer 6" (CR80/CR109)

Project Number: [none]
Project Manager: Chandler Cole

Reported:
09/08/22 10:14

Specific Conductance by EPA Method 120.1, Saturated Paste Extraction - Quality Control

Summit Scientific

Analyte	Result	Reporting		Spike Level	Source		%REC		RPD	
		Limit	Units		Result	%REC	Limits	RPD	Limit	Notes

Batch BF10055 - General Preparation

Blank (BF10055-BLK1)

Prepared: 09/02/22 Analyzed: 09/03/22

Specific Conductance (EC) ND 0.0100 mmhos/cm

LCS (BF10055-BS1)

Prepared: 09/02/22 Analyzed: 09/03/22

Specific Conductance (EC) 0.154 0.0100 mmhos/cm 0.150 102 95-105

Duplicate (BF10055-DUP1)

Source: 2208247-02

Prepared: 09/02/22 Analyzed: 09/03/22

Specific Conductance (EC) 0.439 0.0100 mmhos/cm 0.442 0.636 20

Summit Scientific

The results in this report apply to the samples analyzed in accordance with the chain of custody document. This analytical report must be reproduced in its entirety.



Eagle Environmental Consulting
8000 W 44th Ave
Wheat Ridge CO, 80033

Project: DCP - Dyer 6" (CR80/CR109)

Project Number: [none]
Project Manager: Chandler Cole

Reported:
09/08/22 10:14

Physical Parameters by APHA/ASTM/EPA Methods, Saturated Paste Extraction - Quality Control
Summit Scientific

Analyte	Result	Reporting		Spike Level	Source		%REC		RPD	
		Limit	Units		Result	%REC	Limits	RPD	Limit	Notes

Batch BFI0054 - General Preparation

LCS (BFI0054-BS1)

Prepared & Analyzed: 09/02/22

pH	9.07	pH Units	9.18	98.8	95-105
----	------	----------	------	------	--------

Duplicate (BFI0054-DUP1)

Source: 2208247-02

Prepared & Analyzed: 09/02/22

pH	7.41	pH Units	7.41	0.00	20
----	------	----------	------	------	----

Summit Scientific

The results in this report apply to the samples analyzed in accordance with the chain of custody document. This analytical report must be reproduced in its entirety.



Eagle Environmental Consulting
8000 W 44th Ave
Wheat Ridge CO, 80033

Project: DCP - Dyer 6" (CR80/CR109)

Project Number: [none]
Project Manager: Chandler Cole

Reported:
09/08/22 10:14

Notes and Definitions

QR-04	The RPD value for the sample duplicate or MS/MSD was outside of QC acceptance. QC batch accepted based on LCS and/or LCSD recovery and/or RPD values.
DET	Analyte DETECTED
ND	Analyte NOT DETECTED at or above the reporting limit
NR	Not Reported
dry	Sample results reported on a dry weight basis
RPD	Relative Percent Difference

Summit Scientific

4653 Table Mountain Drive, Golden, Colorado 80403

303.277.9310

September 07, 2022

Chandler Cole

Eagle Environmental Consulting

8000 W 44th Ave

Wheat Ridge, CO 80033

RE: DCP - Dyer 6" (CR80/CR109)

Work Order #2208450

Enclosed are the results of analyses for samples received by Summit Scientific on 08/31/22 14:53. If you have any questions concerning this report, please feel free to contact me.

Sincerely,



Mikayla Axtell For Paul Shrewsbury
President



Eagle Environmental Consulting
8000 W 44th Ave
Wheat Ridge CO, 80033

Project: DCP - Dyer 6" (CR80/CR109)

Project Number: [none]
Project Manager: Chandler Cole

Reported:
09/07/22 15:01

ANALYTICAL REPORT FOR SAMPLES

Sample ID	Laboratory ID	Matrix	Date Sampled	Date Received
SC-SS-01@13'	2208450-01	Soil	08/31/22 07:51	08/31/22 14:53
N-SS-03@11'	2208450-02	Soil	08/31/22 09:30	08/31/22 14:53
E-SS-02@10'	2208450-03	Soil	08/31/22 09:55	08/31/22 14:53
W-SS-03@11'	2208450-04	Soil	08/31/22 10:20	08/31/22 14:53

Summit Scientific

The results in this report apply to the samples analyzed in accordance with the chain of custody document. This analytical report must be reproduced in its entirety.

Summit Scientific

2208450

S₂

4653 Table Mountain Drive ♦ Golden, Colorado 80403

303-277-9310

Page / of /

Client: DCP / Eagle Environmental Consulting

Project Manager: Chandler Cole / David Castro

Address: 6900 E. Layton Ave., Ste 900

E-Mail: cecole@dcpmidstream.com, dcastro@eagle-enviro.com

City/State/Zip: Denver, CO 80237

swenters@dcpmidstream.com, dcoloccia@eagle-enviro.com



Phone: Chandler - 970-939-0329 / David - 713-594-4157

Project Name: Dyer 6" (CR89/CR109)

Sampler Name: David Castro

Project Number:

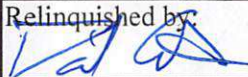
ID	Sample Description	Date Sampled	Time Sampled	# of containers	Preservative				Matrix				Analysis Requested								Special Instructions
					HCl	HNO3	None	Other	Water	Soil	Air-Canister #	Other	LOGGABLE 915-1 FULL	915-1 VOC	915-1 TPH (GAS)	915-1 PAH	915-1 Inorganics	915-1 Metals			
1	SC-SS-01 @ 13'	8/31/22	7:51	3			X			X				X							EC, SAR, pit saturated paste prep
2	N-SS-03 @ 11'	↓	9:30	3			X			X				X	X	X	X	H			Hold Metals
3	E-SS-02 @ 10'	↓	9:55	3			X			X				X	X	X	X	H			Hold Metals
4	W-SS-03 @ 11'	↓	10:20	3			X			X				X	X	X	X	H			Hold Metals
5																					
6																					
7																					
8																					
9																					
10																					

Relinquished by: 	Date/Time: 8/31/22 14:53	Received by: 	Date/Time: 8.31.22 1453	Turn Around Time (Check)	Notes: Bill direct to DCP
Relinquished by:	Date/Time:	Received by:	Date/Time:	Same Day <input checked="" type="checkbox"/> 72 hours	
				24 hours <input type="checkbox"/> Standard	
				48 hours <input type="checkbox"/>	
Temperature Upon Receipt: 20.1	Corrected Temperature: <u> </u>	HNO3 lot #	Sample Integrity:	Samples Intact: <input checked="" type="radio"/> Yes <input type="radio"/> No	
IR gun correction: <u> </u>	IR gun #: <u> </u>				

S₂

2208450

Sample Receipt Checklist

S2 Work Order#

Client: DCP/Beagle Enviro Client Project ID: Dyer 6" (CR80/CR109)Shipped Via: H.D./P.U./FedEx/UPS/USPS/Other ☐ Airbill #: ☐

<input checked="" type="checkbox"/>	<input type="checkbox"/>	<input type="checkbox"/>	<input type="checkbox"/>	<input type="checkbox"/>
-------------------------------------	--------------------------	--------------------------	--------------------------	--------------------------

Matrix (Check all that apply) Air ☐ Soil/Solid ☒ Water ☐ Other ☐Temp (°C) Thermometer #

	Yes	No	N/A	Comments (if any)
If samples require cooling, is the temperature < 6°C? ⁽¹⁾ NOTE: If samples are delivered the same day of sampling, this requirement is met if there is evidence that cooling has begun.	<input checked="" type="checkbox"/>	<input type="checkbox"/>	<input type="checkbox"/>	nil
If custody seals are present, are they intact? ⁽¹⁾	<input type="checkbox"/>	<input type="checkbox"/>	<input checked="" type="checkbox"/>	
Are samples due within 48 hours present?	<input checked="" type="checkbox"/>	<input type="checkbox"/>	<input type="checkbox"/>	Same day
Are water samples with short hold times present? Note the short hold analysis in the comments column - pH, Nitrate/Nitrite, Ferrous Iron (Fe ²⁺), Hexavalent Chromium (Cr ⁶⁺ , Cr VI), COD/BOD, Total Coliform, E. Coli, Total Residual Chlorine (TRC), Dissolved Oxygen	<input type="checkbox"/>	<input type="checkbox"/>	<input checked="" type="checkbox"/>	
Is a chain-of-custody (COC) form present and filled out Completely? ⁽¹⁾	<input checked="" type="checkbox"/>	<input type="checkbox"/>	<input type="checkbox"/>	
Is the COC properly relinquished by the client w/ date and time recorded? ⁽¹⁾	<input checked="" type="checkbox"/>	<input type="checkbox"/>	<input type="checkbox"/>	
Were all samples received intact? ⁽¹⁾	<input checked="" type="checkbox"/>	<input type="checkbox"/>	<input type="checkbox"/>	
Was adequate sample volume provided? ⁽¹⁾	<input checked="" type="checkbox"/>	<input type="checkbox"/>	<input type="checkbox"/>	
Does the COC agree with the number and type of sample bottles received? ⁽¹⁾	<input checked="" type="checkbox"/>	<input type="checkbox"/>	<input type="checkbox"/>	
Do the sample IDs on the bottle labels match the COC? ⁽¹⁾	<input checked="" type="checkbox"/>	<input type="checkbox"/>	<input type="checkbox"/>	
For volatiles in water – is there headspace present? If yes, contact client and note in narrative.	<input type="checkbox"/>	<input type="checkbox"/>	<input checked="" type="checkbox"/>	
Are samples preserved that require preservation (excluding cooling)? ⁽¹⁾ Note the type of preservative in the comments column – HCl, H ₂ SO ₄ , NaOH, HNO ₃ , etc.	<input type="checkbox"/>	<input type="checkbox"/>	<input type="checkbox"/>	
If samples are acid preserved for metals, is the pH ≤ 2? ⁽¹⁾ Record the pH in Comments.	<input type="checkbox"/>	<input type="checkbox"/>	<input checked="" type="checkbox"/>	
If dissolved metals are requested, were samples field filtered?	<input type="checkbox"/>	<input type="checkbox"/>	<input checked="" type="checkbox"/>	

Additional Comments (if any):

⁽¹⁾ If NO, then contact the client before proceeding with analysis and note in case narrative.
AT
Custodian Printed Name

8.31.22
Date/Time



Eagle Environmental Consulting
8000 W 44th Ave
Wheat Ridge CO, 80033

Project: DCP - Dyer 6" (CR80/CR109)

Project Number: [none]
Project Manager: Chandler Cole

Reported:
09/07/22 15:01

SC-SS-01@13'
2208450-01 (Soil)

Summit Scientific

Volatile Organic Compounds by EPA Method 8260B

Date Sampled: **08/31/22 07:51**

Analyte	Result	Reporting Limit	Units	Dilution	Batch	Prepared	Analyzed	Method	Notes
Benzene	ND	0.0020	mg/kg	1	BFH0700	08/31/22	08/31/22	EPA 8260B	
Toluene	ND	0.0050	"	"	"	"	"	"	
Ethylbenzene	ND	0.0050	"	"	"	"	"	"	
Xylenes (total)	ND	0.010	"	"	"	"	"	"	
1,2,4-Trimethylbenzene	ND	0.0050	"	"	"	"	"	"	
1,3,5-Trimethylbenzene	ND	0.0050	"	"	"	"	"	"	
Naphthalene	ND	0.0038	"	"	"	"	"	"	
Gasoline Range Hydrocarbons	ND	0.50	"	"	"	"	"	"	

Date Sampled: **08/31/22 07:51**

Analyte	Result	Reporting Limit	Units	Dilution	Batch	Prepared	Analyzed	Method	Notes
Surrogate: 1,2-Dichloroethane-d4		103 %	50-150		"	"	"	"	
Surrogate: Toluene-d8		94.9 %	50-150		"	"	"	"	
Surrogate: 4-Bromofluorobenzene		91.9 %	50-150		"	"	"	"	

Extractable Petroleum Hydrocarbons by 8015

Date Sampled: **08/31/22 07:51**

Analyte	Result	Reporting Limit	Units	Dilution	Batch	Prepared	Analyzed	Method	Notes
C10-C28 (DRO)	ND	50	mg/kg	1	BFH0701	08/31/22	08/31/22	EPA 8015M	
C28-C36 (ORO)	ND	50	"	"	"	"	"	"	

Date Sampled: **08/31/22 07:51**

Analyte	Result	Reporting Limit	Units	Dilution	Batch	Prepared	Analyzed	Method	Notes
Surrogate: o-Terphenyl		101 %	30-150		"	"	"	"	

PAH by EPA Method 8270D SIM

Summit Scientific

The results in this report apply to the samples analyzed in accordance with the chain of custody document. This analytical report must be reproduced in its entirety.



Eagle Environmental Consulting
8000 W 44th Ave
Wheat Ridge CO, 80033

Project: DCP - Dyer 6" (CR80/CR109)

Project Number: [none]
Project Manager: Chandler Cole

Reported:
09/07/22 15:01

SC-SS-01@13'
2208450-01 (Soil)

Summit Scientific

PAH by EPA Method 8270D SIM

Date Sampled: **08/31/22 07:51**

Analyte	Result	Reporting Limit	Units	Dilution	Batch	Prepared	Analyzed	Method	Notes
Acenaphthene	ND	0.00500	mg/kg	1	BF10002	09/01/22	09/04/22	EPA 8270D SIM	
Anthracene	ND	0.00500	"	"	"	"	"	"	
Benzo (a) anthracene	ND	0.00500	"	"	"	"	"	"	
Benzo (a) pyrene	ND	0.00500	"	"	"	"	"	"	
Benzo (b) fluoranthene	ND	0.00500	"	"	"	"	"	"	
Benzo (k) fluoranthene	ND	0.00500	"	"	"	"	"	"	
Chrysene	ND	0.00500	"	"	"	"	"	"	
Dibenz (a,h) anthracene	ND	0.00500	"	"	"	"	"	"	
Fluoranthene	ND	0.00500	"	"	"	"	"	"	
Fluorene	ND	0.00500	"	"	"	"	"	"	
Indeno (1,2,3-cd) pyrene	ND	0.00500	"	"	"	"	"	"	
Pyrene	ND	0.00500	"	"	"	"	"	"	
1-Methylnaphthalene	ND	0.00500	"	"	"	"	"	"	
2-Methylnaphthalene	ND	0.00500	"	"	"	"	"	"	

Date Sampled: **08/31/22 07:51**

Analyte	Result	Reporting Limit	Units	Dilution	Batch	Prepared	Analyzed	Method	Notes
Surrogate: 2-Methylnaphthalene-d10		81.1 %	40-150		"	"	"	"	
Surrogate: Fluoranthene-d10		65.2 %	40-150		"	"	"	"	

Total Metals by EPA 6020B Hot Water Soluble Extraction

Date Sampled: **08/31/22 07:51**

Analyte	Result	Reporting Limit	Units	Dilution	Batch	Prepared	Analyzed	Method	Notes
Boron	0.0176	0.0100	mg/L	1	BF10013	09/01/22	09/03/22	EPA 6020B	

Total Metals by EPA 6020B

Date Sampled: **08/31/22 07:51**

Analyte	Result	Reporting Limit	Units	Dilution	Batch	Prepared	Analyzed	Method	Notes
---------	--------	-----------------	-------	----------	-------	----------	----------	--------	-------

Summit Scientific

The results in this report apply to the samples analyzed in accordance with the chain of custody document. This analytical report must be reproduced in its entirety.



Eagle Environmental Consulting
8000 W 44th Ave
Wheat Ridge CO, 80033

Project: DCP - Dyer 6" (CR80/CR109)

Project Number: [none]
Project Manager: Chandler Cole

Reported:
09/07/22 15:01

SC-SS-01@13'
2208450-01 (Soil)

Summit Scientific

Total Metals by EPA 6020B

Arsenic	1.30	0.211	mg/kg dry	1	BFH0706	08/31/22	09/02/22	EPA 6020B
Barium	22.8	0.421	"	"	"	"	"	"
Cadmium	ND	0.211	"	"	"	"	"	"
Copper	1.25	0.421	"	"	"	"	"	"
Lead	2.47	0.211	"	"	"	"	"	"
Nickel	0.804	0.421	"	"	"	"	"	"
Selenium	ND	0.274	"	"	"	"	"	"
Silver	ND	0.0211	"	"	"	"	"	"
Zinc	8.78	0.421	"	"	"	"	"	"

Hexavalent Chromium by EPA Method 7196

Date Sampled: **08/31/22 07:51**

Analyte	Result	Reporting Limit	Units	Dilution	Batch	Prepared	Analyzed	Method	Notes
Chromium, Hexavalent	ND	0.30	mg/kg dry	1	BF10011	09/01/22	09/02/22	EPA 7196A	

Soluble Nutrients by EPA 6020/USDA60 6(2) - Saturated Paste Extraction

Date Sampled: **08/31/22 07:51**

Analyte	Result	Reporting Limit	Units	Dilution	Batch	Prepared	Analyzed	Method	Notes
Calcium	14.7	0.0527	mg/L dry	1	BF10007	09/01/22	09/03/22	EPA 6020B	
Magnesium	3.17	0.0527	"	"	"	"	"	"	
Sodium	0.785	0.0527	"	"	"	"	"	"	

Calculated Analysis

Date Sampled: **08/31/22 07:51**

Analyte	Result	Reporting Limit	Units	Dilution	Batch	Prepared	Analyzed	Method	Notes
Sodium Adsorption Ratio	0.0484	0.00100	units	1	BF10092	09/06/22	09/06/22	Calculation	

Physical Parameters by APHA/ASTM/EPA Methods

Summit Scientific

The results in this report apply to the samples analyzed in accordance with the chain of custody document. This analytical report must be reproduced in its entirety.



Eagle Environmental Consulting
8000 W 44th Ave
Wheat Ridge CO, 80033

Project: DCP - Dyer 6" (CR80/CR109)
Project Number: [none]
Project Manager: Chandler Cole

Reported:
09/07/22 15:01

SC-SS-01@13'
2208450-01 (Soil)

Summit Scientific

Physical Parameters by APHA/ASTM/EPA Methods

Date Sampled: **08/31/22 07:51**

Analyte	Result	Reporting		Units	Dilution	Batch	Prepared	Analyzed	Method	Notes
		Limit								
% Solids	94.9			%	1	BF10019	09/01/22	09/02/22	Calculation	

Specific Conductance by EPA Method 120.1, Saturated Paste Extraction

Date Sampled: **08/31/22 07:51**

Analyte	Result	Reporting		Units	Dilution	Batch	Prepared	Analyzed	Method	Notes
		Limit								
Specific Conductance (EC)	0.140	0.0100		mmhos/cm	1	BF10055	09/02/22	09/03/22	EPA 120.1	

Physical Parameters by APHA/ASTM/EPA Methods, Saturated Paste Extraction

Date Sampled: **08/31/22 07:51**

Analyte	Result	Reporting		Units	Dilution	Batch	Prepared	Analyzed	Method	Notes
		Limit								
pH	7.76			pH Units	1	BF10054	09/02/22	09/02/22	EPA 9045D	

Summit Scientific

The results in this report apply to the samples analyzed in accordance with the chain of custody document. This analytical report must be reproduced in its entirety.



Eagle Environmental Consulting
8000 W 44th Ave
Wheat Ridge CO, 80033

Project: DCP - Dyer 6" (CR80/CR109)
Project Number: [none]
Project Manager: Chandler Cole

Reported:
09/07/22 15:01

N-SS-03@11'
2208450-02 (Soil)

Summit Scientific

Volatile Organic Compounds by EPA Method 8260B

Date Sampled: **08/31/22 09:30**

Analyte	Result	Reporting	Units	Dilution	Batch	Prepared	Analyzed	Method	Notes
		Limit							
Benzene	ND	0.0020	mg/kg	1	BFH0700	08/31/22	08/31/22	EPA 8260B	
Toluene	ND	0.0050	"	"	"	"	"	"	
Ethylbenzene	ND	0.0050	"	"	"	"	"	"	
Xylenes (total)	ND	0.010	"	"	"	"	"	"	
1,2,4-Trimethylbenzene	ND	0.0050	"	"	"	"	"	"	
1,3,5-Trimethylbenzene	ND	0.0050	"	"	"	"	"	"	
Naphthalene	ND	0.0038	"	"	"	"	"	"	
Gasoline Range Hydrocarbons	ND	0.50	"	"	"	"	"	"	

Date Sampled: **08/31/22 09:30**

Analyte	Result	Reporting	Units	Dilution	Batch	Prepared	Analyzed	Method	Notes
		Limit							
Surrogate: 1,2-Dichloroethane-d4		99.2 %	50-150		"	"	"	"	
Surrogate: Toluene-d8		94.1 %	50-150		"	"	"	"	
Surrogate: 4-Bromofluorobenzene		89.8 %	50-150		"	"	"	"	

Extractable Petroleum Hydrocarbons by 8015

Date Sampled: **08/31/22 09:30**

Analyte	Result	Reporting	Units	Dilution	Batch	Prepared	Analyzed	Method	Notes
		Limit							
C10-C28 (DRO)	ND	50	mg/kg	1	BFH0701	08/31/22	08/31/22	EPA 8015M	
C28-C36 (ORO)	ND	50	"	"	"	"	"	"	

Date Sampled: **08/31/22 09:30**

Analyte	Result	Reporting	Units	Dilution	Batch	Prepared	Analyzed	Method	Notes
		Limit							
Surrogate: o-Terphenyl		101 %	30-150		"	"	"	"	

PAH by EPA Method 8270D SIM

Summit Scientific

The results in this report apply to the samples analyzed in accordance with the chain of custody document. This analytical report must be reproduced in its entirety.



Eagle Environmental Consulting
8000 W 44th Ave
Wheat Ridge CO, 80033

Project: DCP - Dyer 6" (CR80/CR109)

Project Number: [none]
Project Manager: Chandler Cole

Reported:
09/07/22 15:01

N-SS-03@11'
2208450-02 (Soil)

Summit Scientific

PAH by EPA Method 8270D SIM

Date Sampled: **08/31/22 09:30**

Analyte	Result	Reporting Limit	Units	Dilution	Batch	Prepared	Analyzed	Method	Notes
Acenaphthene	ND	0.00500	mg/kg	1	BF10002	09/01/22	09/04/22	EPA 8270D SIM	
Anthracene	ND	0.00500	"	"	"	"	"	"	
Benzo (a) anthracene	ND	0.00500	"	"	"	"	"	"	
Benzo (a) pyrene	ND	0.00500	"	"	"	"	"	"	
Benzo (b) fluoranthene	ND	0.00500	"	"	"	"	"	"	
Benzo (k) fluoranthene	ND	0.00500	"	"	"	"	"	"	
Chrysene	ND	0.00500	"	"	"	"	"	"	
Dibenz (a,h) anthracene	ND	0.00500	"	"	"	"	"	"	
Fluoranthene	ND	0.00500	"	"	"	"	"	"	
Fluorene	ND	0.00500	"	"	"	"	"	"	
Indeno (1,2,3-cd) pyrene	ND	0.00500	"	"	"	"	"	"	
Pyrene	ND	0.00500	"	"	"	"	"	"	
1-Methylnaphthalene	ND	0.00500	"	"	"	"	"	"	
2-Methylnaphthalene	ND	0.00500	"	"	"	"	"	"	

Date Sampled: **08/31/22 09:30**

Analyte	Result	Reporting Limit	Units	Dilution	Batch	Prepared	Analyzed	Method	Notes
Surrogate: 2-Methylnaphthalene-d10		76.5 %	40-150		"	"	"	"	
Surrogate: Fluoranthene-d10		61.5 %	40-150		"	"	"	"	

Total Metals by EPA 6020B Hot Water Soluble Extraction

Date Sampled: **08/31/22 09:30**

Analyte	Result	Reporting Limit	Units	Dilution	Batch	Prepared	Analyzed	Method	Notes
Boron	0.0520	0.0100	mg/L	1	BF10013	09/01/22	09/03/22	EPA 6020B	

Soluble Nutrients by EPA 6020/USDA60 6(2) - Saturated Paste Extraction

Date Sampled: **08/31/22 09:30**

Analyte	Result	Reporting Limit	Units	Dilution	Batch	Prepared	Analyzed	Method	Notes
---------	--------	-----------------	-------	----------	-------	----------	----------	--------	-------

Summit Scientific

The results in this report apply to the samples analyzed in accordance with the chain of custody document. This analytical report must be reproduced in its entirety.



Eagle Environmental Consulting
8000 W 44th Ave
Wheat Ridge CO, 80033

Project: DCP - Dyer 6" (CR80/CR109)
Project Number: [none]
Project Manager: Chandler Cole

Reported:
09/07/22 15:01

N-SS-03@11'
2208450-02 (Soil)

Summit Scientific

Soluble Nutrients by EPA 6020/USDA60 6(2) - Saturated Paste Extraction

Calcium	8.95	0.0527	mg/L dry	1	BF10007	09/01/22	09/03/22	EPA 6020B
Magnesium	1.71	0.0527	"	"	"	"	"	"
Sodium	14.9	0.0527	"	"	"	"	"	"

Calculated Analysis

Date Sampled: **08/31/22 09:30**

Analyte	Result	Reporting Limit	Units	Dilution	Batch	Prepared	Analyzed	Method	Notes
Sodium Adsorption Ratio	1.20	0.00100	units	1	BF10092	09/06/22	09/06/22	Calculation	

Physical Parameters by APHA/ASTM/EPA Methods

Date Sampled: **08/31/22 09:30**

Analyte	Result	Reporting Limit	Units	Dilution	Batch	Prepared	Analyzed	Method	Notes
% Solids	95.0		%	1	BF10019	09/01/22	09/02/22	Calculation	

Specific Conductance by EPA Method 120.1, Saturated Paste Extraction

Date Sampled: **08/31/22 09:30**

Analyte	Result	Reporting Limit	Units	Dilution	Batch	Prepared	Analyzed	Method	Notes
Specific Conductance (EC)	0.131	0.0100	mmhos/cm	1	BF10055	09/02/22	09/03/22	EPA 120.1	

Physical Parameters by APHA/ASTM/EPA Methods, Saturated Paste Extraction

Date Sampled: **08/31/22 09:30**

Analyte	Result	Reporting Limit	Units	Dilution	Batch	Prepared	Analyzed	Method	Notes
pH	7.72		pH Units	1	BF10054	09/02/22	09/02/22	EPA 9045D	

Summit Scientific

The results in this report apply to the samples analyzed in accordance with the chain of custody document. This analytical report must be reproduced in its entirety.



Eagle Environmental Consulting
8000 W 44th Ave
Wheat Ridge CO, 80033

Project: DCP - Dyer 6" (CR80/CR109)

Project Number: [none]
Project Manager: Chandler Cole

Reported:
09/07/22 15:01

E-SS-02@10'
2208450-03 (Soil)

Summit Scientific

Volatile Organic Compounds by EPA Method 8260B

Date Sampled: **08/31/22 09:55**

Analyte	Result	Reporting	Units	Dilution	Batch	Prepared	Analyzed	Method	Notes
		Limit							
Benzene	ND	0.0020	mg/kg	1	BFH0700	08/31/22	08/31/22	EPA 8260B	
Toluene	ND	0.0050	"	"	"	"	"	"	
Ethylbenzene	ND	0.0050	"	"	"	"	"	"	
Xylenes (total)	ND	0.010	"	"	"	"	"	"	
1,2,4-Trimethylbenzene	ND	0.0050	"	"	"	"	"	"	
1,3,5-Trimethylbenzene	ND	0.0050	"	"	"	"	"	"	
Naphthalene	ND	0.0038	"	"	"	"	"	"	
Gasoline Range Hydrocarbons	ND	0.50	"	"	"	"	"	"	

Date Sampled: **08/31/22 09:55**

Analyte	Result	Reporting	Units	Dilution	Batch	Prepared	Analyzed	Method	Notes
		Limit							
Surrogate: 1,2-Dichloroethane-d4		104 %	50-150		"	"	"	"	
Surrogate: Toluene-d8		94.0 %	50-150		"	"	"	"	
Surrogate: 4-Bromofluorobenzene		91.7 %	50-150		"	"	"	"	

Extractable Petroleum Hydrocarbons by 8015

Date Sampled: **08/31/22 09:55**

Analyte	Result	Reporting	Units	Dilution	Batch	Prepared	Analyzed	Method	Notes
		Limit							
C10-C28 (DRO)	ND	50	mg/kg	1	BFH0701	08/31/22	08/31/22	EPA 8015M	
C28-C36 (ORO)	ND	50	"	"	"	"	"	"	

Date Sampled: **08/31/22 09:55**

Analyte	Result	Reporting	Units	Dilution	Batch	Prepared	Analyzed	Method	Notes
		Limit							
Surrogate: o-Terphenyl		97.7 %	30-150		"	"	"	"	

PAH by EPA Method 8270D SIM

Summit Scientific

The results in this report apply to the samples analyzed in accordance with the chain of custody document. This analytical report must be reproduced in its entirety.



Eagle Environmental Consulting
8000 W 44th Ave
Wheat Ridge CO, 80033

Project: DCP - Dyer 6" (CR80/CR109)

Project Number: [none]
Project Manager: Chandler Cole

Reported:
09/07/22 15:01

E-SS-02@10'
2208450-03 (Soil)

Summit Scientific

PAH by EPA Method 8270D SIM

Date Sampled: **08/31/22 09:55**

Analyte	Result	Reporting Limit	Units	Dilution	Batch	Prepared	Analyzed	Method	Notes
Acenaphthene	ND	0.00500	mg/kg	1	BF10002	09/01/22	09/04/22	EPA 8270D SIM	
Anthracene	ND	0.00500	"	"	"	"	"	"	
Benzo (a) anthracene	ND	0.00500	"	"	"	"	"	"	
Benzo (a) pyrene	ND	0.00500	"	"	"	"	"	"	
Benzo (b) fluoranthene	ND	0.00500	"	"	"	"	"	"	
Benzo (k) fluoranthene	ND	0.00500	"	"	"	"	"	"	
Chrysene	ND	0.00500	"	"	"	"	"	"	
Dibenz (a,h) anthracene	ND	0.00500	"	"	"	"	"	"	
Fluoranthene	ND	0.00500	"	"	"	"	"	"	
Fluorene	ND	0.00500	"	"	"	"	"	"	
Indeno (1,2,3-cd) pyrene	ND	0.00500	"	"	"	"	"	"	
Pyrene	ND	0.00500	"	"	"	"	"	"	
1-Methylnaphthalene	ND	0.00500	"	"	"	"	"	"	
2-Methylnaphthalene	ND	0.00500	"	"	"	"	"	"	

Date Sampled: **08/31/22 09:55**

Analyte	Result	Reporting Limit	Units	Dilution	Batch	Prepared	Analyzed	Method	Notes
Surrogate: 2-Methylnaphthalene-d10		73.2 %	40-150		"	"	"	"	
Surrogate: Fluoranthene-d10		57.5 %	40-150		"	"	"	"	

Total Metals by EPA 6020B Hot Water Soluble Extraction

Date Sampled: **08/31/22 09:55**

Analyte	Result	Reporting Limit	Units	Dilution	Batch	Prepared	Analyzed	Method	Notes
Boron	0.0192	0.0100	mg/L	1	BF10013	09/01/22	09/03/22	EPA 6020B	

Soluble Nutrients by EPA 6020/USDA60 6(2) - Saturated Paste Extraction

Date Sampled: **08/31/22 09:55**

Analyte	Result	Reporting Limit	Units	Dilution	Batch	Prepared	Analyzed	Method	Notes
---------	--------	-----------------	-------	----------	-------	----------	----------	--------	-------

Summit Scientific

The results in this report apply to the samples analyzed in accordance with the chain of custody document. This analytical report must be reproduced in its entirety.



Eagle Environmental Consulting
8000 W 44th Ave
Wheat Ridge CO, 80033

Project: DCP - Dyer 6" (CR80/CR109)

Project Number: [none]
Project Manager: Chandler Cole

Reported:
09/07/22 15:01

E-SS-02@10'
2208450-03 (Soil)

Summit Scientific

Soluble Nutrients by EPA 6020/USDA60 6(2) - Saturated Paste Extraction

Calcium	11.5	0.0526	mg/L dry	1	BF10007	09/01/22	09/03/22	EPA 6020B
Magnesium	2.62	0.0526	"	"	"	"	"	"
Sodium	0.824	0.0526	"	"	"	"	"	"

Calculated Analysis

Date Sampled: **08/31/22 09:55**

Analyte	Result	Reporting Limit	Units	Dilution	Batch	Prepared	Analyzed	Method	Notes
Sodium Adsorption Ratio	0.0570	0.00100	units	1	BF10092	09/06/22	09/06/22	Calculation	

Physical Parameters by APHA/ASTM/EPA Methods

Date Sampled: **08/31/22 09:55**

Analyte	Result	Reporting Limit	Units	Dilution	Batch	Prepared	Analyzed	Method	Notes
% Solids	95.1		%	1	BF10019	09/01/22	09/02/22	Calculation	

Specific Conductance by EPA Method 120.1, Saturated Paste Extraction

Date Sampled: **08/31/22 09:55**

Analyte	Result	Reporting Limit	Units	Dilution	Batch	Prepared	Analyzed	Method	Notes
Specific Conductance (EC)	0.111	0.0100	mmhos/cm	1	BF10055	09/02/22	09/03/22	EPA 120.1	

Physical Parameters by APHA/ASTM/EPA Methods, Saturated Paste Extraction

Date Sampled: **08/31/22 09:55**

Analyte	Result	Reporting Limit	Units	Dilution	Batch	Prepared	Analyzed	Method	Notes
pH	7.49		pH Units	1	BF10054	09/02/22	09/02/22	EPA 9045D	

Summit Scientific

The results in this report apply to the samples analyzed in accordance with the chain of custody document. This analytical report must be reproduced in its entirety.



Eagle Environmental Consulting
8000 W 44th Ave
Wheat Ridge CO, 80033

Project: DCP - Dyer 6" (CR80/CR109)

Project Number: [none]
Project Manager: Chandler Cole

Reported:
09/07/22 15:01

W-SS-03@11'
2208450-04 (Soil)

Summit Scientific

Volatile Organic Compounds by EPA Method 8260B

Date Sampled: **08/31/22 10:20**

Analyte	Result	Reporting	Units	Dilution	Batch	Prepared	Analyzed	Method	Notes
		Limit							
Benzene	ND	0.0020	mg/kg	1	BFH0700	08/31/22	08/31/22	EPA 8260B	
Toluene	ND	0.0050	"	"	"	"	"	"	
Ethylbenzene	ND	0.0050	"	"	"	"	"	"	
Xylenes (total)	ND	0.010	"	"	"	"	"	"	
1,2,4-Trimethylbenzene	ND	0.0050	"	"	"	"	"	"	
1,3,5-Trimethylbenzene	ND	0.0050	"	"	"	"	"	"	
Naphthalene	ND	0.0038	"	"	"	"	"	"	
Gasoline Range Hydrocarbons	ND	0.50	"	"	"	"	"	"	

Date Sampled: **08/31/22 10:20**

Analyte	Result	Reporting	Units	Dilution	Batch	Prepared	Analyzed	Method	Notes
		Limit							
Surrogate: 1,2-Dichloroethane-d4		114 %	50-150		"	"	"	"	
Surrogate: Toluene-d8		96.3 %	50-150		"	"	"	"	
Surrogate: 4-Bromofluorobenzene		90.4 %	50-150		"	"	"	"	

Extractable Petroleum Hydrocarbons by 8015

Date Sampled: **08/31/22 10:20**

Analyte	Result	Reporting	Units	Dilution	Batch	Prepared	Analyzed	Method	Notes
		Limit							
C10-C28 (DRO)	ND	50	mg/kg	1	BFH0701	08/31/22	08/31/22	EPA 8015M	
C28-C36 (ORO)	ND	50	"	"	"	"	"	"	

Date Sampled: **08/31/22 10:20**

Analyte	Result	Reporting	Units	Dilution	Batch	Prepared	Analyzed	Method	Notes
		Limit							
Surrogate: o-Terphenyl		98.0 %	30-150		"	"	"	"	

PAH by EPA Method 8270D SIM

Summit Scientific

The results in this report apply to the samples analyzed in accordance with the chain of custody document. This analytical report must be reproduced in its entirety.



Eagle Environmental Consulting
8000 W 44th Ave
Wheat Ridge CO, 80033

Project: DCP - Dyer 6" (CR80/CR109)

Project Number: [none]
Project Manager: Chandler Cole

Reported:
09/07/22 15:01

W-SS-03@11'
2208450-04 (Soil)

Summit Scientific

PAH by EPA Method 8270D SIM

Date Sampled: **08/31/22 10:20**

Analyte	Result	Reporting Limit	Units	Dilution	Batch	Prepared	Analyzed	Method	Notes
Acenaphthene	ND	0.00500	mg/kg	1	BF10002	09/01/22	09/04/22	EPA 8270D SIM	
Anthracene	ND	0.00500	"	"	"	"	"	"	
Benzo (a) anthracene	ND	0.00500	"	"	"	"	"	"	
Benzo (a) pyrene	ND	0.00500	"	"	"	"	"	"	
Benzo (b) fluoranthene	ND	0.00500	"	"	"	"	"	"	
Benzo (k) fluoranthene	ND	0.00500	"	"	"	"	"	"	
Chrysene	ND	0.00500	"	"	"	"	"	"	
Dibenz (a,h) anthracene	ND	0.00500	"	"	"	"	"	"	
Fluoranthene	ND	0.00500	"	"	"	"	"	"	
Fluorene	ND	0.00500	"	"	"	"	"	"	
Indeno (1,2,3-cd) pyrene	ND	0.00500	"	"	"	"	"	"	
Pyrene	ND	0.00500	"	"	"	"	"	"	
1-Methylnaphthalene	ND	0.00500	"	"	"	"	"	"	
2-Methylnaphthalene	ND	0.00500	"	"	"	"	"	"	

Date Sampled: **08/31/22 10:20**

Analyte	Result	Reporting Limit	Units	Dilution	Batch	Prepared	Analyzed	Method	Notes
Surrogate: 2-Methylnaphthalene-d10		70.7 %	40-150		"	"	"	"	
Surrogate: Fluoranthene-d10		56.8 %	40-150		"	"	"	"	

Total Metals by EPA 6020B Hot Water Soluble Extraction

Date Sampled: **08/31/22 10:20**

Analyte	Result	Reporting Limit	Units	Dilution	Batch	Prepared	Analyzed	Method	Notes
Boron	0.0181	0.0100	mg/L	1	BF10013	09/01/22	09/03/22	EPA 6020B	

Soluble Nutrients by EPA 6020/USDA60 6(2) - Saturated Paste Extraction

Date Sampled: **08/31/22 10:20**

Analyte	Result	Reporting Limit	Units	Dilution	Batch	Prepared	Analyzed	Method	Notes
---------	--------	-----------------	-------	----------	-------	----------	----------	--------	-------

Summit Scientific

The results in this report apply to the samples analyzed in accordance with the chain of custody document. This analytical report must be reproduced in its entirety.



Eagle Environmental Consulting
8000 W 44th Ave
Wheat Ridge CO, 80033

Project: DCP - Dyer 6" (CR80/CR109)

Project Number: [none]
Project Manager: Chandler Cole

Reported:
09/07/22 15:01

W-SS-03@11'
2208450-04 (Soil)

Summit Scientific

Soluble Nutrients by EPA 6020/USDA60 6(2) - Saturated Paste Extraction

Calcium	19.4	0.0530	mg/L dry	1	BF10007	09/01/22	09/03/22	EPA 6020B
Magnesium	5.27	0.0530	"	"	"	"	"	"
Sodium	1.09	0.0530	"	"	"	"	"	"

Calculated Analysis

Date Sampled: **08/31/22 10:20**

Analyte	Result	Reporting Limit	Units	Dilution	Batch	Prepared	Analyzed	Method	Notes
Sodium Adsorption Ratio	0.0566	0.00100	units	1	BF10092	09/06/22	09/06/22	Calculation	

Physical Parameters by APHA/ASTM/EPA Methods

Date Sampled: **08/31/22 10:20**

Analyte	Result	Reporting Limit	Units	Dilution	Batch	Prepared	Analyzed	Method	Notes
% Solids	94.3		%	1	BF10019	09/01/22	09/02/22	Calculation	

Specific Conductance by EPA Method 120.1, Saturated Paste Extraction

Date Sampled: **08/31/22 10:20**

Analyte	Result	Reporting Limit	Units	Dilution	Batch	Prepared	Analyzed	Method	Notes
Specific Conductance (EC)	0.171	0.0100	mmhos/cm	1	BF10055	09/02/22	09/03/22	EPA 120.1	

Physical Parameters by APHA/ASTM/EPA Methods, Saturated Paste Extraction

Date Sampled: **08/31/22 10:20**

Analyte	Result	Reporting Limit	Units	Dilution	Batch	Prepared	Analyzed	Method	Notes
pH	7.52		pH Units	1	BF10054	09/02/22	09/02/22	EPA 9045D	

Summit Scientific

The results in this report apply to the samples analyzed in accordance with the chain of custody document. This analytical report must be reproduced in its entirety.



Eagle Environmental Consulting
8000 W 44th Ave
Wheat Ridge CO, 80033

Project: DCP - Dyer 6" (CR80/CR109)

Project Number: [none]
Project Manager: Chandler Cole

Reported:
09/07/22 15:01

Volatile Organic Compounds by EPA Method 8260B - Quality Control

Summit Scientific

Analyte	Reporting			Spike	Source		%REC		RPD	
	Result	Limit	Units	Level	Result	%REC	Limits	RPD	Limit	Notes

Batch BFH0700 - EPA 5030 Soil MS

Blank (BFH0700-BLK1)

Prepared & Analyzed: 08/31/22

Benzene	ND	0.0020	mg/kg							
Toluene	ND	0.0050	"							
Ethylbenzene	ND	0.0050	"							
Xylenes (total)	ND	0.010	"							
1,2,4-Trimethylbenzene	ND	0.0050	"							
1,3,5-Trimethylbenzene	ND	0.0050	"							
Naphthalene	ND	0.0038	"							
Gasoline Range Hydrocarbons	ND	0.50	"							
Surrogate: 1,2-Dichloroethane-d4	0.0557		"	0.0400		139	50-150			
Surrogate: Toluene-d8	0.0346		"	0.0400		86.6	50-150			
Surrogate: 4-Bromofluorobenzene	0.0328		"	0.0400		81.9	50-150			

LCS (BFH0700-BS1)

Prepared & Analyzed: 08/31/22

Benzene	0.0823	0.0020	mg/kg	0.0750		110	70-130			
Toluene	0.0628	0.0050	"	0.0750		83.7	70-130			
Ethylbenzene	0.0845	0.0050	"	0.0750		113	70-130			
m,p-Xylene	0.192	0.010	"	0.150		128	70-130			
o-Xylene	0.0748	0.0050	"	0.0750		99.8	70-130			
1,2,4-Trimethylbenzene	0.0760	0.0050	"	0.0750		101	70-130			
1,3,5-Trimethylbenzene	0.0811	0.0050	"	0.0750		108	70-130			
Naphthalene	0.0782	0.0038	"	0.0750		104	70-130			
Surrogate: 1,2-Dichloroethane-d4	0.0561		"	0.0400		140	50-150			
Surrogate: Toluene-d8	0.0350		"	0.0400		87.4	50-150			
Surrogate: 4-Bromofluorobenzene	0.0321		"	0.0400		80.2	50-150			

Matrix Spike (BFH0700-MS1)

Source: 2208449-01

Prepared: 08/31/22 Analyzed: 09/01/22

Benzene	0.0827	0.0020	mg/kg	0.0750	ND	110	70-130			
Toluene	0.0752	0.0050	"	0.0750	ND	100	70-130			
Ethylbenzene	0.0866	0.0050	"	0.0750	ND	115	70-130			
m,p-Xylene	0.192	0.010	"	0.150	ND	128	70-130			
o-Xylene	0.0749	0.0050	"	0.0750	ND	99.9	70-130			
1,2,4-Trimethylbenzene	0.0810	0.0050	"	0.0750	ND	108	70-130			
1,3,5-Trimethylbenzene	0.0866	0.0050	"	0.0750	ND	116	70-130			
Naphthalene	0.0788	0.0038	"	0.0750	ND	105	70-130			
Surrogate: 1,2-Dichloroethane-d4	0.0568		"	0.0400		142	50-150			
Surrogate: Toluene-d8	0.0355		"	0.0400		88.8	50-150			
Surrogate: 4-Bromofluorobenzene	0.0319		"	0.0400		79.7	50-150			

Summit Scientific

The results in this report apply to the samples analyzed in accordance with the chain of custody document. This analytical report must be reproduced in its entirety.



Eagle Environmental Consulting
8000 W 44th Ave
Wheat Ridge CO, 80033

Project: DCP - Dyer 6" (CR80/CR109)

Project Number: [none]
Project Manager: Chandler Cole

Reported:
09/07/22 15:01

Volatile Organic Compounds by EPA Method 8260B - Quality Control

Summit Scientific

Analyte	Reporting			Spike	Source		%REC		RPD	
	Result	Limit	Units	Level	Result	%REC	Limits	RPD	Limit	Notes

Batch BFH0700 - EPA 5030 Soil MS

Matrix Spike Dup (BFH0700-MSD1)	Source: 2208449-01			Prepared: 08/31/22 Analyzed: 09/01/22						
Benzene	0.0810	0.0020	mg/kg	0.0750	ND	108	70-130	2.09	30	
Toluene	0.0808	0.0050	"	0.0750	ND	108	70-130	7.27	30	
Ethylbenzene	0.0869	0.0050	"	0.0750	ND	116	70-130	0.380	30	
m,p-Xylene	0.194	0.010	"	0.150	ND	129	70-130	1.14	30	
o-Xylene	0.0762	0.0050	"	0.0750	ND	102	70-130	1.67	30	
1,2,4-Trimethylbenzene	0.0865	0.0050	"	0.0750	ND	115	70-130	6.59	30	
1,3,5-Trimethylbenzene	0.0883	0.0050	"	0.0750	ND	118	70-130	1.89	30	
Naphthalene	0.0756	0.0038	"	0.0750	ND	101	70-130	4.12	30	
Surrogate: 1,2-Dichloroethane-d4	0.0598		"	0.0400		149	50-150			
Surrogate: Toluene-d8	0.0357		"	0.0400		89.2	50-150			
Surrogate: 4-Bromofluorobenzene	0.0325		"	0.0400		81.3	50-150			

Summit Scientific

The results in this report apply to the samples analyzed in accordance with the chain of custody document. This analytical report must be reproduced in its entirety.



Eagle Environmental Consulting
8000 W 44th Ave
Wheat Ridge CO, 80033

Project: DCP - Dyer 6" (CR80/CR109)

Project Number: [none]
Project Manager: Chandler Cole

Reported:
09/07/22 15:01

Extractable Petroleum Hydrocarbons by 8015 - Quality Control
Summit Scientific

Analyte	Reporting			Spike	Source		%REC		RPD	
	Result	Limit	Units	Level	Result	%REC	Limits	RPD	Limit	Notes

Batch BFH0701 - EPA 3550A

Blank (BFH0701-BLK1)

Prepared: 08/31/22 Analyzed: 09/01/22

C10-C28 (DRO)	ND	50	mg/kg
C28-C36 (ORO)	ND	50	"

LCS (BFH0701-BS1)

Prepared: 08/31/22 Analyzed: 09/01/22

C10-C28 (DRO)	580	50	mg/kg	500	116	70-130
---------------	-----	----	-------	-----	-----	--------

Matrix Spike (BFH0701-MS1)

Source: 2208450-01

Prepared: 08/31/22 Analyzed: 09/01/22

C10-C28 (DRO)	539	50	mg/kg	500	15.6	105	70-130
---------------	-----	----	-------	-----	------	-----	--------

Matrix Spike Dup (BFH0701-MSD1)

Source: 2208450-01

Prepared: 08/31/22 Analyzed: 09/01/22

C10-C28 (DRO)	569	50	mg/kg	500	15.6	111	70-130	5.42	20
---------------	-----	----	-------	-----	------	-----	--------	------	----

Summit Scientific

The results in this report apply to the samples analyzed in accordance with the chain of custody document. This analytical report must be reproduced in its entirety.



Eagle Environmental Consulting
8000 W 44th Ave
Wheat Ridge CO, 80033

Project: DCP - Dyer 6" (CR80/CR109)

Project Number: [none]
Project Manager: Chandler Cole

Reported:
09/07/22 15:01

PAH by EPA Method 8270D SIM - Quality Control

Summit Scientific

Analyte	Reporting			Spike		Source		%REC		RPD	
	Result	Limit	Units	Level		Result		%REC	Limits	RPD	Notes

Batch BFI0002 - EPA 5030 Soil MS

Blank (BFI0002-BLK1)

Prepared: 09/01/22 Analyzed: 09/03/22

Acenaphthene	ND	0.00500	mg/kg								
Anthracene	ND	0.00500	"								
Benzo (a) anthracene	ND	0.00500	"								
Benzo (a) pyrene	ND	0.00500	"								
Benzo (b) fluoranthene	ND	0.00500	"								
Benzo (k) fluoranthene	ND	0.00500	"								
Chrysene	ND	0.00500	"								
Dibenz (a,h) anthracene	ND	0.00500	"								
Fluoranthene	ND	0.00500	"								
Fluorene	ND	0.00500	"								
Indeno (1,2,3-cd) pyrene	ND	0.00500	"								
Pyrene	ND	0.00500	"								
1-Methylnaphthalene	ND	0.00500	"								
2-Methylnaphthalene	ND	0.00500	"								
Surrogate: 2-Methylnaphthalene-d10	0.0354		"	0.0333		106		40-150			
Surrogate: Fluoranthene-d10	0.0323		"	0.0333		96.9		40-150			

LCS (BFI0002-BS1)

Prepared: 09/01/22 Analyzed: 09/03/22

Acenaphthene	0.0382	0.00500	mg/kg	0.0333		115		31-137			
Anthracene	0.0388	0.00500	"	0.0333		117		30-120			
Benzo (a) anthracene	0.0320	0.00500	"	0.0333		96.0		30-120			
Benzo (a) pyrene	0.0384	0.00500	"	0.0333		115		30-120			
Benzo (b) fluoranthene	0.0338	0.00500	"	0.0333		101		30-120			
Benzo (k) fluoranthene	0.0342	0.00500	"	0.0333		102		30-120			
Chrysene	0.0350	0.00500	"	0.0333		105		30-120			
Dibenz (a,h) anthracene	0.0354	0.00500	"	0.0333		106		30-120			
Fluoranthene	0.0351	0.00500	"	0.0333		105		30-120			
Fluorene	0.0373	0.00500	"	0.0333		112		30-120			
Indeno (1,2,3-cd) pyrene	0.0312	0.00500	"	0.0333		93.6		30-120			
Pyrene	0.0356	0.00500	"	0.0333		107		35-142			
1-Methylnaphthalene	0.0374	0.00500	"	0.0333		112		35-142			
2-Methylnaphthalene	0.0261	0.00500	"	0.0333		78.4		35-142			
Surrogate: 2-Methylnaphthalene-d10	0.0375		"	0.0333		112		40-150			
Surrogate: Fluoranthene-d10	0.0341		"	0.0333		102		40-150			

Summit Scientific

The results in this report apply to the samples analyzed in accordance with the chain of custody document. This analytical report must be reproduced in its entirety.



Eagle Environmental Consulting
8000 W 44th Ave
Wheat Ridge CO, 80033

Project: DCP - Dyer 6" (CR80/CR109)

Project Number: [none]
Project Manager: Chandler Cole

Reported:
09/07/22 15:01

PAH by EPA Method 8270D SIM - Quality Control

Summit Scientific

Analyte	Reporting			Spike	Source		%REC		RPD	
	Result	Limit	Units	Level	Result	%REC	Limits	RPD	Limit	Notes

Batch BFI0002 - EPA 5030 Soil MS

Matrix Spike (BFI0002-MS1)

Source: 2208448-01

Prepared: 09/01/22 Analyzed: 09/03/22

Acenaphthene	0.0242	0.00500	mg/kg	0.0333	ND	72.7	31-137			
Anthracene	0.0252	0.00500	"	0.0333	ND	75.6	30-120			
Benzo (a) anthracene	0.0220	0.00500	"	0.0333	ND	66.0	30-120			
Benzo (a) pyrene	0.0252	0.00500	"	0.0333	ND	75.7	30-120			
Benzo (b) fluoranthene	0.0280	0.00500	"	0.0333	ND	84.0	30-120			
Benzo (k) fluoranthene	0.0320	0.00500	"	0.0333	ND	95.9	30-120			
Chrysene	0.0236	0.00500	"	0.0333	ND	70.7	30-120			
Dibenz (a,h) anthracene	0.0229	0.00500	"	0.0333	ND	68.8	30-120			
Fluoranthene	0.0281	0.00500	"	0.0333	ND	84.3	30-120			
Fluorene	0.0241	0.00500	"	0.0333	ND	72.4	30-120			
Indeno (1,2,3-cd) pyrene	0.0202	0.00500	"	0.0333	ND	60.6	30-120			
Pyrene	0.0252	0.00500	"	0.0333	ND	75.7	35-142			
1-Methylnaphthalene	0.0237	0.00500	"	0.0333	ND	71.2	15-130			
2-Methylnaphthalene	0.0246	0.00500	"	0.0333	ND	73.8	15-130			
Surrogate: 2-Methylnaphthalene-d10	0.0241		"	0.0333		72.2	40-150			
Surrogate: Fluoranthene-d10	0.0272		"	0.0333		81.5	40-150			

Matrix Spike Dup (BFI0002-MSD1)

Source: 2208448-01

Prepared: 09/01/22 Analyzed: 09/03/22

Acenaphthene	0.0175	0.00500	mg/kg	0.0333	ND	52.6	31-137	32.1	30	QR-02
Anthracene	0.0199	0.00500	"	0.0333	ND	59.8	30-120	23.3	30	
Benzo (a) anthracene	0.0185	0.00500	"	0.0333	ND	55.6	30-120	17.1	30	
Benzo (a) pyrene	0.0209	0.00500	"	0.0333	ND	62.8	30-120	18.7	30	
Benzo (b) fluoranthene	0.0227	0.00500	"	0.0333	ND	68.1	30-120	20.9	30	
Benzo (k) fluoranthene	0.0258	0.00500	"	0.0333	ND	77.5	30-120	21.3	30	
Chrysene	0.0197	0.00500	"	0.0333	ND	59.2	30-120	17.8	30	
Dibenz (a,h) anthracene	0.0197	0.00500	"	0.0333	ND	59.0	30-120	15.3	30	
Fluoranthene	0.0216	0.00500	"	0.0333	ND	64.8	30-120	26.2	30	
Fluorene	0.0190	0.00500	"	0.0333	ND	57.1	30-120	23.7	30	
Indeno (1,2,3-cd) pyrene	0.0173	0.00500	"	0.0333	ND	51.9	30-120	15.5	30	
Pyrene	0.0200	0.00500	"	0.0333	ND	60.1	35-142	23.1	30	
1-Methylnaphthalene	0.0207	0.00500	"	0.0333	ND	62.1	15-130	13.6	50	
2-Methylnaphthalene	0.0213	0.00500	"	0.0333	ND	63.9	15-130	14.4	50	
Surrogate: 2-Methylnaphthalene-d10	0.0202		"	0.0333		60.5	40-150			
Surrogate: Fluoranthene-d10	0.0213		"	0.0333		63.9	40-150			

Summit Scientific

The results in this report apply to the samples analyzed in accordance with the chain of custody document. This analytical report must be reproduced in its entirety.



Eagle Environmental Consulting
8000 W 44th Ave
Wheat Ridge CO, 80033

Project: DCP - Dyer 6" (CR80/CR109)

Project Number: [none]
Project Manager: Chandler Cole

Reported:
09/07/22 15:01

Total Metals by EPA 6020B Hot Water Soluble Extraction - Quality Control
Summit Scientific

Analyte	Reporting			Spike	Source		%REC		RPD	
	Result	Limit	Units	Level	Result	%REC	Limits	RPD	Limit	Notes

Batch BFI0013 - EPA 3050B

Blank (BFI0013-BLK1)

Prepared: 09/01/22 Analyzed: 09/03/22

Boron ND 0.0100 mg/L

LCS (BFI0013-BS1)

Prepared: 09/01/22 Analyzed: 09/03/22

Boron 4.89 0.0100 mg/L 5.00 97.8 80-120

Duplicate (BFI0013-DUP1)

Source: 2208415-01

Prepared: 09/01/22 Analyzed: 09/03/22

Boron 2.16 0.0100 mg/L 1.91 12.5 20

Matrix Spike (BFI0013-MS1)

Source: 2208415-01

Prepared: 09/01/22 Analyzed: 09/03/22

Boron 6.42 0.0100 mg/L 5.00 1.91 90.2 75-125

Matrix Spike Dup (BFI0013-MSD1)

Source: 2208415-01

Prepared: 09/01/22 Analyzed: 09/03/22

Boron 6.31 0.0100 mg/L 5.00 1.91 88.0 75-125 1.72 25

Summit Scientific

The results in this report apply to the samples analyzed in accordance with the chain of custody document. This analytical report must be reproduced in its entirety.



Eagle Environmental Consulting
8000 W 44th Ave
Wheat Ridge CO, 80033

Project: DCP - Dyer 6" (CR80/CR109)

Project Number: [none]
Project Manager: Chandler Cole

Reported:
09/07/22 15:01

Total Metals by EPA 6020B - Quality Control

Summit Scientific

Analyte	Reporting			Spike Level	Source		%REC		RPD	
	Result	Limit	Units		Result	%REC	Limits	RPD	Limit	Notes

Batch BFH0706 - EPA 3050B

Blank (BFH0706-BLK1)

Prepared: 08/31/22 Analyzed: 09/01/22

Arsenic	ND	0.200	mg/kg wet
Barium	ND	0.400	"
Cadmium	ND	0.200	"
Copper	ND	0.400	"
Lead	ND	0.200	"
Nickel	ND	0.400	"
Selenium	ND	0.260	"
Silver	ND	0.0200	"
Zinc	ND	0.400	"

LCS (BFH0706-BS1)

Prepared: 08/31/22 Analyzed: 09/01/22

Arsenic	42.1	0.200	mg/kg wet	40.0	105	80-120
Barium	40.9	0.400	"	40.0	102	80-120
Cadmium	2.05	0.200	"	2.00	102	80-120
Copper	40.5	0.400	"	40.0	101	80-120
Lead	18.9	0.200	"	20.0	94.5	80-120
Nickel	40.1	0.400	"	40.0	100	80-120
Selenium	3.98	0.260	"	4.00	99.4	80-120
Silver	2.01	0.0200	"	2.00	100	80-120
Zinc	42.5	0.400	"	40.0	106	80-120

Duplicate (BFH0706-DUP1)

Source: 2208358-23

Prepared: 08/31/22 Analyzed: 09/02/22

Arsenic	4.38	0.231	mg/kg dry	4.43	1.13	20
Barium	52.1	0.462	"	51.7	0.643	20
Cadmium	0.165	0.231	"	0.164	1.14	20
Copper	7.01	0.462	"	6.94	0.932	20
Lead	7.08	0.231	"	6.98	1.55	20
Nickel	6.27	0.462	"	6.07	3.13	20
Selenium	0.548	0.300	"	0.502	8.81	20
Silver	0.0260	0.0231	"	0.0283	8.72	20
Zinc	28.3	0.462	"	27.9	1.66	20

Summit Scientific

The results in this report apply to the samples analyzed in accordance with the chain of custody document. This analytical report must be reproduced in its entirety.



Eagle Environmental Consulting
8000 W 44th Ave
Wheat Ridge CO, 80033

Project: DCP - Dyer 6" (CR80/CR109)
Project Number: [none]
Project Manager: Chandler Cole

Reported:
09/07/22 15:01

Total Metals by EPA 6020B - Quality Control
Summit Scientific

Analyte	Reporting			Spike	Source		%REC		RPD	
	Result	Limit	Units	Level	Result	%REC	Limits	RPD	Limit	Notes

Batch BFH0706 - EPA 3050B

Matrix Spike (BFH0706-MS1)		Source: 2208358-23			Prepared: 08/31/22 Analyzed: 09/02/22					
Arsenic	54.1	0.231	mg/kg dry	46.2	4.43	108	75-125			
Barium	105	0.462	"	46.2	51.7	115	75-125			
Cadmium	2.61	0.231	"	2.31	0.164	106	75-125			
Copper	54.2	0.462	"	46.2	6.94	102	75-125			
Lead	30.3	0.231	"	23.1	6.98	101	75-125			
Nickel	54.0	0.462	"	46.2	6.07	104	75-125			
Selenium	4.96	0.300	"	4.62	0.502	96.6	75-125			
Silver	2.40	0.0231	"	2.31	0.0283	103	75-125			
Zinc	82.2	0.462	"	46.2	27.9	118	75-125			

Matrix Spike Dup (BFH0706-MSD1)		Source: 2208358-23			Prepared: 08/31/22 Analyzed: 09/02/22					
Arsenic	54.7	0.231	mg/kg dry	46.2	4.43	109	75-125	0.954	25	
Barium	106	0.462	"	46.2	51.7	117	75-125	0.789	25	
Cadmium	2.66	0.231	"	2.31	0.164	108	75-125	1.76	25	
Copper	54.6	0.462	"	46.2	6.94	103	75-125	0.735	25	
Lead	30.8	0.231	"	23.1	6.98	103	75-125	1.90	25	
Nickel	54.3	0.462	"	46.2	6.07	104	75-125	0.437	25	
Selenium	5.25	0.300	"	4.62	0.502	103	75-125	5.61	25	
Silver	2.44	0.0231	"	2.31	0.0283	105	75-125	1.83	25	
Zinc	82.3	0.462	"	46.2	27.9	118	75-125	0.165	25	

Summit Scientific

The results in this report apply to the samples analyzed in accordance with the chain of custody document. This analytical report must be reproduced in its entirety.



Eagle Environmental Consulting
8000 W 44th Ave
Wheat Ridge CO, 80033

Project: DCP - Dyer 6" (CR80/CR109)

Project Number: [none]
Project Manager: Chandler Cole

Reported:
09/07/22 15:01

Hexavalent Chromium by EPA Method 7196 - Quality Control
Summit Scientific

Analyte	Reporting			Spike	Source		%REC		RPD	
	Result	Limit	Units	Level	Result	%REC	Limits	RPD	Limit	Notes

Batch BFI0011 - 3060A Mod

Blank (BFI0011-BLK1)

Prepared: 09/01/22 Analyzed: 09/02/22

Chromium, Hexavalent ND 0.30 mg/kg wet

LCS (BFI0011-BS1)

Prepared: 09/01/22 Analyzed: 09/02/22

Chromium, Hexavalent 24.4 0.30 mg/kg wet 25.0 97.8 80-120

Duplicate (BFI0011-DUP1)

Source: 2208355-02

Prepared: 09/01/22 Analyzed: 09/02/22

Chromium, Hexavalent ND 0.30 mg/kg dry ND 20

Matrix Spike (BFI0011-MS1)

Source: 2208355-02

Prepared: 09/01/22 Analyzed: 09/02/22

Chromium, Hexavalent 31.1 0.30 mg/kg dry 29.3 ND 106 75-125

Matrix Spike Dup (BFI0011-MSD1)

Source: 2208355-02

Prepared: 09/01/22 Analyzed: 09/02/22

Chromium, Hexavalent 29.9 0.30 mg/kg dry 29.3 ND 102 75-125 3.84 20

Summit Scientific

The results in this report apply to the samples analyzed in accordance with the chain of custody document. This analytical report must be reproduced in its entirety.



Eagle Environmental Consulting
8000 W 44th Ave
Wheat Ridge CO, 80033

Project: DCP - Dyer 6" (CR80/CR109)

Project Number: [none]
Project Manager: Chandler Cole

Reported:
09/07/22 15:01

Soluble Nutrients by EPA 6020/USDA60 6(2) - Saturated Paste Extraction - Quality Control

Summit Scientific

Analyte	Reporting			Spike	Source		%REC		RPD	
	Result	Limit	Units	Level	Result	%REC	Limits	RPD	Limit	Notes

Batch BFI0007 - General Preparation

Blank (BFI0007-BLK1)

Prepared: 09/01/22 Analyzed: 09/03/22

Calcium	ND	0.0500	mg/L wet
Magnesium	ND	0.0500	"
Sodium	ND	0.0500	"

LCS (BFI0007-BS1)

Prepared: 09/01/22 Analyzed: 09/03/22

Calcium	5.44	0.0500	mg/L wet	5.00	109	70-130
Magnesium	5.47	0.0500	"	5.00	109	70-130
Sodium	5.55	0.0500	"	5.00	111	70-130

Summit Scientific

The results in this report apply to the samples analyzed in accordance with the chain of custody document. This analytical report must be reproduced in its entirety.



Eagle Environmental Consulting
8000 W 44th Ave
Wheat Ridge CO, 80033

Project: DCP - Dyer 6" (CR80/CR109)

Project Number: [none]
Project Manager: Chandler Cole

Reported:
09/07/22 15:01

Physical Parameters by APHA/ASTM/EPA Methods - Quality Control

Summit Scientific

Analyte	Result	Reporting		Spike Level	Source		%REC		RPD	
		Limit	Units		Result	%REC	Limits	RPD	Limit	Notes

Batch BFI0019 - General Preparation

Duplicate (BFI0019-DUP1)		Source: 2208450-01		Prepared: 09/01/22 Analyzed: 09/02/22	
% Solids	95.5		%	94.9	0.652 20

Summit Scientific

The results in this report apply to the samples analyzed in accordance with the chain of custody document. This analytical report must be reproduced in its entirety.



Eagle Environmental Consulting
8000 W 44th Ave
Wheat Ridge CO, 80033

Project: DCP - Dyer 6" (CR80/CR109)

Project Number: [none]
Project Manager: Chandler Cole

Reported:
09/07/22 15:01

Specific Conductance by EPA Method 120.1, Saturated Paste Extraction - Quality Control

Summit Scientific

Analyte	Result	Reporting		Spike Level	Source		%REC		RPD	
		Limit	Units		Result	%REC	Limits	RPD	Limit	Notes

Batch BF10055 - General Preparation

Blank (BF10055-BLK1)

Prepared: 09/02/22 Analyzed: 09/03/22

Specific Conductance (EC) ND 0.0100 mmhos/cm

LCS (BF10055-BS1)

Prepared: 09/02/22 Analyzed: 09/03/22

Specific Conductance (EC) 0.154 0.0100 mmhos/cm 0.150 102 95-105

Duplicate (BF10055-DUP1)

Source: 2208247-02

Prepared: 09/02/22 Analyzed: 09/03/22

Specific Conductance (EC) 0.439 0.0100 mmhos/cm 0.442 0.636 20

Summit Scientific

The results in this report apply to the samples analyzed in accordance with the chain of custody document. This analytical report must be reproduced in its entirety.



Eagle Environmental Consulting
8000 W 44th Ave
Wheat Ridge CO, 80033

Project: DCP - Dyer 6" (CR80/CR109)

Project Number: [none]
Project Manager: Chandler Cole

Reported:
09/07/22 15:01

Physical Parameters by APHA/ASTM/EPA Methods, Saturated Paste Extraction - Quality Control

Summit Scientific

Analyte	Result	Reporting		Spike Level	Source		%REC		RPD	
		Limit	Units		Result	%REC	Limits	RPD	Limit	Notes

Batch BFI0054 - General Preparation

LCS (BFI0054-BS1)

Prepared & Analyzed: 09/02/22

pH	9.07	pH Units	9.18	98.8	95-105
----	------	----------	------	------	--------

Duplicate (BFI0054-DUP1)

Source: 2208247-02

Prepared & Analyzed: 09/02/22

pH	7.41	pH Units	7.41	0.00	20
----	------	----------	------	------	----

Summit Scientific

The results in this report apply to the samples analyzed in accordance with the chain of custody document. This analytical report must be reproduced in its entirety.



Eagle Environmental Consulting
8000 W 44th Ave
Wheat Ridge CO, 80033

Project: DCP - Dyer 6" (CR80/CR109)

Project Number: [none]
Project Manager: Chandler Cole

Reported:
09/07/22 15:01

Notes and Definitions

QR-02	The RPD result exceeded the QC control limits; however, both percent recoveries were acceptable. Sample results for the QC batch were accepted based on percent recoveries and completeness of QC data.
DET	Analyte DETECTED
ND	Analyte NOT DETECTED at or above the reporting limit
NR	Not Reported
dry	Sample results reported on a dry weight basis
RPD	Relative Percent Difference

Summit Scientific

4653 Table Mountain Drive, Golden, Colorado 80403

303.277.9310

September 09, 2022

Chandler Cole

Eagle Environmental Consulting

8000 W 44th Ave

Wheat Ridge, CO 80033

RE: DCP - Dyer 6" (CR80/CR109)

Work Order #2209084

Enclosed are the results of analyses for samples received by Summit Scientific on 09/06/22 12:40. If you have any questions concerning this report, please feel free to contact me.

Sincerely,



Mikayla Axtell For Paul Shrewsbury
President



Eagle Environmental Consulting
8000 W 44th Ave
Wheat Ridge CO, 80033

Project: DCP - Dyer 6" (CR80/CR109)

Project Number: [none]
Project Manager: Chandler Cole

Reported:
09/09/22 11:32

ANALYTICAL REPORT FOR SAMPLES

Sample ID	Laboratory ID	Matrix	Date Sampled	Date Received
FL-SS-01@13'	2209084-01	Soil	09/06/22 08:55	09/06/22 12:40
SW-SS-01@10'	2209084-02	Soil	09/06/22 09:20	09/06/22 12:40
SE-SS-01@10'	2209084-03	Soil	09/06/22 10:05	09/06/22 12:40

Summit Scientific

The results in this report apply to the samples analyzed in accordance with the chain of custody document. This analytical report must be reproduced in its entirety.

2209084

303-277-9310

Page of

Project Manager: Chandler Cole/David Castro

E-Mail: cecile@depmidstream.com; dcastro@eagle-enviro.com

swweather5@dcpmidstream.com; dcloccia@eagle-enviro.com

Project Name: Dyer 6" (CR80/CR109)

Project Number:

www.s2scientific.com

S₂

2209084

Sample Receipt Checklist

S2 Work Order# _____

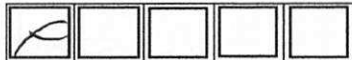
Client: DLP/Eagle Enviro Client Project ID: Dye Dyer 6" (CR80/CR109)Shipped Via: H.D./P.U./FedEx/UPS/USPS/Other ☐ Airbill #: _____Matrix (Check all that apply) Air ☐ Soil/Solid ☒ Water ☐ Other ☐Temp (°C) 7.1Thermometer # 2

	Yes	No	N/A	Comments (if any)
If samples require cooling, is the temperature < 6°C? ⁽¹⁾ NOTE: If samples are delivered the same day of sampling, this requirement is met if there is evidence that cooling has begun.	<input checked="" type="checkbox"/>	<input type="checkbox"/>	<input type="checkbox"/>	<i>n/a</i>
If custody seals are present, are they intact? ⁽¹⁾	<input type="checkbox"/>	<input type="checkbox"/>	<input checked="" type="checkbox"/>	
Are samples due within 48 hours present?	<input checked="" type="checkbox"/>	<input type="checkbox"/>	<input type="checkbox"/>	<i>same day</i>
Are water samples with short hold times present? Note the short hold analysis in the comments column - pH, Nitrate/Nitrite, Ferrous Iron (Fe ²⁺), Hexavalent Chromium (Cr ⁶⁺ , Cr VI), COD/BOD, Total Coliform, E. Coli, Total Residual Chlorine (TRC), Dissolved Oxygen	<input type="checkbox"/>	<input type="checkbox"/>	<input checked="" type="checkbox"/>	
Is a chain-of-custody (COC) form present and filled out Completely? ⁽¹⁾	<input checked="" type="checkbox"/>	<input type="checkbox"/>	<input type="checkbox"/>	
Is the COC properly relinquished by the client w/ date and time recorded? ⁽¹⁾	<input checked="" type="checkbox"/>	<input type="checkbox"/>	<input type="checkbox"/>	
Were all samples received intact? ⁽¹⁾	<input checked="" type="checkbox"/>	<input type="checkbox"/>	<input type="checkbox"/>	
Was adequate sample volume provided? ⁽¹⁾	<input checked="" type="checkbox"/>	<input type="checkbox"/>	<input type="checkbox"/>	
Does the COC agree with the number and type of sample bottles received? ⁽¹⁾	<input checked="" type="checkbox"/>	<input type="checkbox"/>	<input type="checkbox"/>	
Do the sample IDs on the bottle labels match the COC? ⁽¹⁾	<input checked="" type="checkbox"/>	<input type="checkbox"/>	<input type="checkbox"/>	
For volatiles in water – is there headspace present? If yes, contact client and note in narrative.	<input type="checkbox"/>	<input type="checkbox"/>	<input checked="" type="checkbox"/>	
Are samples preserved that require preservation (excluding cooling)? ⁽¹⁾ Note the type of preservative in the comments column – HCl, H ₂ SO ₄ , NaOH, HNO ₃ , etc.	<input type="checkbox"/>	<input type="checkbox"/>	<input checked="" type="checkbox"/>	
If samples are acid preserved for metals, is the pH ≤ 2? ⁽¹⁾ Record the pH in Comments.	<input type="checkbox"/>	<input type="checkbox"/>	<input checked="" type="checkbox"/>	
If dissolved metals are requested, were samples field filtered?	<input type="checkbox"/>	<input type="checkbox"/>	<input checked="" type="checkbox"/>	

Additional Comments (if any):

⁽¹⁾ If NO, then contact the client before proceeding with analysis and note in case narrative.
AT
Custodian Printed Name

9.6.22
Date/Time



Eagle Environmental Consulting
8000 W 44th Ave
Wheat Ridge CO, 80033

Project: DCP - Dyer 6" (CR80/CR109)

Project Number: [none]
Project Manager: Chandler Cole

Reported:
09/09/22 11:32

FL-SS-01@13'
2209084-01 (Soil)

Summit Scientific

Volatile Organic Compounds by EPA Method 8260B

Date Sampled: **09/06/22 08:55**

Analyte	Result	Reporting Limit	Units	Dilution	Batch	Prepared	Analyzed	Method	Notes
Benzene	ND	0.0020	mg/kg	1	BF10121	09/06/22	09/06/22	EPA 8260B	
Toluene	ND	0.0050	"	"	"	"	"	"	
Ethylbenzene	ND	0.0050	"	"	"	"	"	"	
Xylenes (total)	ND	0.010	"	"	"	"	"	"	
1,2,4-Trimethylbenzene	ND	0.0050	"	"	"	"	"	"	
1,3,5-Trimethylbenzene	ND	0.0050	"	"	"	"	"	"	
Naphthalene	ND	0.0038	"	"	"	"	"	"	
Gasoline Range Hydrocarbons	ND	0.50	"	"	"	"	"	"	

Date Sampled: **09/06/22 08:55**

Analyte	Result	Reporting Limit	Units	Dilution	Batch	Prepared	Analyzed	Method	Notes
Surrogate: 1,2-Dichloroethane-d4		100 %	50-150		"	"	"	"	
Surrogate: Toluene-d8		100 %	50-150		"	"	"	"	
Surrogate: 4-Bromofluorobenzene		101 %	50-150		"	"	"	"	

Extractable Petroleum Hydrocarbons by 8015

Date Sampled: **09/06/22 08:55**

Analyte	Result	Reporting Limit	Units	Dilution	Batch	Prepared	Analyzed	Method	Notes
C10-C28 (DRO)	ND	50	mg/kg	1	BF10122	09/06/22	09/06/22	EPA 8015M	
C28-C36 (ORO)	ND	50	"	"	"	"	"	"	

Date Sampled: **09/06/22 08:55**

Analyte	Result	Reporting Limit	Units	Dilution	Batch	Prepared	Analyzed	Method	Notes
Surrogate: o-Terphenyl		66.1 %	30-150		"	"	"	"	

PAH by EPA Method 8270D SIM

Summit Scientific

The results in this report apply to the samples analyzed in accordance with the chain of custody document. This analytical report must be reproduced in its entirety.



Eagle Environmental Consulting
8000 W 44th Ave
Wheat Ridge CO, 80033

Project: DCP - Dyer 6" (CR80/CR109)

Project Number: [none]
Project Manager: Chandler Cole

Reported:
09/09/22 11:32

FL-SS-01@13'
2209084-01 (Soil)

Summit Scientific

PAH by EPA Method 8270D SIM

Date Sampled: **09/06/22 08:55**

Analyte	Result	Reporting	Units	Dilution	Batch	Prepared	Analyzed	Method	Notes
		Limit							
Acenaphthene	ND	0.00500	mg/kg	1	BF10124	09/07/22	09/07/22	EPA 8270D SIM	
Anthracene	ND	0.00500	"	"	"	"	"	"	
Benzo (a) anthracene	ND	0.00500	"	"	"	"	"	"	
Benzo (a) pyrene	ND	0.00500	"	"	"	"	"	"	
Benzo (b) fluoranthene	ND	0.00500	"	"	"	"	"	"	
Benzo (k) fluoranthene	ND	0.00500	"	"	"	"	"	"	
Chrysene	ND	0.00500	"	"	"	"	"	"	
Dibenz (a,h) anthracene	ND	0.00500	"	"	"	"	"	"	
Fluoranthene	ND	0.00500	"	"	"	"	"	"	
Fluorene	ND	0.00500	"	"	"	"	"	"	
Indeno (1,2,3-cd) pyrene	ND	0.00500	"	"	"	"	"	"	
Pyrene	ND	0.00500	"	"	"	"	"	"	
1-Methylnaphthalene	ND	0.00500	"	"	"	"	"	"	
2-Methylnaphthalene	ND	0.00500	"	"	"	"	"	"	

Date Sampled: **09/06/22 08:55**

Analyte	Result	Reporting	Units	Dilution	Batch	Prepared	Analyzed	Method	Notes
		Limit							
Surrogate: 2-Methylnaphthalene-d10		78.2 %	40-150		"	"	"	"	
Surrogate: Fluoranthene-d10		64.6 %	40-150		"	"	"	"	

Summit Scientific

The results in this report apply to the samples analyzed in accordance with the chain of custody document. This analytical report must be reproduced in its entirety.



Eagle Environmental Consulting
8000 W 44th Ave
Wheat Ridge CO, 80033

Project: DCP - Dyer 6" (CR80/CR109)

Project Number: [none]
Project Manager: Chandler Cole

Reported:
09/09/22 11:32

SW-SS-01@10'
2209084-02 (Soil)

Summit Scientific

Volatile Organic Compounds by EPA Method 8260B

Date Sampled: **09/06/22 09:20**

Analyte	Result	Reporting	Units	Dilution	Batch	Prepared	Analyzed	Method	Notes
		Limit							
Benzene	ND	0.0020	mg/kg	1	BF10121	09/06/22	09/06/22	EPA 8260B	
Toluene	ND	0.0050	"	"	"	"	"	"	
Ethylbenzene	ND	0.0050	"	"	"	"	"	"	
Xylenes (total)	ND	0.010	"	"	"	"	"	"	
1,2,4-Trimethylbenzene	ND	0.0050	"	"	"	"	"	"	
1,3,5-Trimethylbenzene	ND	0.0050	"	"	"	"	"	"	
Naphthalene	ND	0.0038	"	"	"	"	"	"	
Gasoline Range Hydrocarbons	ND	0.50	"	"	"	"	"	"	

Date Sampled: **09/06/22 09:20**

Analyte	Result	Reporting	Units	Dilution	Batch	Prepared	Analyzed	Method	Notes
		Limit							
Surrogate: 1,2-Dichloroethane-d4		102 %	50-150		"	"	"	"	
Surrogate: Toluene-d8		98.8 %	50-150		"	"	"	"	
Surrogate: 4-Bromofluorobenzene		101 %	50-150		"	"	"	"	

Extractable Petroleum Hydrocarbons by 8015

Date Sampled: **09/06/22 09:20**

Analyte	Result	Reporting	Units	Dilution	Batch	Prepared	Analyzed	Method	Notes
		Limit							
C10-C28 (DRO)	ND	50	mg/kg	1	BF10122	09/06/22	09/06/22	EPA 8015M	
C28-C36 (ORO)	ND	50	"	"	"	"	"	"	

Date Sampled: **09/06/22 09:20**

Analyte	Result	Reporting	Units	Dilution	Batch	Prepared	Analyzed	Method	Notes
		Limit							
Surrogate: o-Terphenyl		55.9 %	30-150		"	"	"	"	

PAH by EPA Method 8270D SIM

Summit Scientific

The results in this report apply to the samples analyzed in accordance with the chain of custody document. This analytical report must be reproduced in its entirety.



Eagle Environmental Consulting
8000 W 44th Ave
Wheat Ridge CO, 80033

Project: DCP - Dyer 6" (CR80/CR109)

Project Number: [none]
Project Manager: Chandler Cole

Reported:
09/09/22 11:32

SW-SS-01@10'
2209084-02 (Soil)

Summit Scientific

PAH by EPA Method 8270D SIM

Date Sampled: **09/06/22 09:20**

Analyte	Result	Reporting	Units	Dilution	Batch	Prepared	Analyzed	Method	Notes
		Limit							
Acenaphthene	ND	0.00500	mg/kg	1	BF10124	09/07/22	09/07/22	EPA 8270D SIM	
Anthracene	ND	0.00500	"	"	"	"	"	"	
Benzo (a) anthracene	ND	0.00500	"	"	"	"	"	"	
Benzo (a) pyrene	ND	0.00500	"	"	"	"	"	"	
Benzo (b) fluoranthene	ND	0.00500	"	"	"	"	"	"	
Benzo (k) fluoranthene	ND	0.00500	"	"	"	"	"	"	
Chrysene	ND	0.00500	"	"	"	"	"	"	
Dibenz (a,h) anthracene	ND	0.00500	"	"	"	"	"	"	
Fluoranthene	ND	0.00500	"	"	"	"	"	"	
Fluorene	ND	0.00500	"	"	"	"	"	"	
Indeno (1,2,3-cd) pyrene	ND	0.00500	"	"	"	"	"	"	
Pyrene	ND	0.00500	"	"	"	"	"	"	
1-Methylnaphthalene	ND	0.00500	"	"	"	"	"	"	
2-Methylnaphthalene	ND	0.00500	"	"	"	"	"	"	

Date Sampled: **09/06/22 09:20**

Analyte	Result	Reporting	Units	Dilution	Batch	Prepared	Analyzed	Method	Notes
		Limit							
Surrogate: 2-Methylnaphthalene-d10		65.6 %	40-150		"	"	"	"	
Surrogate: Fluoranthene-d10		52.2 %	40-150		"	"	"	"	

Summit Scientific

The results in this report apply to the samples analyzed in accordance with the chain of custody document. This analytical report must be reproduced in its entirety.



Eagle Environmental Consulting
8000 W 44th Ave
Wheat Ridge CO, 80033

Project: DCP - Dyer 6" (CR80/CR109)

Project Number: [none]
Project Manager: Chandler Cole

Reported:
09/09/22 11:32

SE-SS-01@10'
2209084-03 (Soil)

Summit Scientific

Volatile Organic Compounds by EPA Method 8260B

Date Sampled: **09/06/22 10:05**

Analyte	Result	Reporting	Units	Dilution	Batch	Prepared	Analyzed	Method	Notes
		Limit							
Benzene	ND	0.0020	mg/kg	1	BF10121	09/06/22	09/06/22	EPA 8260B	
Toluene	ND	0.0050	"	"	"	"	"	"	
Ethylbenzene	ND	0.0050	"	"	"	"	"	"	
Xylenes (total)	ND	0.010	"	"	"	"	"	"	
1,2,4-Trimethylbenzene	ND	0.0050	"	"	"	"	"	"	
1,3,5-Trimethylbenzene	ND	0.0050	"	"	"	"	"	"	
Naphthalene	ND	0.0038	"	"	"	"	"	"	
Gasoline Range Hydrocarbons	ND	0.50	"	"	"	"	"	"	

Date Sampled: **09/06/22 10:05**

Analyte	Result	Reporting	Units	Dilution	Batch	Prepared	Analyzed	Method	Notes
		Limit							
Surrogate: 1,2-Dichloroethane-d4		106 %	50-150		"	"	"	"	
Surrogate: Toluene-d8		100 %	50-150		"	"	"	"	
Surrogate: 4-Bromofluorobenzene		102 %	50-150		"	"	"	"	

Extractable Petroleum Hydrocarbons by 8015

Date Sampled: **09/06/22 10:05**

Analyte	Result	Reporting	Units	Dilution	Batch	Prepared	Analyzed	Method	Notes
		Limit							
C10-C28 (DRO)	ND	50	mg/kg	1	BF10122	09/06/22	09/06/22	EPA 8015M	
C28-C36 (ORO)	ND	50	"	"	"	"	"	"	

Date Sampled: **09/06/22 10:05**

Analyte	Result	Reporting	Units	Dilution	Batch	Prepared	Analyzed	Method	Notes
		Limit							
Surrogate: o-Terphenyl		62.2 %	30-150		"	"	"	"	

PAH by EPA Method 8270D SIM

Summit Scientific

The results in this report apply to the samples analyzed in accordance with the chain of custody document. This analytical report must be reproduced in its entirety.



Eagle Environmental Consulting
8000 W 44th Ave
Wheat Ridge CO, 80033

Project: DCP - Dyer 6" (CR80/CR109)

Project Number: [none]
Project Manager: Chandler Cole

Reported:
09/09/22 11:32

SE-SS-01@10'
2209084-03 (Soil)

Summit Scientific

PAH by EPA Method 8270D SIM

Date Sampled: **09/06/22 10:05**

Analyte	Result	Reporting	Units	Dilution	Batch	Prepared	Analyzed	Method	Notes
		Limit							
Acenaphthene	ND	0.00500	mg/kg	1	BF10124	09/07/22	09/07/22	EPA 8270D SIM	
Anthracene	ND	0.00500	"	"	"	"	"	"	
Benzo (a) anthracene	ND	0.00500	"	"	"	"	"	"	
Benzo (a) pyrene	ND	0.00500	"	"	"	"	"	"	
Benzo (b) fluoranthene	ND	0.00500	"	"	"	"	"	"	
Benzo (k) fluoranthene	ND	0.00500	"	"	"	"	"	"	
Chrysene	ND	0.00500	"	"	"	"	"	"	
Dibenz (a,h) anthracene	ND	0.00500	"	"	"	"	"	"	
Fluoranthene	ND	0.00500	"	"	"	"	"	"	
Fluorene	ND	0.00500	"	"	"	"	"	"	
Indeno (1,2,3-cd) pyrene	ND	0.00500	"	"	"	"	"	"	
Pyrene	ND	0.00500	"	"	"	"	"	"	
1-Methylnaphthalene	ND	0.00500	"	"	"	"	"	"	
2-Methylnaphthalene	ND	0.00500	"	"	"	"	"	"	

Date Sampled: **09/06/22 10:05**

Analyte	Result	Reporting	Units	Dilution	Batch	Prepared	Analyzed	Method	Notes
		Limit							
Surrogate: 2-Methylnaphthalene-d10		62.9 %	40-150		"	"	"	"	
Surrogate: Fluoranthene-d10		47.9 %	40-150		"	"	"	"	

Summit Scientific

The results in this report apply to the samples analyzed in accordance with the chain of custody document. This analytical report must be reproduced in its entirety.



Eagle Environmental Consulting
8000 W 44th Ave
Wheat Ridge CO, 80033

Project: DCP - Dyer 6" (CR80/CR109)

Project Number: [none]
Project Manager: Chandler Cole

Reported:
09/09/22 11:32

Volatile Organic Compounds by EPA Method 8260B - Quality Control

Summit Scientific

Analyte	Reporting			Spike	Source		%REC		RPD	
	Result	Limit	Units	Level	Result	%REC	Limits	RPD	Limit	Notes

Batch BFI0121 - EPA 5030 Soil MS

Blank (BFI0121-BLK1)

Prepared: 09/06/22 Analyzed: 09/07/22

Benzene	ND	0.0020	mg/kg							
Toluene	ND	0.0050	"							
Ethylbenzene	ND	0.0050	"							
Xylenes (total)	ND	0.010	"							
1,2,4-Trimethylbenzene	ND	0.0050	"							
1,3,5-Trimethylbenzene	ND	0.0050	"							
Naphthalene	ND	0.0038	"							
Gasoline Range Hydrocarbons	ND	0.50	"							
Surrogate: 1,2-Dichloroethane-d4	0.0409		"	0.0400		102	50-150			
Surrogate: Toluene-d8	0.0398		"	0.0400		99.4	50-150			
Surrogate: 4-Bromofluorobenzene	0.0410		"	0.0400		102	50-150			

LCS (BFI0121-BS1)

Prepared: 09/06/22 Analyzed: 09/07/22

Benzene	0.161	0.0020	mg/kg	0.150		108	70-130			
Toluene	0.158	0.0050	"	0.150		105	70-130			
Ethylbenzene	0.156	0.0050	"	0.150		104	70-130			
m,p-Xylene	0.318	0.010	"	0.300		106	70-130			
o-Xylene	0.146	0.0050	"	0.150		97.1	70-130			
1,2,4-Trimethylbenzene	0.152	0.0050	"	0.150		101	70-130			
1,3,5-Trimethylbenzene	0.150	0.0050	"	0.150		99.8	70-130			
Naphthalene	0.143	0.0038	"	0.150		95.4	70-130			
Surrogate: 1,2-Dichloroethane-d4	0.0408		"	0.0400		102	50-150			
Surrogate: Toluene-d8	0.0407		"	0.0400		102	50-150			
Surrogate: 4-Bromofluorobenzene	0.0397		"	0.0400		99.2	50-150			

Matrix Spike (BFI0121-MS1)

Source: 2209083-02

Prepared: 09/06/22 Analyzed: 09/07/22

Benzene	0.144	0.0020	mg/kg	0.150	ND	95.7	70-130			
Toluene	0.134	0.0050	"	0.150	ND	89.6	70-130			
Ethylbenzene	0.129	0.0050	"	0.150	ND	86.1	70-130			
m,p-Xylene	0.259	0.010	"	0.300	ND	86.3	70-130			
o-Xylene	0.143	0.0050	"	0.150	ND	95.4	70-130			
1,2,4-Trimethylbenzene	0.140	0.0050	"	0.150	ND	93.2	70-130			
1,3,5-Trimethylbenzene	0.139	0.0050	"	0.150	ND	92.9	70-130			
Naphthalene	0.128	0.0038	"	0.150	ND	85.5	70-130			
Surrogate: 1,2-Dichloroethane-d4	0.0410		"	0.0400		103	50-150			
Surrogate: Toluene-d8	0.0404		"	0.0400		101	50-150			
Surrogate: 4-Bromofluorobenzene	0.0391		"	0.0400		97.7	50-150			

Summit Scientific

The results in this report apply to the samples analyzed in accordance with the chain of custody document. This analytical report must be reproduced in its entirety.



Eagle Environmental Consulting
8000 W 44th Ave
Wheat Ridge CO, 80033

Project: DCP - Dyer 6" (CR80/CR109)

Project Number: [none]
Project Manager: Chandler Cole

Reported:
09/09/22 11:32

Volatile Organic Compounds by EPA Method 8260B - Quality Control

Summit Scientific

Analyte	Reporting			Spike	Source		%REC		RPD	
	Result	Limit	Units	Level	Result	%REC	Limits	RPD	Limit	Notes

Batch BFI0121 - EPA 5030 Soil MS

Matrix Spike Dup (BFI0121-MSD1)		Source: 2209083-02			Prepared: 09/06/22 Analyzed: 09/07/22					
Benzene	0.144	0.0020	mg/kg	0.150	ND	96.2	70-130	0.500	30	
Toluene	0.137	0.0050	"	0.150	ND	91.3	70-130	1.90	30	
Ethylbenzene	0.132	0.0050	"	0.150	ND	87.7	70-130	1.84	30	
m,p-Xylene	0.263	0.010	"	0.300	ND	87.6	70-130	1.54	30	
o-Xylene	0.147	0.0050	"	0.150	ND	97.7	70-130	2.42	30	
1,2,4-Trimethylbenzene	0.144	0.0050	"	0.150	ND	95.7	70-130	2.67	30	
1,3,5-Trimethylbenzene	0.142	0.0050	"	0.150	ND	94.9	70-130	2.07	30	
Naphthalene	0.128	0.0038	"	0.150	ND	85.6	70-130	0.0935	30	
Surrogate: 1,2-Dichloroethane-d4		0.0412	"	0.0400		103	50-150			
Surrogate: Toluene-d8		0.0408	"	0.0400		102	50-150			
Surrogate: 4-Bromofluorobenzene		0.0403	"	0.0400		101	50-150			

Summit Scientific

The results in this report apply to the samples analyzed in accordance with the chain of custody document. This analytical report must be reproduced in its entirety.



Eagle Environmental Consulting
8000 W 44th Ave
Wheat Ridge CO, 80033

Project: DCP - Dyer 6" (CR80/CR109)
Project Number: [none]
Project Manager: Chandler Cole

Reported:
09/09/22 11:32

Extractable Petroleum Hydrocarbons by 8015 - Quality Control
Summit Scientific

Analyte	Result	Reporting		Spike Level	Source		%REC		RPD	
		Limit	Units		Result	%REC	Limits	RPD	Limit	Notes

Batch BFI0122 - EPA 3550A

Blank (BFI0122-BLK1)

Prepared & Analyzed: 09/06/22

C10-C28 (DRO)	ND	50	mg/kg
C28-C36 (ORO)	ND	50	"

LCS (BFI0122-BS1)

Prepared: 09/06/22 Analyzed: 09/07/22

C10-C28 (DRO)	592	50	mg/kg	500	118	70-130
---------------	-----	----	-------	-----	-----	--------

Matrix Spike (BFI0122-MS1)

Source: 2209083-02

Prepared: 09/06/22 Analyzed: 09/07/22

C10-C28 (DRO)	510	50	mg/kg	500	17.5	98.5	70-130
---------------	-----	----	-------	-----	------	------	--------

Matrix Spike Dup (BFI0122-MSD1)

Source: 2209083-02

Prepared: 09/06/22 Analyzed: 09/07/22

C10-C28 (DRO)	487	50	mg/kg	500	17.5	93.8	70-130	4.68	20
---------------	-----	----	-------	-----	------	------	--------	------	----

Summit Scientific

The results in this report apply to the samples analyzed in accordance with the chain of custody document. This analytical report must be reproduced in its entirety.



Eagle Environmental Consulting
8000 W 44th Ave
Wheat Ridge CO, 80033

Project: DCP - Dyer 6" (CR80/CR109)

Project Number: [none]
Project Manager: Chandler Cole

Reported:
09/09/22 11:32

PAH by EPA Method 8270D SIM - Quality Control

Summit Scientific

Reporting				Spike	Source	%REC			RPD	
Analyte	Result	Limit	Units	Level	Result	%REC	Limits	RPD	Limit	Notes

Batch BFI0124 - EPA 5030 Soil MS

Blank (BFI0124-BLK1)

Prepared & Analyzed: 09/07/22

Acenaphthene	ND	0.00500	mg/kg							
Anthracene	ND	0.00500	"							
Benzo (a) anthracene	ND	0.00500	"							
Benzo (a) pyrene	ND	0.00500	"							
Benzo (b) fluoranthene	ND	0.00500	"							
Benzo (k) fluoranthene	ND	0.00500	"							
Chrysene	ND	0.00500	"							
Dibenz (a,h) anthracene	ND	0.00500	"							
Fluoranthene	ND	0.00500	"							
Fluorene	ND	0.00500	"							
Indeno (1,2,3-cd) pyrene	ND	0.00500	"							
Pyrene	ND	0.00500	"							
1-Methylnaphthalene	ND	0.00500	"							
2-Methylnaphthalene	ND	0.00500	"							
Surrogate: 2-Methylnaphthalene-d10	0.0381		"	0.0333		114	40-150			
Surrogate: Fluoranthene-d10	0.0269		"	0.0333		80.6	40-150			

LCS (BFI0124-BS1)

Prepared & Analyzed: 09/07/22

Acenaphthene	0.0345	0.00500	mg/kg	0.0333		103	31-137			
Anthracene	0.0322	0.00500	"	0.0333		96.7	30-120			
Benzo (a) anthracene	0.0256	0.00500	"	0.0333		76.7	30-120			
Benzo (a) pyrene	0.0244	0.00500	"	0.0333		73.3	30-120			
Benzo (b) fluoranthene	0.0291	0.00500	"	0.0333		87.3	30-120			
Benzo (k) fluoranthene	0.0349	0.00500	"	0.0333		105	30-120			
Chrysene	0.0317	0.00500	"	0.0333		95.0	30-120			
Dibenz (a,h) anthracene	0.0292	0.00500	"	0.0333		87.5	30-120			
Fluoranthene	0.0339	0.00500	"	0.0333		102	30-120			
Fluorene	0.0357	0.00500	"	0.0333		107	30-120			
Indeno (1,2,3-cd) pyrene	0.0248	0.00500	"	0.0333		74.4	30-120			
Pyrene	0.0319	0.00500	"	0.0333		95.6	35-142			
1-Methylnaphthalene	0.0308	0.00500	"	0.0333		92.3	35-142			
2-Methylnaphthalene	0.0299	0.00500	"	0.0333		89.6	35-142			
Surrogate: 2-Methylnaphthalene-d10	0.0311		"	0.0333		93.3	40-150			
Surrogate: Fluoranthene-d10	0.0327		"	0.0333		98.2	40-150			

Summit Scientific

The results in this report apply to the samples analyzed in accordance with the chain of custody document. This analytical report must be reproduced in its entirety.



Eagle Environmental Consulting
8000 W 44th Ave
Wheat Ridge CO, 80033

Project: DCP - Dyer 6" (CR80/CR109)

Project Number: [none]
Project Manager: Chandler Cole

Reported:
09/09/22 11:32

PAH by EPA Method 8270D SIM - Quality Control

Summit Scientific

Analyte	Reporting			Spike		Source		%REC		RPD	
	Result	Limit	Units	Level		Result	%REC	Limits	RPD	Limit	Notes

Batch BFI0124 - EPA 5030 Soil MS

Matrix Spike (BFI0124-MS1)

Source: 2209027-01

Prepared & Analyzed: 09/07/22

Acenaphthene	0.0222	0.00500	mg/kg	0.0333	ND	66.6	31-137				
Anthracene	0.0212	0.00500	"	0.0333	ND	63.6	30-120				
Benzo (a) anthracene	0.0185	0.00500	"	0.0333	ND	55.4	30-120				
Benzo (a) pyrene	0.0166	0.00500	"	0.0333	ND	49.7	30-120				
Benzo (b) fluoranthene	0.0193	0.00500	"	0.0333	ND	57.9	30-120				
Benzo (k) fluoranthene	0.0247	0.00500	"	0.0333	ND	74.2	30-120				
Chrysene	0.0206	0.00500	"	0.0333	ND	61.8	30-120				
Dibenz (a,h) anthracene	0.0191	0.00500	"	0.0333	ND	57.2	30-120				
Fluoranthene	0.0226	0.00500	"	0.0333	ND	67.8	30-120				
Fluorene	0.0234	0.00500	"	0.0333	ND	70.2	30-120				
Indeno (1,2,3-cd) pyrene	0.0179	0.00500	"	0.0333	ND	53.7	30-120				
Pyrene	0.0209	0.00500	"	0.0333	ND	62.6	35-142				
1-Methylnaphthalene	0.0198	0.00500	"	0.0333	ND	59.5	15-130				
2-Methylnaphthalene	0.0186	0.00500	"	0.0333	ND	55.7	15-130				
Surrogate: 2-Methylnaphthalene-d10	0.0196		"	0.0333		58.7	40-150				
Surrogate: Fluoranthene-d10	0.0206		"	0.0333		61.8	40-150				

Matrix Spike Dup (BFI0124-MSD1)

Source: 2209027-01

Prepared & Analyzed: 09/07/22

Acenaphthene	0.0213	0.00500	mg/kg	0.0333	ND	64.0	31-137	3.97	30		
Anthracene	0.0195	0.00500	"	0.0333	ND	58.5	30-120	8.23	30		
Benzo (a) anthracene	0.0172	0.00500	"	0.0333	ND	51.7	30-120	6.78	30		
Benzo (a) pyrene	0.0157	0.00500	"	0.0333	ND	47.1	30-120	5.45	30		
Benzo (b) fluoranthene	0.0179	0.00500	"	0.0333	ND	53.7	30-120	7.55	30		
Benzo (k) fluoranthene	0.0229	0.00500	"	0.0333	ND	68.8	30-120	7.42	30		
Chrysene	0.0187	0.00500	"	0.0333	ND	56.0	30-120	9.81	30		
Dibenz (a,h) anthracene	0.0165	0.00500	"	0.0333	ND	49.4	30-120	14.7	30		
Fluoranthene	0.0213	0.00500	"	0.0333	ND	64.0	30-120	5.71	30		
Fluorene	0.0213	0.00500	"	0.0333	ND	63.8	30-120	9.64	30		
Indeno (1,2,3-cd) pyrene	0.0157	0.00500	"	0.0333	ND	47.2	30-120	12.8	30		
Pyrene	0.0193	0.00500	"	0.0333	ND	57.9	35-142	7.72	30		
1-Methylnaphthalene	0.0204	0.00500	"	0.0333	ND	61.3	15-130	2.98	50		
2-Methylnaphthalene	0.0187	0.00500	"	0.0333	ND	56.2	15-130	0.812	50		
Surrogate: 2-Methylnaphthalene-d10	0.0197		"	0.0333		59.0	40-150				
Surrogate: Fluoranthene-d10	0.0200		"	0.0333		60.1	40-150				

Summit Scientific

The results in this report apply to the samples analyzed in accordance with the chain of custody document. This analytical report must be reproduced in its entirety.



Eagle Environmental Consulting
8000 W 44th Ave
Wheat Ridge CO, 80033

Project: DCP - Dyer 6" (CR80/CR109)

Project Number: [none]
Project Manager: Chandler Cole

Reported:
09/09/22 11:32

Notes and Definitions

DET	Analyte DETECTED
ND	Analyte NOT DETECTED at or above the reporting limit
NR	Not Reported
dry	Sample results reported on a dry weight basis
RPD	Relative Percent Difference