

DD29-13 FACILITY, DD29-14 PAD,
DD29-15 PAD, DD28-14 PAD
LOCATION DRAWING

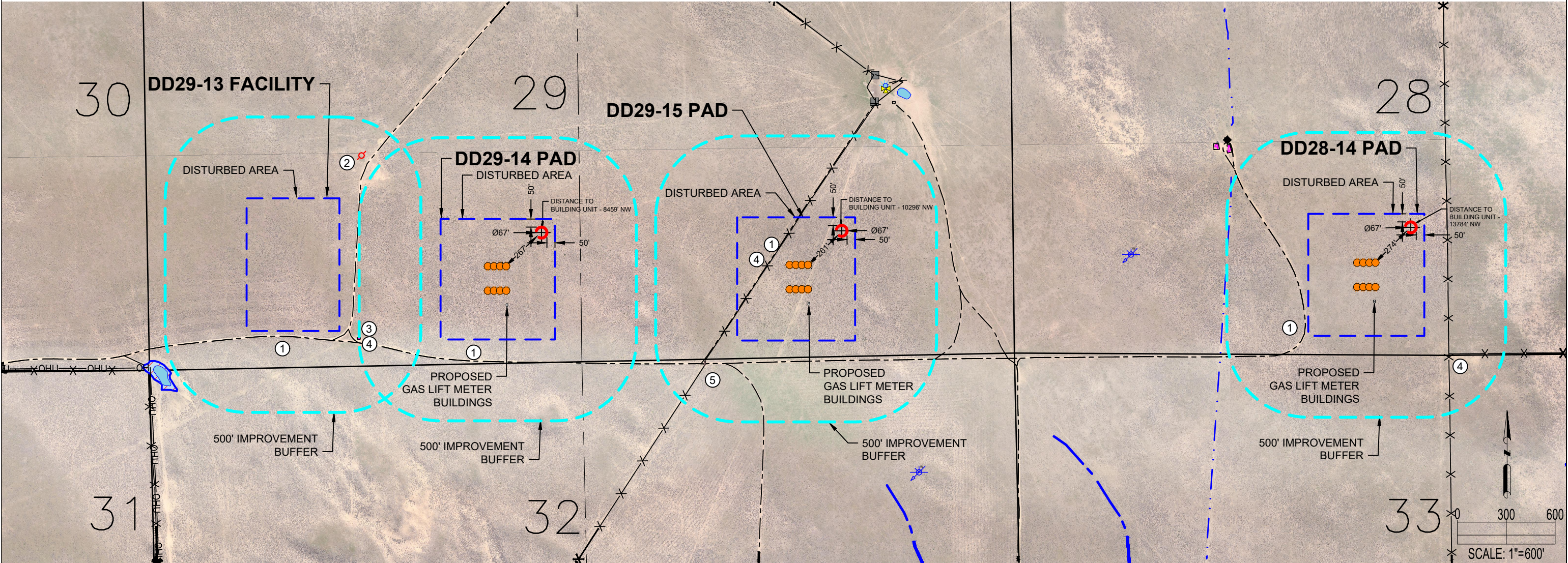

DD29-13 FACILITY

DD29-14 PAD

DD29-15 PAD

DD28-14 PAD

IMPROVEMENTS: (AS MEASURED FROM THE PROPOSED EDGE OF DISTURBANCE)		IMPROVEMENTS: (AS MEASURED FROM THE PROPOSED EDGE OF DISTURBANCE)		IMPROVEMENTS: (AS MEASURED FROM THE PROPOSED EDGE OF DISTURBANCE)		IMPROVEMENTS: (AS MEASURED FROM THE PROPOSED EDGE OF DISTURBANCE)	
1. PRIVATE ROAD:	±31' S, ±33'± SE, ±55' E	1. PRIVATE ROAD:	±116' S	1. PRIVATE ROAD:	0', ±122' S, ±159' SW	1. PRIVATE ROAD:	±18' W
2. OIL/GAS WELL:	±296' NE	2. OIL/GAS WELL:	N/A	2. OIL/GAS WELL:	N/A	2. OIL/GAS WELL:	N/A
3. EXISTING PRODUCTION EQUIPMENT:	±125' SE	3. EXISTING PRODUCTION EQUIPMENT:	±492' W	3. EXISTING PRODUCTION EQUIPMENT:	N/A	3. EXISTING PRODUCTION EQUIPMENT:	N/A
4. FENCE:	±119' SE	4. FENCE:	±496' W	4. FENCE:	0', ±249' SW	4. FENCE:	±140' E, ±187' SE
5. CATTLE GUARD	N/A	5. CATTLE GUARD	N/A	5. CATTLE GUARD	±233' SW	5. CATTLE GUARD	N/A

DISCLAIMER:
THIS PLOT DOES NOT REPRESENT A MONUMENTED LAND SURVEY AND SHOULD NOT BE RELIED UPON TO DETERMINE BOUNDARY LINES, PROPERTY OWNERSHIP OR OTHER PROPERTY INTERESTS. PARCEL LINES, IF DEPICTED HAVE NOT BEEN FIELD VERIFIED AND MAY BE BASED UPON PUBLICLY AVAILABLE DATA THAT ALSO HAS NOT BEEN INDEPENDENTLY VERIFIED.

CURRENT SURFACE USE: RANGELAND
FUTURE SURFACE USE: RANGELAND



8620 Wolff Court
Westminster, CO 80031
(303) 928-7128
www.ascentgeomatics.com

FIELD DATE: 08-02-18	DRAWING DATE: 02-28-19	SITE NAME: DD29-13 FACILITY, DD29-14 PAD, DD29-15 PAD	SITE NAME: DD28-14 PAD
DRAWN BY: JW	CHECKED BY: VQD	SURFACE LOCATION: SEC. 29, T3N, R63W, 6TH P.M. WELD COUNTY, COLORADO	SURFACE LOCATION: SEC. 28, T3N, R63W, 6TH P.M. WELD COUNTY, COLORADO

DATA SOURCE:
AERIAL IMAGERY: NAIP 2017, ASCENT 11/2017
WATER WELLS: COLORADO DWR
NHD: USGS

PUBLICLY AVAILABLE DATA SOURCES HAVE NOT BEEN INDEPENDENTLY VERIFIED BY ASCENT.

LEGEND:

● = PROPOSED WELL	— = SECTION LINE	— = STREAM	— = LOW LYING AREA
⊗ = ABANDONED WELL	- - - = CENTER SECTION LINE	—X—X— = FENCE	— = DISTURBANCE AREA
⊕ = WATER WELL	— = GATE	—OHU— = OVERHEAD UTILITY	— = 500' RADIUS
⊙ = WINDMILL	⊗ = WATER TROUGH	- - - = EXISTING ROAD	— = EXISTING FACILITY
			— = PROPOSED MLVT

