



Form PS-102



RECEIVED

MAY 30 1986

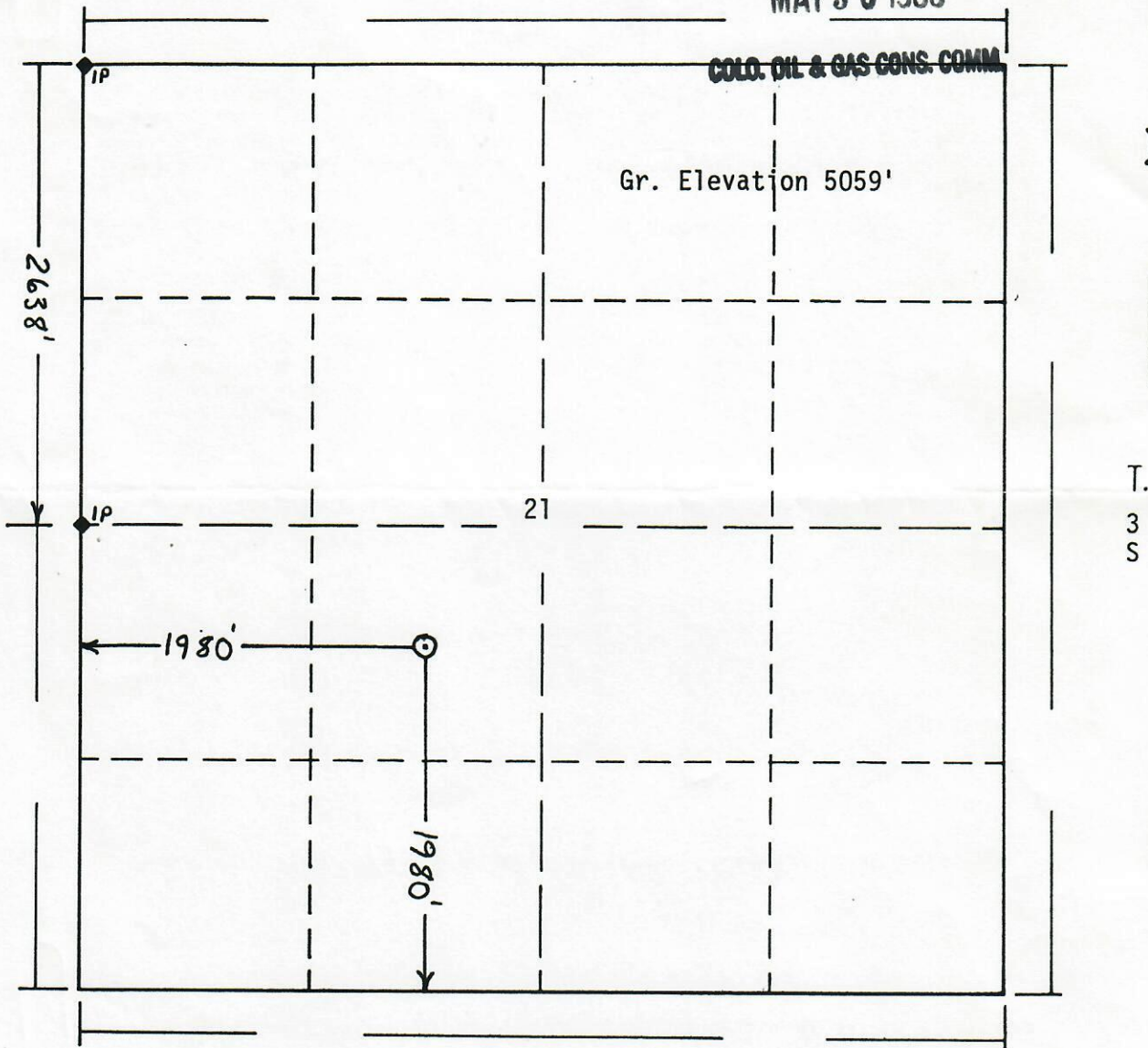

Scale: 1"=1000'

Powers Elevation of Denver, Colorado has in accordance with a request from Mike Asher for E. Doyle Huckabay Ltd. determined the location of 1-21 Linnebur to be 1980fs1, 1980fw1 Section 21 , Township 3 S Range 60 W of the 6th Principal Meridian, Adams County, Colorado

I hereby certify that this plat is an accurate representation of a correct survey showing the location of 1-21 Linnebur

Date: 5-28-86

Calvin Hein
Licensed Land Surveyor No. 23501
State of Colorado

