

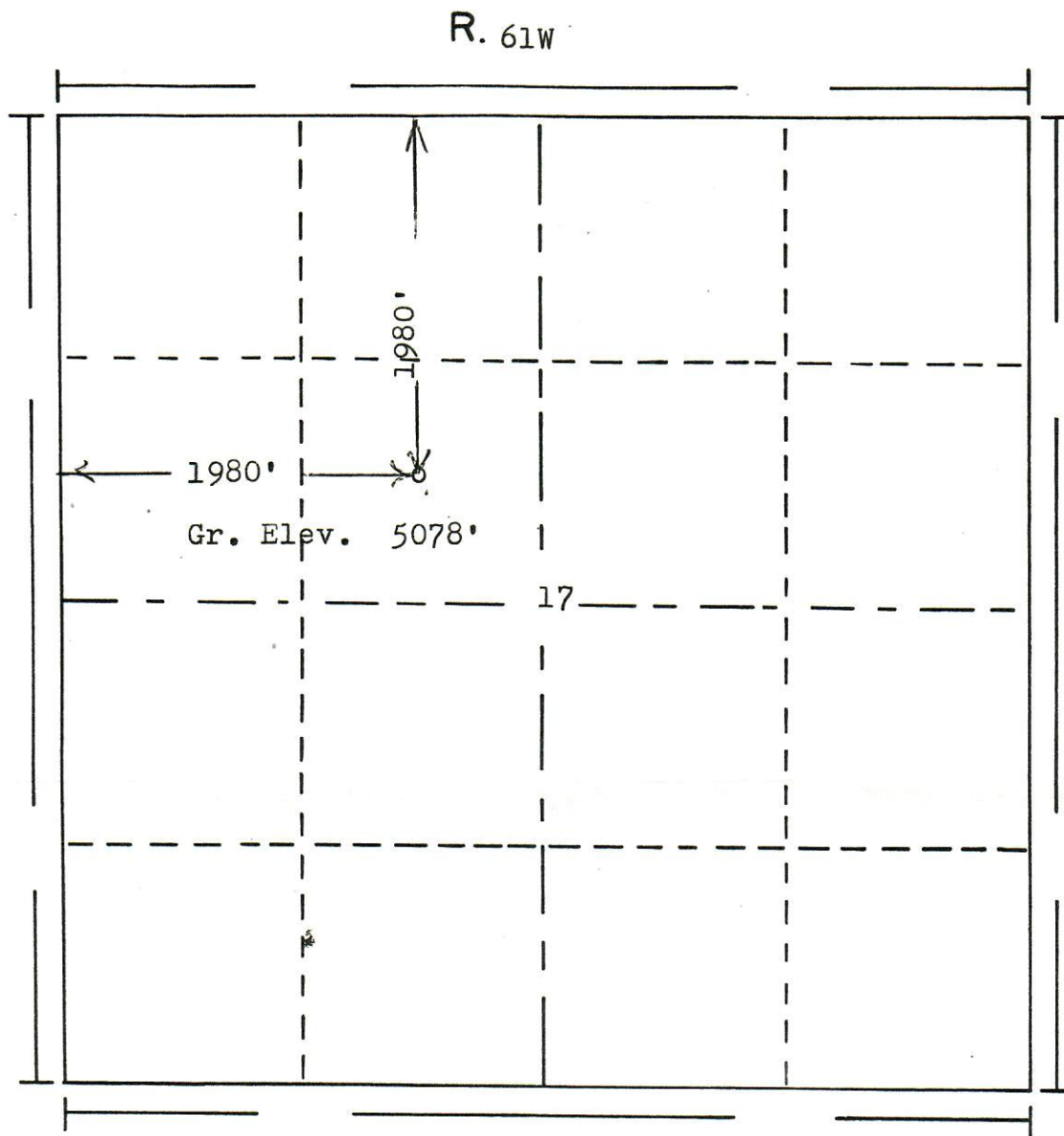

FORM F-106



00396109

RECEIVED  
FEB 11 1985  
COLO. OIL & GAS CONS. COMM.

Scale... 1" = 1000'

**Powers Elevation of Denver, Colorado**has in accordance with a request from  
for Rocky Mountain Production Co.

Mr. Tomson

determined the location of No. 22-17 RMPCO-UPRR-Tippett  
to be CSE NW Section 17 Township 3S  
Range 61W of the 6th Principal Meridian  
Adams County, Colorado

I hereby certify that this plat is an  
accurate representation of a correct  
survey showing the location of

Date:

1-19-85

*Billy G. Hollenbeck*  
Licensed Land Surveyor No. 2853  
State of Colorado

