

WCR 20

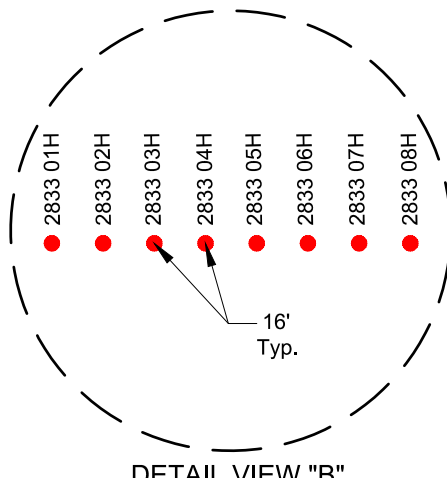

DETAIL VIEW "B"
SCALE: 1" = 60'

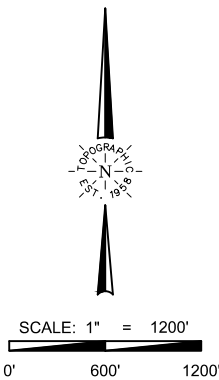

LEGEND

- COUNTY LINE
- SECTION LINE
- QUARTER SECTION LINE
- MINERAL DEVELOPMENT
- PROPOSED BORE PATH
- SURFACE
- TOP OF PRODUCTION ZONE
- BOTTOM OF PRODUCTION ZONE
- BOTTOM HOLE

20

WCR 51

28

29

WCR 51

WCR 16

WCR 53

WCR 55

SEE
DETAIL
"A"

SEE
DETAIL
"B"

32

33

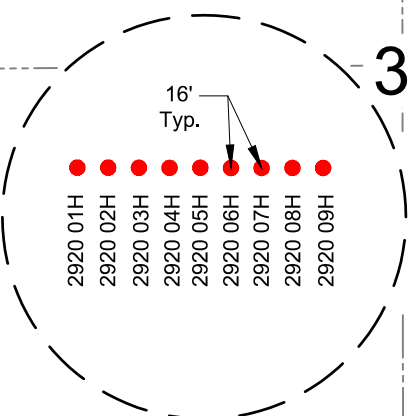

DETAIL VIEW "A"
SCALE: 1" = 100'

2N 64W
1N 64W

Weld County
Adams County



SURVEYOR'S STATEMENT

THE UNDERSIGNED HEREBY STATES THAT THE WELL LOCATION SHOWN HEREON WAS STAKED ON THE GROUND BASED ON EXISTING MONUMENTATION AND/OR PHYSICAL EVIDENCE FOUND IN THE FIELD AND IS CORRECT TO THE BEST OF MY KNOWLEDGE, INFORMATION AND BELIEF.

NOTES

1. HORIZONTAL (NAD 83) AND VERTICAL (NAVD 88) DATUM IS BASED ON THE TRIMBLE VRS NETWORK. THE LINEAL UNITS OF MEASUREMENT ARE U.S. SURVEY FEET.
2. ALL DIRECTIONS, DISTANCES, AND DIMENSIONS SHOWN HEREON ARE BASED ON COORDINATES FROM THE "COLORADO COORDINATE SYSTEM OF 1983 NORTH ZONE" (TITLE 38, ARTICLE 52 C.R.S.).
3. ALL SECTION LINE DIMENSIONS SHOWN HEREON ARE BASED ON FIELD MEASUREMENTS OF EXISTING MONUMENTS AND/OR PHYSICAL EVIDENCE FOUND IN THE FIELD UNLESS OTHERWISE INDICATED.
4. PHYSICAL FEATURES SHOWN HEREON ARE FOR GRAPHICAL REPRESENTATION ONLY.
5. SEE FORM 2A FOR VISIBLE IMPROVEMENTS WITHIN 500' OF WELLHEAD.
6. DISTANCES TO NEAREST SECTION LINES ARE MEASURED PERPENDICULARLY.
7. THIS IS NOT A LAND SURVEY NOR LAND SURVEY PLAT.

PDOP READING: 1.7 INSTRUMENT OPERATOR: J. PHILLIPS

VERDAD RESOURCES
HARAMBE 2929/2920
GEORGENE 2833

FIELD	03/30/2021	DRAFT	SW
REV 1	04/21/2022	CHECK	ZAK
SHEET :	1 OF 1	JOB:	138558

DIRECTIONAL WELL PLAT
 S.H.L. SW/4 NE/4, SECTION 32 T2N R64W 6TH PM
 S.H.L. SE/4 SE/4, SECTION 28 T2N R64W 6TH PM
 TPZ S/2 S/2, SECTION 29 T2N R64W 6TH PM
 TPZ N/2 N/2, SECTION 28 T2N R64W 6TH PM
 BPZ N/2 N/2, SECTION 29 T2N R64W 6TH PM
 BPZ N/2 N/2, SECTION 20 T2N R64W 6TH PM
 BPZ S/2 S/2, SECTION 33 T2N R64W 6TH PM
 BHL N/2 N/2, SECTION 29 T2N R64W 6TH PM
 BHL N/2 N/2, SECTION 20 T2N R64W 6TH PM
 BHL S/2 S/2, SECTION 33 T2N R64W 6TH PM
 WELD COUNTY, COLORADO