

	SECTION LINE
	QUARTER SECTION LINE
	SIXTEENTH SECTION LINE
	RANGE/TOWNSHIP LINE
	PROPOSED LOCATION
	POINT OF INTERSECTION
	MONUMENT FOUND
	CALCULATED CORNER

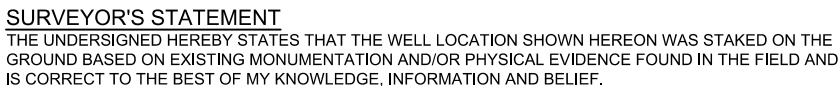
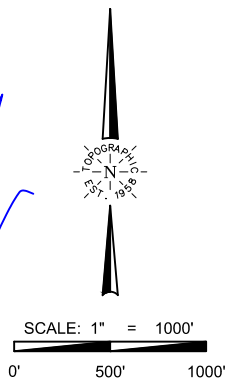

1. HORIZONTAL (NAD 83) AND VERTICAL (NAVD 88) DATUM IS BASED ON THE TRIMBLE VRS NETWORK. THE LINEAL UNITS OF MEASUREMENT ARE U.S. SURVEY FEET.
2. ALL DIRECTIONS, DISTANCES, AND DIMENSIONS SHOWN HEREON ARE BASED ON COORDINATES FROM THE "COLORADO COORDINATE SYSTEM OF 1983 NORTH ZONE" (TITLE 38, ARTICLE 52 C.R.S.).
3. ALL SECTION LINE DIMENSIONS SHOWN HEREON ARE BASED ON FIELD MEASUREMENTS OF EXISTING MONUMENTS AND/OR PHYSICAL EVIDENCE FOUND IN THE FIELD UNLESS OTHERWISE INDICATED.
4. PHYSICAL FEATURES SHOWN HEREON ARE FOR GRAPHICAL REPRESENTATION ONLY.
5. SEE FORM 2A FOR VISIBLE IMPROVEMENTS WITHIN 500' OF WELLHEAD.
6. DISTANCES TO NEAREST SECTION LINES ARE MEASURED PERPENDICULARLY.
7. THIS IS NOT A LAND SURVEY NOR LAND SURVEY PLAT.

PDOP READING: 1.6 INSTRUMENT OPERATOR: Brent Garcia

FIELD	03/31/2022	DRAFT	SW
REV 6	07/22/2022	CHECK	ZAK
SHEET : 1 OF 1		JOB: 128301	

WELL LOCATION MAP
S.H.L. SE/4 SE/4, SECTION 28 T2N R64W 6TH PM
TPZ NE/4 NE/4, SECTION 33 T2N R64W 6TH PM
BPZ/BHL SE/4 SE/4, SECTION 33 T2N R64W 6TH PM
WELD COUNTY, COLORADO