

POINT	NAD 83		NAD 27	
SURFACE HOLE LOCATION	N:	1281682.28	N:	281685.08
	E:	3266017.24	E:	2266168.37
	LAT:	N40.1026941	LAT:	N40.1027115
	LONG:	W104.5490090	LONG:	W104.5484936
TOP OF PRODUCTION ZONE	N:	1281939.70	N:	281942.50
	E:	3266181.08	E:	2266332.20
	LAT:	N40.1033959	LAT:	N40.1034133
	LONG:	W104.5484135	LONG:	W104.5478981
BOTTOM OF PRODUCTION ZONE/ BOTTOM HOLE LOCATION	N:	1281961.42	N:	281964.18
	E:	3261415.96	E:	2261567.18
	LAT:	N40.1035946	LAT:	N40.1036120
	LONG:	W104.5654465	LONG:	W104.5649303

LEGEND

SECTION LINE

QUARTER SECTION LINE

SIXTEENTH SECTION LINE

PROPOSED LOCATION

POINT OF INTERSECTION

MONUMENT FOUND

TOPOGRAPHIC

LOYALTY INNOVATION LEGACY

520 Stacy Court Ste B, Lafayette, CO 80026

303.666.0379 www.topographic.com

**SURVEYOR'S STATEMENT**  
THE UNDERSIGNED HEREBY STATES THAT THE WELL LOCATION SHOWN HEREON WAS STAKED ON THE GROUND BASED ON EXISTING MONUMENTATION AND/OR PHYSICAL EVIDENCE FOUND IN THE FIELD AND IS CORRECT TO THE BEST OF MY KNOWLEDGE, INFORMATION AND BELIEF.

- NOTES**
- HORIZONTAL (NAD 83) AND VERTICAL (NAVD 88) DATUM IS BASED ON THE TRIMBLE VRS NETWORK. THE LINEAL UNITS OF MEASUREMENT ARE U.S. SURVEY FEET.
  - ALL DIRECTIONS, DISTANCES, AND DIMENSIONS SHOWN HEREON ARE BASED ON COORDINATES FROM THE "COLORADO COORDINATE SYSTEM OF 1983 NORTH ZONE" (TITLE 38, ARTICLE 52 C.R.S.).
  - ALL SECTION LINE DIMENSIONS SHOWN HEREON ARE BASED ON FIELD MEASUREMENTS OF EXISTING MONUMENTS AND/OR PHYSICAL EVIDENCE FOUND IN THE FIELD UNLESS OTHERWISE INDICATED.
  - PHYSICAL FEATURES SHOWN HEREON ARE FOR GRAPHICAL REPRESENTATION ONLY.
  - SEE FORM 2A FOR VISIBLE IMPROVEMENTS WITHIN 500' OF WELLHEAD.
  - DISTANCES TO NEAREST SECTION LINES ARE MEASURED PERPENDICULARLY.
  - THIS IS NOT A LAND SURVEY NOR LAND SURVEY PLAT.
- PDOP READING: 1.6 INSTRUMENT OPERATOR: Brent Garcia

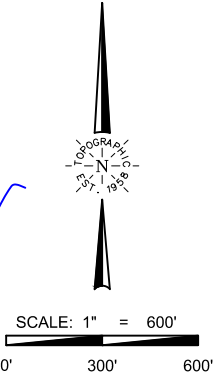
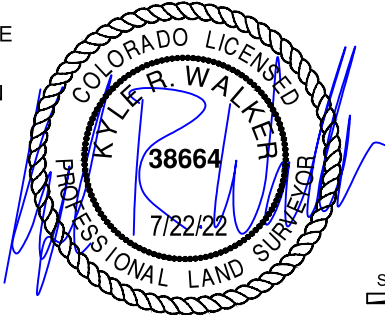

VERDAD RESOURCES GEORGENE 2833-05H			
FIELD	03/31/2022	DRAFT	SW
REV 6	07/22/2022	CHECK	ZAK
SHEET : 1 OF 1		JOB: 128301	

**WELL LOCATION MAP**  
S.H.L. SE/4 SE/4, SECTION 28 T2N R64W 6TH PM  
TPZ SE/4 SE/4, SECTION 28 T2N R64W 6TH PM  
BPZ/BHL SW/4 SW/4, SECTION 28 T2N R64W 6TH PM  
WELD COUNTY, COLORADO