



R. 44W

RECEIVED

NOV 18 1981

COLO. OIL &amp; GAS CONS. COMM.

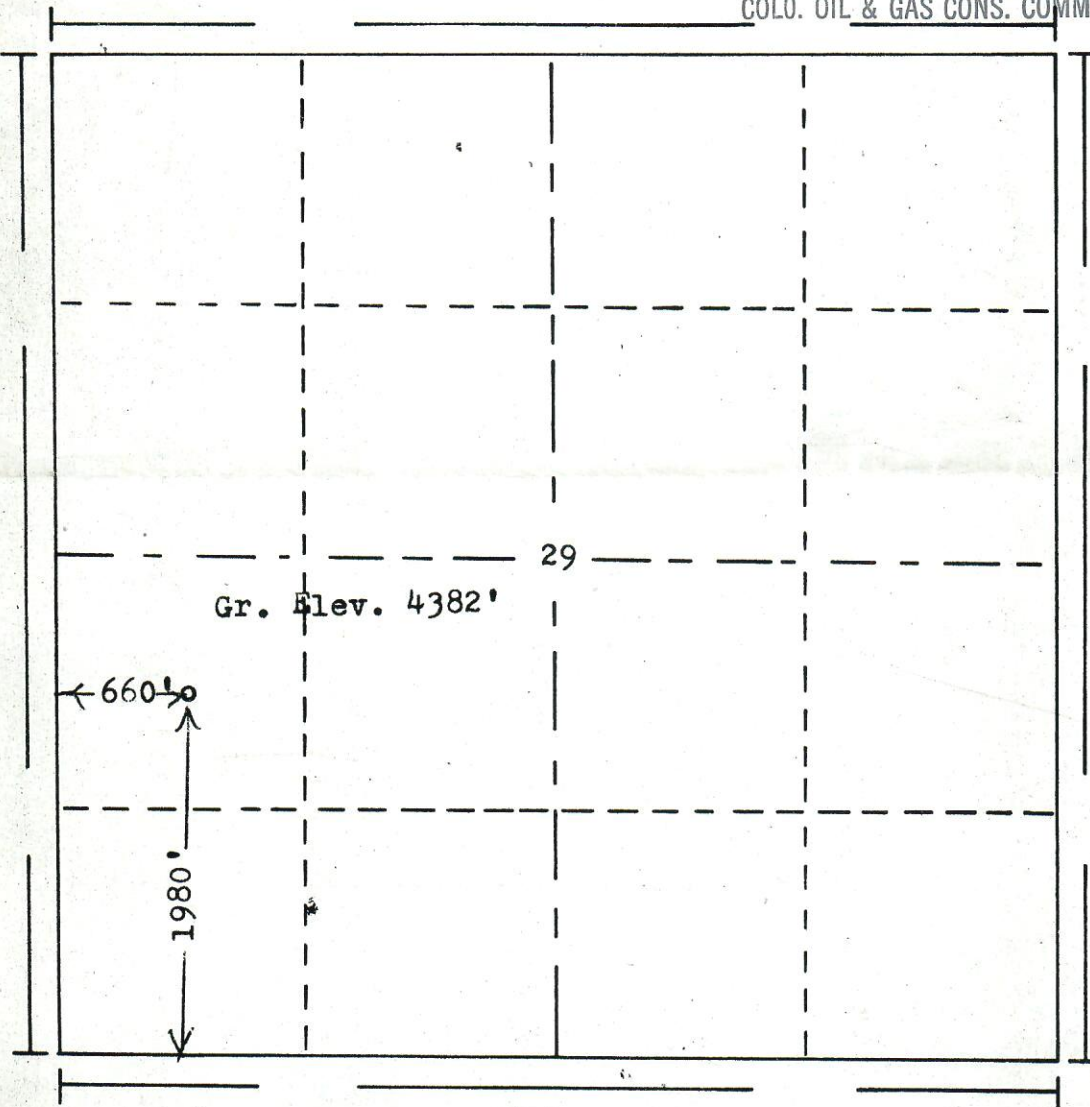
T.  
12  
S

Scale... 1" = 1000'

**Powers Elevation of Denver, Colorado**

has in accordance with a request from Mr. Garrett for Amoco Production Co.

determined the location of 360 Champlin Amoco A-1  
to be CNW SW of the 6th Principal Section 29 Township 12S  
Range 44W Meridian  
Cheyenne County, Colorado

I hereby certify that this plat is an  
accurate representation of a correct  
survey showing the location of



Date

10-29-81

*Billy G. Holloway*  
Licensed Land Surveyor No. 2853  
State of Colorado