

BAYSWATER E&P, LLC

Location	Weld County, CO	Slot	Ruby West 3
Field	WATTENBERG	Well	Ruby West 3
Installation	Ruby 7-J Pad	Wellbore	Ruby West 3 (PWB)

Created by sean.dolfinger
 Date plotted 28-Sep-2021
 Plot reference is Ruby West 3 (PWB).
 Ref wellpath is Ruby West 3 (PWP#1).
 Coordinates are in Feet reference Ruby West 3.
 True Vertical Depths are reference Rig Datum.
 Measured Depths are reference Rig Datum.
 Rig Datum: Planned Datum #1
 Rig Datum to Mean Sea Level: 4946.00 ft.
 Plot North is aligned to GRID North.

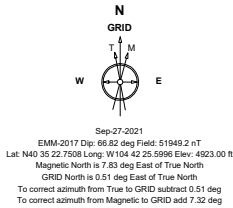

Scale 1 cm = 800 ft

East (Feet) ->

-14400 -12800 -11200 -9600 -8000 -6400 -4800 -3200 -1600 0 1600

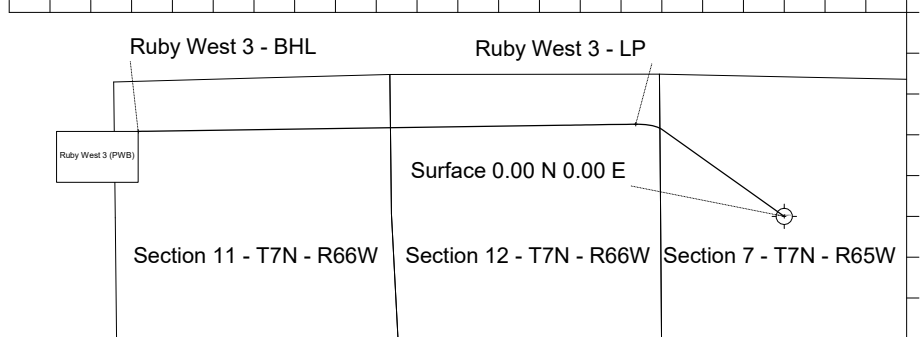

3200
1600
0
-1600
Scale 1 cm = 800 ft
-< North(Feet)

WELL PROFILE DATA

Point	MD	Inc	Azi	TVD	North	East	deg/100ft	V. Sect
Tie on	23.00	0.00	0.00	23.00	S 0.00	W 0.00		0.00
KOP	1573.00	0.00	305.42	1573.00	S 0.00	W 0.00	0.00	0.00
End of Build	3189.64	32.33	305.42	3105.19	N 257.41	W 361.98	2.00	392.47
End of Hold	7847.47	32.33	305.42	7040.86	N 1701.13	W 2392.16	0.00	2593.66
Target Ruby W...3 - LP	8491.94	90.00	269.17	7346.00	N 1807.86	W 2910.66	10.00	3121.66
T.D. & Target Rub...BHL	18251.14	90.00	269.17	7346.00	N 1667.21	W 12668.85	0.00	12778.09

Scale 1 cm = 500 ft
-< True Vertical Depth (Feet)

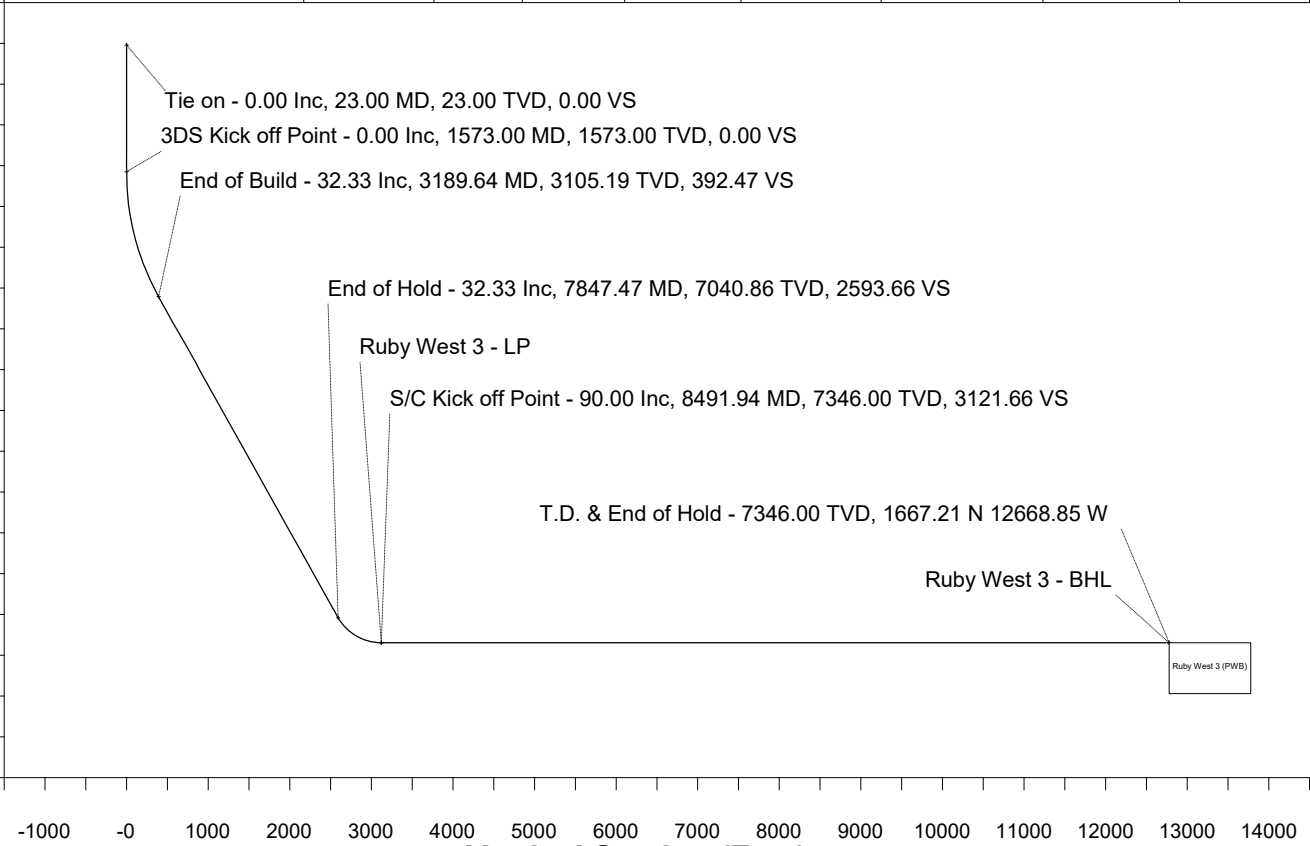

Vertical Section (Feet) ->

Azimuth 277.50 with reference 0.00 N, 0.00 E from Ruby West 3



Wellhead Details							
Name	Latitude	Longitude	Northing	Easting	North	East	Slot Elevation Above Ground
Ruby West 3	40.58957100	-104.70711200	1458606.5738	3220207.0685	29.88S	0.01W	0.00

Declination		
Date	Source	Time
Sep-27-2021	EMM-2017	13:43

Installation Details						
Name	Installation Position (Latitude)	Installation Position (Longitude)	Northing	Easting	Coord System Name	North Alignment
Ruby 7-J Pad	40.58965300	-104.70711100	1458636.4488	3220207.0791	NAD83 Colorado State Planes, North Zone, US Foot	Grid

Summary Wellpath								
MD[ft]	Inc[deg]	Azi[deg]	TVD[ft]	Vertical Depth SS	North[ft]	East[ft]	Dogleg [deg/100ft]	Vertical Section[ft]
23.00	0.00	0.00	23.00	-4923.00	0.00N	0.00E		0.00
1573.00	0.00	305.42	1573.00	-3373.00	0.00N	0.00E	==>	0.00
3189.64	32.33	305.42	3105.19	-1840.81	257.41N	361.98W	2.00	392.47
7847.47	32.33	305.42	7040.86	2094.86	1701.13N	2392.16W	==>	2593.66
8491.94	90.00	269.17	7346.00	2400.00	1807.86N	2910.66W	10.00	3121.66
18251.14	90.00	269.17	7346.00	2400.00	1667.21N	12668.85W	==>	12778.09

Interpolated Wellpath									
MD[ft]	Inc[deg]	Azi[deg]	TVD[ft]	North[ft]	East[ft]	Dogleg [deg/100ft]	Vertical Section[ft]	Station Position (Latitude)	Station Position (Longitude)
0.00	0.00	0.00	0.00	0.00N	0.00E		0.00	40.58957100	-104.70711200
23.00	0.00	0.00	23.00	0.00N	0.00E	==>	0.00	40.58957100	-104.70711200
100.00	0.00	0.00	100.00	0.00N	0.00E	==>	0.00	40.58957100	-104.70711200
200.00	0.00	0.00	200.00	0.00N	0.00E	==>	0.00	40.58957100	-104.70711200
300.00	0.00	0.00	300.00	0.00N	0.00E	==>	0.00	40.58957100	-104.70711200
400.00	0.00	0.00	400.00	0.00N	0.00E	==>	0.00	40.58957100	-104.70711200
500.00	0.00	0.00	500.00	0.00N	0.00E	==>	0.00	40.58957100	-104.70711200
600.00	0.00	0.00	600.00	0.00N	0.00E	==>	0.00	40.58957100	-104.70711200
700.00	0.00	0.00	700.00	0.00N	0.00E	==>	0.00	40.58957100	-104.70711200
800.00	0.00	0.00	800.00	0.00N	0.00E	==>	0.00	40.58957100	-104.70711200
900.00	0.00	0.00	900.00	0.00N	0.00E	==>	0.00	40.58957100	-104.70711200
1000.00	0.00	0.00	1000.00	0.00N	0.00E	==>	0.00	40.58957100	-104.70711200
1100.00	0.00	0.00	1100.00	0.00N	0.00E	==>	0.00	40.58957100	-104.70711200
1200.00	0.00	0.00	1200.00	0.00N	0.00E	==>	0.00	40.58957100	-104.70711200
1300.00	0.00	0.00	1300.00	0.00N	0.00E	==>	0.00	40.58957100	-104.70711200
1400.00	0.00	0.00	1400.00	0.00N	0.00E	==>	0.00	40.58957100	-104.70711200
1500.00	0.00	0.00	1500.00	0.00N	0.00E	==>	0.00	40.58957100	-104.70711200
1573.00	0.00	305.42	1573.00	0.00N	0.00E	==>	0.00	40.58957100	-104.70711200
1673.00	2.00	305.42	1672.98	1.01N	1.42W	2.00	1.54	40.58957381	-104.70711709
1773.00	4.00	305.42	1772.84	4.04N	5.69W	2.00	6.17	40.58958224	-104.70713235
1873.00	6.00	305.42	1872.45	9.09N	12.79W	2.00	13.87	40.58959628	-104.70715775
1973.00	8.00	305.42	1971.70	16.16N	22.72W	2.00	24.63	40.58961590	-104.70719328
2073.00	10.00	305.42	2070.47	25.22N	35.47W	2.00	38.46	40.58964110	-104.70723889
2173.00	12.00	305.42	2168.62	36.28N	51.02W	2.00	55.32	40.58967183	-104.70729451
2273.00	14.00	305.42	2266.06	49.32N	69.35W	2.00	75.19	40.58970806	-104.70736009
2373.00	16.00	305.42	2362.64	64.31N	90.44W	2.00	98.06	40.58974974	-104.70743555
2473.00	18.00	305.42	2458.27	81.26N	114.27W	2.00	123.89	40.58979683	-104.70752078
2573.00	20.00	305.42	2552.82	100.12N	140.80W	2.00	152.66	40.58984927	-104.70761570
2673.00	22.00	305.42	2646.17	120.89N	170.00W	2.00	184.32	40.58990698	-104.70772017
2773.00	24.00	305.42	2738.21	143.54N	201.84W	2.00	218.84	40.58996991	-104.70783409
2873.00	26.00	305.42	2828.84	168.03N	236.28W	2.00	256.18	40.59003798	-104.70795729
2973.00	28.00	305.42	2917.94	194.33N	273.28W	2.00	296.30	40.59011109	-104.70808965

All data is in Feet unless otherwise stated
Coordinates are from Slot MD's are from Rig and TVD's are from Rig (Planned Datum #1 4946.0ft above Mean Sea Level)
Vertical Section is from 0.00N 0.00E on azimuth 277.50 degrees
Bottom hole distance is 12778.09 Feet on azimuth 277.50 degrees from Wellhead
Calculation method uses Minimum Curvature method
Prepared by
Date Printed: 28-Sep-2021

SYSDRILL
Well Design Combined Report
Wellbore: Ruby West 3 (PWB)



Interpolated Wellpath									
MD[ft]	Inc[deg]	Azi[deg]	TVD[ft]	North[ft]	East[ft]	Dogleg [deg/100ft]	Vertical Section[ft]	Station Position (Latitude)	Station Position (Longitude)
3073.00	30.00	305.42	3005.39	222.43N	312.78W	2.00	339.13	40.59018917	-104.70823099
3173.00	32.00	305.42	3091.11	252.28N	354.76W	2.00	384.64	40.59027212	-104.70838114
3189.64	32.33	305.42	3105.19	257.41N	361.98W	2.00	392.47	40.59028639	-104.70840697
3273.00	32.33	305.42	3175.63	283.25N	398.31W	==>	431.86	40.59035820	-104.70853695
3373.00	32.33	305.42	3260.12	314.24N	441.90W	==>	479.12	40.59044434	-104.70869288
3473.00	32.33	305.42	3344.62	345.24N	485.48W	==>	526.38	40.59053048	-104.70884882
3573.00	32.33	305.42	3429.11	376.23N	529.07W	==>	573.63	40.59061662	-104.70900475
3673.00	32.33	305.42	3513.61	407.23N	572.65W	==>	620.89	40.59070276	-104.70916068
3773.00	32.33	305.42	3598.11	438.23N	616.24W	==>	668.15	40.59078890	-104.70931662
3873.00	32.33	305.42	3682.60	469.22N	659.83W	==>	715.41	40.59087504	-104.70947255
3973.00	32.33	305.42	3767.10	500.22N	703.41W	==>	762.67	40.59096118	-104.70962849
4073.00	32.33	305.42	3851.59	531.21N	747.00W	==>	809.92	40.59104732	-104.70978442
4173.00	32.33	305.42	3936.09	562.21N	790.59W	==>	857.18	40.59113346	-104.70994036
4273.00	32.33	305.42	4020.58	593.20N	834.17W	==>	904.44	40.59121960	-104.71009630
4373.00	32.33	305.42	4105.08	624.20N	877.76W	==>	951.70	40.59130574	-104.71025223
4473.00	32.33	305.42	4189.58	655.19N	921.35W	==>	998.96	40.59139188	-104.71040817
4573.00	32.33	305.42	4274.07	686.19N	964.93W	==>	1046.21	40.59147802	-104.71056411
4673.00	32.33	305.42	4358.57	717.19N	1008.52W	==>	1093.47	40.59156415	-104.71072004
4773.00	32.33	305.42	4443.06	748.18N	1052.11W	==>	1140.73	40.59165029	-104.71087598
4873.00	32.33	305.42	4527.56	779.18N	1095.69W	==>	1187.99	40.59173643	-104.71103192
4973.00	32.33	305.42	4612.05	810.17N	1139.28W	==>	1235.25	40.59182257	-104.71118786
5073.00	32.33	305.42	4696.55	841.17N	1182.86W	==>	1282.50	40.59190870	-104.71134380
5173.00	32.33	305.42	4781.04	872.16N	1226.45W	==>	1329.76	40.59199484	-104.71149974
5273.00	32.33	305.42	4865.54	903.16N	1270.04W	==>	1377.02	40.59208098	-104.71165568
5373.00	32.33	305.42	4950.04	934.15N	1313.62W	==>	1424.28	40.59216712	-104.71181162
5473.00	32.33	305.42	5034.53	965.15N	1357.21W	==>	1471.54	40.59225325	-104.71196756
5573.00	32.33	305.42	5119.03	996.15N	1400.80W	==>	1518.79	40.59233939	-104.71212350
5673.00	32.33	305.42	5203.52	1027.14N	1444.38W	==>	1566.05	40.59242552	-104.71227944
5773.00	32.33	305.42	5288.02	1058.14N	1487.97W	==>	1613.31	40.59251166	-104.71243539
5873.00	32.33	305.42	5372.51	1089.13N	1531.56W	==>	1660.57	40.59259780	-104.71259133
5973.00	32.33	305.42	5457.01	1120.13N	1575.14W	==>	1707.83	40.59268393	-104.71274727
6073.00	32.33	305.42	5541.50	1151.12N	1618.73W	==>	1755.08	40.59277007	-104.71290321
6173.00	32.33	305.42	5626.00	1182.12N	1662.32W	==>	1802.34	40.59285620	-104.71305916
6273.00	32.33	305.42	5710.50	1213.11N	1705.90W	==>	1849.60	40.59294234	-104.71321510
6373.00	32.33	305.42	5794.99	1244.11N	1749.49W	==>	1896.86	40.59302847	-104.71337105
6473.00	32.33	305.42	5879.49	1275.10N	1793.07W	==>	1944.12	40.59311461	-104.71352699
6573.00	32.33	305.42	5963.98	1306.10N	1836.66W	==>	1991.37	40.59320074	-104.71368294
6673.00	32.33	305.42	6048.48	1337.10N	1880.25W	==>	2038.63	40.59328687	-104.71383888
6773.00	32.33	305.42	6132.97	1368.09N	1923.83W	==>	2085.89	40.59337301	-104.71399483
6873.00	32.33	305.42	6217.47	1399.09N	1967.42W	==>	2133.15	40.59345914	-104.71415078
6973.00	32.33	305.42	6301.96	1430.08N	2011.01W	==>	2180.41	40.59354528	-104.71430672
7073.00	32.33	305.42	6386.46	1461.08N	2054.59W	==>	2227.66	40.59363141	-104.71446267
7173.00	32.33	305.42	6470.96	1492.07N	2098.18W	==>	2274.92	40.59371754	-104.71461862
7273.00	32.33	305.42	6555.45	1523.07N	2141.77W	==>	2322.18	40.59380368	-104.71477457
7373.00	32.33	305.42	6639.95	1554.06N	2185.35W	==>	2369.44	40.59388981	-104.71493051
7473.00	32.33	305.42	6724.44	1585.06N	2228.94W	==>	2416.70	40.59397594	-104.71508646
7573.00	32.33	305.42	6808.94	1616.06N	2272.53W	==>	2463.95	40.59406207	-104.71524241
7673.00	32.33	305.42	6893.43	1647.05N	2316.11W	==>	2511.21	40.59414820	-104.71539836
7773.00	32.33	305.42	6977.93	1678.05N	2359.70W	==>	2558.47	40.59423434	-104.71555431
7847.47	32.33	305.42	7040.86	1701.13N	2392.16W	==>	2593.66	40.59429848	-104.71567046
7873.00	34.30	302.45	7062.19	1708.95N	2403.79W	10.00	2606.22	40.59432022	-104.71571210
7973.00	42.53	293.25	7140.54	1737.48N	2458.76W	10.00	2664.44	40.59439986	-104.71590910
8073.00	51.29	286.63	7208.83	1762.05N	2527.37W	10.00	2735.67	40.59446897	-104.71615536
8173.00	60.34	281.48	7264.99	1781.91N	2607.54W	10.00	2817.74	40.59452542	-104.71644338
8273.00	69.56	277.19	7307.30	1796.46N	2696.83W	10.00	2908.17	40.59456752	-104.71676442
8373.00	78.87	273.40	7334.48	1805.25N	2792.53W	10.00	3004.19	40.59459398	-104.71710871
8473.00	88.23	269.84	7345.71	1808.02N	2891.73W	10.00	3102.91	40.59460399	-104.71746581
8491.94	90.00	269.17	7346.00	1807.86N	2910.66W	10.00	3121.66	40.59460400	-104.71753400

All data is in Feet unless otherwise stated
Coordinates are from Slot MD's are from Rig and TVD's are from Rig (Planned Datum #1 4946.0ft above Mean Sea Level)
Vertical Section is from 0.00N 0.00E on azimuth 277.50 degrees
Bottom hole distance is 12778.09 Feet on azimuth 277.50 degrees from Wellhead
Calculation method uses Minimum Curvature method
Prepared by
Date Printed: 28-Sep-2021

SYSDRILL
Well Design Combined Report
Wellbore: Ruby West 3 (PWB)



Interpolated Wellpath									
MD[ft]	Inc[deg]	Azi[deg]	TVD[ft]	North[ft]	East[ft]	Dogleg [deg/100ft]	Vertical Section[ft]	Station Position (Latitude)	Station Position (Longitude)
8573.00	90.00	269.17	7346.00	1806.69N	2991.72W	==>	3201.87	40.59460276	-104.71782587
8673.00	90.00	269.17	7346.00	1805.25N	3091.71W	==>	3300.82	40.59460122	-104.71818595
8773.00	90.00	269.17	7346.00	1803.81N	3191.69W	==>	3399.76	40.59459968	-104.71854602
8873.00	90.00	269.17	7346.00	1802.37N	3291.68W	==>	3498.71	40.59459815	-104.71890609
8973.00	90.00	269.17	7346.00	1800.93N	3391.67W	==>	3597.66	40.59459661	-104.71926616
9073.00	90.00	269.17	7346.00	1799.49N	3491.66W	==>	3696.60	40.59459507	-104.71962623
9173.00	90.00	269.17	7346.00	1798.05N	3591.65W	==>	3795.55	40.59459353	-104.71998630
9273.00	90.00	269.17	7346.00	1796.60N	3691.64W	==>	3894.50	40.59459199	-104.72034637
9373.00	90.00	269.17	7346.00	1795.16N	3791.63W	==>	3993.44	40.59459044	-104.72070644
9473.00	90.00	269.17	7346.00	1793.72N	3891.62W	==>	4092.39	40.59458890	-104.72106651
9573.00	90.00	269.17	7346.00	1792.28N	3991.61W	==>	4191.34	40.59458735	-104.72142658
9673.00	90.00	269.17	7346.00	1790.84N	4091.60W	==>	4290.28	40.59458581	-104.72178666
9773.00	90.00	269.17	7346.00	1789.40N	4191.59W	==>	4389.23	40.59458426	-104.72214673
9873.00	90.00	269.17	7346.00	1787.96N	4291.58W	==>	4488.18	40.59458271	-104.72250680
9973.00	90.00	269.17	7346.00	1786.52N	4391.57W	==>	4587.12	40.59458116	-104.72286687
10073.00	90.00	269.17	7346.00	1785.08N	4491.56W	==>	4686.07	40.59457961	-104.72322694
10173.00	90.00	269.17	7346.00	1783.63N	4591.55W	==>	4785.02	40.59457806	-104.72358701
10273.00	90.00	269.17	7346.00	1782.19N	4691.54W	==>	4883.96	40.59457650	-104.72394708
10373.00	90.00	269.17	7346.00	1780.75N	4791.53W	==>	4982.91	40.59457495	-104.72430715
10473.00	90.00	269.17	7346.00	1779.31N	4891.52W	==>	5081.86	40.59457339	-104.72466722
10573.00	90.00	269.17	7346.00	1777.87N	4991.51W	==>	5180.81	40.59457184	-104.72502729
10673.00	90.00	269.17	7346.00	1776.43N	5091.50W	==>	5279.75	40.59457028	-104.72538736
10773.00	90.00	269.17	7346.00	1774.99N	5191.49W	==>	5378.70	40.59456872	-104.72574744
10873.00	90.00	269.17	7346.00	1773.55N	5291.48W	==>	5477.65	40.59456716	-104.72610751
10973.00	90.00	269.17	7346.00	1772.10N	5391.47W	==>	5576.59	40.59456560	-104.72646758
11073.00	90.00	269.17	7346.00	1770.66N	5491.46W	==>	5675.54	40.59456404	-104.72682765
11173.00	90.00	269.17	7346.00	1769.22N	5591.45W	==>	5774.49	40.59456248	-104.72718772
11273.00	90.00	269.17	7346.00	1767.78N	5691.44W	==>	5873.43	40.59456091	-104.72754779
11373.00	90.00	269.17	7346.00	1766.34N	5791.42W	==>	5972.38	40.59455935	-104.72790786
11473.00	90.00	269.17	7346.00	1764.90N	5891.41W	==>	6071.33	40.59455778	-104.72826793
11573.00	90.00	269.17	7346.00	1763.46N	5991.40W	==>	6170.27	40.59455621	-104.72862800
11673.00	90.00	269.17	7346.00	1762.02N	6091.39W	==>	6269.22	40.59455464	-104.72898807
11773.00	90.00	269.17	7346.00	1760.58N	6191.38W	==>	6368.17	40.59455307	-104.72934814
11873.00	90.00	269.17	7346.00	1759.13N	6291.37W	==>	6467.11	40.59455150	-104.72970821
11973.00	90.00	269.17	7346.00	1757.69N	6391.36W	==>	6566.06	40.59454993	-104.73006828
12073.00	90.00	269.17	7346.00	1756.25N	6491.35W	==>	6665.01	40.59454836	-104.73042835
12173.00	90.00	269.17	7346.00	1754.81N	6591.34W	==>	6763.95	40.59454678	-104.73078842
12273.00	90.00	269.17	7346.00	1753.37N	6691.33W	==>	6862.90	40.59454521	-104.73114849
12373.00	90.00	269.17	7346.00	1751.93N	6791.32W	==>	6961.85	40.59454363	-104.73150857
12473.00	90.00	269.17	7346.00	1750.49N	6891.31W	==>	7060.80	40.59454205	-104.73186864
12573.00	90.00	269.17	7346.00	1749.05N	6991.30W	==>	7159.74	40.59454047	-104.73222871
12673.00	90.00	269.17	7346.00	1747.60N	7091.29W	==>	7258.69	40.59453889	-104.73258878
12773.00	90.00	269.17	7346.00	1746.16N	7191.28W	==>	7357.64	40.59453731	-104.73294885
12873.00	90.00	269.17	7346.00	1744.72N	7291.27W	==>	7456.58	40.59453573	-104.73330892
12973.00	90.00	269.17	7346.00	1743.28N	7391.26W	==>	7555.53	40.59453415	-104.73366899
13073.00	90.00	269.17	7346.00	1741.84N	7491.25W	==>	7654.48	40.59453256	-104.73402906
13173.00	90.00	269.17	7346.00	1740.40N	7591.24W	==>	7753.42	40.59453098	-104.73438913
13273.00	90.00	269.17	7346.00	1738.96N	7691.23W	==>	7852.37	40.59452939	-104.73474920
13373.00	90.00	269.17	7346.00	1737.52N	7791.22W	==>	7951.32	40.59452780	-104.73510927
13473.00	90.00	269.17	7346.00	1736.08N	7891.21W	==>	8050.26	40.59452621	-104.73546934
13573.00	90.00	269.17	7346.00	1734.63N	7991.20W	==>	8149.21	40.59452462	-104.73582941
13673.00	90.00	269.17	7346.00	1733.19N	8091.19W	==>	8248.16	40.59452303	-104.73618948
13773.00	90.00	269.17	7346.00	1731.75N	8191.18W	==>	8347.10	40.59452144	-104.73654955
13873.00	90.00	269.17	7346.00	1730.31N	8291.17W	==>	8446.05	40.59451985	-104.73690962
13973.00	90.00	269.17	7346.00	1728.87N	8391.15W	==>	8545.00	40.59451825	-104.73726969
14073.00	90.00	269.17	7346.00	1727.43N	8491.14W	==>	8643.94	40.59451666	-104.73762976
14173.00	90.00	269.17	7346.00	1725.99N	8591.13W	==>	8742.89	40.59451506	-104.73798983
14273.00	90.00	269.17	7346.00	1724.55N	8691.12W	==>	8841.84	40.59451346	-104.73834990
14373.00	90.00	269.17	7346.00	1723.11N	8791.11W	==>	8940.79	40.59451187	-104.73870997

All data is in Feet unless otherwise stated
Coordinates are from Slot MD's are from Rig and TVD's are from Rig (Planned Datum #1 4946.0ft above Mean Sea Level)
Vertical Section is from 0.00N 0.00E on azimuth 277.50 degrees
Bottom hole distance is 12778.09 Feet on azimuth 277.50 degrees from Wellhead
Calculation method uses Minimum Curvature method
Prepared by
Date Printed: 28-Sep-2021

SYSDRILL
Well Design Combined Report
Wellbore: Ruby West 3 (PWB)



Interpolated Wellpath									
MD[ft]	Inc[deg]	Azi[deg]	TVD[ft]	North[ft]	East[ft]	Dogleg [deg/100ft]	Vertical Section[ft]	Station Position (Latitude)	Station Position (Longitude)
14473.00	90.00	269.17	7346.00	1721.66N	8891.10W	==>	9039.73	40.59451027	-104.73907004
14573.00	90.00	269.17	7346.00	1720.22N	8991.09W	==>	9138.68	40.59450866	-104.73943011
14673.00	90.00	269.17	7346.00	1718.78N	9091.08W	==>	9237.63	40.59450706	-104.73979018
14773.00	90.00	269.17	7346.00	1717.34N	9191.07W	==>	9336.57	40.59450546	-104.74015025
14873.00	90.00	269.17	7346.00	1715.90N	9291.06W	==>	9435.52	40.59450385	-104.74051032
14973.00	90.00	269.17	7346.00	1714.46N	9391.05W	==>	9534.47	40.59450225	-104.74087039
15073.00	90.00	269.17	7346.00	1713.02N	9491.04W	==>	9633.41	40.59450064	-104.74123046
15173.00	90.00	269.17	7346.00	1711.58N	9591.03W	==>	9732.36	40.59449903	-104.74159053
15273.00	90.00	269.17	7346.00	1710.13N	9691.02W	==>	9831.31	40.59449743	-104.74195060
15373.00	90.00	269.17	7346.00	1708.69N	9791.01W	==>	9930.25	40.59449582	-104.74231067
15473.00	90.00	269.17	7346.00	1707.25N	9891.00W	==>	10029.20	40.59449420	-104.74267074
15573.00	90.00	269.17	7346.00	1705.81N	9990.99W	==>	10128.15	40.59449259	-104.74303081
15673.00	90.00	269.17	7346.00	1704.37N	10090.98W	==>	10227.09	40.59449098	-104.74339088
15773.00	90.00	269.17	7346.00	1702.93N	10190.97W	==>	10326.04	40.59448936	-104.74375095
15873.00	90.00	269.17	7346.00	1701.49N	10290.96W	==>	10424.99	40.59448775	-104.74411102
15973.00	90.00	269.17	7346.00	1700.05N	10390.95W	==>	10523.93	40.59448613	-104.74447109
16073.00	90.00	269.17	7346.00	1698.61N	10490.94W	==>	10622.88	40.59448451	-104.74483116
16173.00	90.00	269.17	7346.00	1697.16N	10590.93W	==>	10721.83	40.59448290	-104.74519123
16273.00	90.00	269.17	7346.00	1695.72N	10690.92W	==>	10820.77	40.59448128	-104.74555130
16373.00	90.00	269.17	7346.00	1694.28N	10790.91W	==>	10919.72	40.59447965	-104.74591137
16473.00	90.00	269.17	7346.00	1692.84N	10890.90W	==>	11018.67	40.59447803	-104.74627144
16573.00	90.00	269.17	7346.00	1691.40N	10990.88W	==>	11117.62	40.59447641	-104.74663151
16673.00	90.00	269.17	7346.00	1689.96N	11090.87W	==>	11216.56	40.59447478	-104.74699158
16773.00	90.00	269.17	7346.00	1688.52N	11190.86W	==>	11315.51	40.59447316	-104.74735165
16873.00	90.00	269.17	7346.00	1687.08N	11290.85W	==>	11414.46	40.59447153	-104.74771172
16973.00	90.00	269.17	7346.00	1685.63N	11390.84W	==>	11513.40	40.59446990	-104.74807179
17073.00	90.00	269.17	7346.00	1684.19N	11490.83W	==>	11612.35	40.59446828	-104.74843186
17173.00	90.00	269.17	7346.00	1682.75N	11590.82W	==>	11711.30	40.59446665	-104.74879193
17273.00	90.00	269.17	7346.00	1681.31N	11690.81W	==>	11810.24	40.59446501	-104.74915200
17373.00	90.00	269.17	7346.00	1679.87N	11790.80W	==>	11909.19	40.59446338	-104.74951207
17473.00	90.00	269.17	7346.00	1678.43N	11890.79W	==>	12008.14	40.59446175	-104.74987214
17573.00	90.00	269.17	7346.00	1676.99N	11990.78W	==>	12107.08	40.59446011	-104.75023221
17673.00	90.00	269.17	7346.00	1675.55N	12090.77W	==>	12206.03	40.59445848	-104.75059228
17773.00	90.00	269.17	7346.00	1674.11N	12190.76W	==>	12304.98	40.59445684	-104.75095235
17873.00	90.00	269.17	7346.00	1672.66N	12290.75W	==>	12403.92	40.59445520	-104.75131242
17973.00	90.00	269.17	7346.00	1671.22N	12390.74W	==>	12502.87	40.59445356	-104.75167249
18073.00	90.00	269.17	7346.00	1669.78N	12490.73W	==>	12601.82	40.59445192	-104.75203256
18173.00	90.00	269.17	7346.00	1668.34N	12590.72W	==>	12700.76	40.59445028	-104.75239263
18251.14	90.00	269.17	7346.00	1667.21N	12668.85W	==>	12778.09	40.59444900	-104.75267400

All data is in Feet unless otherwise stated
Coordinates are from Slot MD's are from Rig and TVD's are from Rig (Planned Datum #1 4946.0ft above Mean Sea Level)
Vertical Section is from 0.00N 0.00E on azimuth 277.50 degrees
Bottom hole distance is 12778.09 Feet on azimuth 277.50 degrees from Wellhead
Calculation method uses Minimum Curvature method
Prepared by
Date Printed: 28-Sep-2021



Targets							
Name	North[ft]	East[ft]	TVD[ft]	Latitude	Longitude	Northing	Easting
Ruby West 3 - LP	1807.86N	2910.66W	7346.00	40.59460400	-104.71753400	1460414.39	3217296.49
Ruby West 3 - BHL	1667.21N	12668.85W	7346.00	40.59444900	-104.75267400	1460273.74	3207538.56

Survey Tool Program						
Reference	Survey Name	MD[ft]	TVD[ft]	Survey Tool	Error Model	
1026437	Planned	1573.00	1573.00	WdW Rate Gyro	Standard	
1026436	Planned	18251.14	7346.00	ISWWSA MWD	Rev 4 + SAG + FLT	

Notes