

GARNET 21-K PAD DIRECTIONAL WELL PLAT

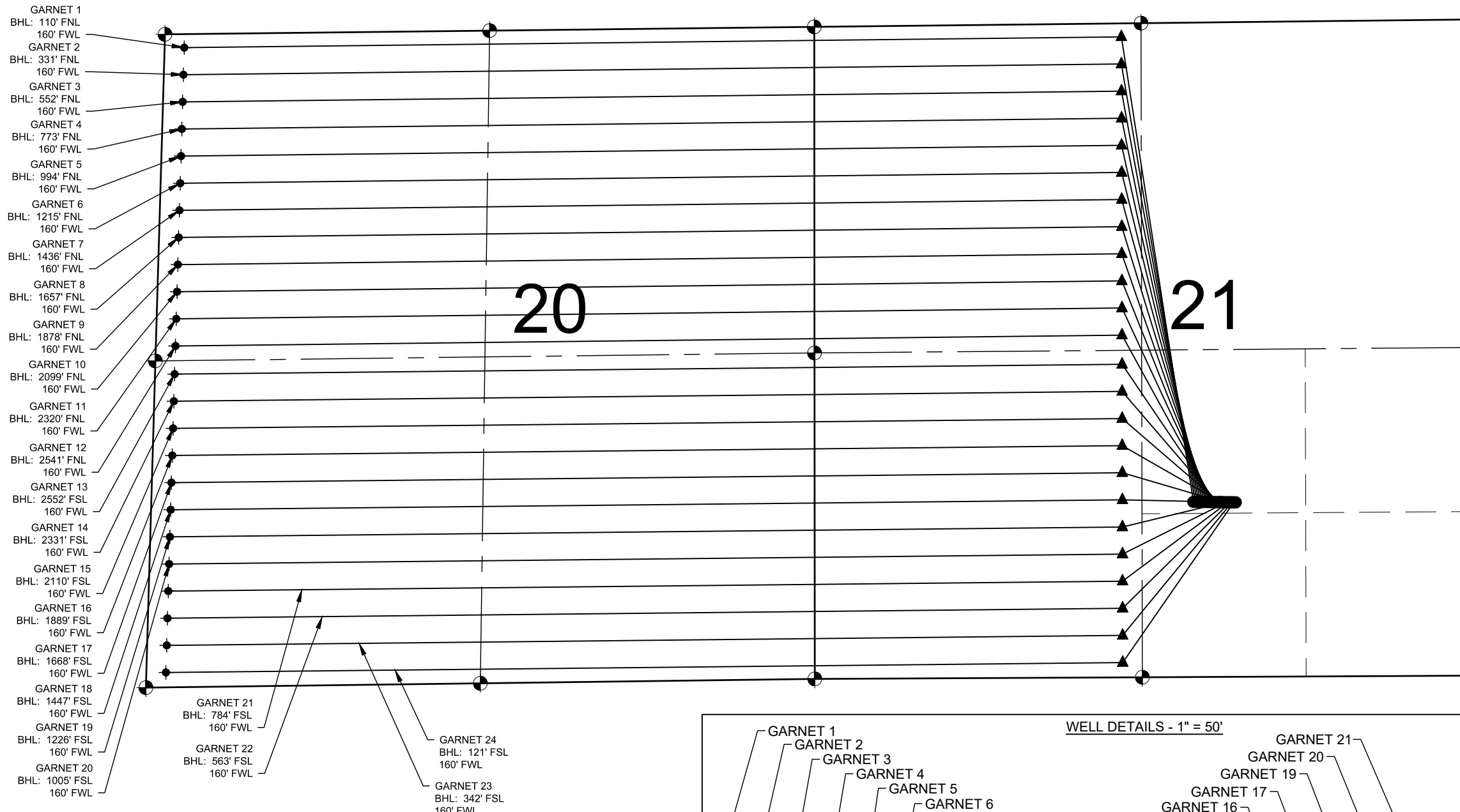

NOTES:

- THIS FIELD SURVEY CONFORMS TO THE MINIMUM STANDARDS SET BY THE COGCC, RULE NO. 215
- ALL DISTANCES AND BEARINGS SHOWN HEREON ARE GROUND VALUES AS GPS MEASURED IN THE FIELD, WITH TIES TO WELLS MEASURED PERPENDICULAR TO LINES SHOWN HEREON. THIS LOW DISTORTION PROJECTION (LDP) IS BASED ON THE NORTH AMERICAN DATUM OF 1983, U.S. SURVEY FOOT WITH A LATITUDE ORIGIN OF 40.568059°N, A CENTRAL MERIDIAN LONGITUDE OF 104.658844°W, AND A SCALE FACTOR ON THE CENTRAL MERIDIAN OF 1.000230 (EXACT). THE LDP BASIS OF BEARINGS IS GEODETIC NORTH.
- FIELD VERIFICATION OF MONUMENTS COMPLETED WITHIN 1 YEAR OF SIGNATURE DATE, UNLESS OTHERWISE NOTED.

NOTES:

GARNET 1 TO BE AT 1428' FSL & 2249' FEL.
 BOTTOM HOLE AT 110' FNL & 160' FWL, SEC. 20.

GARNET 2 TO BE AT 1427' FSL & 2234' FEL.
 BOTTOM HOLE AT 331' FNL & 160' FWL, SEC. 20.

GARNET 3 TO BE AT 1427' FSL & 2219' FEL.
 BOTTOM HOLE AT 552' FNL & 160' FWL, SEC. 20.

GARNET 4 TO BE AT 1427' FSL & 2204' FEL.
 BOTTOM HOLE AT 773' FNL & 160' FWL, SEC. 20.

GARNET 5 TO BE AT 1427' FSL & 2189' FEL.
 BOTTOM HOLE AT 994' FNL & 160' FWL, SEC. 20.

GARNET 6 TO BE AT 1426' FSL & 2174' FEL.
 BOTTOM HOLE AT 1215' FNL & 160' FWL, SEC. 20.

GARNET 7 TO BE AT 1426' FSL & 2159' FEL.
 BOTTOM HOLE AT 1436' FNL & 160' FWL, SEC. 20.

GARNET 8 TO BE AT 1426' FSL & 2144' FEL.
 BOTTOM HOLE AT 1657' FNL & 160' FWL, SEC. 20.

GARNET 9 TO BE AT 1426' FSL & 2129' FEL.
 BOTTOM HOLE AT 1878' FNL & 160' FWL, SEC. 20.

GARNET 10 TO BE AT 1426' FSL & 2114' FEL.
 BOTTOM HOLE AT 2099' FNL & 160' FWL, SEC. 20.

GARNET 11 TO BE AT 1425' FSL & 2099' FEL.
 BOTTOM HOLE AT 2320' FNL & 160' FWL, SEC. 20.

GARNET 12 TO BE AT 1425' FSL & 2084' FEL.
 BOTTOM HOLE AT 2541' FNL & 160' FWL, SEC. 20.

GARNET 13 TO BE AT 1425' FSL & 2069' FEL.
 BOTTOM HOLE AT 2552' FSL & 160' FWL, SEC. 20.

GARNET 14 TO BE AT 1425' FSL & 2054' FEL.
 BOTTOM HOLE AT 2331' FSL & 160' FWL, SEC. 20.

GARNET 15 TO BE AT 1425' FSL & 2039' FEL.
 BOTTOM HOLE AT 2110' FSL & 160' FWL, SEC. 20.

GARNET 16 TO BE AT 1424' FSL & 2024' FEL.
 BOTTOM HOLE AT 1889' FSL & 160' FWL, SEC. 20.

GARNET 17 TO BE AT 1424' FSL & 2009' FEL.
 BOTTOM HOLE AT 1668' FSL & 160' FWL, SEC. 20.

GARNET 18 TO BE AT 1423' FSL & 1994' FEL.
 BOTTOM HOLE AT 1447' FSL & 160' FWL, SEC. 20.

GARNET 19 TO BE AT 1424' FSL & 1979' FEL.
 BOTTOM HOLE AT 1226' FSL & 160' FWL, SEC. 20.

GARNET 20 TO BE AT 1424' FSL & 1964' FEL.
 BOTTOM HOLE AT 1005' FSL & 160' FWL, SEC. 20.

GARNET 21 TO BE AT 1423' FSL & 1949' FEL.
 BOTTOM HOLE AT 784' FSL & 160' FWL, SEC. 20.

GARNET 22 TO BE AT 1423' FSL & 1934' FEL.
 BOTTOM HOLE AT 563' FSL & 160' FWL, SEC. 20.

GARNET 23 TO BE AT 1423' FSL & 1919' FEL.
 BOTTOM HOLE AT 342' FSL & 160' FWL, SEC. 20.

GARNET 24 TO BE AT 1423' FSL & 1904' FEL.
 BOTTOM HOLE AT 121' FSL & 160' FWL, SEC. 20.

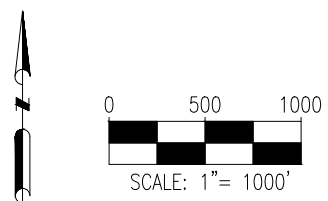
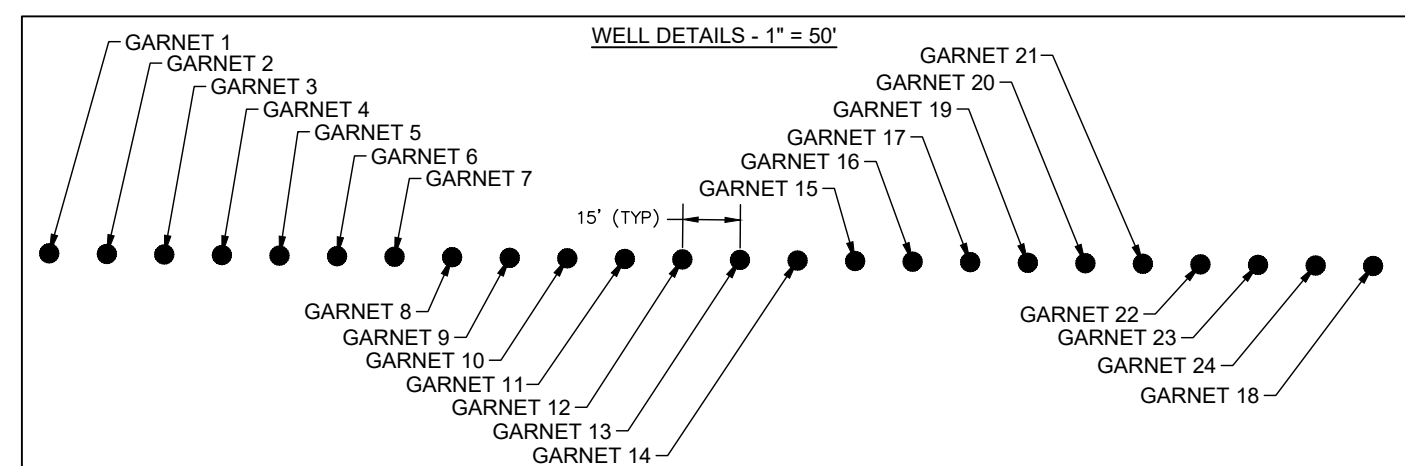

LEGEND

⊕ = EXISTING MONUMENT	▲ = LANDING POINT
○ = CALCULATED POSITION	◆ = EXISTING WELL
● = PROPOSED WELL	BHL = BOTTOM HOLE
⊖ = BOTTOM HOLE	



FIELD DATE: 04-28-20
 DRAWING DATE: 02-23-22
 BY: IJM
 CHECKED: CSG

WELL NAME: GARNET 21-K PAD
 SURFACE LOCATION: NW 1/4 SE 1/4 SEC. 21, T7N, R66W, 6TH P.M.
 WELD COUNTY, COLORADO

