

# CONFLUENCE RESOURCES



Location: COLORADO Slot: SLOT#08 BIGFOOT 11-13-3 (2280'FSL & 620'FWL,SEC.11)

Field: WELD COUNTY (NAD83, TRUE NORTH) Well: BIGFOOT 11-13-3

Facility: SEC.11-T04N-R63W Wellbore: BIGFOOT 11-13-3 PWB

Plot reference wellpath is BIGFOOT 11-13-3 PWP Rev8.0

True vertical depths are referenced to Rig (23) (KB)

Reference wellpath measured depths are referenced to Rig (23) (KB)

Rig (23) (KB) to Mean Sea Level: 4639 feet

Mean Sea Level to Ground level (At Slot: SLOT#08 BIGFOOT 11-13-3 (2280'FSL & 620'FWL,SEC.11)): -4616 feet

Offset wellpath MDs are referenced to each path's default MD datum

Grid System: NAD83 / Lambert Colorado SP, Northern Zone (501), US feet

North Reference: True north

Scale: True distance

Coordinates are in feet referenced to Slot

Depths are in feet

Created by: painestr on 2022-04-26; Database: WellArchitectDB

## Location Information

Facility Name	Grid East (US ft)	Grid North (US ft)	Latitude	Longitude
SEC.11-T04N-R63W	3303108.873	1363635.600	40°19'35.3280"N	104°24'46.1880"W
Slot	Local N (ft)	Local E (ft)	Grid East (US ft)	Grid North (US ft)
SLOT#08 BIGFOOT 11-13-3 (2280'FSL & 620'FWL,SEC.11)	-174.87	2.79	3303113.805	1363460.788
Rig (23) (KB) to Ground level (At Slot: SLOT#08 BIGFOOT 11-13-3 (2280'FSL & 620'FWL,SEC.11))			23ft	
Mean Sea Level to Ground level (At Slot: SLOT#08 BIGFOOT 11-13-3 (2280'FSL & 620'FWL,SEC.11))			-4616ft	
Rig (23) (KB) to Mean Sea Level			4639ft	

## Hole and Casing Sections

Name	Start MD (ft)	End MD (ft)	Interval (ft)	Start TVD (ft)	End TVD (ft)	Start Local N (ft)	Start Local E (ft)	End Local N (ft)	End Local E (ft)	Wellbore
9.625in Casing Surface	23.00	1733.17	1710.17	23.00	1700.00	0.00	0.00	-224.69	-85.59	BIGFOOT 11-13-3 PWB

## Survey Program

Start MD (ft)	End MD (ft)	Tool	Model	Log Name/Comment	Wellbore
23.00	1733.17	BH NavTrak (2019)	BH NavTrak (2019) (Standard)		BIGFOOT 11-13-3 PWB
1733.17	11517.30	BH AutoTrak Curve/Xpress (2019)	BH AutoTrak Curve/Xpress (2019) (Short spacing)		BIGFOOT 11-13-3 PWB

## Bottom Hole Location

MD (ft)	Inc (°)	Az (°)	TVD (ft)	Local N (ft)	Local E (ft)	Grid East (US ft)	Grid North (US ft)	Latitude	Longitude
11517.30	90.000	88.803	6396.00	-1948.68	4255.23	3307392.42	1361564.51	40°19'14.3400"N	104°23'51.2160"W

## Targets

Name	MD (ft)	TVD (ft)	Local N (ft)	Local E (ft)	Grid East (US ft)	Grid North (US ft)	Latitude	Longitude
SEC.11-T04N-R63W	N/A	-2.50	174.87	-2.79	3303108.87	1363635.60	40°19'35.3280"N	104°24'46.1880"W
SEC.11-T04N-R63W E/W 470 SETBACK	N/A	-2.50	174.87	-2.79	3303108.87	1363635.60	40°19'35.3280"N	104°24'46.1880"W
BIGFOOT 11-13-3 BHL REV-1(240'FSL & 470'FEL,SEC.11)	11517.30	6396.00	-1948.68	4255.23	3307392.42	1361564.51	40°19'14.3400"N	104°23'51.2160"W
BIGFOOT 11-13-3 LP REV-1(240'FSL & 470'FWL,SEC.11)	7141.21	6396.00	-2040.12	-119.91	3303018.92	1361419.44	40°19'13.4400"N	104°24'47.7000"W

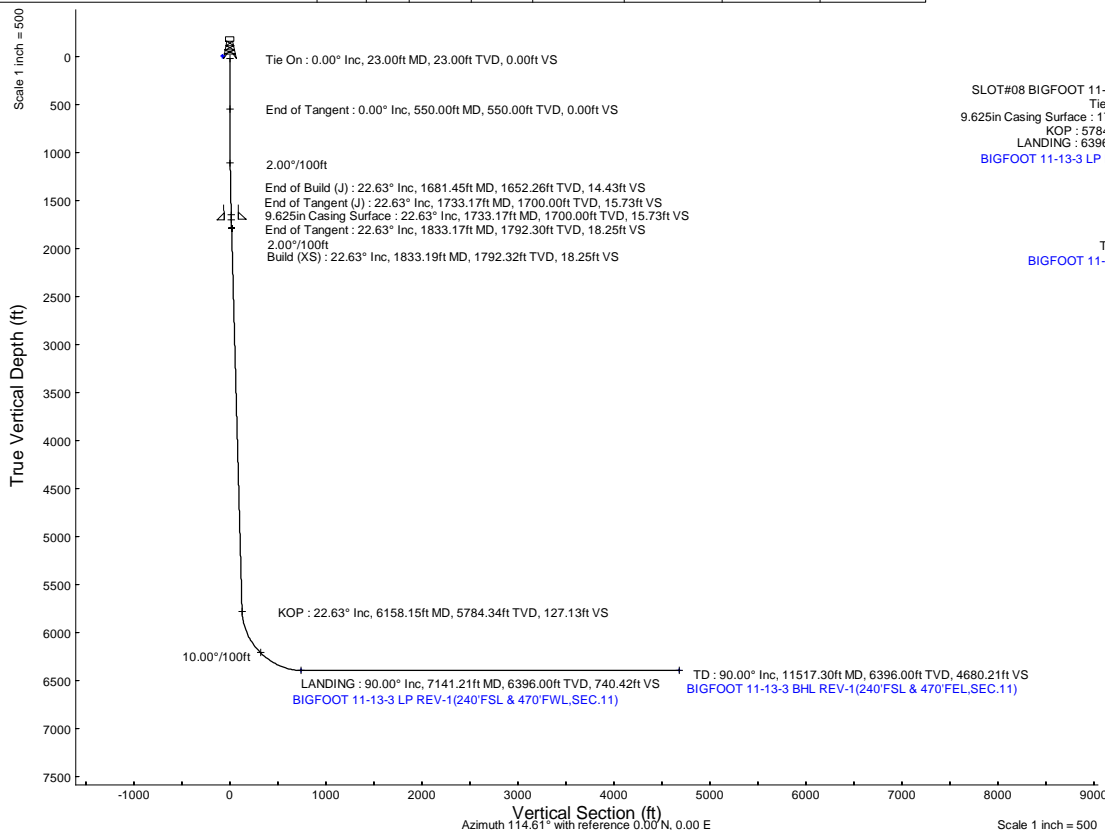

## Well Profile Data

Design Comment	MD (ft)	Inc (°)	Az (°)	TVD (ft)	Local N (ft)	Local E (ft)	DLS (°/100ft)	VS (ft)
Tie On	23.00	0.000		200.854	23.00	0.00	0.00	0.00
End of Tangent	550.00	0.000		200.854	550.00	0.00	0.00	0.00
End of Build (J)	1681.45	22.629	200.854	1652.26	-206.10	-78.51	2.00	14.43
End of Tangent (J)	1733.17	22.629	200.854	1700.00	-224.69	-85.59	0.00	15.73
End of Tangent	1833.17	22.629	200.854	1792.30	-260.65	-99.29	0.00	18.25
Build (XS)	1833.19	22.629	200.854	1792.32	-260.66	-99.29	2.00	18.25
KOP	6158.15	22.629	200.854	5784.34	-1815.70	-691.67	0.00	127.13
LANDING	7141.21	90.000	88.803	6396.00	-2040.12	-119.91	10.00	740.42
TD	11517.30	90.000	88.803	6396.00	-1948.68	4255.23	0.00	4680.21

Scale 1 inch = 500

## Easting (ft)

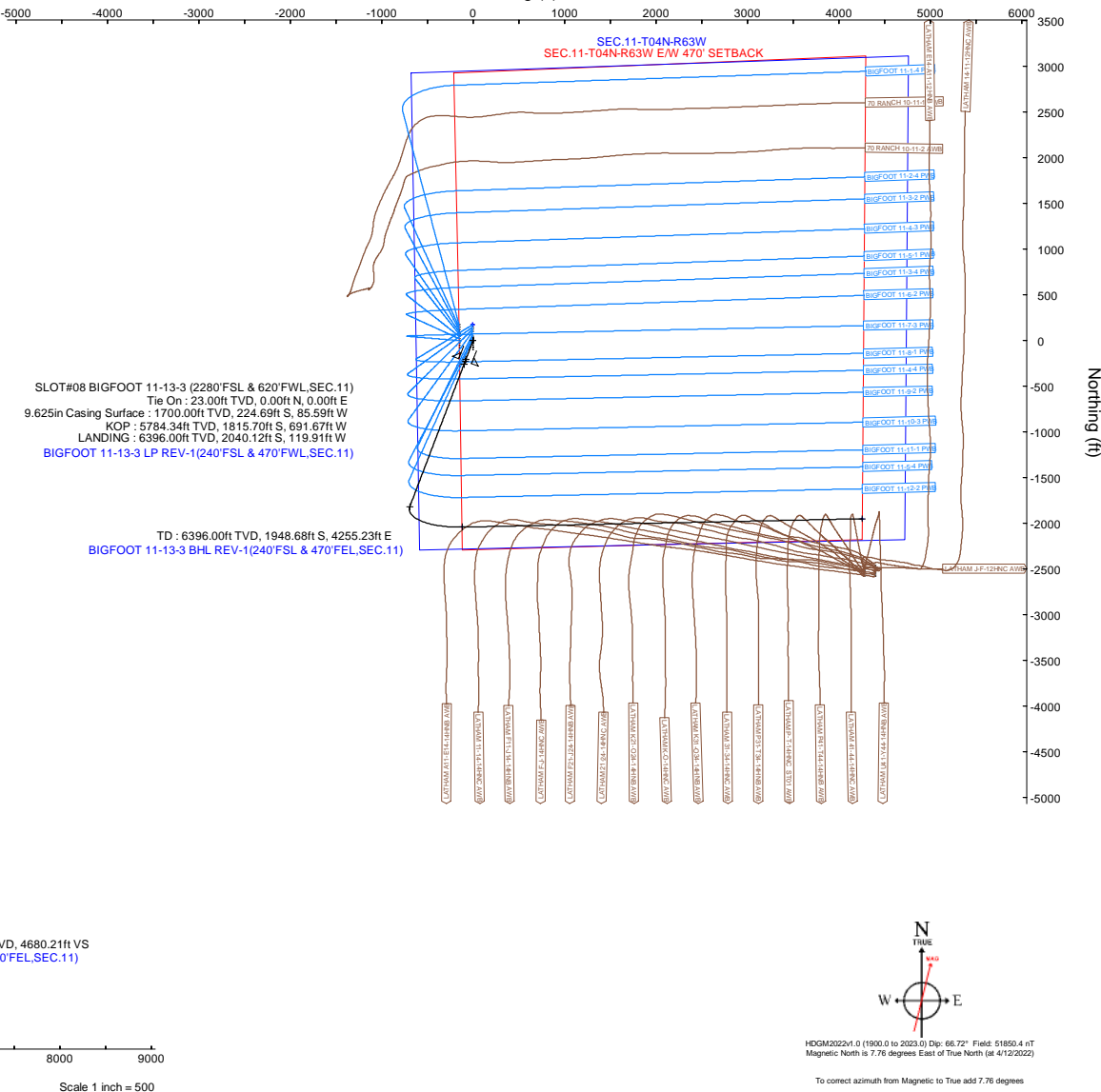



# Planned Wellpath Report

BIGFOOT 11-13-3 PWP Rev-B.0

Page 1 of 8



## REFERENCE WELLPATH IDENTIFICATION

Operator	CONFLUENCE RESOURCES	Well	BIGFOOT 11-13-3
Field	WELD COUNTY (NAD83, TRUE NORTH)	API/Legal	
Facility	SEC.11-T04N-R63W	Wellbore	BIGFOOT 11-13-3 PWB
Slot	SLOT#08 BIGFOOT 11-13-3 (2280'FSL & 620'FWL,SEC.11)		

## REPORT SETUP INFORMATION

Projection System	NAD83 / Lambert Colorado SP, Northern Zone (501), US feet	Software System	WellArchitect® 6.0
North Reference	True	User	Painsetr
Scale	0.999958	Report Generated	4/26/2022 at 1:58:22 PM
Convergence at slot	0.70° East	Database	WellArchitectDB

## WELLPATH LOCATION

	Local coordinates		Grid coordinates		Geographic coordinates	
	North[ft]	East[ft]	Easting[US ft]	Northing[US ft]	Latitude	Longitude
Slot Location	-174.87	2.79	3303113.81	1363460.79	40.3260000°	-104.4128200°
Facility Reference Pt			3303108.87	1363635.60	40.3264800°	-104.4128300°
Field Reference Pt			3230456.90	1245096.09	40.0032400°	-104.6773400°

## WELLPATH DATUM

Calculation method	Minimum curvature	Rig (23') (KB) to Facility Vertical Datum	4639.00ft
Horizontal Reference Pt	Slot	Rig (23') (KB) to Mean Sea Level	4639.00ft
Vertical Reference Pt	Rig (23') (KB)	Rig (23') (KB) to Ground Level at Slot (SLOT#08 BIGFOOT 11-13-3 (2280'FSL & 620'FWL,SEC.11))	23.00ft
MD Reference Pt	Rig (23') (KB)	Section Origin	N 0.00, E 0.00 ft
Field Vertical Reference	Mean Sea Level	Section Azimuth	114.61°

# Planned Wellpath Report

BIGFOOT 11-13-3 PWP Rev-B.0

Page 2 of 8

## REFERENCE WELLPATH IDENTIFICATION

Operator	CONFLUENCE RESOURCES	Well	BIGFOOT 11-13-3
Field	WELD COUNTY (NAD83, TRUE NORTH)	API/Legal	
Facility	SEC.11-T04N-R63W	Wellbore	BIGFOOT 11-13-3 PWB
Slot	SLOT#08 BIGFOOT 11-13-3 (2280'FSL & 620'FWL,SEC.11)		

## WELLPATH DATA (124 stations) † = interpolated, ‡ = extrapolated station

MD [ft]	Inclination [°]	Azimuth [°]	TVD [ft]	Vert Sect [ft]	North [ft]	East [ft]	Grid East [US ft]	Grid North [US ft]	Latitude	Longitude	DLS [°/100ft]	Comments
0.00†	0.000	200.854	0.00	0.00	0.00	0.00	3303113.80	1363460.79	40.3260000	-104.4128200	0.00	
23.00	0.000	200.854	23.00	0.00	0.00	0.00	3303113.80	1363460.79	40.3260000	-104.4128200	0.00	Tie On
123.00†	0.000	200.854	123.00	0.00	0.00	0.00	3303113.80	1363460.79	40.3260000	-104.4128200	0.00	
223.00†	0.000	200.854	223.00	0.00	0.00	0.00	3303113.80	1363460.79	40.3260000	-104.4128200	0.00	
323.00†	0.000	200.854	323.00	0.00	0.00	0.00	3303113.80	1363460.79	40.3260000	-104.4128200	0.00	
423.00†	0.000	200.854	423.00	0.00	0.00	0.00	3303113.80	1363460.79	40.3260000	-104.4128200	0.00	
523.00†	0.000	200.854	523.00	0.00	0.00	0.00	3303113.80	1363460.79	40.3260000	-104.4128200	0.00	
550.00	0.000	200.854	550.00	0.00	0.00	0.00	3303113.80	1363460.79	40.3260000	-104.4128200	0.00	End of Tangent
623.00†	1.460	200.854	622.99	0.06	-0.87	-0.33	3303113.48	1363459.91	40.3259976	-104.4128212	2.00	
723.00†	3.460	200.854	722.89	0.34	-4.88	-1.86	3303112.01	1363455.89	40.3259866	-104.4128267	2.00	
823.00†	5.460	200.854	822.59	0.85	-12.15	-4.63	3303109.33	1363448.59	40.3259667	-104.4128366	2.00	
923.00†	7.460	200.854	921.95	1.59	-22.66	-8.63	3303105.45	1363438.02	40.3259378	-104.4128510	2.00	
1023.00†	9.460	200.854	1020.85	2.55	-36.41	-13.87	3303100.38	1363424.21	40.3259001	-104.4128697	2.00	
1123.00†	11.460	200.854	1119.19	3.74	-53.37	-20.33	3303094.13	1363407.17	40.3258535	-104.4128929	2.00	
1223.00†	13.460	200.854	1216.83	5.15	-73.53	-28.01	3303086.70	1363386.92	40.3257982	-104.4129205	2.00	
1323.00†	15.460	200.854	1313.65	6.78	-96.87	-36.90	3303078.10	1363363.48	40.3257341	-104.4129523	2.00	
1423.00†	17.460	200.854	1409.55	8.64	-123.34	-46.99	3303068.34	1363336.88	40.3256614	-104.4129885	2.00	
1523.00†	19.460	200.854	1504.40	10.71	-152.93	-58.26	3303057.43	1363307.16	40.3255802	-104.4130289	2.00	
1623.00†	21.460	200.854	1598.09	12.99	-185.60	-70.70	3303045.39	1363274.35	40.3254906	-104.4130736	2.00	
1681.45	22.629	200.854	1652.26	14.43	-206.10	-78.51	3303037.83	1363253.75	40.3254343	-104.4131016	2.00	End of Build (J)
1723.00†	22.629	200.854	1690.61	15.48	-221.04	-84.20	3303032.32	1363238.75	40.3253933	-104.4131220	0.00	
1733.17	22.629	200.854	1700.00	15.73	-224.69	-85.59	3303030.97	1363235.07	40.3253832	-104.4131270	0.00	End of Tangent (J)
1823.00†	22.629	200.854	1782.92	17.99	-256.99	-97.90	3303019.07	1363202.63	40.3252946	-104.4131711	0.00	
1833.17	22.629	200.854	1792.30	18.25	-260.65	-99.29	3303017.72	1363198.95	40.3252845	-104.4131761	0.00	End of Tangent
1833.19	22.629	200.854	1792.32	18.25	-260.66	-99.29	3303017.72	1363198.95	40.3252845	-104.4131761	2.00	Build (XS)
1923.00†	22.629	200.854	1875.22	20.51	-292.95	-111.60	3303005.81	1363166.51	40.3251959	-104.4132202	0.00	
2023.00†	22.629	200.854	1967.52	23.03	-328.90	-125.29	3302992.56	1363130.39	40.3250972	-104.4132694	0.00	
2123.00†	22.629	200.854	2059.82	25.55	-364.86	-138.99	3302979.31	1363094.27	40.3249985	-104.4133185	0.00	
2223.00†	22.629	200.854	2152.12	28.06	-400.81	-152.69	3302966.05	1363058.15	40.3248998	-104.4133676	0.00	
2323.00†	22.629	200.854	2244.43	30.58	-436.77	-166.38	3302952.80	1363022.03	40.3248011	-104.4134167	0.00	

# Planned Wellpath Report

**BIGFOOT 11-13-3 PWP Rev-B.0**

Page 3 of 8

## REFERENCE WELLPATH IDENTIFICATION

Operator	CONFLUENCE RESOURCES	Well	BIGFOOT 11-13-3
Field	WELD COUNTY (NAD83, TRUE NORTH)	API/Legal	
Facility	SEC.11-T04N-R63W	Wellbore	BIGFOOT 11-13-3 PWB
Slot	SLOT#08 BIGFOOT 11-13-3 (2280'FSL & 620'FWL,SEC.11)		

## WELLPATH DATA (124 stations) † = interpolated, ‡ = extrapolated station

MD [ft]	Inclination [°]	Azimuth [°]	TVD [ft]	Vert Sect [ft]	North [ft]	East [ft]	Grid East [US ft]	Grid North [US ft]	Latitude	Longitude	DLS [°/100ft]	Comments
2423.00†	22.629	200.854	2336.73	33.10	-472.72	-180.08	3302939.54	1362985.91	40.3247024	-104.4134658	0.00	
2523.00†	22.629	200.854	2429.03	35.62	-508.68	-193.78	3302926.29	1362949.79	40.3246037	-104.4135150	0.00	
2623.00†	22.629	200.854	2521.33	38.13	-544.63	-207.47	3302913.03	1362913.68	40.3245050	-104.4135641	0.00	
2723.00†	22.629	200.854	2613.63	40.65	-580.59	-221.17	3302899.78	1362877.56	40.3244063	-104.4136132	0.00	
2823.00†	22.629	200.854	2705.93	43.17	-616.54	-234.87	3302886.53	1362841.44	40.3243076	-104.4136623	0.00	
2923.00†	22.629	200.854	2798.24	45.69	-652.50	-248.56	3302873.27	1362805.32	40.3242089	-104.4137114	0.00	
3023.00†	22.629	200.854	2890.54	48.20	-688.45	-262.26	3302860.02	1362769.20	40.3241102	-104.4137606	0.00	
3123.00†	22.629	200.854	2982.84	50.72	-724.41	-275.96	3302846.76	1362733.08	40.3240115	-104.4138097	0.00	
3223.00†	22.629	200.854	3075.14	53.24	-760.36	-289.65	3302833.51	1362696.96	40.3239128	-104.4138588	0.00	
3323.00†	22.629	200.854	3167.44	55.76	-796.32	-303.35	3302820.26	1362660.84	40.3238142	-104.4139079	0.00	
3423.00†	22.629	200.854	3259.75	58.27	-832.27	-317.05	3302807.00	1362624.73	40.3237155	-104.4139570	0.00	
3523.00†	22.629	200.854	3352.05	60.79	-868.23	-330.74	3302793.75	1362588.61	40.3236168	-104.4140061	0.00	
3623.00†	22.629	200.854	3444.35	63.31	-904.18	-344.44	3302780.49	1362552.49	40.3235181	-104.4140553	0.00	
3723.00†	22.629	200.854	3536.65	65.83	-940.14	-358.13	3302767.24	1362516.37	40.3234194	-104.4141044	0.00	
3823.00†	22.629	200.854	3628.95	68.34	-976.09	-371.83	3302753.98	1362480.25	40.3233207	-104.4141535	0.00	
3923.00†	22.629	200.854	3721.25	70.86	-1012.05	-385.53	3302740.73	1362444.13	40.3232220	-104.4142026	0.00	
4023.00†	22.629	200.854	3813.56	73.38	-1048.01	-399.22	3302727.48	1362408.01	40.3231233	-104.4142517	0.00	
4123.00†	22.629	200.854	3905.86	75.90	-1083.96	-412.92	3302714.22	1362371.89	40.3230246	-104.4143009	0.00	
4223.00†	22.629	200.854	3998.16	78.41	-1119.92	-426.62	3302700.97	1362335.78	40.3229259	-104.4143500	0.00	
4323.00†	22.629	200.854	4090.46	80.93	-1155.87	-440.31	3302687.71	1362299.66	40.3228272	-104.4143991	0.00	
4423.00†	22.629	200.854	4182.76	83.45	-1191.83	-454.01	3302674.46	1362263.54	40.3227285	-104.4144482	0.00	
4523.00†	22.629	200.854	4275.07	85.97	-1227.78	-467.71	3302661.20	1362227.42	40.3226298	-104.4144973	0.00	
4623.00†	22.629	200.854	4367.37	88.48	-1263.74	-481.40	3302647.95	1362191.30	40.3225311	-104.4145464	0.00	
4723.00†	22.629	200.854	4459.67	91.00	-1299.69	-495.10	3302634.70	1362155.18	40.3224324	-104.4145956	0.00	
4823.00†	22.629	200.854	4551.97	93.52	-1335.65	-508.80	3302621.44	1362119.06	40.3223337	-104.4146447	0.00	
4923.00†	22.629	200.854	4644.27	96.04	-1371.60	-522.49	3302608.19	1362082.94	40.3222350	-104.4146938	0.00	
5023.00†	22.629	200.854	4736.58	98.56	-1407.56	-536.19	3302594.93	1362046.83	40.3221363	-104.4147429	0.00	
5123.00†	22.629	200.854	4828.88	101.07	-1443.51	-549.89	3302581.68	1362010.71	40.3220376	-104.4147920	0.00	
5223.00†	22.629	200.854	4921.18	103.59	-1479.47	-563.58	3302568.43	1361974.59	40.3219389	-104.4148411	0.00	
5323.00†	22.629	200.854	5013.48	106.11	-1515.42	-577.28	3302555.17	1361938.47	40.3218402	-104.4148903	0.00	

# Planned Wellpath Report

BIGFOOT 11-13-3 PWP Rev-B.0

Page 4 of 8

## REFERENCE WELLPATH IDENTIFICATION

Operator	CONFLUENCE RESOURCES	Well	BIGFOOT 11-13-3
Field	WELD COUNTY (NAD83, TRUE NORTH)	API/Legal	
Facility	SEC.11-T04N-R63W	Wellbore	BIGFOOT 11-13-3 PWB
Slot	SLOT#08 BIGFOOT 11-13-3 (2280'FSL & 620'FWL,SEC.11)		

## WELLPATH DATA (124 stations) † = interpolated, ‡ = extrapolated station

MD [ft]	Inclination [°]	Azimuth [°]	TVD [ft]	Vert Sect [ft]	North [ft]	East [ft]	Grid East [US ft]	Grid North [US ft]	Latitude	Longitude	DLS [°/100ft]	Comments
5423.00†	22.629	200.854	5105.78	108.63	-1551.38	-590.98	3302541.92	1361902.35	40.3217415	-104.4149394	0.00	
5523.00†	22.629	200.854	5198.08	111.14	-1587.33	-604.67	3302528.66	1361866.23	40.3216429	-104.4149885	0.00	
5623.00†	22.629	200.854	5290.39	113.66	-1623.29	-618.37	3302515.41	1361830.11	40.3215442	-104.4150376	0.00	
5723.00†	22.629	200.854	5382.69	116.18	-1659.24	-632.07	3302502.15	1361793.99	40.3214455	-104.4150867	0.00	
5823.00†	22.629	200.854	5474.99	118.70	-1695.20	-645.76	3302488.90	1361757.88	40.3213468	-104.4151358	0.00	
5923.00†	22.629	200.854	5567.29	121.21	-1731.15	-659.46	3302475.65	1361721.76	40.3212481	-104.4151850	0.00	
6023.00†	22.629	200.854	5659.59	123.73	-1767.11	-673.16	3302462.39	1361685.64	40.3211494	-104.4152341	0.00	
6123.00†	22.629	200.854	5751.90	126.25	-1803.06	-686.85	3302449.14	1361649.52	40.3210507	-104.4152832	0.00	
6158.15	22.629	200.854	5784.34	127.13	-1815.70	-691.67	3302444.48	1361636.82	40.3210160	-104.4153005	0.00	KOP
6223.00†	21.199	183.843	5844.56	132.11	-1839.08	-696.90	3302439.53	1361613.38	40.3209518	-104.4153192	10.00	
6323.00†	22.585	157.059	5937.58	152.74	-1874.90	-690.61	3302446.26	1361577.65	40.3208535	-104.4152967	10.00	
6423.00†	27.595	136.463	6028.29	188.50	-1909.46	-667.11	3302470.18	1361543.38	40.3207586	-104.4152124	10.00	
6523.00†	34.690	122.732	6113.93	238.29	-1941.72	-627.12	3302510.56	1361511.61	40.3206701	-104.4150690	10.00	
6623.00†	42.840	113.425	6191.90	300.61	-1970.70	-571.85	3302566.19	1361483.32	40.3205905	-104.4148707	10.00	
6723.00†	51.538	106.675	6259.84	373.56	-1995.51	-502.97	3302635.36	1361459.35	40.3205224	-104.4146237	10.00	
6823.00†	60.539	101.408	6315.67	454.93	-2015.40	-422.59	3302715.98	1361440.44	40.3204678	-104.4143355	10.00	
6923.00†	69.713	97.014	6357.71	542.24	-2029.78	-333.14	3302805.59	1361427.17	40.3204284	-104.4140147	10.00	
7023.00†	78.984	93.116	6384.67	632.84	-2038.19	-237.34	3302901.48	1361419.93	40.3204053	-104.4136711	10.00	
7123.00†	88.302	89.459	6395.73	723.98	-2040.40	-138.11	3303000.73	1361418.94	40.3203992	-104.4133153	10.00	
7141.21	90.000	88.803	6396.00†	740.42	-2040.12	-119.91	3303018.92	1361419.44	40.3204000	-104.4132500	10.00	LANDING
7223.00†	90.000	88.803	6396.00	814.06	-2038.41	-38.13	3303100.67	1361422.15	40.3204047	-104.4129567	0.00	
7323.00†	90.000	88.803	6396.00	904.09	-2036.32	61.85	3303200.61	1361425.47	40.3204104	-104.4125982	0.00	
7423.00†	90.000	88.803	6396.00	994.12	-2034.23	161.83	3303300.55	1361428.78	40.3204162	-104.4122397	0.00	
7523.00†	90.000	88.803	6396.00	1084.15	-2032.14	261.80	3303400.49	1361432.10	40.3204219	-104.4118811	0.00	
7623.00†	90.000	88.803	6396.00	1174.18	-2030.05	361.78	3303500.43	1361435.41	40.3204276	-104.4115226	0.00	
7723.00†	90.000	88.803	6396.00	1264.21	-2027.96	461.76	3303600.37	1361438.73	40.3204334	-104.4111641	0.00	
7823.00†	90.000	88.803	6396.00	1354.24	-2025.87	561.74	3303700.31	1361442.04	40.3204391	-104.4108055	0.00	
7923.00†	90.000	88.803	6396.00	1444.27	-2023.78	661.72	3303800.25	1361445.36	40.3204448	-104.4104470	0.00	
8023.00†	90.000	88.803	6396.00	1534.30	-2021.69	761.70	3303900.19	1361448.67	40.3204505	-104.4100884	0.00	
8123.00†	90.000	88.803	6396.00	1624.33	-2019.60	861.67	3304000.13	1361451.99	40.3204563	-104.4097299	0.00	

# Planned Wellpath Report

BIGFOOT 11-13-3 PWP Rev-B.0

Page 5 of 8

## REFERENCE WELLPATH IDENTIFICATION

Operator	CONFLUENCE RESOURCES	Well	BIGFOOT 11-13-3
Field	WELD COUNTY (NAD83, TRUE NORTH)	API/Legal	
Facility	SEC.11-T04N-R63W	Wellbore	BIGFOOT 11-13-3 PWB
Slot	SLOT#08 BIGFOOT 11-13-3 (2280'FSL & 620'FWL,SEC.11)		

## WELLPATH DATA (124 stations) † = interpolated, ‡ = extrapolated station

MD [ft]	Inclination [°]	Azimuth [°]	TVD [ft]	Vert Sect [ft]	North [ft]	East [ft]	Grid East [US ft]	Grid North [US ft]	Latitude	Longitude	DLS [°/100ft]	Comments
8223.00†	90.000	88.803	6396.00	1714.35	-2017.52	961.65	3304100.08	1361455.30	40.3204620	-104.4093714	0.00	
8323.00†	90.000	88.803	6396.00	1804.38	-2015.43	1061.63	3304200.02	1361458.62	40.3204677	-104.4090128	0.00	
8423.00†	90.000	88.803	6396.00	1894.41	-2013.34	1161.61	3304299.96	1361461.93	40.3204734	-104.4086543	0.00	
8523.00†	90.000	88.803	6396.00	1984.44	-2011.25	1261.59	3304399.90	1361465.25	40.3204792	-104.4082957	0.00	
8623.00†	90.000	88.803	6396.00	2074.47	-2009.16	1361.56	3304499.84	1361468.56	40.3204849	-104.4079372	0.00	
8723.00†	90.000	88.803	6396.00	2164.50	-2007.07	1461.54	3304599.78	1361471.88	40.3204906	-104.4075787	0.00	
8823.00†	90.000	88.803	6396.00	2254.53	-2004.98	1561.52	3304699.72	1361475.19	40.3204963	-104.4072201	0.00	
8923.00†	90.000	88.803	6396.00	2344.56	-2002.89	1661.50	3304799.66	1361478.51	40.3205020	-104.4068616	0.00	
9023.00†	90.000	88.803	6396.00	2434.59	-2000.80	1761.48	3304899.60	1361481.82	40.3205078	-104.4065031	0.00	
9123.00†	90.000	88.803	6396.00	2524.62	-1998.71	1861.45	3304999.54	1361485.14	40.3205135	-104.4061445	0.00	
9223.00†	90.000	88.803	6396.00	2614.65	-1996.62	1961.43	3305099.48	1361488.45	40.3205192	-104.4057860	0.00	
9323.00†	90.000	88.803	6396.00	2704.68	-1994.53	2061.41	3305199.42	1361491.77	40.3205249	-104.4054274	0.00	
9423.00†	90.000	88.803	6396.00	2794.71	-1992.44	2161.39	3305299.36	1361495.08	40.3205306	-104.4050689	0.00	
9523.00†	90.000	88.803	6396.00	2884.74	-1990.35	2261.37	3305399.30	1361498.40	40.3205363	-104.4047104	0.00	
9623.00†	90.000	88.803	6396.00	2974.77	-1988.26	2361.35	3305499.24	1361501.71	40.3205420	-104.4043518	0.00	
9723.00†	90.000	88.803	6396.00	3064.80	-1986.17	2461.32	3305599.18	1361505.03	40.3205478	-104.4039933	0.00	
9823.00†	90.000	88.803	6396.00	3154.83	-1984.08	2561.30	3305699.12	1361508.34	40.3205535	-104.4036347	0.00	
9923.00†	90.000	88.803	6396.00	3244.86	-1981.99	2661.28	3305799.07	1361511.66	40.3205592	-104.4032762	0.00	
10023.00†	90.000	88.803	6396.00	3334.89	-1979.90	2761.26	3305899.01	1361514.97	40.3205649	-104.4029177	0.00	
10123.00†	90.000	88.803	6396.00	3424.92	-1977.81	2861.24	3305998.95	1361518.29	40.3205706	-104.4025591	0.00	
10223.00†	90.000	88.803	6396.00	3514.95	-1975.72	2961.21	3306098.89	1361521.60	40.3205763	-104.4022006	0.00	
10323.00†	90.000	88.803	6396.00	3604.98	-1973.63	3061.19	3306198.83	1361524.92	40.3205820	-104.4018420	0.00	
10423.00†	90.000	88.803	6396.00	3695.01	-1971.54	3161.17	3306298.77	1361528.23	40.3205877	-104.4014835	0.00	
10523.00†	90.000	88.803	6396.00	3785.04	-1969.45	3261.15	3306398.71	1361531.55	40.3205934	-104.4011250	0.00	
10623.00†	90.000	88.803	6396.00	3875.07	-1967.36	3361.13	3306498.65	1361534.86	40.3205991	-104.4007664	0.00	
10723.00†	90.000	88.803	6396.00	3965.10	-1965.28	3461.11	3306598.59	1361538.18	40.3206048	-104.4004079	0.00	
10823.00†	90.000	88.803	6396.00	4055.13	-1963.19	3561.08	3306698.53	1361541.49	40.3206105	-104.4000493	0.00	
10923.00†	90.000	88.803	6396.00	4145.16	-1961.10	3661.06	3306798.47	1361544.81	40.3206162	-104.3996908	0.00	
11023.00†	90.000	88.803	6396.00	4235.19	-1959.01	3761.04	3306898.41	1361548.12	40.3206219	-104.3993323	0.00	
11123.00†	90.000	88.803	6396.00	4325.22	-1956.92	3861.02	3306998.35	1361551.44	40.3206276	-104.3989737	0.00	





# Planned Wellpath Report

BIGFOOT 11-13-3 PWP Rev-B.0

Page 6 of 8



## REFERENCE WELLPATH IDENTIFICATION

Operator	CONFLUENCE RESOURCES	Well	BIGFOOT 11-13-3
Field	WELD COUNTY (NAD83, TRUE NORTH)	API/Legal	
Facility	SEC.11-T04N-R63W	Wellbore	BIGFOOT 11-13-3 PWB
Slot	SLOT#08 BIGFOOT 11-13-3 (2280'FSL & 620'FWL,SEC.11)		

## WELLPATH DATA (124 stations) † = interpolated, ‡ = extrapolated station

MD [ft]	Inclination [°]	Azimuth [°]	TVD [ft]	Vert Sect [ft]	North [ft]	East [ft]	Grid East [US ft]	Grid North [US ft]	Latitude	Longitude	DLS [°/100ft]	Comments
11223.00†	90.000	88.803	6396.00	4415.25	-1954.83	3961.00	3307098.29	1361554.75	40.3206333	-104.3986152	0.00	
11323.00†	90.000	88.803	6396.00	4505.28	-1952.74	4060.97	3307198.23	1361558.07	40.3206389	-104.3982566	0.00	
11423.00†	90.000	88.803	6396.00	4595.31	-1950.65	4160.95	3307298.17	1361561.38	40.3206446	-104.3978981	0.00	
11517.30	90.000	88.803	6396.00‡	4680.21	-1948.68	4255.23	3307392.42	1361564.51	40.3206500	-104.3975600	0.00	TD

## HOLE & CASING SECTIONS

- Ref Wellbore: BIGFOOT 11-13-3 PWB      Ref Wellpath: BIGFOOT 11-13-3 PWP Rev-B.0

String/Diameter	Start MD [ft]	End MD [ft]	Interval [ft]	Start TVD [ft]	End TVD [ft]	Start N/S [ft]	Start E/W [ft]	End N/S [ft]	End E/W [ft]
9.625in Casing Surface	23.00	1733.17	1710.17	23.00	1700.00	0.00	0.00	-224.69	-85.59

## REFERENCE WELLPATH IDENTIFICATION

Operator	CONFLUENCE RESOURCES	Well	BIGFOOT 11-13-3
Field	WELD COUNTY (NAD83, TRUE NORTH)	API/Legal	
Facility	SEC.11-T04N-R63W	Wellbore	BIGFOOT 11-13-3 PWB
Slot	SLOT#08 BIGFOOT 11-13-3 (2280'FSL & 620'FWL,SEC.11)		

## TARGETS

Name	MD [ft]	TVD [ft]	North [ft]	East [ft]	Grid East [US ft]	Grid North [US ft]	Latitude	Longitude	Shape
SEC.11-T04N-R63W	N/A	-2.50	174.87	-2.79	3303108.87	1363635.60	40.3264800	-104.4128300	polygon
2D Polygon: dimensions not calculated									
SEC.11-T04N-R63W E/W 470' SETBACK	N/A	-2.50	174.87	-2.79	3303108.87	1363635.60	40.3264800	-104.4128300	polygon
2D Polygon: dimensions not calculated									
2) BIGFOOT 11-13-3 BHL REV-1 (240'FSL & 470'FEL,SEC.11)	11517.30	6396.00	-1948.68	4255.23	3307392.42	1361564.51	40.3206500	-104.3975600	point
1) BIGFOOT 11-13-3 LP REV-1 (240'FSL & 470'FWL,SEC.11)	7141.21	6396.00	-2040.12	-119.91	3303018.92	1361419.44	40.3204000	-104.4132500	point

## SURVEY PROGRAM - Ref Wellbore: BIGFOOT 11-13-3 PWB Ref Wellpath: BIGFOOT 11-13-3 PWP Rev-B.0

Start MD [ft]	End MD [ft]	Positional Uncertainty Model	Log Name/Comment	Wellbore
23.00	1733.17	BH NaviTrak (2019) (Standard)		BIGFOOT 11-13-3 PWB
1733.17	11517.30	BH AutoTrak Curve/eXpress (2019) (Short spacing)		BIGFOOT 11-13-3 PWB





# Planned Wellpath Report

BIGFOOT 11-13-3 PWP Rev-B.0

Page 8 of 8



## REFERENCE WELLPATH IDENTIFICATION

Operator	CONFLUENCE RESOURCES	Well	BIGFOOT 11-13-3
Field	WELD COUNTY (NAD83, TRUE NORTH)	API/Legal	
Facility	SEC.11-T04N-R63W	Wellbore	BIGFOOT 11-13-3 PWB
Slot	SLOT#08 BIGFOOT 11-13-3 (2280'FSL & 620'FWL,SEC.11)		

## DESIGN COMMENTS

MD [ft]	Inclination [°]	Azimuth [°]	TVD [ft]	Comment
23.00	0.000	200.854	23.00	Tie On
550.00	0.000	200.854	550.00	End of Tangent
1681.45	22.629	200.854	1652.26	End of Build (J)
1733.17	22.629	200.854	1700.00	End of Tangent (J)
1833.17	22.629	200.854	1792.30	End of Tangent
1833.19	22.629	200.854	1792.32	Build (XS)
6158.15	22.629	200.854	5784.34	KOP
7141.21	90.000	88.803	6396.00	LANDING
11517.30	90.000	88.803	6396.00	TD



# Closest Approach Clearance Summary Report

BIGFOOT 11-13-3 PWP Rev-B.0 - SPE WPTS Stop  
Drilling HSE Risk (2017)  
Page 1 of 4



REFERENCE WELLPATH IDENTIFICATION			
Operator	CONFLUENCE RESOURCES	Well	BIGFOOT 11-13-3
Field	WELD COUNTY (NAD83, TRUE NORTH)	API/Legal	
Facility	SEC.11-T04N-R63W	Wellbore	BIGFOOT 11-13-3 PWB
Slot	SLOT#08 BIGFOOT 11-13-3 (2280'FSL & 620'FWL,SEC.11)		

REPORT SETUP INFORMATION			
Projection System	NAD83 / Lambert Colorado SP, Northern Zone (501), US feet	Software System	WellArchitect® 6.0
North Reference	True	User	Painsetr
Scale	0.999958	Report Generated	4/26/2022 at 1:58:27 PM
Convergence at slot	0.70° East	Database	WellArchitectDB

WELLPATH LOCATION						
	Local coordinates		Grid coordinates		Geographic coordinates	
	North[ft]	East[ft]	Easting[US ft]	Northing[US ft]	Latitude	Longitude
Slot Location	-174.87	2.79	3303113.81	1363460.79	40.3260000°	-104.4128200°
Facility Reference Pt			3303108.87	1363635.60	40.3264800°	-104.4128300°
Field Reference Pt			3230456.90	1245096.09	40.0032400°	-104.6773400°

WELLPATH DATUM			
Calculation method	Minimum Curvature	Rig (23') (KB) to Facility Vertical Datum	4639.00ft
Horizontal Reference Pt	Slot	Rig (23') (KB) to Mean Sea Level	4639.00ft
Vertical Reference Pt	Rig (23') (KB)	Rig (23') (KB) to Ground Level at Slot (SLOT#08 BIGFOOT 11-13-3 (2280'FSL & 620'FWL,SEC.11))	23.00ft
MD Reference Pt	Rig (23') (KB)		
Field Vertical Reference	Mean Sea Level		

POSITIONAL UNCERTAINTY CALCULATION SETTINGS					
Ellipse Confidence Limit	3.50 Std Dev	Ellipse Start MD	23.00ft	Surface Position Uncertainty	included
Declination	7.76° East of TN	Dip Angle	66.72°	Mag Field Strength	51850 nT
Slot Surface Uncertainty @1SD		Horizontal	0.100ft	Vertical	1.000ft
Facility Surface Uncertainty @1SD		Horizontal	8.200ft	Vertical	3.000ft
Positional Uncertainty values in the WELLPATH DATA table are the projection of the ellipsoid of uncertainty onto the vertical and horizontal planes					



# Closest Approach Clearance Summary Report

BIGFOOT 11-13-3 PWP Rev-B.0 - SPE WPTS Stop  
Drilling HSE Risk (2017)  
Page 2 of 4



## REFERENCE WELLPATH IDENTIFICATION

Operator	CONFLUENCE RESOURCES	Well	BIGFOOT 11-13-3
Field	WELD COUNTY (NAD83, TRUE NORTH)	API/Legal	
Facility	SEC.11-T04N-R63W	Wellbore	BIGFOOT 11-13-3 PWB
Slot	SLOT#08 BIGFOOT 11-13-3 (2280'FSL & 620'FWL,SEC.11)		

## PROXIMITY-SCAN RULE

Rule Name	SPE WPTS Stop Drilling HSE Risk (2017)	Rule Based On	Ratio
Plane of Rule	Closest Approach	Threshold Value	1.00
Include Casing & Hole Size	yes	Apply Cone of Safety	no

## HOLE & CASING SECTIONS

- Ref Wellbore: BIGFOOT 11-13-3 PWB      Ref Wellpath: BIGFOOT 11-13-3 PWP Rev-B.0

String/Diameter	Start MD [ft]	End MD [ft]	Interval [ft]	Start TVD [ft]	End TVD [ft]	Start N/S [ft]	Start E/W [ft]	End N/S [ft]	End E/W [ft]
9.625in Casing Surface	23.00	1733.17	1710.17	23.00	1700.00	0.00	0.00	-224.69	-85.59

## SURVEY PROGRAM - Ref Wellbore: BIGFOOT 11-13-3 PWB      Ref Wellpath: BIGFOOT 11-13-3 PWP Rev-B.0

Start MD [ft]	End MD [ft]	Positional Uncertainty Model	Log Name/Comment	Wellbore
23.00	1733.17	BH NaviTrak (2019) (Standard)		BIGFOOT 11-13-3 PWB
1733.17	11517.30	BH AutoTrak Curve/eXpress (2019) (Short spacing)		BIGFOOT 11-13-3 PWB



# Closest Approach Clearance Summary Report

**BIGFOOT 11-13-3 PWP Rev-B.0 - SPE WPTS Stop  
Drilling HSE Risk (2017)**  
Page 3 of 4



REFERENCE WELLPATH IDENTIFICATION			
Operator	CONFLUENCE RESOURCES	Well	BIGFOOT 11-13-3
Field	WELD COUNTY (NAD83, TRUE NORTH)	API/Legal	
Facility	SEC.11-T04N-R63W	Wellbore	BIGFOOT 11-13-3 PWB
Slot	SLOT#08 BIGFOOT 11-13-3 (2280'FSL & 620'FWL,SEC.11)		

CALCULATION RANGE & CUTOFF		
From: 23.00ft MD	To: 11517.30ft MD	C-C Cutoff: (none)

OFFSET WELL CLEARANCE SUMMARY (36 Offset Wellpaths selected) Ratios are calculated in Closest Approach plane													
Offset Facility	Offset Slot	Offset Well	Offset Wellbore	Offset Wellpath	Wellbore Status	C-C Clearance Distance			Rule Separation Ratio				Rule Status
						Ref MD [ft]	Min C-C Clear Dist [ft]	Diverging from MD [ft]	Ref MD of Min Ratio [ft]	Min Ratio	Min Ratio Dvrg from [ft]		
SEC.14-T04N-R63W	SLOT#14 LATHAM 41-44-14HNC (329'FNL & 453'FEL,SEC.14)	LATHAM 41-44-14HNC	LATHAM 41-44-14HNC AWB	LATHAM 41-44-14HNC AWP	Drilling	11389.10	155.86	11389.10	11398.67	0.72	11398.67		FAIL
SEC.14-T04N-R63W	SLOT#02 LATHAM 11-14-14HNC (377'FNL & 333'FEL,SEC.14)	LATHAM 11-14-14HNC	LATHAM 11-14-14HNC AWB	LATHAM 11-14-14HNC AWP	Drilling	7405.10	139.90	7405.10	7372.98	0.79	7372.98		FAIL
SEC.11-T04N-R63W	SLOT#07 BIGFOOT 11-12-2 (2305'FSL & 620'FWL,SEC.11)	BIGFOOT 11-12-2	BIGFOOT 11-12-2 PWB	BIGFOOT 11-12-2 PWP Rev-B.0	Planned	23.00	25.50	550.00	11517.30	0.85	11517.30		FAIL
SEC.14-T04N-R63W	SLOT#12 LATHAM P-T-14HNC (359'FNL & 453'FEL,SEC.14)	LATHAM P-T-14HNC	LATHAM P-T-14HNC ST01 AWB	LATHAM P-T-14HNC ST01 AWP	Drilling	10727.87	165.29	10727.87	10729.59	0.89	10729.59		FAIL
SEC.14-T04N-R63W	SLOT#04 LATHAM F-J-14HNC (347'FNL & 333'FEL,SEC.14)	LATHAM F-J-14HNC	LATHAM F-J-14HNC AWB	LATHAM F-J-14HNC AWP	Drilling	8083.62	152.77	8083.62	8062.50	0.99	8062.50		FAIL
SEC.14-T04N-R63W	SLOT#06 LATHAM 21-24-14HNC (317'FNL & 333'FEL,SEC.14)	LATHAM 21-24-14HNC	LATHAM 21-24-14HNC AWB	LATHAM 21-24-14HNC AWP	Drilling	8776.21	152.93	8776.21	8755.17	1.00	8755.17		WARN
SEC.14-T04N-R63W	SLOT#10 LATHAM 31-34-14HNC (389'FNL & 453'FEL,SEC.14)	LATHAM 31-34-14HNC	LATHAM 31-34-14HNC AWB	LATHAM 31-34-14HNC AWP	Drilling	10054.36	165.39	10054.36	10050.93	1.06	10050.93		WARN
SEC.14-T04N-R63W	SLOT#01 LATHAM A11-E14-14HNB (392'FNL & 333'FEL,SEC.14)	LATHAM A11-E14-14HNB	LATHAM A11-E14-14HNB AWB	LATHAM A11-E14-14HNB AWP	Drilling	7036.98	197.43	7036.98	6988.44	1.09	6988.44		WARN
SEC.14-T04N-R63W	SLOT#08 LATHAM K-O-14HNC (287'FNL & 332'FEL,SEC.14)	LATHAM K-O-14HNC	LATHAM K-O-14HNC AWB	LATHAM K-O-14HNC AWP	Drilling	9394.89	171.34	9394.89	9399.85	1.14	9399.85		PASS
SEC.14-T04N-R63W	SLOT#13 LATHAM P41-T44-14HNB (344'FNL & 453'FEL,SEC.14)	LATHAM P41-T44-14HNB	LATHAM P41-T44-14HNB AWB	LATHAM P41-T44-14HNB AWP	Drilling	11056.95	225.65	11056.95	11067.54	1.22	11067.54		PASS
SEC.14-T04N-R63W	SLOT#03 LATHAM F11-J14-14HNB (362'FNL & 333'FEL,SEC.14)	LATHAM F11-J14-14HNB	LATHAM F11-J14-14HNB AWB	LATHAM F11-J14-14HNB AWP	Drilling	7735.31	211.12	7735.31	7701.35	1.39	7701.35		PASS
SEC.14-T04N-R63W	SLOT#05 LATHAM F21-J24-14HNB (332'FNL & 333'FEL,SEC.14)	LATHAM F21-J24-14HNB	LATHAM F21-J24-14HNB AWB	LATHAM F21-J24-14HNB AWP	Drilling	8411.64	203.22	8411.64	8383.53	1.43	8383.53		PASS
SEC.11-T04N-R63W	SLOT#06 BIGFOOT 11-5-4 (2330'FSL & 620'FWL,SEC.11)	BIGFOOT 11-5-4	BIGFOOT 11-5-4 PWB	BIGFOOT 11-5-4 PWP Rev-B.0	Planned	23.00	51.08	550.00	11517.30	1.49	11517.30		PASS
SEC.14-T04N-R63W	SLOT#11 LATHAM P31-T34-14HNB (374'FNL & 453'FEL,SEC.14)	LATHAM P31-T34-14HNB	LATHAM P31-T34-14HNB AWB	LATHAM P31-T34-14HNB AWP	Drilling	10383.93	240.27	10383.93	10389.14	1.51	10389.14		PASS
SEC.14-T04N-R63W	SLOT#09 LATHAM K31-O34-14HNB (272'FNL & 332'FEL,SEC.14)	LATHAM K31-O34-14HNB	LATHAM K31-O34-14HNB AWB	LATHAM K31-O34-14HNB AWP	Drilling	9726.64	242.73	9726.64	9729.02	1.71	9729.02		PASS

OFFSET WELL CLEARANCE SUMMARY (36 Offset Wellpaths selected) Ratios are calculated in Closest Approach plane												
Offset Facility	Offset Slot	Offset Well	Offset Wellbore	Offset Wellpath	Wellbore Status	C-C Clearance Distance			Rule Separation Ratio			
						Ref MD [ft]	Min C-C Clear Dist [ft]	Diverging from MD [ft]	Ref MD of Min Ratio [ft]	Min Ratio	Min Ratio Dvrg from [ft]	Rule Status
SEC.14-T04N-R63W	SLOT#07 LATHAM K21-O24-14HNB (302'FNL & 332'FEL,SEC.14)	LATHAM K21-O24-14HNB	LATHAM K21-O24-14HNB AWB	LATHAM K21-O24-14HNB AWP	Drilling	9039.00	232.66	9039.00	9039.00	1.89	9039.00	PASS
SEC.11-T04N-R63W	SLOT#05 BIGFOOT 11-11-1 (2355'FSL & 620'FWL,SEC.11)	BIGFOOT 11-11-1	BIGFOOT 11-11-1 PWB	BIGFOOT 11-11-1 PWP Rev-B.0	Planned	23.00	76.56	550.00	11517.30	1.93	11517.30	PASS
SEC.14-T04N-R63W	SLOT#15 LATHAM U41-Y44-14HNB (314'FNL & 453'FEL,SEC.14)	LATHAM U41-Y44-14HNB	LATHAM U41-Y44-14HNB AWB	LATHAM U41-Y44-14HNB AWP	Drilling	11517.30	303.18	11517.30	11517.30	2.04	11517.30	PASS
SEC.11-T04N-R63W	SLOT#04 BIGFOOT 11-10-3 (2380'FSL & 620'FWL,SEC.11)	BIGFOOT 11-10-3	BIGFOOT 11-10-3 PWB	BIGFOOT 11-10-3 PWP Rev-B.0	Planned	23.00	102.04	550.00	11517.30	2.62	11517.30	PASS
SEC.11-T04N-R63W	SLOT#03 BIGFOOT 11-9-2 (2405'FSL & 620'FWL,SEC.11)	BIGFOOT 11-9-2	BIGFOOT 11-9-2 PWB	BIGFOOT 11-9-2 PWP Rev-B.0	Planned	23.00	127.54	550.00	11517.30	3.44	11517.30	PASS
SEC.11-T04N-R63W	SLOT#02 BIGFOOT 11-4-4 (2430'FSL & 620'FWL,SEC.11)	BIGFOOT 11-4-4	BIGFOOT 11-4-4 PWB	BIGFOOT 11-4-4 PWP Rev-B.0	Planned	23.00	149.39	550.00	11517.30	4.06	11517.30	PASS
SEC.11-T04N-R63W	SLOT#01 BIGFOOT 11-8-1(2455'FSL & 620'FWL,SEC.11)	BIGFOOT 11-8-1	BIGFOOT 11-8-1 PWB	BIGFOOT 11-8-1 PWP Rev-B.0	Planned	23.00	174.89	550.00	11517.30	4.56	11517.30	PASS
SEC.11-T04N-R63W	SLOT#20 BIGFOOT 11-7-3 (2281'FSL & 470'FWL,SEC.11)	BIGFOOT 11-7-3	BIGFOOT 11-7-3 PWB	BIGFOOT 11-7-3 PWP Rev-B.0	Planned	1044.44	141.42	1044.44	11517.30	5.24	11517.30	PASS
SEC.11-T04N-R63W	SLOT#19 BIGFOOT 11-6-2 (2306'FSL & 470'FWL,SEC.11)	BIGFOOT 11-6-2	BIGFOOT 11-6-2 PWB	BIGFOOT 11-6-2 PWP Rev-B.0	Planned	962.02	148.55	962.02	11517.30	6.10	11517.30	PASS
SEC.11-T04N-R63W	SLOT#18 BIGFOOT 11-3-4 (2331'FSL & 470'FWL,SEC.11)	BIGFOOT 11-3-4	BIGFOOT 11-3-4 PWB	BIGFOOT 11-3-4 PWP Rev-B.0	Planned	781.42	157.56	781.42	11517.30	6.71	11517.30	PASS



# Closest Approach Clearance Summary Report

**BIGFOOT 11-13-3 PWP Rev-B.0 - SPE WPTS Stop  
Drilling HSE Risk (2017)**  
Page 4 of 4



## REFERENCE WELLPATH IDENTIFICATION

Operator	CONFLUENCE RESOURCES	Well	BIGFOOT 11-13-3
Field	WELD COUNTY (NAD83, TRUE NORTH)	API/Legal	
Facility	SEC.11-T04N-R63W	Wellbore	BIGFOOT 11-13-3 PWB
Slot	SLOT#08 BIGFOOT 11-13-3 (2280'FSL & 620'FWL,SEC.11)		

## CALCULATION RANGE & CUTOFF

From: 23.00ft MD	To: 11517.30ft MD	C-C Cutoff: (none)
------------------	-------------------	--------------------

## OFFSET WELL CLEARANCE SUMMARY (36 Offset Wellpaths selected) Ratios are calculated in Closest Approach plane

Offset Facility	Offset Slot	Offset Well	Offset Wellbore	Offset Wellpath	Wellbore Status	C-C Clearance Distance			Rule Separation Ratio			
						Ref MD [ft]	Min C-C Clear Dist [ft]	Diverging from MD [ft]	Ref MD of Min Ratio [ft]	Min Ratio	Min Ratio Dvrg from [ft]	Rule Status
SEC.11-T04N-R63W	SLOT#17 BIGFOOT 11-5-1 (2356'FSL & 470'FWL,SEC.11)	BIGFOOT 11-5-1	BIGFOOT 11-5-1 PWB	BIGFOOT 11-5-1 PWP Rev-B.0	Planned	23.00	169.78	550.00	11517.30	7.24	11517.30	PASS
SEC.11-T04N-R63W	SLOT#16 BIGFOOT 11-4-3 (2381'FSL & 470'FWL,SEC.11)	BIGFOOT 11-4-3	BIGFOOT 11-4-3 PWB	BIGFOOT 11-4-3 PWP Rev-B.0	Planned	23.00	182.19	550.00	11517.30	7.91	11517.30	PASS
SEC.14-T04N-R63W	SLOT#18 LATHAM E14-A11-12HNB (269'FNL & 452'FEL,SEC.14)	LATHAM E14-A11-12HNB	LATHAM E14-A11-12HNB AWP	LATHAM E14-A11-12HNB AWP	Drilling	11517.30	725.67	11517.30	11517.30	8.54	11517.30	PASS
SEC.11-T04N-R63W	SLOT#15 BIGFOOT 11-3-2 (2406'FSL & 470'FWL,SEC.11)	BIGFOOT 11-3-2	BIGFOOT 11-3-2 PWB	BIGFOOT 11-3-2 PWP Rev-B.0	Planned	23.00	197.13	550.00	11517.30	8.73	11517.30	PASS
SEC.11-T04N-R63W	SLOT#14 BIGFOOT 11-2-4 (2431'FSL & 470'FWL,SEC.11)	BIGFOOT 11-2-4	BIGFOOT 11-2-4 PWB	BIGFOOT 11-2-4 PWP Rev-B.0	Planned	23.00	214.07	550.00	11517.30	9.34	11517.30	PASS
SEC.10-T04N-R63W	SLOT#02 70 RANCH 10-11-2 (2360'FNL & 514'FEL, SEC.10)	70 RANCH 10-11-2	70 RANCH 10-11-2 AWP	70 RANCH 10-11-2 AWP	Drilling	891.89	1271.63	11517.30	11517.30	10.70	11517.30	PASS
SEC.14-T04N-R63W	SLOT#17 LATHAM 14-11-12HNC (284'FNL & 452'FEL,SEC.14)	LATHAM 14-11-12HNC	LATHAM 14-11-12HNC AWP	LATHAM 14-11-12HNC AWP	Drilling	11517.30	1094.85	11517.30	11517.30	11.48	11517.30	PASS
SEC.10-T04N-R63W	SLOT#01 70 RANCH 10-11-1 (2345'FNL & 514'FEL, SEC.10)	70 RANCH 10-11-1	70 RANCH 10-11-1 AWP	70 RANCH 10-11-1 AWP	Drilling	23.00	1279.91	11517.30	11517.30	12.03	11517.30	PASS
SEC.11-T04N-R63W	SLOT#13 BIGFOOT 11-1-4 (2456'FSL & 470'FWL,SEC.11)	BIGFOOT 11-1-4	BIGFOOT 11-1-4 PWB	BIGFOOT 11-1-4 PWP Rev-B.0	Planned	23.00	232.59	223.00	11517.30	12.22	11517.30	PASS
SEC.14-T04N-R63W	SLOT#16 LATHAM J-F-12HNC (299'FNL & 452'FEL,SEC.14)	LATHAM J-F-12HNC	LATHAM J-F-12HNC AWP	LATHAM J-F-12HNC AWP	Drilling	11517.30	1858.32	11517.30	11517.30	16.38	11517.30	PASS
SEC.14-T04N-R63W	SLOT#12 LATHAM P-T-14HNC (359'FNL & 453'FEL,SEC.14)	LATHAM P-T-14HNC	LATHAM P-T-14HNC OWP AWP	LATHAM P-T-14HNC OWP AWP	Drilling	11081.57	2035.45	11081.57	11517.30	22.86	11517.30	PASS