

CC 697-15-08

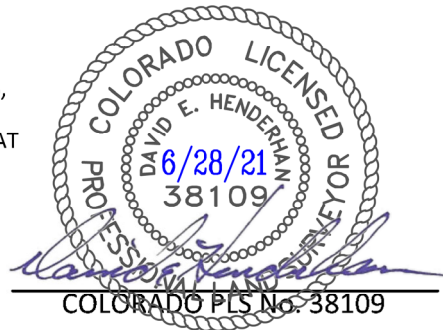

DRG RIFFIN & ASSOCIATES, INC. (307) 362-5028 1414 ELK ST., ROCK SPRINGS, WY 82901	PLAT OF DRILLING LOCATION IN SENE, SECTION 15, FOR LARAMIE ENERGY, LLC.	
	1478' F/NL, & 643' F/EL, SECTION 15, T. 6 S., R. 97 W., 6TH P.M., GARFIELD COUNTY, COLORADO	
	DRAWN: 12/8/2020 - DEH REVISED: 6/28/2021 - DEH REVISED SLOT ASSIGNMENT	SCALE: 1" = 1000' DRG JOB No. 22026 A8-15-18E