

Site Inspection Report

**Site: EUGENE DOVERSBERGER #2 -
CONSOLIDATION FLOWLINE**
04/29/2022

SITE INSPECTION REPORT

INSPECTION DETAILS

SITE/LOCATION	DATE	TIME	INSPECTOR
EUGENE DOVERSBERGER #2 - CONSOLIDATION FLOWLINE	04/29/2022	02:16 PM	COGCC Subcontractor
Comments			
Work Activity Notes			
Changes since previous inspection?	No	Drive by inspection	No
Actively being worked?	No		
Fieldwork Oversight Performed?	No	Oversight Type	N/A
Were Oversight Samples Collected?	N/a	Sample Details	N/A

CHECKLISTS

Remediation Activity Checklist	
	Photo
Question: Open excavation? Approximate size (Length x Width x Depth, ft) Response: No Notes:	No Photo
Question: Stockpiled waste and approximate volume (cubic yards) Response: No Notes:	No Photo

Remediation Activity Checklist

Photo

Notes: Flowline runs under active irrigation ditch.



Notes: Flowline runs under active irrigation ditch.



Remediation Activity Checklist

Question: Monitoring well(s) present? If so note number and approximate location

Response: Yes

Notes: 4

Photo



Question: Monitoring well(s) present? If so note number and approximate location

Response: Yes

Notes: 4

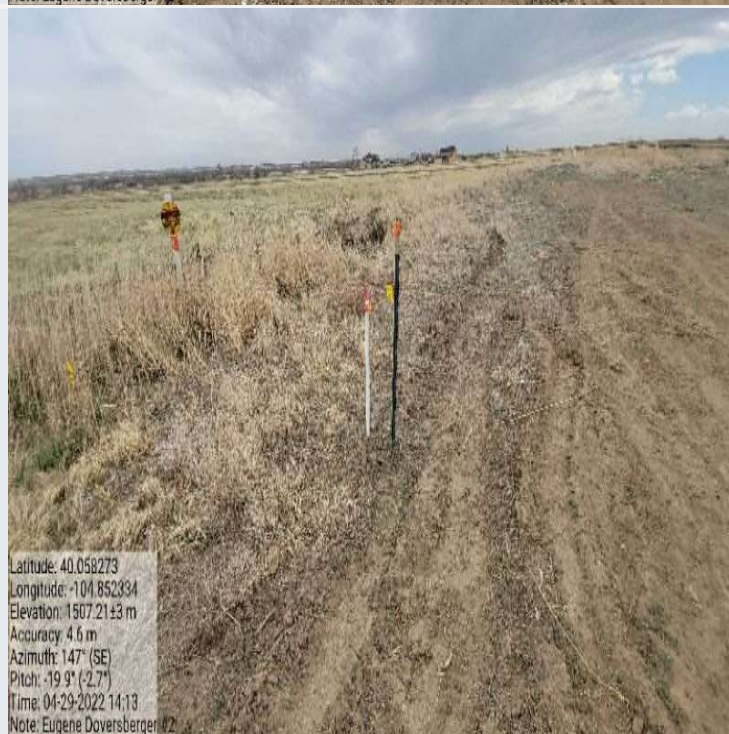

Remediation Activity Checklist

Question: Monitoring well(s) present? If so note number and approximate location

Response: Yes

Notes: 4

Photo



Question: Monitoring well(s) present? If so note number and approximate location

Response: Yes

Notes: 4



Question: Soil impacts remain in situ?

Response: Yes

Notes: Soil impacts remain in-situ and undelineated.

No Photo

EUGENE DOVERSBERGER #2 - CONSOLIDATION FLOWLINE

Site Condition Checklist	
Question: Waste signage present, legible is accurate and up to date (in accordance with rule 913.b.(5)B.iv)? Response: N/A Notes:	Photo No Photo
Question: Emergency sign in compliance with 605.g? Response: N/A Notes: Flags present to mark flowline location.	 <p>Latitude: 40.058276 Longitude: -104.852337 Elevation: 1501.74±3 m Accuracy: 11.0 m Azimuth: 4° (N) Pitch: -29.8° (2.3°) Time: 04-29-2022 14:13 Note: Eugene Doversberger #2</p>
Question: Ground surface appears clean (no evidence of new equipment leaks, oil leaks, spills, or releases)? Response: Yes Notes:	No Photo
Question: Site properly fenced (in accordance with rule 913.b.(5)B.i)? Response: N/A Notes:	No Photo
Question: Is fencing adequate/appropriate for site and well maintained? Response: N/A Notes:	No Photo

Site Condition Checklist	Photo
<p>Question: Exposed flowlines?</p> <p>Response: Yes</p> <p>Notes:</p>	 <p>Latitude: 40.058275 Longitude: -104.852342 Elevation: 1504.16±4 m Accuracy: 10.7 m Azimuth: 253° (W) Pitch: -30.8° (-3.8°) Time: 04-29-2022 14:14 Note: Eugene Doversberger</p>
<p>Question: If flowlines are exposed are they properly capped (bullnose plug, etc.)?</p> <p>Response: Yes</p> <p>Notes:</p>	 <p>Latitude: 40.058275 Longitude: -104.852342 Elevation: 1504.16±4 m Accuracy: 10.7 m Azimuth: 253° (W) Pitch: -30.8° (-3.8°) Time: 04-29-2022 14:14 Note: Eugene Doversberger</p>
<p>Question: Site is protected from vehicular traffic?</p> <p>Response: Yes</p> <p>Notes:</p>	<p>No Photo</p>

Site Condition Checklist	
	Photo
Question: Is an earthen berm secondary containment present and in good condition (no evidence of erosion, animal burrowing, etc.)? Response: N/A Notes:	No Photo
Question: Is work being conducted in a minimal footprint? (Note if any property/crop damage) Response: Yes Notes:	No Photo

Stormwater Checklist	
	Photo
Question: Evidence of pollutants being discharged off-site? Response: No Notes:	No Photo
Question: All stormwater erosion control measures and BMPs are present and in good/working condition? Response: N/A Notes:	No Photo
Question: Site is free of debris/trash? Response: Yes Notes:	No Photo
Question: Potential pollutants (trash, material stockpiles) are properly contained? Response: N/A Notes:	No Photo
Question: Evidence of sediment/debris observed on adjacent roads? (If yes, is note tracking control BMP presence/conditions) Response: No Notes:	No Photo
Question: Additional stormwater control measures/maintenance recommended? Response: No Notes:	No Photo

GENERAL SITE PHOTOS

No additional photos