

St. Croix Operating, Inc.  
Horseshoe #1  
NENE Section 27, T3S R49W  
Washington County, Colorado

---

INTERIM RECLAMATION PLAN

---

St. Croix Operating, Inc. (St. Croix) has drafted this interim reclamation plan in accordance with Rules 304.c.(16) and 1003.

**1. Site Description**

The Horseshoe #1 location is located on fee surface and will access fee minerals. It is a new location. The proposed location is approximately 5.83 acres. The working pad surface is 3.67 acres. The elevation of the area is 4,412’.

**2. Soils Description**

The location is entirely on Soil Type 70 – Valent Sand.

Drainage Class	Excessively drained
Available Water Capacity	Very low; ~2.4 inches of water per foot of soil
Depth to Restrictive Feature	More than 80 inches

**3. Oil and Gas Location Pre-Disturbance Vegetation Composition**

This location is within irrigated cropland.

**4. Identification of Reference Area and Vegetation Composition (Non-Crop Land)**

This location is within irrigated cropland.

**5. Known Weed Infestations**

There are currently no known weed infestations on the location or in the adjacent areas.

**6. Gathering Lines**

One off-location flowline is proposed as part of this project. The flowline will be 1,658 feet in length, approximately 1.14 acres of disturbance. As soon as the flowline is installed, it will under reclamation and be fully reclaimed.

#### **7. Access Road**

The proposed access road is 2,314 feet in length and will have 1.06 acres of disturbance. Once the road is constructed, it will not undergo interim reclamation and will remain in place until the well location undergoes final reclamation.

#### **8. Removal of Drilling, Re-entry, Completion Equipment and all Associated Debris and Waste Materials (1003.a)**

Once drilling operations are completed, all debris and non-E&P waste will be removed from location by the rig company and disposed of properly in commercial waste containers.

All cellars, rat holes, and other boreholes unnecessary for production operations will be backfilled as per industry standards.

#### **9. Management of Waste Material**

No pits are proposed for this location.

All cuttings will be removed from location and hauled offsite for commercial disposal by a licensed third-party transportation company.

#### **10. Identification of Interim Reclamation Areas no Longer in Use (1003.b)**

Once the well proposed for the location has been drilled and is on production, St. Croix will perform interim reclamation on the location. The location will be brought down to 0.002 acres of long-term disturbance. This will allow for continued safe operations around the wellheads and equipment while maximizing the interim reclamation efforts of areas unnecessary to production operations.

#### **11. Compaction Alleviation (1003.c)**

Once the location is ready for interim reclamation, the areas unnecessary to production will be ripped to alleviate compaction and allow for successful seeding.

#### **12. Recontouring**

The location has an overall elevation change of 3 feet from the southwest sloping downwards to the northeast. The location will be recontoured and sloped gently to match the surrounding topography. Erosion control best management practices will occur along the western edge of the well pad to keep potential soil erosion from leaving location. Topsoil will be reincorporated into the interim reclamation as much as possible to keep the microbial ecosystem viable.

### **13. Re-establish and Stabilize Drainage Features**

The location will be recontoured to allow for drainage to move west to east as the previously disturbed area had flowed. The soils will be reseeded as quickly as feasible after construction to stabilize the soils, keep stockpiles and construction-exposed soils in place, and keep the microbial ecosystems viable for future reseeding.

### **14. Establish Desired Self-Perpetuating Plant Community (1003.e)**

St. Croix will utilize a seed mix dictated by the landowner to insure the viability of the soils for the continued agricultural use of the surface. Should the landowner not have a seed mix in mind to use, St. Croix will utilize a wildlife-friendly seed mix as per the Wildlife Mitigation Plan.

### **15. Seedbed Preparation and Seeding (1003.e)**

Proper site preparation would be ensured by spreading of stored and salvaged topsoil or topsoil replacement to an adequate depth and by ripping, tilling, disking, harrowing, and dozer track imprinting where appropriate.

### **16. Fencing**

No fencing is currently anticipated for this location. If fencing becomes necessary to protect reclamation efforts, St. Croix will install a wildlife-friendly fence that complies with the landowner's request and the Wildlife Mitigation Plan.

### **17. Management of Invasive Plants (1003.f)**

Field personnel will be trained on identifying typical noxious weeds in the area. The location will be inspected monthly at a minimum. If invasive plants are identified during an inspection, St. Croix will mobilize noxious weed control to mitigate the weeds.

### **18. Reclamation Monitoring, Inspection, Maintenance, and Reporting**

Once the location has undergone the initial reclamation process, monitoring and inspections will occur monthly. If an issue with the reclamation process is identified during the monthly inspections, St. Croix will assess the concern and modify the practices as necessary. These modifications may include soil additives to assist seed growth if requested by the landowner.

### **19. Interim Reclamation Completion Notice, Form 4 (1003.e.(3))**

St. Croix will submit a Sundry Notice Form 4 which describes the interim reclamation procedures and any associated mitigation measures performed, any changes, if applicable in the landowner's designated final land use, and at a minimum four (4) photographs taken during the growing season facing each cardinal direction which document the success of the interim reclamation and one (1) photograph which documents the total cover of live perennial vegetation of adjacent or nearby undisturbed

land or the reference area. Each photograph shall be identified by date taken, well name, GPS location, and direction of view.

## **20. Site-Specific Interim Reclamation BMPs**

All surface disturbance would be reclaimed to a condition consistent with COGCC and surface owner requirements. Topsoil will be segregated during construction to be redistributed during interim reclamation. Disturbed areas would be reseeded in accordance with the specific requirements of the landowner. Reseeding would occur as soon as possible after drilling and completion activities have been completed for the well proposed on this location. The objective of interim reclamation is to achieve stability objectives to insure erosion control and continued viability of the soils for the future of the land use. The long-term objective of final reclamation is to return the land to approximately pre-project conditions.

Erosion control would be deemed sufficient when adequate vegetation cover is reestablished, water naturally infiltrates into the soil, the site complies with the approved Stormwater Management Plan (SWMP) and when gulying, headcutting, slumping, and deep or excessive rilling is not observed. Proper site preparation would be ensured by spreading of stored and salvaged topsoil or topsoil replacement to an adequate depth and by ripping, tilling, disking, harrowing, and dozer track imprinting where appropriate.

Once the pad has been drilled with the proposed well, interim reclamation would occur. This would consist of minimizing the footprint of disturbance through recontouring and revegetation of all disturbed areas not needed for production operations (including cut/fill slopes). After the topsoil has been returned to these areas and prepared for seeding, a landowner-approved, weed-free seed mix would be installed to prevent erosion, preserve soil integrity, and resist weeds. Prior to interim reclamation, St. Croix would meet with the private landowner to inspect the disturbed area, review the reclamation plan, and agree on any revisions.

# Interim Reclamation Drawing

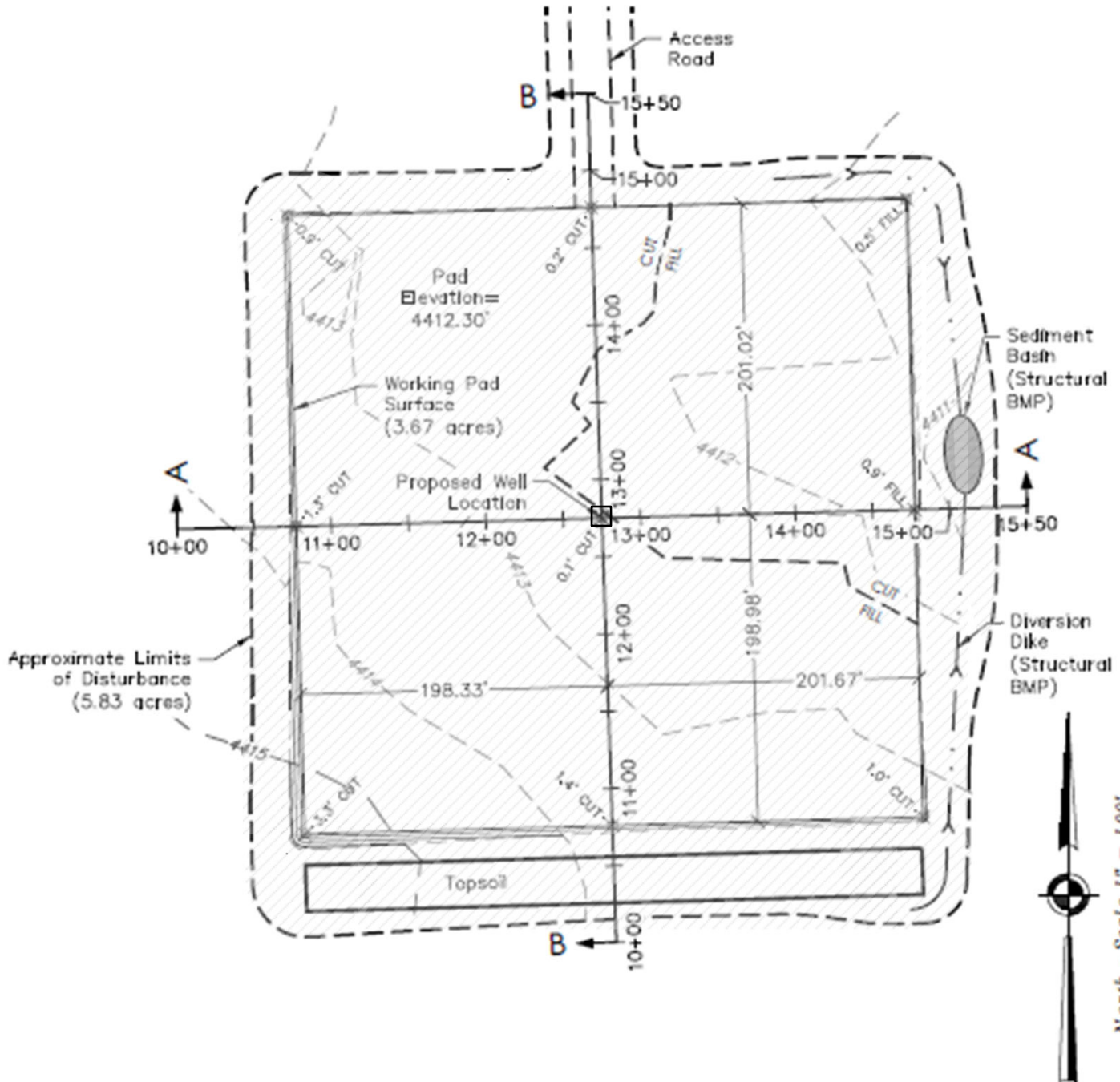

**Notes:**

- Elevations based on NAVD 88 Datum.
- A 15% allowance is made for compaction loss.

Location Disturbance After Interim Reclamation = 0.002 acres

Pad Dim: 400' x 400' Pad Grade: 4412.30'				
Estimated Earthwork (Cubic Yards)				
Cut	Fill	Compaction Loss	Topsoil	Excess
3,750	523	78	3148	1
Cut includes 6" topsoil depth				

G:\Projects\21-0047-00 Off Pad (PLS)\04 Drawings\02\_Horsehoe at Horsehoe.pl - C&F 5/18/21 September 22, 2021 10:49:30 AM

Well Name:	<b>Horseshoe #1</b>	Field Date	07.12.2021	Prepared for:	Project#: 21028.001
		Party Chief	BAB	<b>St Croix Operating, LLC</b>	
		Survey Tech	N/A		
		Proj. Manager	BAB		
	S27-T03S-R49W-6 PM	PLS Corporation 532 West 66th Street Loveland, Colorado 80538 970.669.2100 - info@plscorporation.com			
	Washington County, CO				