

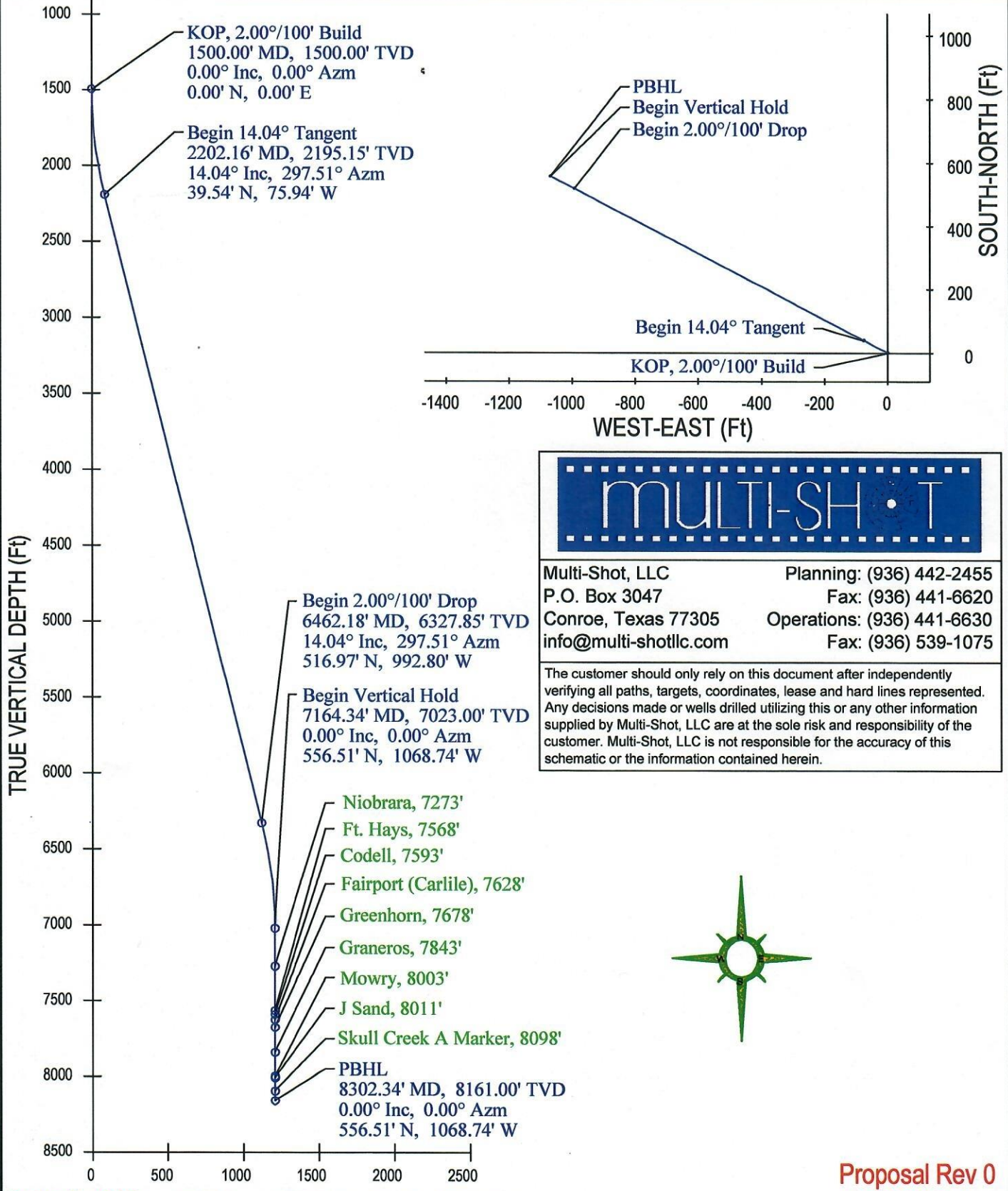

Company: EnCana
 Lease/Well: Wheeler 31-01
 Location: Boulder County
 Rig Name: Unknown



State/Country: Colorado
 Declination:
 Grid:
 Date/Time: 21-June-06 / 14:00



Multi-Shot, LLC
 P.O. Box 3047
 Conroe, Texas 77305
 info@multi-shotllc.com

Planning: (936) 442-2455
 Fax: (936) 441-6620
 Operations: (936) 441-6630
 Fax: (936) 539-1075

The customer should only rely on this document after independently verifying all paths, targets, coordinates, lease and hard lines represented. Any decisions made or wells drilled utilizing this or any other information supplied by Multi-Shot, LLC are at the sole risk and responsibility of the customer. Multi-Shot, LLC is not responsible for the accuracy of this schematic or the information contained herein.



Drawn By: CAS VERTICAL SECTION (Ft) @ 297.51° Azm

Proposal Rev 0
 P06209r0.dwg



Job Number: P06209
 Company: EnCana
 Lease/Well: Wheeler 31-01
 Location: Boulder County
 Rig Name: Unknown
 RKB:
 G.L. or M.S.L.:

State/Country: Colorado
 Declination:
 Grid:
 File name: F:\WELLPL~1\2006\06200\SIP06209\06209.SVY
 Date/Time: 21-Jun-06 / 14:04
 Curve Name: Prop Rev 0

WINSERVE SURVEY CALCULATIONS
 Minimum Curvature Method
 Vertical Section Plane 297.51
 Vertical Section Referenced to Wellhead
 Rectangular Coordinates Referenced to Wellhead

Measured Depth FT	Incl Angle Deg	Drift Direction Deg	True Vertical Depth	N-S FT	E-W FT	Vertical Section FT	CLOSURE Distance FT	Direction Deg	Dogleg Severity Deg/100
KOP, 2.00°/100' Build									
1500.00	.00	.00	1500.00	.00	.00	.00	.00	.00	.00
1600.00	2.00	297.51	1599.98	.81	-1.55	1.75	1.75	297.51	2.00
1700.00	4.00	297.51	1699.84	3.22	-6.19	6.98	6.98	297.51	2.00
1800.00	6.00	297.51	1799.45	7.25	-13.92	15.69	15.69	297.51	2.00
1900.00	8.00	297.51	1898.70	12.88	-24.73	27.88	27.88	297.51	2.00
2000.00	10.00	297.51	1997.47	20.10	-38.60	43.52	43.52	297.51	2.00
2100.00	12.00	297.51	2095.62	28.91	-55.53	62.60	62.60	297.51	2.00
2200.00	14.00	297.51	2193.06	39.30	-75.48	85.10	85.10	297.51	2.00
Begin 14.04° Tangent									
2202.16	14.04	297.51	2195.15	39.54	-75.94	85.62	85.62	297.51	2.00
Begin 2.00°/100' Drop									
6462.18	14.04	297.51	6327.85	516.97	-992.80	1119.33	1119.33	297.51	.00
6562.18	12.04	297.51	6425.26	527.39	-1012.81	1141.90	1141.90	297.51	2.00
6662.18	10.04	297.51	6523.41	536.24	-1029.80	1161.05	1161.05	297.51	2.00
6762.18	8.04	297.51	6622.16	543.49	-1043.74	1176.77	1176.77	297.51	2.00
6862.18	6.04	297.51	6721.40	549.16	-1054.62	1189.03	1189.03	297.51	2.00
6962.18	4.04	297.51	6821.01	553.22	-1062.41	1197.82	1197.82	297.51	2.00
7062.18	2.04	297.51	6920.86	555.67	-1067.12	1203.13	1203.13	297.51	2.00
7162.18	.04	297.51	7020.84	556.51	-1068.74	1204.95	1204.95	297.51	2.00
Begin Vertical Hold									
7164.34	.00	.00	7023.00	556.51	-1068.74	1204.95	1204.95	297.51	2.00



Measured Depth FT	Incl Angle Deg	Drift Direction Deg	True Vertical Depth	N-S FT	E-W FT	Vertical Section FT	CLOSURE Distance FT	Direction Deg	Dogleg Severity Deg/100
Niobrara, 7273'									
7414.34	.00	.00	7273.00	+556.51	-1068.74	1204.95	1204.95	297.51	.00
Ft. Hays, 7568'									
7709.34	.00	.00	7568.00	556.51	-1068.74	1204.95	1204.95	297.51	.00
Codell, 7593'									
7734.34	.00	.00	7593.00	556.51	-1068.74	1204.95	1204.95	297.51	.00
Fairport (Carlile), 7628'									
7769.34	.00	.00	7628.00	556.51	-1068.74	1204.95	1204.95	297.51	.00
Greenhorn, 7678'									
7819.34	.00	.00	7678.00	556.51	-1068.74	1204.95	1204.95	297.51	.00
Graneros, 7843'									
7984.34	.00	.00	7843.00	556.51	-1068.74	1204.95	1204.95	297.51	.00
Mowry, 8003'									
8144.34	.00	.00	8003.00	556.51	-1068.74	1204.95	1204.95	297.51	.00
J Sand, 8011'									
8152.34	.00	.00	8011.00	556.51	-1068.74	1204.95	1204.95	297.51	.00
Skull Creek A Marker, 8098'									
8239.34	.00	.00	8098.00	556.51	-1068.74	1204.95	1204.95	297.51	.00
PBHL									
8302.34	.00	.00	8161.00	556.51	-1068.74	1204.95	1204.95	297.51	.00