



FORM F-106



00051844

RECEIVED

AUG 9 1984

COLO. OIL & GAS CONS. COMM

R. 69W

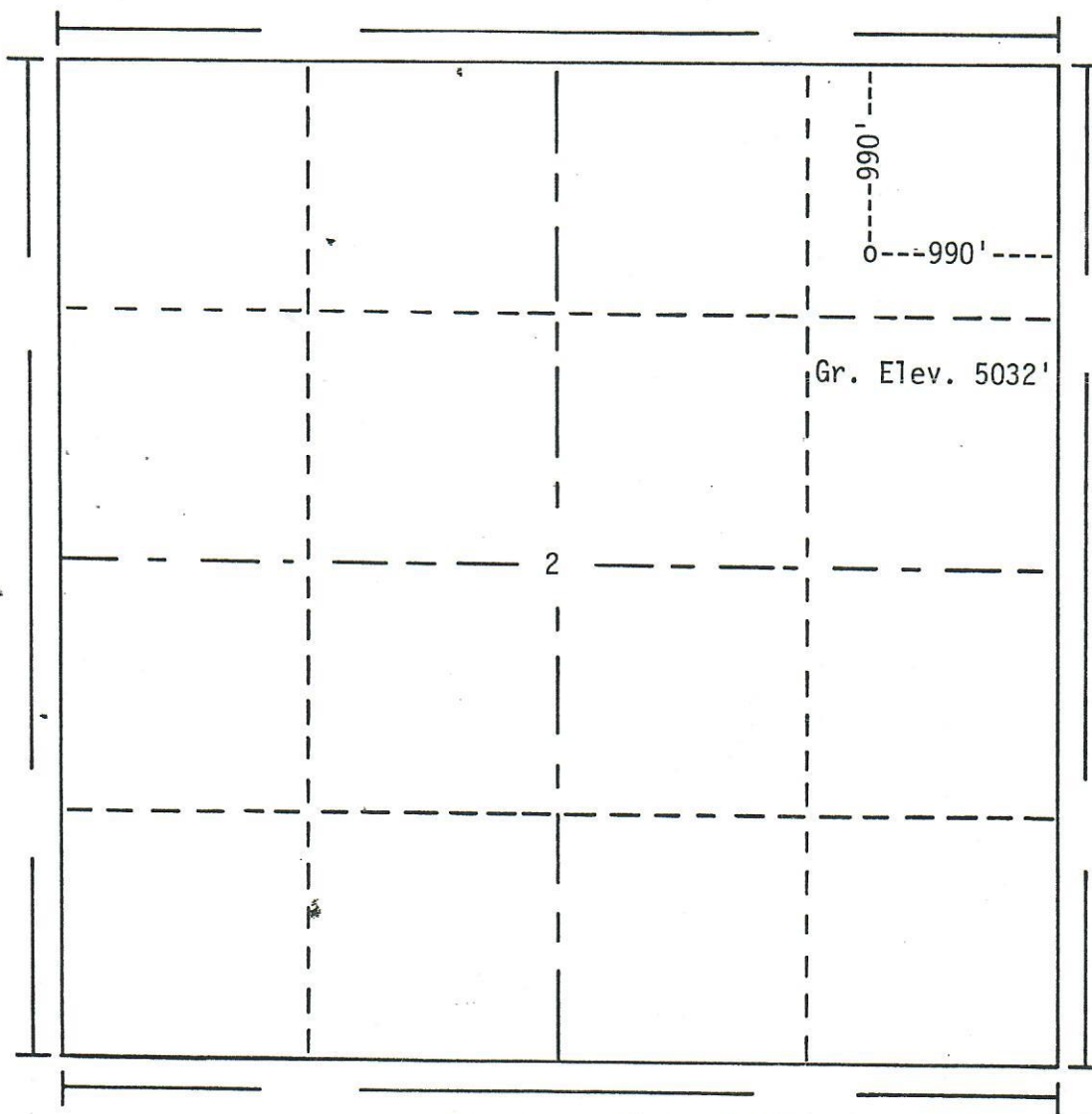

T. 1N

WRS	
FJP	
HHM	
JAM	
RCC	
LAR	
CGM	
ED	

Scale... 1" = 1000'

Powers Elevation of Denver, Colorado
has in accordance with a request from
for Vessels Oil & Gas
determined the location of No.1 Spahn "G" Unit
to be 990'FN & 990'FE Section 2 Township 1N
Range 69W of the 6th Principal Meridian
Boulder County, Colorado

I hereby certify that this plat is an
accurate representation of a correct
survey showing the location of



Date: 8-2-84

Billy G. Holloway
Licensed Land Surveyor No. 2853
State of Colorado