

# A12-07 FACILITY HYDROLOGY MAP

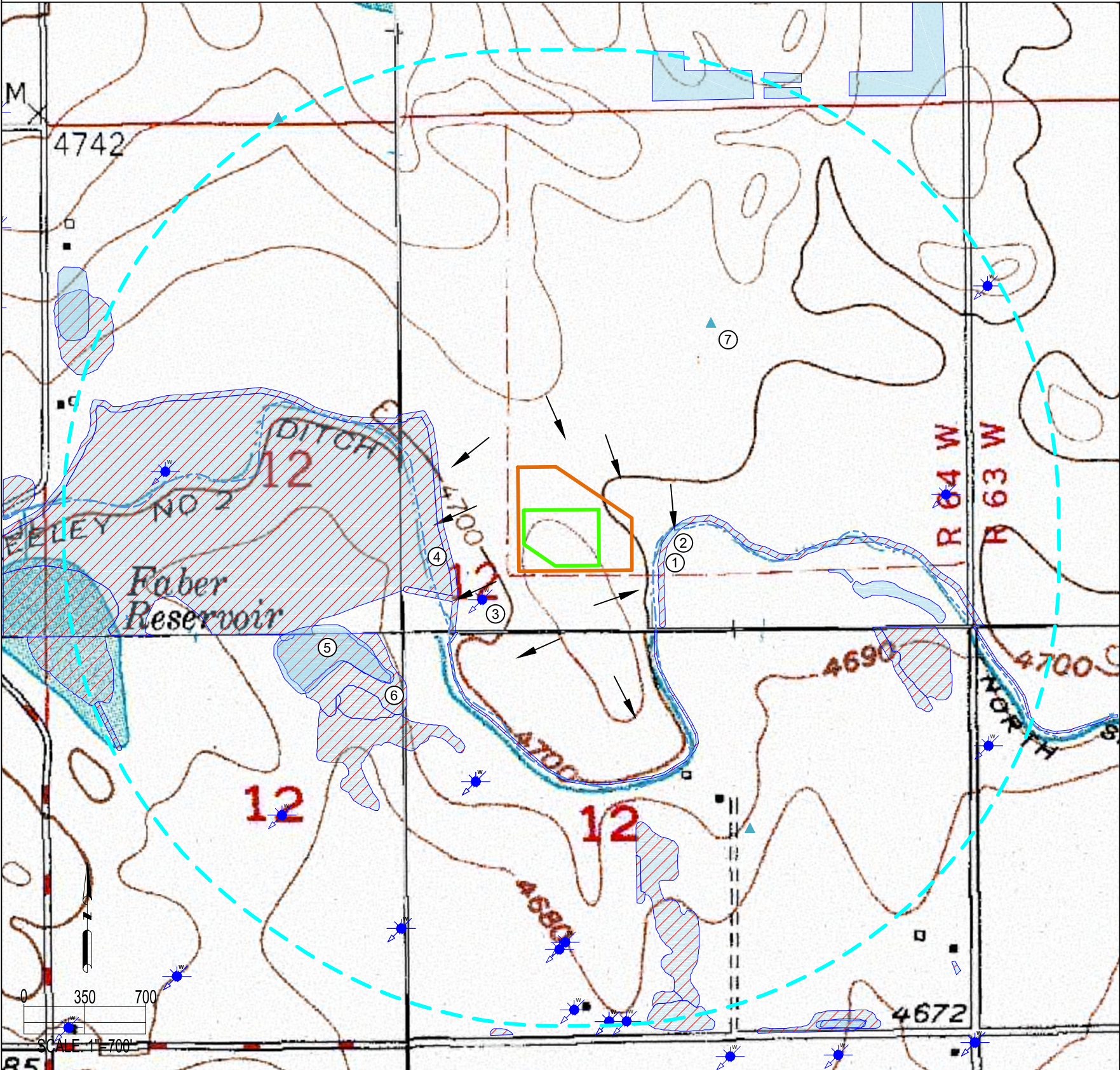

**IMPROVEMENTS:**  
(AS MEASURED FROM THE PROPOSED WORKING PAD SURFACE)

1: GREELEY NUMBER 2 CANAL:	±310' E
2: WETLANDS (RIVERINE) (MAPPED BY USGS):	±337' E
3: WATER WELLS:	±398' SW, ±1320' SW, ±1996' E, ±2068' W, ±2084' SW, ±2160' S, ±2201' S, ±2261' SW, ±2463' SE, ±2548' S, ±2574' NE, ±2618' S, ±2621' S
4: WETLANDS (FRESHWATER EMERGENT) (MAPPED BY USGS):	±453' W, ±986' SW, ±1490' S, ±1609' SE, ±2461' SW
5: PONDS (MAPPED BY ASCENT):	±1056' SW, ±1317' E, ±2364' NE
6: WETLANDS (FRESHWATER PONDS) (MAPPED BY USGS):	±1068' SW, ±1676' S, ±2355' W, ±2533' NW, ±2537' S
7: PIVOT POINTS:	±1252' NE, ±1737' SE

THERE ARE NO PUBLIC WATER SYSTEMS FACILITIES, PWS INTAKES <15 MILES UPSTREAM, OR RULE 411 BUFFER ZONES WITHIN THE 2,640' RADIUS

**NEAREST WATER WELL INFO:**  
(AS MEASURED FROM THE NEAREST EDGE OF THE PROPOSED WORKING PAD SURFACE)

PERMIT #	RECEIPT #	STATIC WATER LEVEL	DISTANCE/DIRECTION
23444	0224484	90'	±398' SW

**NEAREST SURFACE WATER FEATURE:**  
(AS MEASURED FROM THE NEAREST EDGE OF THE PROPOSED WORKING PAD SURFACE)

GREELEY NUMBER 2 CANAL	±310' E
------------------------	---------

DISCLAIMER:  
THIS PLOT DOES NOT REPRESENT A MONUMENTED LAND SURVEY AND SHOULD NOT BE RELIED UPON TO DETERMINE BOUNDARY LINES, PROPERTY OWNERSHIP OR OTHER PROPERTY INTERESTS. PARCEL LINES, IF DEPICTED HAVE NOT BEEN FIELD VERIFIED AND MAY BE BASED UPON PUBLICLY AVAILABLE DATA THAT ALSO HAS NOT BEEN INDEPENDENTLY VERIFIED.

8620 Wolff Court  
Westminster, CO 80031  
(303) 928-7128  
www.ascentgeomatics.com

<b>FIELD DATE:</b> 05-21-21	<b>DRAWING DATE:</b> 08-11-21
<b>DRAWN BY:</b> JDH	<b>CHECKED BY:</b> IJM

**SITE NAME:**  
A12-07 FACILITY

**SURFACE LOCATION:**  
SW 1/4 NE 1/4 SEC. 12, T6N, R64W, 6TH P.M.  
WELD COUNTY, COLORADO

**DATA SOURCE:**  
TOPO MAP: USGS  
WATER WELLS: COLORADO DWR  
NHD: USGS

PUBLICLY AVAILABLE DATA SOURCES HAVE NOT BEEN INDEPENDENTLY VERIFIED BY ASCENT.

**LEGEND:**

- = WATER WELL
- = FLOW DIRECTION
- = PIVOT POINT

- = CANAL
- = DITCH
- = 2640' RADIUS FROM WPS
- = FLOODPLAIN
- = WETLAND
- = POND
- = OIL & GAS LOCATION
- = WORKING PAD SURFACE

PREPARED FOR: