



FORM F-106



00272197

RECEIVED

JUN 14 1974

GOLD. MIN. &amp; GAS CONS. COMM.

N

R. 78 W.

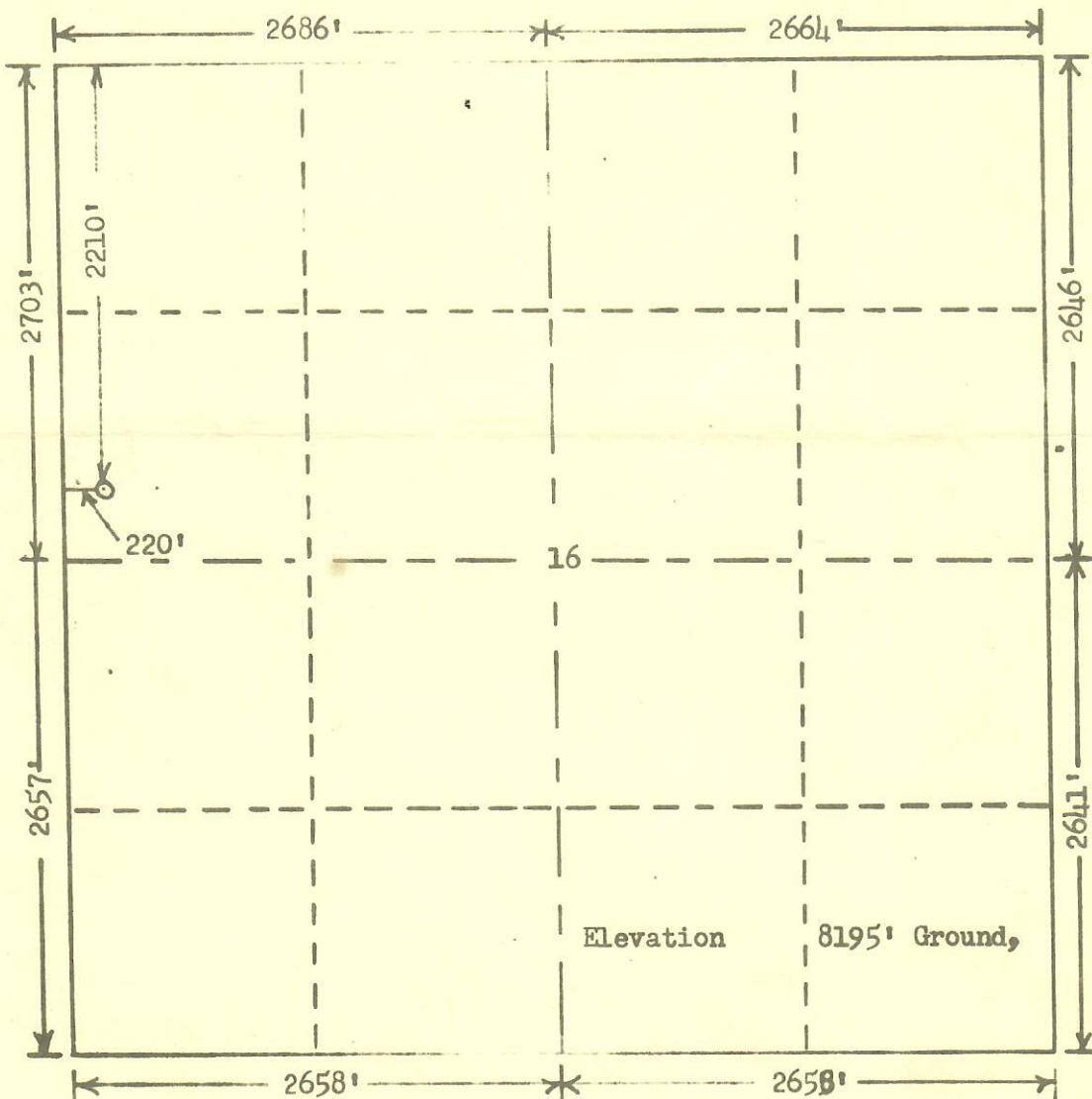
T.  
9  
N

Scale... 1" = 1000'

Powers Elevation Company, Inc. of Denver, Colorado  
has in accordance with a request from Joe Galevich  
for Continental Oil Company  
determined the location of #4 State-16  
to be 2210'FN & 220'FW Section 16 Township 9 N.  
Range 78 W. of the 6th Principal Meridian  
Jackson County, Colorado

I hereby certify that this plat is an  
accurate representation of a correct  
survey showing the location of

#4 State-16

Date: 6-8-74

*Danell T. White*  
Licensed Land Surveyor No. 1671  
State of Colorado