

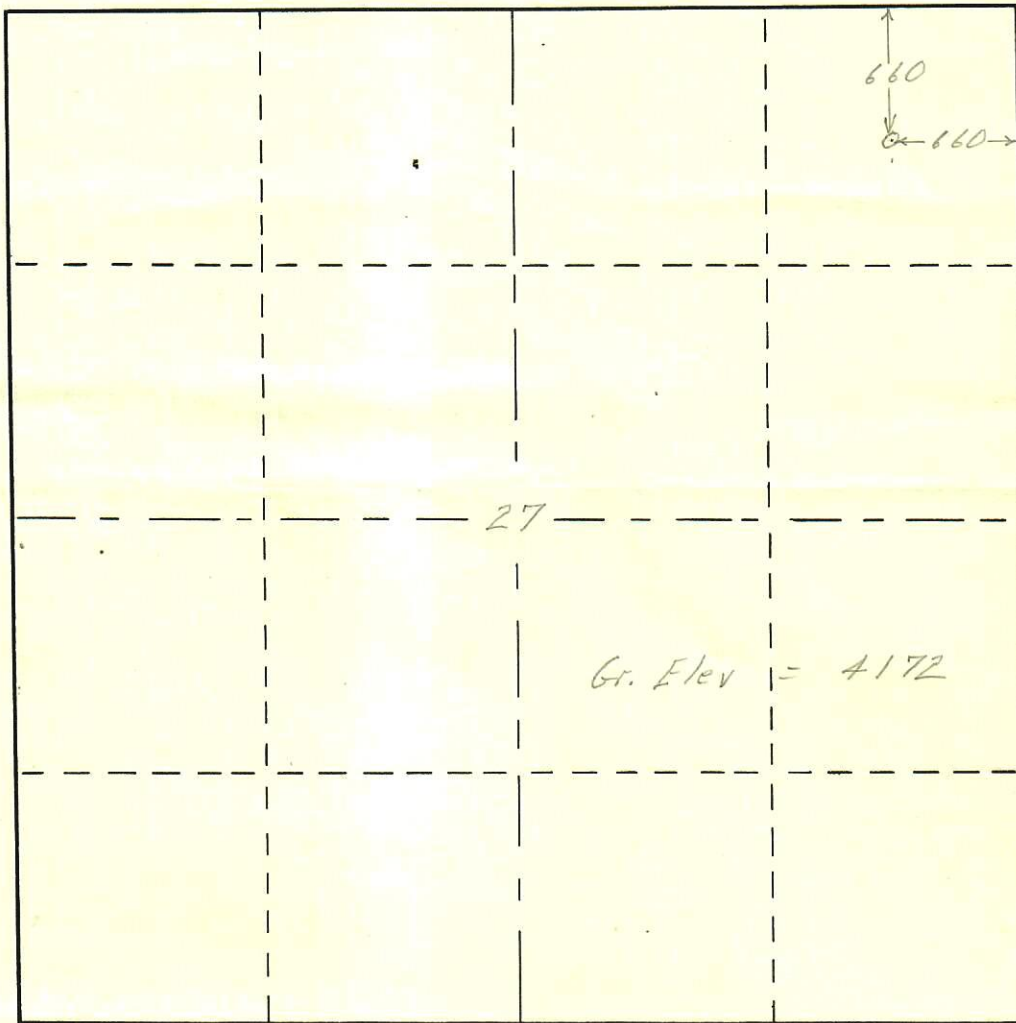

R. 53 W



T.
9
N

Scale ... 1" = 1000'

Powers Elevation Company of Casper, Wyoming
has in accordance with a request from *Mr Paul Speck*
for *Mc Dermott & Barnhart* determined the
Location of *# 1-D Whittier*
to be *C NE NE* Section *27* Township *9N*
Range *53W* of the *Sixth Principal Meridian*
Lagon County, *Colo.*

The above Plat shows the location of the well site
in said section.

Powers Elevation Company

by: *Thomas E Nelson*

Date: *6/17/54*