

POCO Operating

Well Name: Brighton Lakes 20-17-1NCH
 Surface Location: Brighton Lakes Pad Sec.20-T1S-R66W
 North American Datum 1983, US State Plane 1983, Colorado Northern Zone
 Ground Elevation: 5047.0

+N/-S	+E/-W	Northing	Easting	Latitude	Longitude	Slot
0.0	0.0	1223369.35	3195679.33	39.944417	-104.802090	
KB 23' RKB @ 5070.0ft (KB 23')						

ANNOTATIONS

MD	Inc	Azi	TVD	+N/-S	+E/-W	Vsect	Departure	Annotation
0.0	0.00	0.00	0.0	0.0	0.0	0.0	0.0	SHL 400'FSL & 1889'FWL SEC.20
8125.7	87.53	359.98	7536.8	63.2	1441.8	277.1	2200.6	TPZ 8125.7'MD 460'FSL & 1977.4'FEL SEC 20
17787.0	90.75	1.74	7537.0	9721.0	1463.6	9830.6	11860.8	Projection to TD 17787'MD 7537'TVD 90.75 Inc 1.74 AZ
17787.0	90.75	1.74	7537.0	9721.0	1463.6	9830.6	11860.8	BHL 437'FNL & 1969'FEL 9721'N & 1463.6'E of SHL

FINAL SURVEY 0 - 17787'

BHL 437'FNL & 1969'FEL SEC.17 9721'N & 1463.6'E of SHL

Projection to TD 17787'MD 7537'TVD 90.75 inc 1.74 AZ

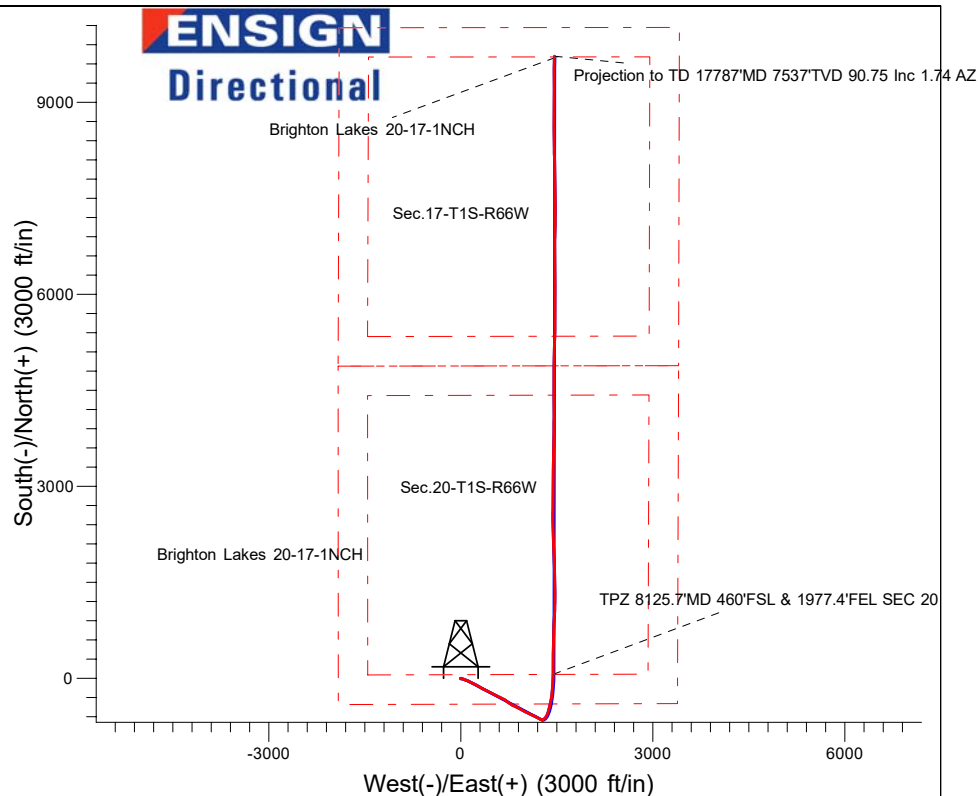

LEGEND

- ✕ Brighton Lakes 20-17-1NCH, Brighton Lakes 20-17-1NCH Wellbore #1, Plan 3 (9-21-21) V0
- Survey #1

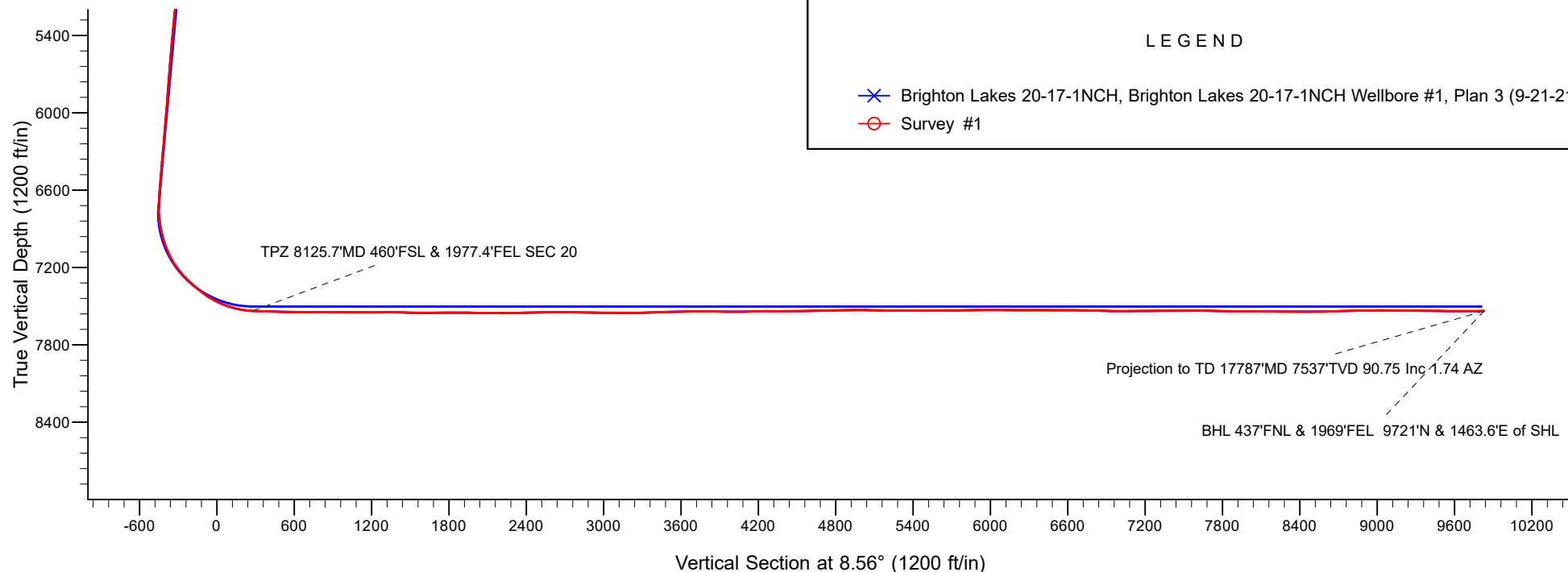



POCO Operating

Sec.20-T1S-R66W

Brighton Lakes Pad Sec.20-T1S-R66W

Brighton Lakes 20-17-1NCH

Brighton Lakes 20-17-1NCH Wellbore #1

Survey: Survey #1

Standard Survey Report

27 September, 2021

Company:	POCO Operating	Local Co-ordinate Reference:	Well Brighton Lakes 20-17-1NCH
Project:	Sec.20-T1S-R66W	TVD Reference:	RKB @ 5070.0ft (KB 23')
Site:	Brighton Lakes Pad Sec.20-T1S-R66W	MD Reference:	RKB @ 5070.0ft (KB 23')
Well:	Brighton Lakes 20-17-1NCH	North Reference:	True
Wellbore:	Brighton Lakes 20-17-1NCH Wellbore #1	Survey Calculation Method:	Minimum Curvature
Design:	Brighton Lakes 20-17-1NCH Wellbore #1	Database:	US_EDM

Survey									
Measured Depth (ft)	Inclination (°)	Azimuth (°)	Vertical Depth (ft)	+N/-S (ft)	+E/-W (ft)	Vertical Section (ft)	Dogleg Rate (°/100usft)	Build Rate (°/100usft)	Turn Rate (°/100usft)
919.3	0.79	346.97	919.3	-2.8	0.8	-2.6	0.15	0.15	1.62
1,006.3	1.27	338.26	1,006.2	-1.3	0.3	-1.2	0.58	0.55	-10.01
1,093.3	0.62	69.58	1,093.2	-0.2	0.4	-0.2	1.64	-0.75	104.97
1,181.3	0.97	97.97	1,181.2	-0.1	1.6	0.1	0.59	0.40	32.26
1,268.3	0.92	121.79	1,268.2	-0.6	2.9	-0.2	0.45	-0.06	27.38
1,355.3	1.14	120.56	1,355.2	-1.4	4.2	-0.8	0.25	0.25	-1.41
1,442.3	3.56	105.53	1,442.1	-2.6	7.6	-1.4	2.85	2.78	-17.28
1,530.3	7.03	104.65	1,529.7	-4.7	15.4	-2.3	3.94	3.94	-1.00
1,617.3	10.55	110.01	1,615.7	-8.8	28.1	-4.5	4.15	4.05	6.16
1,704.3	13.18	110.10	1,700.8	-14.9	44.9	-8.0	3.02	3.02	0.10
1,791.3	15.03	111.77	1,785.2	-22.5	64.7	-12.6	2.18	2.13	1.92
1,846.3	15.16	111.33	1,838.3	-27.7	78.0	-15.8	0.32	0.24	-0.80
1,934.0	15.92	112.83	1,922.8	-36.6	99.8	-21.3	0.98	0.87	1.71
2,023.0	15.83	110.55	2,008.4	-45.6	122.4	-26.9	0.71	-0.10	-2.56
2,113.0	15.74	116.70	2,095.0	-55.4	144.8	-33.2	1.86	-0.10	6.83
2,203.0	15.30	116.35	2,181.7	-66.1	166.3	-40.6	0.50	-0.49	-0.39
2,293.0	14.77	114.59	2,268.7	-76.2	187.4	-47.4	0.78	-0.59	-1.96
2,383.0	15.48	118.28	2,355.5	-86.6	208.4	-54.6	1.33	0.79	4.10
2,473.0	15.04	116.70	2,442.4	-97.6	229.4	-62.3	0.67	-0.49	-1.76
2,562.0	14.60	115.82	2,528.4	-107.7	249.8	-69.3	0.56	-0.49	-0.99
2,651.0	15.12	120.74	2,614.4	-118.5	269.9	-77.0	1.53	0.58	5.53
2,740.0	14.33	120.92	2,700.5	-130.1	289.3	-85.5	0.89	-0.89	0.20
2,829.0	16.27	120.92	2,786.4	-142.1	309.5	-94.5	2.18	2.18	0.00
2,918.0	15.39	120.57	2,872.0	-154.5	330.3	-103.6	0.99	-0.99	-0.39
3,030.0	14.51	119.51	2,980.2	-169.0	355.3	-114.2	0.82	-0.79	-0.95
3,119.0	13.54	118.46	3,066.5	-179.5	374.2	-121.8	1.13	-1.09	-1.18
3,208.0	15.21	114.94	3,152.7	-189.4	393.9	-128.6	2.12	1.88	-3.96
3,298.0	14.33	112.66	3,239.8	-198.6	414.9	-134.6	1.17	-0.98	-2.53
3,387.0	15.74	118.98	3,325.7	-208.7	435.7	-141.5	2.43	1.58	7.10
3,476.0	14.86	116.35	3,411.6	-219.6	456.4	-149.2	1.26	-0.99	-2.96
3,566.0	16.36	119.34	3,498.3	-231.0	477.8	-157.3	1.89	1.67	3.32
3,655.0	15.04	116.52	3,583.9	-242.3	499.1	-165.3	1.71	-1.48	-3.17
3,745.0	14.51	115.82	3,671.0	-252.4	519.7	-172.2	0.62	-0.59	-0.78
3,834.0	16.36	117.93	3,756.7	-263.1	540.8	-179.7	2.17	2.08	2.37
3,923.0	15.39	115.12	3,842.3	-274.0	562.6	-187.2	1.39	-1.09	-3.16
4,013.0	17.41	116.87	3,928.7	-285.2	585.4	-194.8	2.31	2.24	1.94
4,102.0	16.27	115.29	4,013.9	-296.5	608.6	-202.6	1.38	-1.28	-1.78
4,191.0	14.95	113.36	4,099.6	-306.4	630.4	-209.1	1.59	-1.48	-2.17
4,281.0	16.62	117.75	4,186.2	-317.0	652.4	-216.3	2.28	1.86	4.88
4,370.0	15.39	116.87	4,271.7	-328.2	674.2	-224.2	1.41	-1.38	-0.99
4,460.0	16.36	125.66	4,358.3	-341.0	695.2	-233.7	2.88	1.08	9.77
4,550.0	15.04	125.84	4,445.0	-355.3	714.9	-244.9	1.47	-1.47	0.20
4,639.0	17.59	126.02	4,530.4	-369.9	735.2	-256.4	2.87	2.87	0.20

Company:	POCO Operating	Local Co-ordinate Reference:	Well Brighton Lakes 20-17-1NCH
Project:	Sec.20-T1S-R66W	TVD Reference:	RKB @ 5070.0ft (KB 23')
Site:	Brighton Lakes Pad Sec.20-T1S-R66W	MD Reference:	RKB @ 5070.0ft (KB 23')
Well:	Brighton Lakes 20-17-1NCH	North Reference:	True
Wellbore:	Brighton Lakes 20-17-1NCH Wellbore #1	Survey Calculation Method:	Minimum Curvature
Design:	Brighton Lakes 20-17-1NCH Wellbore #1	Database:	US_EDM

Survey									
Measured Depth (ft)	Inclination (°)	Azimuth (°)	Vertical Depth (ft)	+N/-S (ft)	+E/-W (ft)	Vertical Section (ft)	Dogleg Rate (°/100usft)	Build Rate (°/100usft)	Turn Rate (°/100usft)
4,728.0	16.27	126.72	4,615.5	-385.3	756.1	-268.4	1.50	-1.48	0.79
4,818.0	15.48	125.14	4,702.1	-399.8	776.0	-279.8	1.00	-0.88	-1.76
4,907.0	15.74	117.40	4,787.8	-412.1	796.4	-289.0	2.36	0.29	-8.70
4,996.0	14.51	115.82	4,873.7	-422.6	817.2	-296.2	1.46	-1.38	-1.78
5,086.0	16.53	116.87	4,960.4	-433.3	838.7	-303.6	2.27	2.24	1.17
5,175.0	16.00	116.87	5,045.9	-444.5	861.0	-311.4	0.60	-0.60	0.00
5,264.0	15.56	116.70	5,131.5	-455.4	882.6	-319.0	0.50	-0.49	-0.19
5,353.0	14.68	115.64	5,217.4	-465.7	903.4	-326.0	1.04	-0.99	-1.19
5,442.0	16.53	119.16	5,303.1	-476.7	924.6	-333.7	2.33	2.08	3.96
5,532.0	15.39	118.63	5,389.7	-488.7	946.3	-342.3	1.28	-1.27	-0.59
5,621.0	13.63	117.93	5,475.8	-499.3	965.9	-349.9	1.99	-1.98	-0.79
5,710.0	14.95	118.81	5,562.1	-509.7	985.3	-357.3	1.50	1.48	0.99
5,799.0	13.98	118.63	5,648.3	-520.4	1,004.8	-365.0	1.09	-1.09	-0.20
5,888.0	16.00	116.00	5,734.2	-530.9	1,025.2	-372.4	2.39	2.27	-2.96
5,977.0	14.51	114.41	5,820.1	-540.9	1,046.4	-379.1	1.74	-1.67	-1.79
6,066.0	15.39	114.06	5,906.1	-550.3	1,067.3	-385.3	0.99	0.99	-0.39
6,156.0	13.63	112.66	5,993.2	-559.3	1,088.0	-391.1	1.99	-1.96	-1.56
6,245.0	14.07	117.58	6,079.6	-568.3	1,107.3	-397.1	1.41	0.49	5.53
6,335.0	15.83	116.87	6,166.6	-578.9	1,127.9	-404.6	1.97	1.96	-0.79
6,425.0	17.06	118.81	6,252.9	-590.8	1,150.5	-413.0	1.50	1.37	2.16
6,514.0	16.00	117.58	6,338.2	-602.8	1,172.8	-421.5	1.25	-1.19	-1.38
6,604.0	14.51	114.77	6,425.0	-613.3	1,194.0	-428.7	1.85	-1.66	-3.12
6,693.0	16.09	116.52	6,510.9	-623.5	1,215.2	-435.6	1.85	1.78	1.97
6,782.0	14.51	115.12	6,596.7	-633.7	1,236.3	-442.6	1.82	-1.78	-1.57
6,872.0	13.45	116.52	6,684.1	-643.2	1,255.9	-449.0	1.24	-1.18	1.56
6,961.0	12.75	89.98	6,770.8	-647.8	1,275.0	-450.7	6.75	-0.79	-29.82
7,051.0	13.45	58.52	6,858.6	-642.3	1,293.8	-442.5	7.86	0.78	-34.96
7,140.0	17.23	41.64	6,944.4	-627.0	1,311.4	-424.8	6.53	4.25	-18.97
7,230.0	21.37	34.08	7,029.4	-603.5	1,329.5	-398.8	5.36	4.60	-8.40
7,319.0	26.82	24.41	7,110.6	-571.7	1,346.9	-364.8	7.54	6.12	-10.87
7,408.0	34.91	17.03	7,187.0	-529.0	1,362.7	-320.2	10.02	9.09	-8.29
7,497.0	41.94	14.57	7,256.7	-475.8	1,377.7	-265.4	8.08	7.90	-2.76
7,587.0	48.89	12.46	7,319.8	-413.5	1,392.6	-201.6	7.90	7.72	-2.34
7,676.0	50.56	11.58	7,377.3	-347.1	1,406.7	-133.8	2.02	1.88	-0.99
7,766.0	57.42	7.36	7,430.2	-275.3	1,418.5	-61.1	8.51	7.62	-4.69
7,855.0	65.86	5.08	7,472.5	-197.6	1,427.0	17.1	9.75	9.48	-2.56
7,944.0	72.11	4.37	7,504.4	-114.8	1,433.8	99.9	7.06	7.02	-0.80
8,033.0	79.23	3.14	7,526.4	-28.8	1,439.4	185.8	8.11	8.00	-1.38
8,122.0	87.49	359.98	7,536.7	59.5	1,441.8	273.5	9.93	9.28	-3.55
8,125.7	87.53	359.98	7,536.8	63.2	1,441.8	277.1	1.08	1.08	0.00
TPZ 8125.7'MD 460'FSL & 1977.4'FEL SEC 20									
8,212.0	88.46	359.98	7,539.9	149.4	1,441.8	362.4	1.08	1.08	0.00
8,302.0	88.90	359.63	7,541.9	239.4	1,441.5	451.3	0.62	0.49	-0.39

Company:	POCO Operating	Local Co-ordinate Reference:	Well Brighton Lakes 20-17-1NCH
Project:	Sec.20-T1S-R66W	TVD Reference:	RKB @ 5070.0ft (KB 23')
Site:	Brighton Lakes Pad Sec.20-T1S-R66W	MD Reference:	RKB @ 5070.0ft (KB 23')
Well:	Brighton Lakes 20-17-1NCH	North Reference:	True
Wellbore:	Brighton Lakes 20-17-1NCH Wellbore #1	Survey Calculation Method:	Minimum Curvature
Design:	Brighton Lakes 20-17-1NCH Wellbore #1	Database:	US_EDM

Survey									
Measured Depth (ft)	Inclination (°)	Azimuth (°)	Vertical Depth (ft)	+N/-S (ft)	+E/-W (ft)	Vertical Section (ft)	Dogleg Rate (°/100usft)	Build Rate (°/100usft)	Turn Rate (°/100usft)
8,391.0	88.90	1.74	7,543.6	328.4	1,442.5	539.5	2.37	0.00	2.37
8,481.0	89.08	1.39	7,545.2	418.3	1,445.0	628.8	0.44	0.20	-0.39
8,571.0	89.52	1.21	7,546.3	508.3	1,447.0	718.1	0.53	0.49	-0.20
8,660.0	89.96	1.21	7,546.7	597.3	1,448.9	806.3	0.49	0.49	0.00
8,750.0	89.34	1.56	7,547.3	687.2	1,451.1	895.6	0.79	-0.69	0.39
8,839.0	89.60	1.39	7,548.1	776.2	1,453.4	983.9	0.35	0.29	-0.19
8,928.0	90.31	2.26	7,548.2	865.2	1,456.2	1,072.3	1.26	0.80	0.98
9,018.0	89.60	1.91	7,548.2	955.1	1,459.5	1,161.7	0.88	-0.79	-0.39
9,107.0	91.54	4.20	7,547.4	1,044.0	1,464.2	1,250.3	3.37	2.18	2.57
9,197.0	89.34	1.21	7,546.7	1,133.8	1,468.5	1,339.8	4.12	-2.44	-3.32
9,286.0	88.81	359.98	7,548.1	1,222.8	1,469.4	1,428.0	1.50	-0.60	-1.38
9,376.0	88.81	359.98	7,550.0	1,312.8	1,469.4	1,516.9	0.00	0.00	0.00
9,466.0	88.81	359.80	7,551.8	1,402.8	1,469.2	1,605.9	0.20	0.00	-0.20
9,555.0	91.10	359.10	7,551.9	1,491.8	1,468.3	1,693.8	2.69	2.57	-0.79
9,645.0	91.54	359.28	7,549.8	1,581.7	1,467.1	1,782.5	0.53	0.49	0.20
9,734.0	88.90	358.22	7,549.5	1,670.7	1,465.1	1,870.2	3.20	-2.97	-1.19
9,824.0	88.72	357.34	7,551.4	1,760.6	1,461.6	1,958.6	1.00	-0.20	-0.98
9,913.0	90.13	359.28	7,552.3	1,849.6	1,459.0	2,046.2	2.69	1.58	2.18
10,002.0	89.16	357.17	7,552.8	1,938.5	1,456.3	2,133.7	2.61	-1.09	-2.37
10,092.0	89.78	357.17	7,553.6	2,028.4	1,451.8	2,221.9	0.69	0.69	0.00
10,182.0	91.45	358.22	7,552.7	2,118.3	1,448.2	2,310.3	2.19	1.86	1.17
10,271.0	91.19	357.69	7,550.6	2,207.2	1,445.0	2,397.8	0.66	-0.29	-0.60
10,361.0	91.36	356.82	7,548.6	2,297.1	1,440.7	2,486.0	0.98	0.19	-0.97
10,450.0	90.57	359.80	7,547.1	2,386.0	1,438.1	2,573.6	3.46	-0.89	3.35
10,540.0	90.57	358.93	7,546.2	2,476.0	1,437.1	2,662.4	0.97	0.00	-0.97
10,630.0	88.99	1.39	7,546.6	2,566.0	1,437.3	2,751.4	3.25	-1.76	2.73
10,719.0	88.64	1.39	7,548.4	2,655.0	1,439.5	2,839.7	0.39	-0.39	0.00
10,809.0	89.34	1.03	7,550.0	2,744.9	1,441.4	2,929.0	0.87	0.78	-0.40
10,899.0	89.69	1.03	7,550.8	2,834.9	1,443.0	3,018.2	0.39	0.39	0.00
10,988.0	89.78	0.68	7,551.2	2,923.9	1,444.3	3,106.4	0.41	0.10	-0.39
11,077.0	89.52	0.51	7,551.7	3,012.9	1,445.3	3,194.5	0.35	-0.29	-0.19
11,167.0	91.19	0.33	7,551.2	3,102.9	1,445.9	3,283.6	1.87	1.86	-0.20
11,256.0	91.71	0.51	7,548.9	3,191.9	1,446.6	3,371.7	0.62	0.58	0.20
11,345.0	91.89	359.80	7,546.1	3,280.8	1,446.8	3,459.7	0.82	0.20	-0.80
11,435.0	92.24	359.28	7,542.9	3,370.8	1,446.1	3,548.5	0.70	0.39	-0.58
11,524.0	90.22	1.21	7,541.0	3,459.7	1,446.5	3,636.5	3.14	-2.27	2.17
11,613.0	91.28	1.74	7,539.8	3,548.7	1,448.8	3,724.8	1.33	1.19	0.60
11,702.0	88.37	1.03	7,540.1	3,637.7	1,450.9	3,813.1	3.37	-3.27	-0.80
11,792.0	88.46	0.86	7,542.6	3,727.6	1,452.4	3,902.3	0.21	0.10	-0.19
11,881.0	90.40	1.03	7,543.4	3,816.6	1,453.9	3,990.5	2.19	2.18	0.19
11,970.0	90.04	359.98	7,543.1	3,905.6	1,454.7	4,078.6	1.25	-0.40	-1.18
12,060.0	92.95	2.09	7,540.8	3,995.5	1,456.3	4,167.8	3.99	3.23	2.34
12,150.0	90.22	1.56	7,538.3	4,085.4	1,459.1	4,257.1	3.09	-3.03	-0.59
12,239.0	89.60	359.80	7,538.4	4,174.4	1,460.2	4,345.3	2.10	-0.70	-1.98

Company:	POCO Operating	Local Co-ordinate Reference:	Well Brighton Lakes 20-17-1NCH
Project:	Sec.20-T1S-R66W	TVD Reference:	RKB @ 5070.0ft (KB 23')
Site:	Brighton Lakes Pad Sec.20-T1S-R66W	MD Reference:	RKB @ 5070.0ft (KB 23')
Well:	Brighton Lakes 20-17-1NCH	North Reference:	True
Wellbore:	Brighton Lakes 20-17-1NCH Wellbore #1	Survey Calculation Method:	Minimum Curvature
Design:	Brighton Lakes 20-17-1NCH Wellbore #1	Database:	US_EDM

Survey									
Measured Depth (ft)	Inclination (°)	Azimuth (°)	Vertical Depth (ft)	+N/-S (ft)	+E/-W (ft)	Vertical Section (ft)	Dogleg Rate (°/100usft)	Build Rate (°/100usft)	Turn Rate (°/100usft)
12,329.0	89.87	357.52	7,538.8	4,264.4	1,458.1	4,434.0	2.55	0.30	-2.53
12,419.0	90.57	358.93	7,538.5	4,354.3	1,455.3	4,522.5	1.75	0.78	1.57
12,508.0	91.28	359.10	7,537.0	4,443.3	1,453.8	4,610.2	0.82	0.80	0.19
12,596.0	91.71	358.75	7,534.7	4,531.3	1,452.1	4,697.0	0.63	0.49	-0.40
12,686.0	91.28	1.03	7,532.4	4,621.2	1,452.0	4,785.9	2.58	-0.48	2.53
12,774.0	90.31	1.74	7,531.2	4,709.2	1,454.1	4,873.2	1.37	-1.10	0.81
12,864.0	90.84	1.03	7,530.3	4,799.2	1,456.3	4,962.5	0.98	0.59	-0.79
12,953.0	88.55	1.21	7,530.7	4,888.1	1,458.0	5,050.7	2.58	-2.57	0.20
13,042.0	89.43	0.68	7,532.3	4,977.1	1,459.5	5,138.9	1.15	0.99	-0.60
13,131.0	89.78	0.51	7,532.9	5,066.1	1,460.4	5,227.1	0.44	0.39	-0.19
13,221.0	89.60	1.03	7,533.4	5,156.1	1,461.6	5,316.2	0.61	-0.20	0.58
13,310.0	89.96	1.39	7,533.8	5,245.1	1,463.5	5,404.5	0.57	0.40	0.40
13,399.0	90.66	1.74	7,533.3	5,334.0	1,465.9	5,492.8	0.88	0.79	0.39
13,488.0	90.66	1.74	7,532.2	5,423.0	1,468.6	5,581.2	0.00	0.00	0.00
13,578.0	89.96	0.33	7,531.8	5,513.0	1,470.2	5,670.4	1.75	-0.78	-1.57
13,667.0	89.87	0.16	7,531.9	5,602.0	1,470.6	5,758.5	0.22	-0.10	-0.19
13,757.0	90.66	0.33	7,531.5	5,692.0	1,471.0	5,847.5	0.90	0.88	0.19
13,847.0	91.36	0.16	7,529.9	5,782.0	1,471.4	5,936.6	0.80	0.78	-0.19
13,936.0	89.60	359.98	7,529.1	5,871.0	1,471.5	6,024.6	1.99	-1.98	-0.20
14,026.0	89.34	0.16	7,530.0	5,961.0	1,471.6	6,113.6	0.35	-0.29	0.20
14,115.0	89.60	0.51	7,530.8	6,049.9	1,472.1	6,201.7	0.49	0.29	0.39
14,204.0	90.13	0.51	7,531.0	6,138.9	1,472.9	6,289.8	0.60	0.60	0.00
14,294.0	89.96	359.80	7,530.9	6,228.9	1,473.2	6,378.8	0.81	-0.19	-0.79
14,384.0	89.60	358.05	7,531.3	6,318.9	1,471.5	6,467.6	1.99	-0.40	-1.94
14,473.0	90.31	358.75	7,531.4	6,407.9	1,469.0	6,555.2	1.12	0.80	0.79
14,563.0	89.60	359.80	7,531.4	6,497.9	1,467.8	6,644.0	1.41	-0.79	1.17
14,652.0	88.64	0.16	7,532.8	6,586.9	1,467.8	6,732.0	1.15	-1.08	0.40
14,741.0	88.72	359.98	7,534.8	6,675.8	1,467.9	6,820.0	0.22	0.09	-0.20
14,831.0	88.72	359.80	7,536.9	6,765.8	1,467.8	6,908.9	0.20	0.00	-0.20
14,920.0	89.87	0.68	7,537.9	6,854.8	1,468.1	6,997.0	1.63	1.29	0.99
15,009.0	90.31	1.91	7,537.8	6,943.8	1,470.1	7,085.3	1.47	0.49	1.38
15,099.0	90.22	3.32	7,537.4	7,033.7	1,474.2	7,174.8	1.57	-0.10	1.57
15,188.0	90.40	0.33	7,536.9	7,122.6	1,477.1	7,263.2	3.37	0.20	-3.36
15,277.0	90.48	0.33	7,536.2	7,211.6	1,477.6	7,351.2	0.09	0.09	0.00
15,367.0	90.75	358.57	7,535.3	7,301.6	1,476.7	7,440.1	1.98	0.30	-1.96
15,457.0	89.78	359.28	7,534.8	7,391.6	1,475.0	7,528.8	1.34	-1.08	0.79
15,546.0	90.13	359.63	7,534.9	7,480.6	1,474.2	7,616.7	0.56	0.39	0.39
15,636.0	88.46	359.28	7,536.0	7,570.6	1,473.3	7,705.6	1.90	-1.86	-0.39
15,726.0	88.81	358.93	7,538.2	7,660.5	1,471.9	7,794.3	0.55	0.39	-0.39
15,815.0	89.43	359.45	7,539.5	7,749.5	1,470.7	7,882.1	0.91	0.70	0.58
15,905.0	90.22	359.80	7,539.8	7,839.5	1,470.1	7,971.0	0.96	0.88	0.39
15,994.0	89.16	358.93	7,540.3	7,928.5	1,469.1	8,058.9	1.54	-1.19	-0.98
16,084.0	89.78	358.93	7,541.1	8,018.5	1,467.4	8,147.6	0.69	0.69	0.00

Company:	POCO Operating	Local Co-ordinate Reference:	Well Brighton Lakes 20-17-1NCH
Project:	Sec.20-T1S-R66W	TVD Reference:	RKB @ 5070.0ft (KB 23')
Site:	Brighton Lakes Pad Sec.20-T1S-R66W	MD Reference:	RKB @ 5070.0ft (KB 23')
Well:	Brighton Lakes 20-17-1NCH	North Reference:	True
Wellbore:	Brighton Lakes 20-17-1NCH Wellbore #1	Survey Calculation Method:	Minimum Curvature
Design:	Brighton Lakes 20-17-1NCH Wellbore #1	Database:	US_EDM

Survey										
Measured Depth (ft)	Inclination (°)	Azimuth (°)	Vertical Depth (ft)	+N/-S (ft)	+E/-W (ft)	Vertical Section (ft)	Dogleg Rate (°/100usft)	Build Rate (°/100usft)	Turn Rate (°/100usft)	
16,174.0	89.34	358.22	7,541.8	8,108.5	1,465.2	8,236.2	0.93	-0.49	-0.79	
16,263.0	88.90	357.52	7,543.2	8,197.4	1,461.9	8,323.7	0.93	-0.49	-0.79	
16,352.0	91.36	359.63	7,543.0	8,286.3	1,459.7	8,411.3	3.64	2.76	2.37	
16,441.0	90.40	358.57	7,541.6	8,375.3	1,458.3	8,499.1	1.61	-1.08	-1.19	
16,530.0	90.13	359.10	7,541.2	8,464.3	1,456.4	8,586.8	0.67	-0.30	0.60	
16,620.0	91.54	0.51	7,539.9	8,554.3	1,456.1	8,675.7	2.22	1.57	1.57	
16,709.0	91.71	0.51	7,537.4	8,643.2	1,456.9	8,763.8	0.19	0.19	0.00	
16,798.0	91.63	0.33	7,534.8	8,732.2	1,457.6	8,851.9	0.22	-0.09	-0.20	
16,888.0	91.28	0.33	7,532.5	8,822.2	1,458.1	8,940.9	0.39	-0.39	0.00	
16,978.0	89.52	1.03	7,531.9	8,912.2	1,459.2	9,030.1	2.10	-1.96	0.78	
17,066.0	89.34	359.80	7,532.7	9,000.2	1,459.8	9,117.2	1.41	-0.20	-1.40	
17,156.0	89.78	359.63	7,533.4	9,090.2	1,459.4	9,206.1	0.52	0.49	-0.19	
17,245.0	89.25	359.45	7,534.2	9,179.1	1,458.6	9,294.0	0.63	-0.60	-0.20	
17,335.0	89.25	359.98	7,535.4	9,269.1	1,458.2	9,382.9	0.59	0.00	0.59	
17,424.0	89.25	359.10	7,536.5	9,358.1	1,457.5	9,470.8	0.99	0.00	-0.99	
17,513.0	88.99	359.80	7,537.9	9,447.1	1,456.6	9,558.7	0.84	-0.29	0.79	
17,603.0	89.87	1.74	7,538.8	9,537.1	1,457.8	9,647.8	2.37	0.98	2.16	
17,693.0	90.84	1.91	7,538.2	9,627.0	1,460.7	9,737.2	1.09	1.08	0.19	
17,727.0	90.75	1.74	7,537.8	9,661.0	1,461.8	9,771.0	0.57	-0.26	-0.50	
17,787.0	90.75	1.74	7,537.0	9,721.0	1,463.6	9,830.6	0.00	0.00	0.00	
Projection to TD 17787'MD 7537'TVD 90.75 Inc 1.74 AZ - BHL 437'FNL & 1969'FEL 9721'N & 1463.6'E of SHL										

Survey Annotations				
Measured Depth (ft)	Vertical Depth (ft)	Local Coordinates		Comment
		+N/-S (ft)	+E/-W (ft)	
0.0	0.0	0.0	0.0	SHL 400'FSL & 1889'FWL SEC.20
8,125.7	7,536.8	63.2	1,441.8	TPZ 8125.7'MD 460'FSL & 1977.4'FEL SEC 20
17,787.0	7,537.0	9,721.0	1,463.6	Projection to TD 17787'MD 7537'TVD 90.75 Inc 1.74 AZ
17,787.0	7,537.0	9,721.0	1,463.6	BHL 437'FNL & 1969'FEL 9721'N & 1463.6'E of SHL

Checked By: _____	Approved By: _____	Date: _____
-------------------	--------------------	-------------