



00300299

RECEIVED

OCT 16 1970

R. 52W

COLO. OIL & GAS CONS. COMM.

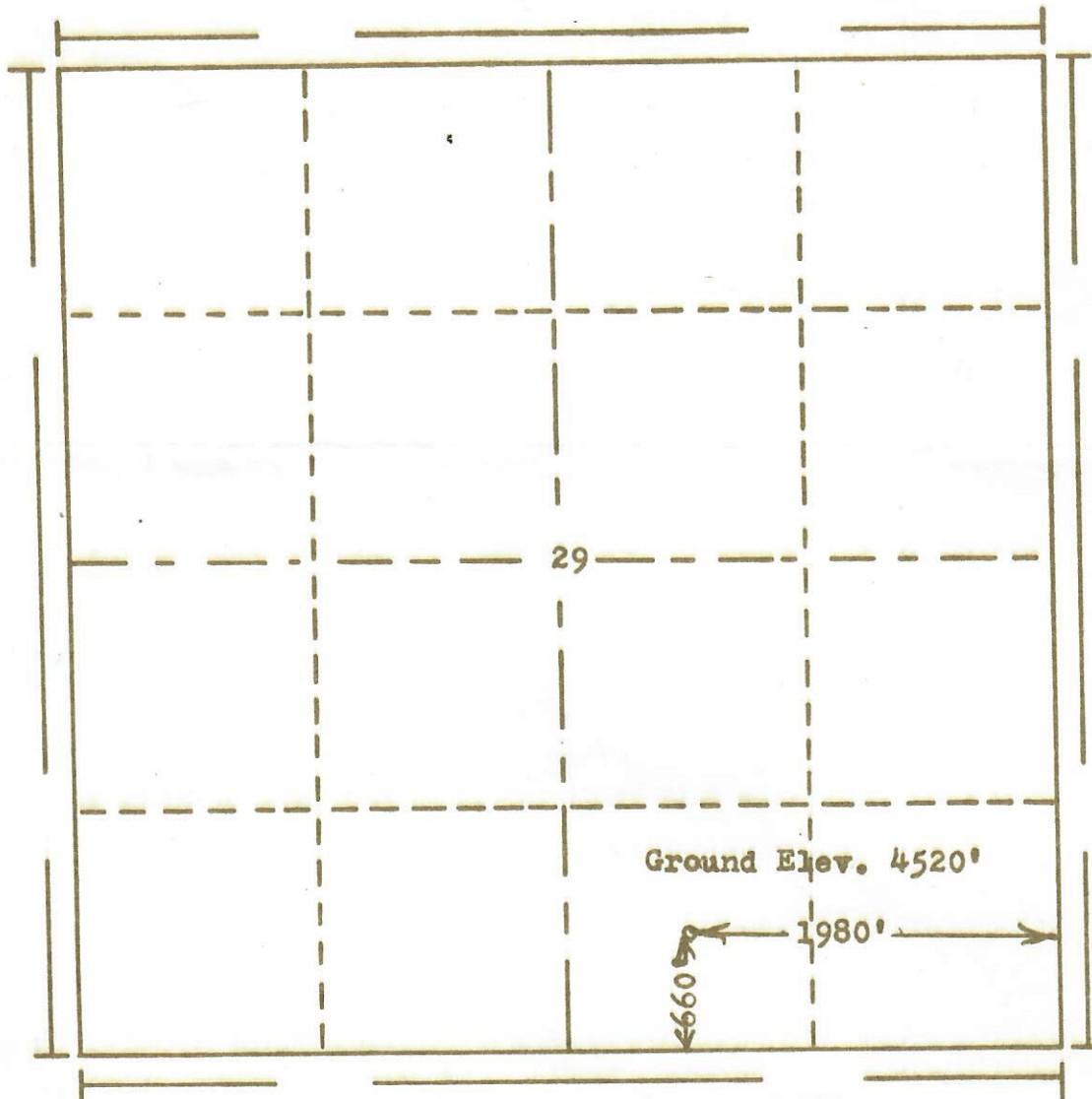
T.
12
N

Scale... 1" = 1000'

Powers Elevation Company, Inc. of Denver, Colorado
has in accordance with a request from Mr. Dahmer
for Edward Mike Davis
determined the location of No. 1-29 Dallegge
to be CSW SE Section 29 Township 12N
Range 52W of the 6th Principal Meridian
Logan County, Colorado

I hereby certify that this plat is an
accurate representation of a correct
survey showing the location of

Date: 9-11-70

B. J. Hoenes
Licensed Land Surveyor No. 2853
State of Colorado