



FORM F-106



00273012

RECEIVED • N

JUN 17 1974

GOLD. OIL & GAS. CONS. COMM.

R. 91 W.

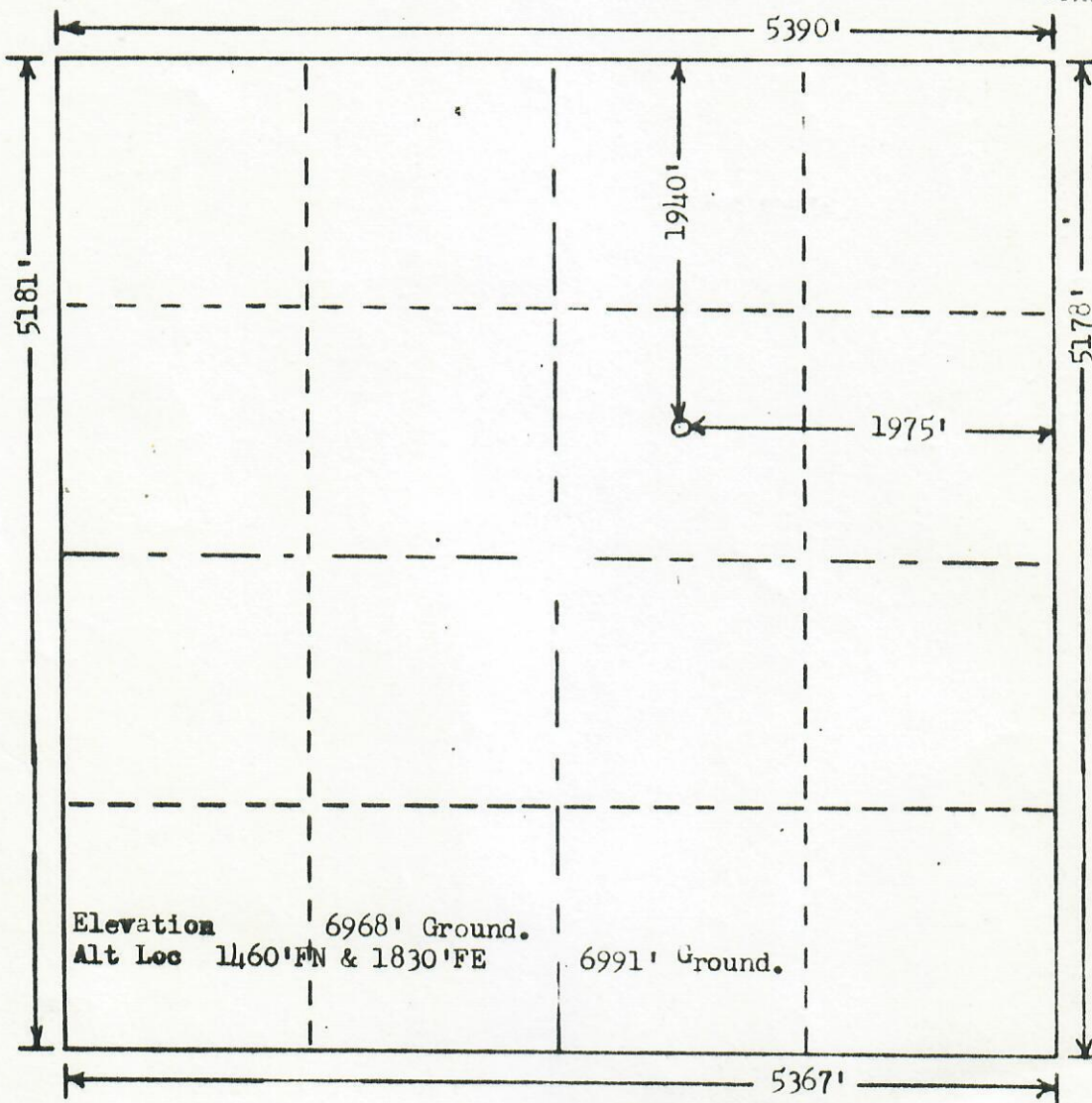

T.

Scale... 1" = 1000'

Powers Elevation Company, Inc. of Denver, Colorado
has in accordance with a request from Mr. Horan
for Equity Oil Company & C. K. Petroleum

determined the location of #1 Federal-1-20 ?
to be 1940'FN & 1975'FE Section 9 Township 9 N.
Range 91 W. of the 6th Principal Meridian
Moffat County, * 20 Colorado

I hereby certify that this plat is an
accurate representation of a correct
survey showing the location of

#1-20 Federal

Date: 5-31-74

L. Russell T. White

Licensed Land Surveyor No 1-71
State of Colorado

* AS PER