

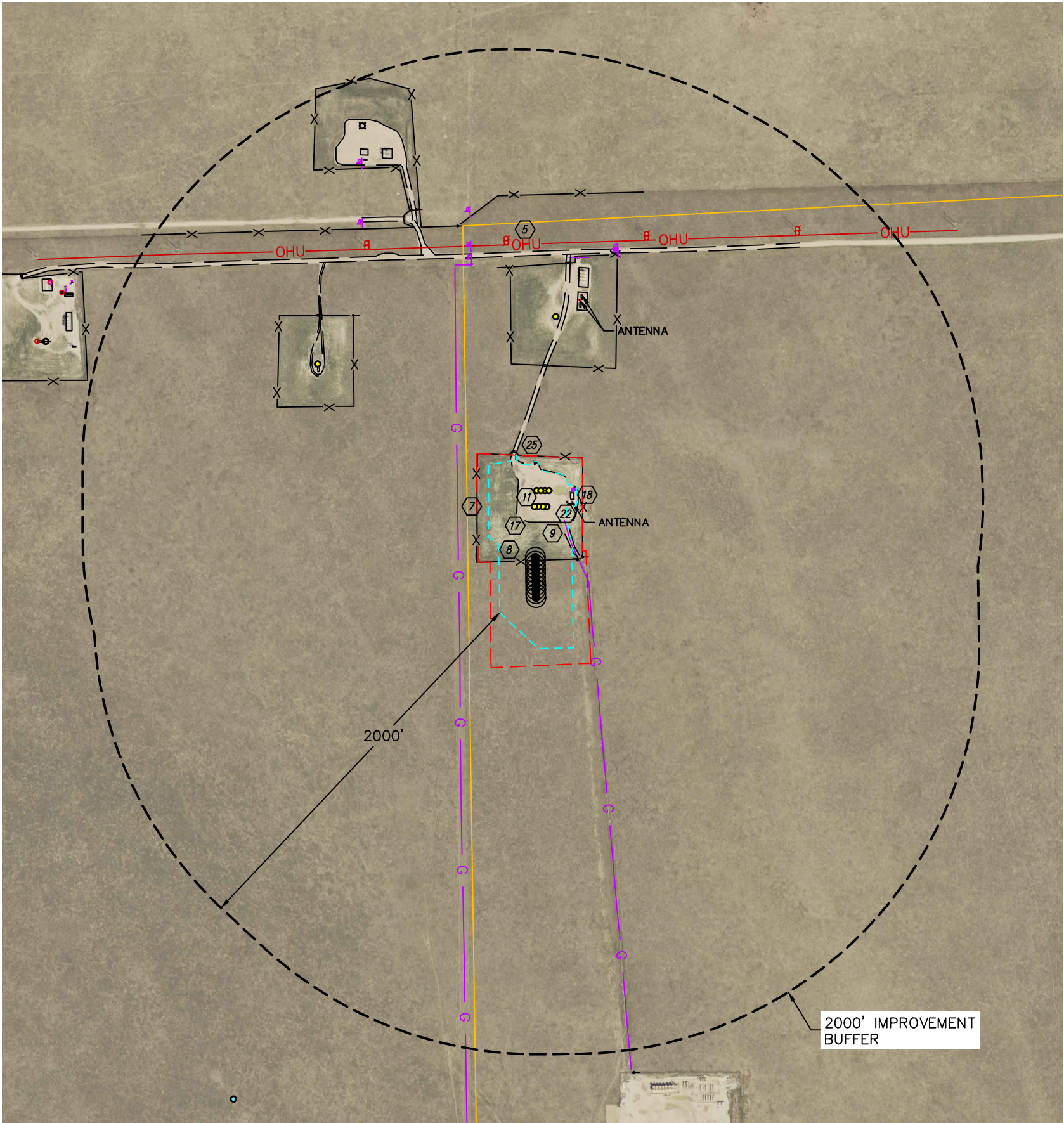

Lat40°, Inc. 6250 W. 10th Street, Unit 2, Greeley, CO 970-515-5294

LOCATION DRAWING  
STATE ANTELOPE B-2 PAD  
BONANZA CREEK ENERGY OPERATING COMPANY LLC

SECTION: 2  
TOWNSHIP: 5N  
RANGE: 62W  
6TH. P.M.  
WELD COUNTY, CO



ID	IMPROVEMENT	DISTANCES/BEARING (MEASURED FROM WORKING PAD SURFACE)
B	BUILDINGS	NA
BU	RESIDENTIAL BUILDING UNITS	NA
1	HIGH OCCUPANCY BUILDING UNITS	NA
2	SCHOOL FACILITY	NA
3	DESIGNATED OUTSIDE ACTIVITY AREA	NA
4	PUBLIC ROAD	NA
5	ABOVE GROUND UTILITY	1036' N
6	RAILROAD	NA
7	PROPERTY LINE	104' W, 1140' N
8	FENCES	1-INSIDE, 56' W, 28' E, 449' N, 723' NW, 1186' NW, 1217' NW
9	PIPELINES OR PIPELINE MARKERS	5-INSIDE, 150' W, 958' NW, 963' NW, 1019' NE, 1020' NE, 1023' NW, 1084' NE, 1096' NE, 1193' NW, 1318' NW, 1588' NW
10	MINES	NA
11	OIL AND GAS WELLS AND FACILITIES	10-INSIDE, 721' N, 789' NE, 821' NE, 828' NE, 885' NE, 951' NW, 977' NW, 1577' NW, 1615' NW, 1637' NW, 1777' NW
12	INJECTION WELLS AND FACILITIES	NA
13	PLUGGED OIL AND GAS WELLS	NA
14	WATER WELLS - GIS LOCATION	NA
15	WATER WELLS - SURVEYED LOCATION	NA
16	SEWER/SEPTIC MANHOLES	NA
OTHER VISIBLE IMPROVEMENTS		
17	PRIVATE ROAD	1-INSIDE, 932' NW, 978' N, 1057' NW, 1225' NW
18	UTILITIES - ELECTRIC	1-INSIDE, 822' NE, 850' NE
19	UTILITIES - WATER	NA
20	UTILITIES - TELEPHONE	NA
21	UTILITIES - FIBER OPTIC	NA
22	UTILITIES - FUEL TANK	5-INSIDE
23	UTILITIES - OTHER	NA
24	BRIDGES	NA
25	MISCELLANEOUS	11' N (CATTLE GUARD), 25' E (SIGN), 458' NE (CATTLE GUARD), 973' NE (CATTLE GUARD), 1099' NW (CATTLE GUARD), 1269' NW (CATTLE GUARD)

— SURFACE PROPERTY

— WORKING PAD SURFACE

— OIL AND GAS LOCATION

W — WATER LINE

G — GAS LINE

T — TELEPHONE LINE

E — UNDERGROUND ELECTRIC

OHU — OVERHEAD UTILITY

FO — FIBER OPTIC LINE

— FENCE

● PROPOSED WELL

⊗ ID DESIGNATION

⊙ BUILDING

⊙ BUILDING UNIT

⊙ RESIDENTIAL BUILDING UNIT

W — WATER MARKER

W — WATER VALVE

T — TELEPHONE PEDESTAL

T — TELEPHONE MARKER

FO — FIBER OPTIC MARKER

FO — FIBER OPTIC PEDESTAL

G — GAS MARKER

G — GAS VALVE

E — ELECTRIC PEDESTAL

E — ELECTRIC SERVICE

P — POWER POLE

G — GUY WIRE

G — GATE

S — SIGN

○ LOCATION

● PRODUCING

⊙ SHUT IN

⊙ TEMPORARY ABANDONED

⊙ INJECTING

⊙ PLUGGED AND ABANDONED

⊙ ACTIVE

⊙ ABANDONED LOCATION

⊙ DRILLED AND ABANDONED

★ DRILLING

⊙ DOMESTIC WELL

■ WAITING ON COMPLETION

● WATER WELLS

DATA SOURCE: COGCC

NOTE:

- SEE HYDROLOGY MAP FOR SURFACE WATER IMPROVEMENTS.
- VISIBLE IMPROVEMENTS SHOWN AND LISTED HEREON THAT ARE LYING OUTSIDE THE SURFACE PROPERTY MAY HAVE BEEN OBTAINED FROM THE AERIAL PHOTO AND OTHER PUBLICLY AVAILABLE DATA. THE ACCURACY AND COMPLETENESS OF SAID IMPROVEMENTS MAY NOT HAVE BEEN VERIFIED BY LAT40, INC. EXISTING CONDITIONS MAY DIFFER FROM WHAT IS SHOWN.

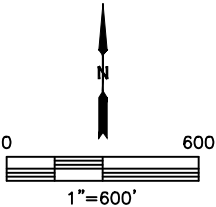

DATE: 7/19/2021  
PROJECT#: 2021205