

Cascade Creek 0697-15-08 Well Site

Layout Drawings COGCC Rule 304.b.(7).B



**Laramie Energy, LLC
760 Horizon Drive, Suite 101
Grand Junction, CO 81506**

UNGRADED ELEVATION: 8515.8'

FINAL ELEVATION: 8504.8'

AREA OF DISTURBANCE: 7.6± ACRES

AREA OF WORKING PAD SURFACE: 3.2± ACRES

Proposed access road and pipeline will be installed within the CC 0697-15-08 Area of Disturbance and previously disturbed surface of the CC 697-15-23.

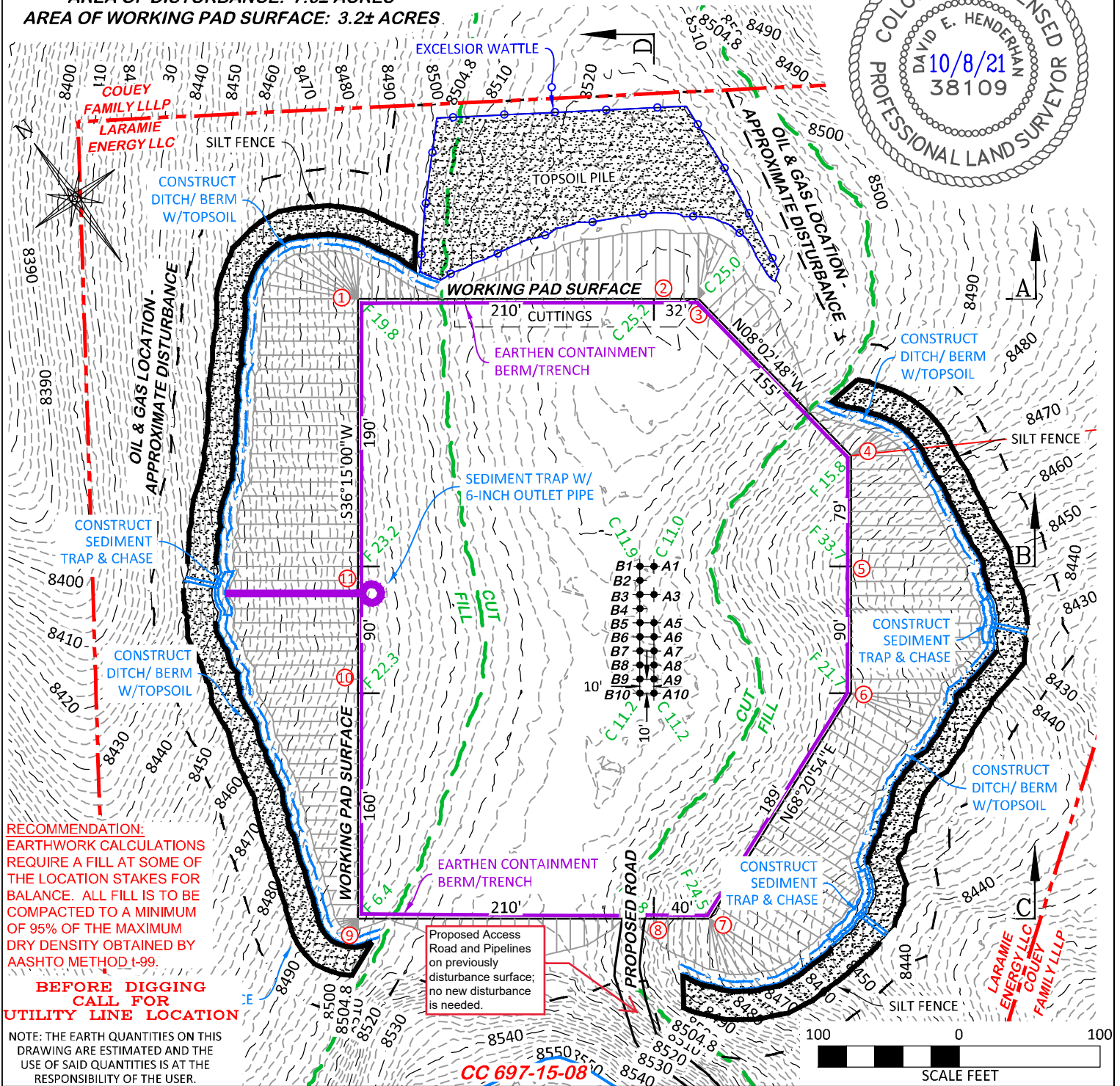
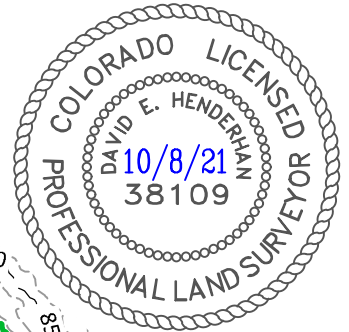

ESTIMATED EARTHWORK BANK					ESTIMATED EARTHWORK LOOSE (25% SWELL)				
ITEM	TOPSOIL	CUT	FILL	EXCESS	ITEM	TOPSOIL	CUT	FILL	EXCESS
PAD	7,869 BCY	37,178 BCY	45,151 BCY	(15,842) BCY	PAD	7,869 BCY	46,473 LCY	45,151 LCY	(6,547) LCY
PIT		NONE		NONE	PIT		NONE		NONE
TOTALS	7,869 BCY	37,178 BCY	45,151 BCY	(15,842) BCY	TOTALS	7,869 BCY	46,473 LCY	45,151 LCY	(6,547) LCY

DRG RIFFIN & ASSOCIATES, INC.
(307) 362-5028 1414 ELK ST., ROCK SPRINGS, WY 82901

DRAWN: 12/8/2020 - DEH	SCALE: 1" = 100'
REVISED: 10/4/2021 - DEH	DRG JOB No. 22026
COGCC RULE REVISIONS	304B(7)BI CONST

LAYOUT DRAWING 1 OF 7

**CONSTRUCTION LAYOUT DRAWING
ESTIMATED EARTHWORK
LARAMIE ENERGY, LLC.
CC 697-15-08
SENE, SECTION 15, T.6 S., R. 97 W., 6th P.M.,
GARFIELD COUNTY, COLORADO**

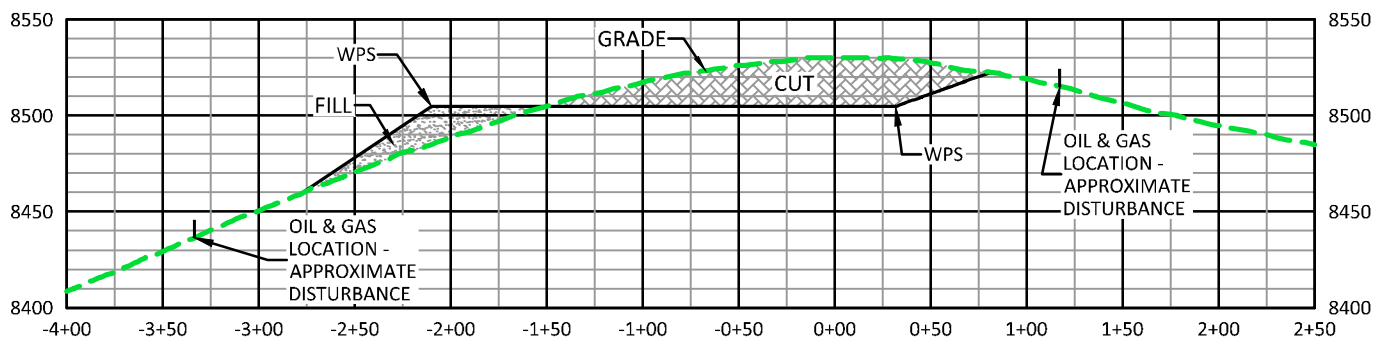

A

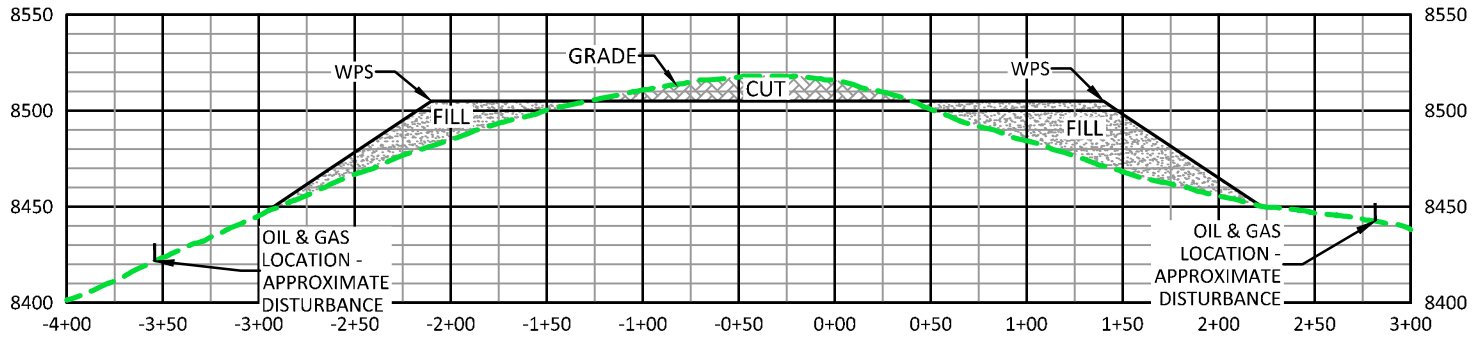

B

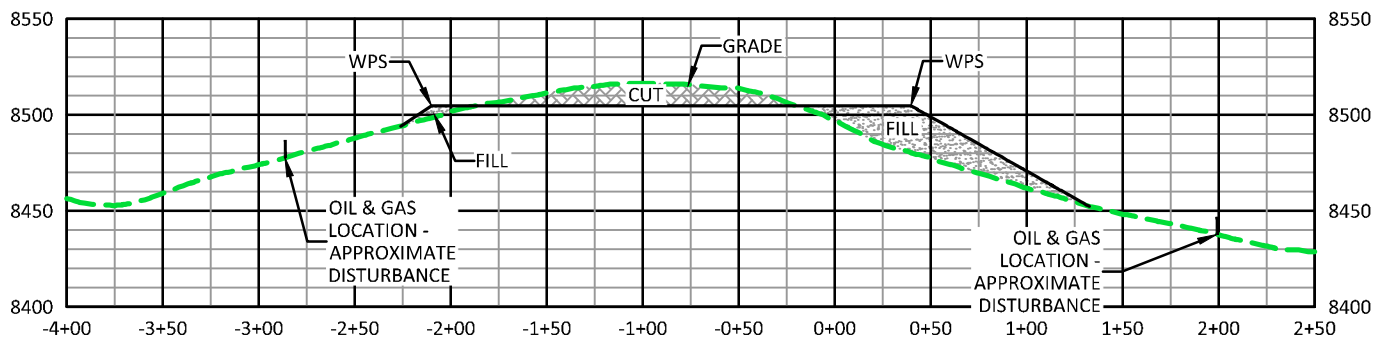

C

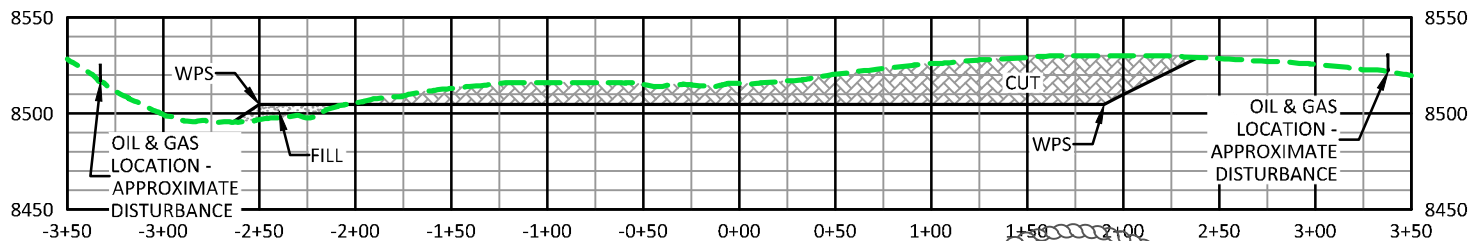

D

**CUT SLOPES 2:1
FILL SLOPES 1.5:1**

RECOMMENDATION:
EARTHWORK CALCULATIONS REQUIRE A FILL AT SOME OF THE LOCATION STAKES FOR BALANCE. ALL FILL IS TO BE COMPACTED TO A MINIMUM OF 95% OF THE MAXIMUM DRY DENSITY OBTAINED BY AASHTO METHOD T-99.

CC 697-15-08

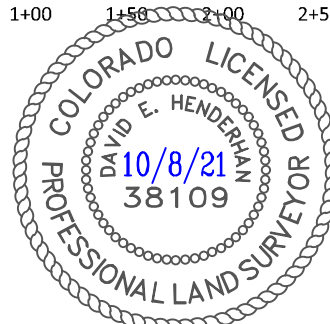

LAYOUT DRAWING 2 OF 7

**CONSTRUCTION LAYOUT DRAWING
CROSS SECTIONS
LARAMIE ENERGY, LLC.**

CC 697-15-08

**SENE, SECTION 15, T. 6 S., R. 97 W., 6th P.M.,
GARFIELD COUNTY, COLORADO**



(307) 362-5028

1414 ELK ST., ROCK SPRINGS, WY 82901

DRAWN: 12/8/2020 - DEH

SCALE: H - 1" = 80' V - 1" = 80'

REVISED: 10/4/2021 - DEH

DRG JOB No. 22026

COGCC RULE REVISIONS

304B(7)BI XSEC

Proposed access road and pipeline will be installed within the CC 0697-15-08 Area of Disturbance and previously disturbed surface of the CC 697-15-23.

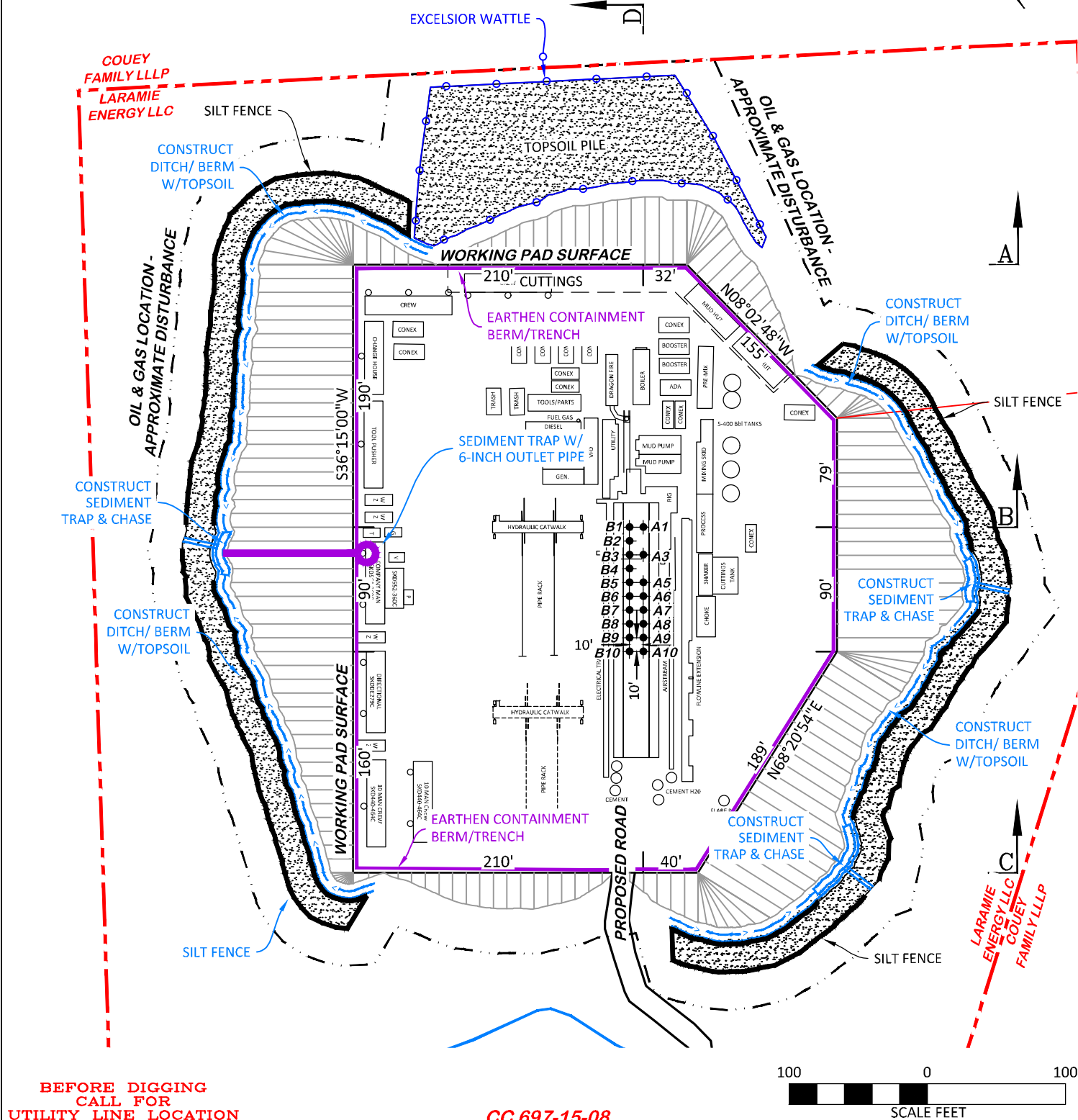
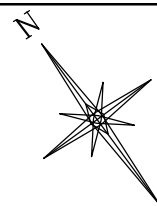

**BEFORE DIGGING
CALL FOR
UTILITY LINE LOCATION**

CC 697-15-08

LAYOUT DRAWING 3 OF 7

PRELIMINARY RIG LAYOUT
LARAMIE ENERGY, LLC.

CC 697-15-08

**SENE, SECTION 15, T. 6 S., R. 97 W., 6th P.M.,
GARFIELD COUNTY, COLORADO**

DRG **RIFFIN & ASSOCIATES, INC.**
(307) 362-5028 1414 ELK ST., ROCK SPRINGS, WY 82901

DRAWN: 12/8/2020 - DEH

SCALE: 1" = 100'

REVISÉ: 10/4/2021 - DEH

DRG JOB No. 22026

COGCC RULE REVISIONS

304B(7)BII RIG

UNGRADED ELEVATION: 8515.8'

FINAL ELEVATION: 8504.8'

AREA OF DISTURBANCE: 7.6± ACRES

AREA OF WORKING PAD SURFACE: 3.2± ACRES

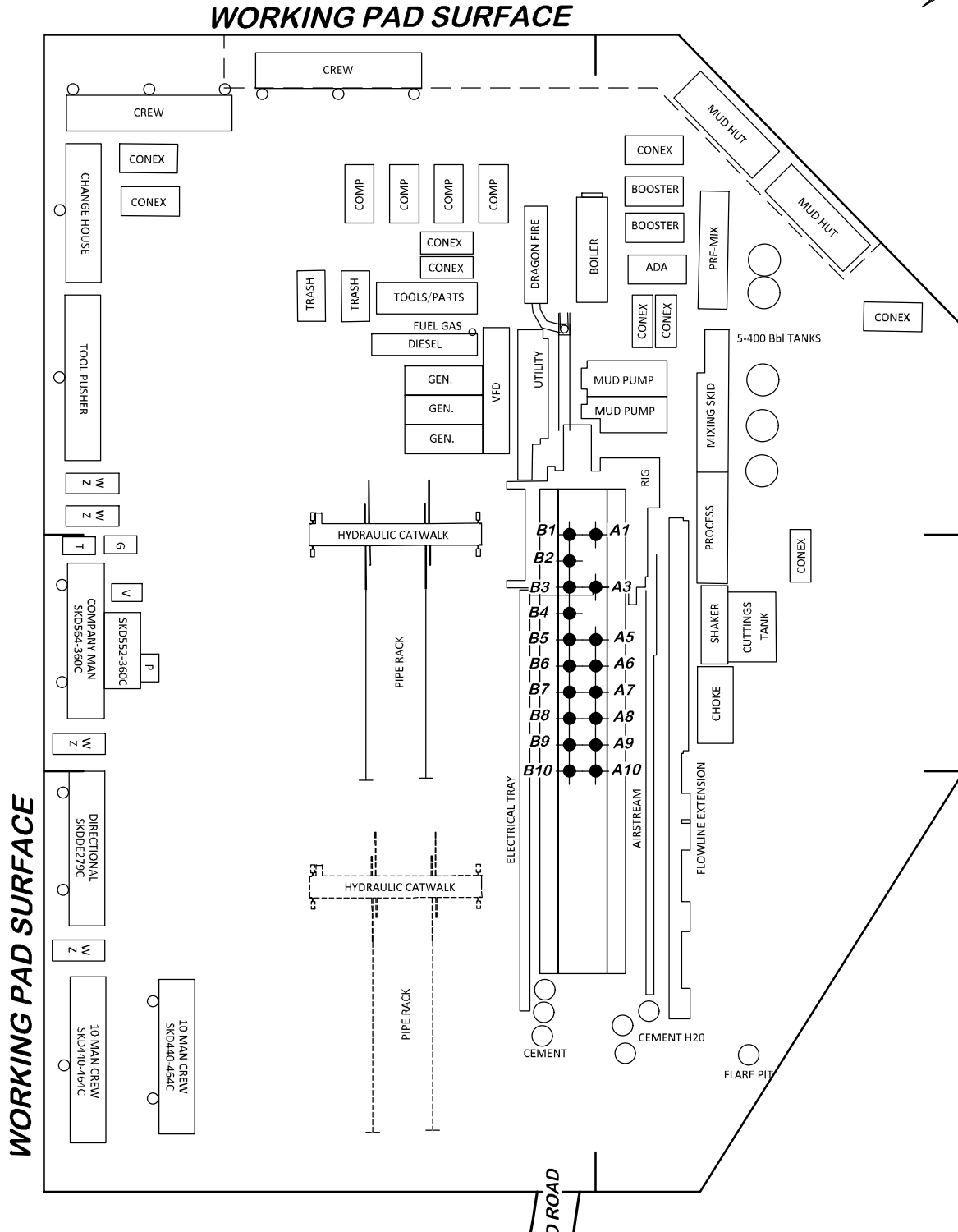
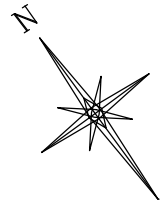

BEFORE DIGGING
CALL FOR
UTILITY LINE LOCATION

CC 697-15-08

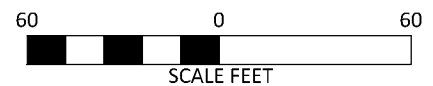

RIFFIN & ASSOCIATES, INC.

(307) 362-5028

1414 ELK ST., ROCK SPRINGS, WY 82901

LAYOUT DRAWING 4 OF 7

RIG DETAIL
LARAMIE ENERGY, LLC.

CC 697-15-08

SENE, SECTION 15, T. 6 S., R. 97 W., 6th P.M.,
GARFIELD COUNTY, COLORADO

DRAWN: 12/8/2020 - DEH

SCALE: 1" = 60'

REVISED: 10/4/2021 - DEH

DRG JOB No. 22026

COGCC RULE REVISIONS

304B(7)BII RIG DET

WORKING PAD SURFACE

LIGHT PLANT

FRAC TANKS

FLOWBACK SEPARATORS

LIGHT PLANT

VOC COMBUSTOR
(TO BE INSTALLED IF
REQUIRED PER APEN)
LOCATION TEMPORARY
FOR COMPLETIONS
AND FLOWBACK
OPERATIONS

INSTALL 4
5 PACKS
SEPARATORS

INSTALL TANKS
W/CONTAINMENT
BARRIER:
2 OIL
4 PROD. WATER
2 GUNBARREL

INSTALL TANKS
W/CONTAINMENT
BARRIER:
2 OIL
4 PROD. WATER
2 GUNBARREL

WIRELINE
EQUIPMENT

B1 A1
B2 A2
B3 A3
B4 A4
B5 A5
B6 A6
B7 A7
B8 A8
B9 A9
B10 A10

FRAC EQUIPMENT

WORKING PAD SURFACE

LIGHT PLANT

FRAC TANKS

LIGHT PLANT

PROPOSED ROAD

NOTES:

1. COMPLETIONS AND FLOWBACK OPERATIONS WILL BE CONDUCTED CONCURRENTLY.
2. EXHIBIT DEPICTS PRELIMINARY FRAC AND FLOWBACK EQUIPMENT LAYOUT. EQUIPMENT AND LAYOUT ARE SUBJECT TO CHANGE DEPENDING ON EQUIPMENT AVAILABILITY AND SITE CONDITIONS.
3. FIFTY-FIVE (55) FRAC TANKS. CAPACITY PER FRAC TANK: 500 BBLs. TOTAL FRAC TANK CAPACITY (55 FRAC TANKS): 27,500 BBLs.
4. EQUIPMENT LOCATED WITHIN THE "FRAC EQUIPMENT" ENVELOPE: HYDRAULIC STIMULATION CONTROL TRAILER, DIESEL FRAC PUMPS, CHARGE PUMP, AND TEMPORARY CHEMICAL STORAGE
5. EACH LIGHT PLANT IS A SELF-CONTAINED UNIT WITH A GENERATOR AND AUXILIARY POWER SOURCE.
6. ACTUAL WATER LINE AND WATER PUMP PLACEMENT DEPENDENT ON PRE-COMPLETION ALIGNMENT OF FRAC TANKS.
7. OPERATOR WILL UTILIZE HEAT PUMPS FOR WINTER OPERATIONS BASED ON LOCATION SPACING.
8. FLOWBACK SUPPORT TRAILER IS LOCATED WITHIN "FLOWBACK SEPARATORS" ENVELOPE.
9. PLEASE REFER TO THE CONSTRUCTION LAYOUT DRAWING FOR STORMWATER CONTROL MEASURES.

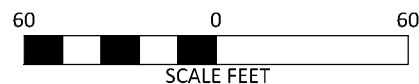

CC 697-15-08

LAYOUT DRAWING 5 OF 7

**PRELIMINARY WELL COMPLETIONS AND
STIMULATION LAYOUT
LARAMIE ENERGY, LLC.**

CC 697-15-08

**SENE, SECTION 15, T. 6 S., R. 97 W., 6th P.M.,
GARFIELD COUNTY, COLORADO**



DRG RIFFIN & ASSOCIATES, INC.

(307) 362-5028

1414 ELK ST., ROCK SPRINGS, WY 82901

DRAWN: 7/28/2021 - DEH

SCALE: 1" = 60'

REVISED: 10/12/2021 - DEH

DRG JOB No. 22026

COGCC RULE REVISIONS

304b(7)Biii COMP

WORKING PAD SURFACE

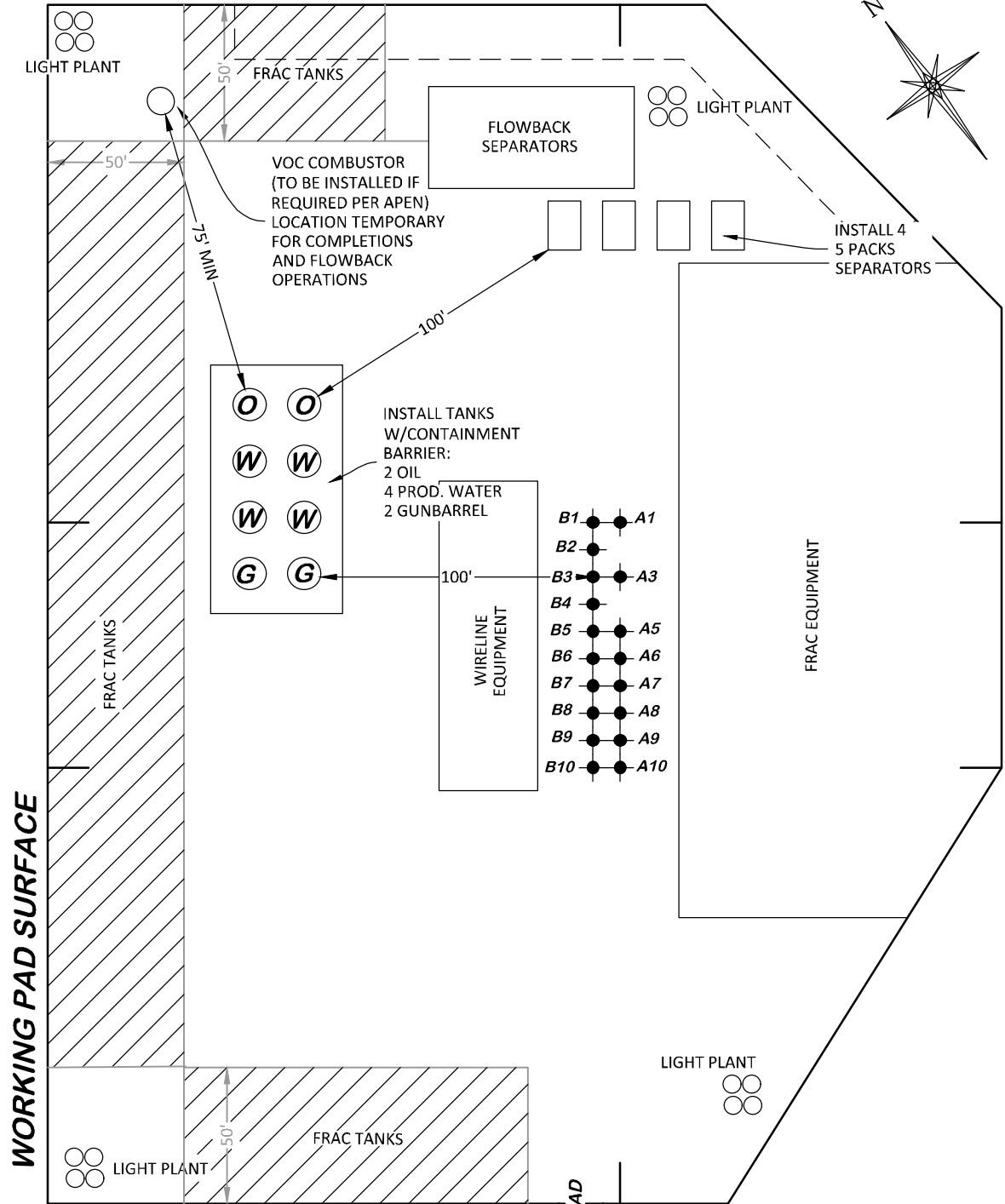

NOTES:

1. COMPLETIONS AND FLOWBACK OPERATIONS WILL BE CONDUCTED CONCURRENTLY.
2. EXHIBIT DEPICTS PRELIMINARY FRAC AND FLOWBACK EQUIPMENT LAYOUT. EQUIPMENT AND LAYOUT ARE SUBJECT TO CHANGE DEPENDING ON EQUIPMENT AVAILABILITY AND SITE CONDITIONS.
3. FIFTY-FIVE (55) FRAC TANKS. CAPACITY PER FRAC TANK: 500 BBLs. TOTAL FRAC TANK CAPACITY (55 FRAC TANKS): 27,500 BBLs.
4. EQUIPMENT LOCATED WITHIN THE "FRAC EQUIPMENT" ENVELOPE: HYDRAULIC STIMULATION CONTROL TRAILER, DIESEL FRAC PUMPS, CHARGE PUMP, AND TEMPORARY CHEMICAL STORAGE
5. EACH LIGHT PLANT IS A SELF-CONTAINED UNIT WITH A GENERATOR AND AUXILIARY POWER SOURCE.
6. ACTUAL WATER LINE AND WATER PUMP PLACEMENT DEPENDENT ON PRE-COMPLETION ALIGNMENT OF FRAC TANKS.
7. OPERATOR WILL UTILIZE HEAT PUMPS FOR WINTER OPERATIONS BASED ON LOCATION SPACING.
8. FLOWBACK SUPPORT TRAILER IS LOCATED WITHIN "FLOWBACK SEPARATORS" ENVELOPE.
9. PLEASE REFER TO THE CONSTRUCTION LAYOUT DRAWING FOR STORMWATER CONTROL MEASURES.

CC 697-15-08

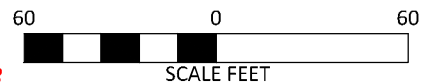

LAYOUT DRAWING 6 OF 7

DRG RIFFIN & ASSOCIATES, INC.
(307) 362-5028 1414 ELK ST., ROCK SPRINGS, WY 82901

DRAWN: 7/28/2021 - DEH

SCALE: 1" = 60'

REVISED: 10/12/2021 - DEH

DRG JOB No. 22026

COGCC RULE REVISIONS

304b(7)Biv FLOWBACK

**FLOWBACK EQUIPMENT LAYOUT
LARAMIE ENERGY, LLC.**

CC 697-15-08

**SENE, SECTION 15, T. 6 S., R. 97 W., 6th P.M.,
GARFIELD COUNTY, COLORADO**

FINAL ELEVATION: 8504.8'

AREA OF WORKING PAD SURFACE: 3.2± ACRES
AREA OF PRODUCTION PAD SURFACE: 1.8± ACRES

Proposed access road and pipeline will be installed within the CC 0697-15-08 Area of Disturbance and previously disturbed surface of the CC 697-15-23.

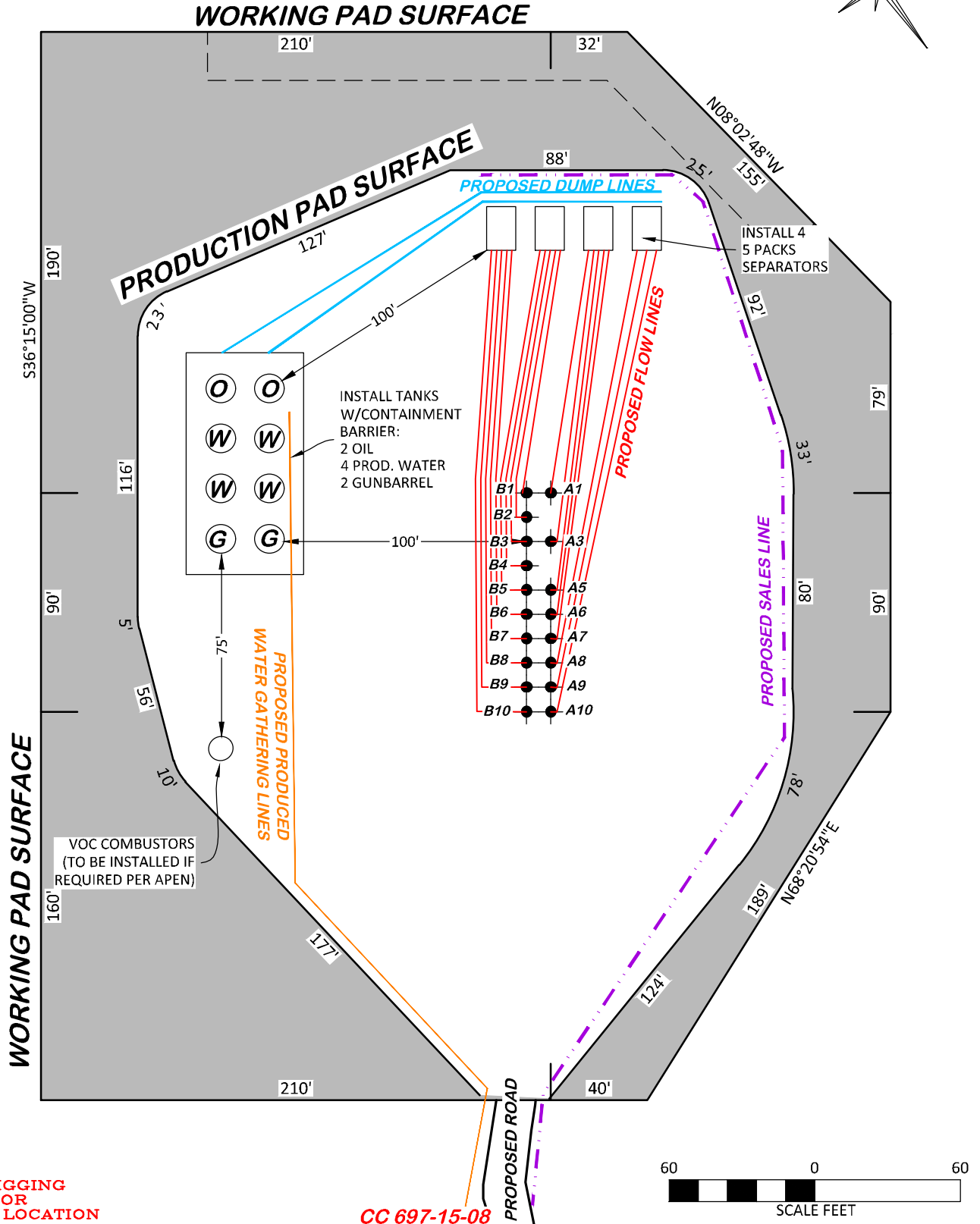
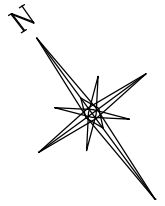

DRG RIFFIN & ASSOCIATES, INC.
(307) 362-5028 1414 ELK ST., ROCK SPRINGS, WY 82901

LAYOUT DRAWING 7 OF 7

**PRELIMINARY FACILITY LAYOUT
LARAMIE ENERGY, LLC.
CC 697-15-08
SENE, SECTION 15, T. 6 S., R. 97 W., 6th P.M.,
GARFIELD COUNTY, COLORADO**

DRAWN: 4/30/2021 - DEH

SCALE: 1" = 50'

REVISED: 10/4/2021 - DEH

DRG JOB No. 22026

COGCC RULE REVISIONS

304B(7)BV FACILITY

APPROXIMATE DISTURBANCE AREA: 7.6 +/- ACRES
 PROPOSED RECLAMATION AREA: 5.8 ACRES
 INTERIM RECLAMATION DISTURBANCE: 1.8 ACRES

Proposed access road and pipeline will be installed within the CC 0697-15-08 Area of Disturbance and previously disturbed surface of the CC 697-15-23.

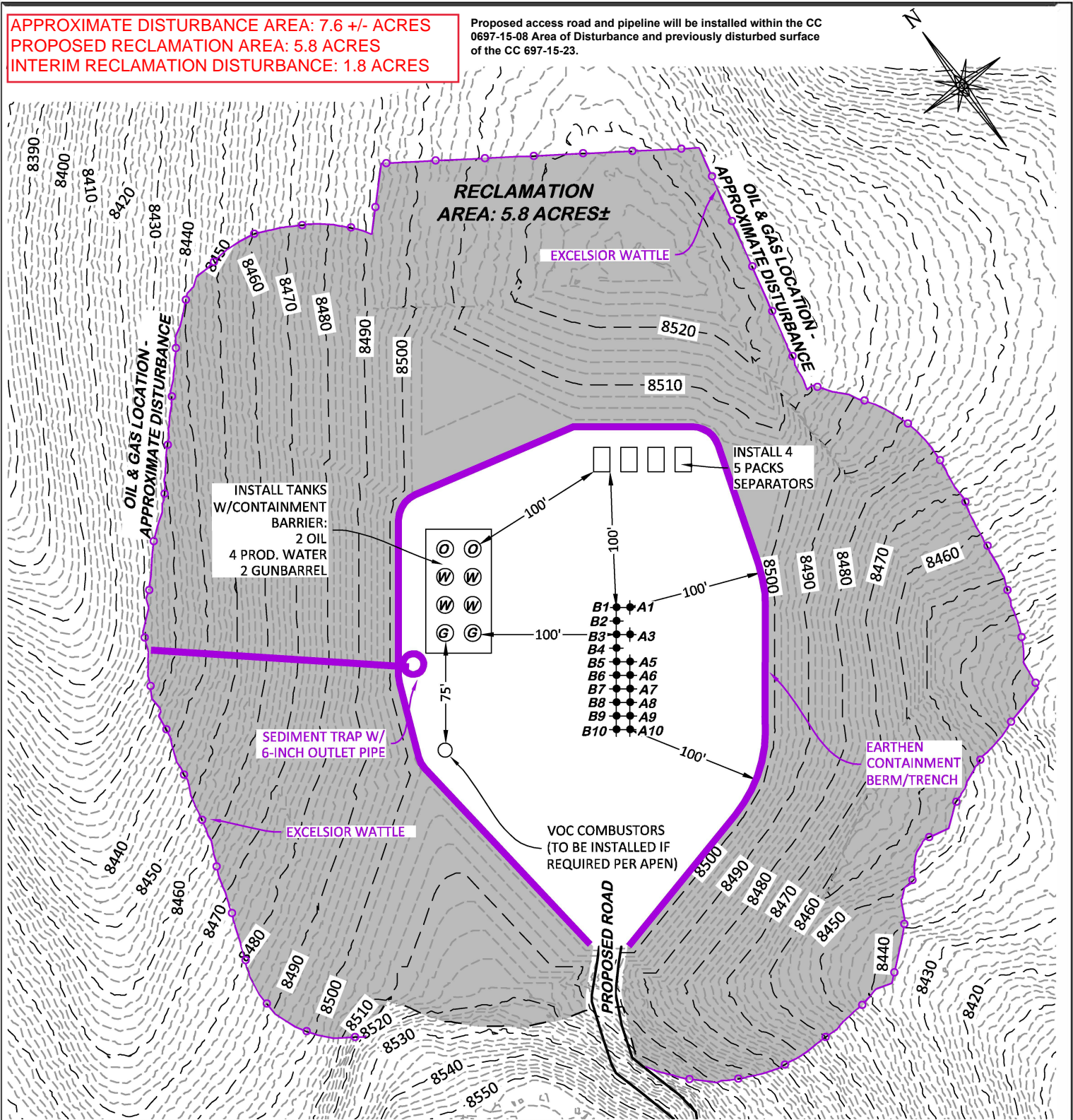

**BEFORE DIGGING
 CALL FOR
 UTILITY LINE LOCATION**

CC 697-15-08

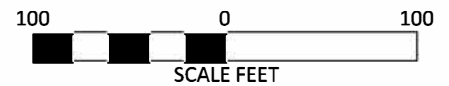

DRG RIFFIN & ASSOCIATES, INC. (307) 362-5028 1414 ELK ST., ROCK SPRINGS, WY 82901	
DRAWN: 12/8/2020 - DEH	SCALE: 1" = 100'
REVISED: 10/4/2021 - DEH	DRG JOB No. 22026
COGCC RULE REVISIONS	304C(16) RECLAMATION

FACILITY LAYOUT DRAWING - INTERIM RECLAMATION PLAN

**PROPOSED INTERIM RECLAMATION
 LARAMIE ENERGY, LLC.**
CC 697-15-08
**SENE, SECTION 15, T. 6 S., R. 97 W., 6th P.M.,
 GARFIELD COUNTY, COLORADO**

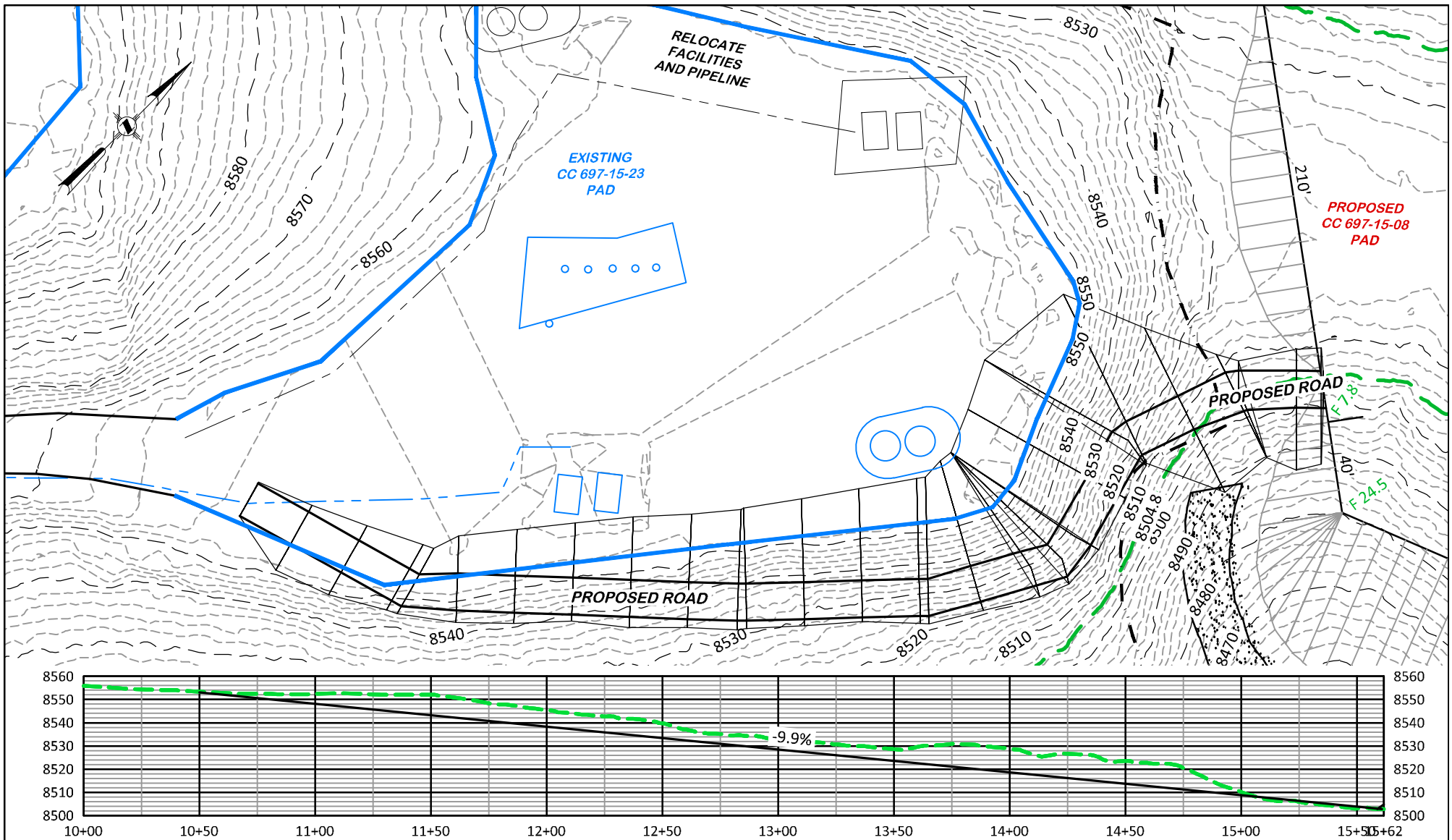

Proposed access road and pipeline will be installed within the CC 0697-15-08 Area of Disturbance and previously disturbed surface of the CC 697-15-23. Laramie will provide an As-Built Layout Drawing after construction to confirm the total acreage disturbed.

CC 697-15-08

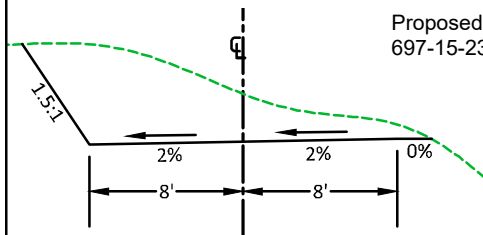

ESTIMATED EARTHWORK		
CUT	FILL	EXCESS
6,949 CY	193 CY	6,756 CY

 DRG RIFFIN & ASSOCIATES, INC. (307) 362-5028 1414 ELK ST., ROCK SPRINGS, WY 82901		ACCESS PLAN AND PROFILE	
		DRAWN: 12/8/2020 - DEH	SCALE: H - 1" = 60' V - 1" = 60'
REVISED: 10/4/2021 - DEH		DRG JOB No. 22026	
COGCC RULE REVISIONS		304B(7)F ROAD PP	

LARAMIE ENERGY, LLC.
CC 697-15-08
SENE, SECTION 15, T. 6 S., R. 97 W., 6th P.M.,
GARFIELD COUNTY, COLORADO