



Project: Weld County, CO NAD 83
Site: Anschutz Equus Farms 4-62-9_10 South Pad
Well: Anschutz Equus Farms 4-62-9-4956C2
Wellbore: OH
Design: Plan 2



T M
Azimuths to True North
Magnetic North: 8.27°

Magnetic Field
Strength: 52609.5snT
Dip Angle: 66.97°
Date: 10/27/2015
Model: BGGM2015

WELL DETAILS: Anschutz Equus Farms 4-62-9-4956C2				PROJECT DETAILS: Weld County, CO NAD 83	
GL 4526' & KB 16' @ 4542.00ft 4526.00				Geodetic System: US State Plane 1983	
				Datum: North American Datum 1983	
				Ellipsoid: GRS 1980	
				Zone: Colorado Northern Zone	
Northing Easting Latitude Longitude				System Datum: Mean Sea Level	
1362432.22	3323910.21	40° 19' 20.830 N	104° 20' 17.830 W	Local North: True	

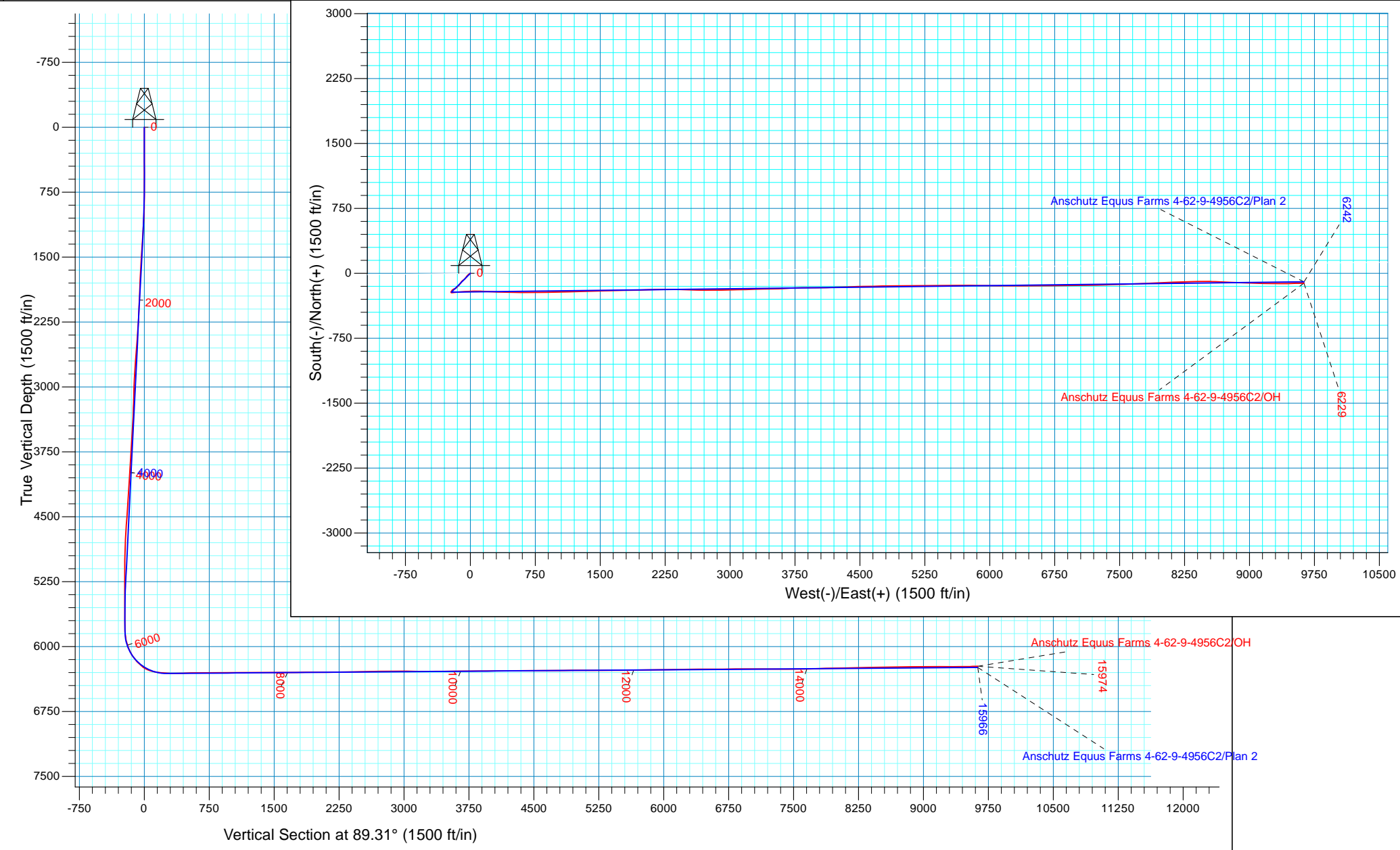



Bill Barrett Corporation

Bill Barrett Corp.

Weld County, CO NAD 83

Anschutz Equus Farms 4-62-9_10 South Pad

Anschutz Equus Farms 4-62-9-4956C2

OH

Design: OH

Standard Survey Report

22 December, 2015



Scientific Drilling

www.scientificdrilling.com



Company:	Bill Barrett Corp.	Local Co-ordinate Reference:	Well Anschutz Equus Farms 4-62-9-4956C2
Project:	Weld County, CO NAD 83	TVD Reference:	GL 4526' & KB 16' @ 4542.00ft
Site:	Anschutz Equus Farms 4-62-9_10 South Pad	MD Reference:	GL 4526' & KB 16' @ 4542.00ft
Well:	Anschutz Equus Farms 4-62-9-4956C2 OH	North Reference:	True
Wellbore:	OH	Survey Calculation Method:	Minimum Curvature
Design:		Database:	Casper District

Project	Weld County, CO NAD 83		
Map System:	US State Plane 1983	System Datum:	Mean Sea Level
Geo Datum:	North American Datum 1983		
Map Zone:	Colorado Northern Zone		

Site	Anschutz Equus Farms 4-62-9_10 South Pad, Site Center : 4-62-09-6457D2B		
Site Position:		Northing:	1,362,402.78 usft
From:	Lat/Long	Easting:	3,323,912.00 usft
Position Uncertainty:	0.00 ft	Slot Radius:	13.200 in
		Latitude:	40° 19' 20.539 N
		Longitude:	104° 20' 17.812 W
		Grid Convergence:	0.75 °

Well	Anschutz Equus Farms 4-62-9-4956C2, 1090' FSL 250' FWL Sec 9 T4N R62W		
Well Position	+N/-S	0.00 ft	Northing: 1,362,432.22 usft
	+E/-W	0.00 ft	Easting: 3,323,910.22 usft
Position Uncertainty	0.00 ft	Wellhead Elevation:	0.00 ft
		Latitude:	40° 19' 20.830 N
		Longitude:	104° 20' 17.830 W
		Ground Level:	4,526.00 ft

Wellbore	OH				
Magnetics	Model Name	Sample Date	Declination (°)	Dip Angle (°)	Field Strength (nT)
	BGGM2015	10/27/2015	8.27	66.97	52,610

Design	OH				
Audit Notes:					
Version:	1.0	Phase:	ACTUAL	Tie On Depth:	0.00
Vertical Section:	Depth From (TVD) (ft)	+N/-S (ft)	+E/-W (ft)	Direction (°)	
	0.00	0.00	0.00	89.31	

Survey Program	Date	12/22/2015			
From (ft)	To (ft)	Survey (Wellbore)	Tool Name	Description	
800.00	6,567.00	Survey #1 - Vertical / Curve (OH)	SDI MWD	SDI MWD - Standard ver 1.0.1	
6,693.00	15,974.00	Survey #2 - Lateral (OH)	SDI MWD	SDI MWD - Standard ver 1.0.1	

Survey										
Measured Depth (ft)	Inclination (°)	Azimuth (°)	Vertical Depth (ft)	+N/-S (ft)	+E/-W (ft)	Vertical Section (ft)	Dogleg Rate (°/100ft)	Build Rate (°/100ft)	Turn Rate (°/100ft)	
800.00	0.00	0.00	800.00	0.00	0.00	0.00	0.00	0.00	0.00	
Casing Assumed Vertical										
884.00	0.88	240.03	884.00	-0.32	-0.56	-0.56	1.05	1.05	0.00	
First SDI MWD Survey										
976.00	2.11	247.85	975.96	-1.31	-2.74	-2.76	1.35	1.34	8.50	
1,068.00	3.25	246.71	1,067.86	-2.98	-6.70	-6.74	1.24	1.24	-1.24	
1,159.00	4.04	237.92	1,158.68	-5.71	-11.79	-11.86	1.06	0.87	-9.66	
1,251.00	5.28	229.66	1,250.37	-10.17	-17.76	-17.88	1.53	1.35	-8.98	
1,343.00	4.75	228.43	1,342.02	-15.44	-23.84	-24.02	0.59	-0.58	-1.34	

Company:	Bill Barrett Corp.	Local Co-ordinate Reference:	Well Anschutz Equus Farms 4-62-9-4956C2
Project:	Weld County, CO NAD 83	TVD Reference:	GL 4526' & KB 16' @ 4542.00ft
Site:	Anschutz Equus Farms 4-62-9_10 South Pad	MD Reference:	GL 4526' & KB 16' @ 4542.00ft
Well:	Anschutz Equus Farms 4-62-9-4956C2	North Reference:	True
Wellbore:	OH	Survey Calculation Method:	Minimum Curvature
Design:	OH	Database:	Casper District

Survey									
Measured Depth (ft)	Inclination (°)	Azimuth (°)	Vertical Depth (ft)	+N/-S (ft)	+E/-W (ft)	Vertical Section (ft)	Dogleg Rate (°/100ft)	Build Rate (°/100ft)	Turn Rate (°/100ft)
1,434.00	5.63	224.56	1,432.65	-21.12	-29.79	-30.04	1.04	0.97	-4.25
1,526.00	5.01	220.52	1,524.25	-27.39	-35.57	-35.89	0.79	-0.67	-4.39
1,617.00	4.48	218.41	1,614.94	-33.19	-40.36	-40.75	0.61	-0.58	-2.32
1,709.00	4.31	222.01	1,706.67	-38.57	-44.90	-45.36	0.35	-0.18	3.91
1,801.00	3.34	207.95	1,798.46	-43.51	-48.47	-48.99	1.46	-1.05	-15.28
1,892.00	4.31	220.96	1,889.26	-48.44	-51.96	-52.54	1.42	1.07	14.30
1,983.00	4.66	223.24	1,979.98	-53.71	-56.73	-57.37	0.43	0.38	2.51
2,075.00	3.96	206.63	2,071.73	-59.27	-60.71	-61.42	1.55	-0.76	-18.05
2,167.00	3.61	226.23	2,163.53	-64.12	-64.23	-65.00	1.45	-0.38	21.30
2,259.00	3.43	226.84	2,255.35	-68.00	-68.33	-69.14	0.20	-0.20	0.66
2,350.00	5.10	236.07	2,346.10	-72.12	-73.67	-74.53	1.98	1.84	10.14
2,445.00	4.57	235.81	2,440.76	-76.61	-80.30	-81.22	0.56	-0.56	-0.27
2,539.00	6.16	230.80	2,534.35	-81.90	-87.31	-88.29	1.76	1.69	-5.33
2,633.00	6.86	228.69	2,627.74	-88.79	-95.44	-96.50	0.79	0.74	-2.24
2,728.00	5.98	218.23	2,722.15	-96.43	-102.76	-103.91	1.54	-0.93	-11.01
2,822.00	5.45	213.40	2,815.68	-104.00	-108.25	-109.49	0.76	-0.56	-5.14
2,917.00	4.31	207.42	2,910.34	-110.93	-112.38	-113.70	1.31	-1.20	-6.29
3,012.00	3.96	224.47	3,005.09	-116.44	-116.32	-117.71	1.34	-0.37	17.95
3,106.00	3.34	207.68	3,098.90	-121.19	-119.86	-121.31	1.31	-0.66	-17.86
3,201.00	3.69	215.24	3,193.73	-126.13	-122.91	-124.42	0.61	0.37	7.96
3,295.00	2.64	216.47	3,287.58	-130.34	-125.95	-127.51	1.12	-1.12	1.31
3,390.00	3.87	220.43	3,382.43	-134.54	-129.33	-130.94	1.32	1.29	4.17
3,484.00	4.40	229.57	3,476.18	-139.30	-134.13	-135.80	0.90	0.56	9.72
3,578.00	5.10	231.77	3,569.86	-144.22	-140.15	-141.88	0.77	0.74	2.34
3,672.00	5.28	223.77	3,663.47	-149.93	-146.43	-148.22	0.79	0.19	-8.51
3,766.00	5.01	218.41	3,757.10	-156.27	-151.97	-153.84	0.59	-0.29	-5.70
3,861.00	5.28	228.69	3,851.71	-162.41	-157.83	-159.78	1.01	0.28	10.82
3,955.00	3.78	224.30	3,945.42	-167.48	-163.24	-165.25	1.64	-1.60	-4.67
4,050.00	4.48	237.04	4,040.17	-171.74	-168.54	-170.60	1.21	0.74	13.41
4,144.00	3.52	244.77	4,133.94	-174.97	-174.24	-176.33	1.17	-1.02	8.22
4,239.00	4.66	250.05	4,228.70	-177.53	-180.50	-182.63	1.26	1.20	5.56
4,333.00	3.34	252.86	4,322.47	-179.64	-186.71	-188.86	1.42	-1.40	2.99
4,428.00	4.04	242.31	4,417.27	-182.01	-192.32	-194.49	1.02	0.74	-11.11
4,523.00	4.84	240.29	4,511.99	-185.55	-198.76	-200.98	0.86	0.84	-2.13
4,617.00	5.28	231.41	4,605.62	-190.21	-205.58	-207.86	0.95	0.47	-9.45
4,711.00	5.28	222.19	4,699.23	-196.11	-211.87	-214.22	0.90	0.00	-9.81
4,806.00	4.31	212.25	4,793.89	-202.37	-216.71	-219.13	1.34	-1.02	-10.46
4,900.00	3.34	215.42	4,887.68	-207.59	-220.18	-222.67	1.06	-1.03	3.37
4,994.00	2.37	203.55	4,981.57	-211.60	-222.55	-225.08	1.20	-1.03	-12.63
5,088.00	2.11	196.79	5,075.49	-215.04	-223.82	-226.40	0.39	-0.28	-7.19
5,183.00	1.67	196.43	5,170.44	-218.04	-224.72	-227.33	0.46	-0.46	-0.38
5,278.00	0.70	119.88	5,265.43	-219.66	-224.61	-227.24	1.74	-1.02	-80.58
5,372.00	0.70	142.38	5,359.42	-220.40	-223.76	-226.40	0.29	0.00	23.94

Company:	Bill Barrett Corp.	Local Co-ordinate Reference:	Well Anschutz Equus Farms 4-62-9-4956C2
Project:	Weld County, CO NAD 83	TVD Reference:	GL 4526' & KB 16' @ 4542.00ft
Site:	Anschutz Equus Farms 4-62-9_10 South	MD Reference:	GL 4526' & KB 16' @ 4542.00ft
Well:	Pad Anschutz Equus Farms 4-62-9-4956C2	North Reference:	True
Wellbore:	OH	Survey Calculation Method:	Minimum Curvature
Design:	OH	Database:	Casper District

Survey									
Measured Depth (ft)	Inclination (°)	Azimuth (°)	Vertical Depth (ft)	+N/-S (ft)	+E/-W (ft)	Vertical Section (ft)	Dogleg Rate (°/100ft)	Build Rate (°/100ft)	Turn Rate (°/100ft)
5,467.00	0.62	152.14	5,454.41	-221.32	-223.16	-225.81	0.14	-0.08	10.27
5,561.00	0.18	145.02	5,548.41	-221.89	-222.84	-225.50	0.47	-0.47	-7.57
5,656.00	0.44	179.65	5,643.41	-222.37	-222.75	-225.42	0.33	0.27	36.45
5,750.00	0.26	189.93	5,737.41	-222.94	-222.79	-225.46	0.20	-0.19	10.94
5,845.00	2.81	88.50	5,832.37	-223.10	-220.50	-223.17	3.02	2.68	-106.77
5,940.00	11.78	89.03	5,926.50	-222.87	-208.45	-211.12	9.44	9.44	0.56
6,035.00	21.63	81.91	6,017.39	-220.24	-181.35	-183.99	10.57	10.37	-7.49
6,129.00	32.45	84.81	6,101.00	-215.50	-138.95	-141.54	11.59	11.51	3.09
6,224.00	42.30	85.96	6,176.40	-210.93	-81.54	-84.08	10.39	10.37	1.21
6,319.00	55.05	88.68	6,239.01	-207.77	-10.43	-12.93	13.59	13.42	2.86
6,413.00	72.63	89.91	6,280.29	-206.80	73.60	71.11	18.74	18.70	1.31
6,507.00	84.06	92.37	6,299.25	-208.67	165.49	162.96	12.43	12.16	2.62
6,567.00	85.30	92.28	6,304.81	-211.10	225.18	222.62	2.07	2.07	-0.15
Last SDI MWD Curve Survey									
6,693.00	90.75	92.20	6,309.15	-216.02	350.96	348.33	4.33	4.33	-0.06
First SDI MWD Lateral Survey									
6,788.00	91.10	91.93	6,307.62	-219.44	445.89	443.21	0.47	0.37	-0.28
6,883.00	91.63	90.09	6,305.36	-221.11	540.84	538.14	2.02	0.56	-1.94
6,977.00	91.01	90.09	6,303.19	-221.26	634.81	632.10	0.66	-0.66	0.00
7,071.00	90.22	89.65	6,302.18	-221.05	728.81	726.09	0.96	-0.84	-0.47
7,166.00	90.84	90.00	6,301.30	-220.76	823.80	821.08	0.75	0.65	0.37
7,260.00	89.34	88.24	6,301.16	-219.31	917.78	915.08	2.46	-1.60	-1.87
7,355.00	89.69	88.15	6,301.96	-216.32	1,012.73	1,010.06	0.38	0.37	-0.09
7,449.00	90.22	88.50	6,302.03	-213.57	1,106.69	1,104.04	0.68	0.56	0.37
7,544.00	90.13	88.15	6,301.74	-210.80	1,201.65	1,199.03	0.38	-0.09	-0.37
7,638.00	90.75	89.03	6,301.02	-208.49	1,295.62	1,293.01	1.15	0.66	0.94
7,732.00	91.28	88.77	6,299.36	-206.68	1,389.59	1,387.00	0.63	0.56	-0.28
7,827.00	89.60	88.15	6,298.63	-204.13	1,484.55	1,481.98	1.88	-1.77	-0.65
7,920.00	90.22	88.59	6,298.77	-201.48	1,577.51	1,574.97	0.82	0.67	0.47
8,015.00	90.04	88.33	6,298.56	-198.93	1,672.47	1,669.96	0.33	-0.19	-0.27
8,110.00	90.40	89.21	6,298.19	-196.89	1,767.45	1,764.95	1.00	0.38	0.93
8,204.00	90.04	88.86	6,297.83	-195.31	1,861.44	1,858.95	0.53	-0.38	-0.37
8,298.00	90.66	89.03	6,297.26	-193.58	1,955.42	1,952.94	0.68	0.66	0.18
8,393.00	90.04	87.89	6,296.68	-191.02	2,050.38	2,047.93	1.37	-0.65	-1.20
8,486.00	89.87	88.24	6,296.75	-187.88	2,143.33	2,140.91	0.42	-0.18	0.38
8,580.00	90.40	89.65	6,296.53	-186.15	2,237.31	2,234.90	1.60	0.56	1.50
8,675.00	91.45	90.61	6,294.99	-186.37	2,332.29	2,329.88	1.50	1.11	1.01
8,769.00	92.07	91.32	6,292.11	-187.95	2,426.23	2,423.79	1.00	0.66	0.76
8,864.00	90.40	91.32	6,290.06	-190.14	2,521.18	2,518.71	1.76	-1.76	0.00
8,958.00	91.28	91.93	6,288.68	-192.80	2,615.13	2,612.62	1.14	0.94	0.65
9,052.00	91.10	90.09	6,286.73	-194.46	2,709.09	2,706.56	1.97	-0.19	-1.96
9,147.00	90.48	89.38	6,285.42	-194.02	2,804.08	2,801.54	0.99	-0.65	-0.75
9,243.00	89.69	89.03	6,285.28	-192.69	2,900.07	2,897.54	0.90	-0.82	-0.36
9,337.00	90.22	89.21	6,285.35	-191.24	2,994.06	2,991.54	0.60	0.56	0.19

Company:	Bill Barrett Corp.	Local Co-ordinate Reference:	Well Anschutz Equus Farms 4-62-9-4956C2
Project:	Weld County, CO NAD 83	TVD Reference:	GL 4526' & KB 16' @ 4542.00ft
Site:	Anschutz Equus Farms 4-62-9_10 South Pad	MD Reference:	GL 4526' & KB 16' @ 4542.00ft
Well:	Anschutz Equus Farms 4-62-9-4956C2	North Reference:	True
Wellbore:	OH	Survey Calculation Method:	Minimum Curvature
Design:	OH	Database:	Casper District

Survey										
Measured Depth (ft)	Inclination (°)	Azimuth (°)	Vertical Depth (ft)	+N/-S (ft)	+E/-W (ft)	Vertical Section (ft)	Dogleg Rate (°/100ft)	Build Rate (°/100ft)	Turn Rate (°/100ft)	
9,431.00	88.99	88.50	6,286.00	-189.37	3,088.04	3,085.53	1.51	-1.31	-0.76	
9,525.00	88.99	88.68	6,287.66	-187.05	3,181.99	3,179.51	0.19	0.00	0.19	
9,620.00	90.31	88.06	6,288.24	-184.35	3,276.95	3,274.49	1.54	1.39	-0.65	
9,715.00	90.75	88.94	6,287.36	-181.86	3,371.91	3,369.48	1.04	0.46	0.93	
9,810.00	90.75	88.77	6,286.11	-179.97	3,466.89	3,464.47	0.18	0.00	-0.18	
9,904.00	91.01	88.50	6,284.67	-177.73	3,560.85	3,558.45	0.40	0.28	-0.29	
9,998.00	90.22	87.36	6,283.66	-174.33	3,654.78	3,652.42	1.48	-0.84	-1.21	
10,093.00	89.60	86.66	6,283.81	-169.38	3,749.65	3,747.34	0.98	-0.65	-0.74	
10,185.00	90.84	90.26	6,283.46	-166.91	3,841.60	3,839.31	4.14	1.35	3.91	
10,276.00	90.75	89.91	6,282.19	-167.04	3,932.59	3,930.29	0.40	-0.10	-0.38	
10,368.00	89.69	88.86	6,281.84	-166.05	4,024.58	4,022.29	1.62	-1.15	-1.14	
10,460.00	90.66	88.77	6,281.56	-164.15	4,116.56	4,114.28	1.06	1.05	-0.10	
10,551.00	90.48	88.15	6,280.66	-161.70	4,207.52	4,205.27	0.71	-0.20	-0.68	
10,643.00	90.66	87.80	6,279.74	-158.45	4,299.46	4,297.24	0.43	0.20	-0.38	
10,734.00	91.19	88.33	6,278.27	-155.38	4,390.40	4,388.21	0.82	0.58	0.58	
10,826.00	89.87	88.50	6,277.42	-152.84	4,482.35	4,480.19	1.45	-1.43	0.18	
10,918.00	89.87	89.12	6,277.63	-150.93	4,574.33	4,572.18	0.67	0.00	0.67	
11,010.00	90.13	88.59	6,277.63	-149.09	4,666.31	4,664.18	0.64	0.28	-0.58	
11,101.00	90.48	88.94	6,277.14	-147.13	4,757.29	4,755.18	0.54	0.38	0.38	
11,193.00	91.19	89.21	6,275.80	-145.64	4,849.27	4,847.16	0.83	0.77	0.29	
11,285.00	89.78	89.38	6,275.02	-144.51	4,941.26	4,939.16	1.54	-1.53	0.18	
11,376.00	89.96	89.65	6,275.23	-143.74	5,032.25	5,030.16	0.36	0.20	0.30	
11,468.00	89.96	90.26	6,275.30	-143.67	5,124.25	5,122.15	0.66	0.00	0.66	
11,559.00	89.96	89.82	6,275.36	-143.73	5,215.25	5,213.14	0.48	0.00	-0.48	
11,651.00	89.25	88.94	6,275.99	-142.74	5,307.24	5,305.14	1.23	-0.77	-0.96	
11,743.00	90.92	89.73	6,275.86	-141.67	5,399.23	5,397.14	2.01	1.82	0.86	
11,834.00	90.92	89.56	6,274.40	-141.10	5,490.22	5,488.12	0.19	0.00	-0.19	
11,925.00	91.45	89.03	6,272.51	-139.98	5,581.19	5,579.10	0.82	0.58	-0.58	
12,017.00	91.10	89.47	6,270.47	-138.78	5,673.16	5,671.08	0.61	-0.38	0.48	
12,109.00	90.22	91.58	6,269.41	-139.62	5,765.15	5,763.05	2.48	-0.96	2.29	
12,201.00	90.40	90.79	6,268.91	-141.53	5,857.12	5,854.99	0.88	0.20	-0.86	
12,292.00	89.96	90.70	6,268.62	-142.71	5,948.12	5,945.97	0.49	-0.48	-0.10	
12,384.00	90.66	90.35	6,268.13	-143.55	6,040.11	6,037.94	0.85	0.76	-0.38	
12,475.00	91.36	90.88	6,266.52	-144.53	6,131.09	6,128.90	0.96	0.77	0.58	
12,567.00	91.36	89.73	6,264.34	-145.02	6,223.06	6,220.86	1.25	0.00	-1.25	
12,658.00	90.40	90.61	6,262.94	-145.29	6,314.05	6,311.84	1.43	-1.05	0.97	
12,750.00	91.10	90.44	6,261.74	-146.13	6,406.04	6,403.81	0.78	0.76	-0.18	
12,842.00	89.78	89.38	6,261.03	-145.99	6,498.03	6,495.80	1.84	-1.43	-1.15	
12,934.00	90.04	88.68	6,261.17	-144.43	6,590.02	6,587.80	0.81	0.28	-0.76	
13,025.00	90.40	89.12	6,260.82	-142.68	6,681.00	6,678.79	0.62	0.40	0.48	
13,117.00	90.57	89.03	6,260.05	-141.20	6,772.98	6,770.79	0.21	0.18	-0.10	
13,209.00	91.19	90.44	6,258.63	-140.77	6,864.97	6,862.77	1.67	0.67	1.53	
13,300.00	89.60	88.86	6,258.01	-140.22	6,955.96	6,953.76	2.46	-1.75	-1.74	

Company:	Bill Barrett Corp.	Local Co-ordinate Reference:	Well Anschutz Equus Farms 4-62-9-4956C2
Project:	Weld County, CO NAD 83	TVD Reference:	GL 4526' & KB 16' @ 4542.00ft
Site:	Anschutz Equus Farms 4-62-9_10 South Pad	MD Reference:	GL 4526' & KB 16' @ 4542.00ft
Well:	Anschutz Equus Farms 4-62-9-4956C2	North Reference:	True
Wellbore:	OH	Survey Calculation Method:	Minimum Curvature
Design:	OH	Database:	Casper District

Survey										
Measured Depth (ft)	Inclination (°)	Azimuth (°)	Vertical Depth (ft)	+N/-S (ft)	+E/-W (ft)	Vertical Section (ft)	Dogleg Rate (°/100ft)	Build Rate (°/100ft)	Turn Rate (°/100ft)	
13,391.00	89.60	89.73	6,258.64	-139.10	7,046.95	7,044.76	0.96	0.00	0.96	
13,483.00	89.16	89.30	6,259.64	-138.32	7,138.94	7,136.76	0.67	-0.48	-0.47	
13,574.00	89.60	88.59	6,260.62	-136.64	7,229.92	7,227.75	0.92	0.48	-0.78	
13,666.00	89.43	87.63	6,261.40	-133.61	7,321.86	7,319.72	1.06	-0.18	-1.04	
13,759.00	90.13	88.42	6,261.76	-130.40	7,414.81	7,412.70	1.13	0.75	0.85	
13,850.00	90.31	87.98	6,261.41	-127.54	7,505.76	7,503.68	0.52	0.20	-0.48	
13,942.00	91.80	88.42	6,259.71	-124.66	7,597.70	7,595.64	1.69	1.62	0.48	
14,034.00	91.89	88.06	6,256.75	-121.83	7,689.60	7,687.58	0.40	0.10	-0.39	
14,125.00	91.45	87.80	6,254.10	-118.55	7,780.51	7,778.51	0.56	-0.48	-0.29	
14,217.00	91.01	88.06	6,252.12	-115.22	7,872.42	7,870.47	0.56	-0.48	0.28	
14,308.00	90.92	86.48	6,250.59	-110.89	7,963.31	7,961.39	1.74	-0.10	-1.74	
14,399.00	91.36	86.22	6,248.78	-105.10	8,054.10	8,052.25	0.56	0.48	-0.29	
14,491.00	90.48	87.98	6,247.30	-100.44	8,145.97	8,144.17	2.14	-0.96	1.91	
14,582.00	91.01	88.50	6,246.12	-97.65	8,236.92	8,235.14	0.82	0.58	0.57	
14,673.00	91.71	90.70	6,243.96	-97.01	8,327.88	8,326.11	2.54	0.77	2.42	
14,765.00	91.10	88.24	6,241.70	-96.16	8,419.84	8,418.08	2.75	-0.66	-2.67	
14,856.00	91.54	89.91	6,239.61	-94.69	8,510.80	8,509.05	1.90	0.48	1.84	
14,948.00	92.51	92.37	6,236.36	-96.52	8,602.72	8,600.93	2.87	1.05	2.67	
15,040.00	90.31	92.37	6,234.09	-100.33	8,694.61	8,692.77	2.39	-2.39	0.00	
15,131.00	90.66	93.60	6,233.32	-105.06	8,785.48	8,783.58	1.41	0.38	1.35	
15,223.00	89.25	91.05	6,233.40	-108.80	8,877.39	8,875.44	3.17	-1.53	-2.77	
15,314.00	90.48	92.02	6,233.61	-111.23	8,968.36	8,966.37	1.72	1.35	1.07	
15,409.00	89.52	91.32	6,233.61	-114.00	9,063.32	9,061.29	1.25	-1.01	-0.74	
15,504.00	91.10	91.67	6,233.10	-116.48	9,158.28	9,156.21	1.70	1.66	0.37	
15,598.00	89.16	90.00	6,232.88	-117.85	9,252.26	9,250.17	2.72	-2.06	-1.78	
15,693.00	91.01	90.97	6,232.74	-118.65	9,347.25	9,345.15	2.20	1.95	1.02	
15,789.00	89.96	88.42	6,231.93	-118.14	9,443.24	9,441.13	2.87	-1.09	-2.66	
15,883.00	91.28	88.77	6,230.91	-115.84	9,537.20	9,535.12	1.45	1.40	0.37	
15,914.00	91.45	89.12	6,230.17	-115.27	9,568.19	9,566.11	1.25	0.55	1.13	
Last SDI MWD Survey										
15,974.00	91.45	89.12	6,228.65	-114.35	9,628.16	9,626.09	0.00	0.00	0.00	
Projection to TD										

Design Annotations				
Measured Depth (ft)	Vertical Depth (ft)	Local Coordinates		Comment
		+N/-S (ft)	+E/-W (ft)	
800.00	800.00	0.00	0.00	Casing Assumed Vertical
884.00	884.00	-0.32	-0.56	First SDI MWD Survey
6,567.00	6,304.81	-211.10	225.18	Last SDI MWD Curve Survey
6,693.00	6,309.15	-216.02	350.96	First SDI MWD Lateral Survey
15,914.00	6,230.17	-115.27	9,568.19	Last SDI MWD Survey
15,974.00	6,228.65	-114.35	9,628.16	Projection to TD