

GREAT WESTERN OPERATING COMPANY

BASIS OF ELEVATION
OPUS SOLUTION GENERATED NAVD 88

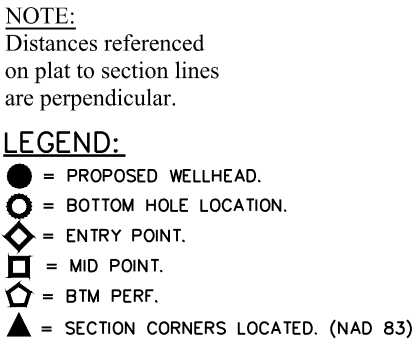
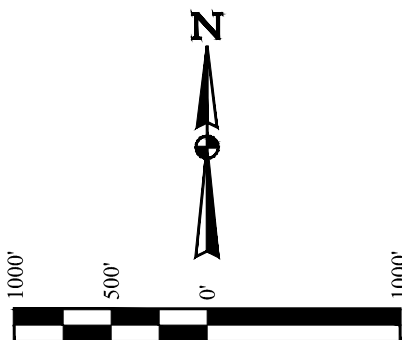
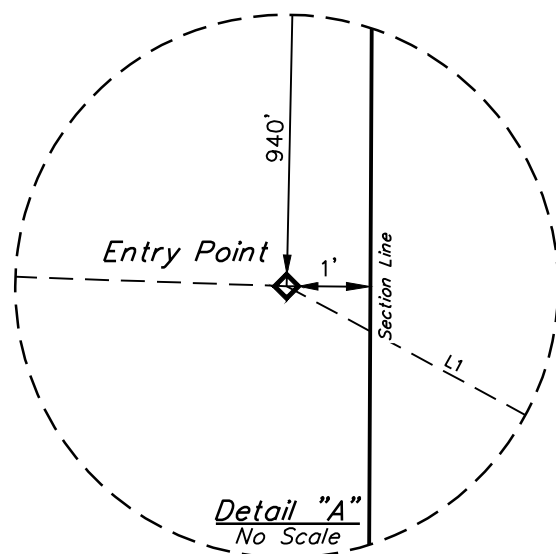
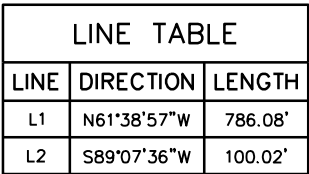

CERTIFICATE OF RECORD
 ABOVE AND CONTAINED HEREIN PREPARED BY THE LAND SURVEYOR
 OF THE STATE OF COLORADO UNDER MY SIGNATURE AND
 MY SEAL AND IN ACCORDANCE WITH THE CONSTITUTION AND
 LAWS OF THE STATE OF COLORADO.
 REGISTERED LAND SURVEYOR
 REGISTRATION NO. 28285
 STATE OF COLORADO
 03-10-21

REV: 16 07-28-21 C.C. (NAME CHANGE, LATERAL CHANGE)

PDOP = 1.5



UELS, LLC
Corporate Office * 85 South 200 East
Vernal, UT 84078 * (435) 789-1017

SURVEYED BY	ORION RICE, J.C.	05-06-20	SCALE
DRAWN BY	C.IVIE	06-12-18	1" = 1000'

WELL LOCATION PLAT