

Form 44: Marr to Mutual (with tie in to Hebron CTB)

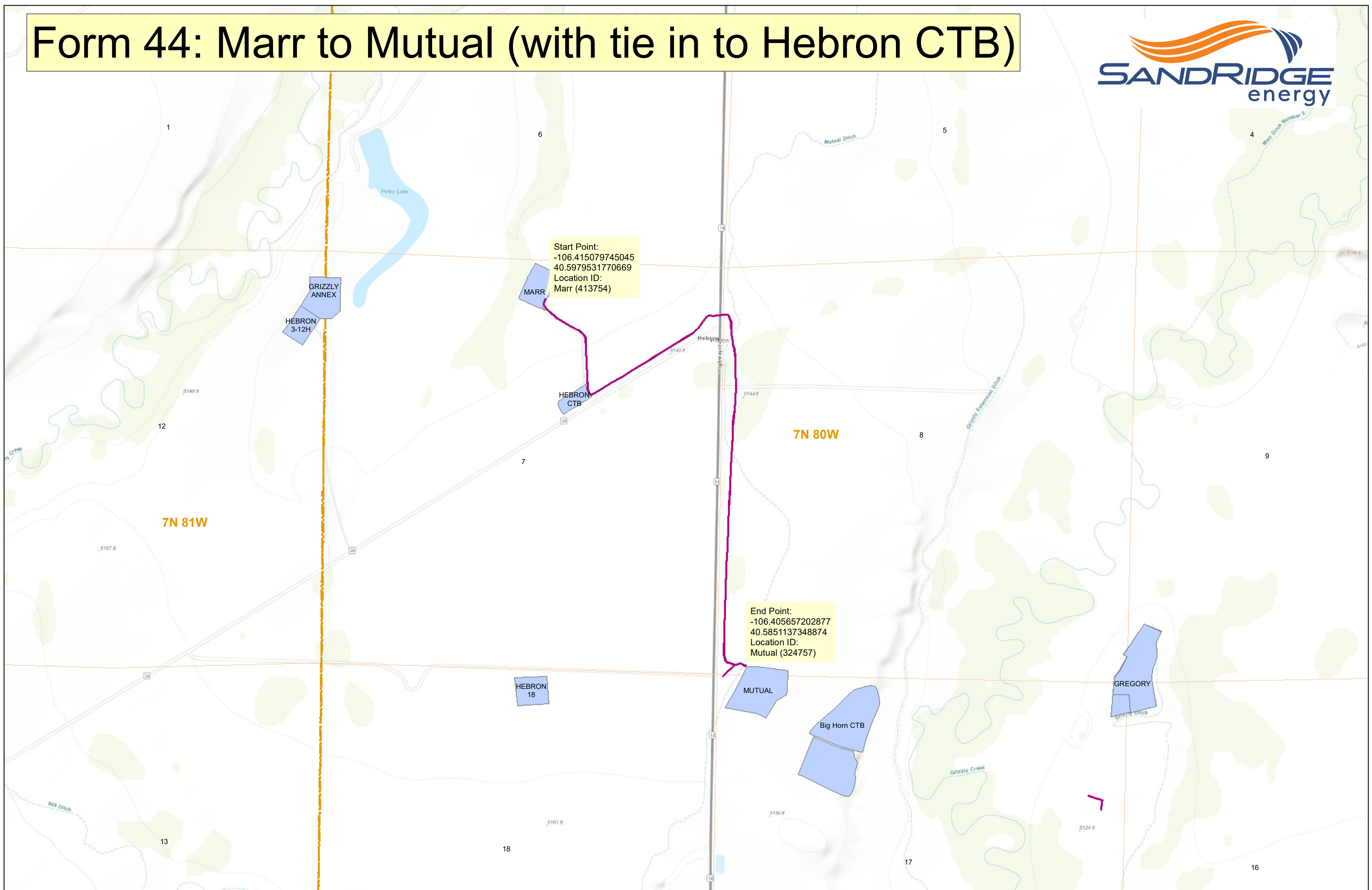

Material	Size	Pressure Rating MAOP	Product	COGCC Line Name
Poly	8	140	2 Phase- Produced Water + Crude Oil	Marr to Mutual (with tie in to Hebron CTB)
Poly	8	140	Natural Gas	Marr to Mutual (with tie in to Hebron CTB)

Legend

— Pipeline(s)

□ Facility Location

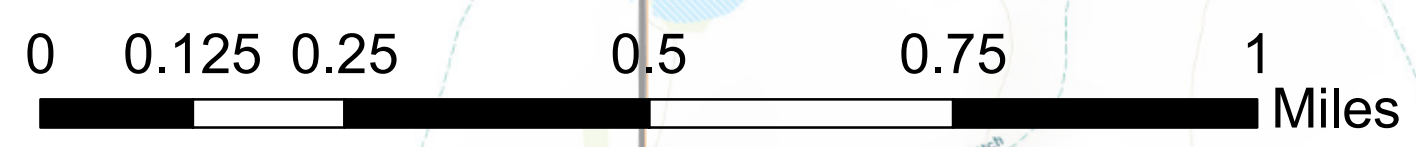

PINTAIL

Esri, HERE, Garmin, (c) OpenStreetMap contributors, and the GIS user community, Sources: Esri, HERE, Garmin, Intermap, increment P Corp., GEBCO, USGS, FAO, NPS, NRCAN, GeoBase, IGN, Kadaster NL, Ordnance Survey, Esri Japan, METI, Esri China (Hong Kong), (c) OpenStreetMap contributors, and the GIS User Community