

US ROCKIES WATTENBERG PLANNING

**WELD-NAD83-UTMFT13N
4N-68W-13 SBJ 22-13HZ PAD
SBJ 13-5HZ**

Plan C

Plan: PERMIT REV-2

Standard Planning Report

04 May, 2021

| | | | | | | | | | | |
|--|---|----------------|--|--------------------|-------------------------|-----------------------|-----------------------|--------------------------|----------|----------------|
| Project: WELD-NAD83-UTMFT13N Site: 4N-68W-13 SBJ 22-13HZ PAD Well: SBJ 13-5HZ Wellbore: Plan C Design: PERMIT REV-2 | ELEVATION | | SURFACE HOLE LOCATION: SBJ 13-5HZ | | | | | | | |
| | GROUND ELEVATION: 4859.00 RKB = 17' @ 4876ft | | +N/-S 0.00 | +E/-W 0.00 | Northing 14641445.95 | Easting 1652441.81 | Latitude 40.315006 | Longitude -104.956862 | | |
| | CASING DETAILS | | DESIGN TARGET DETAILS | | | | | | | |
| | | TVD 1500.00 | MD 1515.80 | Name 9 5/8" Csg | Size 9-5/8 | | | | | |
| | | 6386.00 | 17924.18 | 5 1/2" Csg | 5-1/2 | | | | | |
| SECTION DETAILS | | | | | | | | | | |
| Sec | MD | Inc | Azi | TVD | +N/-S | +E/-W | Dleg | TFace | Vsect | Target |
| 1 | 0.00 | 0.00 | 0.00 | 0.00 | 0.00 | 0.00 | 0.00 | 0.00 | 0.00 | |
| 2 | 400.00 | 0.00 | 0.00 | 400.00 | 0.00 | 0.00 | 0.00 | 0.00 | 0.00 | |
| 3 | 1827.68 | 21.42 | 200.19 | 1794.67 | -247.51 | -91.01 | 1.50 | 200.19 | 93.00 | |
| 4 | 6777.70 | 21.42 | 200.19 | 6402.94 | -1943.84 | -714.77 | 0.00 | 0.00 | 730.35 | |
| 5 | 7850.10 | 93.40 | 269.54 | 6983.00 | -2177.23 | -1462.87 | 8.00 | 69.49 | 1480.30 | SBJ 13-5HZ LP |
| 6 | 17924.18 | 93.40 | 269.54 | 6386.00 | -2258.34 | -11518.91 | 0.00 | 0.00 | 11536.67 | SBJ 13-5HZ BHL |

SHL **HEEL** **TOE**
2203' FNL **917' FSL** **961' FSL**
1076' FWL **387' FEL** **185' FWL**
Section 13 **Section 14** **Section 15**
SWNW **SESE** **SWSW**

| FORMATION TOP DETAILS | | |
|-----------------------|---------|----------------|
| TVDPath | MDPath | Formation |
| 556.00 | 556.04 | Fox Hills |
| 3411.00 | 3563.88 | Parkman |
| 3854.00 | 4039.73 | Sussex |
| 6656.00 | 7064.98 | Sharon Springs |
| 6703.00 | 7124.77 | Niobrara |
| 6755.00 | 7195.43 | Nio B |
| 6808.00 | 7274.41 | Nio C |
| 6947.00 | 7565.22 | Fort Hayes |
| 6967.00 | 7641.98 | Codell |

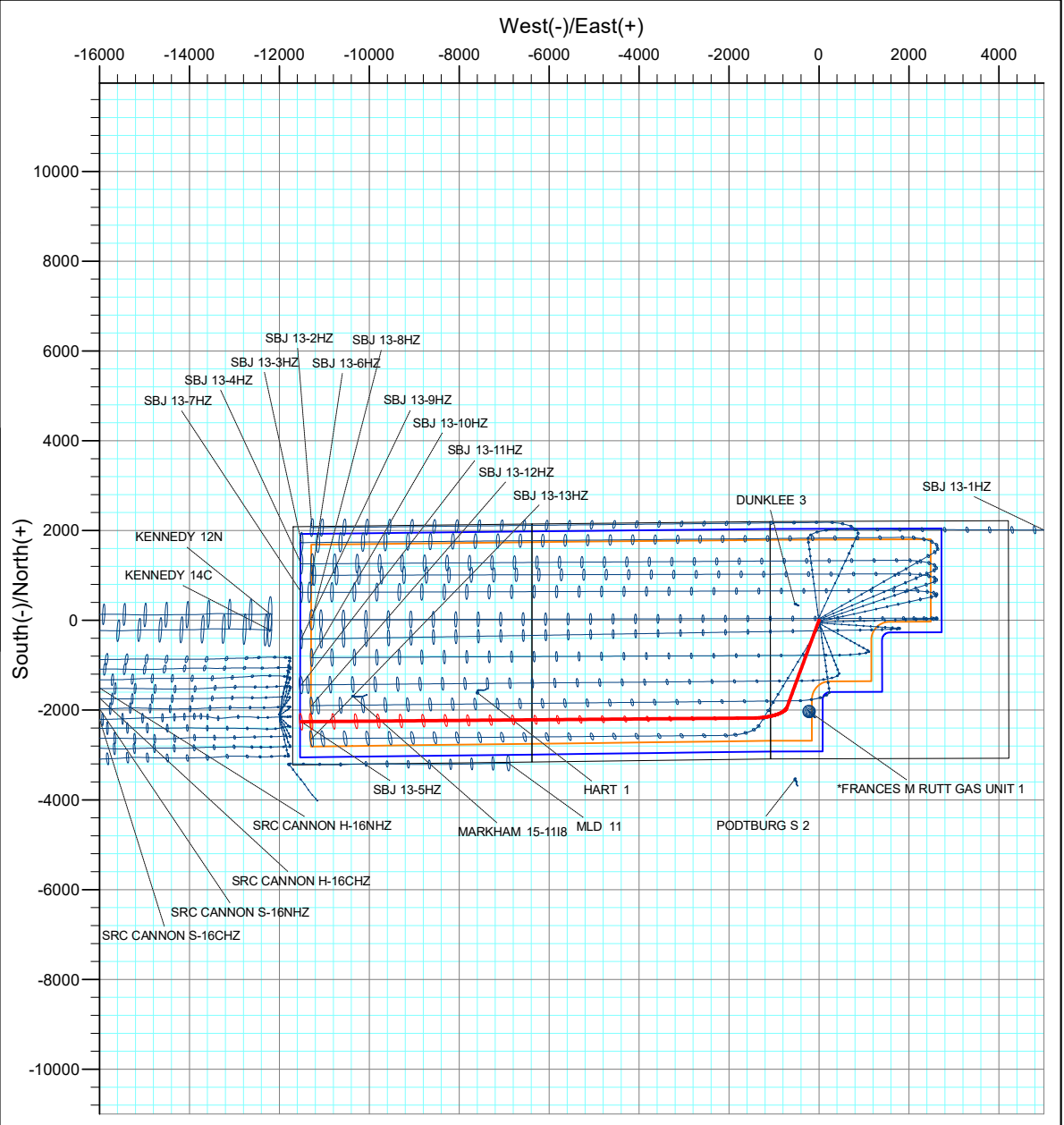
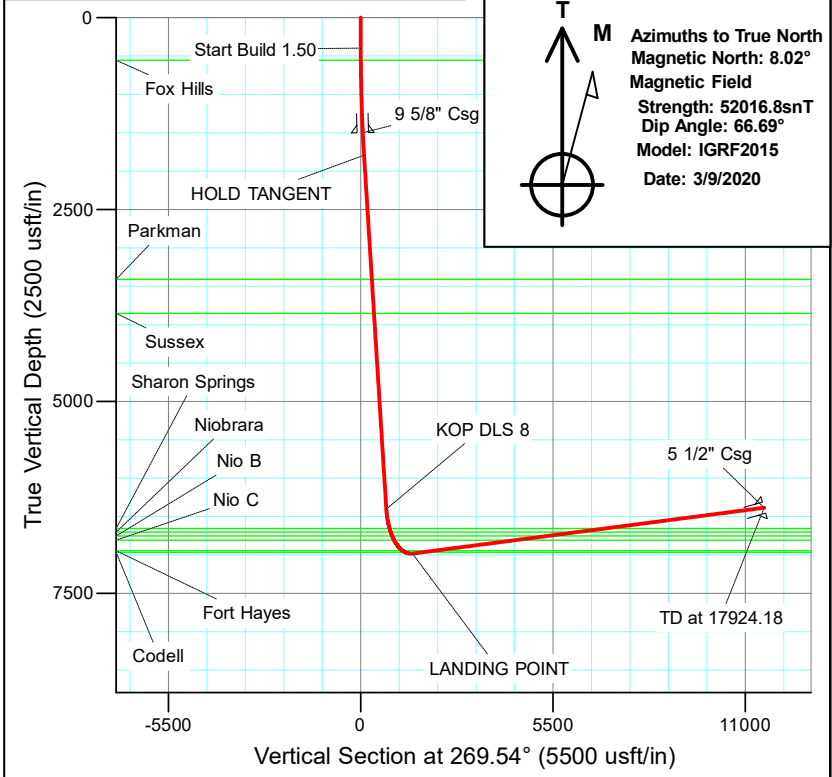

Corporate Planning Report

| | | | |
|------------------|--------------------------------|-------------------------------------|--|
| Database: | PLANNING | Local Co-ordinate Reference: | Well SBJ 13-5HZ |
| Company: | US ROCKIES WATTENBERG PLANNING | TVD Reference: | RKB = 17' @ 4876.00usft (Drilling Rig) |
| Project: | WELD-NAD83-UTMFT13N | MD Reference: | RKB = 17' @ 4876.00usft (Drilling Rig) |
| Site: | 4N-68W-13 SBJ 22-13HZ PAD | North Reference: | True |
| Well: | SBJ 13-5HZ | Survey Calculation Method: | Minimum Curvature |
| Wellbore: | Plan C | | |
| Design: | PERMIT REV-2 | | |

| | | | |
|--------------------|--|----------------------|----------------|
| Project | WELD-NAD83-UTMFT13N | | |
| Map System: | Universal Transverse Mercator (US Survey Feet) | System Datum: | Mean Sea Level |
| Geo Datum: | North American Datum 1983 | | |
| Map Zone: | Zone 13N (108 W to 102 W) | | |

| | | | | | |
|------------------------------|---------------------------|---------------------|--------------------|--------------------------|-------------|
| Site | 4N-68W-13 SBJ 22-13HZ PAD | | | | |
| Site Position: | | Northing: | 14,641,145.55 usft | Latitude: | 40.314181 |
| From: | Lat/Long | Easting: | 1,652,517.50 usft | Longitude: | -104.956591 |
| Position Uncertainty: | 0.00 usft | Slot Radius: | 13-3/16 " | Grid Convergence: | 0.03 ° |

| | | | | | | |
|-----------------------------|--------------|-------------|----------------------------|--------------------|----------------------|---------------|
| Well | SBJ 13-5HZ | | | | | |
| Well Position | +N/-S | 300.43 usft | Northing: | 14,641,445.94 usft | Latitude: | 40.315006 |
| | +E/-W | -75.54 usft | Easting: | 1,652,441.81 usft | Longitude: | -104.956862 |
| Position Uncertainty | | 3.28 usft | Wellhead Elevation: | | Ground Level: | 4,859.00 usft |

| | | | | | |
|------------------|-------------------|--------------------|------------------------|----------------------|----------------------------|
| Wellbore | Plan C | | | | |
| Magnetics | Model Name | Sample Date | Declination (°) | Dip Angle (°) | Field Strength (nT) |
| | IGRF2015 | 3/9/2020 | 8.02 | 66.69 | 52,016.81990793 |

| | | | | |
|--------------------------|--------------------------------|---------------------|----------------------|----------------------|
| Design | PERMIT REV-2 | | | |
| Audit Notes: | | | | |
| Version: | Phase: | PLAN | Tie On Depth: | 0.00 |
| Vertical Section: | Depth From (TVD) (usft) | +N/-S (usft) | +E/-W (usft) | Direction (°) |
| | 0.00 | 0.00 | 0.00 | 269.54 |

| | | | | | |
|---------------------------------|------------------------|--------------------------|-----------------------|--|--|
| Plan Survey Tool Program | Date | 5/4/2021 | | | |
| Depth From (usft) | Depth To (usft) | Survey (Wellbore) | Tool Name | Remarks | |
| 1 | 0.00 | 2,000.00 | PERMIT REV-2 (Plan C) | APC_ISCWSA REV 2 MWD Fixed:v2:standard declination | |
| 2 | 2,000.00 | 17,924.18 | PERMIT REV-2 (Plan C) | APC_ISCWSA REV 2 MWD+II Fixed:v2:Rockies, crustal dec + | |

| Plan Sections | | | | | | | | | | |
|-----------------------|-----------------|-------------|-----------------------|--------------|--------------|-------------------------|------------------------|-----------------------|---------|----------------|
| Measured Depth (usft) | Inclination (°) | Azimuth (°) | Vertical Depth (usft) | +N/-S (usft) | +E/-W (usft) | Dogleg Rate (°/100usft) | Build Rate (°/100usft) | Turn Rate (°/100usft) | TFO (°) | Target |
| 0.00 | 0.00 | 0.00 | 0.00 | 0.00 | 0.00 | 0.00 | 0.00 | 0.00 | 0.00 | |
| 400.00 | 0.00 | 0.00 | 400.00 | 0.00 | 0.00 | 0.00 | 0.00 | 0.00 | 0.00 | |
| 1,827.68 | 21.42 | 200.19 | 1,794.67 | -247.51 | -91.01 | 1.50 | 1.50 | 0.00 | 200.19 | |
| 6,777.70 | 21.42 | 200.19 | 6,402.94 | -1,943.84 | -714.77 | 0.00 | 0.00 | 0.00 | 0.00 | |
| 7,850.10 | 93.40 | 269.54 | 6,983.00 | -2,177.23 | -1,462.87 | 8.00 | 6.71 | 6.47 | 69.49 | SBJ 13-5HZ LP |
| 17,924.18 | 93.40 | 269.54 | 6,386.00 | -2,258.34 | -11,518.91 | 0.00 | 0.00 | 0.00 | 0.00 | SBJ 13-5HZ BHL |

Corporate Planning Report

| | | | |
|------------------|--------------------------------|-------------------------------------|--|
| Database: | PLANNING | Local Co-ordinate Reference: | Well SBJ 13-5HZ |
| Company: | US ROCKIES WATTENBERG PLANNING | TVD Reference: | RKB = 17' @ 4876.00usft (Drilling Rig) |
| Project: | WELD-NAD83-UTMFT13N | MD Reference: | RKB = 17' @ 4876.00usft (Drilling Rig) |
| Site: | 4N-68W-13 SBJ 22-13HZ PAD | North Reference: | True |
| Well: | SBJ 13-5HZ | Survey Calculation Method: | Minimum Curvature |
| Wellbore: | Plan C | | |
| Design: | PERMIT REV-2 | | |

| Planned Survey | | | | | | | | | |
|-----------------------------|--------------------|----------------|-----------------------------|----------------|----------------|-------------------------------|-------------------------------|------------------------------|-----------------------------|
| Measured Depth (usft) | Inclination (°) | Azimuth (°) | Vertical Depth (usft) | +N-S (usft) | +E-W (usft) | Vertical Section (usft) | Dogleg Rate (°/100usft) | Build Rate (°/100usft) | Turn Rate (°/100usft) |
| 0.00 | 0.00 | 0.00 | 0.00 | 0.00 | 0.00 | 0.00 | 0.00 | 0.00 | 0.00 |
| 100.00 | 0.00 | 0.00 | 100.00 | 0.00 | 0.00 | 0.00 | 0.00 | 0.00 | 0.00 |
| 200.00 | 0.00 | 0.00 | 200.00 | 0.00 | 0.00 | 0.00 | 0.00 | 0.00 | 0.00 |
| 300.00 | 0.00 | 0.00 | 300.00 | 0.00 | 0.00 | 0.00 | 0.00 | 0.00 | 0.00 |
| 400.00 | 0.00 | 0.00 | 400.00 | 0.00 | 0.00 | 0.00 | 0.00 | 0.00 | 0.00 |
| Start Build 1.50 | | | | | | | | | |
| 500.00 | 1.50 | 200.19 | 499.99 | -1.23 | -0.45 | 0.46 | 1.50 | 1.50 | 0.00 |
| 556.04 | 2.34 | 200.19 | 556.00 | -2.99 | -1.10 | 1.12 | 1.50 | 1.50 | 0.00 |
| Fox Hills | | | | | | | | | |
| 600.00 | 3.00 | 200.19 | 599.91 | -4.91 | -1.81 | 1.85 | 1.50 | 1.50 | 0.00 |
| 700.00 | 4.50 | 200.19 | 699.69 | -11.05 | -4.06 | 4.15 | 1.50 | 1.50 | 0.00 |
| 800.00 | 6.00 | 200.19 | 799.27 | -19.64 | -7.22 | 7.38 | 1.50 | 1.50 | 0.00 |
| 900.00 | 7.50 | 200.19 | 898.57 | -30.67 | -11.28 | 11.52 | 1.50 | 1.50 | 0.00 |
| 1,000.00 | 9.00 | 200.19 | 997.54 | -44.14 | -16.23 | 16.58 | 1.50 | 1.50 | 0.00 |
| 1,100.00 | 10.50 | 200.19 | 1,096.09 | -60.03 | -22.07 | 22.56 | 1.50 | 1.50 | 0.00 |
| 1,200.00 | 12.00 | 200.19 | 1,194.16 | -78.34 | -28.81 | 29.43 | 1.50 | 1.50 | 0.00 |
| 1,300.00 | 13.50 | 200.19 | 1,291.70 | -99.05 | -36.42 | 37.22 | 1.50 | 1.50 | 0.00 |
| 1,400.00 | 15.00 | 200.19 | 1,388.62 | -122.16 | -44.92 | 45.90 | 1.50 | 1.50 | 0.00 |
| 1,500.00 | 16.50 | 200.19 | 1,484.86 | -147.63 | -54.29 | 55.47 | 1.50 | 1.50 | 0.00 |
| 1,515.80 | 16.74 | 200.19 | 1,500.00 | -151.87 | -55.85 | 57.06 | 1.50 | 1.50 | 0.00 |
| 9 5/8" Csg | | | | | | | | | |
| 1,600.00 | 18.00 | 200.19 | 1,580.36 | -175.46 | -64.52 | 65.93 | 1.50 | 1.50 | 0.00 |
| 1,700.00 | 19.50 | 200.19 | 1,675.05 | -205.63 | -75.61 | 77.26 | 1.50 | 1.50 | 0.00 |
| 1,800.00 | 21.00 | 200.19 | 1,768.86 | -238.12 | -87.56 | 89.47 | 1.50 | 1.50 | 0.00 |
| 1,827.68 | 21.42 | 200.19 | 1,794.67 | -247.51 | -91.01 | 93.00 | 1.50 | 1.50 | 0.00 |
| HOLD TANGENT | | | | | | | | | |
| 1,900.00 | 21.42 | 200.19 | 1,862.00 | -272.30 | -100.13 | 102.31 | 0.00 | 0.00 | 0.00 |
| 2,000.00 | 21.42 | 200.19 | 1,955.09 | -306.57 | -112.73 | 115.19 | 0.00 | 0.00 | 0.00 |
| 2,100.00 | 21.42 | 200.19 | 2,048.19 | -340.84 | -125.33 | 128.06 | 0.00 | 0.00 | 0.00 |
| 2,200.00 | 21.42 | 200.19 | 2,141.28 | -375.10 | -137.93 | 140.94 | 0.00 | 0.00 | 0.00 |
| 2,300.00 | 21.42 | 200.19 | 2,234.38 | -409.37 | -150.53 | 153.81 | 0.00 | 0.00 | 0.00 |
| 2,400.00 | 21.42 | 200.19 | 2,327.48 | -443.64 | -163.13 | 166.69 | 0.00 | 0.00 | 0.00 |
| 2,500.00 | 21.42 | 200.19 | 2,420.57 | -477.91 | -175.73 | 179.56 | 0.00 | 0.00 | 0.00 |
| 2,600.00 | 21.42 | 200.19 | 2,513.67 | -512.18 | -188.33 | 192.44 | 0.00 | 0.00 | 0.00 |
| 2,700.00 | 21.42 | 200.19 | 2,606.76 | -546.45 | -200.93 | 205.32 | 0.00 | 0.00 | 0.00 |
| 2,800.00 | 21.42 | 200.19 | 2,699.86 | -580.72 | -213.54 | 218.19 | 0.00 | 0.00 | 0.00 |
| 2,900.00 | 21.42 | 200.19 | 2,792.96 | -614.99 | -226.14 | 231.07 | 0.00 | 0.00 | 0.00 |
| 3,000.00 | 21.42 | 200.19 | 2,886.05 | -649.26 | -238.74 | 243.94 | 0.00 | 0.00 | 0.00 |
| 3,100.00 | 21.42 | 200.19 | 2,979.15 | -683.53 | -251.34 | 256.82 | 0.00 | 0.00 | 0.00 |
| 3,200.00 | 21.42 | 200.19 | 3,072.24 | -717.79 | -263.94 | 269.69 | 0.00 | 0.00 | 0.00 |
| 3,300.00 | 21.42 | 200.19 | 3,165.34 | -752.06 | -276.54 | 282.57 | 0.00 | 0.00 | 0.00 |
| 3,400.00 | 21.42 | 200.19 | 3,258.44 | -786.33 | -289.14 | 295.45 | 0.00 | 0.00 | 0.00 |
| 3,500.00 | 21.42 | 200.19 | 3,351.53 | -820.60 | -301.74 | 308.32 | 0.00 | 0.00 | 0.00 |
| 3,563.88 | 21.42 | 200.19 | 3,411.00 | -842.49 | -309.79 | 316.55 | 0.00 | 0.00 | 0.00 |
| Parkman | | | | | | | | | |
| 3,600.00 | 21.42 | 200.19 | 3,444.63 | -854.87 | -314.34 | 321.20 | 0.00 | 0.00 | 0.00 |
| 3,700.00 | 21.42 | 200.19 | 3,537.72 | -889.14 | -326.95 | 334.07 | 0.00 | 0.00 | 0.00 |
| 3,800.00 | 21.42 | 200.19 | 3,630.82 | -923.41 | -339.55 | 346.95 | 0.00 | 0.00 | 0.00 |
| 3,900.00 | 21.42 | 200.19 | 3,723.92 | -957.68 | -352.15 | 359.82 | 0.00 | 0.00 | 0.00 |
| 4,000.00 | 21.42 | 200.19 | 3,817.01 | -991.95 | -364.75 | 372.70 | 0.00 | 0.00 | 0.00 |
| 4,039.73 | 21.42 | 200.19 | 3,854.00 | -1,005.56 | -369.76 | 377.82 | 0.00 | 0.00 | 0.00 |
| Sussex | | | | | | | | | |
| 4,100.00 | 21.42 | 200.19 | 3,910.11 | -1,026.22 | -377.35 | 385.58 | 0.00 | 0.00 | 0.00 |

Corporate Planning Report

| | | | |
|------------------|--------------------------------|-------------------------------------|--|
| Database: | PLANNING | Local Co-ordinate Reference: | Well SBJ 13-5HZ |
| Company: | US ROCKIES WATTENBERG PLANNING | TVD Reference: | RKB = 17' @ 4876.00usft (Drilling Rig) |
| Project: | WELD-NAD83-UTMFT13N | MD Reference: | RKB = 17' @ 4876.00usft (Drilling Rig) |
| Site: | 4N-68W-13 SBJ 22-13HZ PAD | North Reference: | True |
| Well: | SBJ 13-5HZ | Survey Calculation Method: | Minimum Curvature |
| Wellbore: | Plan C | | |
| Design: | PERMIT REV-2 | | |

| Planned Survey | | | | | | | | | |
|-----------------------------|--------------------|----------------|-----------------------------|-----------------|-----------------|-------------------------------|-------------------------------|------------------------------|-----------------------------|
| Measured Depth (usft) | Inclination (°) | Azimuth (°) | Vertical Depth (usft) | +N/-S (usft) | +E/-W (usft) | Vertical Section (usft) | Dogleg Rate (°/100usft) | Build Rate (°/100usft) | Turn Rate (°/100usft) |
| 4,200.00 | 21.42 | 200.19 | 4,003.20 | -1,060.48 | -389.95 | 398.45 | 0.00 | 0.00 | 0.00 |
| 4,300.00 | 21.42 | 200.19 | 4,096.30 | -1,094.75 | -402.55 | 411.33 | 0.00 | 0.00 | 0.00 |
| 4,400.00 | 21.42 | 200.19 | 4,189.39 | -1,129.02 | -415.15 | 424.20 | 0.00 | 0.00 | 0.00 |
| 4,500.00 | 21.42 | 200.19 | 4,282.49 | -1,163.29 | -427.75 | 437.08 | 0.00 | 0.00 | 0.00 |
| 4,600.00 | 21.42 | 200.19 | 4,375.59 | -1,197.56 | -440.35 | 449.95 | 0.00 | 0.00 | 0.00 |
| 4,700.00 | 21.42 | 200.19 | 4,468.68 | -1,231.83 | -452.96 | 462.83 | 0.00 | 0.00 | 0.00 |
| 4,800.00 | 21.42 | 200.19 | 4,561.78 | -1,266.10 | -465.56 | 475.71 | 0.00 | 0.00 | 0.00 |
| 4,900.00 | 21.42 | 200.19 | 4,654.87 | -1,300.37 | -478.16 | 488.58 | 0.00 | 0.00 | 0.00 |
| 5,000.00 | 21.42 | 200.19 | 4,747.97 | -1,334.64 | -490.76 | 501.46 | 0.00 | 0.00 | 0.00 |
| 5,100.00 | 21.42 | 200.19 | 4,841.07 | -1,368.91 | -503.36 | 514.33 | 0.00 | 0.00 | 0.00 |
| 5,200.00 | 21.42 | 200.19 | 4,934.16 | -1,403.17 | -515.96 | 527.21 | 0.00 | 0.00 | 0.00 |
| 5,300.00 | 21.42 | 200.19 | 5,027.26 | -1,437.44 | -528.56 | 540.09 | 0.00 | 0.00 | 0.00 |
| 5,400.00 | 21.42 | 200.19 | 5,120.35 | -1,471.71 | -541.16 | 552.96 | 0.00 | 0.00 | 0.00 |
| 5,500.00 | 21.42 | 200.19 | 5,213.45 | -1,505.98 | -553.76 | 565.84 | 0.00 | 0.00 | 0.00 |
| 5,600.00 | 21.42 | 200.19 | 5,306.55 | -1,540.25 | -566.37 | 578.71 | 0.00 | 0.00 | 0.00 |
| 5,700.00 | 21.42 | 200.19 | 5,399.64 | -1,574.52 | -578.97 | 591.59 | 0.00 | 0.00 | 0.00 |
| 5,800.00 | 21.42 | 200.19 | 5,492.74 | -1,608.79 | -591.57 | 604.46 | 0.00 | 0.00 | 0.00 |
| 5,900.00 | 21.42 | 200.19 | 5,585.83 | -1,643.06 | -604.17 | 617.34 | 0.00 | 0.00 | 0.00 |
| 6,000.00 | 21.42 | 200.19 | 5,678.93 | -1,677.33 | -616.77 | 630.22 | 0.00 | 0.00 | 0.00 |
| 6,100.00 | 21.42 | 200.19 | 5,772.03 | -1,711.60 | -629.37 | 643.09 | 0.00 | 0.00 | 0.00 |
| 6,200.00 | 21.42 | 200.19 | 5,865.12 | -1,745.86 | -641.97 | 655.97 | 0.00 | 0.00 | 0.00 |
| 6,300.00 | 21.42 | 200.19 | 5,958.22 | -1,780.13 | -654.57 | 668.84 | 0.00 | 0.00 | 0.00 |
| 6,400.00 | 21.42 | 200.19 | 6,051.31 | -1,814.40 | -667.17 | 681.72 | 0.00 | 0.00 | 0.00 |
| 6,500.00 | 21.42 | 200.19 | 6,144.41 | -1,848.67 | -679.77 | 694.59 | 0.00 | 0.00 | 0.00 |
| 6,600.00 | 21.42 | 200.19 | 6,237.51 | -1,882.94 | -692.38 | 707.47 | 0.00 | 0.00 | 0.00 |
| 6,700.00 | 21.42 | 200.19 | 6,330.60 | -1,917.21 | -704.98 | 720.35 | 0.00 | 0.00 | 0.00 |
| 6,777.70 | 21.42 | 200.19 | 6,402.94 | -1,943.84 | -714.77 | 730.35 | 0.00 | 0.00 | 0.00 |
| KOP DLS 8 | | | | | | | | | |
| 6,800.00 | 22.10 | 204.63 | 6,423.65 | -1,951.47 | -717.92 | 733.57 | 8.00 | 3.07 | 19.93 |
| 6,900.00 | 26.40 | 221.16 | 6,514.91 | -1,985.37 | -740.43 | 756.35 | 8.00 | 4.30 | 16.53 |
| 7,000.00 | 32.07 | 232.79 | 6,602.20 | -2,018.21 | -776.27 | 792.45 | 8.00 | 5.67 | 11.63 |
| 7,064.98 | 36.18 | 238.46 | 6,656.00 | -2,038.69 | -806.38 | 822.72 | 8.00 | 6.33 | 8.73 |
| Sharon Springs | | | | | | | | | |
| 7,100.00 | 38.50 | 241.07 | 6,683.84 | -2,049.37 | -824.73 | 841.16 | 8.00 | 6.61 | 7.44 |
| 7,124.77 | 40.17 | 242.76 | 6,703.00 | -2,056.76 | -838.58 | 855.07 | 8.00 | 6.73 | 6.81 |
| Niobrara | | | | | | | | | |
| 7,195.43 | 45.04 | 246.99 | 6,755.00 | -2,076.98 | -881.89 | 898.53 | 8.00 | 6.90 | 5.99 |
| Nio B | | | | | | | | | |
| 7,200.00 | 45.36 | 247.24 | 6,758.22 | -2,078.24 | -884.88 | 901.53 | 8.00 | 7.01 | 5.43 |
| 7,274.41 | 50.64 | 250.93 | 6,808.00 | -2,097.90 | -936.52 | 953.34 | 8.00 | 7.10 | 4.97 |
| Nio C | | | | | | | | | |
| 7,300.00 | 52.49 | 252.08 | 6,823.91 | -2,104.25 | -955.53 | 972.40 | 8.00 | 7.20 | 4.46 |
| 7,400.00 | 59.77 | 256.06 | 6,879.62 | -2,126.90 | -1,035.33 | 1,052.37 | 8.00 | 7.29 | 3.98 |
| 7,500.00 | 67.16 | 259.48 | 6,924.26 | -2,145.75 | -1,122.71 | 1,139.90 | 8.00 | 7.39 | 3.43 |
| 7,565.22 | 72.02 | 261.52 | 6,947.00 | -2,155.82 | -1,182.98 | 1,200.25 | 8.00 | 7.45 | 3.12 |
| Fort Hayes | | | | | | | | | |
| 7,600.00 | 74.62 | 262.56 | 6,956.98 | -2,160.43 | -1,215.97 | 1,233.28 | 8.00 | 7.47 | 2.98 |
| 7,641.98 | 77.76 | 263.77 | 6,967.00 | -2,165.28 | -1,256.44 | 1,273.79 | 8.00 | 7.49 | 2.90 |
| Codell | | | | | | | | | |
| 7,700.00 | 82.12 | 265.41 | 6,977.13 | -2,170.66 | -1,313.30 | 1,330.69 | 8.00 | 7.50 | 2.82 |
| 7,800.00 | 89.63 | 268.17 | 6,984.32 | -2,176.23 | -1,412.80 | 1,430.23 | 8.00 | 7.51 | 2.75 |
| 7,850.10 | 93.40 | 269.54 | 6,983.00 | -2,177.23 | -1,462.87 | 1,480.30 | 8.00 | 7.52 | 2.74 |
| LANDING POINT | | | | | | | | | |

Corporate Planning Report

| | | | |
|------------------|--------------------------------|-------------------------------------|--|
| Database: | PLANNING | Local Co-ordinate Reference: | Well SBJ 13-5HZ |
| Company: | US ROCKIES WATTENBERG PLANNING | TVD Reference: | RKB = 17' @ 4876.00usft (Drilling Rig) |
| Project: | WELD-NAD83-UTMFT13N | MD Reference: | RKB = 17' @ 4876.00usft (Drilling Rig) |
| Site: | 4N-68W-13 SBJ 22-13HZ PAD | North Reference: | True |
| Well: | SBJ 13-5HZ | Survey Calculation Method: | Minimum Curvature |
| Wellbore: | Plan C | | |
| Design: | PERMIT REV-2 | | |

| Planned Survey | | | | | | | | | | |
|-----------------------------|--------------------|----------------|-----------------------------|-----------------|-----------------|-------------------------------|-------------------------------|------------------------------|-----------------------------|--|
| Measured Depth (usft) | Inclination (°) | Azimuth (°) | Vertical Depth (usft) | +N/-S (usft) | +E/-W (usft) | Vertical Section (usft) | Dogleg Rate (°/100usft) | Build Rate (°/100usft) | Turn Rate (°/100usft) | |
| 7,900.00 | 93.40 | 269.54 | 6,980.04 | -2,177.64 | -1,512.68 | 1,530.11 | 0.00 | 0.00 | 0.00 | |
| 8,000.00 | 93.40 | 269.54 | 6,974.12 | -2,178.44 | -1,612.50 | 1,629.94 | 0.00 | 0.00 | 0.00 | |
| 8,100.00 | 93.40 | 269.54 | 6,968.19 | -2,179.25 | -1,712.32 | 1,729.76 | 0.00 | 0.00 | 0.00 | |
| 8,200.00 | 93.40 | 269.54 | 6,962.26 | -2,180.05 | -1,812.14 | 1,829.58 | 0.00 | 0.00 | 0.00 | |
| 8,300.00 | 93.40 | 269.54 | 6,956.34 | -2,180.86 | -1,911.96 | 1,929.41 | 0.00 | 0.00 | 0.00 | |
| 8,400.00 | 93.40 | 269.54 | 6,950.41 | -2,181.66 | -2,011.78 | 2,029.23 | 0.00 | 0.00 | 0.00 | |
| 8,500.00 | 93.40 | 269.54 | 6,944.49 | -2,182.47 | -2,111.60 | 2,129.06 | 0.00 | 0.00 | 0.00 | |
| 8,600.00 | 93.40 | 269.54 | 6,938.56 | -2,183.27 | -2,211.42 | 2,228.88 | 0.00 | 0.00 | 0.00 | |
| 8,700.00 | 93.40 | 269.54 | 6,932.63 | -2,184.08 | -2,311.25 | 2,328.71 | 0.00 | 0.00 | 0.00 | |
| 8,800.00 | 93.40 | 269.54 | 6,926.71 | -2,184.88 | -2,411.07 | 2,428.53 | 0.00 | 0.00 | 0.00 | |
| 8,900.00 | 93.40 | 269.54 | 6,920.78 | -2,185.69 | -2,510.89 | 2,528.35 | 0.00 | 0.00 | 0.00 | |
| 9,000.00 | 93.40 | 269.54 | 6,914.86 | -2,186.49 | -2,610.71 | 2,628.18 | 0.00 | 0.00 | 0.00 | |
| 9,100.00 | 93.40 | 269.54 | 6,908.93 | -2,187.30 | -2,710.53 | 2,728.00 | 0.00 | 0.00 | 0.00 | |
| 9,200.00 | 93.40 | 269.54 | 6,903.00 | -2,188.10 | -2,810.35 | 2,827.83 | 0.00 | 0.00 | 0.00 | |
| 9,300.00 | 93.40 | 269.54 | 6,897.08 | -2,188.91 | -2,910.17 | 2,927.65 | 0.00 | 0.00 | 0.00 | |
| 9,400.00 | 93.40 | 269.54 | 6,891.15 | -2,189.71 | -3,009.99 | 3,027.48 | 0.00 | 0.00 | 0.00 | |
| 9,500.00 | 93.40 | 269.54 | 6,885.23 | -2,190.52 | -3,109.81 | 3,127.30 | 0.00 | 0.00 | 0.00 | |
| 9,600.00 | 93.40 | 269.54 | 6,879.30 | -2,191.32 | -3,209.63 | 3,227.12 | 0.00 | 0.00 | 0.00 | |
| 9,700.00 | 93.40 | 269.54 | 6,873.37 | -2,192.13 | -3,309.46 | 3,326.95 | 0.00 | 0.00 | 0.00 | |
| 9,800.00 | 93.40 | 269.54 | 6,867.45 | -2,192.93 | -3,409.28 | 3,426.77 | 0.00 | 0.00 | 0.00 | |
| 9,900.00 | 93.40 | 269.54 | 6,861.52 | -2,193.74 | -3,509.10 | 3,526.60 | 0.00 | 0.00 | 0.00 | |
| 10,000.00 | 93.40 | 269.54 | 6,855.60 | -2,194.54 | -3,608.92 | 3,626.42 | 0.00 | 0.00 | 0.00 | |
| 10,100.00 | 93.40 | 269.54 | 6,849.67 | -2,195.35 | -3,708.74 | 3,726.25 | 0.00 | 0.00 | 0.00 | |
| 10,200.00 | 93.40 | 269.54 | 6,843.74 | -2,196.15 | -3,808.56 | 3,826.07 | 0.00 | 0.00 | 0.00 | |
| 10,300.00 | 93.40 | 269.54 | 6,837.82 | -2,196.96 | -3,908.38 | 3,925.89 | 0.00 | 0.00 | 0.00 | |
| 10,400.00 | 93.40 | 269.54 | 6,831.89 | -2,197.76 | -4,008.20 | 4,025.72 | 0.00 | 0.00 | 0.00 | |
| 10,500.00 | 93.40 | 269.54 | 6,825.96 | -2,198.57 | -4,108.02 | 4,125.54 | 0.00 | 0.00 | 0.00 | |
| 10,600.00 | 93.40 | 269.54 | 6,820.04 | -2,199.37 | -4,207.84 | 4,225.37 | 0.00 | 0.00 | 0.00 | |
| 10,700.00 | 93.40 | 269.54 | 6,814.11 | -2,200.18 | -4,307.67 | 4,325.19 | 0.00 | 0.00 | 0.00 | |
| 10,800.00 | 93.40 | 269.54 | 6,808.19 | -2,200.98 | -4,407.49 | 4,425.02 | 0.00 | 0.00 | 0.00 | |
| 10,900.00 | 93.40 | 269.54 | 6,802.26 | -2,201.79 | -4,507.31 | 4,524.84 | 0.00 | 0.00 | 0.00 | |
| 11,000.00 | 93.40 | 269.54 | 6,796.33 | -2,202.59 | -4,607.13 | 4,624.66 | 0.00 | 0.00 | 0.00 | |
| 11,100.00 | 93.40 | 269.54 | 6,790.41 | -2,203.40 | -4,706.95 | 4,724.49 | 0.00 | 0.00 | 0.00 | |
| 11,200.00 | 93.40 | 269.54 | 6,784.48 | -2,204.20 | -4,806.77 | 4,824.31 | 0.00 | 0.00 | 0.00 | |
| 11,300.00 | 93.40 | 269.54 | 6,778.56 | -2,205.01 | -4,906.59 | 4,924.14 | 0.00 | 0.00 | 0.00 | |
| 11,400.00 | 93.40 | 269.54 | 6,772.63 | -2,205.81 | -5,006.41 | 5,023.96 | 0.00 | 0.00 | 0.00 | |
| 11,500.00 | 93.40 | 269.54 | 6,766.70 | -2,206.62 | -5,106.23 | 5,123.79 | 0.00 | 0.00 | 0.00 | |
| 11,600.00 | 93.40 | 269.54 | 6,760.78 | -2,207.42 | -5,206.05 | 5,223.61 | 0.00 | 0.00 | 0.00 | |
| 11,700.00 | 93.40 | 269.54 | 6,754.85 | -2,208.23 | -5,305.88 | 5,323.43 | 0.00 | 0.00 | 0.00 | |
| 11,800.00 | 93.40 | 269.54 | 6,748.93 | -2,209.03 | -5,405.70 | 5,423.26 | 0.00 | 0.00 | 0.00 | |
| 11,900.00 | 93.40 | 269.54 | 6,743.00 | -2,209.84 | -5,505.52 | 5,523.08 | 0.00 | 0.00 | 0.00 | |
| 12,000.00 | 93.40 | 269.54 | 6,737.07 | -2,210.64 | -5,605.34 | 5,622.91 | 0.00 | 0.00 | 0.00 | |
| 12,100.00 | 93.40 | 269.54 | 6,731.15 | -2,211.45 | -5,705.16 | 5,722.73 | 0.00 | 0.00 | 0.00 | |
| 12,200.00 | 93.40 | 269.54 | 6,725.22 | -2,212.25 | -5,804.98 | 5,822.55 | 0.00 | 0.00 | 0.00 | |
| 12,300.00 | 93.40 | 269.54 | 6,719.29 | -2,213.06 | -5,904.80 | 5,922.38 | 0.00 | 0.00 | 0.00 | |
| 12,400.00 | 93.40 | 269.54 | 6,713.37 | -2,213.86 | -6,004.62 | 6,022.20 | 0.00 | 0.00 | 0.00 | |
| 12,500.00 | 93.40 | 269.54 | 6,707.44 | -2,214.67 | -6,104.44 | 6,122.03 | 0.00 | 0.00 | 0.00 | |
| 12,600.00 | 93.40 | 269.54 | 6,701.52 | -2,215.47 | -6,204.27 | 6,221.85 | 0.00 | 0.00 | 0.00 | |
| 12,700.00 | 93.40 | 269.54 | 6,695.59 | -2,216.28 | -6,304.09 | 6,321.68 | 0.00 | 0.00 | 0.00 | |
| 12,800.00 | 93.40 | 269.54 | 6,689.66 | -2,217.08 | -6,403.91 | 6,421.50 | 0.00 | 0.00 | 0.00 | |
| 12,900.00 | 93.40 | 269.54 | 6,683.74 | -2,217.89 | -6,503.73 | 6,521.32 | 0.00 | 0.00 | 0.00 | |
| 13,000.00 | 93.40 | 269.54 | 6,677.81 | -2,218.69 | -6,603.55 | 6,621.15 | 0.00 | 0.00 | 0.00 | |
| 13,100.00 | 93.40 | 269.54 | 6,671.89 | -2,219.50 | -6,703.37 | 6,720.97 | 0.00 | 0.00 | 0.00 | |
| 13,200.00 | 93.40 | 269.54 | 6,665.96 | -2,220.30 | -6,803.19 | 6,820.80 | 0.00 | 0.00 | 0.00 | |

Corporate Planning Report

| | | | |
|------------------|--------------------------------|-------------------------------------|--|
| Database: | PLANNING | Local Co-ordinate Reference: | Well SBJ 13-5HZ |
| Company: | US ROCKIES WATTENBERG PLANNING | TVD Reference: | RKB = 17' @ 4876.00usft (Drilling Rig) |
| Project: | WELD-NAD83-UTMFT13N | MD Reference: | RKB = 17' @ 4876.00usft (Drilling Rig) |
| Site: | 4N-68W-13 SBJ 22-13HZ PAD | North Reference: | True |
| Well: | SBJ 13-5HZ | Survey Calculation Method: | Minimum Curvature |
| Wellbore: | Plan C | | |
| Design: | PERMIT REV-2 | | |

| Planned Survey | | | | | | | | | | |
|-----------------------------|--------------------|----------------|-----------------------------|-----------------|-----------------|-------------------------------|-------------------------------|------------------------------|-----------------------------|--|
| Measured Depth (usft) | Inclination (°) | Azimuth (°) | Vertical Depth (usft) | +N/-S (usft) | +E/-W (usft) | Vertical Section (usft) | Dogleg Rate (°/100usft) | Build Rate (°/100usft) | Turn Rate (°/100usft) | |
| 13,300.00 | 93.40 | 269.54 | 6,660.03 | -2,221.11 | -6,903.01 | 6,920.62 | 0.00 | 0.00 | 0.00 | |
| 13,400.00 | 93.40 | 269.54 | 6,654.11 | -2,221.91 | -7,002.83 | 7,020.45 | 0.00 | 0.00 | 0.00 | |
| 13,500.00 | 93.40 | 269.54 | 6,648.18 | -2,222.72 | -7,102.65 | 7,120.27 | 0.00 | 0.00 | 0.00 | |
| 13,600.00 | 93.40 | 269.54 | 6,642.26 | -2,223.52 | -7,202.48 | 7,220.09 | 0.00 | 0.00 | 0.00 | |
| 13,700.00 | 93.40 | 269.54 | 6,636.33 | -2,224.33 | -7,302.30 | 7,319.92 | 0.00 | 0.00 | 0.00 | |
| 13,800.00 | 93.40 | 269.54 | 6,630.40 | -2,225.13 | -7,402.12 | 7,419.74 | 0.00 | 0.00 | 0.00 | |
| 13,900.00 | 93.40 | 269.54 | 6,624.48 | -2,225.94 | -7,501.94 | 7,519.57 | 0.00 | 0.00 | 0.00 | |
| 14,000.00 | 93.40 | 269.54 | 6,618.55 | -2,226.74 | -7,601.76 | 7,619.39 | 0.00 | 0.00 | 0.00 | |
| 14,100.00 | 93.40 | 269.54 | 6,612.62 | -2,227.55 | -7,701.58 | 7,719.22 | 0.00 | 0.00 | 0.00 | |
| 14,200.00 | 93.40 | 269.54 | 6,606.70 | -2,228.35 | -7,801.40 | 7,819.04 | 0.00 | 0.00 | 0.00 | |
| 14,300.00 | 93.40 | 269.54 | 6,600.77 | -2,229.16 | -7,901.22 | 7,918.86 | 0.00 | 0.00 | 0.00 | |
| 14,400.00 | 93.40 | 269.54 | 6,594.85 | -2,229.96 | -8,001.04 | 8,018.69 | 0.00 | 0.00 | 0.00 | |
| 14,500.00 | 93.40 | 269.54 | 6,588.92 | -2,230.77 | -8,100.86 | 8,118.51 | 0.00 | 0.00 | 0.00 | |
| 14,600.00 | 93.40 | 269.54 | 6,582.99 | -2,231.57 | -8,200.69 | 8,218.34 | 0.00 | 0.00 | 0.00 | |
| 14,700.00 | 93.40 | 269.54 | 6,577.07 | -2,232.38 | -8,300.51 | 8,318.16 | 0.00 | 0.00 | 0.00 | |
| 14,800.00 | 93.40 | 269.54 | 6,571.14 | -2,233.18 | -8,400.33 | 8,417.99 | 0.00 | 0.00 | 0.00 | |
| 14,900.00 | 93.40 | 269.54 | 6,565.22 | -2,233.99 | -8,500.15 | 8,517.81 | 0.00 | 0.00 | 0.00 | |
| 15,000.00 | 93.40 | 269.54 | 6,559.29 | -2,234.79 | -8,599.97 | 8,617.63 | 0.00 | 0.00 | 0.00 | |
| 15,100.00 | 93.40 | 269.54 | 6,553.36 | -2,235.60 | -8,699.79 | 8,717.46 | 0.00 | 0.00 | 0.00 | |
| 15,200.00 | 93.40 | 269.54 | 6,547.44 | -2,236.40 | -8,799.61 | 8,817.28 | 0.00 | 0.00 | 0.00 | |
| 15,300.00 | 93.40 | 269.54 | 6,541.51 | -2,237.21 | -8,899.43 | 8,917.11 | 0.00 | 0.00 | 0.00 | |
| 15,400.00 | 93.40 | 269.54 | 6,535.59 | -2,238.01 | -8,999.25 | 9,016.93 | 0.00 | 0.00 | 0.00 | |
| 15,500.00 | 93.40 | 269.54 | 6,529.66 | -2,238.82 | -9,099.07 | 9,116.76 | 0.00 | 0.00 | 0.00 | |
| 15,600.00 | 93.40 | 269.54 | 6,523.73 | -2,239.62 | -9,198.90 | 9,216.58 | 0.00 | 0.00 | 0.00 | |
| 15,700.00 | 93.40 | 269.54 | 6,517.81 | -2,240.43 | -9,298.72 | 9,316.40 | 0.00 | 0.00 | 0.00 | |
| 15,800.00 | 93.40 | 269.54 | 6,511.88 | -2,241.23 | -9,398.54 | 9,416.23 | 0.00 | 0.00 | 0.00 | |
| 15,900.00 | 93.40 | 269.54 | 6,505.95 | -2,242.04 | -9,498.36 | 9,516.05 | 0.00 | 0.00 | 0.00 | |
| 16,000.00 | 93.40 | 269.54 | 6,500.03 | -2,242.84 | -9,598.18 | 9,615.88 | 0.00 | 0.00 | 0.00 | |
| 16,100.00 | 93.40 | 269.54 | 6,494.10 | -2,243.65 | -9,698.00 | 9,715.70 | 0.00 | 0.00 | 0.00 | |
| 16,200.00 | 93.40 | 269.54 | 6,488.18 | -2,244.45 | -9,797.82 | 9,815.52 | 0.00 | 0.00 | 0.00 | |
| 16,300.00 | 93.40 | 269.54 | 6,482.25 | -2,245.26 | -9,897.64 | 9,915.35 | 0.00 | 0.00 | 0.00 | |
| 16,400.00 | 93.40 | 269.54 | 6,476.32 | -2,246.06 | -9,997.46 | 10,015.17 | 0.00 | 0.00 | 0.00 | |
| 16,500.00 | 93.40 | 269.54 | 6,470.40 | -2,246.87 | -10,097.28 | 10,115.00 | 0.00 | 0.00 | 0.00 | |
| 16,600.00 | 93.40 | 269.54 | 6,464.47 | -2,247.67 | -10,197.11 | 10,214.82 | 0.00 | 0.00 | 0.00 | |
| 16,700.00 | 93.40 | 269.54 | 6,458.55 | -2,248.48 | -10,296.93 | 10,314.65 | 0.00 | 0.00 | 0.00 | |
| 16,800.00 | 93.40 | 269.54 | 6,452.62 | -2,249.29 | -10,396.75 | 10,414.47 | 0.00 | 0.00 | 0.00 | |
| 16,900.00 | 93.40 | 269.54 | 6,446.69 | -2,250.09 | -10,496.57 | 10,514.29 | 0.00 | 0.00 | 0.00 | |
| 17,000.00 | 93.40 | 269.54 | 6,440.77 | -2,250.90 | -10,596.39 | 10,614.12 | 0.00 | 0.00 | 0.00 | |
| 17,100.00 | 93.40 | 269.54 | 6,434.84 | -2,251.70 | -10,696.21 | 10,713.94 | 0.00 | 0.00 | 0.00 | |
| 17,200.00 | 93.40 | 269.54 | 6,428.92 | -2,252.51 | -10,796.03 | 10,813.77 | 0.00 | 0.00 | 0.00 | |
| 17,300.00 | 93.40 | 269.54 | 6,422.99 | -2,253.31 | -10,895.85 | 10,913.59 | 0.00 | 0.00 | 0.00 | |
| 17,400.00 | 93.40 | 269.54 | 6,417.06 | -2,254.12 | -10,995.67 | 11,013.42 | 0.00 | 0.00 | 0.00 | |
| 17,500.00 | 93.40 | 269.54 | 6,411.14 | -2,254.92 | -11,095.49 | 11,113.24 | 0.00 | 0.00 | 0.00 | |
| 17,600.00 | 93.40 | 269.54 | 6,405.21 | -2,255.73 | -11,195.32 | 11,213.06 | 0.00 | 0.00 | 0.00 | |
| 17,700.00 | 93.40 | 269.54 | 6,399.29 | -2,256.53 | -11,295.14 | 11,312.89 | 0.00 | 0.00 | 0.00 | |
| 17,800.00 | 93.40 | 269.54 | 6,393.36 | -2,257.34 | -11,394.96 | 11,412.71 | 0.00 | 0.00 | 0.00 | |
| 17,900.00 | 93.40 | 269.54 | 6,387.43 | -2,258.14 | -11,494.78 | 11,512.54 | 0.00 | 0.00 | 0.00 | |
| 17,924.18 | 93.40 | 269.54 | 6,386.00 | -2,258.34 | -11,518.91 | 11,536.67 | 0.00 | 0.00 | 0.00 | |
| TD at 17924.18 | | | | | | | | | | |

Corporate
Planning Report

| | | | |
|------------------|--------------------------------|-------------------------------------|--|
| Database: | PLANNING | Local Co-ordinate Reference: | Well SBJ 13-5HZ |
| Company: | US ROCKIES WATTENBERG PLANNING | TVD Reference: | RKB = 17' @ 4876.00usft (Drilling Rig) |
| Project: | WELD-NAD83-UTMFT13N | MD Reference: | RKB = 17' @ 4876.00usft (Drilling Rig) |
| Site: | 4N-68W-13 SBJ 22-13HZ PAD | North Reference: | True |
| Well: | SBJ 13-5HZ | Survey Calculation Method: | Minimum Curvature |
| Wellbore: | Plan C | | |
| Design: | PERMIT REV-2 | | |

| Design Targets | | | | | | | | | |
|--|-----------|----------|----------|-----------|------------|---------------|--------------|-----------|-------------|
| Target Name | Dip Angle | Dip Dir. | TVD | +N/-S | +E/-W | Northing | Easting | Latitude | Longitude |
| - hit/miss target | (°) | (°) | (usft) | (usft) | (usft) | (usft) | (usft) | | |
| - Shape | | | | | | | | | |
| SBJ 13-5HZ BHL - plan hits target center - Point | 0.00 | 0.00 | 6,386.00 | -2,258.34 | -11,518.91 | 14,639,182.00 | 1,640,924.00 | 40.308797 | -104.998180 |
| SBJ 13-5HZ LP - plan hits target center - Point | 0.00 | 0.00 | 6,983.00 | -2,177.23 | -1,462.87 | 14,639,268.00 | 1,650,980.00 | 40.309027 | -104.962110 |

| Casing Points | | | | | |
|----------------|----------------|------------|-----------------|---------------|--|
| Measured Depth | Vertical Depth | Name | Casing Diameter | Hole Diameter | |
| (usft) | (usft) | | (") | (") | |
| 1,515.80 | 1,500.00 | 9 5/8" Csg | 9-5/8 | 13-1/2 | |
| 17,924.18 | 6,386.00 | 5 1/2" Csg | 5-1/2 | 7-7/8 | |

| Formations | | | | | |
|----------------|----------------|----------------|-----------|-----|---------------|
| Measured Depth | Vertical Depth | Name | Lithology | Dip | Dip Direction |
| (usft) | (usft) | | | (°) | (°) |
| 556.04 | 556.00 | Fox Hills | | | |
| 3,563.88 | 3,411.00 | Parkman | | | |
| 4,039.73 | 3,854.00 | Sussex | | | |
| 7,064.98 | 6,656.00 | Sharon Springs | | | |
| 7,124.77 | 6,703.00 | Niobrara | | | |
| 7,195.43 | 6,755.00 | Nio B | | | |
| 7,274.41 | 6,808.00 | Nio C | | | |
| 7,565.22 | 6,947.00 | Fort Hayes | | | |
| 7,641.98 | 6,967.00 | Codell | | | |

| Plan Annotations | | | | | |
|------------------|----------------|-------------------|------------|------------------|--|
| Measured Depth | Vertical Depth | Local Coordinates | | Comment | |
| (usft) | (usft) | +N/-S | +E/-W | | |
| | | (usft) | (usft) | | |
| 400.00 | 400.00 | 0.00 | 0.00 | Start Build 1.50 | |
| 1,827.68 | 1,794.67 | -247.51 | -91.01 | HOLD TANGENT | |
| 6,777.70 | 6,402.94 | -1,943.84 | -714.77 | KOP DLS 8 | |
| 7,850.10 | 6,983.00 | -2,177.23 | -1,462.87 | LANDING POINT | |
| 17,924.18 | 6,386.00 | -2,258.34 | -11,518.91 | TD at 17924.18 | |