



ON-SITE FINAL RECLAMATION CONSULTATION

Well Name(s):	Agricultural Prod Inc. 11-2F	API #'s: 05-123-15572
Facility Name:		ID #:
Surface Owner:	Dave Petrocco	Contact #: 303-748-6691
Landman:	Cory Sheahen	

On CRIMP Priority List - Yes / **No**

Appears ready for Form 4 evaluation - Yes / **No**

Variance Required – Yes / **No**

Location Information (choose all that apply):

☒ Off-Location Well(s) ☐ Tank Battery ☐ On-Location Well(s)

Reclamation Plan:

Work to be performed	Access	Well Pad	Tank Battery / PF
Reclaim	Yes / No / NA	Yes / No / NA	Yes / No / NA
Remove Culvert / Cattle Guard	Yes / No / NA	Yes / No / NA	Yes / No / NA
Rip Area	Yes / No / NA	Yes / No / NA	Yes / No / NA
Grade and Contour	Yes / No / NA	Yes / No / NA	Yes / No / NA
Remove Gravel / Roadbase	Yes / No / NA	Yes / No / NA	Yes / No / NA
Replace Topsoil	Yes / No / NA	Yes / No / NA	Yes / No / NA
Remove Fencing	Yes / No / NA	Yes / No / NA	Yes / No / NA
Reseed with Seed Type	Farmer to Plant	Farmer to Plant	N/A
Type of Crop	N/A	N/A	N/A

Special Instructions:

DRIP TAPE IN FIELD AROUND WELLHEAD

Flowline special instructions (NEW P&A's only):

Abandon in place to avoid damaging irrigation system

Notes for CRIMP Spreadsheet:

Surface Owner gives approval for reclamation to begin as of 12/21/2020.

ON-SITE FINAL RECLAMATION CONSULTATION

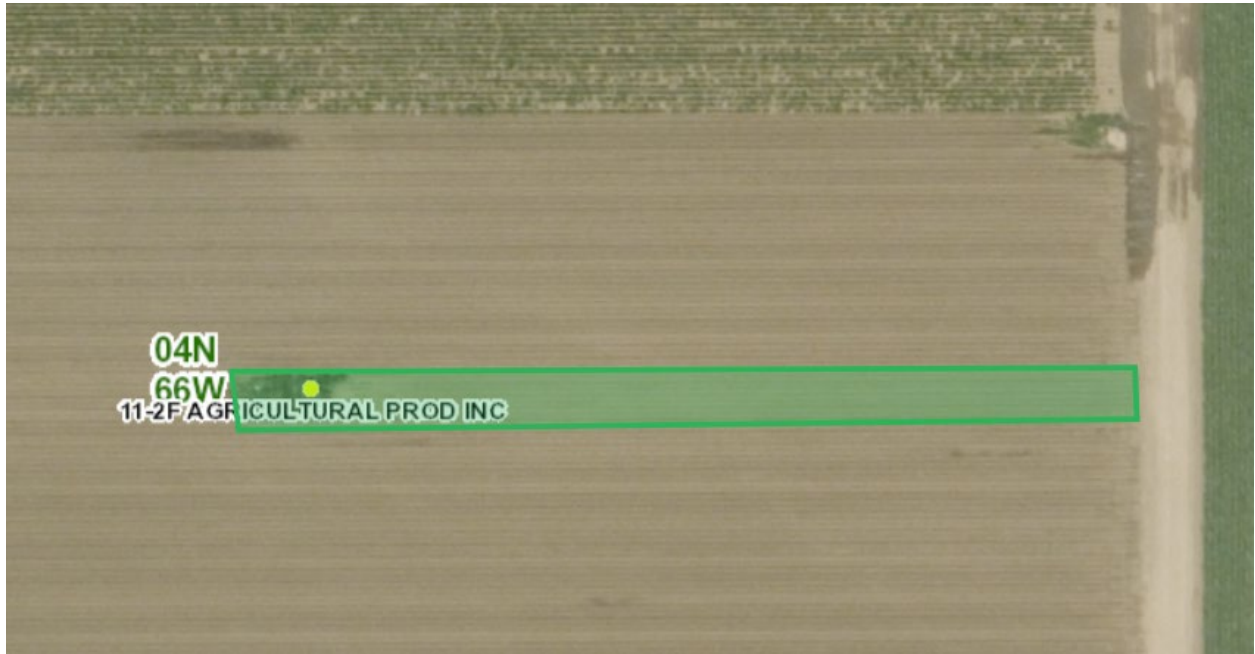

Green- Approximate area to be reclaimed.