

CONFLUENCE RESOURCES



Location:	COLORADO	Slot:	SLOT#17 CANAL 22-3-3L (185°FSL & 1121°FWL,SEC.22)
Field:	WELD COUNTY (NAD83, TRUE NORTH)	Well:	CANAL 22-3-3L
Facility:	SEC.22-T01N-R65W	Wellbore:	CANAL 22-3-3L PWB
Plot reference wellpath is CANAL 22-3-3L PWP Rev-A.0		Grid System: NAD83 / Lambert Colorado SP, Northern Zone (501), US feet	
True vertical depths are referenced to Rig (23) (KB)		North Reference: True north	
Reference wellpath measured depths are referenced to Rig (23) (KB)		Scale: True distance	
Rig (23) (KB) to Mean Sea Level: 5118 feet		Coordinates are in feet referenced to Slot	
Mean Sea Level to Mud line (At Slot: SLOT#17 CANAL 22-3-3L (185°FSL & 1121°FWL,SEC.22)): 0 feet		Depths are in feet	
Offset wellpath MDs are referenced to each path's default MD datum		Created by: painsetr on 2021-05-17; Database: WellArcheicIDB	

Location Information

Facility Name				Grid East (US ft)	Grid North (US ft)	Latitude	Longitude
SEC.22-T01N-R65W				3236383.461	1254962.137	40°01'48.6120"N	104°39'21.0600"W
Slot	Local N (ft)	Local E (ft)		Grid East (US ft)	Grid North (US ft)	Latitude	Longitude
SLOT#17 CANAL 22-3-3L (185°FSL & 1121°FWL,SEC.22)	0.00	72.81		3236456.265	1254962.830	40°01'48.6120"N	104°39'20.1240"W
Rig (23) (KB) to Mud line (At Slot: SLOT#17 CANAL 22-3-3L (185°FSL & 1121°FWL,SEC.22))				5118ft			
Mean Sea Level to Mud line (At Slot: SLOT#17 CANAL 22-3-3L (185°FSL & 1121°FWL,SEC.22))				0ft			
Rig (23) (KB) to Mean Sea Level				5118ft			

Hole and Casing Sections

Name	Start MD (ft)	End MD (ft)	Interval (ft)	Start TVD (ft)	End TVD (ft)	Start Local N (ft)	Start Local E (ft)	End Local N (ft)	End Local E (ft)	Wellbore
9.625in Casing Surface	23.00	1550.00	1527.00	23.00	1541.83	0.00	0.00	-97.02	57.31	CANAL 22-3-3L PWB

Bottom Hole Location

MD (ft)	Inc (°)	Az (°)	TVD (ft)	Local N (ft)	Local E (ft)	Grid East (US ft)	Grid North (US ft)	Latitude	Longitude
17756.54	90.000	1.008	7326.00	9937.94	2505.36	3238866.78	1264923.80	40°03'26.8200"N	104°38'47.9040"W

Targets

Name	MD (ft)	TVD (ft)	Local N (ft)	Local E (ft)	Grid East (US ft)	Grid North (US ft)	Latitude	Longitude
SEC.15-22-T01N-R65W (SB 460)	N/A	6.50	0.00	-72.81	3236383.46	1254962.14	40°01'48.6120"N	104°39'21.0600"W
SEC.15-T01N-R65W	N/A	10.00	0.00	-72.81	3236383.46	1254962.14	40°01'48.6120"N	104°39'21.0600"W
SEC.22-T01N-R65W	N/A	10.00	0.00	-72.81	3236383.46	1254962.14	40°01'48.6120"N	104°39'21.0600"W
CANAL 22-3-3L BHL REV-1(470°FNL & 1720°FEL,SEC.15)	17756.54	7326.00	9937.94	2505.36	3238866.78	1264923.80	40°03'26.8200"N	104°38'47.9040"W
CANAL 22-3-3L LP REV-1(470°FSL & 1820°FEL,SEC.22)	8097.73	7326.00	280.61	2335.51	3238788.91	1255265.66	40°01'51.3840"N	104°38'50.1000"W

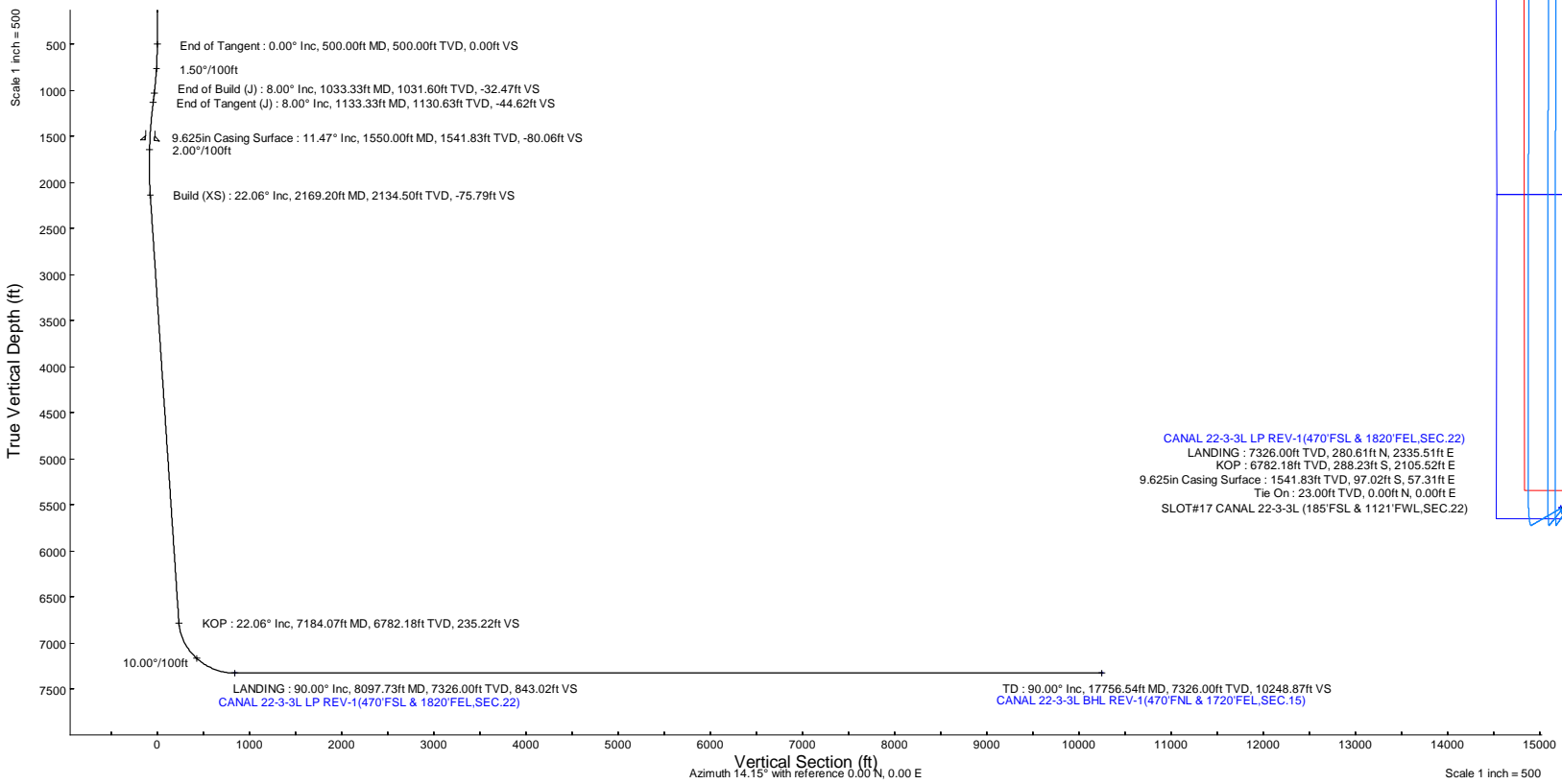

Well Profile Data								
Design Comment	MD (ft)	Inc (°)	Az (°)	TVD (ft)	Local N (ft)	Local E (ft)	DLS (°/100ft)	VS (ft)
Tie On	23.00	0.000	165.000	23.00	0.00	0.00	0.00	0.00
End of Tangent	500.00	0.000	165.000	500.00	0.00	0.00	0.00	0.00
End of Build (J)	1033.33	8.000	165.000	1031.60	-35.91	9.62	1.50	-32.47
End of Tangent (J)	1133.33	8.000	165.000	1130.63	-49.35	13.22	0.00	-44.62
Build (XS)	2169.20	22.061	94.645	2134.50	-135.67	228.12	2.00	-75.79
KOP	7184.07	22.061	94.645	6782.18	-288.23	2105.52	0.00	235.22
LANDING	8097.73	90.000	1.008	7326.00	280.61	2335.51	10.00	843.02
TD	17756.54	90.000	1.008	7326.00	9937.94	2505.36	0.00	10248.87

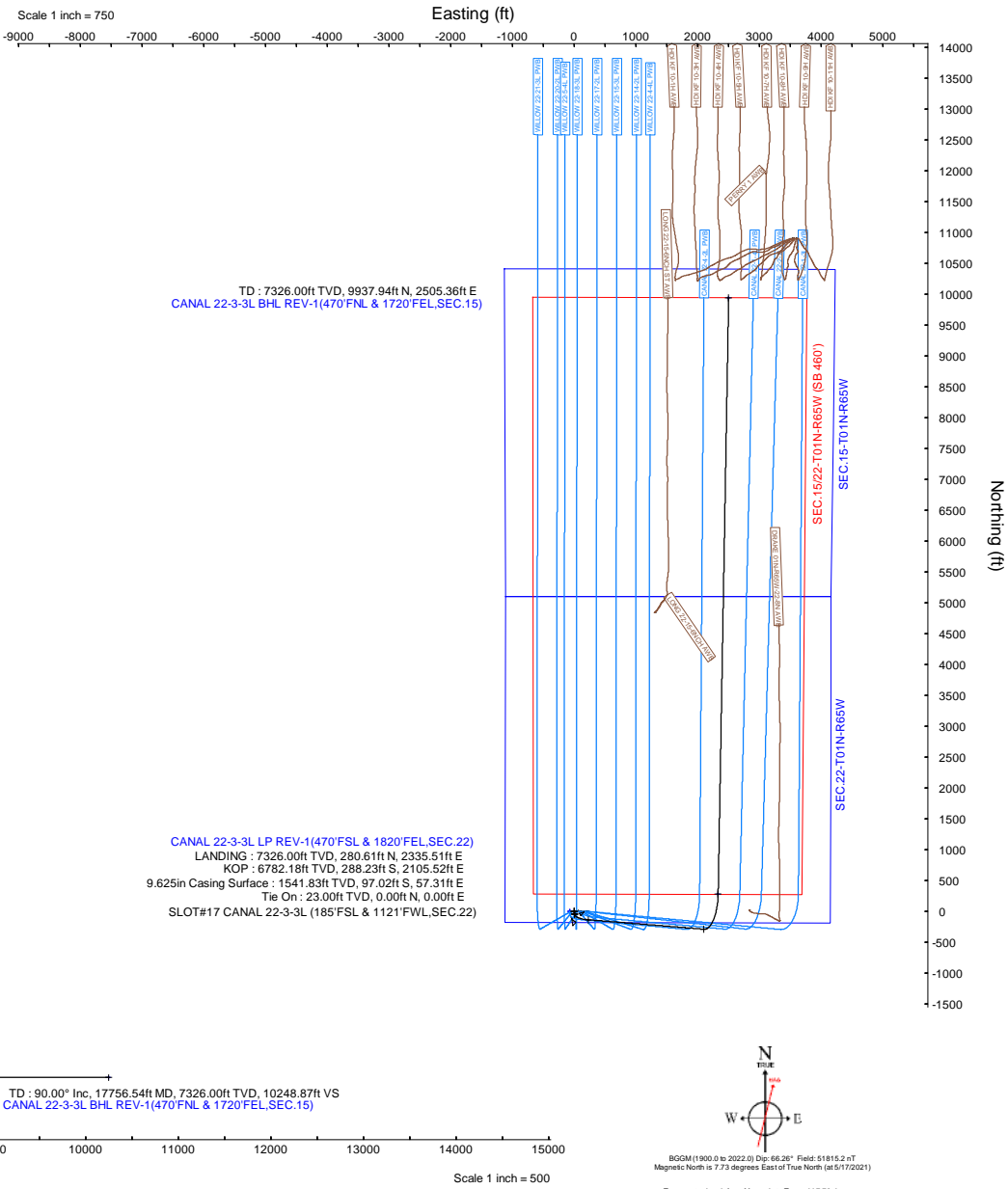

Planned Wellpath Report

CANAL 22-3-3L PWP Rev-A.0

Page 1 of 10

REFERENCE WELLPATH IDENTIFICATION

Operator	CONFLUENCE RESOURCES	Well	CANAL 22-3-3L
Field	WELD COUNTY (NAD83, TRUE NORTH)	API/Legal	
Facility	SEC.22-T01N-R65W	Wellbore	CANAL 22-3-3L PWB
Slot	SLOT#17 CANAL 22-3-3L (185'FSL & 1121'FWL,SEC.22)		

REPORT SETUP INFORMATION

Projection System	NAD83 / Lambert Colorado SP, Northern Zone (501), US feet	Software System	WellArchitect® 6.0
North Reference	True	User	Painsetr
Scale	0.999964	Report Generated	5/17/2021 at 1:48:49 PM
Convergence at slot	0.55° East	Database	WellArchitectDB

WELLPATH LOCATION

	Local coordinates		Grid coordinates		Geographic coordinates	
	North[ft]	East[ft]	Easting[US ft]	Northing[US ft]	Latitude	Longitude
Slot Location	0.00	72.81	3236456.27	1254962.83	40.0301700°	-104.6555900°
Facility Reference Pt			3236383.46	1254962.14	40.0301700°	-104.6558500°
Field Reference Pt			3230456.90	1245096.09	40.0032400°	-104.6773400°

WELLPATH DATUM

Calculation method	Minimum curvature	Rig (23') (KB) to Facility Vertical Datum	5118.00ft
Horizontal Reference Pt	Slot	Rig (23') (KB) to Mean Sea Level	5118.00ft
Vertical Reference Pt	Rig (23') (KB)	Rig (23') (KB) to Mud Line at Slot (SLOT#17 CANAL 22-3-3L (185'FSL & 1121'FWL,SEC.22))	5118.00ft
MD Reference Pt	Rig (23') (KB)	Section Origin	N 0.00, E 0.00 ft
Field Vertical Reference	Mean Sea Level	Section Azimuth	14.15°

Planned Wellpath Report

CANAL 22-3-3L PWP Rev-A.0

Page 2 of 10

REFERENCE WELLPATH IDENTIFICATION

Operator	CONFLUENCE RESOURCES	Well	CANAL 22-3-3L
Field	WELD COUNTY (NAD83, TRUE NORTH)	API/Legal	
Facility	SEC.22-T01N-R65W	Wellbore	CANAL 22-3-3L PWB
Slot	SLOT#17 CANAL 22-3-3L (185'FSL & 1121'FWL,SEC.22)		

WELLPATH DATA (186 stations) † = interpolated, ‡ = extrapolated station

MD [ft]	Inclination [°]	Azimuth [°]	TVD [ft]	Vert Sect [ft]	North [ft]	East [ft]	Grid East [US ft]	Grid North [US ft]	Latitude	Longitude	DLS [°/100ft]	Comments
0.00†	0.000	165.000	0.00	0.00	0.00	0.00	3236456.27	1254962.83	40.0301700	-104.6555900	0.00	
23.00	0.000	165.000	23.00	0.00	0.00	0.00	3236456.27	1254962.83	40.0301700	-104.6555900	0.00	Tie On
123.00†	0.000	165.000	123.00	0.00	0.00	0.00	3236456.27	1254962.83	40.0301700	-104.6555900	0.00	
223.00†	0.000	165.000	223.00	0.00	0.00	0.00	3236456.27	1254962.83	40.0301700	-104.6555900	0.00	
323.00†	0.000	165.000	323.00	0.00	0.00	0.00	3236456.27	1254962.83	40.0301700	-104.6555900	0.00	
423.00†	0.000	165.000	423.00	0.00	0.00	0.00	3236456.27	1254962.83	40.0301700	-104.6555900	0.00	
500.00	0.000	165.000	500.00	0.00	0.00	0.00	3236456.27	1254962.83	40.0301700	-104.6555900	0.00	End of Tangent
523.00†	0.345	165.000	523.00	-0.06	-0.07	0.02	3236456.28	1254962.76	40.0301698	-104.6555899	1.50	
623.00†	1.845	165.000	622.98	-1.73	-1.91	0.51	3236456.80	1254960.92	40.0301647	-104.6555882	1.50	
723.00†	3.345	165.000	722.87	-5.68	-6.29	1.68	3236458.01	1254956.56	40.0301527	-104.6555840	1.50	
823.00†	4.845	165.000	822.62	-11.92	-13.18	3.53	3236459.92	1254949.68	40.0301338	-104.6555774	1.50	
923.00†	6.345	165.000	922.14	-20.43	-22.60	6.06	3236462.54	1254940.29	40.0301080	-104.6555684	1.50	
1023.00†	7.845	165.000	1021.37	-31.22	-34.53	9.25	3236465.85	1254928.39	40.0300752	-104.6555570	1.50	
1033.33	8.000	165.000	1031.60	-32.47	-35.91	9.62	3236466.23	1254927.02	40.0300714	-104.6555556	1.50	End of Build (J)
1123.00†	8.000	165.000	1120.40	-43.36	-47.96	12.85	3236469.57	1254915.00	40.0300383	-104.6555441	0.00	
1133.33	8.000	165.000	1130.63	-44.62	-49.35	13.22	3236469.96	1254913.61	40.0300345	-104.6555428	0.00	End of Tangent (J)
1223.00†	8.178	152.292	1219.41	-54.82	-61.02	17.80	3236474.65	1254901.98	40.0300025	-104.6555264	2.00	
1323.00†	8.810	139.411	1318.32	-64.54	-73.14	26.09	3236483.05	1254889.95	40.0299692	-104.6554968	2.00	
1423.00†	9.814	128.689	1417.01	-72.50	-84.28	37.73	3236494.80	1254878.92	40.0299386	-104.6554553	2.00	
1523.00†	11.088	120.169	1515.36	-78.69	-94.44	52.70	3236509.86	1254868.90	40.0299107	-104.6554018	2.00	
1623.00†	12.552	113.496	1613.24	-83.11	-103.61	70.98	3236528.22	1254859.91	40.0298856	-104.6553365	2.00	
1723.00†	14.145	108.249	1710.54	-85.75	-111.77	92.55	3236549.87	1254851.95	40.0298632	-104.6552595	2.00	
1823.00†	15.829	104.070	1807.13	-86.61	-118.91	117.39	3236574.77	1254845.05	40.0298436	-104.6551708	2.00	
1923.00†	17.578	100.690	1902.91	-85.68	-125.03	145.46	3236602.90	1254839.20	40.0298268	-104.6550706	2.00	
2023.00†	19.374	97.912	1997.76	-82.96	-130.11	176.73	3236634.22	1254834.41	40.0298128	-104.6549589	2.00	
2123.00†	21.206	95.592	2091.55	-78.47	-134.16	211.16	3236668.68	1254830.69	40.0298017	-104.6548360	2.00	
2169.20	22.061	94.645	2134.50	-75.79	-135.67	228.12	3236685.66	1254829.34	40.0297976	-104.6547754	2.00	Build (XS)
2223.00†	22.061	94.645	2184.36	-72.46	-137.31	248.26	3236705.82	1254827.89	40.0297931	-104.6547035	0.00	
2323.00†	22.061	94.645	2277.03	-66.25	-140.35	285.70	3236743.28	1254825.21	40.0297847	-104.6545698	0.00	
2423.00†	22.061	94.645	2369.71	-60.05	-143.39	323.14	3236780.74	1254822.52	40.0297764	-104.6544361	0.00	

Planned Wellpath Report

CANAL 22-3-3L PWP Rev-A.0

Page 3 of 10

REFERENCE WELLPATH IDENTIFICATION

Operator	CONFLUENCE RESOURCES	Well	CANAL 22-3-3L
Field	WELD COUNTY (NAD83, TRUE NORTH)	API/Legal	
Facility	SEC.22-T01N-R65W	Wellbore	CANAL 22-3-3L PWB
Slot	SLOT#17 CANAL 22-3-3L (185'FSL & 1121'FWL,SEC.22)		

WELLPATH DATA (186 stations) † = interpolated, ‡ = extrapolated station

MD [ft]	Inclination [°]	Azimuth [°]	TVD [ft]	Vert Sect [ft]	North [ft]	East [ft]	Grid East [US ft]	Grid North [US ft]	Latitude	Longitude	DLS [°/100ft]	Comments
2523.00†	22.061	94.645	2462.39	-53.85	-146.44	360.57	3236818.20	1254819.84	40.0297680	-104.6543024	0.00	
2623.00†	22.061	94.645	2555.07	-47.65	-149.48	398.01	3236855.67	1254817.15	40.0297597	-104.6541687	0.00	
2723.00†	22.061	94.645	2647.75	-41.45	-152.52	435.45	3236893.13	1254814.47	40.0297513	-104.6540351	0.00	
2823.00†	22.061	94.645	2740.42	-35.25	-155.56	472.88	3236930.59	1254811.78	40.0297430	-104.6539014	0.00	
2923.00†	22.061	94.645	2833.10	-29.04	-158.60	510.32	3236968.05	1254809.10	40.0297346	-104.6537677	0.00	
3023.00†	22.061	94.645	2925.78	-22.84	-161.65	547.76	3237005.52	1254806.41	40.0297263	-104.6536340	0.00	
3123.00†	22.061	94.645	3018.46	-16.64	-164.69	585.19	3237042.98	1254803.73	40.0297179	-104.6535003	0.00	
3223.00†	22.061	94.645	3111.14	-10.44	-167.73	622.63	3237080.44	1254801.04	40.0297095	-104.6533667	0.00	
3323.00†	22.061	94.645	3203.82	-4.24	-170.77	660.07	3237117.90	1254798.36	40.0297012	-104.6532330	0.00	
3423.00†	22.061	94.645	3296.49	1.96	-173.81	697.50	3237155.37	1254795.67	40.0296928	-104.6530993	0.00	
3523.00†	22.061	94.645	3389.17	8.17	-176.86	734.94	3237192.83	1254792.99	40.0296845	-104.6529656	0.00	
3623.00†	22.061	94.645	3481.85	14.37	-179.90	772.38	3237230.29	1254790.30	40.0296761	-104.6528319	0.00	
3723.00†	22.061	94.645	3574.53	20.57	-182.94	809.81	3237267.75	1254787.62	40.0296678	-104.6526982	0.00	
3823.00†	22.061	94.645	3667.21	26.77	-185.98	847.25	3237305.22	1254784.93	40.0296594	-104.6525646	0.00	
3923.00†	22.061	94.645	3759.88	32.97	-189.02	884.69	3237342.68	1254782.24	40.0296511	-104.6524309	0.00	
4023.00†	22.061	94.645	3852.56	39.17	-192.07	922.12	3237380.14	1254779.56	40.0296427	-104.6522972	0.00	
4123.00†	22.061	94.645	3945.24	45.38	-195.11	959.56	3237417.60	1254776.87	40.0296344	-104.6521635	0.00	
4223.00†	22.061	94.645	4037.92	51.58	-198.15	997.00	3237455.07	1254774.19	40.0296260	-104.6520298	0.00	
4323.00†	22.061	94.645	4130.60	57.78	-201.19	1034.43	3237492.53	1254771.50	40.0296177	-104.6518962	0.00	
4423.00†	22.061	94.645	4223.28	63.98	-204.23	1071.87	3237529.99	1254768.82	40.0296093	-104.6517625	0.00	
4523.00†	22.061	94.645	4315.95	70.18	-207.28	1109.31	3237567.45	1254766.13	40.0296009	-104.6516288	0.00	
4623.00†	22.061	94.645	4408.63	76.39	-210.32	1146.74	3237604.92	1254763.45	40.0295926	-104.6514951	0.00	
4723.00†	22.061	94.645	4501.31	82.59	-213.36	1184.18	3237642.38	1254760.76	40.0295842	-104.6513614	0.00	
4823.00†	22.061	94.645	4593.99	88.79	-216.40	1221.62	3237679.84	1254758.08	40.0295759	-104.6512278	0.00	
4923.00†	22.061	94.645	4686.67	94.99	-219.44	1259.05	3237717.30	1254755.39	40.0295675	-104.6510941	0.00	
5023.00†	22.061	94.645	4779.34	101.19	-222.49	1296.49	3237754.77	1254752.71	40.0295592	-104.6509604	0.00	
5123.00†	22.061	94.645	4872.02	107.39	-225.53	1333.93	3237792.23	1254750.02	40.0295508	-104.6508267	0.00	
5223.00†	22.061	94.645	4964.70	113.60	-228.57	1371.36	3237829.69	1254747.34	40.0295425	-104.6506930	0.00	
5323.00†	22.061	94.645	5057.38	119.80	-231.61	1408.80	3237867.15	1254744.65	40.0295341	-104.6505593	0.00	
5423.00†	22.061	94.645	5150.06	126.00	-234.65	1446.24	3237904.62	1254741.97	40.0295257	-104.6504257	0.00	

Planned Wellpath Report

CANAL 22-3-3L PWP Rev-A.0

Page 4 of 10

REFERENCE WELLPATH IDENTIFICATION

Operator	CONFLUENCE RESOURCES	Well	CANAL 22-3-3L
Field	WELD COUNTY (NAD83, TRUE NORTH)	API/Legal	
Facility	SEC.22-T01N-R65W	Wellbore	CANAL 22-3-3L PWB
Slot	SLOT#17 CANAL 22-3-3L (185'FSL & 1121'FWL,SEC.22)		

WELLPATH DATA (186 stations) † = interpolated, ‡ = extrapolated station

MD [ft]	Inclination [°]	Azimuth [°]	TVD [ft]	Vert Sect [ft]	North [ft]	East [ft]	Grid East [US ft]	Grid North [US ft]	Latitude	Longitude	DLS [°/100ft]	Comments
5523.00†	22.061	94.645	5242.74	132.20	-237.70	1483.67	3237942.08	1254739.28	40.0295174	-104.6502920	0.00	
5623.00†	22.061	94.645	5335.41	138.40	-240.74	1521.11	3237979.54	1254736.60	40.0295090	-104.6501583	0.00	
5723.00†	22.061	94.645	5428.09	144.60	-243.78	1558.55	3238017.00	1254733.91	40.0295007	-104.6500246	0.00	
5823.00†	22.061	94.645	5520.77	150.81	-246.82	1595.98	3238054.47	1254731.22	40.0294923	-104.6498909	0.00	
5923.00†	22.061	94.645	5613.45	157.01	-249.86	1633.42	3238091.93	1254728.54	40.0294840	-104.6497573	0.00	
6023.00†	22.061	94.645	5706.13	163.21	-252.91	1670.86	3238129.39	1254725.85	40.0294756	-104.6496236	0.00	
6123.00†	22.061	94.645	5798.80	169.41	-255.95	1708.29	3238166.85	1254723.17	40.0294672	-104.6494899	0.00	
6223.00†	22.061	94.645	5891.48	175.61	-258.99	1745.73	3238204.32	1254720.48	40.0294589	-104.6493562	0.00	
6323.00†	22.061	94.645	5984.16	181.82	-262.03	1783.17	3238241.78	1254717.80	40.0294505	-104.6492225	0.00	
6423.00†	22.061	94.645	6076.84	188.02	-265.07	1820.60	3238279.24	1254715.11	40.0294422	-104.6490889	0.00	
6523.00†	22.061	94.645	6169.52	194.22	-268.12	1858.04	3238316.70	1254712.43	40.0294338	-104.6489552	0.00	
6623.00†	22.061	94.645	6262.20	200.42	-271.16	1895.48	3238354.16	1254709.74	40.0294255	-104.6488215	0.00	
6723.00†	22.061	94.645	6354.87	206.62	-274.20	1932.91	3238391.63	1254707.06	40.0294171	-104.6486878	0.00	
6823.00†	22.061	94.645	6447.55	212.82	-277.24	1970.35	3238429.09	1254704.37	40.0294087	-104.6485541	0.00	
6923.00†	22.061	94.645	6540.23	219.03	-280.28	2007.78	3238466.55	1254701.69	40.0294004	-104.6484205	0.00	
7023.00†	22.061	94.645	6632.91	225.23	-283.33	2045.22	3238504.01	1254699.00	40.0293920	-104.6482868	0.00	
7123.00†	22.061	94.645	6725.59	231.43	-286.37	2082.66	3238541.48	1254696.32	40.0293837	-104.6481531	0.00	
7184.07	22.061	94.645	6782.18	235.22	-288.23	2105.52	3238564.36	1254694.68	40.0293786	-104.6480715	0.00	KOP
7223.00†	22.159	84.293	6818.27	238.92	-288.09	2120.12	3238578.95	1254694.95	40.0293789	-104.6480193	10.00	
7323.00†	25.180	60.356	6910.05	260.10	-275.66	2157.47	3238616.18	1254707.74	40.0294130	-104.6478860	10.00	
7423.00†	31.096	43.121	6998.34	297.51	-246.21	2193.70	3238652.13	1254737.52	40.0294939	-104.6477566	10.00	
7523.00†	38.591	31.460	7080.45	350.01	-200.65	2227.71	3238685.71	1254783.41	40.0296189	-104.6476351	10.00	
7623.00†	46.907	23.242	7153.88	416.01	-140.34	2258.48	3238715.89	1254844.01	40.0297845	-104.6475252	10.00	
7723.00†	55.667	17.043	7216.39	493.49	-67.13	2285.06	3238741.77	1254917.46	40.0299854	-104.6474303	10.00	
7823.00†	64.680	12.039	7266.10	580.11	16.76	2306.64	3238762.55	1255001.55	40.0302157	-104.6473532	10.00	
7923.00†	73.839	7.739	7301.49	673.24	108.78	2322.57	3238777.61	1255093.72	40.0304683	-104.6472962	10.00	
8023.00†	83.075	3.823	7321.49	770.04	206.14	2332.37	3238786.48	1255191.16	40.0307356	-104.6472612	10.00	
8097.73	90.000	1.008	7326.00†	843.02	280.61	2335.51	3238788.91	1255265.66	40.0309400	-104.6472500	10.00	LANDING
8123.00†	90.000	1.008	7326.00	867.63	305.88	2335.95	3238789.11	1255290.93	40.0310094	-104.6472484	0.00	
8223.00†	90.000	1.008	7326.00	965.01	405.87	2337.71	3238789.92	1255390.92	40.0312838	-104.6472421	0.00	

Planned Wellpath Report

CANAL 22-3-3L PWP Rev-A.0

Page 5 of 10

REFERENCE WELLPATH IDENTIFICATION

Operator	CONFLUENCE RESOURCES	Well	CANAL 22-3-3L
Field	WELD COUNTY (NAD83, TRUE NORTH)	API/Legal	
Facility	SEC.22-T01N-R65W	Wellbore	CANAL 22-3-3L PWB
Slot	SLOT#17 CANAL 22-3-3L (185'FSL & 1121'FWL,SEC.22)		

WELLPATH DATA (186 stations) † = interpolated, ‡ = extrapolated station

MD [ft]	Inclination [°]	Azimuth [°]	TVD [ft]	Vert Sect [ft]	North [ft]	East [ft]	Grid East [US ft]	Grid North [US ft]	Latitude	Longitude	DLS [°/100ft]	Comments
8323.00†	90.000	1.008	7326.00	1062.39	505.85	2339.47	3238790.72	1255490.92	40.0315583	-104.6472358	0.00	
8423.00†	90.000	1.008	7326.00	1159.77	605.84	2341.23	3238791.53	1255590.91	40.0318328	-104.6472295	0.00	
8523.00†	90.000	1.008	7326.00	1257.16	705.82	2342.99	3238792.34	1255690.90	40.0321072	-104.6472232	0.00	
8623.00†	90.000	1.008	7326.00	1354.54	805.81	2344.75	3238793.14	1255790.90	40.0323817	-104.6472168	0.00	
8723.00†	90.000	1.008	7326.00	1451.92	905.79	2346.50	3238793.95	1255890.89	40.0326562	-104.6472105	0.00	
8823.00†	90.000	1.008	7326.00	1549.30	1005.77	2348.26	3238794.76	1255990.88	40.0329306	-104.6472042	0.00	
8923.00†	90.000	1.008	7326.00	1646.68	1105.76	2350.02	3238795.56	1256090.87	40.0332051	-104.6471979	0.00	
9023.00†	90.000	1.008	7326.00	1744.06	1205.74	2351.78	3238796.37	1256190.87	40.0334796	-104.6471916	0.00	
9123.00†	90.000	1.008	7326.00	1841.44	1305.73	2353.54	3238797.17	1256290.86	40.0337540	-104.6471853	0.00	
9223.00†	90.000	1.008	7326.00	1938.82	1405.71	2355.30	3238797.98	1256390.85	40.0340285	-104.6471790	0.00	
9323.00†	90.000	1.008	7326.00	2036.20	1505.70	2357.06	3238798.79	1256490.85	40.0343029	-104.6471726	0.00	
9423.00†	90.000	1.008	7326.00	2133.58	1605.68	2358.81	3238799.59	1256590.84	40.0345774	-104.6471663	0.00	
9523.00†	90.000	1.008	7326.00	2230.97	1705.67	2360.57	3238800.40	1256690.83	40.0348519	-104.6471600	0.00	
9623.00†	90.000	1.008	7326.00	2328.35	1805.65	2362.33	3238801.21	1256790.83	40.0351263	-104.6471537	0.00	
9723.00†	90.000	1.008	7326.00	2425.73	1905.64	2364.09	3238802.01	1256890.82	40.0354008	-104.6471474	0.00	
9823.00†	90.000	1.008	7326.00	2523.11	2005.62	2365.85	3238802.82	1256990.81	40.0356753	-104.6471411	0.00	
9923.00†	90.000	1.008	7326.00	2620.49	2105.60	2367.61	3238803.63	1257090.80	40.0359497	-104.6471348	0.00	
10023.00†	90.000	1.008	7326.00	2717.87	2205.59	2369.36	3238804.43	1257190.80	40.0362242	-104.6471284	0.00	
10123.00†	90.000	1.008	7326.00	2815.25	2305.57	2371.12	3238805.24	1257290.79	40.0364987	-104.6471221	0.00	
10223.00†	90.000	1.008	7326.00	2912.63	2405.56	2372.88	3238806.04	1257390.78	40.0367731	-104.6471158	0.00	
10323.00†	90.000	1.008	7326.00	3010.01	2505.54	2374.64	3238806.85	1257490.78	40.0370476	-104.6471095	0.00	
10423.00†	90.000	1.008	7326.00	3107.39	2605.53	2376.40	3238807.66	1257590.77	40.0373221	-104.6471032	0.00	
10523.00†	90.000	1.008	7326.00	3204.78	2705.51	2378.16	3238808.46	1257690.76	40.0375965	-104.6470969	0.00	
10623.00†	90.000	1.008	7326.00	3302.16	2805.50	2379.92	3238809.27	1257790.76	40.0378710	-104.6470906	0.00	
10723.00†	90.000	1.008	7326.00	3399.54	2905.48	2381.67	3238810.08	1257890.75	40.0381454	-104.6470842	0.00	
10823.00†	90.000	1.008	7326.00	3496.92	3005.47	2383.43	3238810.88	1257990.74	40.0384199	-104.6470779	0.00	
10923.00†	90.000	1.008	7326.00	3594.30	3105.45	2385.19	3238811.69	1258090.73	40.0386944	-104.6470716	0.00	
11023.00†	90.000	1.008	7326.00	3691.68	3205.43	2386.95	3238812.49	1258190.73	40.0389688	-104.6470653	0.00	
11123.00†	90.000	1.008	7326.00	3789.06	3305.42	2388.71	3238813.30	1258290.72	40.0392433	-104.6470590	0.00	
11223.00†	90.000	1.008	7326.00	3886.44	3405.40	2390.47	3238814.11	1258390.71	40.0395178	-104.6470527	0.00	

Planned Wellpath Report

CANAL 22-3-3L PWP Rev-A.0

Page 6 of 10

REFERENCE WELLPATH IDENTIFICATION

Operator	CONFLUENCE RESOURCES	Well	CANAL 22-3-3L
Field	WELD COUNTY (NAD83, TRUE NORTH)	API/Legal	
Facility	SEC.22-T01N-R65W	Wellbore	CANAL 22-3-3L PWB
Slot	SLOT#17 CANAL 22-3-3L (185'FSL & 1121'FWL,SEC.22)		

WELLPATH DATA (186 stations) † = interpolated, ‡ = extrapolated station

MD [ft]	Inclination [°]	Azimuth [°]	TVD [ft]	Vert Sect [ft]	North [ft]	East [ft]	Grid East [US ft]	Grid North [US ft]	Latitude	Longitude	DLS [°/100ft]	Comments
11323.00†	90.000	1.008	7326.00	3983.82	3505.39	2392.22	3238814.91	1258490.71	40.0397922	-104.6470464	0.00	
11423.00†	90.000	1.008	7326.00	4081.20	3605.37	2393.98	3238815.72	1258590.70	40.0400667	-104.6470400	0.00	
11523.00†	90.000	1.008	7326.00	4178.59	3705.36	2395.74	3238816.53	1258690.69	40.0403412	-104.6470337	0.00	
11623.00†	90.000	1.008	7326.00	4275.97	3805.34	2397.50	3238817.33	1258790.68	40.0406156	-104.6470274	0.00	
11723.00†	90.000	1.008	7326.00	4373.35	3905.33	2399.26	3238818.14	1258890.68	40.0408901	-104.6470211	0.00	
11823.00†	90.000	1.008	7326.00	4470.73	4005.31	2401.02	3238818.94	1258990.67	40.0411646	-104.6470148	0.00	
11923.00†	90.000	1.008	7326.00	4568.11	4105.30	2402.78	3238819.75	1259090.66	40.0414390	-104.6470085	0.00	
12023.00†	90.000	1.008	7326.00	4665.49	4205.28	2404.53	3238820.56	1259190.66	40.0417135	-104.6470022	0.00	
12123.00†	90.000	1.008	7326.00	4762.87	4305.26	2406.29	3238821.36	1259290.65	40.0419879	-104.6469958	0.00	
12223.00†	90.000	1.008	7326.00	4860.25	4405.25	2408.05	3238822.17	1259390.64	40.0422624	-104.6469895	0.00	
12323.00†	90.000	1.008	7326.00	4957.63	4505.23	2409.81	3238822.98	1259490.64	40.0425369	-104.6469832	0.00	
12423.00†	90.000	1.008	7326.00	5055.01	4605.22	2411.57	3238823.78	1259590.63	40.0428113	-104.6469769	0.00	
12523.00†	90.000	1.008	7326.00	5152.40	4705.20	2413.33	3238824.59	1259690.62	40.0430858	-104.6469706	0.00	
12623.00†	90.000	1.008	7326.00	5249.78	4805.19	2415.08	3238825.39	1259790.61	40.0433603	-104.6469643	0.00	
12723.00†	90.000	1.008	7326.00	5347.16	4905.17	2416.84	3238826.20	1259890.61	40.0436347	-104.6469580	0.00	
12823.00†	90.000	1.008	7326.00	5444.54	5005.16	2418.60	3238827.01	1259990.60	40.0439092	-104.6469516	0.00	
12923.00†	90.000	1.008	7326.00	5541.92	5105.14	2420.36	3238827.81	1260090.59	40.0441837	-104.6469453	0.00	
13023.00†	90.000	1.008	7326.00	5639.30	5205.13	2422.12	3238828.62	1260190.59	40.0444581	-104.6469390	0.00	
13123.00†	90.000	1.008	7326.00	5736.68	5305.11	2423.88	3238829.43	1260290.58	40.0447326	-104.6469327	0.00	
13223.00†	90.000	1.008	7326.00	5834.06	5405.09	2425.64	3238830.23	1260390.57	40.0450071	-104.6469264	0.00	
13323.00†	90.000	1.008	7326.00	5931.44	5505.08	2427.39	3238831.04	1260490.57	40.0452815	-104.6469201	0.00	
13423.00†	90.000	1.008	7326.00	6028.83	5605.06	2429.15	3238831.84	1260590.56	40.0455560	-104.6469137	0.00	
13523.00†	90.000	1.008	7326.00	6126.21	5705.05	2430.91	3238832.65	1260690.55	40.0458304	-104.6469074	0.00	
13623.00†	90.000	1.008	7326.00	6223.59	5805.03	2432.67	3238833.46	1260790.54	40.0461049	-104.6469011	0.00	
13723.00†	90.000	1.008	7326.00	6320.97	5905.02	2434.43	3238834.26	1260890.54	40.0463794	-104.6468948	0.00	
13823.00†	90.000	1.008	7326.00	6418.35	6005.00	2436.19	3238835.07	1260990.53	40.0466538	-104.6468885	0.00	
13923.00†	90.000	1.008	7326.00	6515.73	6104.99	2437.95	3238835.88	1261090.52	40.0469283	-104.6468822	0.00	
14023.00†	90.000	1.008	7326.00	6613.11	6204.97	2439.70	3238836.68	1261190.52	40.0472028	-104.6468758	0.00	
14123.00†	90.000	1.008	7326.00	6710.49	6304.96	2441.46	3238837.49	1261290.51	40.0474772	-104.6468695	0.00	
14223.00†	90.000	1.008	7326.00	6807.87	6404.94	2443.22	3238838.29	1261390.50	40.0477517	-104.6468632	0.00	

Planned Wellpath Report

CANAL 22-3-3L PWP Rev-A.0

Page 7 of 10

REFERENCE WELLPATH IDENTIFICATION

Operator	CONFLUENCE RESOURCES	Well	CANAL 22-3-3L
Field	WELD COUNTY (NAD83, TRUE NORTH)	API/Legal	
Facility	SEC.22-T01N-R65W	Wellbore	CANAL 22-3-3L PWB
Slot	SLOT#17 CANAL 22-3-3L (185'FSL & 1121'FWL,SEC.22)		

WELLPATH DATA (186 stations) † = interpolated, ‡ = extrapolated station

MD [ft]	Inclination [°]	Azimuth [°]	TVD [ft]	Vert Sect [ft]	North [ft]	East [ft]	Grid East [US ft]	Grid North [US ft]	Latitude	Longitude	DLS [°/100ft]	Comments
14323.00†	90.000	1.008	7326.00	6905.25	6504.92	2444.98	3238839.10	1261490.50	40.0480262	-104.6468569	0.00	
14423.00†	90.000	1.008	7326.00	7002.64	6604.91	2446.74	3238839.91	1261590.49	40.0483006	-104.6468506	0.00	
14523.00†	90.000	1.008	7326.00	7100.02	6704.89	2448.50	3238840.71	1261690.48	40.0485751	-104.6468443	0.00	
14623.00†	90.000	1.008	7326.00	7197.40	6804.88	2450.25	3238841.52	1261790.47	40.0488496	-104.6468380	0.00	
14723.00†	90.000	1.008	7326.00	7294.78	6904.86	2452.01	3238842.33	1261890.47	40.0491240	-104.6468316	0.00	
14823.00†	90.000	1.008	7326.00	7392.16	7004.85	2453.77	3238843.13	1261990.46	40.0493985	-104.6468253	0.00	
14923.00†	90.000	1.008	7326.00	7489.54	7104.83	2455.53	3238843.94	1262090.45	40.0496729	-104.6468190	0.00	
15023.00†	90.000	1.008	7326.00	7586.92	7204.82	2457.29	3238844.74	1262190.45	40.0499474	-104.6468127	0.00	
15123.00†	90.000	1.008	7326.00	7684.30	7304.80	2459.05	3238845.55	1262290.44	40.0502219	-104.6468064	0.00	
15223.00†	90.000	1.008	7326.00	7781.68	7404.79	2460.81	3238846.36	1262390.43	40.0504963	-104.6468001	0.00	
15323.00†	90.000	1.008	7326.00	7879.06	7504.77	2462.56	3238847.16	1262490.42	40.0507708	-104.6467937	0.00	
15423.00†	90.000	1.008	7326.00	7976.45	7604.75	2464.32	3238847.97	1262590.42	40.0510453	-104.6467874	0.00	
15523.00†	90.000	1.008	7326.00	8073.83	7704.74	2466.08	3238848.78	1262690.41	40.0513197	-104.6467811	0.00	
15623.00†	90.000	1.008	7326.00	8171.21	7804.72	2467.84	3238849.58	1262790.40	40.0515942	-104.6467748	0.00	
15723.00†	90.000	1.008	7326.00	8268.59	7904.71	2469.60	3238850.39	1262890.40	40.0518687	-104.6467685	0.00	
15823.00†	90.000	1.008	7326.00	8365.97	8004.69	2471.36	3238851.20	1262990.39	40.0521431	-104.6467622	0.00	
15923.00†	90.000	1.008	7326.00	8463.35	8104.68	2473.11	3238852.00	1263090.38	40.0524176	-104.6467558	0.00	
16023.00†	90.000	1.008	7326.00	8560.73	8204.66	2474.87	3238852.81	1263190.38	40.0526920	-104.6467495	0.00	
16123.00†	90.000	1.008	7326.00	8658.11	8304.65	2476.63	3238853.61	1263290.37	40.0529665	-104.6467432	0.00	
16223.00†	90.000	1.008	7326.00	8755.49	8404.63	2478.39	3238854.42	1263390.36	40.0532410	-104.6467369	0.00	
16323.00†	90.000	1.008	7326.00	8852.87	8504.62	2480.15	3238855.23	1263490.35	40.0535154	-104.6467306	0.00	
16423.00†	90.000	1.008	7326.00	8950.26	8604.60	2481.91	3238856.03	1263590.35	40.0537899	-104.6467242	0.00	
16523.00†	90.000	1.008	7326.00	9047.64	8704.58	2483.67	3238856.84	1263690.34	40.0540644	-104.6467179	0.00	
16623.00†	90.000	1.008	7326.00	9145.02	8804.57	2485.42	3238857.65	1263790.33	40.0543388	-104.6467116	0.00	
16723.00†	90.000	1.008	7326.00	9242.40	8904.55	2487.18	3238858.45	1263890.33	40.0546133	-104.6467053	0.00	
16823.00†	90.000	1.008	7326.00	9339.78	9004.54	2488.94	3238859.26	1263990.32	40.0548878	-104.6466990	0.00	
16923.00†	90.000	1.008	7326.00	9437.16	9104.52	2490.70	3238860.06	1264090.31	40.0551622	-104.6466927	0.00	
17023.00†	90.000	1.008	7326.00	9534.54	9204.51	2492.46	3238860.87	1264190.31	40.0554367	-104.6466863	0.00	
17123.00†	90.000	1.008	7326.00	9631.92	9304.49	2494.22	3238861.68	1264290.30	40.0557111	-104.6466800	0.00	
17223.00†	90.000	1.008	7326.00	9729.30	9404.48	2495.97	3238862.48	1264390.29	40.0559856	-104.6466737	0.00	

Planned Wellpath Report

CANAL 22-3-3L PWP Rev-A.0

Page 8 of 10

REFERENCE WELLPATH IDENTIFICATION

Operator	CONFLUENCE RESOURCES	Well	CANAL 22-3-3L
Field	WELD COUNTY (NAD83, TRUE NORTH)	API/Legal	
Facility	SEC.22-T01N-R65W	Wellbore	CANAL 22-3-3L PWB
Slot	SLOT#17 CANAL 22-3-3L (185'FSL & 1121'FWL,SEC.22)		

WELLPATH DATA (186 stations) † = interpolated, ‡ = extrapolated station

MD [ft]	Inclination [°]	Azimuth [°]	TVD [ft]	Vert Sect [ft]	North [ft]	East [ft]	Grid East [US ft]	Grid North [US ft]	Latitude	Longitude	DLS [°/100ft]	Comments
17323.00†	90.000	1.008	7326.00	9826.68	9504.46	2497.73	3238863.29	1264490.28	40.0562601	-104.6466674	0.00	
17423.00†	90.000	1.008	7326.00	9924.07	9604.45	2499.49	3238864.10	1264590.28	40.0565345	-104.6466611	0.00	
17523.00†	90.000	1.008	7326.00	10021.45	9704.43	2501.25	3238864.90	1264690.27	40.0568090	-104.6466548	0.00	
17623.00†	90.000	1.008	7326.00	10118.83	9804.41	2503.01	3238865.71	1264790.26	40.0570835	-104.6466484	0.00	
17723.00†	90.000	1.008	7326.00	10216.21	9904.40	2504.77	3238866.51	1264890.26	40.0573579	-104.6466421	0.00	
17756.54	90.000	1.008	7326.00 [‡]	10248.87	9937.94	2505.36	3238866.78	1264923.80	40.0574500	-104.6466400	0.00	TD

HOLE & CASING SECTIONS - Ref Wellbore: CANAL 22-3-3L PWB Ref Wellpath: CANAL 22-3-3L PWP Rev-A.0

String/Diameter	Start MD [ft]	End MD [ft]	Interval [ft]	Start TVD [ft]	End TVD [ft]	Start N/S [ft]	Start E/W [ft]	End N/S [ft]	End E/W [ft]
9.625in Casing Surface	23.00	1550.00	1527.00	23.00	1541.83	0.00	0.00	-97.02	57.31

REFERENCE WELLPATH IDENTIFICATION

Operator	CONFLUENCE RESOURCES	Well	CANAL 22-3-3L
Field	WELD COUNTY (NAD83, TRUE NORTH)	API/Legal	
Facility	SEC.22-T01N-R65W	Wellbore	CANAL 22-3-3L PWB
Slot	SLOT#17 CANAL 22-3-3L (185'FSL & 1121'FWL,SEC.22)		

TARGETS

Name	MD [ft]	TVD [ft]	North [ft]	East [ft]	Grid East [US ft]	Grid North [US ft]	Latitude	Longitude	Shape
SEC.15/22-T01N-R65W (SB 460')	N/A	6.50	0.00	-72.81	3236383.46	1254962.14	40.0301700	-104.6558500	polygon
	2D Polygon: dimensions not calculated								
SEC.15-T01N-R65W	N/A	10.00	0.00	-72.81	3236383.46	1254962.14	40.0301700	-104.6558500	polygon
	2D Polygon: dimensions not calculated								
SEC.22-T01N-R65W	N/A	10.00	0.00	-72.81	3236383.46	1254962.14	40.0301700	-104.6558500	polygon
	2D Polygon: dimensions not calculated								
2) CANAL 22-3-3L BHL REV-1 (470'FNL & 1720'FEL,SEC.15)	17756.54	7326.00	9937.94	2505.36	3238866.78	1264923.80	40.0574500	-104.6466400	point
1) CANAL 22-3-3L LP REV-1 (470'FSL & 1820'FEL,SEC.22)	8097.73	7326.00	280.61	2335.51	3238788.91	1255265.66	40.0309400	-104.6472500	point

SURVEY PROGRAM - Ref Wellbore: CANAL 22-3-3L PWB Ref Wellpath: CANAL 22-3-3L PWP Rev-A.0

Start MD [ft]	End MD [ft]	Positional Uncertainty Model	Log Name/Comment	Wellbore
23.00	1550.00	BH NaviTrak (2019) (Axial)		CANAL 22-3-3L PWB
1550.00	17756.54	BH AutoTrak Curve/eXpress (2019) (Short spacing)		CANAL 22-3-3L PWB

Planned Wellpath Report

CANAL 22-3-3L PWP Rev-A.0

Page 10 of 10

REFERENCE WELLPATH IDENTIFICATION

Operator	CONFLUENCE RESOURCES	Well	CANAL 22-3-3L
Field	WELD COUNTY (NAD83, TRUE NORTH)	API/Legal	
Facility	SEC.22-T01N-R65W	Wellbore	CANAL 22-3-3L PWB
Slot	SLOT#17 CANAL 22-3-3L (185'FSL & 1121'FWL,SEC.22)		

DESIGN COMMENTS

MD [ft]	Inclination [°]	Azimuth [°]	TVD [ft]	Comment
23.00	0.000	165.000	23.00	Tie On
500.00	0.000	165.000	500.00	End of Tangent
1033.33	8.000	165.000	1031.60	End of Build (J)
1133.33	8.000	165.000	1130.63	End of Tangent (J)
2169.20	22.061	94.645	2134.50	Build (XS)
7184.07	22.061	94.645	6782.18	KOP
8097.73	90.000	1.008	7326.00	LANDING
17756.54	90.000	1.008	7326.00	TD