

# CONFLUENCE RESOURCES



Location:	COLORADO	Slot:	SLOT#16 CANAL 22-1-4L (185°FSL & 1221°FWL,SEC.22)
Field:	WELD COUNTY (NAD83, TRUE NORTH)	Well:	CANAL 22-1-4L
Facility:	SEC.22-T01N-R65W	Wellbore:	CANAL 22-1-4L PWB
Plot reference wellpath is CANAL 22-1-4L PWP Rev-A.0		Grid System: NAD83 / Lambert Colorado SP, Northern Zone (501), US feet	
True vertical depths are referenced to Rig (23) (KB)		North Reference: True north	
Reference wellpath measured depths are referenced to Rig (23) (KB)		Scale: True distance	
Rig (23) (KB) to Mean Sea Level: 5118 feet		Coordinates are in feet referenced to Slot	
Mean Sea Level to Mud line (At Slot: SLOT#16 CANAL 22-1-4L (185°FSL & 1221°FWL,SEC.22)): 0 feet		Depths are in feet	
Offset wellpath MDs are referenced to each path's default MD datum		Created by: painsetr on 2021-05-17; Database: WellArchiTecIDB	

Location Information					
Facility Name			Grid East (US ft)	Grid North (US ft)	Latitude
SEC.22-T01N-R65W			3236383.461	1254962.137	40°01'48.6120"N
Slot	Local N (ft)	Local E (ft)	Grid East (US ft)	Grid North (US ft)	Latitude
SLOT#16 CANAL 22-1-4L (185°FSL & 1221°FWL,SEC.22)	0.00	173.62	3236557.072	1254963.790	40°01'48.6120"N
Rig (23) (KB) to Mud line (At Slot: SLOT#16 CANAL 22-1-4L (185°FSL & 1221°FWL,SEC.22))			5118ft		
Mean Sea Level to Mud line (At Slot: SLOT#16 CANAL 22-1-4L (185°FSL & 1221°FWL,SEC.22))			0ft		
Rig (23) (KB) to Mean Sea Level			5118ft		

Hole and Casing Sections										
Name	Start MD (ft)	End MD (ft)	Interval (ft)	Start TVD (ft)	End TVD (ft)	Start Local N (ft)	Start Local E (ft)	End Local N (ft)	End Local E (ft)	Wellbore
9.625in Casing Surface	23.00	1550.00	1527.00	23.00	1539.43	0.00	0.00	-71.13	106.57	CANAL 22-1-4L PWB

Bottom Hole Location							
MD (ft)	Inc (°)	Az (°)	TVD (ft)	Local N (ft)	Local E (ft)	Grid East (US ft)	Grid North (US ft)
17966.23	90.000	1.306	7475.00	9934.33	2804.88	3239267.08	1264924.01

Targets							
Name	MD (ft)	TVD (ft)	Local N (ft)	Local E (ft)	Grid East (US ft)	Grid North (US ft)	Latitude
SEC.15-22-T01N-R65W (SB 460)	N/A	6.50	0.00	-173.62	3236383.46	1254962.14	40°01'48.6120"N
SEC.15-T01N-R65W	N/A	10.00	0.00	-173.62	3236383.46	1254962.14	40°01'48.6120"N
SEC.22-T01N-R65W	N/A	10.00	0.00	-173.62	3236383.46	1254962.14	40°01'48.6120"N
CANAL 22-1-4L BHL REV-1(470°FNL & 1320°FEL,SEC.15)	17966.23	7475.00	9934.33	2804.88	3239267.08	1264924.01	40°03'26.7840"N
CANAL 22-1-4L LP REV-1(470°FSL & 1470°FEL,SEC.22)	8310.03	7475.00	280.64	2584.74	3239138.93	1255269.03	40°01'51.3840"N

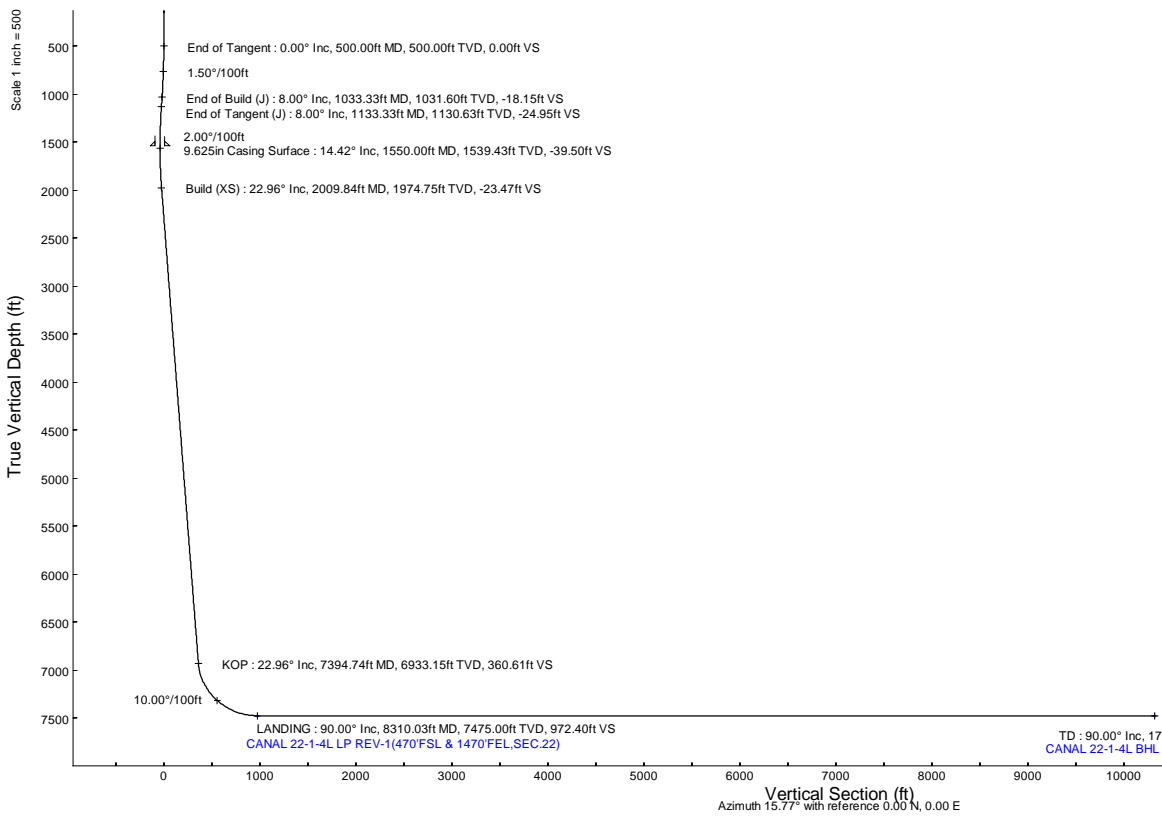

Well Profile Data								
Design Comment	MD (ft)	Inc (°)	Az (°)	TVD (ft)	Local N (ft)	Local E (ft)	DLS (°/100ft)	VS (ft)
Tie On	23.00	0.000	135.000	23.00	0.00	0.00	0.00	0.00
End of Tangent	500.00	0.000	135.000	500.00	0.00	0.00	0.00	0.00
End of Build (J)	1033.33	8.000	135.000	1031.60	-26.29	26.29	1.50	-18.15
End of Tangent (J)	1133.33	8.000	135.000	1130.63	-36.13	36.13	0.00	-24.95
Build (XS)	2009.84	22.957	95.230	1974.75	-95.30	251.16	2.00	-23.47
KOP	7394.74	22.957	95.230	6933.15	-286.75	2342.76	0.00	360.61
LANDING	8310.03	90.000	1.306	7475.00	280.64	2584.74	10.00	972.40
TD	17966.23	90.000	1.306	7475.00	9934.33	2804.88	0.00	10322.70

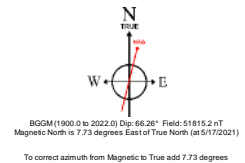
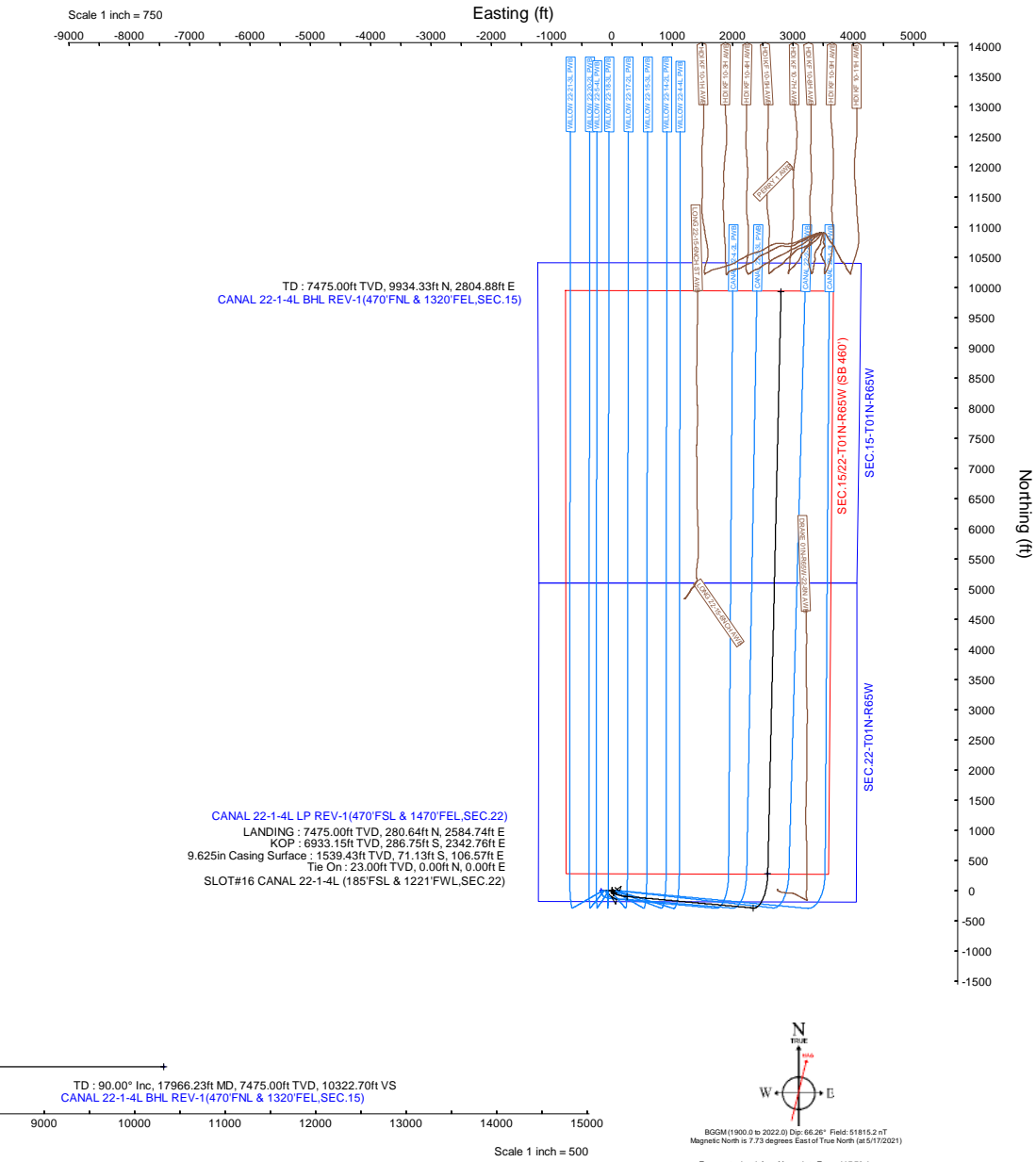

# Planned Wellpath Report

CANAL 22-1-4L PWP Rev-A.0

Page 1 of 10

## REFERENCE WELLPATH IDENTIFICATION

Operator	CONFLUENCE RESOURCES	Well	CANAL 22-1-4L
Field	WELD COUNTY (NAD83, TRUE NORTH)	API/Legal	
Facility	SEC.22-T01N-R65W	Wellbore	CANAL 22-1-4L PWB
Slot	SLOT#16 CANAL 22-1-4L (185'FSL & 1221'FWL,SEC.22)		

## REPORT SETUP INFORMATION

Projection System	NAD83 / Lambert Colorado SP, Northern Zone (501), US feet	Software System	WellArchitect® 6.0
North Reference	True	User	Painsetr
Scale	0.999964	Report Generated	5/17/2021 at 1:43:52 PM
Convergence at slot	0.55° East	Database	WellArchitectDB

## WELLPATH LOCATION

	Local coordinates		Grid coordinates		Geographic coordinates	
	North[ft]	East[ft]	Easting[US ft]	Northing[US ft]	Latitude	Longitude
Slot Location	0.00	173.62	3236557.07	1254963.79	40.0301700°	-104.6552300°
Facility Reference Pt			3236383.46	1254962.14	40.0301700°	-104.6558500°
Field Reference Pt			3230456.90	1245096.09	40.0032400°	-104.6773400°

## WELLPATH DATUM

Calculation method	Minimum curvature	Rig (23') (KB) to Facility Vertical Datum	5118.00ft
Horizontal Reference Pt	Slot	Rig (23') (KB) to Mean Sea Level	5118.00ft
Vertical Reference Pt	Rig (23') (KB)	Rig (23') (KB) to Mud Line at Slot (SLOT#16 CANAL 22-1-4L (185'FSL & 1221'FWL,SEC.22))	5118.00ft
MD Reference Pt	Rig (23') (KB)	Section Origin	N 0.00, E 0.00 ft
Field Vertical Reference	Mean Sea Level	Section Azimuth	15.77°

# Planned Wellpath Report

CANAL 22-1-4L PWP Rev-A.0

Page 2 of 10

## REFERENCE WELLPATH IDENTIFICATION

Operator	CONFLUENCE RESOURCES	Well	CANAL 22-1-4L
Field	WELD COUNTY (NAD83, TRUE NORTH)	API/Legal	
Facility	SEC.22-T01N-R65W	Wellbore	CANAL 22-1-4L PWB
Slot	SLOT#16 CANAL 22-1-4L (185'FSL & 1221'FWL,SEC.22)		

## WELLPATH DATA (188 stations) † = interpolated, ‡ = extrapolated station

MD [ft]	Inclination [°]	Azimuth [°]	TVD [ft]	Vert Sect [ft]	North [ft]	East [ft]	Grid East [US ft]	Grid North [US ft]	Latitude	Longitude	DLS [°/100ft]	Comments
0.00†	0.000	135.000	0.00	0.00	0.00	0.00	3236557.07	1254963.79	40.0301700	-104.6552300	0.00	
23.00	0.000	135.000	23.00	0.00	0.00	0.00	3236557.07	1254963.79	40.0301700	-104.6552300	0.00	Tie On
123.00†	0.000	135.000	123.00	0.00	0.00	0.00	3236557.07	1254963.79	40.0301700	-104.6552300	0.00	
223.00†	0.000	135.000	223.00	0.00	0.00	0.00	3236557.07	1254963.79	40.0301700	-104.6552300	0.00	
323.00†	0.000	135.000	323.00	0.00	0.00	0.00	3236557.07	1254963.79	40.0301700	-104.6552300	0.00	
423.00†	0.000	135.000	423.00	0.00	0.00	0.00	3236557.07	1254963.79	40.0301700	-104.6552300	0.00	
500.00	0.000	135.000	500.00	0.00	0.00	0.00	3236557.07	1254963.79	40.0301700	-104.6552300	0.00	End of Tangent
523.00†	0.345	135.000	523.00	-0.03	-0.05	0.05	3236557.12	1254963.74	40.0301699	-104.6552298	1.50	
623.00†	1.845	135.000	622.98	-0.97	-1.40	1.40	3236558.48	1254962.40	40.0301662	-104.6552250	1.50	
723.00†	3.345	135.000	722.87	-3.18	-4.60	4.60	3236561.72	1254959.23	40.0301574	-104.6552136	1.50	
823.00†	4.845	135.000	822.62	-6.67	-9.65	9.65	3236566.81	1254954.23	40.0301435	-104.6551955	1.50	
923.00†	6.345	135.000	922.14	-11.43	-16.54	16.54	3236573.77	1254947.40	40.0301246	-104.6551709	1.50	
1023.00†	7.845	135.000	1021.37	-17.46	-25.28	25.28	3236582.59	1254938.75	40.0301006	-104.6551397	1.50	
1033.33	8.000	135.000	1031.60	-18.15	-26.29	26.29	3236583.61	1254937.76	40.0300978	-104.6551361	1.50	End of Build (J)
1123.00†	8.000	135.000	1120.40	-24.25	-35.11	35.11	3236592.51	1254929.02	40.0300736	-104.6551046	0.00	
1133.33	8.000	135.000	1130.63	-24.95	-36.13	36.13	3236593.54	1254928.01	40.0300708	-104.6551010	0.00	End of Tangent (J)
1223.00†	9.125	125.592	1219.30	-30.41	-44.68	46.32	3236603.81	1254919.56	40.0300474	-104.6550646	2.00	
1323.00†	10.598	117.664	1317.82	-35.00	-53.56	60.92	3236618.49	1254910.81	40.0300230	-104.6550125	2.00	
1423.00†	12.220	111.732	1415.85	-37.99	-61.75	78.89	3236636.55	1254902.79	40.0300005	-104.6549483	2.00	
1523.00†	13.940	107.206	1513.25	-39.39	-69.24	100.23	3236657.96	1254895.52	40.0299799	-104.6548721	2.00	
1623.00†	15.724	103.673	1609.92	-39.20	-76.00	124.91	3236682.69	1254888.98	40.0299614	-104.6547840	2.00	
1723.00†	17.554	100.852	1705.73	-37.42	-82.04	152.89	3236710.73	1254883.21	40.0299448	-104.6546840	2.00	
1823.00†	19.417	98.552	1800.57	-34.04	-87.36	184.14	3236742.03	1254878.20	40.0299302	-104.6545725	2.00	
1923.00†	21.304	96.643	1894.31	-29.07	-91.93	218.62	3236776.55	1254873.95	40.0299176	-104.6544493	2.00	
2009.84	22.957	95.230	1974.75	-23.47	-95.30	251.16	3236809.12	1254870.89	40.0299084	-104.6543331	2.00	Build (XS)
2023.00†	22.957	95.230	1986.87	-22.53	-95.77	256.27	3236814.24	1254870.47	40.0299071	-104.6543149	0.00	
2123.00†	22.957	95.230	2078.95	-15.40	-99.32	295.11	3236853.11	1254867.29	40.0298973	-104.6541762	0.00	
2223.00†	22.957	95.230	2171.03	-8.26	-102.88	333.96	3236891.98	1254864.10	40.0298876	-104.6540375	0.00	
2323.00†	22.957	95.230	2263.11	-1.13	-106.43	372.80	3236930.85	1254860.92	40.0298778	-104.6538988	0.00	
2423.00†	22.957	95.230	2355.19	6.00	-109.99	411.64	3236969.73	1254857.73	40.0298681	-104.6537601	0.00	

# Planned Wellpath Report

CANAL 22-1-4L PWP Rev-A.0

Page 3 of 10

## REFERENCE WELLPATH IDENTIFICATION

Operator	CONFLUENCE RESOURCES	Well	CANAL 22-1-4L
Field	WELD COUNTY (NAD83, TRUE NORTH)	API/Legal	
Facility	SEC.22-T01N-R65W	Wellbore	CANAL 22-1-4L PWB
Slot	SLOT#16 CANAL 22-1-4L (185'FSL & 1221'FWL,SEC.22)		

## WELLPATH DATA (188 stations) † = interpolated, ‡ = extrapolated station

MD [ft]	Inclination [°]	Azimuth [°]	TVD [ft]	Vert Sect [ft]	North [ft]	East [ft]	Grid East [US ft]	Grid North [US ft]	Latitude	Longitude	DLS [°/100ft]	Comments
2523.00†	22.957	95.230	2447.27	13.13	-113.54	450.48	3237008.60	1254854.55	40.0298583	-104.6536214	0.00	
2623.00†	22.957	95.230	2539.35	20.27	-117.10	489.32	3237047.47	1254851.36	40.0298485	-104.6534827	0.00	
2723.00†	22.957	95.230	2631.43	27.40	-120.65	528.17	3237086.34	1254848.18	40.0298388	-104.6533440	0.00	
2823.00†	22.957	95.230	2723.51	34.53	-124.21	567.01	3237125.22	1254844.99	40.0298290	-104.6532053	0.00	
2923.00†	22.957	95.230	2815.59	41.66	-127.76	605.85	3237164.09	1254841.81	40.0298193	-104.6530666	0.00	
3023.00†	22.957	95.230	2907.67	48.80	-131.32	644.69	3237202.96	1254838.62	40.0298095	-104.6529279	0.00	
3123.00†	22.957	95.230	2999.75	55.93	-134.87	683.53	3237241.83	1254835.44	40.0297997	-104.6527892	0.00	
3223.00†	22.957	95.230	3091.83	63.06	-138.43	722.38	3237280.71	1254832.25	40.0297900	-104.6526505	0.00	
3323.00†	22.957	95.230	3183.91	70.19	-141.99	761.22	3237319.58	1254829.07	40.0297802	-104.6525118	0.00	
3423.00†	22.957	95.230	3275.99	77.33	-145.54	800.06	3237358.45	1254825.88	40.0297704	-104.6523731	0.00	
3523.00†	22.957	95.230	3368.07	84.46	-149.10	838.90	3237397.32	1254822.70	40.0297607	-104.6522344	0.00	
3623.00†	22.957	95.230	3460.15	91.59	-152.65	877.74	3237436.20	1254819.51	40.0297509	-104.6520957	0.00	
3723.00†	22.957	95.230	3552.23	98.72	-156.21	916.59	3237475.07	1254816.33	40.0297412	-104.6519570	0.00	
3823.00†	22.957	95.230	3644.31	105.86	-159.76	955.43	3237513.94	1254813.14	40.0297314	-104.6518183	0.00	
3923.00†	22.957	95.230	3736.39	112.99	-163.32	994.27	3237552.81	1254809.96	40.0297216	-104.6516796	0.00	
4023.00†	22.957	95.230	3828.47	120.12	-166.87	1033.11	3237591.69	1254806.77	40.0297119	-104.6515409	0.00	
4123.00†	22.957	95.230	3920.55	127.26	-170.43	1071.95	3237630.56	1254803.59	40.0297021	-104.6514022	0.00	
4223.00†	22.957	95.230	4012.62	134.39	-173.98	1110.80	3237669.43	1254800.40	40.0296923	-104.6512635	0.00	
4323.00†	22.957	95.230	4104.70	141.52	-177.54	1149.64	3237708.30	1254797.22	40.0296826	-104.6511248	0.00	
4423.00†	22.957	95.230	4196.78	148.65	-181.09	1188.48	3237747.18	1254794.03	40.0296728	-104.6509861	0.00	
4523.00†	22.957	95.230	4288.86	155.79	-184.65	1227.32	3237786.05	1254790.85	40.0296630	-104.6508474	0.00	
4623.00†	22.957	95.230	4380.94	162.92	-188.20	1266.16	3237824.92	1254787.66	40.0296533	-104.6507087	0.00	
4723.00†	22.957	95.230	4473.02	170.05	-191.76	1305.00	3237863.79	1254784.48	40.0296435	-104.6505700	0.00	
4823.00†	22.957	95.230	4565.10	177.18	-195.31	1343.85	3237902.67	1254781.29	40.0296337	-104.6504313	0.00	
4923.00†	22.957	95.230	4657.18	184.32	-198.87	1382.69	3237941.54	1254778.11	40.0296240	-104.6502926	0.00	
5023.00†	22.957	95.230	4749.26	191.45	-202.43	1421.53	3237980.41	1254774.92	40.0296142	-104.6501539	0.00	
5123.00†	22.957	95.230	4841.34	198.58	-205.98	1460.37	3238019.28	1254771.74	40.0296044	-104.6500152	0.00	
5223.00†	22.957	95.230	4933.42	205.71	-209.54	1499.21	3238058.16	1254768.55	40.0295947	-104.6498765	0.00	
5323.00†	22.957	95.230	5025.50	212.85	-213.09	1538.06	3238097.03	1254765.37	40.0295849	-104.6497378	0.00	
5423.00†	22.957	95.230	5117.58	219.98	-216.65	1576.90	3238135.90	1254762.18	40.0295752	-104.6495991	0.00	

# Planned Wellpath Report

CANAL 22-1-4L PWP Rev-A.0

Page 4 of 10

## REFERENCE WELLPATH IDENTIFICATION

Operator	CONFLUENCE RESOURCES	Well	CANAL 22-1-4L
Field	WELD COUNTY (NAD83, TRUE NORTH)	API/Legal	
Facility	SEC.22-T01N-R65W	Wellbore	CANAL 22-1-4L PWB
Slot	SLOT#16 CANAL 22-1-4L (185'FSL & 1221'FWL,SEC.22)		

## WELLPATH DATA (188 stations) † = interpolated, ‡ = extrapolated station

MD [ft]	Inclination [°]	Azimuth [°]	TVD [ft]	Vert Sect [ft]	North [ft]	East [ft]	Grid East [US ft]	Grid North [US ft]	Latitude	Longitude	DLS [°/100ft]	Comments
5523.00†	22.957	95.230	5209.66	227.11	-220.20	1615.74	3238174.77	1254759.00	40.0295654	-104.6494604	0.00	
5623.00†	22.957	95.230	5301.74	234.24	-223.76	1654.58	3238213.65	1254755.81	40.0295556	-104.6493217	0.00	
5723.00†	22.957	95.230	5393.82	241.38	-227.31	1693.42	3238252.52	1254752.63	40.0295459	-104.6491830	0.00	
5823.00†	22.957	95.230	5485.90	248.51	-230.87	1732.27	3238291.39	1254749.44	40.0295361	-104.6490443	0.00	
5923.00†	22.957	95.230	5577.98	255.64	-234.42	1771.11	3238330.26	1254746.26	40.0295263	-104.6489056	0.00	
6023.00†	22.957	95.230	5670.06	262.77	-237.98	1809.95	3238369.14	1254743.07	40.0295166	-104.6487669	0.00	
6123.00†	22.957	95.230	5762.14	269.91	-241.53	1848.79	3238408.01	1254739.89	40.0295068	-104.6486282	0.00	
6223.00†	22.957	95.230	5854.22	277.04	-245.09	1887.63	3238446.88	1254736.70	40.0294970	-104.6484895	0.00	
6323.00†	22.957	95.230	5946.30	284.17	-248.64	1926.48	3238485.76	1254733.52	40.0294872	-104.6483508	0.00	
6423.00†	22.957	95.230	6038.38	291.30	-252.20	1965.32	3238524.63	1254730.33	40.0294775	-104.6482121	0.00	
6523.00†	22.957	95.230	6130.46	298.44	-255.75	2004.16	3238563.50	1254727.15	40.0294677	-104.6480734	0.00	
6623.00†	22.957	95.230	6222.54	305.57	-259.31	2043.00	3238602.37	1254723.96	40.0294579	-104.6479347	0.00	
6723.00†	22.957	95.230	6314.62	312.70	-262.87	2081.84	3238641.25	1254720.78	40.0294482	-104.6477960	0.00	
6823.00†	22.957	95.230	6406.70	319.83	-266.42	2120.68	3238680.12	1254717.59	40.0294384	-104.6476573	0.00	
6923.00†	22.957	95.230	6498.78	326.97	-269.98	2159.53	3238718.99	1254714.41	40.0294286	-104.6475186	0.00	
7023.00†	22.957	95.230	6590.86	334.10	-273.53	2198.37	3238757.86	1254711.22	40.0294189	-104.6473799	0.00	
7123.00†	22.957	95.230	6682.94	341.23	-277.09	2237.21	3238796.74	1254708.04	40.0294091	-104.6472412	0.00	
7223.00†	22.957	95.230	6775.02	348.36	-280.64	2276.05	3238835.61	1254704.85	40.0293993	-104.6471025	0.00	
7323.00†	22.957	95.230	6867.09	355.50	-284.20	2314.89	3238874.48	1254701.67	40.0293896	-104.6469638	0.00	
7394.74	22.957	95.230	6933.15	360.61	-286.75	2342.76	3238902.37	1254699.38	40.0293826	-104.6468643	0.00	KOP
7423.00†	22.944	87.977	6959.18	363.31	-287.06	2353.75	3238913.37	1254699.18	40.0293817	-104.6468250	10.00	
7523.00†	25.408	64.140	7050.62	383.56	-276.99	2392.64	3238952.15	1254709.62	40.0294093	-104.6466862	10.00	
7623.00†	30.883	46.265	7138.92	420.02	-249.82	2430.58	3238989.83	1254737.15	40.0294839	-104.6465507	10.00	
7723.00†	38.086	33.938	7221.40	471.57	-206.38	2466.44	3239025.27	1254780.93	40.0296031	-104.6464226	10.00	
7823.00†	46.208	25.206	7295.54	536.64	-147.98	2499.11	3239057.38	1254839.62	40.0297634	-104.6463059	10.00	
7923.00†	54.833	18.629	7359.10	613.26	-76.41	2527.61	3239085.20	1254911.46	40.0299599	-104.6462042	10.00	
8023.00†	63.744	13.338	7410.15	699.10	6.16	2551.07	3239107.87	1254994.25	40.0301865	-104.6461203	10.00	
8123.00†	72.820	8.814	7447.13	791.56	97.23	2568.78	3239124.71	1255085.48	40.0304365	-104.6460571	10.00	
8223.00†	81.988	4.716	7468.92	887.81	194.02	2580.20	3239135.21	1255182.38	40.0307022	-104.6460163	10.00	
8310.03	90.000	1.306	7475.00†	972.40	280.64	2584.74	3239138.93	1255269.03	40.0309400	-104.6460000	10.00	LANDING

# Planned Wellpath Report

CANAL 22-1-4L PWP Rev-A.0

Page 5 of 10

## REFERENCE WELLPATH IDENTIFICATION

Operator	CONFLUENCE RESOURCES	Well	CANAL 22-1-4L
Field	WELD COUNTY (NAD83, TRUE NORTH)	API/Legal	
Facility	SEC.22-T01N-R65W	Wellbore	CANAL 22-1-4L PWB
Slot	SLOT#16 CANAL 22-1-4L (185'FSL & 1221'FWL,SEC.22)		

## WELLPATH DATA (188 stations) † = interpolated, ‡ = extrapolated station

MD [ft]	Inclination [°]	Azimuth [°]	TVD [ft]	Vert Sect [ft]	North [ft]	East [ft]	Grid East [US ft]	Grid North [US ft]	Latitude	Longitude	DLS [°/100ft]	Comments
8323.00†	90.000	1.306	7475.00	984.96	293.60	2585.04	3239139.10	1255282.00	40.0309756	-104.6459989	0.00	
8423.00†	90.000	1.306	7475.00	1081.80	393.58	2587.32	3239140.42	1255381.98	40.0312500	-104.6459908	0.00	
8523.00†	90.000	1.306	7475.00	1178.63	493.55	2589.60	3239141.75	1255481.97	40.0315245	-104.6459826	0.00	
8623.00†	90.000	1.306	7475.00	1275.46	593.53	2591.88	3239143.08	1255581.96	40.0317989	-104.6459744	0.00	
8723.00†	90.000	1.306	7475.00	1372.29	693.50	2594.16	3239144.41	1255681.94	40.0320733	-104.6459662	0.00	
8823.00†	90.000	1.306	7475.00	1469.12	793.47	2596.44	3239145.73	1255781.93	40.0323478	-104.6459580	0.00	
8923.00†	90.000	1.306	7475.00	1565.96	893.45	2598.72	3239147.06	1255881.92	40.0326222	-104.6459499	0.00	
9023.00†	90.000	1.306	7475.00	1662.79	993.42	2601.00	3239148.39	1255981.91	40.0328966	-104.6459417	0.00	
9123.00†	90.000	1.306	7475.00	1759.62	1093.40	2603.28	3239149.72	1256081.89	40.0331711	-104.6459335	0.00	
9223.00†	90.000	1.306	7475.00	1856.45	1193.37	2605.56	3239151.04	1256181.88	40.0334455	-104.6459253	0.00	
9323.00†	90.000	1.306	7475.00	1953.28	1293.34	2607.84	3239152.37	1256281.87	40.0337200	-104.6459172	0.00	
9423.00†	90.000	1.306	7475.00	2050.12	1393.32	2610.12	3239153.70	1256381.86	40.0339944	-104.6459090	0.00	
9523.00†	90.000	1.306	7475.00	2146.95	1493.29	2612.40	3239155.02	1256481.84	40.0342688	-104.6459008	0.00	
9623.00†	90.000	1.306	7475.00	2243.78	1593.27	2614.67	3239156.35	1256581.83	40.0345433	-104.6458926	0.00	
9723.00†	90.000	1.306	7475.00	2340.61	1693.24	2616.95	3239157.68	1256681.82	40.0348177	-104.6458844	0.00	
9823.00†	90.000	1.306	7475.00	2437.44	1793.21	2619.23	3239159.01	1256781.81	40.0350921	-104.6458763	0.00	
9923.00†	90.000	1.306	7475.00	2534.28	1893.19	2621.51	3239160.33	1256881.79	40.0353666	-104.6458681	0.00	
10023.00†	90.000	1.306	7475.00	2631.11	1993.16	2623.79	3239161.66	1256981.78	40.0356410	-104.6458599	0.00	
10123.00†	90.000	1.306	7475.00	2727.94	2093.14	2626.07	3239162.99	1257081.77	40.0359154	-104.6458517	0.00	
10223.00†	90.000	1.306	7475.00	2824.77	2193.11	2628.35	3239164.31	1257181.76	40.0361899	-104.6458435	0.00	
10323.00†	90.000	1.306	7475.00	2921.60	2293.08	2630.63	3239165.64	1257281.74	40.0364643	-104.6458354	0.00	
10423.00†	90.000	1.306	7475.00	3018.44	2393.06	2632.91	3239166.97	1257381.73	40.0367387	-104.6458272	0.00	
10523.00†	90.000	1.306	7475.00	3115.27	2493.03	2635.19	3239168.30	1257481.72	40.0370132	-104.6458190	0.00	
10623.00†	90.000	1.306	7475.00	3212.10	2593.01	2637.47	3239169.62	1257581.71	40.0372876	-104.6458108	0.00	
10723.00†	90.000	1.306	7475.00	3308.93	2692.98	2639.75	3239170.95	1257681.69	40.0375620	-104.6458026	0.00	
10823.00†	90.000	1.306	7475.00	3405.77	2792.95	2642.03	3239172.28	1257781.68	40.0378365	-104.6457945	0.00	
10923.00†	90.000	1.306	7475.00	3502.60	2892.93	2644.31	3239173.60	1257881.67	40.0381109	-104.6457863	0.00	
11023.00†	90.000	1.306	7475.00	3599.43	2992.90	2646.59	3239174.93	1257981.66	40.0383854	-104.6457781	0.00	
11123.00†	90.000	1.306	7475.00	3696.26	3092.88	2648.87	3239176.26	1258081.64	40.0386598	-104.6457699	0.00	
11223.00†	90.000	1.306	7475.00	3793.09	3192.85	2651.15	3239177.59	1258181.63	40.0389342	-104.6457617	0.00	



## REFERENCE WELLPATH IDENTIFICATION

Operator	CONFLUENCE RESOURCES	Well	CANAL 22-1-4L
Field	WELD COUNTY (NAD83, TRUE NORTH)	API/Legal	
Facility	SEC.22-T01N-R65W	Wellbore	CANAL 22-1-4L PWB
Slot	SLOT#16 CANAL 22-1-4L (185'FSL & 1221'FWL,SEC.22)		

## WELLPATH DATA (188 stations) † = interpolated, ‡ = extrapolated station

MD [ft]	Inclination [°]	Azimuth [°]	TVD [ft]	Vert Sect [ft]	North [ft]	East [ft]	Grid East [US ft]	Grid North [US ft]	Latitude	Longitude	DLS [°/100ft]	Comments
11323.00†	90.000	1.306	7475.00	3889.93	3292.82	2653.43	3239178.91	1258281.62	40.0392087	-104.6457536	0.00	
11423.00†	90.000	1.306	7475.00	3986.76	3392.80	2655.71	3239180.24	1258381.61	40.0394831	-104.6457454	0.00	
11523.00†	90.000	1.306	7475.00	4083.59	3492.77	2657.99	3239181.57	1258481.59	40.0397575	-104.6457372	0.00	
11623.00†	90.000	1.306	7475.00	4180.42	3592.75	2660.27	3239182.90	1258581.58	40.0400320	-104.6457290	0.00	
11723.00†	90.000	1.306	7475.00	4277.25	3692.72	2662.55	3239184.22	1258681.57	40.0403064	-104.6457208	0.00	
11823.00†	90.000	1.306	7475.00	4374.09	3792.69	2664.83	3239185.55	1258781.55	40.0405808	-104.6457127	0.00	
11923.00†	90.000	1.306	7475.00	4470.92	3892.67	2667.11	3239186.88	1258881.54	40.0408553	-104.6457045	0.00	
12023.00†	90.000	1.306	7475.00	4567.75	3992.64	2669.39	3239188.20	1258981.53	40.0411297	-104.6456963	0.00	
12123.00†	90.000	1.306	7475.00	4664.58	4092.62	2671.67	3239189.53	1259081.52	40.0414041	-104.6456881	0.00	
12223.00†	90.000	1.306	7475.00	4761.41	4192.59	2673.95	3239190.86	1259181.50	40.0416786	-104.6456799	0.00	
12323.00†	90.000	1.306	7475.00	4858.25	4292.56	2676.23	3239192.19	1259281.49	40.0419530	-104.6456718	0.00	
12423.00†	90.000	1.306	7475.00	4955.08	4392.54	2678.51	3239193.51	1259381.48	40.0422274	-104.6456636	0.00	
12523.00†	90.000	1.306	7475.00	5051.91	4492.51	2680.79	3239194.84	1259481.47	40.0425019	-104.6456554	0.00	
12623.00†	90.000	1.306	7475.00	5148.74	4592.49	2683.07	3239196.17	1259581.45	40.0427763	-104.6456472	0.00	
12723.00†	90.000	1.306	7475.00	5245.58	4692.46	2685.35	3239197.49	1259681.44	40.0430507	-104.6456390	0.00	
12823.00†	90.000	1.306	7475.00	5342.41	4792.43	2687.63	3239198.82	1259781.43	40.0433252	-104.6456309	0.00	
12923.00†	90.000	1.306	7475.00	5439.24	4892.41	2689.91	3239200.15	1259881.42	40.0435996	-104.6456227	0.00	
13023.00†	90.000	1.306	7475.00	5536.07	4992.38	2692.19	3239201.48	1259981.40	40.0438741	-104.6456145	0.00	
13123.00†	90.000	1.306	7475.00	5632.90	5092.36	2694.47	3239202.80	1260081.39	40.0441485	-104.6456063	0.00	
13223.00†	90.000	1.306	7475.00	5729.74	5192.33	2696.75	3239204.13	1260181.38	40.0444229	-104.6455981	0.00	
13323.00†	90.000	1.306	7475.00	5826.57	5292.30	2699.03	3239205.46	1260281.37	40.0446974	-104.6455900	0.00	
13423.00†	90.000	1.306	7475.00	5923.40	5392.28	2701.31	3239206.79	1260381.35	40.0449718	-104.6455818	0.00	
13523.00†	90.000	1.306	7475.00	6020.23	5492.25	2703.59	3239208.11	1260481.34	40.0452462	-104.6455736	0.00	
13623.00†	90.000	1.306	7475.00	6117.06	5592.23	2705.87	3239209.44	1260581.33	40.0455207	-104.6455654	0.00	
13723.00†	90.000	1.306	7475.00	6213.90	5692.20	2708.15	3239210.77	1260681.32	40.0457951	-104.6455572	0.00	
13823.00†	90.000	1.306	7475.00	6310.73	5792.17	2710.42	3239212.09	1260781.30	40.0460695	-104.6455490	0.00	
13923.00†	90.000	1.306	7475.00	6407.56	5892.15	2712.70	3239213.42	1260881.29	40.0463440	-104.6455409	0.00	
14023.00†	90.000	1.306	7475.00	6504.39	5992.12	2714.98	3239214.75	1260981.28	40.0466184	-104.6455327	0.00	
14123.00†	90.000	1.306	7475.00	6601.22	6092.10	2717.26	3239216.08	1261081.27	40.0468928	-104.6455245	0.00	
14223.00†	90.000	1.306	7475.00	6698.06	6192.07	2719.54	3239217.40	1261181.25	40.0471673	-104.6455163	0.00	

# Planned Wellpath Report

CANAL 22-1-4L PWP Rev-A.0

Page 7 of 10

## REFERENCE WELLPATH IDENTIFICATION

Operator	CONFLUENCE RESOURCES	Well	CANAL 22-1-4L
Field	WELD COUNTY (NAD83, TRUE NORTH)	API/Legal	
Facility	SEC.22-T01N-R65W	Wellbore	CANAL 22-1-4L PWB
Slot	SLOT#16 CANAL 22-1-4L (185'FSL & 1221'FWL,SEC.22)		

## WELLPATH DATA (188 stations) † = interpolated, ‡ = extrapolated station

MD [ft]	Inclination [°]	Azimuth [°]	TVD [ft]	Vert Sect [ft]	North [ft]	East [ft]	Grid East [US ft]	Grid North [US ft]	Latitude	Longitude	DLS [°/100ft]	Comments
14323.00†	90.000	1.306	7475.00	6794.89	6292.04	2721.82	3239218.73	1261281.24	40.0474417	-104.6455081	0.00	
14423.00†	90.000	1.306	7475.00	6891.72	6392.02	2724.10	3239220.06	1261381.23	40.0477161	-104.6455000	0.00	
14523.00†	90.000	1.306	7475.00	6988.55	6491.99	2726.38	3239221.38	1261481.21	40.0479906	-104.6454918	0.00	
14623.00†	90.000	1.306	7475.00	7085.38	6591.97	2728.66	3239222.71	1261581.20	40.0482650	-104.6454836	0.00	
14723.00†	90.000	1.306	7475.00	7182.22	6691.94	2730.94	3239224.04	1261681.19	40.0485394	-104.6454754	0.00	
14823.00†	90.000	1.306	7475.00	7279.05	6791.91	2733.22	3239225.37	1261781.18	40.0488139	-104.6454672	0.00	
14923.00†	90.000	1.306	7475.00	7375.88	6891.89	2735.50	3239226.69	1261881.16	40.0490883	-104.6454590	0.00	
15023.00†	90.000	1.306	7475.00	7472.71	6991.86	2737.78	3239228.02	1261981.15	40.0493628	-104.6454509	0.00	
15123.00†	90.000	1.306	7475.00	7569.55	7091.84	2740.06	3239229.35	1262081.14	40.0496372	-104.6454427	0.00	
15223.00†	90.000	1.306	7475.00	7666.38	7191.81	2742.34	3239230.68	1262181.13	40.0499116	-104.6454345	0.00	
15323.00†	90.000	1.306	7475.00	7763.21	7291.78	2744.62	3239232.00	1262281.11	40.0501861	-104.6454263	0.00	
15423.00†	90.000	1.306	7475.00	7860.04	7391.76	2746.90	3239233.33	1262381.10	40.0504605	-104.6454181	0.00	
15523.00†	90.000	1.306	7475.00	7956.87	7491.73	2749.18	3239234.66	1262481.09	40.0507349	-104.6454099	0.00	
15623.00†	90.000	1.306	7475.00	8053.71	7591.71	2751.46	3239235.98	1262581.08	40.0510094	-104.6454018	0.00	
15723.00†	90.000	1.306	7475.00	8150.54	7691.68	2753.74	3239237.31	1262681.06	40.0512838	-104.6453936	0.00	
15823.00†	90.000	1.306	7475.00	8247.37	7791.65	2756.02	3239238.64	1262781.05	40.0515582	-104.6453854	0.00	
15923.00†	90.000	1.306	7475.00	8344.20	7891.63	2758.30	3239239.97	1262881.04	40.0518327	-104.6453772	0.00	
16023.00†	90.000	1.306	7475.00	8441.03	7991.60	2760.58	3239241.29	1262981.03	40.0521071	-104.6453690	0.00	
16123.00†	90.000	1.306	7475.00	8537.87	8091.58	2762.86	3239242.62	1263081.01	40.0523815	-104.6453608	0.00	
16223.00†	90.000	1.306	7475.00	8634.70	8191.55	2765.14	3239243.95	1263181.00	40.0526560	-104.6453527	0.00	
16323.00†	90.000	1.306	7475.00	8731.53	8291.53	2767.42	3239245.27	1263280.99	40.0529304	-104.6453445	0.00	
16423.00†	90.000	1.306	7475.00	8828.36	8391.50	2769.70	3239246.60	1263380.98	40.0532048	-104.6453363	0.00	
16523.00†	90.000	1.306	7475.00	8925.19	8491.47	2771.98	3239247.93	1263480.96	40.0534793	-104.6453281	0.00	
16623.00†	90.000	1.306	7475.00	9022.03	8591.45	2774.26	3239249.26	1263580.95	40.0537537	-104.6453199	0.00	
16723.00†	90.000	1.306	7475.00	9118.86	8691.42	2776.54	3239250.58	1263680.94	40.0540281	-104.6453117	0.00	
16823.00†	90.000	1.306	7475.00	9215.69	8791.40	2778.82	3239251.91	1263780.93	40.0543026	-104.6453036	0.00	
16923.00†	90.000	1.306	7475.00	9312.52	8891.37	2781.10	3239253.24	1263880.91	40.0545770	-104.6452954	0.00	
17023.00†	90.000	1.306	7475.00	9409.36	8991.34	2783.38	3239254.56	1263980.90	40.0548515	-104.6452872	0.00	
17123.00†	90.000	1.306	7475.00	9506.19	9091.32	2785.66	3239255.89	1264080.89	40.0551259	-104.6452790	0.00	
17223.00†	90.000	1.306	7475.00	9603.02	9191.29	2787.94	3239257.22	1264180.88	40.0554003	-104.6452708	0.00	



# Planned Wellpath Report

CANAL 22-1-4L PWP Rev-A.0

Page 8 of 10

## REFERENCE WELLPATH IDENTIFICATION

Operator	CONFLUENCE RESOURCES	Well	CANAL 22-1-4L
Field	WELD COUNTY (NAD83, TRUE NORTH)	API/Legal	
Facility	SEC.22-T01N-R65W	Wellbore	CANAL 22-1-4L PWB
Slot	SLOT#16 CANAL 22-1-4L (185'FSL & 1221'FWL,SEC.22)		

## WELLPATH DATA (188 stations) † = interpolated, ‡ = extrapolated station

MD [ft]	Inclination [°]	Azimuth [°]	TVD [ft]	Vert Sect [ft]	North [ft]	East [ft]	Grid East [US ft]	Grid North [US ft]	Latitude	Longitude	DLS [°/100ft]	Comments
17323.00†	90.000	1.306	7475.00	9699.85	9291.27	2790.22	3239258.55	1264280.86	40.0556748	-104.6452626	0.00	
17423.00†	90.000	1.306	7475.00	9796.68	9391.24	2792.50	3239259.87	1264380.85	40.0559492	-104.6452545	0.00	
17523.00†	90.000	1.306	7475.00	9893.52	9491.21	2794.78	3239261.20	1264480.84	40.0562236	-104.6452463	0.00	
17623.00†	90.000	1.306	7475.00	9990.35	9591.19	2797.06	3239262.53	1264580.82	40.0564981	-104.6452381	0.00	
17723.00†	90.000	1.306	7475.00	10087.18	9691.16	2799.34	3239263.86	1264680.81	40.0567725	-104.6452299	0.00	
17823.00†	90.000	1.306	7475.00	10184.01	9791.14	2801.62	3239265.18	1264780.80	40.0570469	-104.6452217	0.00	
17923.00†	90.000	1.306	7475.00	10280.84	9891.11	2803.90	3239266.51	1264880.79	40.0573214	-104.6452135	0.00	
17966.23	90.000	1.306	7475.00 <sup>‡</sup>	10322.70	9934.33	2804.88	3239267.08	1264924.01	40.0574400	-104.6452100	0.00	TD

## HOLE & CASING SECTIONS - Ref Wellbore: CANAL 22-1-4L PWB Ref Wellpath: CANAL 22-1-4L PWP Rev-A.0

String/Diameter	Start MD [ft]	End MD [ft]	Interval [ft]	Start TVD [ft]	End TVD [ft]	Start N/S [ft]	Start E/W [ft]	End N/S [ft]	End E/W [ft]
9.625in Casing Surface	23.00	1550.00	1527.00	23.00	1539.43	0.00	0.00	-71.13	106.57

## REFERENCE WELLPATH IDENTIFICATION

Operator	CONFLUENCE RESOURCES	Well	CANAL 22-1-4L
Field	WELD COUNTY (NAD83, TRUE NORTH)	API/Legal	
Facility	SEC.22-T01N-R65W	Wellbore	CANAL 22-1-4L PWB
Slot	SLOT#16 CANAL 22-1-4L (185'FSL & 1221'FWL,SEC.22)		

## TARGETS

Name	MD [ft]	TVD [ft]	North [ft]	East [ft]	Grid East [US ft]	Grid North [US ft]	Latitude	Longitude	Shape
SEC.15/22-T01N-R65W (SB 460')	N/A	6.50	0.00	-173.62	3236383.46	1254962.14	40.0301700	-104.6558500	polygon
	2D Polygon: dimensions not calculated								
SEC.15-T01N-R65W	N/A	10.00	0.00	-173.62	3236383.46	1254962.14	40.0301700	-104.6558500	polygon
	2D Polygon: dimensions not calculated								
SEC.22-T01N-R65W	N/A	10.00	0.00	-173.62	3236383.46	1254962.14	40.0301700	-104.6558500	polygon
	2D Polygon: dimensions not calculated								
2) CANAL 22-1-4L BHL REV-1 (470'FNL & 1320'FEL,SEC.15)	17966.23	7475.00	9934.33	2804.88	3239267.08	1264924.01	40.0574400	-104.6452100	point
1) CANAL 22-1-4L LP REV-1 (470'FSL & 1470'FEL,SEC.22)	8310.03	7475.00	280.64	2584.74	3239138.93	1255269.03	40.0309400	-104.6460000	point

## SURVEY PROGRAM - Ref Wellbore: CANAL 22-1-4L PWB Ref Wellpath: CANAL 22-1-4L PWP Rev-A.0

Start MD [ft]	End MD [ft]	Positional Uncertainty Model	Log Name/Comment	Wellbore
23.00	1550.00	BH NaviTrak (2019) (Axial)		CANAL 22-1-4L PWB
1550.00	17966.23	BH AutoTrak Curve/eXpress (2019) (Short spacing)		CANAL 22-1-4L PWB

# Planned Wellpath Report

CANAL 22-1-4L PWP Rev-A.0

Page 10 of 10

## REFERENCE WELLPATH IDENTIFICATION

Operator	CONFLUENCE RESOURCES	Well	CANAL 22-1-4L
Field	WELD COUNTY (NAD83, TRUE NORTH)	API/Legal	
Facility	SEC.22-T01N-R65W	Wellbore	CANAL 22-1-4L PWB
Slot	SLOT#16 CANAL 22-1-4L (185'FSL & 1221'FWL,SEC.22)		

## DESIGN COMMENTS

MD [ft]	Inclination [°]	Azimuth [°]	TVD [ft]	Comment
23.00	0.000	135.000	23.00	Tie On
500.00	0.000	135.000	500.00	End of Tangent
1033.33	8.000	135.000	1031.60	End of Build (J)
1133.33	8.000	135.000	1130.63	End of Tangent (J)
2009.84	22.957	95.230	1974.75	Build (XS)
7394.74	22.957	95.230	6933.15	KOP
8310.03	90.000	1.306	7475.00	LANDING
17966.23	90.000	1.306	7475.00	TD