



40.12217, -108.8622, 5203.5ft, 216°
04/28/2021 02:40:44 PM



COLORADO
Oil & Gas Conservation
Commission
Department of Natural Resources

Photo 1. Access road looking west.

Fee 42

API: 05-103-05688

Inspection: 701500529



40.12205, -108.8624, 5214.6ft, 64°
04/28/2021 02:41:33 PM



COLORADO
Oil & Gas Conservation
Commission
Department of Natural Resources

Photo 3. County Road 1 looking north.

Fee 42

API: 05-103-05688

Inspection: 701500529



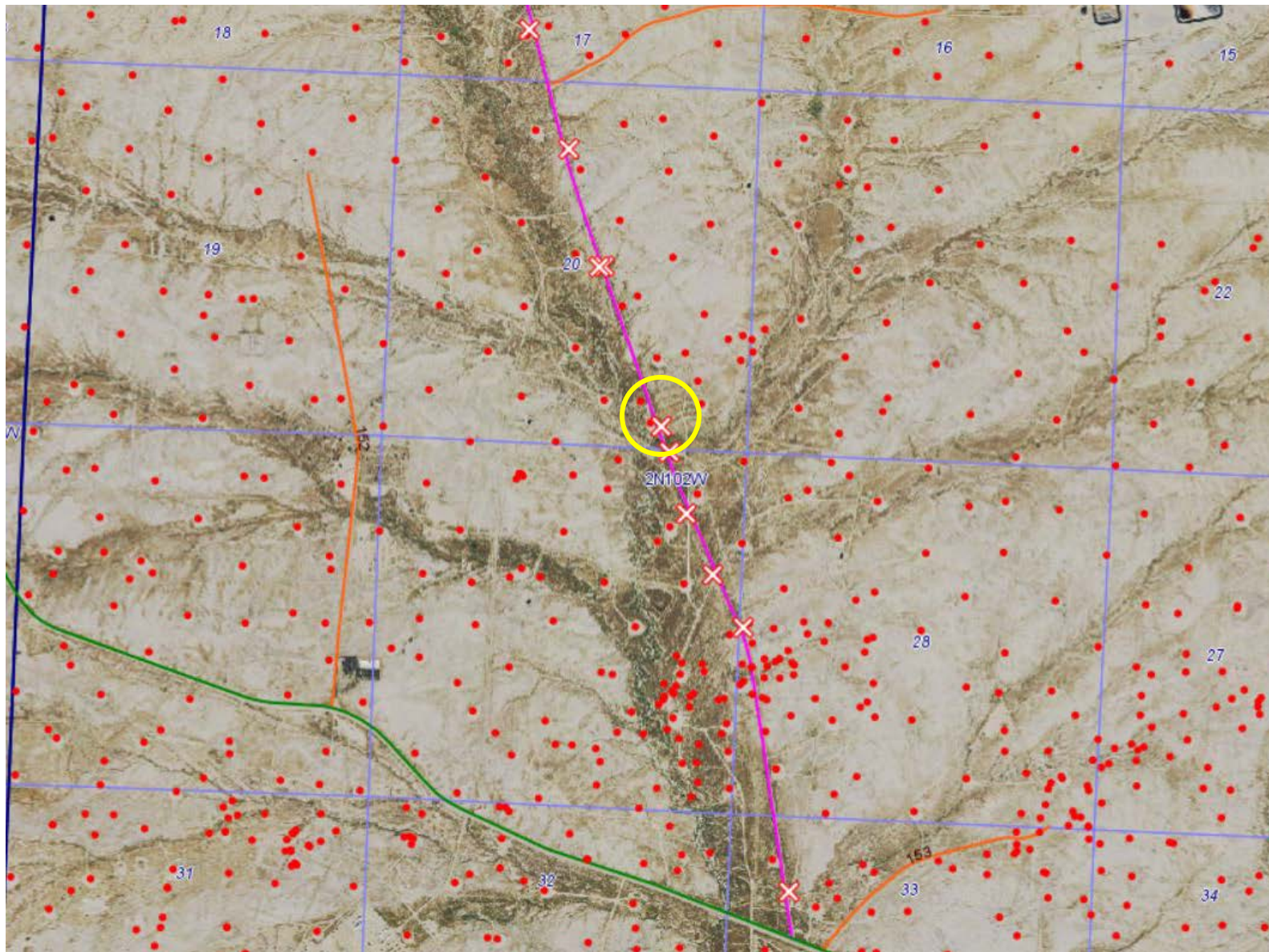

COLORADO
Oil & Gas Conservation
Commission
Department of Natural Resources

Photo 5. Satellite image with tracking location circled.

Fee 42

API: 05-103-05688

Inspection: 701500529

