

Location Name: MCCULLOUGH 34-32, 4-29-21, API #: 071-07953, Insp. #:695104327

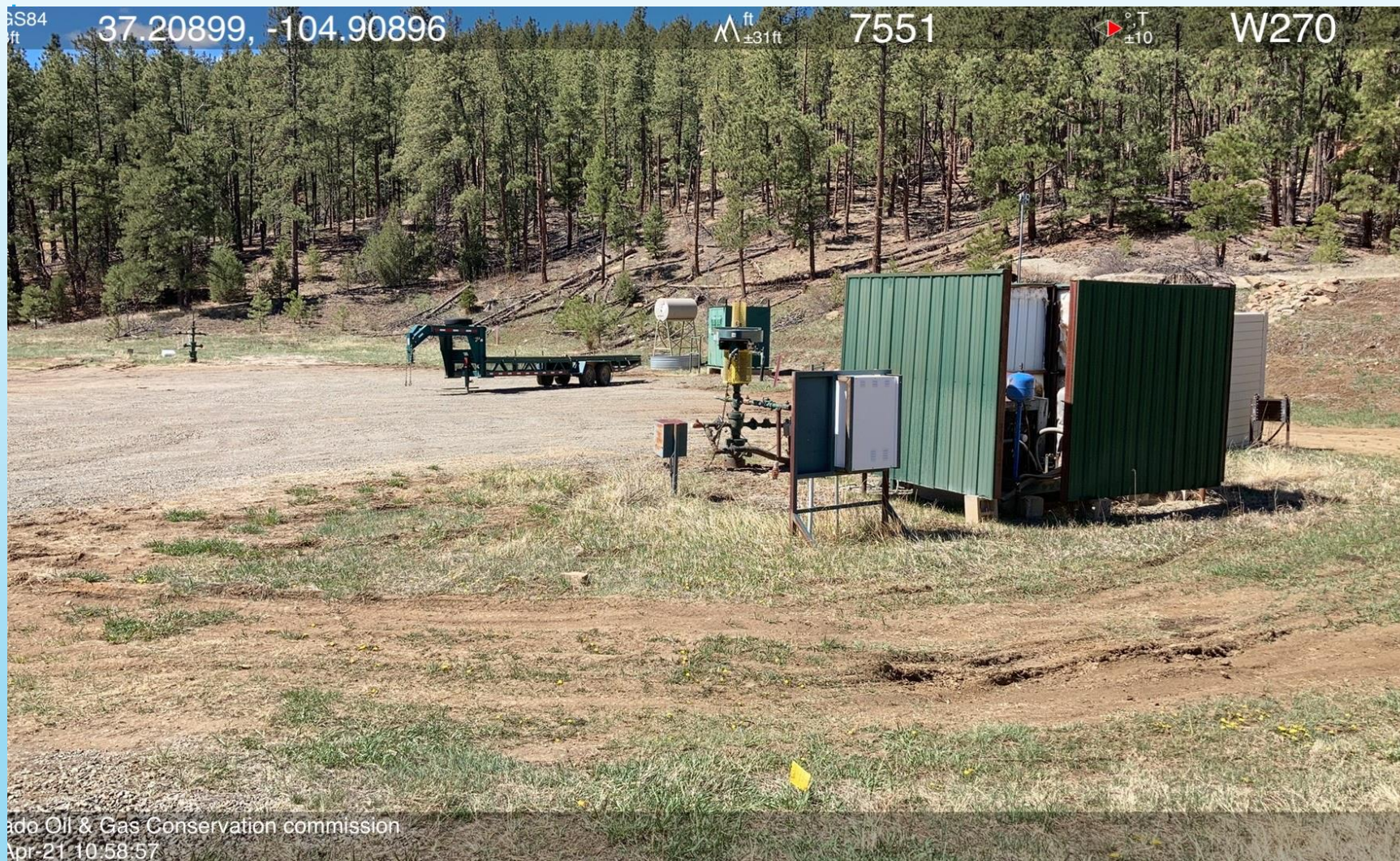

PHOTO 1: LOCATION



37.20868, -104.90920

ft  
±10ft

7555

°T  
±14

NW30

**NATURAL RESOURCES LLC**

McCullough 34-32

API#05-71-07953

T32S, R67W, Sec. 32: SWSE

CR 32.5

Lat. 37.20866 / Long. -104.90884

Emergency Number: 911

or (719)846-7898

WDID 1911337 / PERMIT #72984-F

**NATURAL RESOURCES LLC**

McCullough 34-32 Tr

API#05-071-08157

T32S, R67W, Sec. 32: SWSE

CR 32.5

Lat. 37.20903 / Long. -104.90876

Emergency Number: 911

or (719)846-7898

WDID 1911338 / PERMIT #72985-F

WDID 1911338 / Permit # 72985

COGCC APPROVAL  
VACUUM

& Gas Conservation commission  
11:01:52







