

LEGEND

 Site Location

N



Figure 1
Location Site Map
September 9, 2020 LBK

Park U-4-9XRLC
API: 05-123-47956
SWSW Sec 34, T5N, R62W, 6th PM
Weld County, Colorado

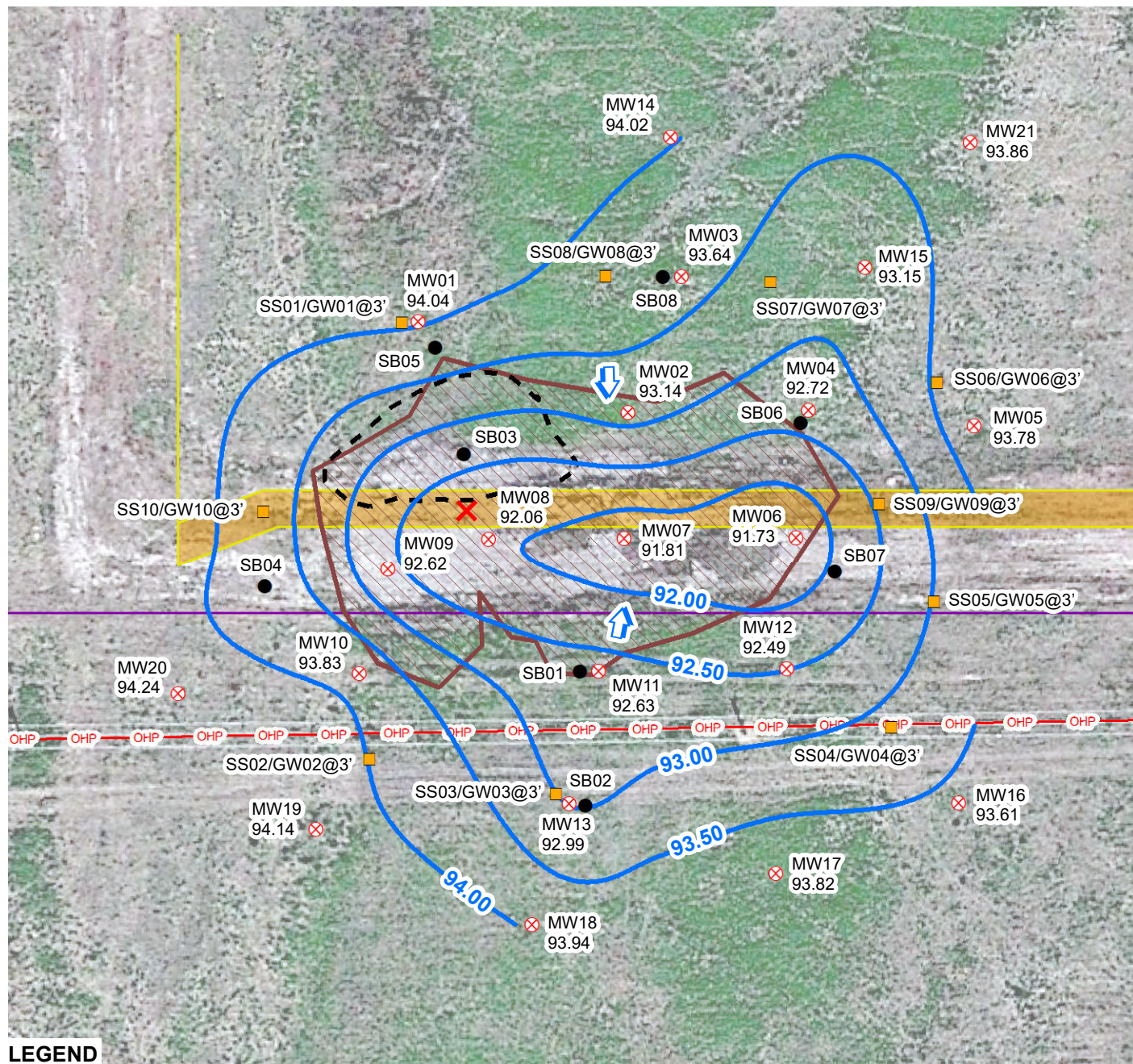

SAMPLE ID
 SAMPLE DATE
 B: BENZENE IN MICROGRAMS PER LITER (µg/L)
 T: TOLUENE (µg/L)
 E: ETHYLBENZENE (µg/L)
 X: TOTAL XYLENES (µg/L)
 NAPH: NAPHTHALENE (µg/L)
 1,2,4-TRI: TRIMETHYLBENZENE (µg/L)
 1,3,5-TRI: TRIMETHYLBENZENE (µg/L)
 Cl: CHLORIDE IN MILLIGRAMS PER LITER (mg/L)
 SU: SULFATE (mg/L)
 TDS: (mg/L)
 <: LESS THAN LABORATORY REPORTING LIMIT
BOLD: INDICATES RESULT EXCEEDS THE APPLICABLE STANDARD
 NS-FP: NOT SAMPLED-FREE PRODUCT

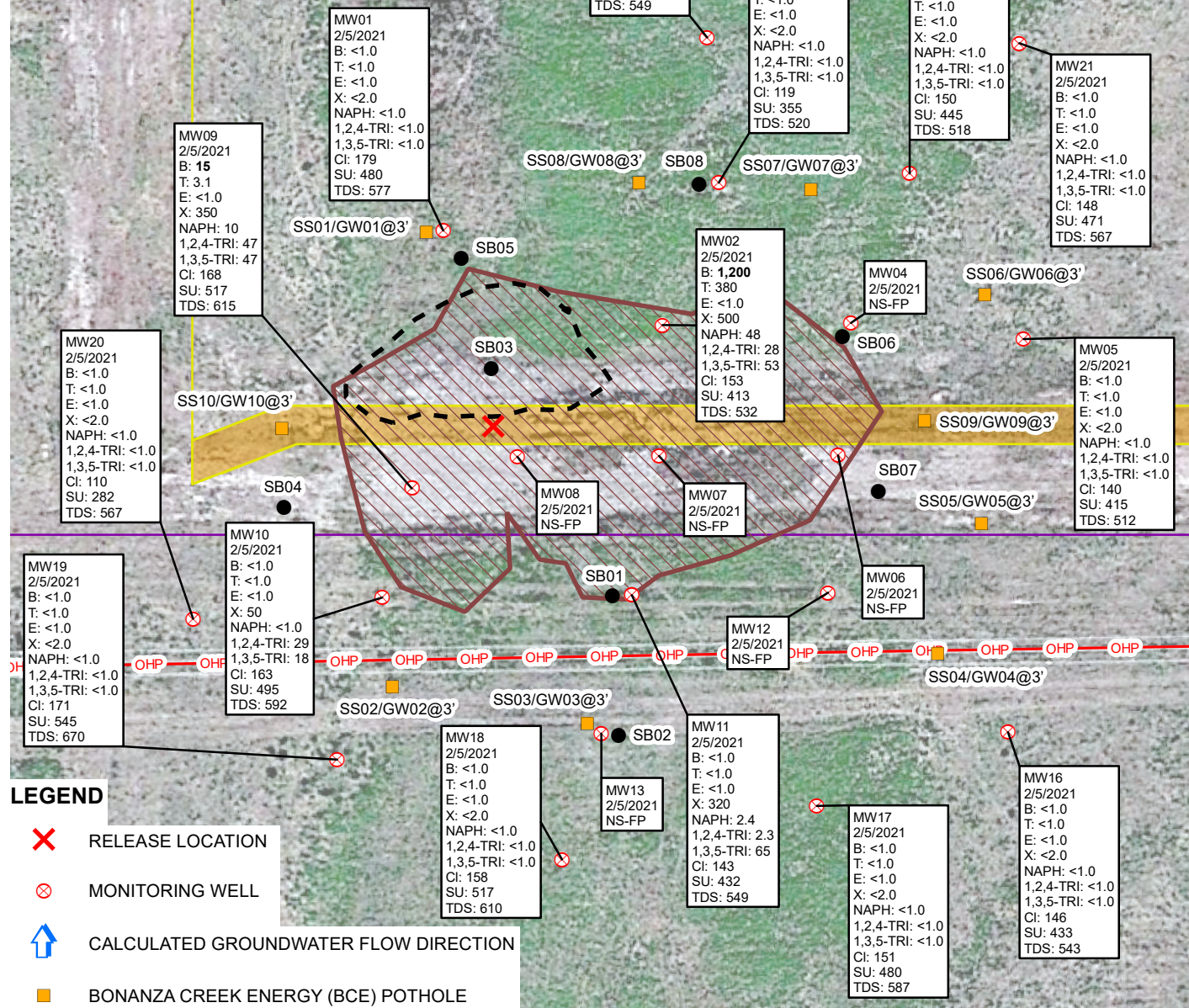
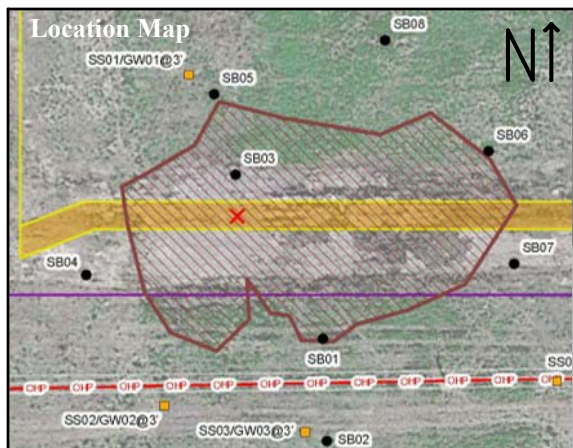

IMAGE COURTESY OF GOOGLE EARTH 2016

FIGURE 4
 GROUNDWATER ANALYTICAL RESULTS MAP
 PARK U-4-9XRLC
 SWSW SEC 34-T5N-R63W
 WELD COUNTY, COLORADO
 BONANZA CREEK ENERGY, INC.





A proud member
of WSP

BORING LOG/MONITORING WELL COMPLETION DIAGRAM

PROJECT NAME: Park U-4-9XRLC
PROJECT NO: 027320018 **LOGGED BY:** Jeremy Pike
BORING/WELL ID: SB01 **SAMPLE METHOD:** Continuous
COMPLETION DATE: 9/16/2020 **DRILL METHOD:** Geoprobe 6620DT
TD (ft bgs): 20' **DRILLED BY:** Vine Labs
DTW (ft bgs): 3' **DETECTOR:** MiniRAE 3000
SCREEN SLOT: NA **FILTER PACK:** NA
CASING LENGTH: NA **ANNULUS SEAL:** NA
SCREEN LENGTH: NA **SURFACE SEAL:** NA

HOLE DIAMETER: 3.25"

WELL DIAMETER: NA

CASING TYPE: NA

SCREEN TYPE: NA

PID (ppm)	Staining	Moisture Content	Sample ID	Recovery (ft/ft)	Depth (ft)	USCS	USCS Graphic	Lithology Description	Well Construction
2,014		Dry	SB01 @2.5'	4/5	0	SM		0' - 1' - SILTY SAND, fine grained, light brown, dry, no staining, no odor	
1,730		Wet			5	SW		1' - 15' - SAND, brown, well graded, fine to coarse grained, some gravel at 5' bgs, trace gravel 5' to 15' bgs, wet at 3' bgs, yellow free product present at 3' to 5' bgs, odor at 3' to 5' bgs	
368			SB01 @12.5'	2.5/5	10				
235.8					15	SP		15' - 17.5' - SAND, poorly graded, fine grained, trace medium and coarse grains, wet, no staining, no odor	
765				4/5		SW		17.5' - 20' - SAND, well graded, fine to coarse grained, trace gravel, wet, no staining, no odor	
304				5/5					
750									
163					20				

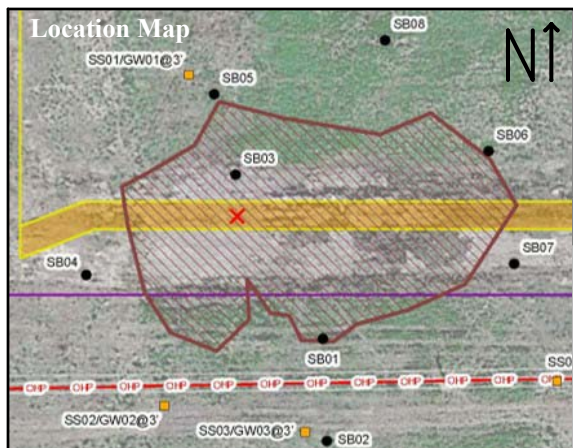

A proud member
of WSP

BORING LOG/MONITORING WELL COMPLETION DIAGRAM

PROJECT NAME: Park U-4-9XRLC
PROJECT NO: 027320018 **LOGGED BY:** Jeremy Pike
BORING/WELL ID: SB02 **SAMPLE METHOD:** Continuous
COMPLETION DATE: 9/16/2020 **DRILL METHOD:** Geoprobe 6620DT
TD (ft bgs): 10' **DRILLED BY:** Vine Labs
DTW (ft bgs): 4' **DETECTOR:** MiniRAE 3000
SCREEN SLOT: NA **FILTER PACK:** NA
CASING LENGTH: NA **ANNULUS SEAL:** NA
SCREEN LENGTH: NA **SURFACE SEAL:** NA

HOLE DIAMETER: 3.25"

WELL DIAMETER: NA

CASING TYPE: NA

SCREEN TYPE: NA

PID (ppm)	Staining	Moisture Content	Sample ID	Recovery (ft/ft)	Depth (ft)	USCS	USCS Graphic	Lithology Description	Well Construction
		Dry			0	SM			
70.6				3/5		SW			
27.8		Wet	SB02 @5'		5				
				1/5					
17.2					10				

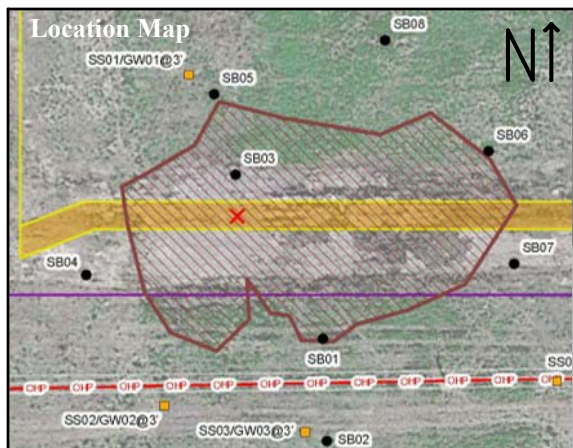

A proud member
of WSP

BORING LOG/MONITORING WELL COMPLETION DIAGRAM

PROJECT NAME: Park U-4-9XRLC
PROJECT NO: 027320018 **LOGGED BY:** Jeremy Pike
BORING/WELL ID: SB03 **SAMPLE METHOD:** Continuous
COMPLETION DATE: 9/16/2020 **DRILL METHOD:** Geoprobe 6620DT
TD (ft bgs): 15' **DRILLED BY:** Vine Labs
DTW (ft bgs): 2' **DETECTOR:** MiniRAE 3000
SCREEN SLOT: NA **FILTER PACK:** NA
CASING LENGTH: NA **ANNULUS SEAL:** NA
SCREEN LENGTH: NA **SURFACE SEAL:** NA

HOLE DIAMETER: 3.25"

WELL DIAMETER: NA

CASING TYPE: NA

SCREEN TYPE: NA

PID (ppm)	Staining	Moisture Content	Sample ID	Recovery (ft/ft)	Depth (ft)	USCS	USCS Graphic	Lithology Description	Well Construction
		Dry			0				
1,253		Wet		3/5		SM		0' - 2' - SILTY SAND, fine grained, dark brown, some clay, trace roots, dry to wet at 2' bgs, yellow free product and odor at 2' bgs	
1,062			SB03 @2.5'		5	SW		2' - 14' - SAND, brown, well graded, medium to coarse grained, trace gravel, wet, no staining, yellow free product and odor present at 2' to 5' bgs, drilled to 15' bgs but 14' to 15' interval was not recovered	
70				2/5					
237					10				
74.8				2/5					
50.6			SB03 @14'		15				

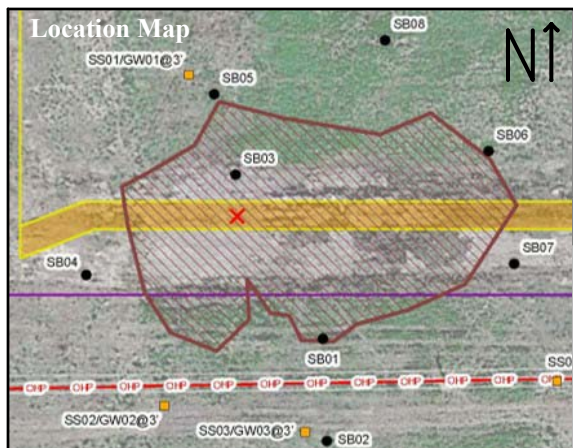

A proud member
of WSP

BORING LOG/MONITORING WELL COMPLETION DIAGRAM

PROJECT NAME: Park U-4-9XRLC
PROJECT NO: 027320018 **LOGGED BY:** Jeremy Pike
BORING/WELL ID: SB04 **SAMPLE METHOD:** Continuous
COMPLETION DATE: 9/16/2020 **DRILL METHOD:** Geoprobe 6620DT
TD (ft bgs): 10' **DRILLED BY:** Vine Labs
DTW (ft bgs): 5' **DETECTOR:** MiniRAE 3000
SCREEN SLOT: NA **FILTER PACK:** NA
CASING LENGTH: NA **ANNULUS SEAL:** NA
SCREEN LENGTH: NA **SURFACE SEAL:** NA

HOLE DIAMETER: 3.25"

WELL DIAMETER: NA

CASING TYPE: NA

SCREEN TYPE: NA

PID (ppm)	Staining	Moisture Content	Sample ID	Recovery (ft/ft)	Depth (ft)	USCS	USCS Graphic	Lithology Description	Well Construction
312		Dry			0	SM		0' - 1' - SILTY SAND, fine grained, dark brown, some clay, trace roots, dry, no staining, no odor	
50				3/5		SM		1' - 4' - SAND, brown, poorly graded, fine grained, trace gravel, dry to moist, no staining, no odor	
52.2		Moist	SB04 @4'			SW		4' - 10' - SAND, well graded, fine to coarse grained, trace gravel, moist to wet at 5' bgs, no staining, no odor	
35.2		Wet			5				
38				2/5					
32.5			SB04 @10'		10				

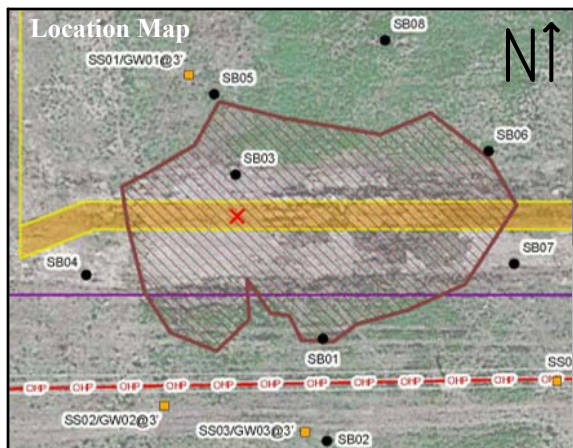

A proud member
of WSP

BORING LOG/MONITORING WELL COMPLETION DIAGRAM

PROJECT NAME: Park U-4-9XRLC
PROJECT NO: 027320018 **LOGGED BY:** Jeremy Pike
BORING/WELL ID: SB05 **SAMPLE METHOD:** Continuous
COMPLETION DATE: 9/16/2020 **DRILL METHOD:** Geoprobe 6620DT
TD (ft bgs): 10' **DRILLED BY:** Vine Labs
DTW (ft bgs): 5' **DETECTOR:** MiniRAE 3000
SCREEN SLOT: NA **FILTER PACK:** NA
CASING LENGTH: NA **ANNULUS SEAL:** NA
SCREEN LENGTH: NA **SURFACE SEAL:** NA

HOLE DIAMETER: 3.25"

WELL DIAMETER: NA

CASING TYPE: NA

SCREEN TYPE: NA

PID (ppm)	Staining	Moisture Content	Sample ID	Recovery (ft/ft)	Depth (ft)	USCS	USCS Graphic	Lithology Description	Well Construction
85.5		Dry		3/5	0	SM		0' - 2.5' - SILTY SAND, fine grained, dark brown, some clay, trace roots, dry, no staining, no odor	
1,605		Wet	SB05 @5'		5	SW		2.5' - 10' - SAND, brown, well graded, fine to coarse grained, trace gravel, dry to wet at 5', no staining, odor present at 2.5' to 5' bgs	
41.2			SB05 @10'	1.5/5	10				

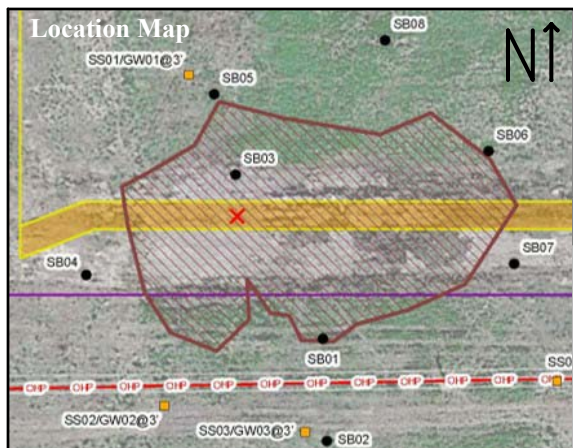

A proud member
of WSP

BORING LOG/MONITORING WELL COMPLETION DIAGRAM

PROJECT NAME: Park U-4-9XRLC
PROJECT NO: 027320018 **LOGGED BY:** Jeremy Pike
BORING/WELL ID: SB06 **SAMPLE METHOD:** Continuous
COMPLETION DATE: 9/16/2020 **DRILL METHOD:** Geoprobe 6620DT
TD (ft bgs): 15' **DRILLED BY:** Vine Labs
DTW (ft bgs): 4' **DETECTOR:** MiniRAE 3000
SCREEN SLOT: NA **FILTER PACK:** NA
CASING LENGTH: NA **ANNULUS SEAL:** NA
SCREEN LENGTH: NA **SURFACE SEAL:** NA

HOLE DIAMETER: 3.25"

WELL DIAMETER: NA

CASING TYPE: NA

SCREEN TYPE: NA

PID (ppm)	Staining	Moisture Content	Sample ID	Recovery (ft/ft)	Depth (ft)	USCS	USCS Graphic	Lithology Description	Well Construction
		Dry			0				
1,766				2.5/5		SM		0' - 1' - SILTY SAND, fine grained, dark brown, some clay, trace roots, dry, staining and odor present	
1,995						SP		1' - 4' - SAND, brown, poorly graded, fine grained, trace gravel, dry to wet at 4', no staining, odor present, yellow free product at 4' bgs	
2,078		Wet	SB06 @4'		5	SW		4' - 15' - SAND, well graded, fine to coarse grained, some gravel, no staining, odor present from 4' to 10' bgs	
395				2.5/5					
225					10				
59.1				1.5/5					
95.7			SB06		15				

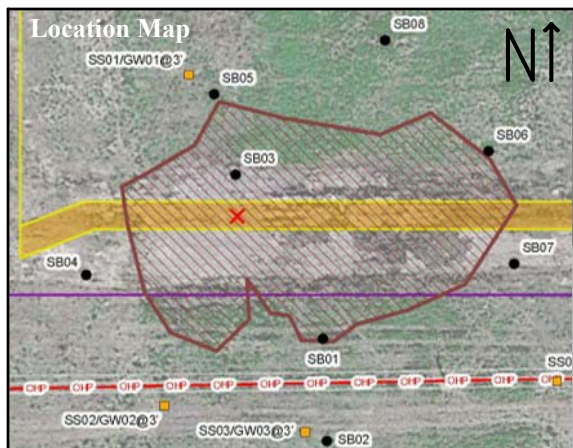

A proud member
of WSP

BORING LOG/MONITORING WELL COMPLETION DIAGRAM

PROJECT NAME: Park U-4-9XRLC
PROJECT NO: 027320018 **LOGGED BY:** Jeremy Pike
BORING/WELL ID: SB07 **SAMPLE METHOD:** Continuous
COMPLETION DATE: 9/16/2020 **DRILL METHOD:** Geoprobe 6620DT
TD (ft bgs): 15' **DRILLED BY:** Vine Labs
DTW (ft bgs): 4' **DETECTOR:** MiniRAE 3000
SCREEN SLOT: NA **FILTER PACK:** NA
CASING LENGTH: NA **ANNULUS SEAL:** NA
SCREEN LENGTH: NA **SURFACE SEAL:** NA

HOLE DIAMETER: 3.25"

WELL DIAMETER: NA

CASING TYPE: NA

SCREEN TYPE: NA

PID (ppm)	Staining	Moisture Content	Sample ID	Recovery (ft/ft)	Depth (ft)	USCS	USCS Graphic	Lithology Description	Well Construction
437		Dry		3.5/5	0	SM		0' - 4' - SILTY SAND, fine grained, dark brown to brown, some clay, trace roots, trace gravel at 1' to 4' bgs, dry to moist at 1' bgs, no staining, no odor	
2,200		Moist							
2,020		Wet			5	SW		4' - 15' - SAND, brown, well graded, fine to coarse grained, some gravel, wet, no staining, odor present at 4' to 5' bgs, yellow free product at 4' to 5' bgs	
				0/5					
370			SB07 @11'		10				
				3.5/5					
370			SB07		15				

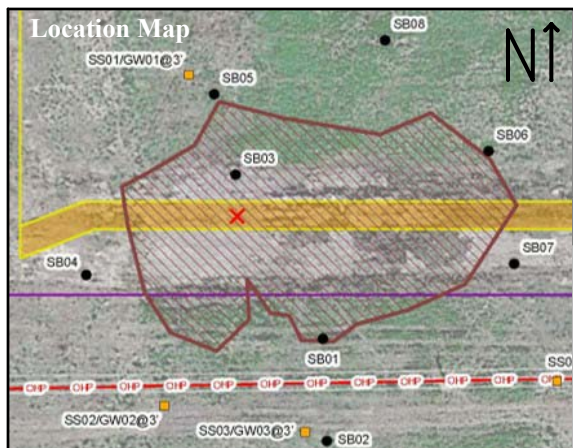

A proud member
of WSP

BORING LOG/MONITORING WELL COMPLETION DIAGRAM

PROJECT NAME: Park U-4-9XRLC
PROJECT NO: 027320018 **LOGGED BY:** Jeremy Pike
BORING/WELL ID: SB08 **SAMPLE METHOD:** Continuous
COMPLETION DATE: 9/16/2020 **DRILL METHOD:** Geoprobe 6620DT
TD (ft bgs): 10' **DRILLED BY:** Vine Labs
DTW (ft bgs): 4' **DETECTOR:** MiniRAE 3000
SCREEN SLOT: NA **FILTER PACK:** NA
CASING LENGTH: NA **ANNULUS SEAL:** NA
SCREEN LENGTH: NA **SURFACE SEAL:** NA

HOLE DIAMETER: 3.25"

WELL DIAMETER: NA

CASING TYPE: NA

SCREEN TYPE: NA

PID (ppm)	Staining	Moisture Content	Sample ID	Recovery (ft/ft)	Depth (ft)	USCS	USCS Graphic	Lithology Description	Well Construction
176		Dry			0	SM		0' - 1.5' - SILTY SAND, fine grained, dark brown to brown, some clay, trace roots, dry, no staining, no odor	
		Moist		3/5		SP		1.5' - 4' - SAND, brown, poorly graded, fine grained, moist, no staining, odor present at 3' to 4' bgs	
1,170		Wet	SB08 @4'			SW		4' - 10' - SAND, brown, well graded, fine to coarse grained, trace gravel, no staining, no odor	
1,027					5				
25				3/5					
25			SB08 @10'		10				

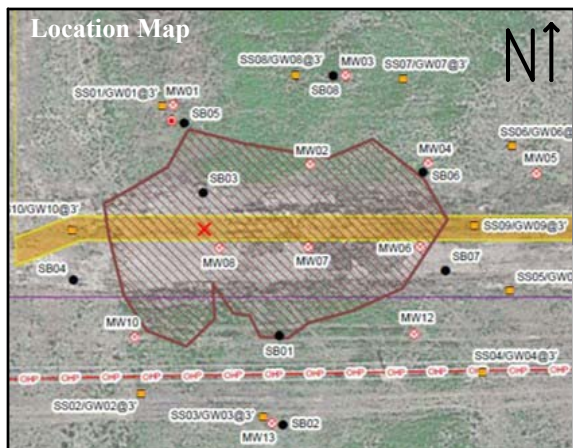

BORING LOG/MONITORING WELL COMPLETION DIAGRAM

PROJECT NAME: Park U-4-9XRLC
PROJECT NO: TE034520034 **LOGGED BY:** Jeremy Pike
BORING/WELL ID: MW01 **SAMPLE METHOD:** Continuous
COMPLETION DATE: 11/4/2020 **DRILL METHOD:** Geoprobe 6620DT
TD (ft bgs): 12' **DRILLED BY:** Vine Labs
DTW (ft bgs): 4.5' **DETECTOR:** ultraRAE 3000
SCREEN SLOT: 0.010" **FILTER PACK:** 10-20 silica sand
CASING LENGTH: 2' **ANNULUS SEAL:** Bentonite chips
SCREEN LENGTH: 10' **SURFACE SEAL:** NA

HOLE DIAMETER: 3.25"

WELL DIAMETER: 1"

CASING TYPE: PVC

SCREEN TYPE: PVC

PID (ppm)	Staining	Moisture Content	Sample ID	Recovery (ft/ft)	Depth (ft)	USCS	USCS Graphic	Lithology Description	Well Construction
		Moist			0	SM			
1.5				1.5/5	1.5	SW			
5		Wet			5				
1				2/5					
1					10				
				1/2					

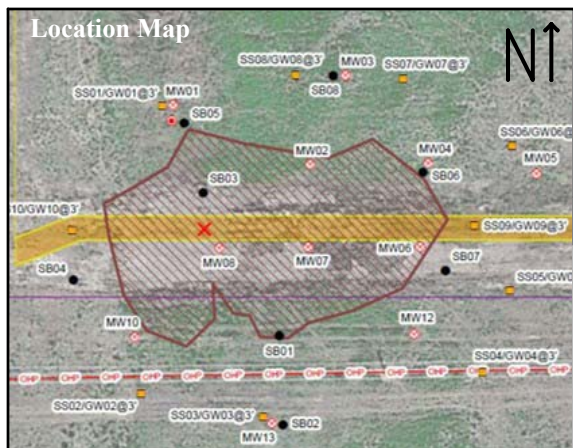

BORING LOG/MONITORING WELL COMPLETION DIAGRAM

PROJECT NAME: Park U-4-9XRLC
PROJECT NO: TE034520034 **LOGGED BY:** Jeremy Pike
BORING/WELL ID: MW02 **SAMPLE METHOD:** Continuous
COMPLETION DATE: 11/4/2020 **DRILL METHOD:** Geoprobe 6620DT
TD (ft bgs): 12' **DRILLED BY:** Vine Labs
DTW (ft bgs): 3' **DETECTOR:** ultraRAE 3000
SCREEN SLOT: 0.010" **FILTER PACK:** 10-20 silica sand
CASING LENGTH: 2' **ANNULUS SEAL:** Bentonite chips
SCREEN LENGTH: 8' **SURFACE SEAL:** NA

HOLE DIAMETER: 3.25"

WELL DIAMETER: 1"

CASING TYPE: PVC

SCREEN TYPE: PVC

PID (ppm)	Staining	Moisture Content	Sample ID	Recovery (ft/ft)	Depth (ft)	USCS	USCS Graphic	Lithology Description	Well Construction
1,417		Moist	MW02 @1'		0	SM		0' - 1' - SILTY SAND, dark brown, some clay, trace roots, moist, no staining, hydrocarbon odor	
1,304				3/5		SM		1' - 3' - SILTY SAND, light brown, fine grained, wet at 3' bgs, no stain, hydrocarbon odor	
960		Wet			5	SW		3' - 5' - SAND, light brown, fine to coarse grained, wet, no stain, hydrocarbon odor, free product observed on sample liner	
289			MW02 @10'		10	SW		5' - 10' - SAND, light brown, fine to coarse grained, trace gravel, wet, no stain, hydrocarbon odor	
				0/2				10' - 12' - No recovery	

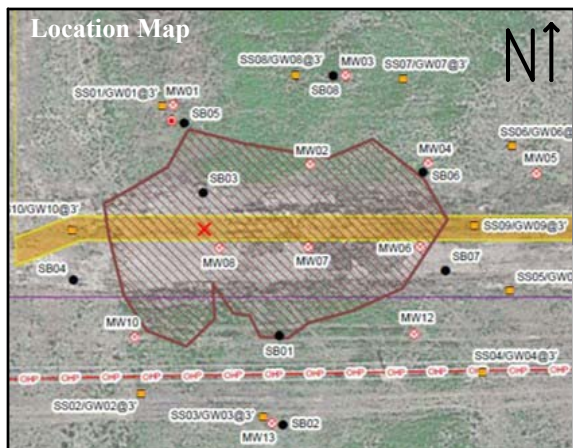

BORING LOG/MONITORING WELL COMPLETION DIAGRAM

PROJECT NAME: Park U-4-9XRLC
PROJECT NO: TE034520034 **LOGGED BY:** Jeremy Pike
BORING/WELL ID: MW03 **SAMPLE METHOD:** Continuous
COMPLETION DATE: 11/4/2020 **DRILL METHOD:** Geoprobe 6620DT
TD (ft bgs): 12' **DRILLED BY:** Vine Labs
DTW (ft bgs): 4.5' **DETECTOR:** ultraRAE 3000
SCREEN SLOT: 0.010" **FILTER PACK:** 10-20 silica sand
CASING LENGTH: 2' **ANNULUS SEAL:** Bentonite chips
SCREEN LENGTH: 10' **SURFACE SEAL:** NA

HOLE DIAMETER: 3.25"

WELL DIAMETER: 1"

CASING TYPE: PVC

SCREEN TYPE: PVC

PID (ppm)	Staining	Moisture Content	Sample ID	Recovery (ft/ft)	Depth (ft)	USCS	USCS Graphic	Lithology Description	Well Construction
27		Moist		2.5/5	0	SM		0' - 1' - SILTY SAND, dark brown, some clay, trace roots, moist, no staining, no odor	
250		Wet			5	SP		1' - 5' - SAND, light brown, fine grained, moist to wet at 4.5' bgs, orange iron stain at 4.5' to 5' bgs, thin (<0.5") black stain at 4.5' bgs, odor at 4.5' to 5' bgs	
6				2/5	10	SW		5' - 12' - SAND, light brown, fine to coarse grained, trace gravel, wet, no stain, no odor	
5									
1.5				2/2					

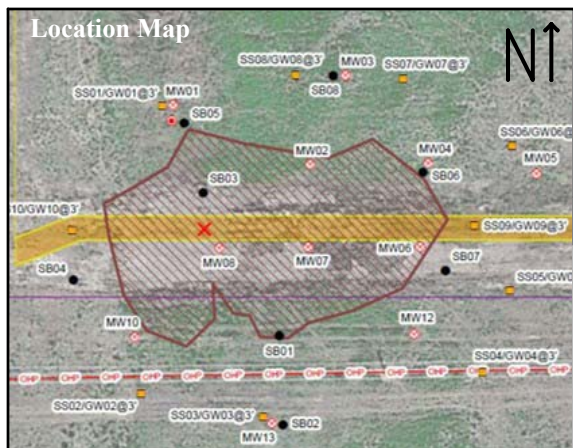

BORING LOG/MONITORING WELL COMPLETION DIAGRAM

PROJECT NAME: Park U-4-9XRLC
PROJECT NO: TE034520034 **LOGGED BY:** Jeremy Pike
BORING/WELL ID: MW04 **SAMPLE METHOD:** Continuous
COMPLETION DATE: 11/4/2020 **DRILL METHOD:** Geoprobe 6620DT
TD (ft bgs): 12' **DRILLED BY:** Vine Labs
DTW (ft bgs): 4' **DETECTOR:** ultraRAE 3000
SCREEN SLOT: 0.010" **FILTER PACK:** 10-20 silica sand
CASING LENGTH: 2' **ANNULUS SEAL:** Bentonite chips
SCREEN LENGTH: 10' **SURFACE SEAL:** NA

HOLE DIAMETER: 3.25"

WELL DIAMETER: 1"

CASING TYPE: PVC

SCREEN TYPE: PVC

PID (ppm)	Staining	Moisture Content	Sample ID	Recovery (ft/ft)	Depth (ft)	USCS	USCS Graphic	Lithology Description	Well Construction
		Moist			0	SC		0' - 0.5' - CLAYEY SAND, black, fine grained, dry, no staining, no odor	
2.57				3/5		SP		0.5' - 4' - SAND, light brown, fine grained coarsening downward, moist, no stain, no odor	
498		Wet			5	SW		4' - 10' - SAND, light brown, fine to coarse grained, trace gravel, wet, no stain, hydrocarbon odor at 5', free product observed at 5', poor sample recovery from 5' to 10' bgs	
350				1.5/5					
180					10			10' - 12' - No recovery	
				0/2					

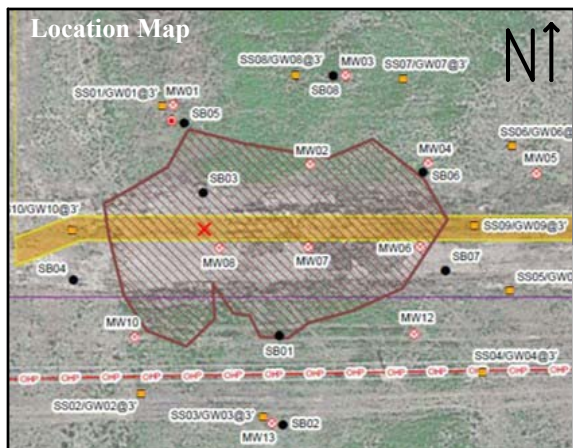

BORING LOG/MONITORING WELL COMPLETION DIAGRAM

PROJECT NAME: Park U-4-9XRLC
PROJECT NO: TE034520034 **LOGGED BY:** Jeremy Pike
BORING/WELL ID: MW05 **SAMPLE METHOD:** Continuous
COMPLETION DATE: 11/4/2020 **DRILL METHOD:** Geoprobe 6620DT
TD (ft bgs): 12' **DRILLED BY:** Vine Labs
DTW (ft bgs): 4' **DETECTOR:** ultraRAE 3000
SCREEN SLOT: 0.010" **FILTER PACK:** 10-20 silica sand
CASING LENGTH: 2' **ANNULUS SEAL:** Bentonite chips
SCREEN LENGTH: 10' **SURFACE SEAL:** NA

HOLE DIAMETER: 3.25"

WELL DIAMETER: 1"

CASING TYPE: PVC

SCREEN TYPE: PVC

PID (ppm)	Staining	Moisture Content	Sample ID	Recovery (ft/ft)	Depth (ft)	USCS	USCS Graphic	Lithology Description	Well Construction
		Moist			0	SM			
1				3.5/5		SW			
8.6		Wet	MW05 @4'						
8.3					5				
1.38				2.5/5					
2.5					10				
2.5			MW05 @12'	1.5/2					

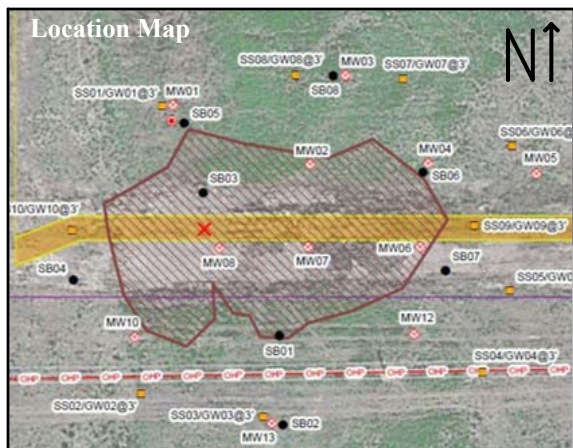

BORING LOG/MONITORING WELL COMPLETION DIAGRAM

PROJECT NAME: Park U-4-9XRLC
PROJECT NO: TE034520034 **LOGGED BY:** Jeremy Pike
BORING/WELL ID: MW06 **SAMPLE METHOD:** Continuous
COMPLETION DATE: 11/4/2020 **DRILL METHOD:** Geoprobe 6620DT
TD (ft bgs): 12' **DRILLED BY:** Vine Labs
DTW (ft bgs): 4' **DETECTOR:** ultraRAE 3000
SCREEN SLOT: 0.010" **FILTER PACK:** 10-20 silica sand
CASING LENGTH: 2' **ANNULUS SEAL:** Bentonite chips
SCREEN LENGTH: 10' **SURFACE SEAL:** NA

HOLE DIAMETER: 3.25"

WELL DIAMETER: 1"

CASING TYPE: PVC

SCREEN TYPE: PVC

PID (ppm)	Staining	Moisture Content	Sample ID	Recovery (ft/ft)	Depth (ft)	USCS	USCS Graphic	Lithology Description	Well Construction
747		Moist	MW06 @0-1.5'		0	SM		0' - 1.5' - SAND, brown, fine to coarse grained, some clay, moist, hydrocarbon staining and odor	
				0/5				1.5' - 5' - No recovery, hydrovacuumed due to the proximity to buried flow lines	
833.3		Wet	MW06 @5'		5	SW		5' - 10' - SAND, light brown, fine to coarse grained, gravelly, wet, no stain, odor, free product observed at 5' to 7' bgs	
446			MW06 @7'	1.5/5					
48.3					10	SW		10' - 12' - SAND, light brown, fine to coarse grained, trace gravel, no stain, no odor	
26.5			MW06 @12'	2/5	15				

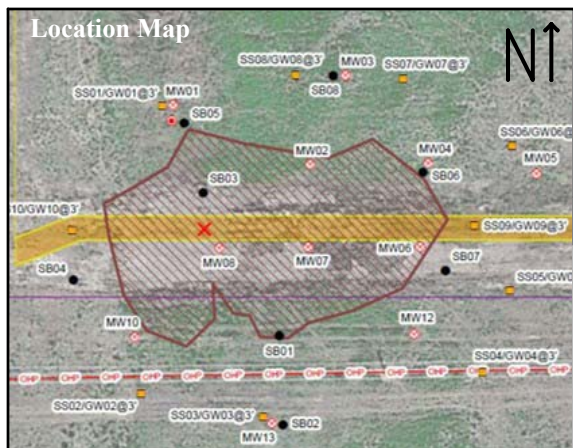

BORING LOG/MONITORING WELL COMPLETION DIAGRAM

PROJECT NAME: Park U-4-9XRLC
PROJECT NO: TE034520034 **LOGGED BY:** Jeremy Pike
BORING/WELL ID: MW07 **SAMPLE METHOD:** Continuous
COMPLETION DATE: 11/4/2020 **DRILL METHOD:** Geoprobe 6620DT
TD (ft bgs): 12' **DRILLED BY:** Vine Labs
DTW (ft bgs): 4' **DETECTOR:** ultraRAE 3000
SCREEN SLOT: 0.010" **FILTER PACK:** 10-20 silica sand
CASING LENGTH: 2' **ANNULUS SEAL:** Bentonite chips
SCREEN LENGTH: 10' **SURFACE SEAL:** NA

HOLE DIAMETER: 3.25"

WELL DIAMETER: 1"

CASING TYPE: PVC

SCREEN TYPE: PVC

PID (ppm)	Staining	Moisture Content	Sample ID	Recovery (ft/ft)	Depth (ft)	USCS	USCS Graphic	Lithology Description	Well Construction
1,280		Moist	MW07 @0-1.5'		0	SM		0' - 1.5' - SAND, brown, fine to coarse grained, some clay, moist, hydrocarbon staining and odor	
				0/5				1.5' - 5' - No recovery, hydrovacuumed due to the proximity to buried flow lines	
789		Wet	MW07 @5'		5	SW		5' - 12' - SAND, light brown, fine to coarse grained, trace gravel, wet, trace staining at 5', hydrocarbon odor, poor recovery at 10' to 12' bgs and suspected cross-contamination from sloughing with trace free product on liner at 12' bgs	
210			MW07 @7'	2/5					
365					10				
301			MW07 @12'	1/2					

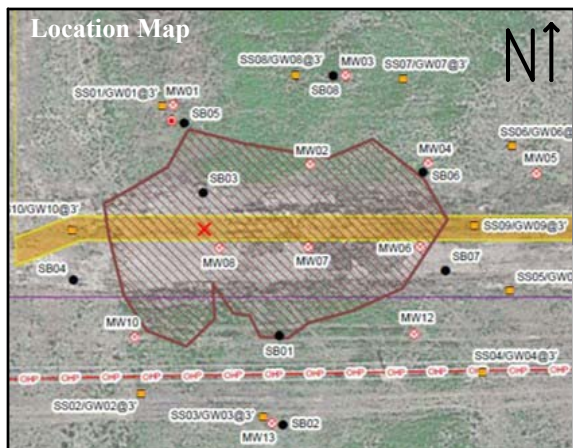

BORING LOG/MONITORING WELL COMPLETION DIAGRAM

PROJECT NAME: Park U-4-9XRLC
PROJECT NO: TE034520034 **LOGGED BY:** Jeremy Pike
BORING/WELL ID: MW08 **SAMPLE METHOD:** Continuous
COMPLETION DATE: 11/4/2020 **DRILL METHOD:** Geoprobe 6620DT
TD (ft bgs): 12' **DRILLED BY:** Vine Labs
DTW (ft bgs): 3' **DETECTOR:** ultraRAE 3000
SCREEN SLOT: 0.010" **FILTER PACK:** 10-20 silica sand
CASING LENGTH: 2' **ANNULUS SEAL:** Bentonite chips
SCREEN LENGTH: 10' **SURFACE SEAL:** NA

HOLE DIAMETER: 3.25"

WELL DIAMETER: 1"

CASING TYPE: PVC

SCREEN TYPE: PVC

PID (ppm)	Staining	Moisture Content	Sample ID	Recovery (ft/ft)	Depth (ft)	USCS	USCS Graphic	Lithology Description	Well Construction
736		Moist	MW08 @0-1.5'		0	SM		0' - 1' - SAND, brown, fine grained, some clay, moist, hydrocarbon staining and odor	
674		Wet		2.5/5		SP		1' - 3.5' - SAND, brown, fine grained, moist to wet at 3' bgs, no stain, hydrocarbon odor	
124						CL		3.5' - 4' - SILTY CLAY, gray, sandy, wet, hydrocarbon staining and odor	
1,058			MW08 @5'		5	SW		4' - 12' - SAND, light brown, fine to coarse grained, wet, no stain, hydrocarbon odor at 4' to 5' bgs	
11.65			MW08 @7'	2/5					
10.5					10				
2.2			MW08 @12'						

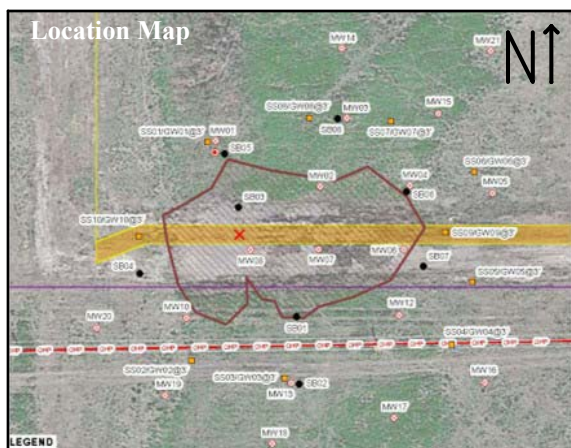

BORING LOG/MONITORING WELL COMPLETION DIAGRAM

PROJECT NAME:	Park U-4-9XRLC		
PROJECT NO:	TE034520034	LOGGED BY:	Drew Bullinger
BORING/WELL ID:	MW09	SAMPLE METHOD:	Continuous
COMPLETION DATE:	11/10/2020	DRILL METHOD:	Direct push
TD (ft bgs):	12'	DRILLED BY:	Vine Labs
DTW (ft bgs):	3'	DETECTOR:	ultraRAE 3000
SCREEN SLOT:	0.010"	FILTER PACK:	10-20 silica sand
CASING LENGTH:	2'	ANNULUS SEAL:	Bentonite chips
SCREEN LENGTH:	10'	SURFACE SEAL:	NA

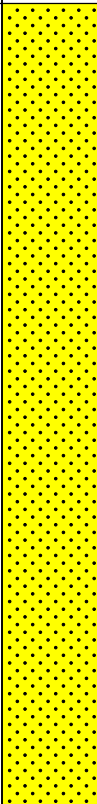
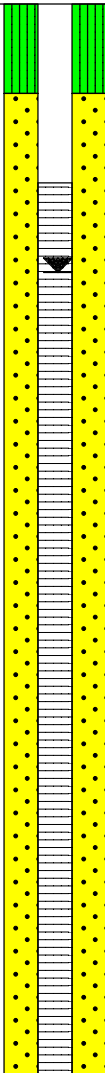
PID (ppm)	Staining	Moisture Content	Sample ID	Recovery (ft/ft)	Depth (ft)	USCS	USCS Graphic	Lithology Description	Well Construction
		dry			0			0' - 3' - hydrovacuumed due to proximity to buried utilities, not logged	
256		Wet	MW09 @4'	0.5/2	5	SW		3' - 12' - SAND, brown, well graded, fine to coarse grained, wet, stain at 3' to 6' bgs, odor at 3' to 9' bgs, poor recovery from 3' to 5' bgs	
244									
195									
143				2/5					
51									
24					10				
5.42				2/2					
0.74			MW09 @12'						

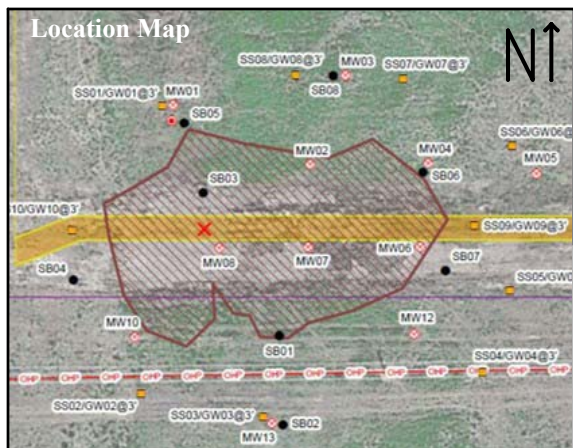

BORING LOG/MONITORING WELL COMPLETION DIAGRAM

PROJECT NAME: Park U-4-9XRLC
PROJECT NO: TE034520034 **LOGGED BY:** Jeremy Pike
BORING/WELL ID: MW10 **SAMPLE METHOD:** Continuous
COMPLETION DATE: 11/4/2020 **DRILL METHOD:** Geoprobe 6620DT
TD (ft bgs): 12' **DRILLED BY:** Vine Labs
DTW (ft bgs): 4' **DETECTOR:** ultraRAE 3000
SCREEN SLOT: 0.010" **FILTER PACK:** 10-20 silica sand
CASING LENGTH: 2' **ANNULUS SEAL:** Bentonite chips
SCREEN LENGTH: 10' **SURFACE SEAL:** NA

HOLE DIAMETER: 3.25"

WELL DIAMETER: 1"

CASING TYPE: PVC

SCREEN TYPE: PVC

PID (ppm)	Staining	Moisture Content	Sample ID	Recovery (ft/ft)	Depth (ft)	USCS	USCS Graphic	Lithology Description	Well Construction
10		Moist		2.5/5	0	SC		0' - 2.5' - CLAYEY SAND, dark brown, fine grained, some roots, moist, no staining, no odor	
400		Wet	MW10 @4'			SP		2' - 5' - SAND, light brown, fine grained, increasing coarsed grains with depth, trace gravel at 5' bgs, moist to wet at 4' bgs, no stain, no odor	
353					5	SW		5' - 12' - SAND, light brown, fine to coarse grained, trace gravel, wet, no stain, no odor	
1.27				2/5					
1.2					10				
1.2			MW10 @12'	2/2					

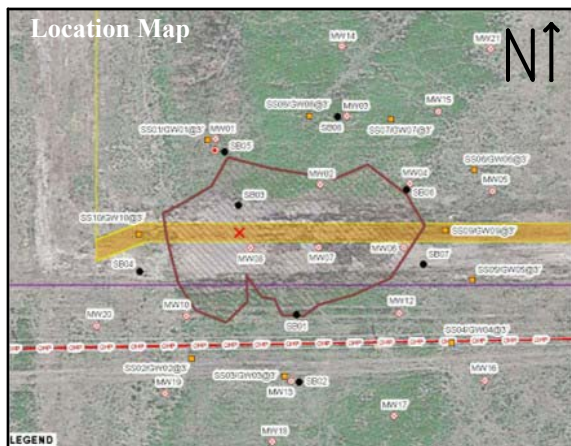

BORING LOG/MONITORING WELL COMPLETION DIAGRAM

PROJECT NAME:	Park U-4-9XRLC		
PROJECT NO:	TE034520034	LOGGED BY:	Drew Bullinger
BORING/WELL ID:	MW11	SAMPLE METHOD:	Continuous
COMPLETION DATE:	11/10/2020	DRILL METHOD:	Direct push
TD (ft bgs):	12'	DRILLED BY:	Vine Labs
DTW (ft bgs):	4'	DETECTOR:	ultraRAE 3000
SCREEN SLOT:	0.010"	FILTER PACK:	10-20 silica sand
CASING LENGTH:	2'	ANNULUS SEAL:	Bentonite chips
SCREEN LENGTH:	10'	SURFACE SEAL:	NA

[illegible]

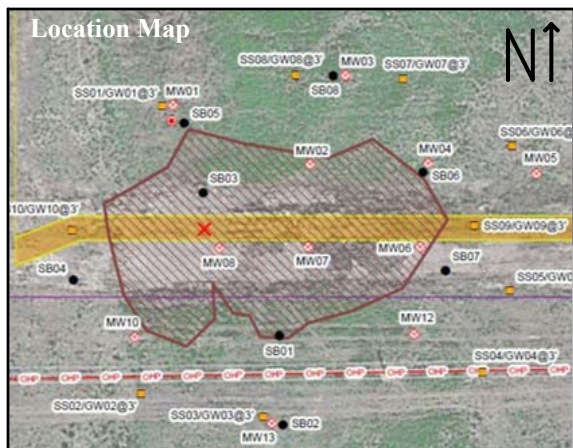

BORING LOG/MONITORING WELL COMPLETION DIAGRAM

PROJECT NAME: Park U-4-9XRLC
PROJECT NO: TE034520034 **LOGGED BY:** Jeremy Pike
BORING/WELL ID: MW12 **SAMPLE METHOD:** Continuous
COMPLETION DATE: 11/4/2020 **DRILL METHOD:** Geoprobe 6620DT
TD (ft bgs): 12' **DRILLED BY:** Vine Labs
DTW (ft bgs): 4' **DETECTOR:** ultraRAE 3000
SCREEN SLOT: 0.010" **FILTER PACK:** 10-20 silica sand
CASING LENGTH: 2' **ANNULUS SEAL:** Bentonite chips
SCREEN LENGTH: 10' **SURFACE SEAL:** NA

HOLE DIAMETER: 3.25"

WELL DIAMETER: 1"

CASING TYPE: PVC

SCREEN TYPE: PVC

PID (ppm)	Staining	Moisture Content	Sample ID	Recovery (ft/ft)	Depth (ft)	USCS	USCS Graphic	Lithology Description	Well Construction
4.2		Moist			0	SM		0' - 3' - SILTY SAND, light brown, fine grained, some clay, trace roots, dry to moist, no staining, no odor	
868		Wet	MW12 @4'		3/5	SW		3' - 12' - SAND, light brown, fine to coarse grained, trace gravel with no gravel at 11' to 12' bgs, moist to wet at 4' bgs, hydrocarbon staining and odor at 4' to 5' bgs	
465					5				
119					1.5/5				
12.05					10				
6			MW12 @12'		2/2				

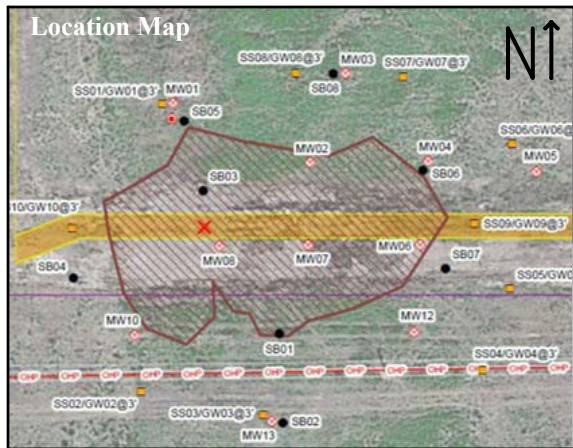

HOLE DIAMETER: 3.25"
WELL DIAMETER: 1"
CASING TYPE: PVC
SCREEN TYPE: PVC

BORING LOG/MONITORING WELL COMPLETION DIAGRAM

PROJECT NAME: Park U-4-9XRLC
PROJECT NO: TE034520034
BORING/WELL ID: MW13
COMPLETION DATE: 11/4/2020
TD (ft bgs): 12'
DTW (ft bgs): 3'
SCREEN SLOT: 0.010"
CASING LENGTH: 2'
SCREEN LENGTH: 10'

LOGGED BY: Jeremy Pike
SAMPLE METHOD: Continuous
DRILL METHOD: Geoprobe 6620DT
DRILLED BY: Vine Labs
DETECTOR: ultraRAE 3000
FILTER PACK: 10-20 silica sand
ANNULUS SEAL: Bentonite chips
SURFACE SEAL: NA

PID (ppm)	Staining	Moisture Content	Sample ID	Recovery (ft/ft)	Depth (ft)	USCS	USCS Graphic	Lithology Description	Well Construction
1.93		Moist			0	SM		0' - 3' - SILTY SAND, light brown, fine grained, some clay, trace roots, dry to moist, no staining, no odor	
22.5		Wet		3/5		SW		3' - 12' - SAND, light brown, fine to coarse grained, trace gravel with no gravel at 11' to 12' bgs, wet, hydrocarbon staining and odor at 4' to 5' bgs	
461					5				
170				1.5/5					
102				1/2	10				

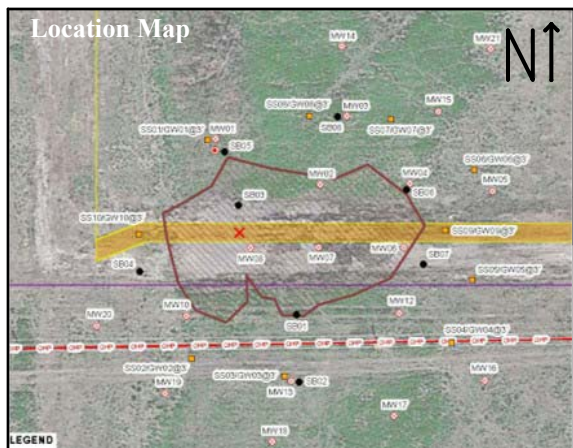

BORING LOG/MONITORING WELL COMPLETION DIAGRAM

PROJECT NAME: Park U-4-9XRLC
PROJECT NO: TE034520034 **LOGGED BY:** Drew Bullinger
BORING/WELL ID: MW14 **SAMPLE METHOD:** Continuous
COMPLETION DATE: 11/10/2020 **DRILL METHOD:** Direct push
TD (ft bgs): 12' **DRILLED BY:** Vine Labs
DTW (ft bgs): 3.5' **DETECTOR:** ultraRAE 3000
SCREEN SLOT: 0.010" **FILTER PACK:** 10-20 silica sand
CASING LENGTH: 2' **ANNULUS SEAL:** Bentonite chips
SCREEN LENGTH: 10' **SURFACE SEAL:** NA

HOLE DIAMETER: 3.25"

WELL DIAMETER: 1"

CASING TYPE: PVC

SCREEN TYPE: PVC

PID (ppm)	Staining	Moisture Content	Sample ID	Recovery (ft/ft)	Depth (ft)	USCS	USCS Graphic	Lithology Description	Well Construction
7.25		dry			0	SM		0' - 2' - SILTY SAND, dark brown, fine grained, organics, dry, no staining, no odor	
8.87									
9.22			MW14 @3'	3/5		SW		2' - 12' - SAND, brown, well graded, fine to coarse grained, dry to wet at 3.5' bgs, no stain, no odor	
3.23		Wet							
2.80					5				
0.57									
0.56									
0.56				2/5					
0.57									
0.46					10				
0.39				2/2					
0.37			MW14 @12'						

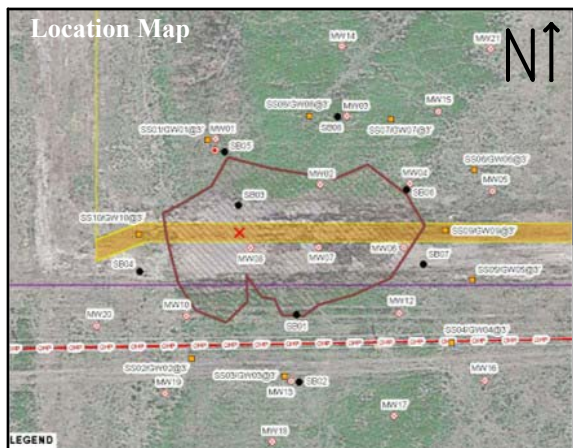

BORING LOG/MONITORING WELL COMPLETION DIAGRAM

PROJECT NAME: Park U-4-9XRLC
PROJECT NO: TE034520034 **LOGGED BY:** Drew Bullinger
BORING/WELL ID: MW15 **SAMPLE METHOD:** Continuous
COMPLETION DATE: 11/10/2020 **DRILL METHOD:** Direct push
TD (ft bgs): 12' **DRILLED BY:** Vine Labs
DTW (ft bgs): 4' **DETECTOR:** ultraRAE 3000
SCREEN SLOT: 0.010" **FILTER PACK:** 10-20 silica sand
CASING LENGTH: 2' **ANNULUS SEAL:** Bentonite chips
SCREEN LENGTH: 10' **SURFACE SEAL:** NA

HOLE DIAMETER: 3.25"

WELL DIAMETER: 1"

CASING TYPE: PVC

SCREEN TYPE: PVC

PID (ppm)	Staining	Moisture Content	Sample ID	Recovery (ft/ft)	Depth (ft)	USCS	USCS Graphic	Lithology Description	Well Construction
4.06		dry			0	SM		0' - 2' - SILTY SAND, brown, fine grained, organics, dry, no staining, no odor	
7.08				2.5/5		SW		2' - 12' - SAND, brown, well graded, fine to coarse grained, dry to wet at 4' bgs, stain at 4' to 5' bgs, odor at 4' to 6' bgs and at 11' bgs	
23.33									
507	Wet		MW15 @4'						
246					5				
25.93									
3.66				3/5					
4.00									
3.95									
9.18					10				
21.38				2/2					
12.22			MW15 @12'						

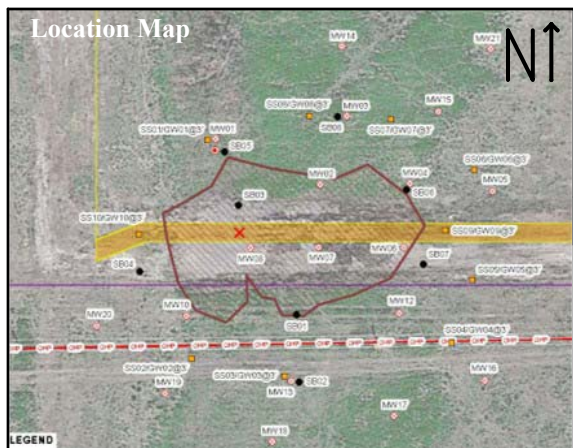

BORING LOG/MONITORING WELL COMPLETION DIAGRAM

PROJECT NAME: Park U-4-9XRLC
PROJECT NO: TE034520034 **LOGGED BY:** Drew Bullinger
BORING/WELL ID: MW16 **SAMPLE METHOD:** Continuous
COMPLETION DATE: 11/10/2020 **DRILL METHOD:** Direct push
TD (ft bgs): 12' **DRILLED BY:** Vine Labs
DTW (ft bgs): 4' **DETECTOR:** ultraRAE 3000
SCREEN SLOT: 0.010" **FILTER PACK:** 10-20 silica sand
CASING LENGTH: 2' **ANNULUS SEAL:** Bentonite chips
SCREEN LENGTH: 10' **SURFACE SEAL:** NA

HOLE DIAMETER: 3.25"

WELL DIAMETER: 1"

CASING TYPE: PVC

SCREEN TYPE: PVC

PID (ppm)	Staining	Moisture Content	Sample ID	Recovery (ft/ft)	Depth (ft)	USCS	USCS Graphic	Lithology Description	Well Construction
0.08		dry			0	SM		0' - 2' - SILTY SAND, dark brown, fine grained, some medium grains, little gravel, dry, no staining, no odor	
0.09				3/5		SW		2' - 12' - SAND, brown, well graded, fine to coarse grained, dry to wet at 4' bgs, no stain, no odor, trace gravel at 5' bgs, increase in grain size starting at 10' bgs	
0.10									
0.10	Wet		MW16 @4'						
0.09					5				
0.11									
0.12				2.5/5					
0.09									
0.10									
0.10					10				
0.09				2/2					
0.09			MW16 @12'						

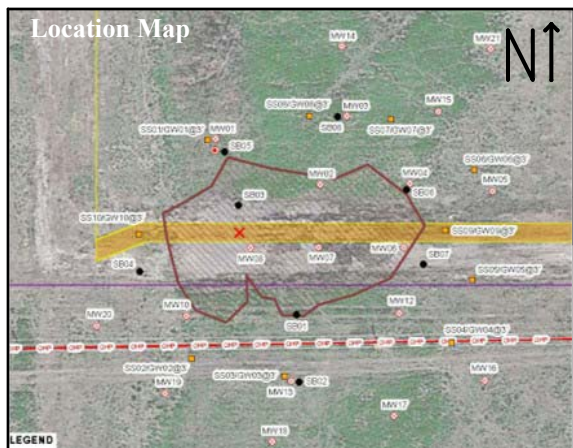

BORING LOG/MONITORING WELL COMPLETION DIAGRAM

PROJECT NAME: Park U-4-9XRLC
PROJECT NO: TE034520034 **LOGGED BY:** Drew Bullinger
BORING/WELL ID: MW17 **SAMPLE METHOD:** Continuous
COMPLETION DATE: 11/10/2020 **DRILL METHOD:** Direct push
TD (ft bgs): 12' **DRILLED BY:** Vine Labs
DTW (ft bgs): 4' **DETECTOR:** ultraRAE 3000
SCREEN SLOT: 0.010" **FILTER PACK:** 10-20 silica sand
CASING LENGTH: 2' **ANNULUS SEAL:** Bentonite chips
SCREEN LENGTH: 10' **SURFACE SEAL:** NA

HOLE DIAMETER: 3.25"

WELL DIAMETER: 1"

CASING TYPE: PVC

SCREEN TYPE: PVC

PID (ppm)	Staining	Moisture Content	Sample ID	Recovery (ft/ft)	Depth (ft)	USCS	USCS Graphic	Lithology Description	Well Construction
0.01		dry			0	SM		0' - 1' - SILTY SAND, dark brown, fine grained, little gravel, organics, dry, no staining, no odor	
0.05				2.5/5		SW		1' - 11' - SAND, brown, well graded, fine to coarse grained, dry to wet at 4' bgs, no stain, no odor, trace gravel at 5' to 6' bgs	
0.06									
0.09		Wet	MW17 @4'						
0.11					5				
0.07									
0.09				2.5/5					
0.06									
0.07									
0.07					10				
0.09				2/2		SP		11' - 12' - SAND, brown, poorly graded, fine grained, little coarse grains, wet, no stain, no odor	
0.09			MW17 @12'						

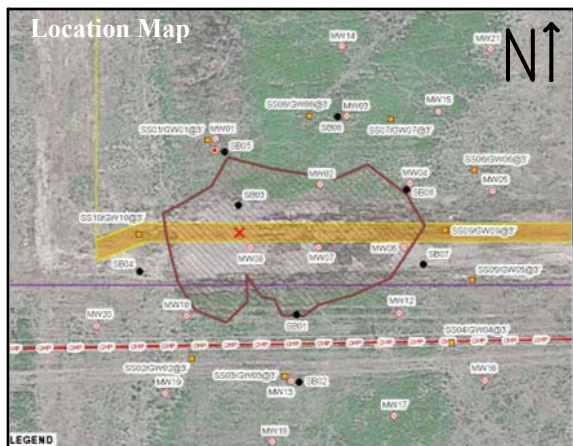

BORING LOG/MONITORING WELL COMPLETION DIAGRAM

PROJECT NAME: Park U-4-9XRLC
PROJECT NO: TE034520034 **LOGGED BY:** Drew Bullinger
BORING/WELL ID: MW18 **SAMPLE METHOD:** Continuous
COMPLETION DATE: 11/10/2020 **DRILL METHOD:** Direct push
TD (ft bgs): 12' **DRILLED BY:** Vine Labs
DTW (ft bgs): 4' **DETECTOR:** ultraRAE 3000
SCREEN SLOT: 0.010" **FILTER PACK:** 10-20 silica sand
CASING LENGTH: 2' **ANNULUS SEAL:** Bentonite chips
SCREEN LENGTH: 10' **SURFACE SEAL:** NA

HOLE DIAMETER: 3.25"

WELL DIAMETER: 1"

CASING TYPE: PVC

SCREEN TYPE: PVC

PID (ppm)	Staining	Moisture Content	Sample ID	Recovery (ft/ft)	Depth (ft)	USCS	USCS Graphic	Lithology Description	Well Construction
0.18		dry			0	SM		0' - 2' - SILTY SAND, brown, fine grained, organics, dry, no staining, no odor	
0.24				2.5/5	2.5	SW		2' - 12' - SAND, brown, well graded, fine to coarse grained, dry to wet at 4' bgs, no stain, no odor, little gravel at 5' bgs	
0.28									
0.40		Wet	MW18 @4'						
0.36					5				
0.32									
0.24				2.5/5					
0.26									
0.30									
0.38					10				
0.35				2/2					
0.31			MW18 @12'						

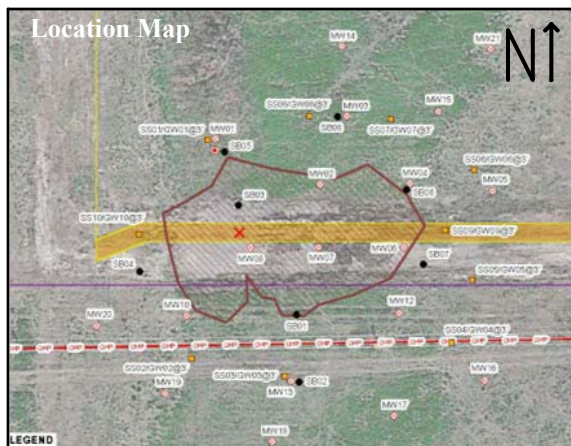

BORING LOG/MONITORING WELL COMPLETION DIAGRAM

PROJECT NAME:	Park U-4-9XRLC		
PROJECT NO:	TE034520034	LOGGED BY:	Drew Bullinger
BORING/WELL ID:	MW19	SAMPLE METHOD:	Continuous
COMPLETION DATE:	11/10/2020	DRILL METHOD:	Direct push
TD (ft bgs):	12'	DRILLED BY:	Vine Labs
DTW (ft bgs):	4'	DETECTOR:	ultraRAE 3000
SCREEN SLOT:	0.010"	FILTER PACK:	10-20 silica sand
CASING LENGTH:	2'	ANNULUS SEAL:	Bentonite chips
SCREEN LENGTH:	10'	SURFACE SEAL:	NA

PID (ppm)	Staining	Moisture Content	Sample ID	Recovery (ft/ft)	Depth (ft)	USCS	USCS Graphic	Lithology Description	Well Construction
		dry			0	SM		0' - 2' - SILTY SAND, grayish brown, fine grained, organics, trace gravel, dry, no staining, no odor	
0.07									
0.09				3/5		SW		2' - 12' - SAND, brown, well graded, fine to coarse grained, dry to wet at 4' bgs, no stain, no odor, layer of fine sand at 9' bgs	
0.12									
0.17		Wet	MW19 @4'						
0.14					5				
0.11									
0.13				2.5/5					
0.09									
0.11									
0.24					10				
0.22				2/2					
0.07			MW19 @12'						

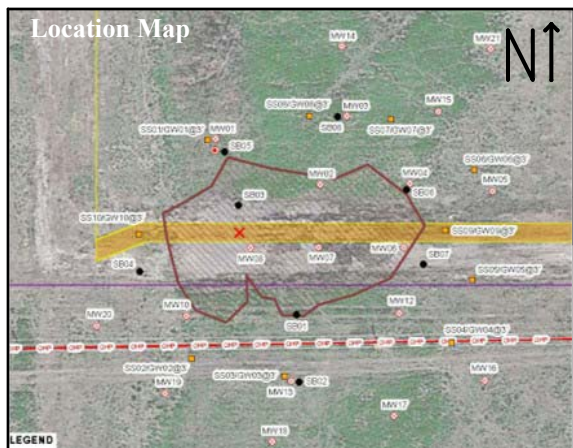

BORING LOG/MONITORING WELL COMPLETION DIAGRAM

PROJECT NAME: Park U-4-9XRLC
PROJECT NO: TE034520034 **LOGGED BY:** Drew Bullinger
BORING/WELL ID: MW20 **SAMPLE METHOD:** Continuous
COMPLETION DATE: 11/10/2020 **DRILL METHOD:** Direct push
TD (ft bgs): 12' **DRILLED BY:** Vine Labs
DTW (ft bgs): 4' **DETECTOR:** ultraRAE 3000
SCREEN SLOT: 0.010" **FILTER PACK:** 10-20 silica sand
CASING LENGTH: 2' **ANNULUS SEAL:** Bentonite chips
SCREEN LENGTH: 10' **SURFACE SEAL:** NA

HOLE DIAMETER: 3.25"

WELL DIAMETER: 1"

CASING TYPE: PVC

SCREEN TYPE: PVC

PID (ppm)	Staining	Moisture Content	Sample ID	Recovery (ft/ft)	Depth (ft)	USCS	USCS Graphic	Lithology Description	Well Construction
0.92		dry			0	SM		0' - 2' - SILTY SAND, brown, fine grained, organics, dry, no staining, no odor	
0.77				3/5		SW		2' - 12' - SAND, brown, well graded, fine to coarse grained, dry to wet at 4' bgs, no stain, no odor	
0.32									
0.50		Wet	MW20 @4'						
0.44					5				
0.36									
0.33				2.5/5					
0.34									
0.32									
0.39					10				
0.42				2/2					
0.43			MW20 @12'						

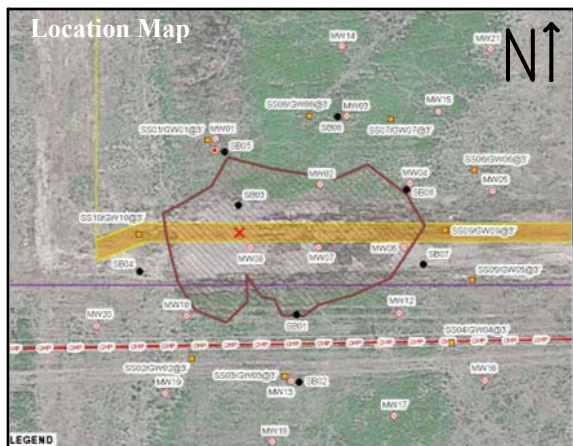

BORING LOG/MONITORING WELL COMPLETION DIAGRAM

PROJECT NAME: Park U-4-9XRLC
PROJECT NO: TE034520034 **LOGGED BY:** Drew Bullinger
BORING/WELL ID: MW21 **SAMPLE METHOD:** Continuous
COMPLETION DATE: 11/10/2020 **DRILL METHOD:** Direct push
TD (ft bgs): 12' **DRILLED BY:** Vine Labs
DTW (ft bgs): 4' **DETECTOR:** ultraRAE 3000
SCREEN SLOT: 0.010" **FILTER PACK:** 10-20 silica sand
CASING LENGTH: 2' **ANNULUS SEAL:** Bentonite chips
SCREEN LENGTH: 10' **SURFACE SEAL:** NA

HOLE DIAMETER: 3.25"

WELL DIAMETER: 1"

CASING TYPE: PVC

SCREEN TYPE: PVC

PID (ppm)	Staining	Moisture Content	Sample ID	Recovery (ft/ft)	Depth (ft)	USCS	USCS Graphic	Lithology Description	Well Construction
7.73		dry			0	SM		0' - 2' - SILTY SAND, grayish brown, fine grained, organics, trace gravel, dry, no staining, no odor	
14.22				3.5/5		SW		2' - 12' - SAND, brown, well graded, fine to coarse grained, trace gravel, dry to wet at 4' bgs, no stain, no odor	
1.96									
0.97		Wet	MW21 @4'						
0.47					5				
1.44									
1.23				2.5/5					
1.11									
1.06									
0.99					10				
1.36				2/2					
1.22			MW21 @12'						

Table 1

Groundwater Analytical Results
Park U-4-9XRLC - Remediation Project # 15983
Bonanza Creek Energy, Inc.
Weld County, Colorado

Sample ID	Sample Date	Depth to Groundwater (feet bgs)	Relative Groundwater Elevation (feet)	Depth to Product (feet bgs)	Product Thickness (feet)	Benzene (µg/L)	Toluene (µg/L)	Ethylbenzene (µg/L)	Total Xylenes (µg/L)	Naphthalene (µg/L)	1,2,4-trimethylbenzene (µg/L)	1,3,5-trimethylbenzene (µg/L)	Chloride (mg/L)	Sulfate (mg/L)	Total Dissolved Solids (mg/L)
COGCC Table 915-1 Cleaup Concentrations						5	560	700	1,400	140	67	67	250 mg/L or <1.25 X local background	250mg/L or <1.25 X local background (*687.5 mg/L)	<1.25 X local background (*1,625 mg/L)
MW01	11/6/2020	2.85	93.18	ND	--	<1.0	<1.0	<1.0	<2.0	--	--	--	--	--	--
	2/5/2021	1.99	94.04	ND	--	<1.0	<1.0	<1.0	<2.0	<1.0	<1.0	<1.0	179	480	577
MW02	11/6/2020	4.50	91.56	2.82	1.68	300	300	<1.0	140	--	--	--	--	--	--
	2/5/2021	2.92	93.14	1.99	0.93	1,200	380	<1.0	500	48	28	53	153	413	532
MW03	11/6/2020	5.10	91.70	3.52	1.58	270	480	<1.0	56	--	--	--	--	--	--
	2/5/2021	3.16	93.64	2.80	0.36	<1.0	<1.0	<1.0	<2.0	<1.0	<1.0	<1.0	119	355	520
MW04	11/6/2020	3.86	92.20	2.77	1.09	1,100	9.6	<1.0	350	Not sampled - free product present			--	--	--
	2/5/2021	3.34	92.72	2.01	1.33								--	--	--
MW05	11/6/2020	4.01	92.89	ND	--	<1.0	<1.0	<1.0	<2.0	--	--	--	--	--	--
	2/5/2021	3.12	93.78	ND	--	<1.0	<1.0	<1.0	<2.0	<1.0	<1.0	<1.0	140	415	512
MW06	11/6/2020	3.12	92.65	2.55	0.57	700	44	<1.0	250	Not sampled - free product present			--	--	--
	2/5/2021	4.04	91.73	1.64	2.40								--	--	--
MW07	11/6/2020	4.57	90.98	2.19	2.38	59	41	<1.0	280	--	--	--	--	--	--
	2/5/2021	3.74	91.81	1.25	2.49					Not sampled - free product present					
MW08	11/6/2020	4.00	91.50	2.13	1.87	11	7.5	<1.0	300	--	--	--	--	--	--
	2/5/2021	3.44	92.06	1.10	2.34					Not sampled - free product present					
MW09	11/12/2020	4.16	91.24	2.01	2.15	16	5.5	<1.0	410	--	--	--	--	--	--
	2/5/2021	2.78	92.62	1.02	1.76	15	3.1	<1.0	350	10	47	47	168	517	615
MW10	11/6/2020	3.41	92.98	3.18	0.23	<1.0	<1.0	<1.0	20	--	--	--	--	--	--
	2/5/2021	2.56	93.83	2.20	0.36	<1.0	<1.0	<1.0	50	<1.0	29	18	163	495	592
MW11	11/12/2020	5.04	91.14	2.91	2.13	11	9.9	<1.0	200	--	--	--	--	--	--
	2/5/2021	3.55	92.63	1.93	1.62	<1.0	<1.0	<1.0	320	2.4	2.3	65	143	432	549

Table 1

Groundwater Analytical Results
Park U-4-9XRLC - Remediation Project # 15983
Bonanza Creek Energy, Inc.
Weld County, Colorado

Sample ID	Sample Date	Depth to Groundwater (feet bgs)	Relative Groundwater Elevation (feet)	Depth to Product (feet bgs)	Product Thickness (feet)	Benzene (µg/L)	Toluene (µg/L)	Ethylbenzene (µg/L)	Total Xylenes (µg/L)	Naphthalene (µg/L)	1,2,4-trimethylbenzene (µg/L)	1,3,5-trimethylbenzene (µg/L)	Chloride (mg/L)	Sulfate (mg/L)	Total Dissolved Solids (mg/L)
COGCC Table 915-1 Cleaup Concentrations						5	560	700	1,400	140	67	67	250 mg/L or <1.25 X local background	250mg/L or <1.25 X local background (*687.5 mg/L)	<1.25 X local background (*1,625 mg/L)
MW12	11/6/2020	5.25	91.09	3.15	2.10	<1.0	<1.0	<1.0	<2.0	--	--	--	--	--	--
	2/5/2021	3.85	92.49	2.33	1.52	Not sampled - free product present									--
MW13	11/6/2020	4.19	92.21	3.28	0.91	<1.0	<1.0	<1.0	<2.0	--	--	--	--	--	--
	2/5/2021	3.41	92.99	2.29	1.12	Not sampled - free product present									--
MW14	11/12/2020	3.45	93.04	ND	--	<1.0	<1.0	<1.0	<2.0	--	--	--	--	--	--
	2/5/2021	2.47	94.02	ND	--	<1.0	<1.0	<1.0	<2.0	<1.0	<1.0	<1.0	146	431	549
MW15	11/12/2020	5.22	91.50	3.54	1.68	150	500	<1.0	1,400	--	--	--	--	--	--
	2/5/2021	3.57	93.15	2.73	0.84	<1.0	<1.0	<1.0	<2.0	<1.0	<1.0	<1.0	150	445	518
MW16	11/12/2020	3.99	92.70	ND	--	<1.0	<1.0	<1.0	<2.0	--	--	--	--	--	--
	2/5/2021	3.08	93.61	ND	--	<1.0	<1.0	<1.0	<2.0	<1.0	<1.0	<1.0	146	433	543
MW17	11/12/2020	3.50	92.86	ND	--	<1.0	<1.0	<1.0	<2.0	--	--	--	--	--	--
	2/5/2021	2.54	93.82	ND	--	<1.0	<1.0	<1.0	<2.0	<1.0	<1.0	<1.0	151	480	587
MW18	11/12/2020	3.30	92.94	ND	--	<1.0	<1.0	<1.0	<2.0	--	--	--	--	--	--
	2/5/2021	2.30	93.94	ND	--	<1.0	<1.0	<1.0	<2.0	<1.0	<1.0	<1.0	158	517	610
MW19	11/12/2020	4.35	93.08	ND	--	<1.0	<1.0	<1.0	<2.0	--	--	--	--	--	--
	2/5/2021	3.29	94.14	ND	--	<1.0	<1.0	<1.0	<2.0	<1.0	<1.0	<1.0	171	545	670
MW20	11/12/2020	4.63	92.97	ND	--	<1.0	<1.0	<1.0	<2.0	--	--	--	--	--	--
	2/5/2021	3.36	94.24	ND	--	<1.0	<1.0	<1.0	<2.0	<1.0	<1.0	<1.0	110	282	567
MW21	11/12/2020	3.85	92.93	ND	--	<1.0	<1.0	<1.0	<2.0	--	--	--	--	--	--
	2/5/2021	2.92	93.86	ND	--	<1.0	<1.0	<1.0	<2.0	<1.0	<1.0	<1.0	148	471	567

Notes:
bgs - below ground surface
µg/L - micrograms per liter
-- - not measured
< - indicates the result is less than laboratory reporting limit
COGCC - Colorado Oil and Gas Conservation Commission
Bold indicates result exceeds the applicable COGCC Table 910-1 Concentration Level
ND - not detected

***Inorganic Background Determination:** In September 2020, WSP USA INC. collected water samples from four existing landowner wells within 0.3 miles of the release area. The samples were uploaded to COGCC with sample IDs 619813, 619814, 619815, and 619816. The highest sulfate and total dissolved solids concentrations were 550 mg/L and 1,300 mg/L, respectively. This establishes the COGCC site specific background standards (1.25 X background) for sulfate and total dissolved solids at 687.5 mg/L and 1,625 mg/L, respectively.

Summit Scientific

4653 Table Mountain Drive, Golden, Colorado 80403

303.277.9310

February 15, 2021

Jeremy Pike

WSP

4600 West 60th Avenue

Arvada, CO 80003

RE: Park U-4-9XRLC

Work Order #2102104

Enclosed are the results of analyses for samples received by Summit Scientific on 02/05/21 18:15. If you have any questions concerning this report, please feel free to contact me.

Sincerely,

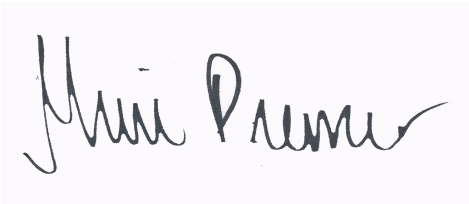
A handwritten signature in black ink, appearing to read "Muri Premier", is displayed on a light purple rectangular background.

Muri Premier For Paul Shrewsbury
President



WSP
4600 West 60th Avenue
Arvada CO, 80003

Project: Park U-4-9XRLC
Project Number: 034520034
Project Manager: Jeremy Pike

Reported:
02/15/21 16:19

ANALYTICAL REPORT FOR SAMPLES

Sample ID	Laboratory ID	Matrix	Date Sampled	Date Received
MW01	2102104-01	Water	02/05/21 16:24	02/05/21 18:15
MW02	2102104-02	Water	02/05/21 16:03	02/05/21 18:15
MW03	2102104-03	Water	02/05/21 13:37	02/05/21 18:15
MW05	2102104-04	Water	02/05/21 14:40	02/05/21 18:15
MW09	2102104-05	Water	02/05/21 11:43	02/05/21 18:15
MW10	2102104-06	Water	02/05/21 15:16	02/05/21 18:15
MW11	2102104-07	Water	02/05/21 14:54	02/05/21 18:15
MW21	2102104-08	Water	02/05/21 13:57	02/05/21 18:15
MW14	2102104-09	Water	02/05/21 13:18	02/05/21 18:15
MW15	2102104-10	Water	02/05/21 14:20	02/05/21 18:15
MW16	2102104-11	Water	02/05/21 16:26	02/05/21 18:15
MW17	2102104-12	Water	02/05/21 16:12	02/05/21 18:15
MW18	2102104-13	Water	02/05/21 16:00	02/05/21 18:15
MW19	2102104-14	Water	02/05/21 16:40	02/05/21 18:15
MW20	2102104-15	Water	02/05/21 16:39	02/05/21 18:15

Summit Scientific

The results in this report apply to the samples analyzed in accordance with the chain of custody document. This analytical report must be reproduced in its entirety.

Summit Scientific

2102104.1

741 Corporate Circle Suite I ♦ Golden, Colorado 80401
303-277-9310 ♦ 303-374-5933 Fax

Page 1 of 2

Client: WSP
Address: 4600 West 60th Ave
City/State/Zip: Arvada, CO 80003
Phone: 303-433-9788 Fax: 303-433-1432
Sampler Name: Drew B / niko W

Project Manager: Jeremy Pike
E-Mail: jeremy.pike@wsp.com
Project Name: Park U-4-9XRLC
Project Number: TE034520034

Sample Description	Date Sampled	Time Sampled	Number of Containers	Preservative				Matrix			Analyze For:							Special Instructions	
				HCl	HNO ₃	None	Other (Specify)	Groundwater	Soil	Air - Canister Serial #	Other (Specify)	BTEX	naphthalene	1,2,4-trimethylbenz	1,3,5-trimethylbenz	TDS	Chloride		Sulfate
MW01	02/05/21	16:24	4			✓		✓				✓	✓	✓	✓	✓	✓		
MW02		16:03																	
MW03		13:37																	
MW04																			
MW05		19:40																	
MW06																			
MW07																			
MW08																			
MW09		11:43																	
MW10		15:16																	

Relinquished by: <i>Drew Burkling</i>	Date/Time: 2/5/21 18:15	Received by: <i>[Signature]</i>	Date/Time: 2-5-21 18:15	Turn Around Time (Check) Same Day <input type="checkbox"/> 24 Hours <input type="checkbox"/> 48 Hours <input type="checkbox"/>	72 Hours <input type="checkbox"/> Standard <input checked="" type="checkbox"/>	Notes:
Relinquished by:	Date/Time:	Received by:	Date/Time:	Sample Integrity: Temperature Upon Receipt: <u>1.3</u>		
Relinquished by:	Date/Time:	Received in Lab by:	Date/Time:	Intact: Yes <input checked="" type="checkbox"/> No <input type="checkbox"/>		

Summit Scientific

2102104.2

741 Corporate Circle Suite I ♦ Golden, Colorado 80401
303-277-9310 ♦ 303-374-5933 Fax

Page 2 of 2

Client: WSP
Address: 4600 West 60th Ave
City/State/Zip: Arvada, CO 80003
Phone: 303-433-9788 Fax: 303-433-1432
Sampler Name: Drew B / Hiko W

Project Manager: Jeremy Pike
E-Mail: jeremy.pike@wsp.com
Project Name: Park U-4-9XRLC
Project Number: TE034520034

Sample Description	Date Sampled	Time Sampled	Number of Containers	Preservative				Matrix				Analyze For:								Special Instructions
				HCl	HNO ₃	None	Other (Specify)	Groundwater	Soil	Air - Canister Serial #	Other (Specify)	BTEX	naphthalene	1,2,4-trimethylbenz	1,3,5-trimethylbenz	TDS	Chloride	Sulfate		
MW11	02/05/21	14:54	4			✓		X					✓	✓	✓	✓	✓	✓		
MW12																				
MW13 / MW21		13:57																		
MW14		13:18																		
MW15		14:20																		
MW16		16:26																		
MW17		16:12																		
MW18		16:00																		
MW19		16:40																		
MW20		16:39																		

Relinquished by: <u>Drew Bullock</u>	Date/Time: <u>2/5/21 18:15</u>	Received by: <u>AS 2-5-21 18:15</u>	Date/Time: <u></u>	Turn Around Time (Check) Same Day <input type="checkbox"/> 72 Hours <input type="checkbox"/> 24 Hours <input type="checkbox"/> Standard <input checked="" type="checkbox"/> 48 Hours <input type="checkbox"/>	Notes:
Relinquished by:	Date/Time:	Received by:	Date/Time:	Sample Integrity: Temperature Upon Receipt: <u>13</u> Intact: Yes <input checked="" type="checkbox"/> No <input type="checkbox"/>	
Relinquished by:	Date/Time:	Received in Lab by:	Date/Time:		

Sample Receipt Checklist

2102104

S2 Work Order _____

Client: WSP Client Project ID: Park U-4-9XRLC

Shipped Via: FD P.U./FedEx/UPS/USPS/Other _____ Airbill #: _____

Matrix (check all that apply): _____ Air _____ Soil/Solid X Water _____ Other: _____
(Describe)

Temp (°C)	1.3
-----------	-----

Thermometer ID: 61857155-K

	Yes	No	N/A	Comments (if any)
If samples require cooling, was the temperature at 4°C +/- 2°C ⁽¹⁾ ? NOTE: If samples are delivered the same day of sampling, this requirement is met provided that there is evidence that cooling has begun.	<u>—</u>			on ice
Were all samples received intact ⁽¹⁾ ?	<u>—</u>			
Was adequate sample volume provided ⁽¹⁾ ?	<u>—</u>			
If custody seals are present, are they intact ⁽¹⁾ ?			<u>—</u>	
Are samples with holding times due within 48 hours sample due within 48 hours present?			<u>—</u>	
Is a chain-of-custody (COC) form present and filled out completely ⁽¹⁾ ?	<u>—</u>			
Does the COC agree with the number and type of sample bottles received ⁽¹⁾ ?	<u>—</u>			
Do the sample IDs on the bottle labels match the COC ⁽¹⁾ ?	<u>—</u>			
Is the COC properly relinquished by the client w/ date and time recorded ⁽¹⁾ ?	<u>—</u>			
For volatiles in water – is there headspace present? If yes, contact client and note in narrative.		<u>—</u>		
Are samples preserved that require preservation (excluding cooling) ⁽¹⁾ ? Note the type of preservative in the Comments column – HCl, H2SO4, NaOH, HNO3, ect			<u>—</u>	
If samples are acid preserved for metals, is the pH ≤ 2 ⁽¹⁾ ? Record the pH in Comments.			<u>—</u>	
If dissolved metals are requested, were samples field filtered?			<u>—</u>	
Additional Comments (if any):				

⁽¹⁾ If NO, then contact the client before proceeding with analysis and note in case narrative.

LS
Custodian Printed Name or Initials

[Signature]
Signature of Custodian

2.5.21
Date/Time



WSP
4600 West 60th Avenue
Arvada CO, 80003

Project: Park U-4-9XRLC
Project Number: 034520034
Project Manager: Jeremy Pike

Reported:
02/15/21 16:19

MW01
2102104-01 (Water)

Summit Scientific

Volatile Organic Compounds by EPA Method 8260B

Date Sampled: **02/05/21 16:24**

Analyte	Result	Reporting		Units	Dilution	Batch	Prepared	Analyzed	Method	Notes
		Limit								
Benzene	ND	1.0		ug/l	1	BEB0119	02/08/21	02/09/21	EPA 8260B	
Toluene	ND	1.0		"	"	"	"	"	"	
Ethylbenzene	ND	1.0		"	"	"	"	"	"	
Xylenes (total)	ND	2.0		"	"	"	"	"	"	
Naphthalene	ND	1.0		"	"	"	"	"	"	
1,2,4-Trimethylbenzene	ND	1.0		"	"	"	"	"	"	
1,3,5-Trimethylbenzene	ND	1.0		"	"	"	"	"	"	

Date Sampled: **02/05/21 16:24**

Analyte	Result	Reporting		Units	Dilution	Batch	Prepared	Analyzed	Method	Notes
		Limit								
Surrogate: 1,2-Dichloroethane-d4		85.9 %		23-173		"	"	"	"	
Surrogate: Toluene-d8		102 %		20-170		"	"	"	"	
Surrogate: 4-Bromofluorobenzene		101 %		21-167		"	"	"	"	

Anions by EPA Method 300.0

Date Sampled: **02/05/21 16:24**

Analyte	Result	Reporting		Units	Dilution	Batch	Prepared	Analyzed	Method	Notes
		Limit								
Chloride	179	12.0		mg/L	200	BEB0150	02/10/21	02/10/21	EPA 300.0	
Sulfate	480	60.0		"	"	"	"	"	"	

Total Dissolved Solids by SM2540C

Date Sampled: **02/05/21 16:24**

Analyte	Result	Reporting		Units	Dilution	Batch	Prepared	Analyzed	Method	Notes
		Limit								
Total Dissolved Solids	577	10.0		mg/L	1	BEB0196	02/12/21	02/12/21	SM2540C	

Summit Scientific

The results in this report apply to the samples analyzed in accordance with the chain of custody document. This analytical report must be reproduced in its entirety.



WSP
4600 West 60th Avenue
Arvada CO, 80003

Project: Park U-4-9XRLC
Project Number: 034520034
Project Manager: Jeremy Pike

Reported:
02/15/21 16:19

MW02
2102104-02 (Water)

Summit Scientific

Volatile Organic Compounds by EPA Method 8260B

Date Sampled: **02/05/21 16:03**

Analyte	Result	Reporting Limit	Units	Dilution	Batch	Prepared	Analyzed	Method	Notes
Benzene	1200	10	ug/l	10	BEB0119	02/08/21	02/09/21	EPA 8260B	
Toluene	380	10	"	"	"	"	"	"	
Ethylbenzene	ND	1.0	"	1	"	"	"	"	
Xylenes (total)	500	20	"	10	"	"	"	"	
Naphthalene	48	1.0	"	1	"	"	"	"	
1,2,4-Trimethylbenzene	28	10	"	10	"	"	"	"	
1,3,5-Trimethylbenzene	53	10	"	"	"	"	"	"	

Date Sampled: **02/05/21 16:03**

Analyte	Result	Reporting Limit	Units	Dilution	Batch	Prepared	Analyzed	Method	Notes
Surrogate: 1,2-Dichloroethane-d4		88.4 %	23-173		"	"	"	"	
Surrogate: Toluene-d8		103 %	20-170		"	"	"	"	
Surrogate: 4-Bromofluorobenzene		100 %	21-167		"	"	"	"	

Anions by EPA Method 300.0

Date Sampled: **02/05/21 16:03**

Analyte	Result	Reporting Limit	Units	Dilution	Batch	Prepared	Analyzed	Method	Notes
Chloride	153	12.0	mg/L	200	BEB0150	02/10/21	02/10/21	EPA 300.0	
Sulfate	413	60.0	"	"	"	"	"	"	

Total Dissolved Solids by SM2540C

Date Sampled: **02/05/21 16:03**

Analyte	Result	Reporting Limit	Units	Dilution	Batch	Prepared	Analyzed	Method	Notes
Total Dissolved Solids	532	10.0	mg/L	1	BEB0196	02/12/21	02/12/21	SM2540C	

Summit Scientific

The results in this report apply to the samples analyzed in accordance with the chain of custody document. This analytical report must be reproduced in its entirety.



WSP
4600 West 60th Avenue
Arvada CO, 80003

Project: Park U-4-9XRLC
Project Number: 034520034
Project Manager: Jeremy Pike

Reported:
02/15/21 16:19

MW03
2102104-03 (Water)

Summit Scientific

Volatile Organic Compounds by EPA Method 8260B

Date Sampled: **02/05/21 13:37**

Analyte	Result	Reporting		Units	Dilution	Batch	Prepared	Analyzed	Method	Notes
		Limit								
Benzene	ND	1.0		ug/l	1	BEB0119	02/08/21	02/09/21	EPA 8260B	
Toluene	ND	1.0		"	"	"	"	"	"	
Ethylbenzene	ND	1.0		"	"	"	"	"	"	
Xylenes (total)	ND	2.0		"	"	"	"	"	"	
Naphthalene	ND	1.0		"	"	"	"	"	"	
1,2,4-Trimethylbenzene	ND	1.0		"	"	"	"	"	"	
1,3,5-Trimethylbenzene	ND	1.0		"	"	"	"	"	"	

Date Sampled: **02/05/21 13:37**

Analyte	Result	Reporting		Units	Dilution	Batch	Prepared	Analyzed	Method	Notes
		Limit								
Surrogate: 1,2-Dichloroethane-d4		85.0 %		23-173		"	"	"	"	
Surrogate: Toluene-d8		103 %		20-170		"	"	"	"	
Surrogate: 4-Bromofluorobenzene		101 %		21-167		"	"	"	"	

Anions by EPA Method 300.0

Date Sampled: **02/05/21 13:37**

Analyte	Result	Reporting		Units	Dilution	Batch	Prepared	Analyzed	Method	Notes
		Limit								
Sulfate	355	60.0		mg/L	200	BEB0150	02/10/21	02/10/21	EPA 300.0	
Chloride	119	12.0		"	"	"	"	"	"	

Total Dissolved Solids by SM2540C

Date Sampled: **02/05/21 13:37**

Analyte	Result	Reporting		Units	Dilution	Batch	Prepared	Analyzed	Method	Notes
		Limit								
Total Dissolved Solids	520	10.0		mg/L	1	BEB0196	02/12/21	02/12/21	SM2540C	

Summit Scientific

The results in this report apply to the samples analyzed in accordance with the chain of custody document. This analytical report must be reproduced in its entirety.



WSP
4600 West 60th Avenue
Arvada CO, 80003

Project: Park U-4-9XRLC
Project Number: 034520034
Project Manager: Jeremy Pike

Reported:
02/15/21 16:19

MW05
2102104-04 (Water)

Summit Scientific

Volatile Organic Compounds by EPA Method 8260B

Date Sampled: **02/05/21 14:40**

Analyte	Result	Reporting		Units	Dilution	Batch	Prepared	Analyzed	Method	Notes
		Limit								
Benzene	ND	1.0		ug/l	1	BEB0119	02/08/21	02/09/21	EPA 8260B	
Toluene	ND	1.0		"	"	"	"	"	"	
Ethylbenzene	ND	1.0		"	"	"	"	"	"	
Xylenes (total)	ND	2.0		"	"	"	"	"	"	
Naphthalene	ND	1.0		"	"	"	"	"	"	
1,2,4-Trimethylbenzene	ND	1.0		"	"	"	"	"	"	
1,3,5-Trimethylbenzene	ND	1.0		"	"	"	"	"	"	

Date Sampled: **02/05/21 14:40**

Analyte	Result	Reporting		Units	Dilution	Batch	Prepared	Analyzed	Method	Notes
		Limit								
Surrogate: 1,2-Dichloroethane-d4		85.1 %		23-173		"	"	"	"	
Surrogate: Toluene-d8		102 %		20-170		"	"	"	"	
Surrogate: 4-Bromofluorobenzene		98.7 %		21-167		"	"	"	"	

Anions by EPA Method 300.0

Date Sampled: **02/05/21 14:40**

Analyte	Result	Reporting		Units	Dilution	Batch	Prepared	Analyzed	Method	Notes
		Limit								
Sulfate	415	60.0		mg/L	200	BEB0150	02/10/21	02/10/21	EPA 300.0	
Chloride	140	12.0		"	"	"	"	"	"	

Total Dissolved Solids by SM2540C

Date Sampled: **02/05/21 14:40**

Analyte	Result	Reporting		Units	Dilution	Batch	Prepared	Analyzed	Method	Notes
		Limit								
Total Dissolved Solids	512	10.0		mg/L	1	BEB0196	02/12/21	02/12/21	SM2540C	

Summit Scientific

The results in this report apply to the samples analyzed in accordance with the chain of custody document. This analytical report must be reproduced in its entirety.



WSP
4600 West 60th Avenue
Arvada CO, 80003

Project: Park U-4-9XRLC
Project Number: 034520034
Project Manager: Jeremy Pike

Reported:
02/15/21 16:19

MW09
2102104-05 (Water)

Summit Scientific

Volatile Organic Compounds by EPA Method 8260B

Date Sampled: **02/05/21 11:43**

Analyte	Result	Reporting Limit	Units	Dilution	Batch	Prepared	Analyzed	Method	Notes
Benzene	15	1.0	ug/l	1	BEB0119	02/08/21	02/09/21	EPA 8260B	
Toluene	3.1	1.0	"	"	"	"	"	"	
Ethylbenzene	ND	1.0	"	"	"	"	"	"	
Xylenes (total)	350	2.0	"	"	"	"	"	"	
Naphthalene	10	1.0	"	"	"	"	"	"	
1,2,4-Trimethylbenzene	47	1.0	"	"	"	"	"	"	
1,3,5-Trimethylbenzene	47	1.0	"	"	"	"	"	"	

Date Sampled: **02/05/21 11:43**

Analyte	Result	Reporting Limit	Units	Dilution	Batch	Prepared	Analyzed	Method	Notes
Surrogate: 1,2-Dichloroethane-d4		92.6 %	23-173		"	"	"	"	
Surrogate: Toluene-d8		105 %	20-170		"	"	"	"	
Surrogate: 4-Bromofluorobenzene		108 %	21-167		"	"	"	"	

Anions by EPA Method 300.0

Date Sampled: **02/05/21 11:43**

Analyte	Result	Reporting Limit	Units	Dilution	Batch	Prepared	Analyzed	Method	Notes
Sulfate	517	60.0	mg/L	200	BEB0150	02/10/21	02/10/21	EPA 300.0	
Chloride	168	12.0	"	"	"	"	"	"	

Total Dissolved Solids by SM2540C

Date Sampled: **02/05/21 11:43**

Analyte	Result	Reporting Limit	Units	Dilution	Batch	Prepared	Analyzed	Method	Notes
Total Dissolved Solids	615	10.0	mg/L	1	BEB0196	02/12/21	02/12/21	SM2540C	

Summit Scientific

The results in this report apply to the samples analyzed in accordance with the chain of custody document. This analytical report must be reproduced in its entirety.



WSP
4600 West 60th Avenue
Arvada CO, 80003

Project: Park U-4-9XRLC
Project Number: 034520034
Project Manager: Jeremy Pike

Reported:
02/15/21 16:19

MW10
2102104-06 (Water)

Summit Scientific

Volatile Organic Compounds by EPA Method 8260B

Date Sampled: **02/05/21 15:16**

Analyte	Result	Reporting	Units	Dilution	Batch	Prepared	Analyzed	Method	Notes
		Limit							
Benzene	ND	1.0	ug/l	1	BEB0119	02/08/21	02/09/21	EPA 8260B	
Toluene	ND	1.0	"	"	"	"	"	"	
Ethylbenzene	ND	1.0	"	"	"	"	"	"	
Xylenes (total)	50	2.0	"	"	"	"	"	"	
Naphthalene	ND	1.0	"	"	"	"	"	"	
1,2,4-Trimethylbenzene	29	1.0	"	"	"	"	"	"	
1,3,5-Trimethylbenzene	18	1.0	"	"	"	"	"	"	

Date Sampled: **02/05/21 15:16**

Analyte	Result	Reporting	Units	Dilution	Batch	Prepared	Analyzed	Method	Notes
		Limit							
Surrogate: 1,2-Dichloroethane-d4		88.1 %	23-173		"	"	"	"	
Surrogate: Toluene-d8		101 %	20-170		"	"	"	"	
Surrogate: 4-Bromofluorobenzene		107 %	21-167		"	"	"	"	

Anions by EPA Method 300.0

Date Sampled: **02/05/21 15:16**

Analyte	Result	Reporting	Units	Dilution	Batch	Prepared	Analyzed	Method	Notes
		Limit							
Sulfate	495	60.0	mg/L	200	BEB0150	02/10/21	02/10/21	EPA 300.0	
Chloride	163	12.0	"	"	"	"	"	"	

Total Dissolved Solids by SM2540C

Date Sampled: **02/05/21 15:16**

Analyte	Result	Reporting	Units	Dilution	Batch	Prepared	Analyzed	Method	Notes
		Limit							
Total Dissolved Solids	592	10.0	mg/L	1	BEB0196	02/12/21	02/12/21	SM2540C	

Summit Scientific

The results in this report apply to the samples analyzed in accordance with the chain of custody document. This analytical report must be reproduced in its entirety.



WSP
4600 West 60th Avenue
Arvada CO, 80003

Project: Park U-4-9XRLC
Project Number: 034520034
Project Manager: Jeremy Pike

Reported:
02/15/21 16:19

MW11
2102104-07 (Water)

Summit Scientific

Volatile Organic Compounds by EPA Method 8260B

Date Sampled: **02/05/21 14:54**

Analyte	Result	Reporting	Units	Dilution	Batch	Prepared	Analyzed	Method	Notes
		Limit							
Benzene	ND	1.0	ug/l	1	BEB0119	02/08/21	02/09/21	EPA 8260B	
Toluene	ND	1.0	"	"	"	"	"	"	
Ethylbenzene	ND	1.0	"	"	"	"	"	"	
Xylenes (total)	320	20	"	10	"	"	"	"	
Naphthalene	2.4	1.0	"	1	"	"	"	"	
1,2,4-Trimethylbenzene	2.3	1.0	"	"	"	"	"	"	
1,3,5-Trimethylbenzene	65	1.0	"	"	"	"	"	"	

Date Sampled: **02/05/21 14:54**

Analyte	Result	Reporting	Units	Dilution	Batch	Prepared	Analyzed	Method	Notes
		Limit							
Surrogate: 1,2-Dichloroethane-d4		88.7 %	23-173		"	"	"	"	
Surrogate: Toluene-d8		104 %	20-170		"	"	"	"	
Surrogate: 4-Bromofluorobenzene		103 %	21-167		"	"	"	"	

Anions by EPA Method 300.0

Date Sampled: **02/05/21 14:54**

Analyte	Result	Reporting	Units	Dilution	Batch	Prepared	Analyzed	Method	Notes
		Limit							
Sulfate	432	60.0	mg/L	200	BEB0150	02/10/21	02/10/21	EPA 300.0	
Chloride	143	12.0	"	"	"	"	"	"	

Total Dissolved Solids by SM2540C

Date Sampled: **02/05/21 14:54**

Analyte	Result	Reporting	Units	Dilution	Batch	Prepared	Analyzed	Method	Notes
		Limit							
Total Dissolved Solids	549	10.0	mg/L	1	BEB0196	02/12/21	02/12/21	SM2540C	

Summit Scientific

The results in this report apply to the samples analyzed in accordance with the chain of custody document. This analytical report must be reproduced in its entirety.



WSP
4600 West 60th Avenue
Arvada CO, 80003

Project: Park U-4-9XRLC
Project Number: 034520034
Project Manager: Jeremy Pike

Reported:
02/15/21 16:19

MW21
2102104-08 (Water)

Summit Scientific

Volatile Organic Compounds by EPA Method 8260B

Date Sampled: **02/05/21 13:57**

Analyte	Result	Reporting		Units	Dilution	Batch	Prepared	Analyzed	Method	Notes
		Limit								
Benzene	ND	1.0		ug/l	1	BEB0119	02/08/21	02/09/21	EPA 8260B	
Toluene	ND	1.0		"	"	"	"	"	"	
Ethylbenzene	ND	1.0		"	"	"	"	"	"	
Xylenes (total)	ND	2.0		"	"	"	"	"	"	
Naphthalene	ND	1.0		"	"	"	"	"	"	
1,2,4-Trimethylbenzene	ND	1.0		"	"	"	"	"	"	
1,3,5-Trimethylbenzene	ND	1.0		"	"	"	"	"	"	

Date Sampled: **02/05/21 13:57**

Analyte	Result	Reporting		Units	Dilution	Batch	Prepared	Analyzed	Method	Notes
		Limit								
Surrogate: 1,2-Dichloroethane-d4		87.5 %		23-173		"	"	"	"	
Surrogate: Toluene-d8		102 %		20-170		"	"	"	"	
Surrogate: 4-Bromofluorobenzene		99.5 %		21-167		"	"	"	"	

Anions by EPA Method 300.0

Date Sampled: **02/05/21 13:57**

Analyte	Result	Reporting		Units	Dilution	Batch	Prepared	Analyzed	Method	Notes
		Limit								
Chloride	148	12.0		mg/L	200	BEB0150	02/10/21	02/10/21	EPA 300.0	
Sulfate	471	60.0		"	"	"	"	"	"	

Total Dissolved Solids by SM2540C

Date Sampled: **02/05/21 13:57**

Analyte	Result	Reporting		Units	Dilution	Batch	Prepared	Analyzed	Method	Notes
		Limit								
Total Dissolved Solids	567	10.0		mg/L	1	BEB0196	02/12/21	02/12/21	SM2540C	

Summit Scientific

The results in this report apply to the samples analyzed in accordance with the chain of custody document. This analytical report must be reproduced in its entirety.



WSP
4600 West 60th Avenue
Arvada CO, 80003

Project: Park U-4-9XRLC
Project Number: 034520034
Project Manager: Jeremy Pike

Reported:
02/15/21 16:19

MW14
2102104-09 (Water)

Summit Scientific

Volatile Organic Compounds by EPA Method 8260B

Date Sampled: **02/05/21 13:18**

Analyte	Result	Reporting	Units	Dilution	Batch	Prepared	Analyzed	Method	Notes
		Limit							
Benzene	ND	1.0	ug/l	1	BEB0119	02/08/21	02/09/21	EPA 8260B	
Toluene	ND	1.0	"	"	"	"	"	"	
Ethylbenzene	ND	1.0	"	"	"	"	"	"	
Xylenes (total)	ND	2.0	"	"	"	"	"	"	
Naphthalene	ND	1.0	"	"	"	"	"	"	
1,2,4-Trimethylbenzene	ND	1.0	"	"	"	"	"	"	
1,3,5-Trimethylbenzene	ND	1.0	"	"	"	"	"	"	

Date Sampled: **02/05/21 13:18**

Analyte	Result	Reporting	Units	Dilution	Batch	Prepared	Analyzed	Method	Notes
		Limit							
Surrogate: 1,2-Dichloroethane-d4		88.3 %	23-173		"	"	"	"	
Surrogate: Toluene-d8		102 %	20-170		"	"	"	"	
Surrogate: 4-Bromofluorobenzene		98.8 %	21-167		"	"	"	"	

Anions by EPA Method 300.0

Date Sampled: **02/05/21 13:18**

Analyte	Result	Reporting	Units	Dilution	Batch	Prepared	Analyzed	Method	Notes
		Limit							
Sulfate	431	60.0	mg/L	200	BEB0150	02/10/21	02/10/21	EPA 300.0	
Chloride	146	12.0	"	"	"	"	"	"	

Total Dissolved Solids by SM2540C

Date Sampled: **02/05/21 13:18**

Analyte	Result	Reporting	Units	Dilution	Batch	Prepared	Analyzed	Method	Notes
		Limit							
Total Dissolved Solids	549	10.0	mg/L	1	BEB0196	02/12/21	02/12/21	SM2540C	

Summit Scientific

The results in this report apply to the samples analyzed in accordance with the chain of custody document. This analytical report must be reproduced in its entirety.



WSP
4600 West 60th Avenue
Arvada CO, 80003

Project: Park U-4-9XRLC
Project Number: 034520034
Project Manager: Jeremy Pike

Reported:
02/15/21 16:19

MW15
2102104-10 (Water)

Summit Scientific

Volatile Organic Compounds by EPA Method 8260B

Date Sampled: **02/05/21 14:20**

Analyte	Result	Reporting		Units	Dilution	Batch	Prepared	Analyzed	Method	Notes
		Limit								
Benzene	ND	1.0		ug/l	1	BEB0119	02/08/21	02/09/21	EPA 8260B	
Toluene	ND	1.0		"	"	"	"	"	"	
Ethylbenzene	ND	1.0		"	"	"	"	"	"	
Xylenes (total)	ND	2.0		"	"	"	"	"	"	
Naphthalene	ND	1.0		"	"	"	"	"	"	
1,2,4-Trimethylbenzene	ND	1.0		"	"	"	"	"	"	
1,3,5-Trimethylbenzene	ND	1.0		"	"	"	"	"	"	

Date Sampled: **02/05/21 14:20**

Analyte	Result	Reporting		Units	Dilution	Batch	Prepared	Analyzed	Method	Notes
		Limit								
Surrogate: 1,2-Dichloroethane-d4		87.9 %		23-173		"	"	"	"	
Surrogate: Toluene-d8		102 %		20-170		"	"	"	"	
Surrogate: 4-Bromofluorobenzene		99.4 %		21-167		"	"	"	"	

Anions by EPA Method 300.0

Date Sampled: **02/05/21 14:20**

Analyte	Result	Reporting		Units	Dilution	Batch	Prepared	Analyzed	Method	Notes
		Limit								
Chloride	150	12.0		mg/L	200	BEB0150	02/10/21	02/10/21	EPA 300.0	
Sulfate	445	60.0		"	"	"	"	"	"	

Total Dissolved Solids by SM2540C

Date Sampled: **02/05/21 14:20**

Analyte	Result	Reporting		Units	Dilution	Batch	Prepared	Analyzed	Method	Notes
		Limit								
Total Dissolved Solids	518	10.0		mg/L	1	BEB0196	02/12/21	02/12/21	SM2540C	

Summit Scientific

The results in this report apply to the samples analyzed in accordance with the chain of custody document. This analytical report must be reproduced in its entirety.



WSP
4600 West 60th Avenue
Arvada CO, 80003

Project: Park U-4-9XRLC
Project Number: 034520034
Project Manager: Jeremy Pike

Reported:
02/15/21 16:19

MW16
2102104-11 (Water)

Summit Scientific

Volatile Organic Compounds by EPA Method 8260B

Date Sampled: **02/05/21 16:26**

Analyte	Result	Reporting		Units	Dilution	Batch	Prepared	Analyzed	Method	Notes
		Limit								
Benzene	ND	1.0		ug/l	1	BEB0119	02/08/21	02/09/21	EPA 8260B	
Toluene	ND	1.0		"	"	"	"	"	"	
Ethylbenzene	ND	1.0		"	"	"	"	"	"	
Xylenes (total)	ND	2.0		"	"	"	"	"	"	
Naphthalene	ND	1.0		"	"	"	"	"	"	
1,2,4-Trimethylbenzene	ND	1.0		"	"	"	"	"	"	
1,3,5-Trimethylbenzene	ND	1.0		"	"	"	"	"	"	

Date Sampled: **02/05/21 16:26**

Analyte	Result	Reporting		Units	Dilution	Batch	Prepared	Analyzed	Method	Notes
		Limit								
Surrogate: 1,2-Dichloroethane-d4		89.8 %		23-173		"	"	"	"	
Surrogate: Toluene-d8		98.6 %		20-170		"	"	"	"	
Surrogate: 4-Bromofluorobenzene		101 %		21-167		"	"	"	"	

Anions by EPA Method 300.0

Date Sampled: **02/05/21 16:26**

Analyte	Result	Reporting		Units	Dilution	Batch	Prepared	Analyzed	Method	Notes
		Limit								
Sulfate	433	60.0		mg/L	200	BEB0150	02/10/21	02/10/21	EPA 300.0	
Chloride	146	12.0		"	"	"	"	"	"	

Total Dissolved Solids by SM2540C

Date Sampled: **02/05/21 16:26**

Analyte	Result	Reporting		Units	Dilution	Batch	Prepared	Analyzed	Method	Notes
		Limit								
Total Dissolved Solids	543	10.0		mg/L	1	BEB0196	02/12/21	02/12/21	SM2540C	

Summit Scientific

The results in this report apply to the samples analyzed in accordance with the chain of custody document. This analytical report must be reproduced in its entirety.



WSP
4600 West 60th Avenue
Arvada CO, 80003

Project: Park U-4-9XRLC
Project Number: 034520034
Project Manager: Jeremy Pike

Reported:
02/15/21 16:19

MW17
2102104-12 (Water)

Summit Scientific

Volatile Organic Compounds by EPA Method 8260B

Date Sampled: **02/05/21 16:12**

Analyte	Result	Reporting		Units	Dilution	Batch	Prepared	Analyzed	Method	Notes
		Limit								
Benzene	ND	1.0		ug/l	1	BEB0119	02/08/21	02/09/21	EPA 8260B	
Toluene	ND	1.0		"	"	"	"	"	"	
Ethylbenzene	ND	1.0		"	"	"	"	"	"	
Xylenes (total)	ND	2.0		"	"	"	"	"	"	
Naphthalene	ND	1.0		"	"	"	"	"	"	
1,2,4-Trimethylbenzene	ND	1.0		"	"	"	"	"	"	
1,3,5-Trimethylbenzene	ND	1.0		"	"	"	"	"	"	

Date Sampled: **02/05/21 16:12**

Analyte	Result	Reporting		Units	Dilution	Batch	Prepared	Analyzed	Method	Notes
		Limit								
Surrogate: 1,2-Dichloroethane-d4		91.3 %		23-173		"	"	"	"	
Surrogate: Toluene-d8		105 %		20-170		"	"	"	"	
Surrogate: 4-Bromofluorobenzene		102 %		21-167		"	"	"	"	

Anions by EPA Method 300.0

Date Sampled: **02/05/21 16:12**

Analyte	Result	Reporting		Units	Dilution	Batch	Prepared	Analyzed	Method	Notes
		Limit								
Sulfate	480	60.0		mg/L	200	BEB0150	02/10/21	02/10/21	EPA 300.0	
Chloride	151	12.0		"	"	"	"	"	"	

Total Dissolved Solids by SM2540C

Date Sampled: **02/05/21 16:12**

Analyte	Result	Reporting		Units	Dilution	Batch	Prepared	Analyzed	Method	Notes
		Limit								
Total Dissolved Solids	587	10.0		mg/L	1	BEB0196	02/12/21	02/12/21	SM2540C	

Summit Scientific

The results in this report apply to the samples analyzed in accordance with the chain of custody document. This analytical report must be reproduced in its entirety.



WSP
4600 West 60th Avenue
Arvada CO, 80003

Project: Park U-4-9XRLC
Project Number: 034520034
Project Manager: Jeremy Pike

Reported:
02/15/21 16:19

MW18
2102104-13 (Water)

Summit Scientific

Volatile Organic Compounds by EPA Method 8260B

Date Sampled: **02/05/21 16:00**

Analyte	Result	Reporting		Units	Dilution	Batch	Prepared	Analyzed	Method	Notes
		Limit								
Benzene	ND	1.0		ug/l	1	BEB0119	02/08/21	02/09/21	EPA 8260B	
Toluene	ND	1.0		"	"	"	"	"	"	
Ethylbenzene	ND	1.0		"	"	"	"	"	"	
Xylenes (total)	ND	2.0		"	"	"	"	"	"	
Naphthalene	ND	1.0		"	"	"	"	"	"	
1,2,4-Trimethylbenzene	ND	1.0		"	"	"	"	"	"	
1,3,5-Trimethylbenzene	ND	1.0		"	"	"	"	"	"	

Date Sampled: **02/05/21 16:00**

Analyte	Result	Reporting		Units	Dilution	Batch	Prepared	Analyzed	Method	Notes
		Limit								
Surrogate: 1,2-Dichloroethane-d4		93.8 %		23-173		"	"	"	"	
Surrogate: Toluene-d8		105 %		20-170		"	"	"	"	
Surrogate: 4-Bromofluorobenzene		99.3 %		21-167		"	"	"	"	

Anions by EPA Method 300.0

Date Sampled: **02/05/21 16:00**

Analyte	Result	Reporting		Units	Dilution	Batch	Prepared	Analyzed	Method	Notes
		Limit								
Sulfate	517	60.0		mg/L	200	BEB0150	02/10/21	02/10/21	EPA 300.0	
Chloride	158	12.0		"	"	"	"	"	"	

Total Dissolved Solids by SM2540C

Date Sampled: **02/05/21 16:00**

Analyte	Result	Reporting		Units	Dilution	Batch	Prepared	Analyzed	Method	Notes
		Limit								
Total Dissolved Solids	610	10.0		mg/L	1	BEB0196	02/12/21	02/12/21	SM2540C	

Summit Scientific

The results in this report apply to the samples analyzed in accordance with the chain of custody document. This analytical report must be reproduced in its entirety.



WSP
4600 West 60th Avenue
Arvada CO, 80003

Project: Park U-4-9XRLC
Project Number: 034520034
Project Manager: Jeremy Pike

Reported:
02/15/21 16:19

MW19
2102104-14 (Water)

Summit Scientific

Volatile Organic Compounds by EPA Method 8260B

Date Sampled: **02/05/21 16:40**

Analyte	Result	Reporting		Units	Dilution	Batch	Prepared	Analyzed	Method	Notes
		Limit								
Benzene	ND	1.0		ug/l	1	BEB0119	02/08/21	02/09/21	EPA 8260B	
Toluene	ND	1.0		"	"	"	"	"	"	
Ethylbenzene	ND	1.0		"	"	"	"	"	"	
Xylenes (total)	ND	2.0		"	"	"	"	"	"	
Naphthalene	ND	1.0		"	"	"	"	"	"	
1,2,4-Trimethylbenzene	ND	1.0		"	"	"	"	"	"	
1,3,5-Trimethylbenzene	ND	1.0		"	"	"	"	"	"	

Date Sampled: **02/05/21 16:40**

Analyte	Result	Reporting		Units	Dilution	Batch	Prepared	Analyzed	Method	Notes
		Limit								
Surrogate: 1,2-Dichloroethane-d4		92.9 %		23-173		"	"	"	"	
Surrogate: Toluene-d8		104 %		20-170		"	"	"	"	
Surrogate: 4-Bromofluorobenzene		99.6 %		21-167		"	"	"	"	

Anions by EPA Method 300.0

Date Sampled: **02/05/21 16:40**

Analyte	Result	Reporting		Units	Dilution	Batch	Prepared	Analyzed	Method	Notes
		Limit								
Sulfate	545	60.0		mg/L	200	BEB0150	02/10/21	02/10/21	EPA 300.0	
Chloride	171	12.0		"	"	"	"	"	"	

Total Dissolved Solids by SM2540C

Date Sampled: **02/05/21 16:40**

Analyte	Result	Reporting		Units	Dilution	Batch	Prepared	Analyzed	Method	Notes
		Limit								
Total Dissolved Solids	670	10.0		mg/L	1	BEB0196	02/12/21	02/12/21	SM2540C	

Summit Scientific

The results in this report apply to the samples analyzed in accordance with the chain of custody document. This analytical report must be reproduced in its entirety.



WSP
4600 West 60th Avenue
Arvada CO, 80003

Project: Park U-4-9XRLC
Project Number: 034520034
Project Manager: Jeremy Pike

Reported:
02/15/21 16:19

MW20
2102104-15 (Water)

Summit Scientific

Volatile Organic Compounds by EPA Method 8260B

Date Sampled: **02/05/21 16:39**

Analyte	Result	Reporting		Units	Dilution	Batch	Prepared	Analyzed	Method	Notes
		Limit								
Benzene	ND	1.0		ug/l	1	BEB0119	02/08/21	02/09/21	EPA 8260B	
Toluene	ND	1.0		"	"	"	"	"	"	
Ethylbenzene	ND	1.0		"	"	"	"	"	"	
Xylenes (total)	ND	2.0		"	"	"	"	"	"	
Naphthalene	ND	1.0		"	"	"	"	"	"	
1,2,4-Trimethylbenzene	ND	1.0		"	"	"	"	"	"	
1,3,5-Trimethylbenzene	ND	1.0		"	"	"	"	"	"	

Date Sampled: **02/05/21 16:39**

Analyte	Result	Reporting		Units	Dilution	Batch	Prepared	Analyzed	Method	Notes
		Limit								
Surrogate: 1,2-Dichloroethane-d4		92.4 %		23-173		"	"	"	"	
Surrogate: Toluene-d8		104 %		20-170		"	"	"	"	
Surrogate: 4-Bromofluorobenzene		101 %		21-167		"	"	"	"	

Anions by EPA Method 300.0

Date Sampled: **02/05/21 16:39**

Analyte	Result	Reporting		Units	Dilution	Batch	Prepared	Analyzed	Method	Notes
		Limit								
Sulfate	282	60.0		mg/L	200	BEB0150	02/10/21	02/10/21	EPA 300.0	
Chloride	110	12.0		"	"	"	"	"	"	

Total Dissolved Solids by SM2540C

Date Sampled: **02/05/21 16:39**

Analyte	Result	Reporting		Units	Dilution	Batch	Prepared	Analyzed	Method	Notes
		Limit								
Total Dissolved Solids	567	10.0		mg/L	1	BEB0196	02/12/21	02/12/21	SM2540C	

Summit Scientific

The results in this report apply to the samples analyzed in accordance with the chain of custody document. This analytical report must be reproduced in its entirety.



WSP
4600 West 60th Avenue
Arvada CO, 80003

Project: Park U-4-9XRLC
Project Number: 034520034
Project Manager: Jeremy Pike

Reported:
02/15/21 16:19

Volatile Organic Compounds by EPA Method 8260B - Quality Control

Summit Scientific

Analyte	Reporting			Spike	Source		%REC		RPD	
	Result	Limit	Units	Level	Result	%REC	Limits	RPD	Limit	Notes

Batch BEB0119 - EPA 5030 Water MS

Blank (BEB0119-BLK1)

Prepared: 02/08/21 Analyzed: 02/09/21

Benzene	ND	1.0	ug/l							
Toluene	ND	1.0	"							
Ethylbenzene	ND	1.0	"							
Xylenes (total)	ND	2.0	"							
Naphthalene	ND	1.0	"							
1,2,4-Trimethylbenzene	ND	1.0	"							
1,3,5-Trimethylbenzene	ND	1.0	"							
Surrogate: 1,2-Dichloroethane-d4	13.3		"	13.3		100	23-173			
Surrogate: Toluene-d8	13.9		"	13.3		104	20-170			
Surrogate: 4-Bromofluorobenzene	14.0		"	13.3		105	21-167			

LCS (BEB0119-BS1)

Prepared: 02/08/21 Analyzed: 02/09/21

Benzene	44.8	1.0	ug/l	50.0		89.5	51-132			
Toluene	48.0	1.0	"	50.0		95.9	51-138			
Ethylbenzene	43.2	1.0	"	50.0		86.5	58-146			
m,p-Xylene	84.0	2.0	"	100		84.0	57-144			
o-Xylene	44.0	1.0	"	50.0		87.9	53-146			
Naphthalene	48.8	1.0	"	50.0		97.6	70-130			
1,2,4-Trimethylbenzene	41.9	1.0	"	50.0		83.7	70-130			
1,3,5-Trimethylbenzene	42.5	1.0	"	50.0		85.0	70-130			
Surrogate: 1,2-Dichloroethane-d4	13.0		"	13.3		97.4	23-173			
Surrogate: Toluene-d8	14.0		"	13.3		105	20-170			
Surrogate: 4-Bromofluorobenzene	13.9		"	13.3		104	21-167			

Matrix Spike (BEB0119-MS1)

Source: 2102072-02

Prepared: 02/08/21 Analyzed: 02/09/21

Benzene	49.5	1.0	ug/l	50.0	1.22	96.6	34-141			
Toluene	53.2	1.0	"	50.0	1.27	104	27-151			
Ethylbenzene	50.0	1.0	"	50.0	ND	99.9	29-160			
m,p-Xylene	97.7	2.0	"	100	ND	97.7	20-166			
o-Xylene	49.2	1.0	"	50.0	ND	98.5	33-159			
Naphthalene	46.7	1.0	"	50.0	ND	93.5	70-130			
1,2,4-Trimethylbenzene	49.3	1.0	"	50.0	ND	98.5	70-130			
1,3,5-Trimethylbenzene	50.5	1.0	"	50.0	ND	101	70-130			
Surrogate: 1,2-Dichloroethane-d4	11.8		"	13.3		88.6	23-173			
Surrogate: Toluene-d8	13.6		"	13.3		102	20-170			
Surrogate: 4-Bromofluorobenzene	13.5		"	13.3		101	21-167			

Summit Scientific

The results in this report apply to the samples analyzed in accordance with the chain of custody document. This analytical report must be reproduced in its entirety.



WSP
4600 West 60th Avenue
Arvada CO, 80003

Project: Park U-4-9XRLC
Project Number: 034520034
Project Manager: Jeremy Pike

Reported:
02/15/21 16:19

Volatile Organic Compounds by EPA Method 8260B - Quality Control
Summit Scientific

Analyte	Reporting			Spike	Source		%REC		RPD	
	Result	Limit	Units	Level	Result	%REC	Limits	RPD	Limit	Notes

Batch BEB0119 - EPA 5030 Water MS

Matrix Spike Dup (BEB0119-MSD1)		Source: 2102072-02			Prepared: 02/08/21 Analyzed: 02/09/21					
Benzene	48.2	1.0	ug/l	50.0	1.22	94.0	34-141	2.72	30	
Toluene	51.4	1.0	"	50.0	1.27	100	27-151	3.61	30	
Ethylbenzene	47.9	1.0	"	50.0	ND	95.8	29-160	4.15	30	
m,p-Xylene	92.9	2.0	"	100	ND	92.9	20-166	5.03	30	
o-Xylene	46.9	1.0	"	50.0	ND	93.8	33-159	4.87	30	
Naphthalene	46.4	1.0	"	50.0	ND	92.8	70-130	0.752	30	
1,2,4-Trimethylbenzene	46.4	1.0	"	50.0	ND	92.7	70-130	6.11	30	
1,3,5-Trimethylbenzene	48.0	1.0	"	50.0	ND	95.9	70-130	5.14	30	
Surrogate: 1,2-Dichloroethane-d4	11.9		"	13.3		89.0	23-173			
Surrogate: Toluene-d8	14.0		"	13.3		105	20-170			
Surrogate: 4-Bromofluorobenzene	13.5		"	13.3		101	21-167			

Summit Scientific

The results in this report apply to the samples analyzed in accordance with the chain of custody document. This analytical report must be reproduced in its entirety.



WSP
4600 West 60th Avenue
Arvada CO, 80003

Project: Park U-4-9XRLC
Project Number: 034520034
Project Manager: Jeremy Pike

Reported:
02/15/21 16:19

Anions by EPA Method 300.0 - Quality Control
Summit Scientific

Analyte	Reporting			Spike	Source		%REC		RPD	
	Result	Limit	Units	Level	Result	%REC	Limits	RPD	Limit	Notes

Batch BEB0150 - General Preparation

Blank (BEB0150-BLK1)

Prepared & Analyzed: 02/10/21

Chloride	ND	0.0600	mg/L
Sulfate	ND	0.300	"

LCS (BEB0150-BS1)

Prepared & Analyzed: 02/10/21

Sulfate	15.7	0.300	mg/L	15.0	105	90-110
Chloride	3.15	0.0600	"	3.00	105	90-110

Duplicate (BEB0150-DUP1)

Source: 2102104-01

Prepared & Analyzed: 02/10/21

Chloride	167	12.0	mg/L	179	7.28	20
Sulfate	506	60.0	"	480	5.28	20

Matrix Spike (BEB0150-MS1)

Source: 2102104-01

Prepared & Analyzed: 02/10/21

Sulfate	3460	60.0	mg/L	3000	480	99.4	80-120
Chloride	809	12.0	"	600	179	105	80-120

Summit Scientific

The results in this report apply to the samples analyzed in accordance with the chain of custody document. This analytical report must be reproduced in its entirety.



WSP
4600 West 60th Avenue
Arvada CO, 80003

Project: Park U-4-9XRLC
Project Number: 034520034
Project Manager: Jeremy Pike

Reported:
02/15/21 16:19

Total Dissolved Solids by SM2540C - Quality Control
Summit Scientific

Analyte	Result	Reporting			Spike	Source	%REC		RPD		
		Limit	Units	Level	Result	%REC	Limits	RPD	Limit	Notes	

Batch BEB0196 - General Preparation

Blank (BEB0196-BLK1)

Prepared & Analyzed: 02/12/21

Total Dissolved Solids ND 10.0 mg/L

Duplicate (BEB0196-DUP1)

Source: 2102104-01

Prepared & Analyzed: 02/12/21

Total Dissolved Solids 610 10.0 mg/L 577 5.49 20

Summit Scientific

The results in this report apply to the samples analyzed in accordance with the chain of custody document. This analytical report must be reproduced in its entirety.



WSP
4600 West 60th Avenue
Arvada CO, 80003

Project: Park U-4-9XRLC
Project Number: 034520034
Project Manager: Jeremy Pike

Reported:
02/15/21 16:19

Notes and Definitions

DET	Analyte DETECTED
ND	Analyte NOT DETECTED at or above the reporting limit
NR	Not Reported
dry	Sample results reported on a dry weight basis
RPD	Relative Percent Difference