

Bayswater Exploration & Production, LLC

DJ Basin

Topaz Pad 6-I HZ Pad

TOPAZ 10

Wellbore #1

Plan: Design #1

Standard Planning Report

25 November, 2020



Pad Name: Topaz Pad 6-I HZ Pad
Well Name: TOPAZ 10
Ground Level: 4946.0
SHL Latitude: 40° 36' 3.740 N
SHL Longitude: 104° 42' 50.753 W

SECTION DETAILS

Sec	MD	Inc	Azi	TVD	+N/-S	+E/-W	Dleg	TFace	VSect	Target
1	0.0	0.00	0.00	0.0	0.0	0.0	0.00	0.00	0.0	
2	1500.0	0.00	0.00	1500.0	0.0	0.0	0.00	0.00	0.0	
3	2467.0	19.34	346.78	2448.7	157.4	-37.0	2.00	346.78	61.6	
4	7073.5	19.34	346.78	6795.3	1642.5	-385.7	0.00	0.00	643.1	
5	7931.8	90.00	269.46	7298.0	1809.2	-958.8	10.00	-78.02	1235.4	TOPAZ 10 LP
6	17593.6	90.00	269.46	7298.0	1718.2	-10620.1	0.00	0.00	10758.2	TOPAZ 10 PBHL

DESIGN TARGET DETAILS

Name	TVD	+N/-S	+E/-W	Northing	Easting	Latitude	Longitude	Shape
TOPAZ 10 LP	7298.0	1809.2	-958.8	1464567.74	3217255.11	40° 36' 21.618 N	104° 43' 3.184 W	Point
TOPAZ 10 PBHL	- plan hits target center 7298.0	1718.2	-10620.1	1464391.12	3207594.94	40° 36' 20.696 N	104° 45' 8.446 W	Point
	- plan hits target center							

REFERENCE INFORMATION

Co-ordinate (N/E) Reference: Well TOPAZ 10, True North
Vertical (TVD) Reference: KB @ 4966.0usft (Original Well Elev)
Section (VS) Reference: Slot - (0.0N, 0.0E)
Measured Depth Reference: KB @ 4966.0usft (Original Well Elev)
Calculation Method: Minimum Curvature

CASING DETAILS

No casing data is available

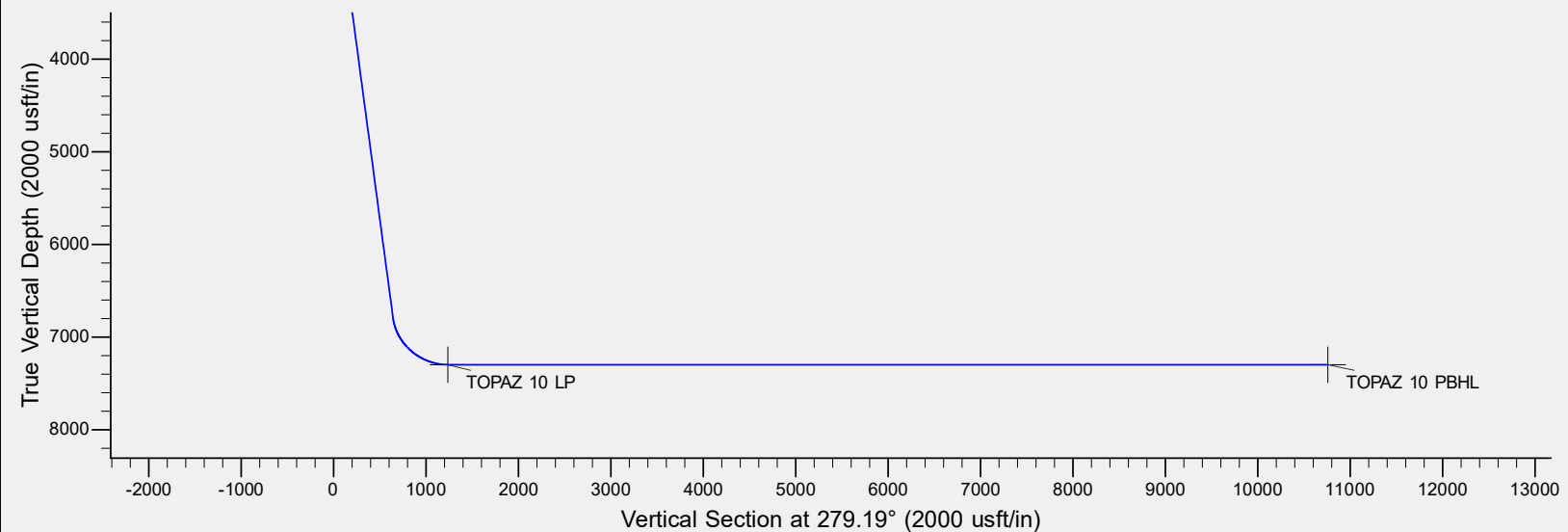
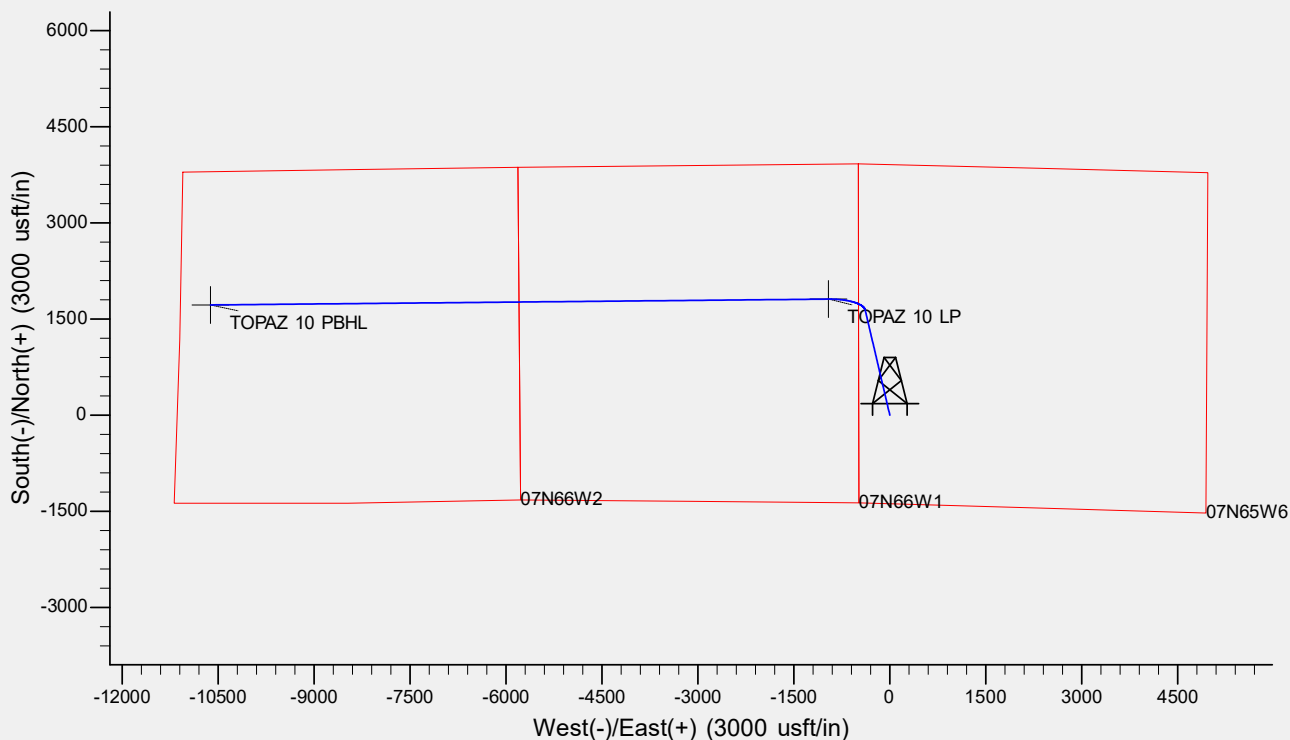
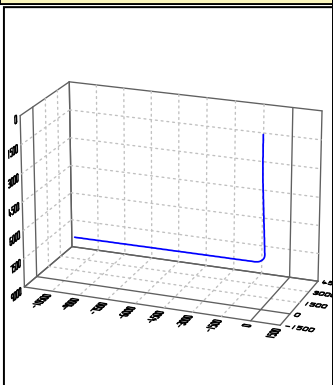
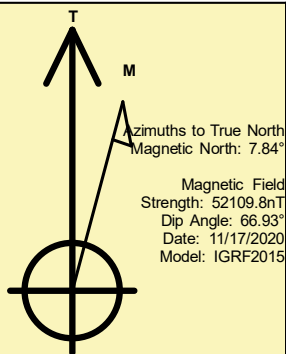

Bayswater Exploration & Production LLC

Planning Report

Database:	edm	Local Co-ordinate Reference:	Well TOPAZ 10
Company:	Bayswater Exploration & Production, LLC	TVD Reference:	KB @ 4966.0usft (Original Well Elev)
Project:	DJ Basin	MD Reference:	KB @ 4966.0usft (Original Well Elev)
Site:	Topaz Pad 6-I HZ Pad	North Reference:	True
Well:	TOPAZ 10	Survey Calculation Method:	Minimum Curvature
Wellbore:	Wellbore #1		
Design:	Design #1		

Project	DJ Basin, DJ Basin		
Map System:	US State Plane 1983	System Datum:	Mean Sea Level
Geo Datum:	North American Datum 1983		
Map Zone:	Colorado Northern Zone		

Site	Topaz Pad 6-I HZ Pad					
Site Position:		Northing:	1,462,796.90 usft	Latitude:	40° 36' 4.046 N	
From:	Lat/Long	Easting:	3,218,098.27 usft	Longitude:	104° 42' 52.456 W	
Position Uncertainty:		0.0 usft	Slot Radius:	13-3/16 "	Grid Convergence:	0.51 °

Well	TOPAZ 10					
Well Position	+N/-S	-31.0 usft	Northing:	1,462,767.09 usft	Latitude:	40° 36' 3.740 N
	+E/-W	131.3 usft	Easting:	3,218,229.89 usft	Longitude:	104° 42' 50.753 W
Position Uncertainty		0.0 usft	Wellhead Elevation:		Ground Level:	4,946.0 usft

Wellbore	Wellbore #1				
Magnetics	Model Name	Sample Date	Declination (°)	Dip Angle (°)	Field Strength (nT)
	IGRF2015	11/17/2020	7.84	66.93	52,109.82890784

Design	Design #1			
Audit Notes:				
Version:	Phase:	PLAN	Tie On Depth:	0.0
Vertical Section:	Depth From (TVD) (usft)	+N/-S (usft)	+E/-W (usft)	Direction (°)
	0.0	0.0	0.0	279.19

Plan Survey Tool Program	Date	11/25/2020		
Depth From (usft)	Depth To (usft)	Survey (Wellbore)	Tool Name	Remarks
1	0.0	17,593.6	Design #1 (Wellbore #1)	MWD
				OWSG MWD - Standard

Plan Sections										
Measured Depth (usft)	Inclination (°)	Azimuth (°)	Vertical Depth (usft)	+N/-S (usft)	+E/-W (usft)	Dogleg Rate (°/100usft)	Build Rate (°/100usft)	Turn Rate (°/100usft)	TFO (°)	Target
0.0	0.00	0.00	0.0	0.0	0.0	0.00	0.00	0.00	0.00	
1,500.0	0.00	0.00	1,500.0	0.0	0.0	0.00	0.00	0.00	0.00	
2,467.0	19.34	346.78	2,448.7	157.4	-37.0	2.00	2.00	0.00	346.78	
7,073.5	19.34	346.78	6,795.3	1,642.5	-385.7	0.00	0.00	0.00	0.00	
7,931.8	90.00	269.46	7,298.0	1,809.2	-958.8	10.00	8.23	-9.01	-78.02	TOPAZ 10 LP
17,593.6	90.00	269.46	7,298.0	1,718.2	-10,620.1	0.00	0.00	0.00	0.00	TOPAZ 10 PBHL

Bayswater Exploration & Production LLC

Planning Report

Database:	edm	Local Co-ordinate Reference:	Well TOPAZ 10
Company:	Bayswater Exploration & Production, LLC	TVD Reference:	KB @ 4966.0usft (Original Well Elev)
Project:	DJ Basin	MD Reference:	KB @ 4966.0usft (Original Well Elev)
Site:	Topaz Pad 6-I HZ Pad	North Reference:	True
Well:	TOPAZ 10	Survey Calculation Method:	Minimum Curvature
Wellbore:	Wellbore #1		
Design:	Design #1		

Planned Survey									
Measured Depth (usft)	Inclination (°)	Azimuth (°)	Vertical Depth (usft)	+N/-S (usft)	+E/-W (usft)	Vertical Section (usft)	Dogleg Rate (°/100usft)	Build Rate (°/100usft)	Turn Rate (°/100usft)
0.0	0.00	0.00	0.0	0.0	0.0	0.0	0.00	0.00	0.00
100.0	0.00	0.00	100.0	0.0	0.0	0.0	0.00	0.00	0.00
200.0	0.00	0.00	200.0	0.0	0.0	0.0	0.00	0.00	0.00
300.0	0.00	0.00	300.0	0.0	0.0	0.0	0.00	0.00	0.00
400.0	0.00	0.00	400.0	0.0	0.0	0.0	0.00	0.00	0.00
500.0	0.00	0.00	500.0	0.0	0.0	0.0	0.00	0.00	0.00
600.0	0.00	0.00	600.0	0.0	0.0	0.0	0.00	0.00	0.00
700.0	0.00	0.00	700.0	0.0	0.0	0.0	0.00	0.00	0.00
800.0	0.00	0.00	800.0	0.0	0.0	0.0	0.00	0.00	0.00
900.0	0.00	0.00	900.0	0.0	0.0	0.0	0.00	0.00	0.00
1,000.0	0.00	0.00	1,000.0	0.0	0.0	0.0	0.00	0.00	0.00
1,100.0	0.00	0.00	1,100.0	0.0	0.0	0.0	0.00	0.00	0.00
1,200.0	0.00	0.00	1,200.0	0.0	0.0	0.0	0.00	0.00	0.00
1,300.0	0.00	0.00	1,300.0	0.0	0.0	0.0	0.00	0.00	0.00
1,400.0	0.00	0.00	1,400.0	0.0	0.0	0.0	0.00	0.00	0.00
1,500.0	0.00	0.00	1,500.0	0.0	0.0	0.0	0.00	0.00	0.00
1,600.0	2.00	346.78	1,600.0	1.7	-0.4	0.7	2.00	2.00	0.00
1,700.0	4.00	346.78	1,699.8	6.8	-1.6	2.7	2.00	2.00	0.00
1,800.0	6.00	346.78	1,799.5	15.3	-3.6	6.0	2.00	2.00	0.00
1,900.0	8.00	346.78	1,898.7	27.1	-6.4	10.6	2.00	2.00	0.00
2,000.0	10.00	346.78	1,997.5	42.4	-10.0	16.6	2.00	2.00	0.00
2,100.0	12.00	346.78	2,095.6	60.9	-14.3	23.9	2.00	2.00	0.00
2,200.0	14.00	346.78	2,193.1	82.8	-19.5	32.4	2.00	2.00	0.00
2,300.0	16.00	346.78	2,289.6	108.0	-25.4	42.3	2.00	2.00	0.00
2,400.0	18.00	346.78	2,385.3	136.5	-32.1	53.4	2.00	2.00	0.00
2,467.0	19.34	346.78	2,448.7	157.4	-37.0	61.6	2.00	2.00	0.00
2,500.0	19.34	346.78	2,479.9	168.0	-39.5	65.8	0.00	0.00	0.00
2,600.0	19.34	346.78	2,574.2	200.3	-47.0	78.4	0.00	0.00	0.00
2,700.0	19.34	346.78	2,668.6	232.5	-54.6	91.0	0.00	0.00	0.00
2,800.0	19.34	346.78	2,763.0	264.7	-62.2	103.7	0.00	0.00	0.00
2,900.0	19.34	346.78	2,857.3	297.0	-69.7	116.3	0.00	0.00	0.00
3,000.0	19.34	346.78	2,951.7	329.2	-77.3	128.9	0.00	0.00	0.00
3,100.0	19.34	346.78	3,046.0	361.5	-84.9	141.5	0.00	0.00	0.00
3,200.0	19.34	346.78	3,140.4	393.7	-92.5	154.1	0.00	0.00	0.00
3,300.0	19.34	346.78	3,234.7	425.9	-100.0	166.8	0.00	0.00	0.00
3,400.0	19.34	346.78	3,329.1	458.2	-107.6	179.4	0.00	0.00	0.00
3,500.0	19.34	346.78	3,423.5	490.4	-115.2	192.0	0.00	0.00	0.00
3,600.0	19.34	346.78	3,517.8	522.6	-122.7	204.6	0.00	0.00	0.00
3,700.0	19.34	346.78	3,612.2	554.9	-130.3	217.3	0.00	0.00	0.00
3,800.0	19.34	346.78	3,706.5	587.1	-137.9	229.9	0.00	0.00	0.00
3,900.0	19.34	346.78	3,800.9	619.4	-145.5	242.5	0.00	0.00	0.00
4,000.0	19.34	346.78	3,895.2	651.6	-153.0	255.1	0.00	0.00	0.00
4,100.0	19.34	346.78	3,989.6	683.8	-160.6	267.8	0.00	0.00	0.00
4,200.0	19.34	346.78	4,084.0	716.1	-168.2	280.4	0.00	0.00	0.00
4,300.0	19.34	346.78	4,178.3	748.3	-175.7	293.0	0.00	0.00	0.00
4,400.0	19.34	346.78	4,272.7	780.6	-183.3	305.6	0.00	0.00	0.00
4,500.0	19.34	346.78	4,367.0	812.8	-190.9	318.3	0.00	0.00	0.00
4,600.0	19.34	346.78	4,461.4	845.0	-198.5	330.9	0.00	0.00	0.00
4,700.0	19.34	346.78	4,555.7	877.3	-206.0	343.5	0.00	0.00	0.00
4,800.0	19.34	346.78	4,650.1	909.5	-213.6	356.1	0.00	0.00	0.00
4,900.0	19.34	346.78	4,744.5	941.8	-221.2	368.7	0.00	0.00	0.00
5,000.0	19.34	346.78	4,838.8	974.0	-228.7	381.4	0.00	0.00	0.00
5,100.0	19.34	346.78	4,933.2	1,006.2	-236.3	394.0	0.00	0.00	0.00
5,200.0	19.34	346.78	5,027.5	1,038.5	-243.9	406.6	0.00	0.00	0.00

Bayswater Exploration & Production LLC

Planning Report

Database:	edm	Local Co-ordinate Reference:	Well TOPAZ 10
Company:	Bayswater Exploration & Production, LLC	TVD Reference:	KB @ 4966.0usft (Original Well Elev)
Project:	DJ Basin	MD Reference:	KB @ 4966.0usft (Original Well Elev)
Site:	Topaz Pad 6-I HZ Pad	North Reference:	True
Well:	TOPAZ 10	Survey Calculation Method:	Minimum Curvature
Wellbore:	Wellbore #1		
Design:	Design #1		

Planned Survey									
Measured Depth (usft)	Inclination (°)	Azimuth (°)	Vertical Depth (usft)	+N/-S (usft)	+E/-W (usft)	Vertical Section (usft)	Dogleg Rate (°/100usft)	Build Rate (°/100usft)	Turn Rate (°/100usft)
5,300.0	19.34	346.78	5,121.9	1,070.7	-251.5	419.2	0.00	0.00	0.00
5,400.0	19.34	346.78	5,216.2	1,103.0	-259.0	431.9	0.00	0.00	0.00
5,500.0	19.34	346.78	5,310.6	1,135.2	-266.6	444.5	0.00	0.00	0.00
5,600.0	19.34	346.78	5,405.0	1,167.4	-274.2	457.1	0.00	0.00	0.00
5,700.0	19.34	346.78	5,499.3	1,199.7	-281.7	469.7	0.00	0.00	0.00
5,800.0	19.34	346.78	5,593.7	1,231.9	-289.3	482.4	0.00	0.00	0.00
5,900.0	19.34	346.78	5,688.0	1,264.2	-296.9	495.0	0.00	0.00	0.00
6,000.0	19.34	346.78	5,782.4	1,296.4	-304.5	507.6	0.00	0.00	0.00
6,100.0	19.34	346.78	5,876.7	1,328.6	-312.0	520.2	0.00	0.00	0.00
6,200.0	19.34	346.78	5,971.1	1,360.9	-319.6	532.8	0.00	0.00	0.00
6,300.0	19.34	346.78	6,065.5	1,393.1	-327.2	545.5	0.00	0.00	0.00
6,400.0	19.34	346.78	6,159.8	1,425.4	-334.7	558.1	0.00	0.00	0.00
6,500.0	19.34	346.78	6,254.2	1,457.6	-342.3	570.7	0.00	0.00	0.00
6,600.0	19.34	346.78	6,348.5	1,489.8	-349.9	583.3	0.00	0.00	0.00
6,700.0	19.34	346.78	6,442.9	1,522.1	-357.5	596.0	0.00	0.00	0.00
6,800.0	19.34	346.78	6,537.2	1,554.3	-365.0	608.6	0.00	0.00	0.00
6,900.0	19.34	346.78	6,631.6	1,586.5	-372.6	621.2	0.00	0.00	0.00
7,000.0	19.34	346.78	6,726.0	1,618.8	-380.2	633.8	0.00	0.00	0.00
7,073.5	19.34	346.78	6,795.3	1,642.5	-385.7	643.1	0.00	0.00	0.00
7,100.0	20.05	339.21	6,820.3	1,651.0	-388.3	647.1	10.00	2.69	-28.60
7,200.0	25.09	316.45	6,912.7	1,682.5	-409.1	672.6	10.00	5.04	-22.76
7,300.0	32.40	302.12	7,000.5	1,712.2	-446.5	714.2	10.00	7.31	-14.33
7,400.0	40.76	292.86	7,080.8	1,739.2	-499.4	770.8	10.00	8.37	-9.25
7,500.0	49.65	286.37	7,151.2	1,762.6	-566.2	840.5	10.00	8.89	-6.49
7,600.0	58.81	281.42	7,209.6	1,781.9	-644.9	921.2	10.00	9.16	-4.95
7,700.0	68.13	277.36	7,254.2	1,796.4	-733.1	1,010.6	10.00	9.32	-4.06
7,800.0	77.54	273.80	7,283.7	1,805.6	-828.0	1,105.8	10.00	9.41	-3.56
7,900.0	86.99	270.49	7,297.2	1,809.2	-926.9	1,204.0	10.00	9.45	-3.31
7,931.8	90.00	269.46	7,298.0	1,809.2	-958.8	1,235.4	10.00	9.46	-3.24
8,000.0	90.00	269.46	7,298.0	1,808.6	-1,026.9	1,302.6	0.00	0.00	0.00
8,100.0	90.00	269.46	7,298.0	1,807.6	-1,126.9	1,401.2	0.00	0.00	0.00
8,200.0	90.00	269.46	7,298.0	1,806.7	-1,226.9	1,499.7	0.00	0.00	0.00
8,300.0	90.00	269.46	7,298.0	1,805.8	-1,326.9	1,598.3	0.00	0.00	0.00
8,400.0	90.00	269.46	7,298.0	1,804.8	-1,426.9	1,696.8	0.00	0.00	0.00
8,500.0	90.00	269.46	7,298.0	1,803.9	-1,526.9	1,795.4	0.00	0.00	0.00
8,600.0	90.00	269.46	7,298.0	1,802.9	-1,626.9	1,894.0	0.00	0.00	0.00
8,700.0	90.00	269.46	7,298.0	1,802.0	-1,726.9	1,992.5	0.00	0.00	0.00
8,800.0	90.00	269.46	7,298.0	1,801.0	-1,826.9	2,091.1	0.00	0.00	0.00
8,900.0	90.00	269.46	7,298.0	1,800.1	-1,926.9	2,189.6	0.00	0.00	0.00
9,000.0	90.00	269.46	7,298.0	1,799.2	-2,026.9	2,288.2	0.00	0.00	0.00
9,100.0	90.00	269.46	7,298.0	1,798.2	-2,126.9	2,386.8	0.00	0.00	0.00
9,200.0	90.00	269.46	7,298.0	1,797.3	-2,226.9	2,485.3	0.00	0.00	0.00
9,300.0	90.00	269.46	7,298.0	1,796.3	-2,326.9	2,583.9	0.00	0.00	0.00
9,400.0	90.00	269.46	7,298.0	1,795.4	-2,426.9	2,682.5	0.00	0.00	0.00
9,500.0	90.00	269.46	7,298.0	1,794.5	-2,526.9	2,781.0	0.00	0.00	0.00
9,600.0	90.00	269.46	7,298.0	1,793.5	-2,626.9	2,879.6	0.00	0.00	0.00
9,700.0	90.00	269.46	7,298.0	1,792.6	-2,726.8	2,978.1	0.00	0.00	0.00
9,800.0	90.00	269.46	7,298.0	1,791.6	-2,826.8	3,076.7	0.00	0.00	0.00
9,900.0	90.00	269.46	7,298.0	1,790.7	-2,926.8	3,175.3	0.00	0.00	0.00
10,000.0	90.00	269.46	7,298.0	1,789.7	-3,026.8	3,273.8	0.00	0.00	0.00
10,100.0	90.00	269.46	7,298.0	1,788.8	-3,126.8	3,372.4	0.00	0.00	0.00
10,200.0	90.00	269.46	7,298.0	1,787.9	-3,226.8	3,470.9	0.00	0.00	0.00
10,300.0	90.00	269.46	7,298.0	1,786.9	-3,326.8	3,569.5	0.00	0.00	0.00
10,400.0	90.00	269.46	7,298.0	1,786.0	-3,426.8	3,668.1	0.00	0.00	0.00

Bayswater Exploration & Production LLC

Planning Report

Database:	edm	Local Co-ordinate Reference:	Well TOPAZ 10
Company:	Bayswater Exploration & Production, LLC	TVD Reference:	KB @ 4966.0usft (Original Well Elev)
Project:	DJ Basin	MD Reference:	KB @ 4966.0usft (Original Well Elev)
Site:	Topaz Pad 6-I HZ Pad	North Reference:	True
Well:	TOPAZ 10	Survey Calculation Method:	Minimum Curvature
Wellbore:	Wellbore #1		
Design:	Design #1		

Planned Survey										
Measured Depth (usft)	Inclination (°)	Azimuth (°)	Vertical Depth (usft)	+N/-S (usft)	+E/-W (usft)	Vertical Section (usft)	Dogleg Rate (°/100usft)	Build Rate (°/100usft)	Turn Rate (°/100usft)	
10,500.0	90.00	269.46	7,298.0	1,785.0	-3,526.8	3,766.6	0.00	0.00	0.00	
10,600.0	90.00	269.46	7,298.0	1,784.1	-3,626.8	3,865.2	0.00	0.00	0.00	
10,700.0	90.00	269.46	7,298.0	1,783.2	-3,726.8	3,963.8	0.00	0.00	0.00	
10,800.0	90.00	269.46	7,298.0	1,782.2	-3,826.8	4,062.3	0.00	0.00	0.00	
10,900.0	90.00	269.46	7,298.0	1,781.3	-3,926.8	4,160.9	0.00	0.00	0.00	
11,000.0	90.00	269.46	7,298.0	1,780.3	-4,026.8	4,259.4	0.00	0.00	0.00	
11,100.0	90.00	269.46	7,298.0	1,779.4	-4,126.8	4,358.0	0.00	0.00	0.00	
11,200.0	90.00	269.46	7,298.0	1,778.4	-4,226.8	4,456.6	0.00	0.00	0.00	
11,300.0	90.00	269.46	7,298.0	1,777.5	-4,326.8	4,555.1	0.00	0.00	0.00	
11,400.0	90.00	269.46	7,298.0	1,776.6	-4,426.8	4,653.7	0.00	0.00	0.00	
11,500.0	90.00	269.46	7,298.0	1,775.6	-4,526.8	4,752.2	0.00	0.00	0.00	
11,600.0	90.00	269.46	7,298.0	1,774.7	-4,626.8	4,850.8	0.00	0.00	0.00	
11,700.0	90.00	269.46	7,298.0	1,773.7	-4,726.8	4,949.4	0.00	0.00	0.00	
11,800.0	90.00	269.46	7,298.0	1,772.8	-4,826.8	5,047.9	0.00	0.00	0.00	
11,900.0	90.00	269.46	7,298.0	1,771.8	-4,926.8	5,146.5	0.00	0.00	0.00	
12,000.0	90.00	269.46	7,298.0	1,770.9	-5,026.7	5,245.1	0.00	0.00	0.00	
12,100.0	90.00	269.46	7,298.0	1,770.0	-5,126.7	5,343.6	0.00	0.00	0.00	
12,200.0	90.00	269.46	7,298.0	1,769.0	-5,226.7	5,442.2	0.00	0.00	0.00	
12,300.0	90.00	269.46	7,298.0	1,768.1	-5,326.7	5,540.7	0.00	0.00	0.00	
12,400.0	90.00	269.46	7,298.0	1,767.1	-5,426.7	5,639.3	0.00	0.00	0.00	
12,500.0	90.00	269.46	7,298.0	1,766.2	-5,526.7	5,737.9	0.00	0.00	0.00	
12,600.0	90.00	269.46	7,298.0	1,765.3	-5,626.7	5,836.4	0.00	0.00	0.00	
12,700.0	90.00	269.46	7,298.0	1,764.3	-5,726.7	5,935.0	0.00	0.00	0.00	
12,800.0	90.00	269.46	7,298.0	1,763.4	-5,826.7	6,033.5	0.00	0.00	0.00	
12,900.0	90.00	269.46	7,298.0	1,762.4	-5,926.7	6,132.1	0.00	0.00	0.00	
13,000.0	90.00	269.46	7,298.0	1,761.5	-6,026.7	6,230.7	0.00	0.00	0.00	
13,100.0	90.00	269.46	7,298.0	1,760.5	-6,126.7	6,329.2	0.00	0.00	0.00	
13,200.0	90.00	269.46	7,298.0	1,759.6	-6,226.7	6,427.8	0.00	0.00	0.00	
13,300.0	90.00	269.46	7,298.0	1,758.7	-6,326.7	6,526.4	0.00	0.00	0.00	
13,400.0	90.00	269.46	7,298.0	1,757.7	-6,426.7	6,624.9	0.00	0.00	0.00	
13,500.0	90.00	269.46	7,298.0	1,756.8	-6,526.7	6,723.5	0.00	0.00	0.00	
13,600.0	90.00	269.46	7,298.0	1,755.8	-6,626.7	6,822.0	0.00	0.00	0.00	
13,700.0	90.00	269.46	7,298.0	1,754.9	-6,726.7	6,920.6	0.00	0.00	0.00	
13,800.0	90.00	269.46	7,298.0	1,754.0	-6,826.7	7,019.2	0.00	0.00	0.00	
13,900.0	90.00	269.46	7,298.0	1,753.0	-6,926.7	7,117.7	0.00	0.00	0.00	
14,000.0	90.00	269.46	7,298.0	1,752.1	-7,026.7	7,216.3	0.00	0.00	0.00	
14,100.0	90.00	269.46	7,298.0	1,751.1	-7,126.7	7,314.8	0.00	0.00	0.00	
14,200.0	90.00	269.46	7,298.0	1,750.2	-7,226.6	7,413.4	0.00	0.00	0.00	
14,300.0	90.00	269.46	7,298.0	1,749.2	-7,326.6	7,512.0	0.00	0.00	0.00	
14,400.0	90.00	269.46	7,298.0	1,748.3	-7,426.6	7,610.5	0.00	0.00	0.00	
14,500.0	90.00	269.46	7,298.0	1,747.4	-7,526.6	7,709.1	0.00	0.00	0.00	
14,600.0	90.00	269.46	7,298.0	1,746.4	-7,626.6	7,807.7	0.00	0.00	0.00	
14,700.0	90.00	269.46	7,298.0	1,745.5	-7,726.6	7,906.2	0.00	0.00	0.00	
14,800.0	90.00	269.46	7,298.0	1,744.5	-7,826.6	8,004.8	0.00	0.00	0.00	
14,900.0	90.00	269.46	7,298.0	1,743.6	-7,926.6	8,103.3	0.00	0.00	0.00	
15,000.0	90.00	269.46	7,298.0	1,742.7	-8,026.6	8,201.9	0.00	0.00	0.00	
15,100.0	90.00	269.46	7,298.0	1,741.7	-8,126.6	8,300.5	0.00	0.00	0.00	
15,200.0	90.00	269.46	7,298.0	1,740.8	-8,226.6	8,399.0	0.00	0.00	0.00	
15,300.0	90.00	269.46	7,298.0	1,739.8	-8,326.6	8,497.6	0.00	0.00	0.00	
15,400.0	90.00	269.46	7,298.0	1,738.9	-8,426.6	8,596.1	0.00	0.00	0.00	
15,500.0	90.00	269.46	7,298.0	1,737.9	-8,526.6	8,694.7	0.00	0.00	0.00	
15,600.0	90.00	269.46	7,298.0	1,737.0	-8,626.6	8,793.3	0.00	0.00	0.00	
15,700.0	90.00	269.46	7,298.0	1,736.1	-8,726.6	8,891.8	0.00	0.00	0.00	
15,800.0	90.00	269.46	7,298.0	1,735.1	-8,826.6	8,990.4	0.00	0.00	0.00	

Bayswater Exploration & Production LLC

Planning Report

Database:	edm	Local Co-ordinate Reference:	Well TOPAZ 10
Company:	Bayswater Exploration & Production, LLC	TVD Reference:	KB @ 4966.0usft (Original Well Elev)
Project:	DJ Basin	MD Reference:	KB @ 4966.0usft (Original Well Elev)
Site:	Topaz Pad 6-I HZ Pad	North Reference:	True
Well:	TOPAZ 10	Survey Calculation Method:	Minimum Curvature
Wellbore:	Wellbore #1		
Design:	Design #1		

Planned Survey										
Measured Depth (usft)	Inclination (°)	Azimuth (°)	Vertical Depth (usft)	+N/-S (usft)	+E/-W (usft)	Vertical Section (usft)	Dogleg Rate (°/100usft)	Build Rate (°/100usft)	Turn Rate (°/100usft)	
15,900.0	90.00	269.46	7,298.0	1,734.2	-8,926.6	9,089.0	0.00	0.00	0.00	
16,000.0	90.00	269.46	7,298.0	1,733.2	-9,026.6	9,187.5	0.00	0.00	0.00	
16,100.0	90.00	269.46	7,298.0	1,732.3	-9,126.6	9,286.1	0.00	0.00	0.00	
16,200.0	90.00	269.46	7,298.0	1,731.4	-9,226.6	9,384.6	0.00	0.00	0.00	
16,300.0	90.00	269.46	7,298.0	1,730.4	-9,326.6	9,483.2	0.00	0.00	0.00	
16,400.0	90.00	269.46	7,298.0	1,729.5	-9,426.6	9,581.8	0.00	0.00	0.00	
16,500.0	90.00	269.46	7,298.0	1,728.5	-9,526.5	9,680.3	0.00	0.00	0.00	
16,600.0	90.00	269.46	7,298.0	1,727.6	-9,626.5	9,778.9	0.00	0.00	0.00	
16,700.0	90.00	269.46	7,298.0	1,726.6	-9,726.5	9,877.4	0.00	0.00	0.00	
16,800.0	90.00	269.46	7,298.0	1,725.7	-9,826.5	9,976.0	0.00	0.00	0.00	
16,900.0	90.00	269.46	7,298.0	1,724.8	-9,926.5	10,074.6	0.00	0.00	0.00	
17,000.0	90.00	269.46	7,298.0	1,723.8	-10,026.5	10,173.1	0.00	0.00	0.00	
17,100.0	90.00	269.46	7,298.0	1,722.9	-10,126.5	10,271.7	0.00	0.00	0.00	
17,200.0	90.00	269.46	7,298.0	1,721.9	-10,226.5	10,370.3	0.00	0.00	0.00	
17,300.0	90.00	269.46	7,298.0	1,721.0	-10,326.5	10,468.8	0.00	0.00	0.00	
17,400.0	90.00	269.46	7,298.0	1,720.1	-10,426.5	10,567.4	0.00	0.00	0.00	
17,500.0	90.00	269.46	7,298.0	1,719.1	-10,526.5	10,665.9	0.00	0.00	0.00	
17,593.6	90.00	269.46	7,298.0	1,718.2	-10,620.1	10,758.2	0.00	0.00	0.00	

Design Targets										
Target Name	Dip Angle (°)	Dip Dir. (°)	TVD (usft)	+N/-S (usft)	+E/-W (usft)	Northing (usft)	Easting (usft)	Latitude	Longitude	
- hit/miss target										
- Shape										
TOPAZ 10 PBHL	0.00	0.00	7,298.0	1,718.2	-10,620.1	1,464,391.13	3,207,594.94	40° 36' 20.696 N	104° 45' 8.446 W	
- plan hits target center										
- Point										
TOPAZ 10 LP	0.00	0.00	7,298.0	1,809.2	-958.8	1,464,567.74	3,217,255.12	40° 36' 21.618 N	104° 43' 3.184 W	
- plan hits target center										
- Point										