

Bayswater Exploration & Production, LLC

DJ Basin

Topaz Pad 6-I HZ Pad

TOPAZ 06

Wellbore #1

Plan: Design #1

Standard Planning Report

25 November, 2020



Pad Name: Topaz Pad 6-I HZ Pad
Well Name: TOPAZ 06
Ground Level: 4946.0
SHL Latitude: 40° 36' 3.873 N
SHL Longitude: 104° 42' 51.509 W

SECTION DETAILS

Sec	MD	Inc	Azi	TVD	+N/-S	+E/-W	Dleg	TFace	VSect	Target
1	0.0	0.00	0.00	0.0	0.0	0.0	0.00	0.00	0.0	
2	1500.0	0.00	0.00	1500.0	0.0	0.0	0.00	0.00	0.0	
3	2892.7	27.85	352.28	2838.5	328.9	-44.6	2.00	352.28	120.8	
4	7395.9	27.85	352.28	6819.9	2413.9	-327.2	0.00	0.00	886.3	
5	8262.7	90.00	269.39	7298.0	2658.4	-901.8	10.00	-83.71	1502.4	TOPAZ 6 LP
6	17907.9	90.00	269.39	7298.0	2555.0	-10546.5	0.00	0.00	10851.5	TOPAZ 6 PBHL

DESIGN TARGET DETAILS

Name	TVD	+N/-S	+E/-W	Northing	Easting	Latitude	Longitude	Shape
TOPAZ 6 LP	7298.0	2658.4	-901.8	1465430.39	3217246.11	40° 36' 30.143 N	104° 43' 3.202 W	Point
TOPAZ 6 PBHL	7298.0	2555.0	-10546.5	1465241.53	3207602.77	40° 36' 29.099 N	104° 45' 8.251 W	Point

REFERENCE INFORMATION

Co-ordinate (N/E) Reference: Well TOPAZ 06, True North
Vertical (TVD) Reference: KB @ 4966.0usft (Original Well Elev)
Section (VS) Reference: Slot - (0.0N, 0.0E)
Measured Depth Reference: KB @ 4966.0usft (Original Well Elev)
Calculation Method: Minimum Curvature

CASING DETAILS

No casing data is available

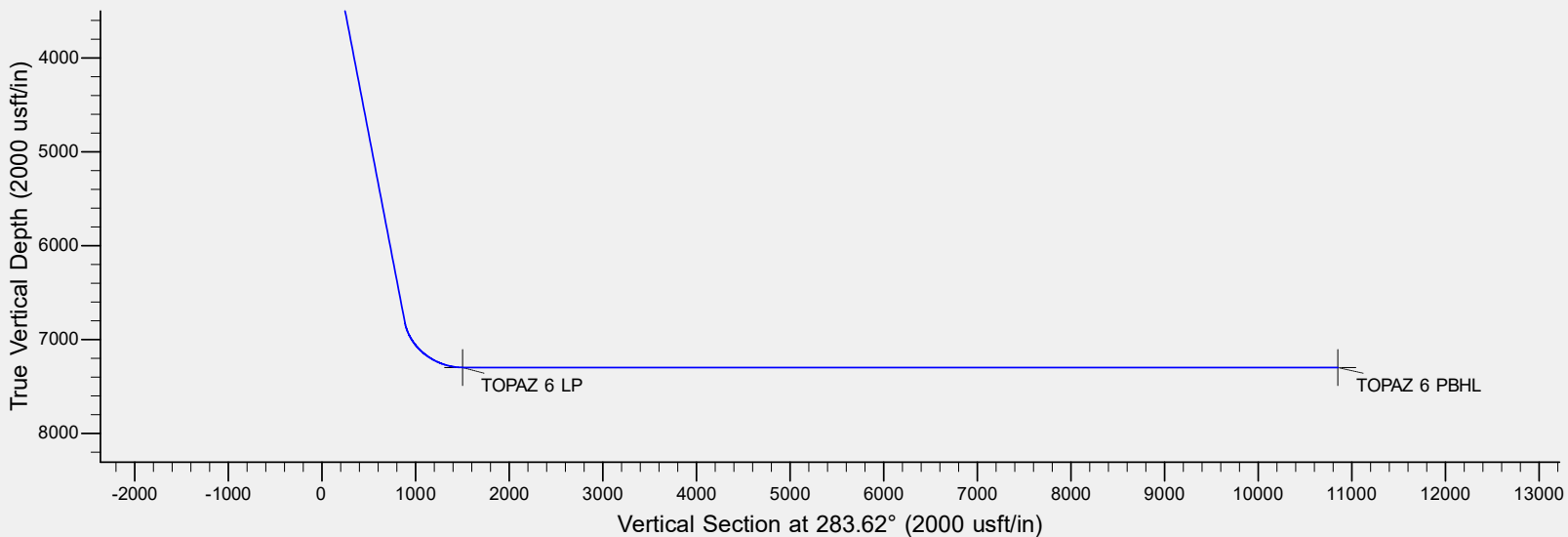
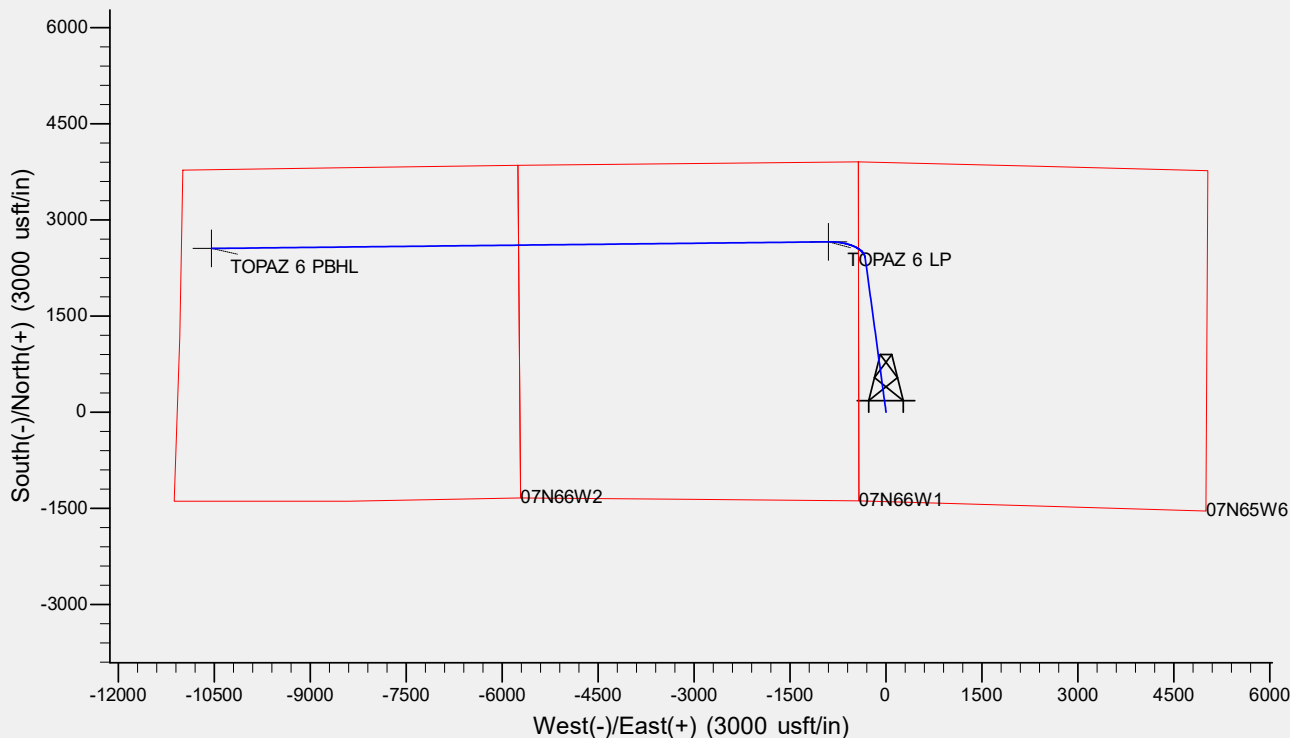
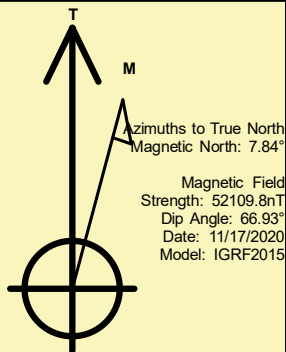

Bayswater Exploration & Production LLC

Planning Report

Database:	edm	Local Co-ordinate Reference:	Well TOPAZ 06
Company:	Bayswater Exploration & Production, LLC	TVD Reference:	KB @ 4966.0usft (Original Well Elev)
Project:	DJ Basin	MD Reference:	KB @ 4966.0usft (Original Well Elev)
Site:	Topaz Pad 6-I HZ Pad	North Reference:	True
Well:	TOPAZ 06	Survey Calculation Method:	Minimum Curvature
Wellbore:	Wellbore #1		
Design:	Design #1		

Project	DJ Basin, DJ Basin		
Map System:	US State Plane 1983	System Datum:	Mean Sea Level
Geo Datum:	North American Datum 1983		
Map Zone:	Colorado Northern Zone		

Site		Topaz Pad 6-I HZ Pad			
Site Position:		Northing:	1,462,796.90 usft	Latitude:	40° 36' 4.046 N
From:	Lat/Long	Easting:	3,218,098.27 usft	Longitude:	104° 42' 52.456 W
Position Uncertainty:	0.0 usft	Slot Radius:	13-3/16 "	Grid Convergence:	0.51 °

Well	TOPAZ 06					
Well Position	+N/-S	-17.5 usft	Northing:	1,462,780.05 usft	Latitude:	40° 36' 3.873 N
	+E/-W	73.0 usft	Easting:	3,218,171.46 usft	Longitude:	104° 42' 51.509 W
Position Uncertainty		0.0 usft	Wellhead Elevation:		Ground Level:	4,946.0 usft

Wellbore	Wellbore #1				
Magnetics	Model Name	Sample Date	Declination (°)	Dip Angle (°)	Field Strength (nT)
	IGRF2015	11/17/2020	7.84	66.93	52,109.82629776

Design	Design #1			
Audit Notes:				
Version:	Phase:	PLAN	Tie On Depth:	0.0
Vertical Section:	Depth From (TVD) (usft)	+N/-S (usft)	+E/-W (usft)	Direction (°)
	0.0	0.0	0.0	283.62

Plan Survey Tool Program	Date	11/25/2020		
Depth From (usft)	Depth To (usft)	Survey (Wellbore)	Tool Name	Remarks
1	0.0	17,907.9	Design #1 (Wellbore #1)	MWD
				OWSG MWD - Standard

Plan Sections										
Measured Depth (usft)	Inclination (°)	Azimuth (°)	Vertical Depth (usft)	+N/-S (usft)	+E/-W (usft)	Dogleg Rate (°/100usft)	Build Rate (°/100usft)	Turn Rate (°/100usft)	TFO (°)	Target
0.0	0.00	0.00	0.0	0.0	0.0	0.00	0.00	0.00	0.00	
1,500.0	0.00	0.00	1,500.0	0.0	0.0	0.00	0.00	0.00	0.00	
2,892.7	27.85	352.28	2,838.5	328.9	-44.6	2.00	2.00	0.00	352.28	
7,395.9	27.85	352.28	6,819.9	2,413.9	-327.2	0.00	0.00	0.00	0.00	
8,262.7	90.00	269.39	7,298.0	2,658.4	-901.8	10.00	7.17	-9.56	-83.71	TOPAZ 6 LP
17,907.9	90.00	269.39	7,298.0	2,555.0	-10,546.5	0.00	0.00	0.00	0.00	TOPAZ 6 PBHL

Bayswater Exploration & Production LLC

Planning Report

Database:	edm	Local Co-ordinate Reference:	Well TOPAZ 06
Company:	Bayswater Exploration & Production, LLC	TVD Reference:	KB @ 4966.0usft (Original Well Elev)
Project:	DJ Basin	MD Reference:	KB @ 4966.0usft (Original Well Elev)
Site:	Topaz Pad 6-I HZ Pad	North Reference:	True
Well:	TOPAZ 06	Survey Calculation Method:	Minimum Curvature
Wellbore:	Wellbore #1		
Design:	Design #1		

Planned Survey									
Measured Depth (usft)	Inclination (°)	Azimuth (°)	Vertical Depth (usft)	+N/-S (usft)	+E/-W (usft)	Vertical Section (usft)	Dogleg Rate (°/100usft)	Build Rate (°/100usft)	Turn Rate (°/100usft)
0.0	0.00	0.00	0.0	0.0	0.0	0.0	0.00	0.00	0.00
100.0	0.00	0.00	100.0	0.0	0.0	0.0	0.00	0.00	0.00
200.0	0.00	0.00	200.0	0.0	0.0	0.0	0.00	0.00	0.00
300.0	0.00	0.00	300.0	0.0	0.0	0.0	0.00	0.00	0.00
400.0	0.00	0.00	400.0	0.0	0.0	0.0	0.00	0.00	0.00
500.0	0.00	0.00	500.0	0.0	0.0	0.0	0.00	0.00	0.00
600.0	0.00	0.00	600.0	0.0	0.0	0.0	0.00	0.00	0.00
700.0	0.00	0.00	700.0	0.0	0.0	0.0	0.00	0.00	0.00
800.0	0.00	0.00	800.0	0.0	0.0	0.0	0.00	0.00	0.00
900.0	0.00	0.00	900.0	0.0	0.0	0.0	0.00	0.00	0.00
1,000.0	0.00	0.00	1,000.0	0.0	0.0	0.0	0.00	0.00	0.00
1,100.0	0.00	0.00	1,100.0	0.0	0.0	0.0	0.00	0.00	0.00
1,200.0	0.00	0.00	1,200.0	0.0	0.0	0.0	0.00	0.00	0.00
1,300.0	0.00	0.00	1,300.0	0.0	0.0	0.0	0.00	0.00	0.00
1,400.0	0.00	0.00	1,400.0	0.0	0.0	0.0	0.00	0.00	0.00
1,500.0	0.00	0.00	1,500.0	0.0	0.0	0.0	0.00	0.00	0.00
1,600.0	2.00	352.28	1,600.0	1.7	-0.2	0.6	2.00	2.00	0.00
1,700.0	4.00	352.28	1,699.8	6.9	-0.9	2.5	2.00	2.00	0.00
1,800.0	6.00	352.28	1,799.5	15.6	-2.1	5.7	2.00	2.00	0.00
1,900.0	8.00	352.28	1,898.7	27.6	-3.7	10.1	2.00	2.00	0.00
2,000.0	10.00	352.28	1,997.5	43.1	-5.8	15.8	2.00	2.00	0.00
2,100.0	12.00	352.28	2,095.6	62.0	-8.4	22.8	2.00	2.00	0.00
2,200.0	14.00	352.28	2,193.1	84.3	-11.4	31.0	2.00	2.00	0.00
2,300.0	16.00	352.28	2,289.6	110.0	-14.9	40.4	2.00	2.00	0.00
2,400.0	18.00	352.28	2,385.3	138.9	-18.8	51.0	2.00	2.00	0.00
2,500.0	20.00	352.28	2,479.8	171.2	-23.2	62.9	2.00	2.00	0.00
2,600.0	22.00	352.28	2,573.2	206.7	-28.0	75.9	2.00	2.00	0.00
2,700.0	24.00	352.28	2,665.2	245.4	-33.3	90.1	2.00	2.00	0.00
2,800.0	26.00	352.28	2,755.8	287.3	-38.9	105.5	2.00	2.00	0.00
2,892.7	27.85	352.28	2,838.5	328.9	-44.6	120.8	2.00	2.00	0.00
2,900.0	27.85	352.28	2,844.9	332.3	-45.0	122.0	0.00	0.00	0.00
3,000.0	27.85	352.28	2,933.4	378.6	-51.3	139.0	0.00	0.00	0.00
3,100.0	27.85	352.28	3,021.8	424.9	-57.6	156.0	0.00	0.00	0.00
3,200.0	27.85	352.28	3,110.2	471.2	-63.9	173.0	0.00	0.00	0.00
3,300.0	27.85	352.28	3,198.6	517.5	-70.1	190.0	0.00	0.00	0.00
3,400.0	27.85	352.28	3,287.0	563.8	-76.4	207.0	0.00	0.00	0.00
3,500.0	27.85	352.28	3,375.4	610.1	-82.7	224.0	0.00	0.00	0.00
3,600.0	27.85	352.28	3,463.8	656.4	-89.0	241.0	0.00	0.00	0.00
3,700.0	27.85	352.28	3,552.2	702.7	-95.2	258.0	0.00	0.00	0.00
3,800.0	27.85	352.28	3,640.7	749.0	-101.5	275.0	0.00	0.00	0.00
3,900.0	27.85	352.28	3,729.1	795.3	-107.8	292.0	0.00	0.00	0.00
4,000.0	27.85	352.28	3,817.5	841.6	-114.1	309.0	0.00	0.00	0.00
4,100.0	27.85	352.28	3,905.9	887.9	-120.3	326.0	0.00	0.00	0.00
4,200.0	27.85	352.28	3,994.3	934.2	-126.6	343.0	0.00	0.00	0.00
4,300.0	27.85	352.28	4,082.7	980.5	-132.9	360.0	0.00	0.00	0.00
4,400.0	27.85	352.28	4,171.1	1,026.8	-139.2	377.0	0.00	0.00	0.00
4,500.0	27.85	352.28	4,259.6	1,073.1	-145.4	394.0	0.00	0.00	0.00
4,600.0	27.85	352.28	4,348.0	1,119.4	-151.7	411.0	0.00	0.00	0.00
4,700.0	27.85	352.28	4,436.4	1,165.7	-158.0	428.0	0.00	0.00	0.00
4,800.0	27.85	352.28	4,524.8	1,212.0	-164.3	445.0	0.00	0.00	0.00
4,900.0	27.85	352.28	4,613.2	1,258.3	-170.5	462.0	0.00	0.00	0.00
5,000.0	27.85	352.28	4,701.6	1,304.6	-176.8	479.0	0.00	0.00	0.00
5,100.0	27.85	352.28	4,790.0	1,350.9	-183.1	496.0	0.00	0.00	0.00
5,200.0	27.85	352.28	4,878.5	1,397.2	-189.4	513.0	0.00	0.00	0.00

Bayswater Exploration & Production LLC

Planning Report

Database:	edm	Local Co-ordinate Reference:	Well TOPAZ 06
Company:	Bayswater Exploration & Production, LLC	TVD Reference:	KB @ 4966.0usft (Original Well Elev)
Project:	DJ Basin	MD Reference:	KB @ 4966.0usft (Original Well Elev)
Site:	Topaz Pad 6-I HZ Pad	North Reference:	True
Well:	TOPAZ 06	Survey Calculation Method:	Minimum Curvature
Wellbore:	Wellbore #1		
Design:	Design #1		

Planned Survey									
Measured Depth (usft)	Inclination (°)	Azimuth (°)	Vertical Depth (usft)	+N/-S (usft)	+E/-W (usft)	Vertical Section (usft)	Dogleg Rate (°/100usft)	Build Rate (°/100usft)	Turn Rate (°/100usft)
5,300.0	27.85	352.28	4,966.9	1,443.5	-195.6	530.0	0.00	0.00	0.00
5,400.0	27.85	352.28	5,055.3	1,489.8	-201.9	547.0	0.00	0.00	0.00
5,500.0	27.85	352.28	5,143.7	1,536.1	-208.2	564.0	0.00	0.00	0.00
5,600.0	27.85	352.28	5,232.1	1,582.4	-214.5	581.0	0.00	0.00	0.00
5,700.0	27.85	352.28	5,320.5	1,628.7	-220.7	598.0	0.00	0.00	0.00
5,800.0	27.85	352.28	5,408.9	1,675.0	-227.0	615.0	0.00	0.00	0.00
5,900.0	27.85	352.28	5,497.3	1,721.3	-233.3	632.0	0.00	0.00	0.00
6,000.0	27.85	352.28	5,585.8	1,767.6	-239.6	649.0	0.00	0.00	0.00
6,100.0	27.85	352.28	5,674.2	1,813.9	-245.8	666.0	0.00	0.00	0.00
6,200.0	27.85	352.28	5,762.6	1,860.2	-252.1	683.0	0.00	0.00	0.00
6,300.0	27.85	352.28	5,851.0	1,906.5	-258.4	700.0	0.00	0.00	0.00
6,400.0	27.85	352.28	5,939.4	1,952.8	-264.7	717.0	0.00	0.00	0.00
6,500.0	27.85	352.28	6,027.8	1,999.1	-270.9	734.0	0.00	0.00	0.00
6,600.0	27.85	352.28	6,116.2	2,045.4	-277.2	751.0	0.00	0.00	0.00
6,700.0	27.85	352.28	6,204.7	2,091.7	-283.5	768.0	0.00	0.00	0.00
6,800.0	27.85	352.28	6,293.1	2,138.0	-289.8	785.0	0.00	0.00	0.00
6,900.0	27.85	352.28	6,381.5	2,184.3	-296.0	802.0	0.00	0.00	0.00
7,000.0	27.85	352.28	6,469.9	2,230.6	-302.3	819.0	0.00	0.00	0.00
7,100.0	27.85	352.28	6,558.3	2,276.9	-308.6	836.0	0.00	0.00	0.00
7,200.0	27.85	352.28	6,646.7	2,323.2	-314.9	853.0	0.00	0.00	0.00
7,300.0	27.85	352.28	6,735.1	2,369.5	-321.1	870.0	0.00	0.00	0.00
7,395.9	27.85	352.28	6,819.9	2,413.9	-327.2	886.3	0.00	0.00	0.00
7,400.0	27.90	351.41	6,823.5	2,415.8	-327.4	887.0	10.00	1.16	-21.24
7,500.0	30.65	331.65	6,911.0	2,461.5	-343.1	913.0	10.00	2.74	-19.76
7,600.0	35.83	315.97	6,994.7	2,505.0	-375.6	954.9	10.00	5.18	-15.68
7,700.0	42.56	304.21	7,072.3	2,545.2	-424.0	1,011.4	10.00	6.73	-11.75
7,800.0	50.21	295.29	7,141.3	2,580.7	-486.9	1,080.9	10.00	7.65	-8.93
7,900.0	58.40	288.21	7,199.7	2,610.5	-562.3	1,161.1	10.00	8.19	-7.08
8,000.0	66.92	282.30	7,245.6	2,633.7	-647.9	1,249.8	10.00	8.52	-5.91
8,100.0	75.63	277.11	7,277.7	2,649.5	-741.1	1,344.1	10.00	8.71	-5.19
8,200.0	84.45	272.31	7,295.0	2,657.5	-839.2	1,441.3	10.00	8.82	-4.80
8,262.7	90.00	269.39	7,298.0	2,658.4	-901.8	1,502.4	10.00	8.85	-4.66
8,300.0	90.00	269.39	7,298.0	2,658.0	-939.1	1,538.5	0.00	0.00	0.00
8,400.0	90.00	269.39	7,298.0	2,657.0	-1,039.1	1,635.4	0.00	0.00	0.00
8,500.0	90.00	269.39	7,298.0	2,655.9	-1,139.1	1,732.4	0.00	0.00	0.00
8,600.0	90.00	269.39	7,298.0	2,654.8	-1,239.1	1,829.3	0.00	0.00	0.00
8,700.0	90.00	269.39	7,298.0	2,653.8	-1,339.0	1,926.2	0.00	0.00	0.00
8,800.0	90.00	269.39	7,298.0	2,652.7	-1,439.0	2,023.2	0.00	0.00	0.00
8,900.0	90.00	269.39	7,298.0	2,651.6	-1,539.0	2,120.1	0.00	0.00	0.00
9,000.0	90.00	269.39	7,298.0	2,650.5	-1,639.0	2,217.0	0.00	0.00	0.00
9,100.0	90.00	269.39	7,298.0	2,649.5	-1,739.0	2,314.0	0.00	0.00	0.00
9,200.0	90.00	269.39	7,298.0	2,648.4	-1,839.0	2,410.9	0.00	0.00	0.00
9,300.0	90.00	269.39	7,298.0	2,647.3	-1,939.0	2,507.8	0.00	0.00	0.00
9,400.0	90.00	269.39	7,298.0	2,646.2	-2,039.0	2,604.7	0.00	0.00	0.00
9,500.0	90.00	269.39	7,298.0	2,645.2	-2,139.0	2,701.7	0.00	0.00	0.00
9,600.0	90.00	269.39	7,298.0	2,644.1	-2,239.0	2,798.6	0.00	0.00	0.00
9,700.0	90.00	269.39	7,298.0	2,643.0	-2,339.0	2,895.5	0.00	0.00	0.00
9,800.0	90.00	269.39	7,298.0	2,642.0	-2,439.0	2,992.5	0.00	0.00	0.00
9,900.0	90.00	269.39	7,298.0	2,640.9	-2,539.0	3,089.4	0.00	0.00	0.00
10,000.0	90.00	269.39	7,298.0	2,639.8	-2,639.0	3,186.3	0.00	0.00	0.00
10,100.0	90.00	269.39	7,298.0	2,638.7	-2,739.0	3,283.3	0.00	0.00	0.00
10,200.0	90.00	269.39	7,298.0	2,637.7	-2,839.0	3,380.2	0.00	0.00	0.00
10,300.0	90.00	269.39	7,298.0	2,636.6	-2,939.0	3,477.1	0.00	0.00	0.00
10,400.0	90.00	269.39	7,298.0	2,635.5	-3,038.9	3,574.1	0.00	0.00	0.00

Bayswater Exploration & Production LLC

Planning Report

Database:	edm	Local Co-ordinate Reference:	Well TOPAZ 06
Company:	Bayswater Exploration & Production, LLC	TVD Reference:	KB @ 4966.0usft (Original Well Elev)
Project:	DJ Basin	MD Reference:	KB @ 4966.0usft (Original Well Elev)
Site:	Topaz Pad 6-I HZ Pad	North Reference:	True
Well:	TOPAZ 06	Survey Calculation Method:	Minimum Curvature
Wellbore:	Wellbore #1		
Design:	Design #1		

Planned Survey										
Measured Depth (usft)	Inclination (°)	Azimuth (°)	Vertical Depth (usft)	+N/-S (usft)	+E/-W (usft)	Vertical Section (usft)	Dogleg Rate (°/100usft)	Build Rate (°/100usft)	Turn Rate (°/100usft)	
10,500.0	90.00	269.39	7,298.0	2,634.5	-3,138.9	3,671.0	0.00	0.00	0.00	
10,600.0	90.00	269.39	7,298.0	2,633.4	-3,238.9	3,767.9	0.00	0.00	0.00	
10,700.0	90.00	269.39	7,298.0	2,632.3	-3,338.9	3,864.8	0.00	0.00	0.00	
10,800.0	90.00	269.39	7,298.0	2,631.2	-3,438.9	3,961.8	0.00	0.00	0.00	
10,900.0	90.00	269.39	7,298.0	2,630.2	-3,538.9	4,058.7	0.00	0.00	0.00	
11,000.0	90.00	269.39	7,298.0	2,629.1	-3,638.9	4,155.6	0.00	0.00	0.00	
11,100.0	90.00	269.39	7,298.0	2,628.0	-3,738.9	4,252.6	0.00	0.00	0.00	
11,200.0	90.00	269.39	7,298.0	2,626.9	-3,838.9	4,349.5	0.00	0.00	0.00	
11,300.0	90.00	269.39	7,298.0	2,625.9	-3,938.9	4,446.4	0.00	0.00	0.00	
11,400.0	90.00	269.39	7,298.0	2,624.8	-4,038.9	4,543.4	0.00	0.00	0.00	
11,500.0	90.00	269.39	7,298.0	2,623.7	-4,138.9	4,640.3	0.00	0.00	0.00	
11,600.0	90.00	269.39	7,298.0	2,622.7	-4,238.9	4,737.2	0.00	0.00	0.00	
11,700.0	90.00	269.39	7,298.0	2,621.6	-4,338.9	4,834.2	0.00	0.00	0.00	
11,800.0	90.00	269.39	7,298.0	2,620.5	-4,438.9	4,931.1	0.00	0.00	0.00	
11,900.0	90.00	269.39	7,298.0	2,619.4	-4,538.9	5,028.0	0.00	0.00	0.00	
12,000.0	90.00	269.39	7,298.0	2,618.4	-4,638.9	5,124.9	0.00	0.00	0.00	
12,100.0	90.00	269.39	7,298.0	2,617.3	-4,738.9	5,221.9	0.00	0.00	0.00	
12,200.0	90.00	269.39	7,298.0	2,616.2	-4,838.8	5,318.8	0.00	0.00	0.00	
12,300.0	90.00	269.39	7,298.0	2,615.2	-4,938.8	5,415.7	0.00	0.00	0.00	
12,400.0	90.00	269.39	7,298.0	2,614.1	-5,038.8	5,512.7	0.00	0.00	0.00	
12,500.0	90.00	269.39	7,298.0	2,613.0	-5,138.8	5,609.6	0.00	0.00	0.00	
12,600.0	90.00	269.39	7,298.0	2,611.9	-5,238.8	5,706.5	0.00	0.00	0.00	
12,700.0	90.00	269.39	7,298.0	2,610.9	-5,338.8	5,803.5	0.00	0.00	0.00	
12,800.0	90.00	269.39	7,298.0	2,609.8	-5,438.8	5,900.4	0.00	0.00	0.00	
12,900.0	90.00	269.39	7,298.0	2,608.7	-5,538.8	5,997.3	0.00	0.00	0.00	
13,000.0	90.00	269.39	7,298.0	2,607.6	-5,638.8	6,094.2	0.00	0.00	0.00	
13,100.0	90.00	269.39	7,298.0	2,606.6	-5,738.8	6,191.2	0.00	0.00	0.00	
13,200.0	90.00	269.39	7,298.0	2,605.5	-5,838.8	6,288.1	0.00	0.00	0.00	
13,300.0	90.00	269.39	7,298.0	2,604.4	-5,938.8	6,385.0	0.00	0.00	0.00	
13,400.0	90.00	269.39	7,298.0	2,603.4	-6,038.8	6,482.0	0.00	0.00	0.00	
13,500.0	90.00	269.39	7,298.0	2,602.3	-6,138.8	6,578.9	0.00	0.00	0.00	
13,600.0	90.00	269.39	7,298.0	2,601.2	-6,238.8	6,675.8	0.00	0.00	0.00	
13,700.0	90.00	269.39	7,298.0	2,600.1	-6,338.8	6,772.8	0.00	0.00	0.00	
13,800.0	90.00	269.39	7,298.0	2,599.1	-6,438.8	6,869.7	0.00	0.00	0.00	
13,900.0	90.00	269.39	7,298.0	2,598.0	-6,538.7	6,966.6	0.00	0.00	0.00	
14,000.0	90.00	269.39	7,298.0	2,596.9	-6,638.7	7,063.6	0.00	0.00	0.00	
14,100.0	90.00	269.39	7,298.0	2,595.9	-6,738.7	7,160.5	0.00	0.00	0.00	
14,200.0	90.00	269.39	7,298.0	2,594.8	-6,838.7	7,257.4	0.00	0.00	0.00	
14,300.0	90.00	269.39	7,298.0	2,593.7	-6,938.7	7,354.3	0.00	0.00	0.00	
14,400.0	90.00	269.39	7,298.0	2,592.6	-7,038.7	7,451.3	0.00	0.00	0.00	
14,500.0	90.00	269.39	7,298.0	2,591.6	-7,138.7	7,548.2	0.00	0.00	0.00	
14,600.0	90.00	269.39	7,298.0	2,590.5	-7,238.7	7,645.1	0.00	0.00	0.00	
14,700.0	90.00	269.39	7,298.0	2,589.4	-7,338.7	7,742.1	0.00	0.00	0.00	
14,800.0	90.00	269.39	7,298.0	2,588.4	-7,438.7	7,839.0	0.00	0.00	0.00	
14,900.0	90.00	269.39	7,298.0	2,587.3	-7,538.7	7,935.9	0.00	0.00	0.00	
15,000.0	90.00	269.39	7,298.0	2,586.2	-7,638.7	8,032.9	0.00	0.00	0.00	
15,100.0	90.00	269.39	7,298.0	2,585.1	-7,738.7	8,129.8	0.00	0.00	0.00	
15,200.0	90.00	269.39	7,298.0	2,584.1	-7,838.7	8,226.7	0.00	0.00	0.00	
15,300.0	90.00	269.39	7,298.0	2,583.0	-7,938.7	8,323.7	0.00	0.00	0.00	
15,400.0	90.00	269.39	7,298.0	2,581.9	-8,038.7	8,420.6	0.00	0.00	0.00	
15,500.0	90.00	269.39	7,298.0	2,580.8	-8,138.7	8,517.5	0.00	0.00	0.00	
15,600.0	90.00	269.39	7,298.0	2,579.8	-8,238.7	8,614.4	0.00	0.00	0.00	
15,700.0	90.00	269.39	7,298.0	2,578.7	-8,338.6	8,711.4	0.00	0.00	0.00	
15,800.0	90.00	269.39	7,298.0	2,577.6	-8,438.6	8,808.3	0.00	0.00	0.00	

Bayswater Exploration & Production LLC

Planning Report

Database:	edm	Local Co-ordinate Reference:	Well TOPAZ 06
Company:	Bayswater Exploration & Production, LLC	TVD Reference:	KB @ 4966.0usft (Original Well Elev)
Project:	DJ Basin	MD Reference:	KB @ 4966.0usft (Original Well Elev)
Site:	Topaz Pad 6-I HZ Pad	North Reference:	True
Well:	TOPAZ 06	Survey Calculation Method:	Minimum Curvature
Wellbore:	Wellbore #1		
Design:	Design #1		

Planned Survey										
Measured Depth (usft)	Inclination (°)	Azimuth (°)	Vertical Depth (usft)	+N/-S (usft)	+E/-W (usft)	Vertical Section (usft)	Dogleg Rate (°/100usft)	Build Rate (°/100usft)	Turn Rate (°/100usft)	
15,900.0	90.00	269.39	7,298.0	2,576.6	-8,538.6	8,905.2	0.00	0.00	0.00	
16,000.0	90.00	269.39	7,298.0	2,575.5	-8,638.6	9,002.2	0.00	0.00	0.00	
16,100.0	90.00	269.39	7,298.0	2,574.4	-8,738.6	9,099.1	0.00	0.00	0.00	
16,200.0	90.00	269.39	7,298.0	2,573.3	-8,838.6	9,196.0	0.00	0.00	0.00	
16,300.0	90.00	269.39	7,298.0	2,572.3	-8,938.6	9,293.0	0.00	0.00	0.00	
16,400.0	90.00	269.39	7,298.0	2,571.2	-9,038.6	9,389.9	0.00	0.00	0.00	
16,500.0	90.00	269.39	7,298.0	2,570.1	-9,138.6	9,486.8	0.00	0.00	0.00	
16,600.0	90.00	269.39	7,298.0	2,569.1	-9,238.6	9,583.7	0.00	0.00	0.00	
16,700.0	90.00	269.39	7,298.0	2,568.0	-9,338.6	9,680.7	0.00	0.00	0.00	
16,800.0	90.00	269.39	7,298.0	2,566.9	-9,438.6	9,777.6	0.00	0.00	0.00	
16,900.0	90.00	269.39	7,298.0	2,565.8	-9,538.6	9,874.5	0.00	0.00	0.00	
17,000.0	90.00	269.39	7,298.0	2,564.8	-9,638.6	9,971.5	0.00	0.00	0.00	
17,100.0	90.00	269.39	7,298.0	2,563.7	-9,738.6	10,068.4	0.00	0.00	0.00	
17,200.0	90.00	269.39	7,298.0	2,562.6	-9,838.6	10,165.3	0.00	0.00	0.00	
17,300.0	90.00	269.39	7,298.0	2,561.5	-9,938.6	10,262.3	0.00	0.00	0.00	
17,400.0	90.00	269.39	7,298.0	2,560.5	-10,038.5	10,359.2	0.00	0.00	0.00	
17,500.0	90.00	269.39	7,298.0	2,559.4	-10,138.5	10,456.1	0.00	0.00	0.00	
17,600.0	90.00	269.39	7,298.0	2,558.3	-10,238.5	10,553.1	0.00	0.00	0.00	
17,700.0	90.00	269.39	7,298.0	2,557.3	-10,338.5	10,650.0	0.00	0.00	0.00	
17,800.0	90.00	269.39	7,298.0	2,556.2	-10,438.5	10,746.9	0.00	0.00	0.00	
17,900.0	90.00	269.39	7,298.0	2,555.1	-10,538.5	10,843.8	0.00	0.00	0.00	
17,907.9	90.00	269.39	7,298.0	2,555.0	-10,546.5	10,851.5	0.00	0.00	0.00	

Design Targets										
Target Name	Dip Angle (°)	Dip Dir. (°)	TVD (usft)	+N/-S (usft)	+E/-W (usft)	Northing (usft)	Easting (usft)	Latitude		Longitude
TOPAZ 6 LP	0.00	0.00	7,298.0	2,658.4	-901.8	1,465,430.40	3,217,246.12	40° 36' 30.143 N		104° 43' 3.202 W
- hit/miss target										
- Shape										
- Point										
TOPAZ 6 PBHL	0.00	0.00	7,298.0	2,555.0	-10,546.5	1,465,241.54	3,207,602.77	40° 36' 29.099 N		104° 45' 8.251 W
- plan hits target center										
- Point										