

Bayswater Exploration & Production, LLC

DJ Basin

Topaz Pad 6-I HZ Pad

TOPAZ 04

Wellbore #1

Plan: Design #1

Standard Planning Report

25 November, 2020



Pad Name: Topaz Pad 6-I HZ Pad
Well Name: TOPAZ 04
Ground Level: 4946.0
SHL Latitude: 40° 36' 3.942 N
SHL Longitude: 104° 42' 51.887 W

SECTION DETAILS

Sec	MD	Inc	Azi	TVD	+N/-S	+E/-W	Dleg	TFace	VSect	Target
1	0.0	0.00	0.00	0.0	0.0	0.0	0.00	0.00	0.0	
2	1500.0	0.00	0.00	1500.0	0.0	0.0	0.00	0.00	0.0	
3	3116.9	32.34	353.97	3032.4	441.9	-46.7	2.00	353.97	165.3	
4	7545.7	32.34	353.97	6774.3	2797.8	-295.7	0.00	0.00	1046.3	
5	8418.9	90.24	269.35	7234.0	3082.5	-873.2	10.00	-85.32	1679.5	TOPAZ 4 LP
6	18056.0	90.24	269.35	7194.0	2974.0	-10509.6	0.00	0.00	10922.3	TOPAZ 4 PBHL

DESIGN TARGET DETAILS

Name	TVD	+N/-S	+E/-W	Northing	Easting	Latitude	Longitude	Shape
TOPAZ 4 LP	7234.0	3082.5	-873.2	1465861.36	3217241.76	40° 36' 34.402 N	104° 43' 3.209 W	Point
TOPAZ 4 PBHL	- plan hits target center 7194.0	2974.0	-10509.6	1465667.47	3207606.67	40° 36' 33.307 N	104° 45' 8.154 W	Point
	- plan hits target center							

REFERENCE INFORMATION

Co-ordinate (N/E) Reference: Well TOPAZ 04, True North
Vertical (TVD) Reference: KB @ 4966.0usft (Original Well Elev)
Section (VS) Reference: Slot - (0.0N, 0.0E)
Measured Depth Reference: KB @ 4966.0usft (Original Well Elev)
Calculation Method: Minimum Curvature

CASING DETAILS

No casing data is available

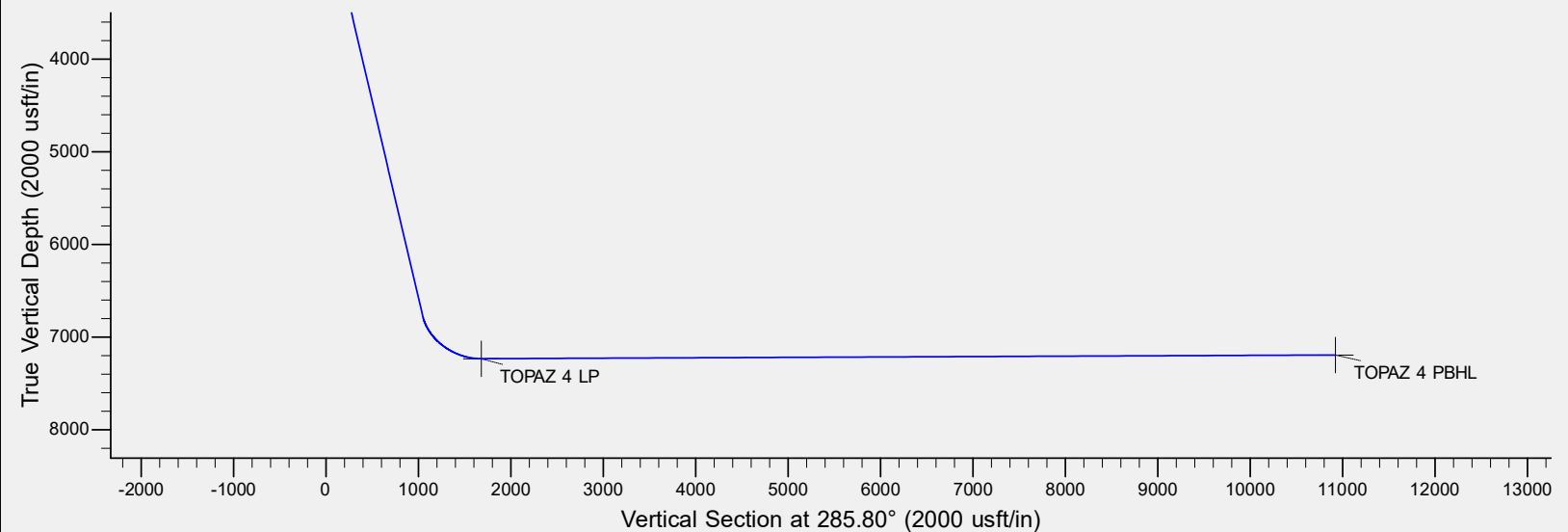
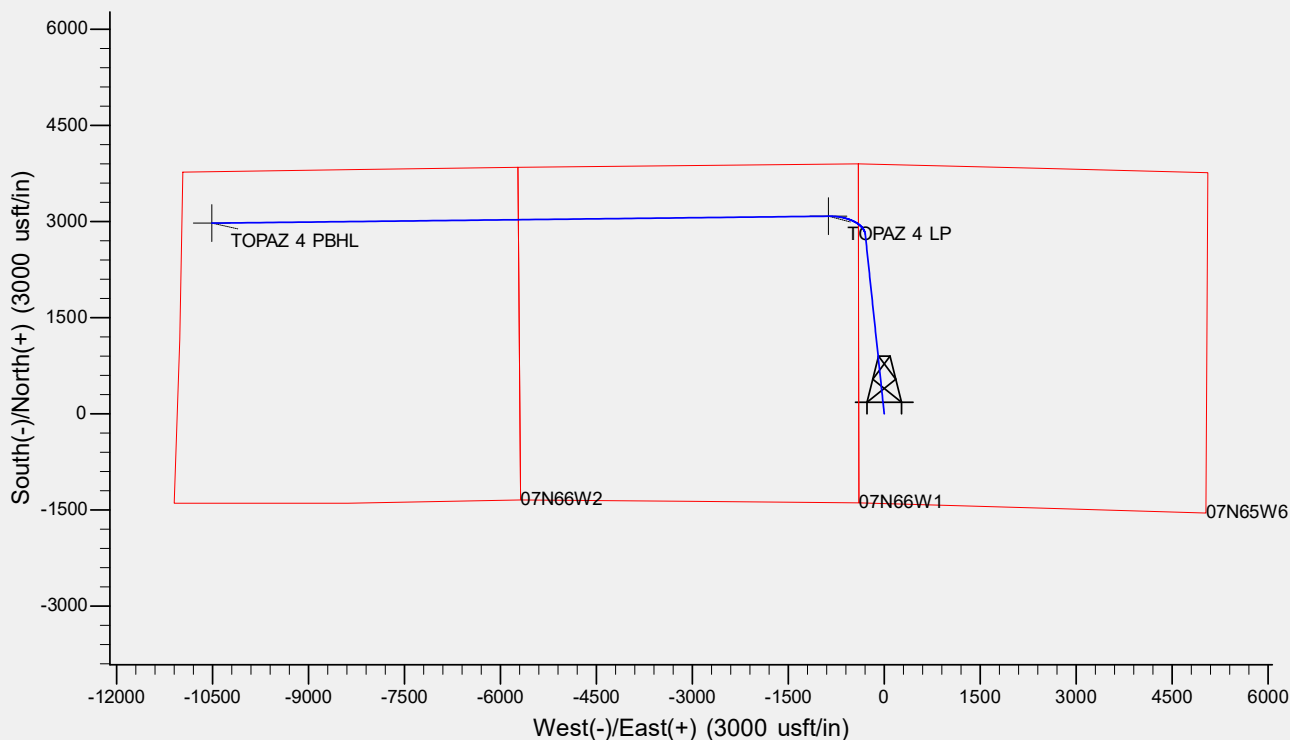
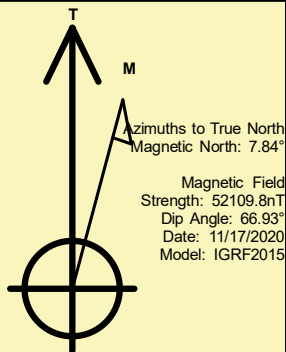

Bayswater Exploration & Production LLC

Planning Report

Database:	edm	Local Co-ordinate Reference:	Well TOPAZ 04
Company:	Bayswater Exploration & Production, LLC	TVD Reference:	KB @ 4966.0usft (Original Well Elev)
Project:	DJ Basin	MD Reference:	KB @ 4966.0usft (Original Well Elev)
Site:	Topaz Pad 6-I HZ Pad	North Reference:	True
Well:	TOPAZ 04	Survey Calculation Method:	Minimum Curvature
Wellbore:	Wellbore #1		
Design:	Design #1		

Project	DJ Basin, DJ Basin		
Map System:	US State Plane 1983	System Datum:	Mean Sea Level
Geo Datum:	North American Datum 1983		
Map Zone:	Colorado Northern Zone		

Site		Topaz Pad 6-I HZ Pad			
Site Position:		Northing:	1,462,796.90 usft	Latitude:	40° 36' 4.046 N
From:	Lat/Long	Easting:	3,218,098.27 usft	Longitude:	104° 42' 52.456 W
Position Uncertainty:	0.0 usft	Slot Radius:	13-3/16 "	Grid Convergence:	0.51 °

Well	TOPAZ 04					
Well Position	+N/-S	-10.6 usft	Northing:	1,462,786.72 usft	Latitude:	40° 36' 3.942 N
	+E/-W	43.9 usft	Easting:	3,218,142.24 usft	Longitude:	104° 42' 51.887 W
Position Uncertainty		0.0 usft	Wellhead Elevation:		Ground Level:	4,946.0 usft

Wellbore	Wellbore #1				
Magnetics	Model Name	Sample Date	Declination (°)	Dip Angle (°)	Field Strength (nT)
	IGRF2015	11/17/2020	7.84	66.93	52,109.82524883

Design	Design #1			
Audit Notes:				
Version:	Phase:	PLAN	Tie On Depth:	0.0
Vertical Section:	Depth From (TVD) (usft)	+N/-S (usft)	+E/-W (usft)	Direction (°)
	0.0	0.0	0.0	285.80

Plan Survey Tool Program	Date	11/25/2020		
Depth From (usft)	Depth To (usft)	Survey (Wellbore)	Tool Name	Remarks
1	0.0	18,056.0	Design #1 (Wellbore #1)	MWD
				OWSG MWD - Standard

Plan Sections										
Measured Depth (usft)	Inclination (°)	Azimuth (°)	Vertical Depth (usft)	+N/-S (usft)	+E/-W (usft)	Dogleg Rate (°/100usft)	Build Rate (°/100usft)	Turn Rate (°/100usft)	TFO (°)	Target
0.0	0.00	0.00	0.0	0.0	0.0	0.00	0.00	0.00	0.00	
1,500.0	0.00	0.00	1,500.0	0.0	0.0	0.00	0.00	0.00	0.00	
3,116.9	32.34	353.97	3,032.4	441.9	-46.7	2.00	2.00	0.00	353.97	
7,545.7	32.34	353.97	6,774.3	2,797.8	-295.7	0.00	0.00	0.00	0.00	
8,418.9	90.24	269.35	7,234.0	3,082.5	-873.2	10.00	6.63	-9.69	-85.32	TOPAZ 4 LP
18,056.0	90.24	269.35	7,194.0	2,974.0	-10,509.6	0.00	0.00	0.00	0.00	TOPAZ 4 PBHL

Bayswater Exploration & Production LLC

Planning Report

Database:	edm	Local Co-ordinate Reference:	Well TOPAZ 04
Company:	Bayswater Exploration & Production, LLC	TVD Reference:	KB @ 4966.0usft (Original Well Elev)
Project:	DJ Basin	MD Reference:	KB @ 4966.0usft (Original Well Elev)
Site:	Topaz Pad 6-I HZ Pad	North Reference:	True
Well:	TOPAZ 04	Survey Calculation Method:	Minimum Curvature
Wellbore:	Wellbore #1		
Design:	Design #1		

Planned Survey									
Measured Depth (usft)	Inclination (°)	Azimuth (°)	Vertical Depth (usft)	+N/-S (usft)	+E/-W (usft)	Vertical Section (usft)	Dogleg Rate (°/100usft)	Build Rate (°/100usft)	Turn Rate (°/100usft)
0.0	0.00	0.00	0.0	0.0	0.0	0.0	0.00	0.00	0.00
100.0	0.00	0.00	100.0	0.0	0.0	0.0	0.00	0.00	0.00
200.0	0.00	0.00	200.0	0.0	0.0	0.0	0.00	0.00	0.00
300.0	0.00	0.00	300.0	0.0	0.0	0.0	0.00	0.00	0.00
400.0	0.00	0.00	400.0	0.0	0.0	0.0	0.00	0.00	0.00
500.0	0.00	0.00	500.0	0.0	0.0	0.0	0.00	0.00	0.00
600.0	0.00	0.00	600.0	0.0	0.0	0.0	0.00	0.00	0.00
700.0	0.00	0.00	700.0	0.0	0.0	0.0	0.00	0.00	0.00
800.0	0.00	0.00	800.0	0.0	0.0	0.0	0.00	0.00	0.00
900.0	0.00	0.00	900.0	0.0	0.0	0.0	0.00	0.00	0.00
1,000.0	0.00	0.00	1,000.0	0.0	0.0	0.0	0.00	0.00	0.00
1,100.0	0.00	0.00	1,100.0	0.0	0.0	0.0	0.00	0.00	0.00
1,200.0	0.00	0.00	1,200.0	0.0	0.0	0.0	0.00	0.00	0.00
1,300.0	0.00	0.00	1,300.0	0.0	0.0	0.0	0.00	0.00	0.00
1,400.0	0.00	0.00	1,400.0	0.0	0.0	0.0	0.00	0.00	0.00
1,500.0	0.00	0.00	1,500.0	0.0	0.0	0.0	0.00	0.00	0.00
1,600.0	2.00	353.97	1,600.0	1.7	-0.2	0.6	2.00	2.00	0.00
1,700.0	4.00	353.97	1,699.8	6.9	-0.7	2.6	2.00	2.00	0.00
1,800.0	6.00	353.97	1,799.5	15.6	-1.6	5.8	2.00	2.00	0.00
1,900.0	8.00	353.97	1,898.7	27.7	-2.9	10.4	2.00	2.00	0.00
2,000.0	10.00	353.97	1,997.5	43.3	-4.6	16.2	2.00	2.00	0.00
2,100.0	12.00	353.97	2,095.6	62.3	-6.6	23.3	2.00	2.00	0.00
2,200.0	14.00	353.97	2,193.1	84.6	-8.9	31.6	2.00	2.00	0.00
2,300.0	16.00	353.97	2,289.6	110.4	-11.7	41.3	2.00	2.00	0.00
2,400.0	18.00	353.97	2,385.3	139.4	-14.7	52.1	2.00	2.00	0.00
2,500.0	20.00	353.97	2,479.8	171.8	-18.2	64.3	2.00	2.00	0.00
2,600.0	22.00	353.97	2,573.2	207.4	-21.9	77.6	2.00	2.00	0.00
2,700.0	24.00	353.97	2,665.2	246.3	-26.0	92.1	2.00	2.00	0.00
2,800.0	26.00	353.97	2,755.8	288.3	-30.5	107.8	2.00	2.00	0.00
2,900.0	28.00	353.97	2,844.9	333.5	-35.2	124.7	2.00	2.00	0.00
3,000.0	30.00	353.97	2,932.4	381.7	-40.3	142.7	2.00	2.00	0.00
3,100.0	32.00	353.97	3,018.1	432.9	-45.8	161.9	2.00	2.00	0.00
3,116.9	32.34	353.97	3,032.4	441.9	-46.7	165.3	2.00	2.00	0.00
3,200.0	32.34	353.97	3,102.6	486.1	-51.4	181.8	0.00	0.00	0.00
3,300.0	32.34	353.97	3,187.1	539.2	-57.0	201.7	0.00	0.00	0.00
3,400.0	32.34	353.97	3,271.6	592.4	-62.6	221.6	0.00	0.00	0.00
3,500.0	32.34	353.97	3,356.1	645.6	-68.2	241.5	0.00	0.00	0.00
3,600.0	32.34	353.97	3,440.6	698.8	-73.9	261.4	0.00	0.00	0.00
3,700.0	32.34	353.97	3,525.1	752.0	-79.5	281.3	0.00	0.00	0.00
3,800.0	32.34	353.97	3,609.6	805.2	-85.1	301.1	0.00	0.00	0.00
3,900.0	32.34	353.97	3,694.1	858.4	-90.7	321.0	0.00	0.00	0.00
4,000.0	32.34	353.97	3,778.5	911.6	-96.4	340.9	0.00	0.00	0.00
4,100.0	32.34	353.97	3,863.0	964.8	-102.0	360.8	0.00	0.00	0.00
4,200.0	32.34	353.97	3,947.5	1,018.0	-107.6	380.7	0.00	0.00	0.00
4,300.0	32.34	353.97	4,032.0	1,071.2	-113.2	400.6	0.00	0.00	0.00
4,400.0	32.34	353.97	4,116.5	1,124.4	-118.8	420.5	0.00	0.00	0.00
4,500.0	32.34	353.97	4,201.0	1,177.6	-124.5	440.4	0.00	0.00	0.00
4,600.0	32.34	353.97	4,285.5	1,230.8	-130.1	460.3	0.00	0.00	0.00
4,700.0	32.34	353.97	4,370.0	1,284.0	-135.7	480.2	0.00	0.00	0.00
4,800.0	32.34	353.97	4,454.5	1,337.2	-141.3	500.1	0.00	0.00	0.00
4,900.0	32.34	353.97	4,539.0	1,390.4	-147.0	520.0	0.00	0.00	0.00
5,000.0	32.34	353.97	4,623.4	1,443.6	-152.6	539.9	0.00	0.00	0.00
5,100.0	32.34	353.97	4,707.9	1,496.8	-158.2	559.8	0.00	0.00	0.00
5,200.0	32.34	353.97	4,792.4	1,550.0	-163.8	579.7	0.00	0.00	0.00

Bayswater Exploration & Production LLC

Planning Report

Database:	edm	Local Co-ordinate Reference:	Well TOPAZ 04
Company:	Bayswater Exploration & Production, LLC	TVD Reference:	KB @ 4966.0usft (Original Well Elev)
Project:	DJ Basin	MD Reference:	KB @ 4966.0usft (Original Well Elev)
Site:	Topaz Pad 6-I HZ Pad	North Reference:	True
Well:	TOPAZ 04	Survey Calculation Method:	Minimum Curvature
Wellbore:	Wellbore #1		
Design:	Design #1		

Planned Survey									
Measured Depth (usft)	Inclination (°)	Azimuth (°)	Vertical Depth (usft)	+N/-S (usft)	+E/-W (usft)	Vertical Section (usft)	Dogleg Rate (°/100usft)	Build Rate (°/100usft)	Turn Rate (°/100usft)
5,300.0	32.34	353.97	4,876.9	1,603.2	-169.5	599.6	0.00	0.00	0.00
5,400.0	32.34	353.97	4,961.4	1,656.4	-175.1	619.5	0.00	0.00	0.00
5,500.0	32.34	353.97	5,045.9	1,709.6	-180.7	639.4	0.00	0.00	0.00
5,600.0	32.34	353.97	5,130.4	1,762.8	-186.3	659.3	0.00	0.00	0.00
5,700.0	32.34	353.97	5,214.9	1,816.0	-191.9	679.1	0.00	0.00	0.00
5,800.0	32.34	353.97	5,299.4	1,869.2	-197.6	699.0	0.00	0.00	0.00
5,900.0	32.34	353.97	5,383.9	1,922.3	-203.2	718.9	0.00	0.00	0.00
6,000.0	32.34	353.97	5,468.3	1,975.5	-208.8	738.8	0.00	0.00	0.00
6,100.0	32.34	353.97	5,552.8	2,028.7	-214.4	758.7	0.00	0.00	0.00
6,200.0	32.34	353.97	5,637.3	2,081.9	-220.1	778.6	0.00	0.00	0.00
6,300.0	32.34	353.97	5,721.8	2,135.1	-225.7	798.5	0.00	0.00	0.00
6,400.0	32.34	353.97	5,806.3	2,188.3	-231.3	818.4	0.00	0.00	0.00
6,500.0	32.34	353.97	5,890.8	2,241.5	-236.9	838.3	0.00	0.00	0.00
6,600.0	32.34	353.97	5,975.3	2,294.7	-242.5	858.2	0.00	0.00	0.00
6,700.0	32.34	353.97	6,059.8	2,347.9	-248.2	878.1	0.00	0.00	0.00
6,800.0	32.34	353.97	6,144.3	2,401.1	-253.8	898.0	0.00	0.00	0.00
6,900.0	32.34	353.97	6,228.8	2,454.3	-259.4	917.9	0.00	0.00	0.00
7,000.0	32.34	353.97	6,313.2	2,507.5	-265.0	937.8	0.00	0.00	0.00
7,100.0	32.34	353.97	6,397.7	2,560.7	-270.7	957.7	0.00	0.00	0.00
7,200.0	32.34	353.97	6,482.2	2,613.9	-276.3	977.6	0.00	0.00	0.00
7,300.0	32.34	353.97	6,566.7	2,667.1	-281.9	997.5	0.00	0.00	0.00
7,400.0	32.34	353.97	6,651.2	2,720.3	-287.5	1,017.4	0.00	0.00	0.00
7,500.0	32.34	353.97	6,735.7	2,773.5	-293.2	1,037.3	0.00	0.00	0.00
7,545.7	32.34	353.97	6,774.3	2,797.8	-295.7	1,046.3	0.00	0.00	0.00
7,600.0	33.18	344.04	6,820.0	2,826.5	-301.3	1,059.6	10.00	1.55	-18.28
7,700.0	36.60	327.56	6,902.2	2,878.1	-324.9	1,096.3	10.00	3.42	-16.48
7,800.0	41.90	314.11	6,979.8	2,926.7	-365.0	1,148.1	10.00	5.30	-13.44
7,900.0	48.46	303.44	7,050.3	2,970.7	-420.3	1,213.3	10.00	6.56	-10.67
8,000.0	55.82	294.84	7,111.7	3,008.7	-489.3	1,290.0	10.00	7.36	-8.60
8,100.0	63.68	287.67	7,162.1	3,039.8	-569.7	1,375.9	10.00	7.86	-7.17
8,200.0	71.85	281.43	7,199.9	3,062.9	-659.2	1,468.3	10.00	8.17	-6.24
8,300.0	80.20	275.76	7,224.1	3,077.3	-755.0	1,564.4	10.00	8.35	-5.67
8,400.0	88.64	270.36	7,233.8	3,082.5	-854.3	1,661.4	10.00	8.44	-5.39
8,418.9	90.24	269.35	7,234.0	3,082.5	-873.2	1,679.5	10.00	8.46	-5.33
8,500.0	90.24	269.35	7,233.7	3,081.6	-954.3	1,757.3	0.00	0.00	0.00
8,600.0	90.24	269.35	7,233.2	3,080.5	-1,054.3	1,853.2	0.00	0.00	0.00
8,700.0	90.24	269.35	7,232.8	3,079.3	-1,154.3	1,949.1	0.00	0.00	0.00
8,800.0	90.24	269.35	7,232.4	3,078.2	-1,254.3	2,045.0	0.00	0.00	0.00
8,900.0	90.24	269.35	7,232.0	3,077.1	-1,354.3	2,140.9	0.00	0.00	0.00
9,000.0	90.24	269.35	7,231.6	3,076.0	-1,454.3	2,236.8	0.00	0.00	0.00
9,100.0	90.24	269.35	7,231.2	3,074.8	-1,554.3	2,332.8	0.00	0.00	0.00
9,200.0	90.24	269.35	7,230.8	3,073.7	-1,654.2	2,428.7	0.00	0.00	0.00
9,300.0	90.24	269.35	7,230.3	3,072.6	-1,754.2	2,524.6	0.00	0.00	0.00
9,400.0	90.24	269.35	7,229.9	3,071.5	-1,854.2	2,620.5	0.00	0.00	0.00
9,500.0	90.24	269.35	7,229.5	3,070.3	-1,954.2	2,716.4	0.00	0.00	0.00
9,600.0	90.24	269.35	7,229.1	3,069.2	-2,054.2	2,812.3	0.00	0.00	0.00
9,700.0	90.24	269.35	7,228.7	3,068.1	-2,154.2	2,908.2	0.00	0.00	0.00
9,800.0	90.24	269.35	7,228.3	3,066.9	-2,254.2	3,004.1	0.00	0.00	0.00
9,900.0	90.24	269.35	7,227.9	3,065.8	-2,354.2	3,100.0	0.00	0.00	0.00
10,000.0	90.24	269.35	7,227.4	3,064.7	-2,454.2	3,195.9	0.00	0.00	0.00
10,100.0	90.24	269.35	7,227.0	3,063.6	-2,554.2	3,291.8	0.00	0.00	0.00
10,200.0	90.24	269.35	7,226.6	3,062.4	-2,654.2	3,387.7	0.00	0.00	0.00
10,300.0	90.24	269.35	7,226.2	3,061.3	-2,754.2	3,483.7	0.00	0.00	0.00
10,400.0	90.24	269.35	7,225.8	3,060.2	-2,854.2	3,579.6	0.00	0.00	0.00

Bayswater Exploration & Production LLC

Planning Report

Database:	edm	Local Co-ordinate Reference:	Well TOPAZ 04
Company:	Bayswater Exploration & Production, LLC	TVD Reference:	KB @ 4966.0usft (Original Well Elev)
Project:	DJ Basin	MD Reference:	KB @ 4966.0usft (Original Well Elev)
Site:	Topaz Pad 6-I HZ Pad	North Reference:	True
Well:	TOPAZ 04	Survey Calculation Method:	Minimum Curvature
Wellbore:	Wellbore #1		
Design:	Design #1		

Planned Survey									
Measured Depth (usft)	Inclination (°)	Azimuth (°)	Vertical Depth (usft)	+N/-S (usft)	+E/-W (usft)	Vertical Section (usft)	Dogleg Rate (°/100usft)	Build Rate (°/100usft)	Turn Rate (°/100usft)
10,500.0	90.24	269.35	7,225.4	3,059.1	-2,954.2	3,675.5	0.00	0.00	0.00
10,600.0	90.24	269.35	7,224.9	3,057.9	-3,054.1	3,771.4	0.00	0.00	0.00
10,700.0	90.24	269.35	7,224.5	3,056.8	-3,154.1	3,867.3	0.00	0.00	0.00
10,800.0	90.24	269.35	7,224.1	3,055.7	-3,254.1	3,963.2	0.00	0.00	0.00
10,900.0	90.24	269.35	7,223.7	3,054.6	-3,354.1	4,059.1	0.00	0.00	0.00
11,000.0	90.24	269.35	7,223.3	3,053.4	-3,454.1	4,155.0	0.00	0.00	0.00
11,100.0	90.24	269.35	7,222.9	3,052.3	-3,554.1	4,250.9	0.00	0.00	0.00
11,200.0	90.24	269.35	7,222.5	3,051.2	-3,654.1	4,346.8	0.00	0.00	0.00
11,300.0	90.24	269.35	7,222.0	3,050.1	-3,754.1	4,442.7	0.00	0.00	0.00
11,400.0	90.24	269.35	7,221.6	3,048.9	-3,854.1	4,538.6	0.00	0.00	0.00
11,500.0	90.24	269.35	7,221.2	3,047.8	-3,954.1	4,634.6	0.00	0.00	0.00
11,600.0	90.24	269.35	7,220.8	3,046.7	-4,054.1	4,730.5	0.00	0.00	0.00
11,700.0	90.24	269.35	7,220.4	3,045.6	-4,154.1	4,826.4	0.00	0.00	0.00
11,800.0	90.24	269.35	7,220.0	3,044.4	-4,254.1	4,922.3	0.00	0.00	0.00
11,900.0	90.24	269.35	7,219.6	3,043.3	-4,354.1	5,018.2	0.00	0.00	0.00
12,000.0	90.24	269.35	7,219.1	3,042.2	-4,454.0	5,114.1	0.00	0.00	0.00
12,100.0	90.24	269.35	7,218.7	3,041.0	-4,554.0	5,210.0	0.00	0.00	0.00
12,200.0	90.24	269.35	7,218.3	3,039.9	-4,654.0	5,305.9	0.00	0.00	0.00
12,300.0	90.24	269.35	7,217.9	3,038.8	-4,754.0	5,401.8	0.00	0.00	0.00
12,400.0	90.24	269.35	7,217.5	3,037.7	-4,854.0	5,497.7	0.00	0.00	0.00
12,500.0	90.24	269.35	7,217.1	3,036.5	-4,954.0	5,593.6	0.00	0.00	0.00
12,600.0	90.24	269.35	7,216.6	3,035.4	-5,054.0	5,689.5	0.00	0.00	0.00
12,700.0	90.24	269.35	7,216.2	3,034.3	-5,154.0	5,785.5	0.00	0.00	0.00
12,800.0	90.24	269.35	7,215.8	3,033.2	-5,254.0	5,881.4	0.00	0.00	0.00
12,900.0	90.24	269.35	7,215.4	3,032.0	-5,354.0	5,977.3	0.00	0.00	0.00
13,000.0	90.24	269.35	7,215.0	3,030.9	-5,454.0	6,073.2	0.00	0.00	0.00
13,100.0	90.24	269.35	7,214.6	3,029.8	-5,554.0	6,169.1	0.00	0.00	0.00
13,200.0	90.24	269.35	7,214.2	3,028.7	-5,654.0	6,265.0	0.00	0.00	0.00
13,300.0	90.24	269.35	7,213.7	3,027.5	-5,754.0	6,360.9	0.00	0.00	0.00
13,400.0	90.24	269.35	7,213.3	3,026.4	-5,853.9	6,456.8	0.00	0.00	0.00
13,500.0	90.24	269.35	7,212.9	3,025.3	-5,953.9	6,552.7	0.00	0.00	0.00
13,600.0	90.24	269.35	7,212.5	3,024.2	-6,053.9	6,648.6	0.00	0.00	0.00
13,700.0	90.24	269.35	7,212.1	3,023.0	-6,153.9	6,744.5	0.00	0.00	0.00
13,800.0	90.24	269.35	7,211.7	3,021.9	-6,253.9	6,840.4	0.00	0.00	0.00
13,900.0	90.24	269.35	7,211.2	3,020.8	-6,353.9	6,936.3	0.00	0.00	0.00
14,000.0	90.24	269.35	7,210.8	3,019.7	-6,453.9	7,032.3	0.00	0.00	0.00
14,100.0	90.24	269.35	7,210.4	3,018.5	-6,553.9	7,128.2	0.00	0.00	0.00
14,200.0	90.24	269.35	7,210.0	3,017.4	-6,653.9	7,224.1	0.00	0.00	0.00
14,300.0	90.24	269.35	7,209.6	3,016.3	-6,753.9	7,320.0	0.00	0.00	0.00
14,400.0	90.24	269.35	7,209.2	3,015.1	-6,853.9	7,415.9	0.00	0.00	0.00
14,500.0	90.24	269.35	7,208.8	3,014.0	-6,953.9	7,511.8	0.00	0.00	0.00
14,600.0	90.24	269.35	7,208.3	3,012.9	-7,053.9	7,607.7	0.00	0.00	0.00
14,700.0	90.24	269.35	7,207.9	3,011.8	-7,153.8	7,703.6	0.00	0.00	0.00
14,800.0	90.24	269.35	7,207.5	3,010.6	-7,253.8	7,799.5	0.00	0.00	0.00
14,900.0	90.24	269.35	7,207.1	3,009.5	-7,353.8	7,895.4	0.00	0.00	0.00
15,000.0	90.24	269.35	7,206.7	3,008.4	-7,453.8	7,991.3	0.00	0.00	0.00
15,100.0	90.24	269.35	7,206.3	3,007.3	-7,553.8	8,087.2	0.00	0.00	0.00
15,200.0	90.24	269.35	7,205.9	3,006.1	-7,653.8	8,183.2	0.00	0.00	0.00
15,300.0	90.24	269.35	7,205.4	3,005.0	-7,753.8	8,279.1	0.00	0.00	0.00
15,400.0	90.24	269.35	7,205.0	3,003.9	-7,853.8	8,375.0	0.00	0.00	0.00
15,500.0	90.24	269.35	7,204.6	3,002.8	-7,953.8	8,470.9	0.00	0.00	0.00
15,600.0	90.24	269.35	7,204.2	3,001.6	-8,053.8	8,566.8	0.00	0.00	0.00
15,700.0	90.24	269.35	7,203.8	3,000.5	-8,153.8	8,662.7	0.00	0.00	0.00
15,800.0	90.24	269.35	7,203.4	2,999.4	-8,253.8	8,758.6	0.00	0.00	0.00

Bayswater Exploration & Production LLC

Planning Report

Database:	edm	Local Co-ordinate Reference:	Well TOPAZ 04
Company:	Bayswater Exploration & Production, LLC	TVD Reference:	KB @ 4966.0usft (Original Well Elev)
Project:	DJ Basin	MD Reference:	KB @ 4966.0usft (Original Well Elev)
Site:	Topaz Pad 6-I HZ Pad	North Reference:	True
Well:	TOPAZ 04	Survey Calculation Method:	Minimum Curvature
Wellbore:	Wellbore #1		
Design:	Design #1		

Planned Survey										
Measured Depth (usft)	Inclination (°)	Azimuth (°)	Vertical Depth (usft)	+N/-S (usft)	+E/-W (usft)	Vertical Section (usft)	Dogleg Rate (°/100usft)	Build Rate (°/100usft)	Turn Rate (°/100usft)	
15,900.0	90.24	269.35	7,202.9	2,998.3	-8,353.8	8,854.5	0.00	0.00	0.00	
16,000.0	90.24	269.35	7,202.5	2,997.1	-8,453.8	8,950.4	0.00	0.00	0.00	
16,100.0	90.24	269.35	7,202.1	2,996.0	-8,553.7	9,046.3	0.00	0.00	0.00	
16,200.0	90.24	269.35	7,201.7	2,994.9	-8,653.7	9,142.2	0.00	0.00	0.00	
16,300.0	90.24	269.35	7,201.3	2,993.8	-8,753.7	9,238.1	0.00	0.00	0.00	
16,400.0	90.24	269.35	7,200.9	2,992.6	-8,853.7	9,334.1	0.00	0.00	0.00	
16,500.0	90.24	269.35	7,200.5	2,991.5	-8,953.7	9,430.0	0.00	0.00	0.00	
16,600.0	90.24	269.35	7,200.0	2,990.4	-9,053.7	9,525.9	0.00	0.00	0.00	
16,700.0	90.24	269.35	7,199.6	2,989.2	-9,153.7	9,621.8	0.00	0.00	0.00	
16,800.0	90.24	269.35	7,199.2	2,988.1	-9,253.7	9,717.7	0.00	0.00	0.00	
16,900.0	90.24	269.35	7,198.8	2,987.0	-9,353.7	9,813.6	0.00	0.00	0.00	
17,000.0	90.24	269.35	7,198.4	2,985.9	-9,453.7	9,909.5	0.00	0.00	0.00	
17,100.0	90.24	269.35	7,198.0	2,984.7	-9,553.7	10,005.4	0.00	0.00	0.00	
17,200.0	90.24	269.35	7,197.6	2,983.6	-9,653.7	10,101.3	0.00	0.00	0.00	
17,300.0	90.24	269.35	7,197.1	2,982.5	-9,753.7	10,197.2	0.00	0.00	0.00	
17,400.0	90.24	269.35	7,196.7	2,981.4	-9,853.7	10,293.1	0.00	0.00	0.00	
17,500.0	90.24	269.35	7,196.3	2,980.2	-9,953.6	10,389.0	0.00	0.00	0.00	
17,600.0	90.24	269.35	7,195.9	2,979.1	-10,053.6	10,484.9	0.00	0.00	0.00	
17,700.0	90.24	269.35	7,195.5	2,978.0	-10,153.6	10,580.9	0.00	0.00	0.00	
17,800.0	90.24	269.35	7,195.1	2,976.9	-10,253.6	10,676.8	0.00	0.00	0.00	
17,900.0	90.24	269.35	7,194.6	2,975.7	-10,353.6	10,772.7	0.00	0.00	0.00	
18,000.0	90.24	269.35	7,194.2	2,974.6	-10,453.6	10,868.6	0.00	0.00	0.00	
18,056.0	90.24	269.35	7,194.0	2,974.0	-10,509.6	10,922.3	0.00	0.00	0.00	

Design Targets										
Target Name - hit/miss target - Shape	Dip Angle (°)	Dip Dir. (°)	TVD (usft)	+N/-S (usft)	+E/-W (usft)	Northing (usft)	Easting (usft)	Latitude	Longitude	
TOPAZ 4 PBHL - plan hits target center - Point	0.00	0.00	7,194.0	2,974.0	-10,509.6	1,465,667.47	3,207,606.67	40° 36' 33.307 N	104° 45' 8.154 W	
TOPAZ 4 LP - plan hits target center - Point	0.00	0.00	7,234.0	3,082.5	-873.2	1,465,861.36	3,217,241.76	40° 36' 34.402 N	104° 43' 3.209 W	