

## BORING LOG/MONITORING WELL COMPLETION DIAGRAM

**PROJECT NAME:** Park U-4-9XRLC  
**PROJECT NO:** TE034520034 **LOGGED BY:** Jeremy Pike  
**BORING/WELL ID:** MW01 **SAMPLE METHOD:** Continuous  
**COMPLETION DATE:** 11/4/2020 **DRILL METHOD:** Geoprobe 6620DT  
**TD (ft bgs):** 12' **DRILLED BY:** Vine Labs  
**DTW (ft bgs):** 4.5' **DETECTOR:** ultraRAE 3000  
**SCREEN SLOT:** 0.010" **FILTER PACK:** 10-20 silica sand  
**CASING LENGTH:** 2' **ANNULUS SEAL:** Bentonite chips  
**SCREEN LENGTH:** 10' **SURFACE SEAL:** NA

**HOLE DIAMETER:** 3.25"

**WELL DIAMETER:** 1"

**CASING TYPE:** PVC

**SCREEN TYPE:** PVC

PID (ppm)	Staining	Moisture Content	Sample ID	Recovery (ft/ft)	Depth (ft)	USCS	USCS Graphic	Lithology Description	Well Construction
		Moist			0	SM			
1.5				1.5/5		SW			
5		Wet			5				
1				2/5					
1					10				
				1/2					

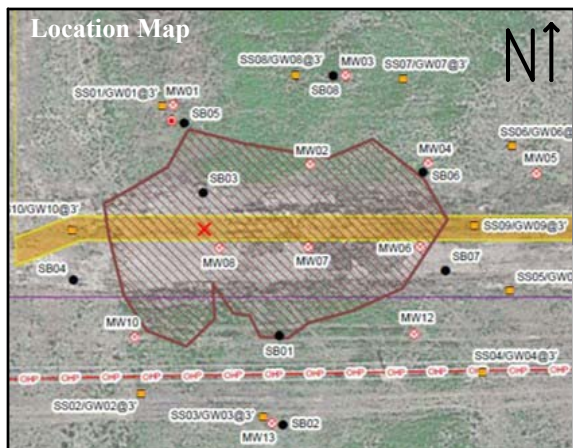

## BORING LOG/MONITORING WELL COMPLETION DIAGRAM

**PROJECT NAME:** Park U-4-9XRLC  
**PROJECT NO:** TE034520034 **LOGGED BY:** Jeremy Pike  
**BORING/WELL ID:** MW02 **SAMPLE METHOD:** Continuous  
**COMPLETION DATE:** 11/4/2020 **DRILL METHOD:** Geoprobe 6620DT  
**TD (ft bgs):** 12' **DRILLED BY:** Vine Labs  
**DTW (ft bgs):** 3' **DETECTOR:** ultraRAE 3000  
**SCREEN SLOT:** 0.010" **FILTER PACK:** 10-20 silica sand  
**CASING LENGTH:** 2' **ANNULUS SEAL:** Bentonite chips  
**SCREEN LENGTH:** 8' **SURFACE SEAL:** NA

**HOLE DIAMETER:** 3.25"

**WELL DIAMETER:** 1"

**CASING TYPE:** PVC

**SCREEN TYPE:** PVC

PID (ppm)	Staining	Moisture Content	Sample ID	Recovery (ft/ft)	Depth (ft)	USCS	USCS Graphic	Lithology Description	Well Construction
1,417		Moist	MW02 @1'		0	SM		0' - 1' - SILTY SAND, dark brown, some clay, trace roots, moist, no staining, hydrocarbon odor	
1,304				3/5		SM		1' - 3' - SILTY SAND, light brown, fine grained, wet at 3' bgs, no stain, hydrocarbon odor	
960		Wet			5	SW		3' - 5' - SAND, light brown, fine to coarse grained, wet, no stain, hydrocarbon odor, free product observed on sample liner	
289			MW02 @10'		10	SW		5' - 10' - SAND, light brown, fine to coarse grained, trace gravel, wet, no stain, hydrocarbon odor	
				0/2				10' - 12' - No recovery	

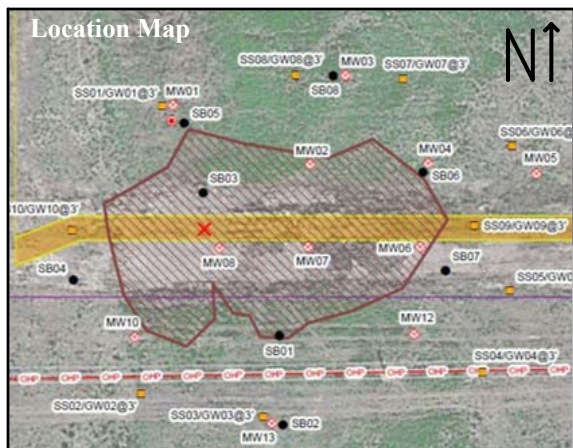

## BORING LOG/MONITORING WELL COMPLETION DIAGRAM

**PROJECT NAME:** Park U-4-9XRLC  
**PROJECT NO:** TE034520034 **LOGGED BY:** Jeremy Pike  
**BORING/WELL ID:** MW03 **SAMPLE METHOD:** Continuous  
**COMPLETION DATE:** 11/4/2020 **DRILL METHOD:** Geoprobe 6620DT  
**TD (ft bgs):** 12' **DRILLED BY:** Vine Labs  
**DTW (ft bgs):** 4.5' **DETECTOR:** ultraRAE 3000  
**SCREEN SLOT:** 0.010" **FILTER PACK:** 10-20 silica sand  
**CASING LENGTH:** 2' **ANNULUS SEAL:** Bentonite chips  
**SCREEN LENGTH:** 10' **SURFACE SEAL:** NA

**HOLE DIAMETER:** 3.25"

**WELL DIAMETER:** 1"

**CASING TYPE:** PVC

**SCREEN TYPE:** PVC

PID (ppm)	Staining	Moisture Content	Sample ID	Recovery (ft/ft)	Depth (ft)	USCS	USCS Graphic	Lithology Description	Well Construction
27		Moist		2.5/5	0	SM		0' - 1' - SILTY SAND, dark brown, some clay, trace roots, moist, no staining, no odor	
250		Wet			5	SP		1' - 5' - SAND, light brown, fine grained, moist to wet at 4.5' bgs, orange iron stain at 4.5' to 5' bgs, thin (<0.5") black stain at 4.5' bgs, odor at 4.5' to 5' bgs	
6				2/5		SW		5' - 12' - SAND, light brown, fine to coarse grained, trace gravel, wet, no stain, no odor	
5					10				
1.5				2/2					

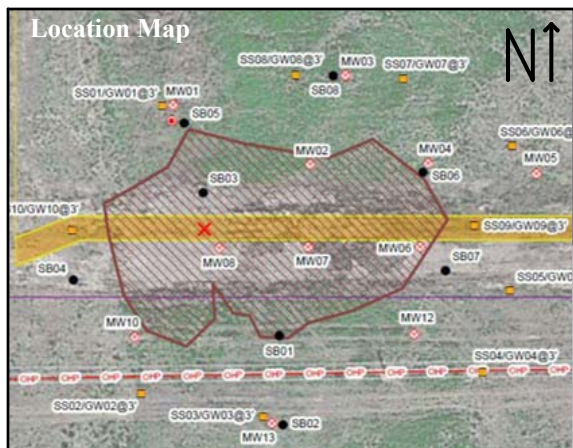

## BORING LOG/MONITORING WELL COMPLETION DIAGRAM

**PROJECT NAME:** Park U-4-9XRLC  
**PROJECT NO:** TE034520034 **LOGGED BY:** Jeremy Pike  
**BORING/WELL ID:** MW04 **SAMPLE METHOD:** Continuous  
**COMPLETION DATE:** 11/4/2020 **DRILL METHOD:** Geoprobe 6620DT  
**TD (ft bgs):** 12' **DRILLED BY:** Vine Labs  
**DTW (ft bgs):** 4' **DETECTOR:** ultraRAE 3000  
**SCREEN SLOT:** 0.010" **FILTER PACK:** 10-20 silica sand  
**CASING LENGTH:** 2' **ANNULUS SEAL:** Bentonite chips  
**SCREEN LENGTH:** 10' **SURFACE SEAL:** NA

**HOLE DIAMETER:** 3.25"

**WELL DIAMETER:** 1"

**CASING TYPE:** PVC

**SCREEN TYPE:** PVC

PID (ppm)	Staining	Moisture Content	Sample ID	Recovery (ft/ft)	Depth (ft)	USCS	USCS Graphic	Lithology Description	Well Construction
		Moist			0	SC		0' - 0.5' - CLAYEY SAND, black, fine grained, dry, no staining, no odor	
2.57				3/5		SP		0.5' - 4' - SAND, light brown, fine grained coarsening downward, moist, no stain, no odor	
498		Wet			5	SW		4' - 10' - SAND, light brown, fine to coarse grained, trace gravel, wet, no stain, hydrocarbon odor at 5', free product observed at 5', poor sample recovery from 5' to 10' bgs	
350				1.5/5					
180					10				
				0/2				10' - 12' - No recovery	

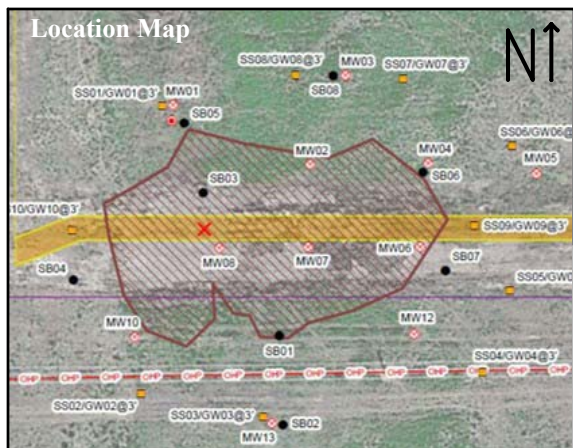

## BORING LOG/MONITORING WELL COMPLETION DIAGRAM

**PROJECT NAME:** Park U-4-9XRLC  
**PROJECT NO:** TE034520034 **LOGGED BY:** Jeremy Pike  
**BORING/WELL ID:** MW05 **SAMPLE METHOD:** Continuous  
**COMPLETION DATE:** 11/4/2020 **DRILL METHOD:** Geoprobe 6620DT  
**TD (ft bgs):** 12' **DRILLED BY:** Vine Labs  
**DTW (ft bgs):** 4' **DETECTOR:** ultraRAE 3000  
**SCREEN SLOT:** 0.010" **FILTER PACK:** 10-20 silica sand  
**CASING LENGTH:** 2' **ANNULUS SEAL:** Bentonite chips  
**SCREEN LENGTH:** 10' **SURFACE SEAL:** NA

**HOLE DIAMETER:** 3.25"

**WELL DIAMETER:** 1"

**CASING TYPE:** PVC

**SCREEN TYPE:** PVC

PID (ppm)	Staining	Moisture Content	Sample ID	Recovery (ft/ft)	Depth (ft)	USCS	USCS Graphic	Lithology Description	Well Construction
		Moist			0	SM			
1				3.5/5		SW			
8.6		Wet	MW05 @4'						
8.3					5				
1.38				2.5/5					
2.5					10				
2.5			MW05 @12'	1.5/2					



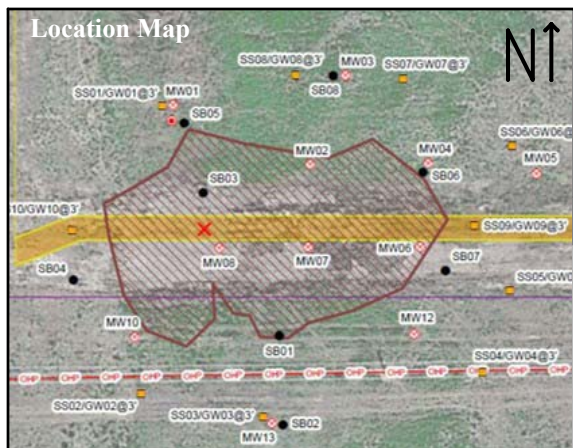

## BORING LOG/MONITORING WELL COMPLETION DIAGRAM

**PROJECT NAME:** Park U-4-9XRLC  
**PROJECT NO:** TE034520034 **LOGGED BY:** Jeremy Pike  
**BORING/WELL ID:** MW06 **SAMPLE METHOD:** Continuous  
**COMPLETION DATE:** 11/4/2020 **DRILL METHOD:** Geoprobe 6620DT  
**TD (ft bgs):** 12' **DRILLED BY:** Vine Labs  
**DTW (ft bgs):** 4' **DETECTOR:** ultraRAE 3000  
**SCREEN SLOT:** 0.010" **FILTER PACK:** 10-20 silica sand  
**CASING LENGTH:** 2' **ANNULUS SEAL:** Bentonite chips  
**SCREEN LENGTH:** 10' **SURFACE SEAL:** NA

**HOLE DIAMETER:** 3.25"

**WELL DIAMETER:** 1"

**CASING TYPE:** PVC

**SCREEN TYPE:** PVC

PID (ppm)	Staining	Moisture Content	Sample ID	Recovery (ft/ft)	Depth (ft)	USCS	USCS Graphic	Lithology Description	Well Construction
747		Moist	MW06 @0-1.5'		0	SM		0' - 1.5' - SAND, brown, fine to coarse grained, some clay, moist, hydrocarbon staining and odor	
				0/5				1.5' - 5' - No recovery, hydrovacuumed due to the proximity to buried flow lines	
833.3		Wet	MW06 @5'		5	SW		5' - 10' - SAND, light brown, fine to coarse grained, gravelly, wet, no stain, odor, free product observed at 5' to 7' bgs	
446			MW06 @7'	1.5/5					
48.3					10	SW		10' - 12' - SAND, light brown, fine to coarse grained, trace gravel, no stain, no odor	
26.5			MW06 @12'	2/5					
					15				

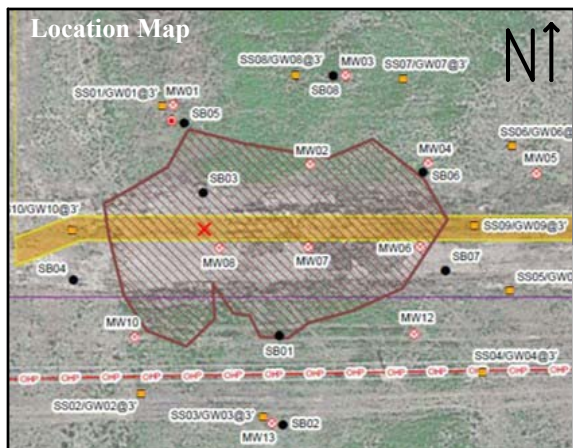

## BORING LOG/MONITORING WELL COMPLETION DIAGRAM

**PROJECT NAME:** Park U-4-9XRLC  
**PROJECT NO:** TE034520034 **LOGGED BY:** Jeremy Pike  
**BORING/WELL ID:** MW07 **SAMPLE METHOD:** Continuous  
**COMPLETION DATE:** 11/4/2020 **DRILL METHOD:** Geoprobe 6620DT  
**TD (ft bgs):** 12' **DRILLED BY:** Vine Labs  
**DTW (ft bgs):** 4' **DETECTOR:** ultraRAE 3000  
**SCREEN SLOT:** 0.010" **FILTER PACK:** 10-20 silica sand  
**CASING LENGTH:** 2' **ANNULUS SEAL:** Bentonite chips  
**SCREEN LENGTH:** 10' **SURFACE SEAL:** NA

**HOLE DIAMETER:** 3.25"

**WELL DIAMETER:** 1"

**CASING TYPE:** PVC

**SCREEN TYPE:** PVC

PID (ppm)	Staining	Moisture Content	Sample ID	Recovery (ft/ft)	Depth (ft)	USCS	USCS Graphic	Lithology Description	Well Construction
1,280		Moist	MW07 @0-1.5'		0	SM		0' - 1.5' - SAND, brown, fine to coarse grained, some clay, moist, hydrocarbon staining and odor	
				0/5				1.5' - 5' - No recovery, hydrovacuumed due to the proximity to buried flow lines	
789		Wet	MW07 @5'		5	SW		5' - 12' - SAND, light brown, fine to coarse grained, trace gravel, wet, trace staining at 5', hydrocarbon odor, poor recovery at 10' to 12' bgs and suspected cross-contamination from sloughing with trace free product on liner at 12' bgs	
210			MW07 @7'	2/5					
365					10				
301			MW07 @12'						

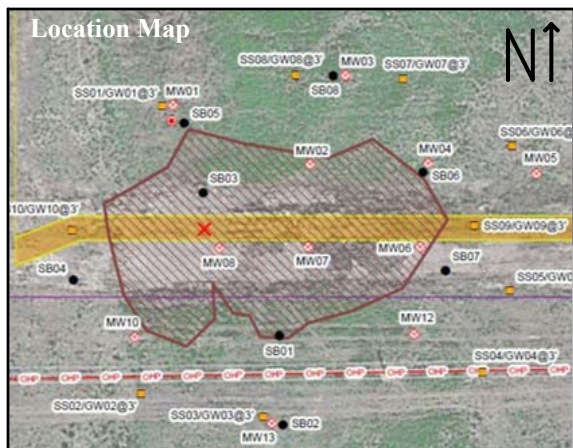

## BORING LOG/MONITORING WELL COMPLETION DIAGRAM

**PROJECT NAME:** Park U-4-9XRLC  
**PROJECT NO:** TE034520034 **LOGGED BY:** Jeremy Pike  
**BORING/WELL ID:** MW08 **SAMPLE METHOD:** Continuous  
**COMPLETION DATE:** 11/4/2020 **DRILL METHOD:** Geoprobe 6620DT  
**TD (ft bgs):** 12' **DRILLED BY:** Vine Labs  
**DTW (ft bgs):** 3' **DETECTOR:** ultraRAE 3000  
**SCREEN SLOT:** 0.010" **FILTER PACK:** 10-20 silica sand  
**CASING LENGTH:** 2' **ANNULUS SEAL:** Bentonite chips  
**SCREEN LENGTH:** 10' **SURFACE SEAL:** NA

**HOLE DIAMETER:** 3.25"

**WELL DIAMETER:** 1"

**CASING TYPE:** PVC

**SCREEN TYPE:** PVC

PID (ppm)	Staining	Moisture Content	Sample ID	Recovery (ft/ft)	Depth (ft)	USCS	USCS Graphic	Lithology Description	Well Construction
736		Moist	MW08 @0-1.5'		0	SM		0' - 1' - SAND, brown, fine grained, some clay, moist, hydrocarbon staining and odor	
674		Wet		2.5/5		SP		1' - 3.5' - SAND, brown, fine grained, moist to wet at 3' bgs, no stain, hydrocarbon odor	
124						CL		3.5' - 4' - SILTY CLAY, gray, sandy, wet, hydrocarbon staining and odor	
1,058			MW08 @5'		5	SW		4' - 12' - SAND, light brown, fine to coarse grained, wet, no stain, hydrocarbon odor at 4' to 5' bgs	
11.65			MW08 @7'	2/5					
10.5					10				
2.2			MW08 @12'						





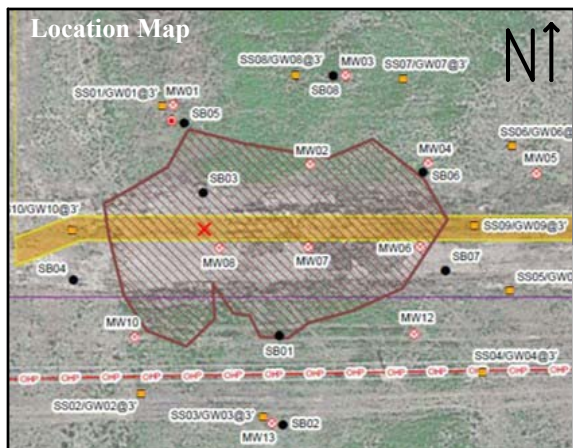

## BORING LOG/MONITORING WELL COMPLETION DIAGRAM

**PROJECT NAME:** Park U-4-9XRLC  
**PROJECT NO:** TE034520034 **LOGGED BY:** Jeremy Pike  
**BORING/WELL ID:** MW10 **SAMPLE METHOD:** Continuous  
**COMPLETION DATE:** 11/4/2020 **DRILL METHOD:** Geoprobe 6620DT  
**TD (ft bgs):** 12' **DRILLED BY:** Vine Labs  
**DTW (ft bgs):** 4' **DETECTOR:** ultraRAE 3000  
**SCREEN SLOT:** 0.010" **FILTER PACK:** 10-20 silica sand  
**CASING LENGTH:** 2' **ANNULUS SEAL:** Bentonite chips  
**SCREEN LENGTH:** 10' **SURFACE SEAL:** NA

**HOLE DIAMETER:** 3.25"

**WELL DIAMETER:** 1"

**CASING TYPE:** PVC

**SCREEN TYPE:** PVC

PID (ppm)	Staining	Moisture Content	Sample ID	Recovery (ft/ft)	Depth (ft)	USCS	USCS Graphic	Lithology Description	Well Construction
10		Moist		2.5/5	0	SC		0' - 2.5' - CLAYEY SAND, dark brown, fine grained, some roots, moist, no staining, no odor	
400		Wet	MW10 @4'			SP		2' - 5' - SAND, light brown, fine grained, increasing coarsed grains with depth, trace gravel at 5' bgs, moist to wet at 4' bgs, no stain, no odor	
353					5	SW		5' - 12' - SAND, light brown, fine to coarse grained, trace gravel, wet, no stain, no odor	
1.27				2/5					
1.2					10				
1.2			MW10 @12'	2/2					



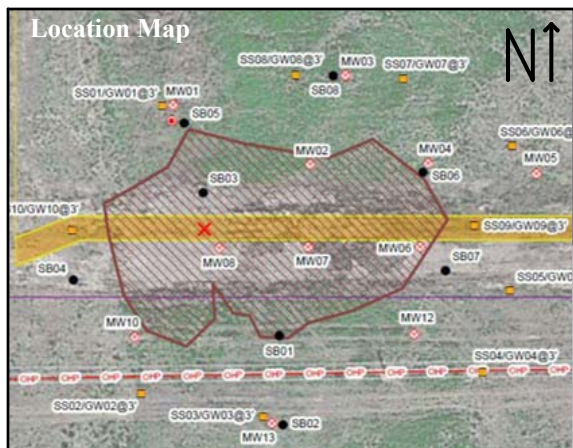

## BORING LOG/MONITORING WELL COMPLETION DIAGRAM

**PROJECT NAME:** Park U-4-9XRLC  
**PROJECT NO:** TE034520034 **LOGGED BY:** Jeremy Pike  
**BORING/WELL ID:** MW12 **SAMPLE METHOD:** Continuous  
**COMPLETION DATE:** 11/4/2020 **DRILL METHOD:** Geoprobe 6620DT  
**TD (ft bgs):** 12' **DRILLED BY:** Vine Labs  
**DTW (ft bgs):** 4' **DETECTOR:** ultraRAE 3000  
**SCREEN SLOT:** 0.010" **FILTER PACK:** 10-20 silica sand  
**CASING LENGTH:** 2' **ANNULUS SEAL:** Bentonite chips  
**SCREEN LENGTH:** 10' **SURFACE SEAL:** NA

**HOLE DIAMETER:** 3.25"

**WELL DIAMETER:** 1"

**CASING TYPE:** PVC

**SCREEN TYPE:** PVC

PID (ppm)	Staining	Moisture Content	Sample ID	Recovery (ft/ft)	Depth (ft)	USCS	USCS Graphic	Lithology Description	Well Construction
4.2		Moist			0	SM		0' - 3' - SILTY SAND, light brown, fine grained, some clay, trace roots, dry to moist, no staining, no odor	
868		Wet	MW12 @4'		3/5	SW		3' - 12' - SAND, light brown, fine to coarse grained, trace gravel with no gravel at 11' to 12' bgs, moist to wet at 4' bgs, hydrocarbon staining and odor at 4' to 5' bgs	
465					5				
119					1.5/5				
12.05					10				
6			MW12 @12'		2/2				

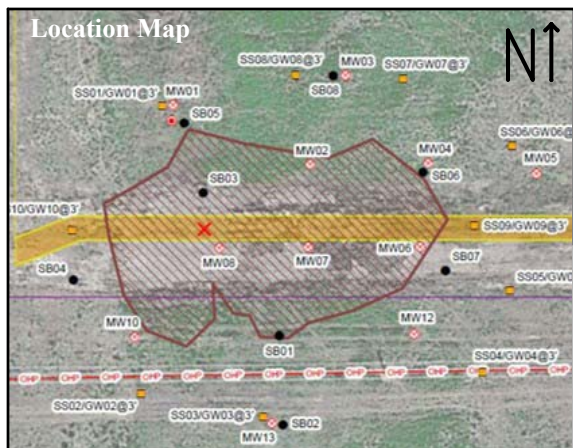

## BORING LOG/MONITORING WELL COMPLETION DIAGRAM

**PROJECT NAME:** Park U-4-9XRLC  
**PROJECT NO:** TE034520034 **LOGGED BY:** Jeremy Pike  
**BORING/WELL ID:** MW13 **SAMPLE METHOD:** Continuous  
**COMPLETION DATE:** 11/4/2020 **DRILL METHOD:** Geoprobe 6620DT  
**TD (ft bgs):** 12' **DRILLED BY:** Vine Labs  
**DTW (ft bgs):** 3' **DETECTOR:** ultraRAE 3000  
**SCREEN SLOT:** 0.010" **FILTER PACK:** 10-20 silica sand  
**CASING LENGTH:** 2' **ANNULUS SEAL:** Bentonite chips  
**SCREEN LENGTH:** 10' **SURFACE SEAL:** NA

**HOLE DIAMETER:** 3.25"

**WELL DIAMETER:** 1"

**CASING TYPE:** PVC

**SCREEN TYPE:** PVC

PID (ppm)	Staining	Moisture Content	Sample ID	Recovery (ft/ft)	Depth (ft)	USCS	USCS Graphic	Lithology Description	Well Construction
1.93		Moist			0	SM		0' - 3' - SILTY SAND, light brown, fine grained, some clay, trace roots, dry to moist, no staining, no odor	
22.5		Wet		3/5		SW		3' - 12' - SAND, light brown, fine to coarse grained, trace gravel with no gravel at 11' to 12' bgs, wet, hydrocarbon staining and odor at 4' to 5' bgs	
461					5				
170				1.5/5					
102				1/2	10				



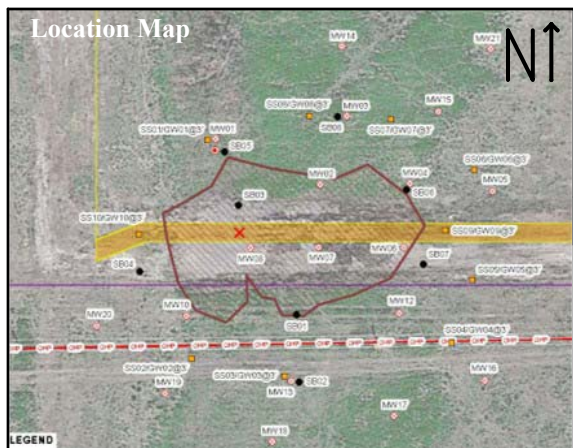

## BORING LOG/MONITORING WELL COMPLETION DIAGRAM

**PROJECT NAME:** Park U-4-9XRLC  
**PROJECT NO:** TE034520034 **LOGGED BY:** Drew Bullinger  
**BORING/WELL ID:** MW14 **SAMPLE METHOD:** Continuous  
**COMPLETION DATE:** 11/10/2020 **DRILL METHOD:** Direct push  
**TD (ft bgs):** 12' **DRILLED BY:** Vine Labs  
**DTW (ft bgs):** 3.5' **DETECTOR:** ultraRAE 3000  
**SCREEN SLOT:** 0.010" **FILTER PACK:** 10-20 silica sand  
**CASING LENGTH:** 2' **ANNULUS SEAL:** Bentonite chips  
**SCREEN LENGTH:** 10' **SURFACE SEAL:** NA

**HOLE DIAMETER:** 3.25"

**WELL DIAMETER:** 1"

**CASING TYPE:** PVC

**SCREEN TYPE:** PVC

PID (ppm)	Staining	Moisture Content	Sample ID	Recovery (ft/ft)	Depth (ft)	USCS	USCS Graphic	Lithology Description	Well Construction
7.25		dry			0	SM		0' - 2' - SILTY SAND, dark brown, fine grained, organics, dry, no staining, no odor	
8.87						SW		2' - 12' - SAND, brown, well graded, fine to coarse grained, dry to wet at 3.5' bgs, no stain, no odor	
9.22			MW14 @3'	3/5					
3.23		Wet							
2.80					5				
0.57									
0.56									
0.56				2/5					
0.57									
0.46					10				
0.39				2/2					
0.37			MW14 @12'						

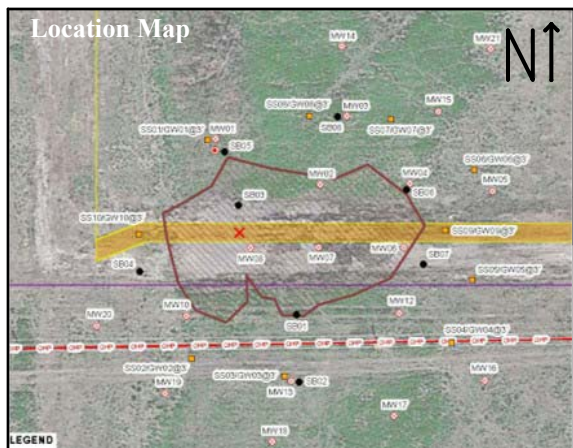

## BORING LOG/MONITORING WELL COMPLETION DIAGRAM

**PROJECT NAME:** Park U-4-9XRLC  
**PROJECT NO:** TE034520034 **LOGGED BY:** Drew Bullinger  
**BORING/WELL ID:** MW15 **SAMPLE METHOD:** Continuous  
**COMPLETION DATE:** 11/10/2020 **DRILL METHOD:** Direct push  
**TD (ft bgs):** 12' **DRILLED BY:** Vine Labs  
**DTW (ft bgs):** 4' **DETECTOR:** ultraRAE 3000  
**SCREEN SLOT:** 0.010" **FILTER PACK:** 10-20 silica sand  
**CASING LENGTH:** 2' **ANNULUS SEAL:** Bentonite chips  
**SCREEN LENGTH:** 10' **SURFACE SEAL:** NA

**HOLE DIAMETER:** 3.25"

**WELL DIAMETER:** 1"

**CASING TYPE:** PVC

**SCREEN TYPE:** PVC

PID (ppm)	Staining	Moisture Content	Sample ID	Recovery (ft/ft)	Depth (ft)	USCS	USCS Graphic	Lithology Description	Well Construction
4.06		dry			0	SM		0' - 2' - SILTY SAND, brown, fine grained, organics, dry, no staining, no odor	
7.08				2.5/5		SW		2' - 12' - SAND, brown, well graded, fine to coarse grained, dry to wet at 4' bgs, stain at 4' to 5' bgs, odor at 4' to 6' bgs and at 11' bgs	
23.33									
507	Wet		MW15 @4'						
246					5				
25.93									
3.66				3/5					
4.00									
3.95									
9.18					10				
21.38				2/2					
12.22			MW15 @12'						

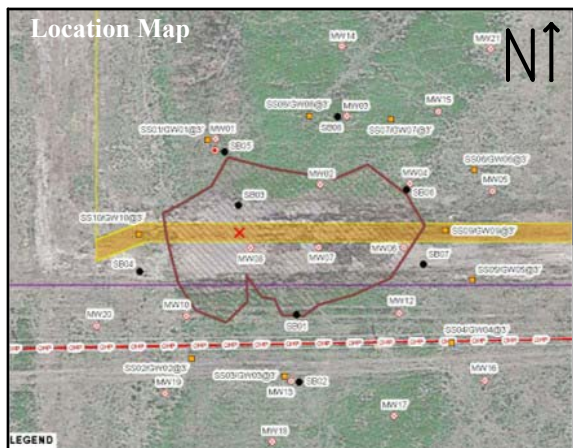

## BORING LOG/MONITORING WELL COMPLETION DIAGRAM

**PROJECT NAME:** Park U-4-9XRLC  
**PROJECT NO:** TE034520034 **LOGGED BY:** Drew Bullinger  
**BORING/WELL ID:** MW16 **SAMPLE METHOD:** Continuous  
**COMPLETION DATE:** 11/10/2020 **DRILL METHOD:** Direct push  
**TD (ft bgs):** 12' **DRILLED BY:** Vine Labs  
**DTW (ft bgs):** 4' **DETECTOR:** ultraRAE 3000  
**SCREEN SLOT:** 0.010" **FILTER PACK:** 10-20 silica sand  
**CASING LENGTH:** 2' **ANNULUS SEAL:** Bentonite chips  
**SCREEN LENGTH:** 10' **SURFACE SEAL:** NA

**HOLE DIAMETER:** 3.25"

**WELL DIAMETER:** 1"

**CASING TYPE:** PVC

**SCREEN TYPE:** PVC

PID (ppm)	Staining	Moisture Content	Sample ID	Recovery (ft/ft)	Depth (ft)	USCS	USCS Graphic	Lithology Description	Well Construction
0.08		dry			0	SM		0' - 2' - SILTY SAND, dark brown, fine grained, some medium grains, little gravel, dry, no staining, no odor	
0.09				3/5		SW		2' - 12' - SAND, brown, well graded, fine to coarse grained, dry to wet at 4' bgs, no stain, no odor, trace gravel at 5' bgs, increase in grain size starting at 10' bgs	
0.10		Wet	MW16 @4'						
0.09					5				
0.11									
0.12				2.5/5					
0.09									
0.10									
0.10					10				
0.09				2/2					
0.09			MW16 @12'						

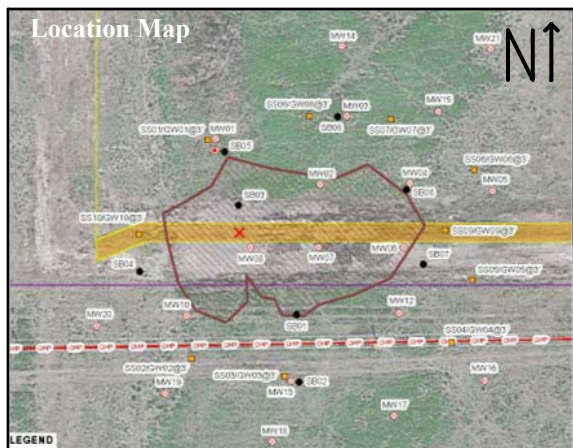

## BORING LOG/MONITORING WELL COMPLETION DIAGRAM

**PROJECT NAME:** Park U-4-9XRLC  
**PROJECT NO:** TE034520034 **LOGGED BY:** Drew Bullinger  
**BORING/WELL ID:** MW17 **SAMPLE METHOD:** Continuous  
**COMPLETION DATE:** 11/10/2020 **DRILL METHOD:** Direct push  
**TD (ft bgs):** 12' **DRILLED BY:** Vine Labs  
**DTW (ft bgs):** 4' **DETECTOR:** ultraRAE 3000  
**SCREEN SLOT:** 0.010" **FILTER PACK:** 10-20 silica sand  
**CASING LENGTH:** 2' **ANNULUS SEAL:** Bentonite chips  
**SCREEN LENGTH:** 10' **SURFACE SEAL:** NA

**HOLE DIAMETER:** 3.25"  
**WELL DIAMETER:** 1"  
**CASING TYPE:** PVC  
**SCREEN TYPE:** PVC

PID (ppm)	Staining	Moisture Content	Sample ID	Recovery (ft/ft)	Depth (ft)	USCS	USCS Graphic	Lithology Description	Well Construction
0.01		dry			0	SM		0' - 1' - SILTY SAND, dark brown, fine grained, little gravel, organics, dry, no staining, no odor	
0.05				2.5/5		SW		1' - 11' - SAND, brown, well graded, fine to coarse grained, dry to wet at 4' bgs, no stain, no odor, trace gravel at 5' to 6' bgs	
0.06									
0.09	Wet		MW17 @4'						
0.11					5				
0.07									
0.09				2.5/5					
0.06									
0.07									
0.07					10				
0.09				2/2		SP		11' - 12' - SAND, brown, poorly graded, fine grained, little coarse grains, wet, no stain, no odor	
0.09			MW17 @12'						

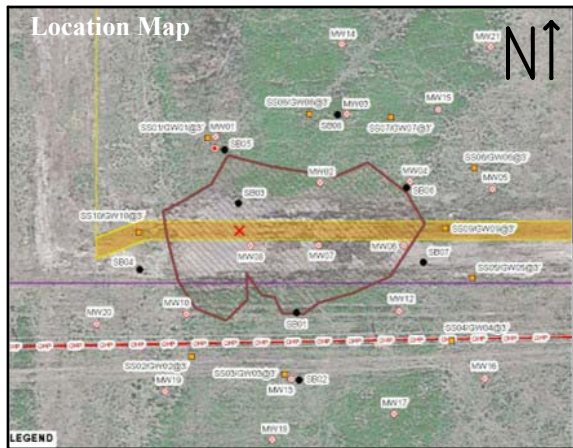

## BORING LOG/MONITORING WELL COMPLETION DIAGRAM

**PROJECT NAME:** Park U-4-9XRLC  
**PROJECT NO:** TE034520034 **LOGGED BY:** Drew Bullinger  
**BORING/WELL ID:** MW18 **SAMPLE METHOD:** Continuous  
**COMPLETION DATE:** 11/10/2020 **DRILL METHOD:** Direct push  
**TD (ft bgs):** 12' **DRILLED BY:** Vine Labs  
**DTW (ft bgs):** 4' **DETECTOR:** ultraRAE 3000  
**SCREEN SLOT:** 0.010" **FILTER PACK:** 10-20 silica sand  
**CASING LENGTH:** 2' **ANNULUS SEAL:** Bentonite chips  
**SCREEN LENGTH:** 10' **SURFACE SEAL:** NA

**HOLE DIAMETER:** 3.25"

**WELL DIAMETER:** 1"

**CASING TYPE:** PVC

**SCREEN TYPE:** PVC

PID (ppm)	Staining	Moisture Content	Sample ID	Recovery (ft/ft)	Depth (ft)	USCS	USCS Graphic	Lithology Description	Well Construction
0.18		dry			0	SM		0' - 2' - SILTY SAND, brown, fine grained, organics, dry, no staining, no odor	
0.24				2.5/5		SW		2' - 12' - SAND, brown, well graded, fine to coarse grained, dry to wet at 4' bgs, no stain, no odor, little gravel at 5' bgs	
0.28									
0.40		Wet	MW18 @4'						
0.36					5				
0.32									
0.24				2.5/5					
0.26									
0.30									
0.38					10				
0.35				2/2					
0.31			MW18 @12'						



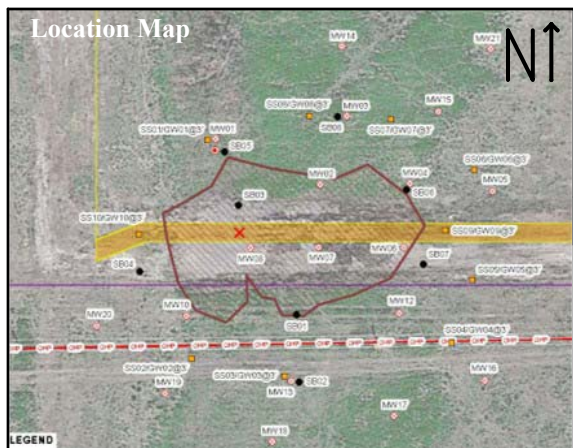

## BORING LOG/MONITORING WELL COMPLETION DIAGRAM

**PROJECT NAME:** Park U-4-9XRLC  
**PROJECT NO:** TE034520034 **LOGGED BY:** Drew Bullinger  
**BORING/WELL ID:** MW19 **SAMPLE METHOD:** Continuous  
**COMPLETION DATE:** 11/10/2020 **DRILL METHOD:** Direct push  
**TD (ft bgs):** 12' **DRILLED BY:** Vine Labs  
**DTW (ft bgs):** 4' **DETECTOR:** ultraRAE 3000  
**SCREEN SLOT:** 0.010" **FILTER PACK:** 10-20 silica sand  
**CASING LENGTH:** 2' **ANNULUS SEAL:** Bentonite chips  
**SCREEN LENGTH:** 10' **SURFACE SEAL:** NA

**HOLE DIAMETER:** 3.25"

**WELL DIAMETER:** 1"

**CASING TYPE:** PVC

**SCREEN TYPE:** PVC

PID (ppm)	Staining	Moisture Content	Sample ID	Recovery (ft/ft)	Depth (ft)	USCS	USCS Graphic	Lithology Description	Well Construction
0.07		dry			0	SM		0' - 2' - SILTY SAND, grayish brown, fine grained, organics, trace gravel, dry, no staining, no odor	
0.09				3/5		SW		2' - 12' - SAND, brown, well graded, fine to coarse grained, dry to wet at 4' bgs, no stain, no odor, layer of fine sand at 9' bgs	
0.12									
0.17		Wet	MW19 @4'						
0.14				5					
0.11									
0.13				2.5/5					
0.09									
0.11									
0.24				10					
0.22				2/2					
0.07			MW19 @12'						

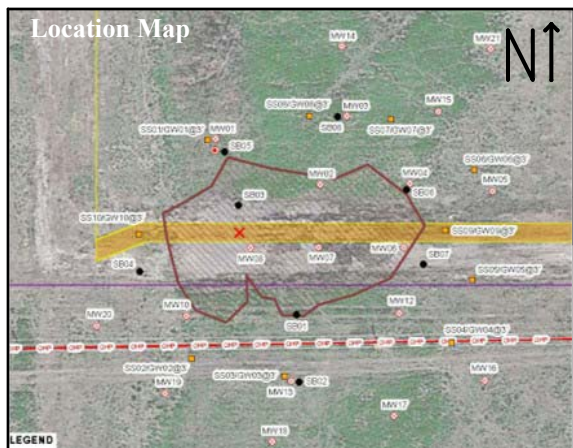

## BORING LOG/MONITORING WELL COMPLETION DIAGRAM

**PROJECT NAME:** Park U-4-9XRLC  
**PROJECT NO:** TE034520034 **LOGGED BY:** Drew Bullinger  
**BORING/WELL ID:** MW20 **SAMPLE METHOD:** Continuous  
**COMPLETION DATE:** 11/10/2020 **DRILL METHOD:** Direct push  
**TD (ft bgs):** 12' **DRILLED BY:** Vine Labs  
**DTW (ft bgs):** 4' **DETECTOR:** ultraRAE 3000  
**SCREEN SLOT:** 0.010" **FILTER PACK:** 10-20 silica sand  
**CASING LENGTH:** 2' **ANNULUS SEAL:** Bentonite chips  
**SCREEN LENGTH:** 10' **SURFACE SEAL:** NA

**HOLE DIAMETER:** 3.25"

**WELL DIAMETER:** 1"

**CASING TYPE:** PVC

**SCREEN TYPE:** PVC

PID (ppm)	Staining	Moisture Content	Sample ID	Recovery (ft/ft)	Depth (ft)	USCS	USCS Graphic	Lithology Description	Well Construction
0.92		dry			0	SM		0' - 2' - SILTY SAND, brown, fine grained, organics, dry, no staining, no odor	
0.77				3/5		SW		2' - 12' - SAND, brown, well graded, fine to coarse grained, dry to wet at 4' bgs, no stain, no odor	
0.32									
0.50		Wet	MW20 @4'						
0.44					5				
0.36									
0.33				2.5/5					
0.34									
0.32									
0.39					10				
0.42				2/2					
0.43			MW20 @12'						

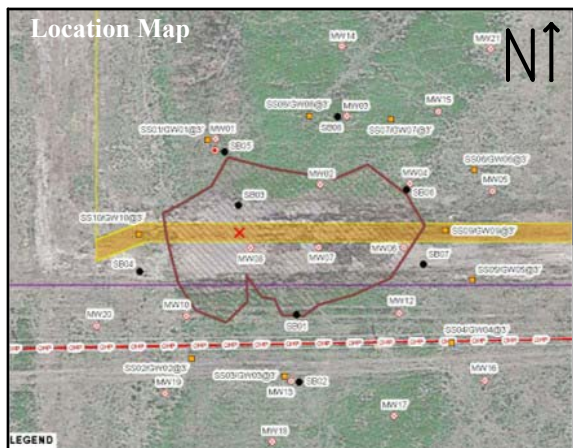

## BORING LOG/MONITORING WELL COMPLETION DIAGRAM

**PROJECT NAME:** Park U-4-9XRLC  
**PROJECT NO:** TE034520034 **LOGGED BY:** Drew Bullinger  
**BORING/WELL ID:** MW21 **SAMPLE METHOD:** Continuous  
**COMPLETION DATE:** 11/10/2020 **DRILL METHOD:** Direct push  
**TD (ft bgs):** 12' **DRILLED BY:** Vine Labs  
**DTW (ft bgs):** 4' **DETECTOR:** ultraRAE 3000  
**SCREEN SLOT:** 0.010" **FILTER PACK:** 10-20 silica sand  
**CASING LENGTH:** 2' **ANNULUS SEAL:** Bentonite chips  
**SCREEN LENGTH:** 10' **SURFACE SEAL:** NA

**HOLE DIAMETER:** 3.25"

**WELL DIAMETER:** 1"

**CASING TYPE:** PVC

**SCREEN TYPE:** PVC

PID (ppm)	Staining	Moisture Content	Sample ID	Recovery (ft/ft)	Depth (ft)	USCS	USCS Graphic	Lithology Description	Well Construction
7.73		dry			0	SM		0' - 2' - SILTY SAND, grayish brown, fine grained, organics, trace gravel, dry, no staining, no odor	
14.22				3.5/5		SW		2' - 12' - SAND, brown, well graded, fine to coarse grained, trace gravel, dry to wet at 4' bgs, no stain, no odor	
1.96									
0.97		Wet	MW21 @4'						
0.47					5				
1.44									
1.23				2.5/5					
1.11									
1.06									
0.99					10				
1.36				2/2					
1.22			MW21 @12'						