

Great Western Operating Company, LLC

Created by	mmount
Date plotted	25-Nov-2020
Plot reference is Tower LD 19-142HN (AWB).	
Ref wellpath is Tower LD 19-142HN (AWP#1).	
Coordinates are in Feet reference N12 - Tower LD 19-142HN.	
True Vertical Depths are reference Rig Datum.	
Measured Depths are reference Rig Datum.	
Rig Datum: Actual Datum #1	
Rig Datum to Mean Sea Level 5244.00 ft.	
Plot North is aligned to TRUE North.	

Location	Colorado	Slot	N12 - Tower LD 19-142HN
Field	Wattenburg	Well	Tower LD 19-142HN
Installation	Tower	Wellbore	Tower LD 19-142HN (AWB)

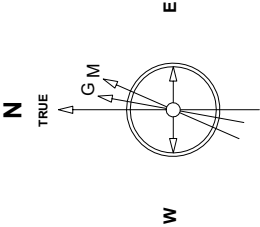

Scale 1 cm = 2 ft

East (Feet) ->

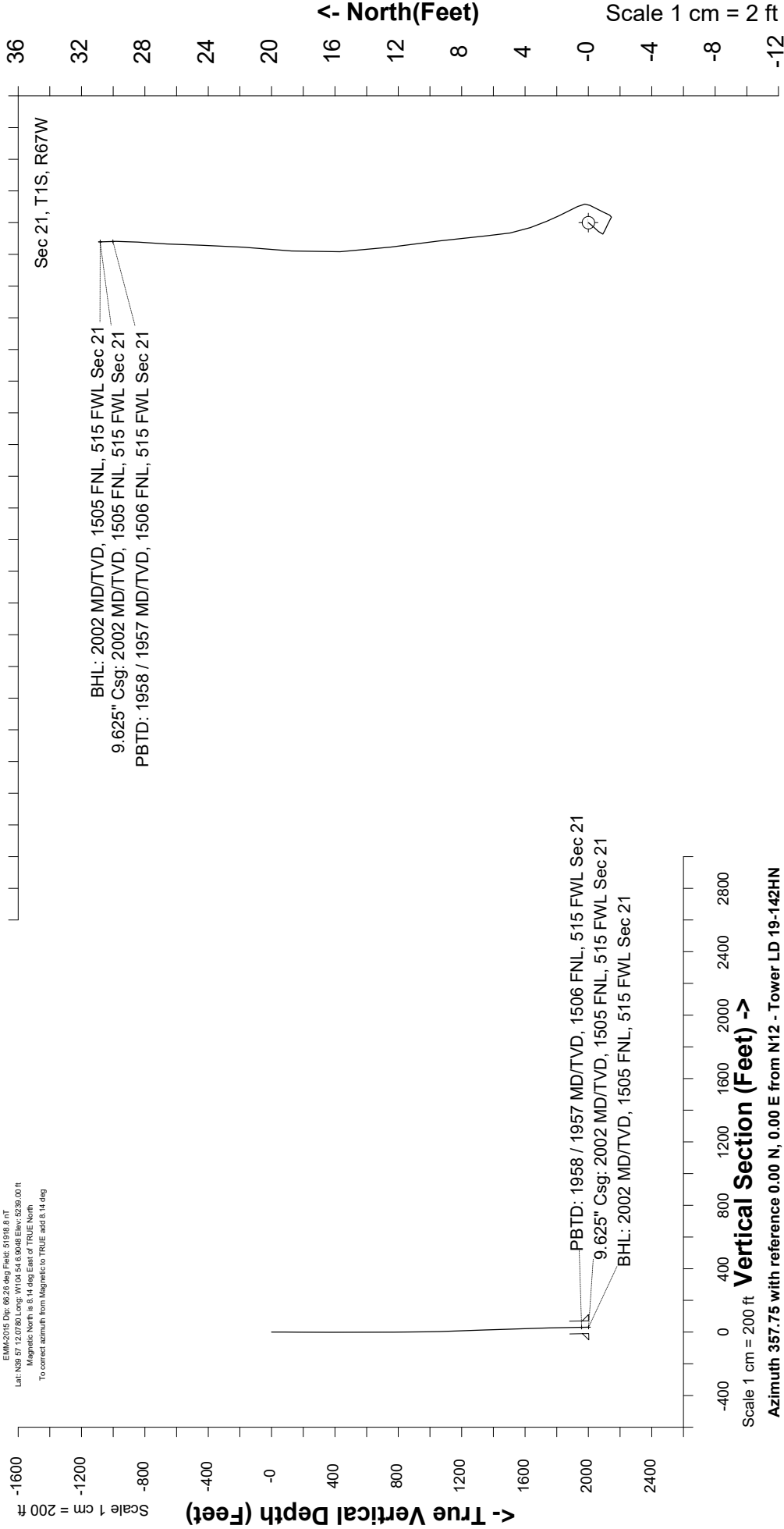

Vertical Section (Feet) ->

Scale 1 cm = 200 ft

Azimuth 357.75 with reference 0.00 N, 0.00 E from N12 - Tower LD 19-142HN

Great Western Operating Co, LLC  
 Directional Survey Report  
 Wellpath: Tower LD 19-142HN  
 MDs and TVDs are from Rig Floor 5244.0ft above Mean Sea Level

**Wellpath Report**

MD[ft]	Inc[deg]	Azi[deg]	TVD[ft]	North[ft]	East[ft]	DLS [deg/100ft]	Vertical Section[ft]
0.00	0.00	0.00	0.00	0.00	0.00		0.00
82.00	0.35	219.50	82.00	-0.19	-0.16	0.43	-0.19
168.00	0.44	223.46	168.00	-0.64	-0.55	0.11	-0.61
254.00	0.09	121.59	254.00	-0.91	-0.72	0.54	-0.88
343.00	0.22	117.29	343.00	-1.03	-0.51	0.15	-1.00
432.00	0.40	115.44	431.99	-1.24	-0.08	0.20	-1.23
522.00	0.04	122.12	521.99	-1.39	0.23	0.40	-1.40
612.00	0.13	117.02	611.99	-1.45	0.35	0.10	-1.46
702.00	0.79	21.92	701.99	-0.92	0.67	0.90	-0.95
792.00	0.40	37.22	791.99	-0.10	1.09	0.46	-0.14
882.00	0.75	333.50	881.98	0.68	1.02	0.75	0.64
972.00	0.92	333.50	971.97	1.85	0.43	0.19	1.84
1062.00	1.58	340.09	1061.95	3.67	-0.31	0.75	3.68
1152.00	2.07	356.35	1151.91	6.46	-0.84	0.79	6.48
1241.00	1.80	351.16	1240.85	9.44	-1.15	0.36	9.48
1331.00	2.11	354.06	1330.80	12.49	-1.54	0.36	12.54
1421.00	1.98	355.65	1420.74	15.68	-1.83	0.16	15.74
1511.00	1.93	6.10	1510.69	18.74	-1.79	0.40	18.80
1601.00	1.93	2.94	1600.64	21.76	-1.55	0.12	21.81
1691.00	1.49	2.15	1690.60	24.44	-1.43	0.49	24.48
1781.00	1.27	2.06	1780.58	26.61	-1.35	0.24	26.64
1871.00	1.05	5.93	1870.56	28.43	-1.23	0.26	28.45
1947.00	1.05	358.11	1946.54	29.82	-1.18	0.19	29.84
2002.00	1.05	358.11	2001.53	30.82	-1.21	==>	30.85