

UPLAND EXPLORATION



Location: COLORADO Slot: SLOT#07 LITTLE LADY 21-5NH (2245'FSL & 260'FEL,SC.21)
Field: WELD COUNTY (TRUE NORTH NAD 83) Well: LITTLE LADY 21-5NH
Facility: SEC.21-T11N-R64W Wellbore: LITTLE LADY 21-5NH PWB

Plot reference wellpath is LITTLE LADY 21-5NH PWB Rev A.0
True vertical depths are referenced to Rig (20) (RT)
Reference wellpath measured depths are referenced to Rig (20) (RT)
Rig (20) (RT) to Mean Sea Level: 5412 feet
Mean Sea Level to Ground level (At Slot: SLOT#07 LITTLE LADY 21-5NH (2245'FSL & 260'FEL,SC.21)): 0 feet
Offset wellpath MDs are referenced to each path's default MD datum
Grid System: NAD83 / Lambert Colorado SP, Northern Zone (501), US feet
North Reference: True north
Scale: True distance
Coordinates are in feet referenced to Slot
Depths are in feet
Created by: painsear on 2020-11-12; Database: WellArchitectDB

Location Information

Facility Name			Grid East (US ft)	Grid North (US ft)	Latitude	Longitude
SEC.21-T11N-R64W			3264604.583	1572171.056	40°54'0.2160"N	104°32'34.2600"W
Slot	Local N (ft)	Local E (ft)	Grid East (US ft)	Grid North (US ft)	Latitude	Longitude
SLOT#07 LITTLE LADY 21-5NH (2245'FSL & 260'FEL,SC.21)	1839.10	85.27	3264670.000	1574011.000	40°54'18.3877"N	104°32'33.1495"W
Rig (20) (RT) to Ground level (At Slot: SLOT#07 LITTLE LADY 21-5NH (2245'FSL & 260'FEL,SC.21))					5412ft	
Mean Sea Level to Ground level (At Slot: SLOT#07 LITTLE LADY 21-5NH (2245'FSL & 260'FEL,SC.21))					0ft	
Rig (20) (RT) to Mean Sea Level					5412ft	

Survey Program

Start MD (ft)	End MD (ft)	Tool	Model	Log Name/Comment	Wellbore
20.00	1500.00	BH NewTrak (2019)	BH NewTrak (2019) (Axial)		LITTLE LADY 21-5NH PWB
1500.00	13139.47	BH AutoTrak CurveXpress (2019)	BH AutoTrak CurveXpress (2019) (Short spacing)		LITTLE LADY 21-5NH PWB

Hole and Casing Sections

Name	Start MD (ft)	End MD (ft)	Interval (ft)	Start TVD (ft)	End TVD (ft)	Start Local E (ft)	Start Local N (ft)	End Local E (ft)	End Local N (ft)	Wellbore
9.625in Casing Surface	20.00	1500.00	1480.00	20.00	1500.00	0.00	0.00	0.00	0.00	LITTLE LADY 21-5NH PWB

Bottom Hole Location

MD (ft)	Inc (")	Az (")	TVD (ft)	Local N (ft)	Local E (ft)	Grid East (US ft)	Grid North (US ft)	Latitude	Longitude
13139.46	90.310	270.190	7674.00	1465.75	-4880.36	3259774.00	1575424.00	40°54'32.8656"N	104°33'36.7112"W

Targets

Name	MD (ft)	TVD (ft)	Local N (ft)	Local E (ft)	Grid East (US ft)	Grid North (US ft)	Latitude	Longitude
SEC.21-T11N-R64W 330' SETBACKS	N/A	-1.00	119.76	-1.01	3264667.70	1574130.74	40°54'19.5710"N	104°32'33.1626"W
SEC.21-T11N-R64W	N/A	12.00	119.76	-1.01	3264667.70	1574130.74	40°54'19.5710"N	104°32'33.1626"W
LITTLE LADY 21-5NH BHL (1650'FNL & 230'FWL,SEC.21)	13139.46	7674.00	1465.75	-4880.36	3259774.00	1575424.00	40°54'32.8656"N	104°33'36.7112"W
LITTLE LADY 21-5NH LP (1650'FNL & 330'FEL,SEC.21)	8332.35	7700.00	1449.85	-73.35	3264581.00	1575460.00	40°54'32.7133"N	104°32'34.1048"W

Well Profile Data							
Design Comment	MD (ft)	Inc (")	Az (")	TVD (ft)	Local N (ft)	Local E (ft)	VS (ft)
Tie On	20.00	0.000	27.254	20.00	0.00	0.00	0.00
End of Tangent	1600.00	0.000	27.254	1600.00	0.00	0.00	0.00
Build (J)	2688.59	16.329	27.254	2673.92	136.97	70.56	-28.18
KOP	7111.73	16.329	27.254	6918.64	1242.48	640.03	-255.59
LANDING	8332.35	90.310	270.190	7700.00	1449.85	-73.35	487.29
TD	13139.46	90.310	270.190	7674.00	1465.75	-4880.36	5095.72

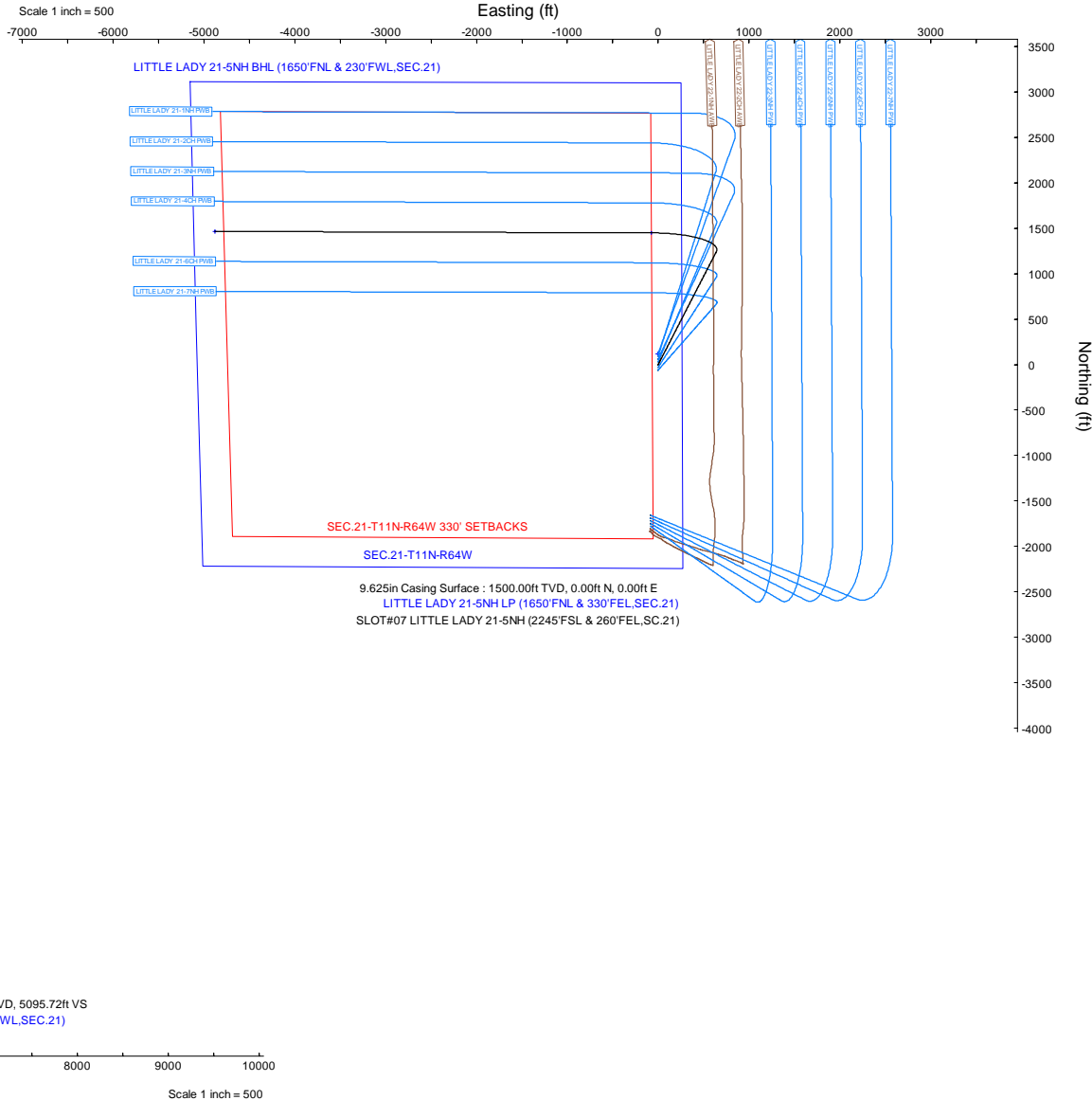



Planned Wellpath Report

LITTLE LADY 21-5NH PWP Rev-A.0

Page 1 of 8



REFERENCE WELLPATH IDENTIFICATION

Operator	UPLAND EXPLORATION	Well	LITTLE LADY 21-5NH
Field	WELD COUNTY (TRUE NORTH NAD 83)	API/Legal	
Facility	SEC.21-T11N-R64W	Wellbore	LITTLE LADY 21-5NH PWB
Slot	SLOT#07 LITTLE LADY 21-5NH (2245'FSL & 260'FEL,SC.21)		

REPORT SETUP INFORMATION

Projection System	NAD83 / Lambert Colorado SP, Northern Zone (501), US feet	Software System	WellArchitect® 6.0
North Reference	True	User	Painsetr
Scale	1.000022	Report Generated	11/12/2020 at 10:01:07 AM
Convergence at slot	0.62° East	Database	WellArchitectDB

WELLPATH LOCATION

	Local coordinates		Grid coordinates		Geographic coordinates	
	North[ft]	East[ft]	Easting[US ft]	Northing[US ft]	Latitude	Longitude
Slot Location	1839.10	85.27	3264670.00	1574011.00	40°54'18.3877"N	104°32'33.1495"W
Facility Reference Pt			3264604.58	1572171.06	40°54'0.2160"N	104°32'34.2600"W
Field Reference Pt			3264604.58	1572171.06	40°54'0.2160"N	104°32'34.2600"W

WELLPATH DATUM

Calculation method	Minimum curvature	Rig (20') (RT) to Facility Vertical Datum	5412.00ft
Horizontal Reference Pt	Slot	Rig (20') (RT) to Mean Sea Level	5412.00ft
Vertical Reference Pt	Rig (20') (RT)	Rig (20') (RT) to Ground Level at Slot (SLOT#07 LITTLE LADY 21-5NH (2245'FSL & 260'FEL,SC.21))	5412.00ft
MD Reference Pt	Rig (20') (RT)	Section Origin	N 0.00, E 0.00 ft
Field Vertical Reference	Mean Sea Level	Section Azimuth	286.72°



Planned Wellpath Report

LITTLE LADY 21-5NH PWP Rev-A.0

Page 2 of 8



REFERENCE WELLPATH IDENTIFICATION

Operator	UPLAND EXPLORATION	Well	LITTLE LADY 21-5NH
Field	WELD COUNTY (TRUE NORTH NAD 83)	API/Legal	
Facility	SEC.21-T11N-R64W	Wellbore	LITTLE LADY 21-5NH PWB
Slot	SLOT#07 LITTLE LADY 21-5NH (2245'FSL & 260'FEL,SC.21)		

WELLPATH DATA (138 stations) † = interpolated, ‡ = extrapolated station

MD [ft]	Inclination [°]	Azimuth [°]	TVD [ft]	Vert Sect [ft]	North [ft]	East [ft]	Latitude	Longitude	DLS [°/100ft]	Comments
0.00†	0.000	27.254	0.00	0.00	0.00	0.00	40°54'18.3877"N	104°32'33.1495"W	0.00	
20.00	0.000	27.254	20.00	0.00	0.00	0.00	40°54'18.3877"N	104°32'33.1495"W	0.00	Tie On
120.00†	0.000	27.254	120.00	0.00	0.00	0.00	40°54'18.3877"N	104°32'33.1495"W	0.00	
220.00†	0.000	27.254	220.00	0.00	0.00	0.00	40°54'18.3877"N	104°32'33.1495"W	0.00	
320.00†	0.000	27.254	320.00	0.00	0.00	0.00	40°54'18.3877"N	104°32'33.1495"W	0.00	
420.00†	0.000	27.254	420.00	0.00	0.00	0.00	40°54'18.3877"N	104°32'33.1495"W	0.00	
520.00†	0.000	27.254	520.00	0.00	0.00	0.00	40°54'18.3877"N	104°32'33.1495"W	0.00	
620.00†	0.000	27.254	620.00	0.00	0.00	0.00	40°54'18.3877"N	104°32'33.1495"W	0.00	
720.00†	0.000	27.254	720.00	0.00	0.00	0.00	40°54'18.3877"N	104°32'33.1495"W	0.00	
820.00†	0.000	27.254	820.00	0.00	0.00	0.00	40°54'18.3877"N	104°32'33.1495"W	0.00	
920.00†	0.000	27.254	920.00	0.00	0.00	0.00	40°54'18.3877"N	104°32'33.1495"W	0.00	
1020.00†	0.000	27.254	1020.00	0.00	0.00	0.00	40°54'18.3877"N	104°32'33.1495"W	0.00	
1120.00†	0.000	27.254	1120.00	0.00	0.00	0.00	40°54'18.3877"N	104°32'33.1495"W	0.00	
1220.00†	0.000	27.254	1220.00	0.00	0.00	0.00	40°54'18.3877"N	104°32'33.1495"W	0.00	
1320.00†	0.000	27.254	1320.00	0.00	0.00	0.00	40°54'18.3877"N	104°32'33.1495"W	0.00	
1420.00†	0.000	27.254	1420.00	0.00	0.00	0.00	40°54'18.3877"N	104°32'33.1495"W	0.00	
1520.00†	0.000	27.254	1520.00	0.00	0.00	0.00	40°54'18.3877"N	104°32'33.1495"W	0.00	
1600.00	0.000	27.254	1600.00	0.00	0.00	0.00	40°54'18.3877"N	104°32'33.1495"W	0.00	End of Tangent
1620.00†	0.300	27.254	1620.00	-0.01	0.05	0.02	40°54'18.3881"N	104°32'33.1492"W	1.50	
1720.00†	1.800	27.254	1719.98	-0.34	1.68	0.86	40°54'18.4042"N	104°32'33.1383"W	1.50	
1820.00†	3.300	27.254	1819.88	-1.16	5.63	2.90	40°54'18.4433"N	104°32'33.1117"W	1.50	
1920.00†	4.800	27.254	1919.63	-2.45	11.91	6.13	40°54'18.5054"N	104°32'33.0696"W	1.50	
2020.00†	6.300	27.254	2019.15	-4.22	20.51	10.56	40°54'18.5903"N	104°32'33.0119"W	1.50	
2120.00†	7.800	27.254	2118.40	-6.46	31.42	16.18	40°54'18.6981"N	104°32'32.9387"W	1.50	
2220.00†	9.300	27.254	2217.28	-9.18	44.63	22.99	40°54'18.8287"N	104°32'32.8501"W	1.50	
2320.00†	10.800	27.254	2315.74	-12.37	60.15	30.98	40°54'18.9820"N	104°32'32.7460"W	1.50	
2420.00†	12.300	27.254	2413.72	-16.03	77.95	40.15	40°54'19.1578"N	104°32'32.6266"W	1.50	
2520.00†	13.800	27.254	2511.13	-20.16	98.02	50.49	40°54'19.3562"N	104°32'32.4919"W	1.50	
2620.00†	15.300	27.254	2607.92	-24.76	120.35	62.00	40°54'19.5768"N	104°32'32.3421"W	1.50	
2688.59	16.329	27.254	2673.92	-28.18	136.97	70.56	40°54'19.7410"N	104°32'32.2306"W	1.50	Build (J)



Planned Wellpath Report

LITTLE LADY 21-5NH PWP Rev-A.0

Page 3 of 8



REFERENCE WELLPATH IDENTIFICATION

Operator	UPLAND EXPLORATION	Well	LITTLE LADY 21-5NH
Field	WELD COUNTY (TRUE NORTH NAD 83)	API/Legal	
Facility	SEC.21-T11N-R64W	Wellbore	LITTLE LADY 21-5NH PWB
Slot	SLOT#07 LITTLE LADY 21-5NH (2245'FSL & 260'FEL,SC.21)		

WELLPATH DATA (138 stations) † = interpolated, ‡ = extrapolated station

MD [ft]	Inclination [°]	Azimuth [°]	TVD [ft]	Vert Sect [ft]	North [ft]	East [ft]	Latitude	Longitude	DLS [°/100ft]	Comments
2720.00†	16.329	27.254	2704.06	-29.79	144.82	74.60	40°54'19.8186"N	104°32'32.1780"W	0.00	
2820.00†	16.329	27.254	2800.02	-34.93	169.81	87.47	40°54'20.0656"N	104°32'32.0103"W	0.00	
2920.00†	16.329	27.254	2895.99	-40.07	194.81	100.35	40°54'20.3125"N	104°32'31.8426"W	0.00	
3020.00†	16.329	27.254	2991.96	-45.21	219.80	113.22	40°54'20.5595"N	104°32'31.6749"W	0.00	
3120.00†	16.329	27.254	3087.92	-50.36	244.79	126.10	40°54'20.8064"N	104°32'31.5073"W	0.00	
3220.00†	16.329	27.254	3183.89	-55.50	269.79	138.97	40°54'21.0534"N	104°32'31.3396"W	0.00	
3320.00†	16.329	27.254	3279.85	-60.64	294.78	151.85	40°54'21.3004"N	104°32'31.1719"W	0.00	
3420.00†	16.329	27.254	3375.82	-65.78	319.78	164.72	40°54'21.5473"N	104°32'31.0042"W	0.00	
3520.00†	16.329	27.254	3471.79	-70.92	344.77	177.60	40°54'21.7943"N	104°32'30.8366"W	0.00	
3620.00†	16.329	27.254	3567.75	-76.06	369.76	190.47	40°54'22.0412"N	104°32'30.6689"W	0.00	
3720.00†	16.329	27.254	3663.72	-81.20	394.76	203.35	40°54'22.2882"N	104°32'30.5012"W	0.00	
3820.00†	16.329	27.254	3759.69	-86.35	419.75	216.22	40°54'22.5351"N	104°32'30.3335"W	0.00	
3920.00†	16.329	27.254	3855.65	-91.49	444.75	229.10	40°54'22.7821"N	104°32'30.1658"W	0.00	
4020.00†	16.329	27.254	3951.62	-96.63	469.74	241.97	40°54'23.0291"N	104°32'29.9982"W	0.00	
4120.00†	16.329	27.254	4047.59	-101.77	494.73	254.85	40°54'23.2760"N	104°32'29.8305"W	0.00	
4220.00†	16.329	27.254	4143.55	-106.91	519.73	267.72	40°54'23.5230"N	104°32'29.6628"W	0.00	
4320.00†	16.329	27.254	4239.52	-112.05	544.72	280.60	40°54'23.7699"N	104°32'29.4951"W	0.00	
4420.00†	16.329	27.254	4335.48	-117.19	569.72	293.47	40°54'24.0169"N	104°32'29.3274"W	0.00	
4520.00†	16.329	27.254	4431.45	-122.34	594.71	306.35	40°54'24.2638"N	104°32'29.1598"W	0.00	
4620.00†	16.329	27.254	4527.42	-127.48	619.70	319.22	40°54'24.5108"N	104°32'28.9921"W	0.00	
4720.00†	16.329	27.254	4623.38	-132.62	644.70	332.10	40°54'24.7578"N	104°32'28.8244"W	0.00	
4820.00†	16.329	27.254	4719.35	-137.76	669.69	344.97	40°54'25.0047"N	104°32'28.6567"W	0.00	
4920.00†	16.329	27.254	4815.32	-142.90	694.69	357.85	40°54'25.2517"N	104°32'28.4890"W	0.00	
5020.00†	16.329	27.254	4911.28	-148.04	719.68	370.72	40°54'25.4986"N	104°32'28.3214"W	0.00	
5120.00†	16.329	27.254	5007.25	-153.18	744.67	383.60	40°54'25.7456"N	104°32'28.1537"W	0.00	
5220.00†	16.329	27.254	5103.22	-158.33	769.67	396.47	40°54'25.9925"N	104°32'27.9860"W	0.00	
5320.00†	16.329	27.254	5199.18	-163.47	794.66	409.35	40°54'26.2395"N	104°32'27.8183"W	0.00	
5420.00†	16.329	27.254	5295.15	-168.61	819.65	422.22	40°54'26.4865"N	104°32'27.6506"W	0.00	
5520.00†	16.329	27.254	5391.11	-173.75	844.65	435.10	40°54'26.7334"N	104°32'27.4829"W	0.00	
5620.00†	16.329	27.254	5487.08	-178.89	869.64	447.97	40°54'26.9804"N	104°32'27.3153"W	0.00	



Planned Wellpath Report

LITTLE LADY 21-5NH PWP Rev-A.0

Page 4 of 8



REFERENCE WELLPATH IDENTIFICATION

Operator	UPLAND EXPLORATION	Well	LITTLE LADY 21-5NH
Field	WELD COUNTY (TRUE NORTH NAD 83)	API/Legal	
Facility	SEC.21-T11N-R64W	Wellbore	LITTLE LADY 21-5NH PWB
Slot	SLOT#07 LITTLE LADY 21-5NH (2245'FSL & 260'FEL,SC.21)		

WELLPATH DATA (138 stations) † = interpolated, ‡ = extrapolated station

MD [ft]	Inclination [°]	Azimuth [°]	TVD [ft]	Vert Sect [ft]	North [ft]	East [ft]	Latitude	Longitude	DLS [°/100ft]	Comments
5720.00†	16.329	27.254	5583.05	-184.03	894.64	460.85	40°54'27.2273"N	104°32'27.1476"W	0.00	
5820.00†	16.329	27.254	5679.01	-189.17	919.63	473.72	40°54'27.4743"N	104°32'26.9799"W	0.00	
5920.00†	16.329	27.254	5774.98	-194.32	944.62	486.60	40°54'27.7212"N	104°32'26.8122"W	0.00	
6020.00†	16.329	27.254	5870.95	-199.46	969.62	499.47	40°54'27.9682"N	104°32'26.6445"W	0.00	
6120.00†	16.329	27.254	5966.91	-204.60	994.61	512.35	40°54'28.2152"N	104°32'26.4768"W	0.00	
6220.00†	16.329	27.254	6062.88	-209.74	1019.61	525.22	40°54'28.4621"N	104°32'26.3091"W	0.00	
6320.00†	16.329	27.254	6158.85	-214.88	1044.60	538.10	40°54'28.7091"N	104°32'26.1415"W	0.00	
6420.00†	16.329	27.254	6254.81	-220.02	1069.59	550.97	40°54'28.9560"N	104°32'25.9738"W	0.00	
6520.00†	16.329	27.254	6350.78	-225.16	1094.59	563.85	40°54'29.2030"N	104°32'25.8061"W	0.00	
6620.00†	16.329	27.254	6446.74	-230.31	1119.58	576.72	40°54'29.4499"N	104°32'25.6384"W	0.00	
6720.00†	16.329	27.254	6542.71	-235.45	1144.58	589.60	40°54'29.6969"N	104°32'25.4707"W	0.00	
6820.00†	16.329	27.254	6638.68	-240.59	1169.57	602.47	40°54'29.9438"N	104°32'25.3030"W	0.00	
6920.00†	16.329	27.254	6734.64	-245.73	1194.56	615.35	40°54'30.1908"N	104°32'25.1353"W	0.00	
7020.00†	16.329	27.254	6830.61	-250.87	1219.56	628.22	40°54'30.4378"N	104°32'24.9676"W	0.00	
7111.73	16.329	27.254	6918.64	-255.59	1242.48	640.03	40°54'30.6643"N	104°32'24.8138"W	0.00	KOP
7120.00†	16.049	25.103	6926.58	-255.97	1244.55	641.05	40°54'30.6847"N	104°32'24.8006"W	8.00	
7220.00†	14.691	355.009	7023.16	-253.29	1269.74	645.82	40°54'30.9336"N	104°32'24.7385"W	8.00	
7320.00†	17.300	327.224	7119.42	-237.27	1294.92	636.65	40°54'31.1824"N	104°32'24.8578"W	8.00	
7420.00†	22.537	309.258	7213.49	-208.22	1319.59	613.72	40°54'31.4261"N	104°32'25.1564"W	8.00	
7520.00†	29.011	298.355	7303.54	-166.70	1343.27	577.49	40°54'31.6601"N	104°32'25.6283"W	8.00	
7620.00†	36.060	291.281	7387.83	-113.52	1365.50	528.64	40°54'31.8798"N	104°32'26.2645"W	8.00	
7720.00†	43.403	286.295	7464.70	-49.73	1385.86	468.14	40°54'32.0810"N	104°32'27.0524"W	8.00	
7820.00†	50.911	282.515	7532.66	23.45	1403.94	397.17	40°54'32.2596"N	104°32'27.9768"W	8.00	
7920.00†	58.516	279.471	7590.39	104.59	1419.39	317.09	40°54'32.4123"N	104°32'29.0197"W	8.00	
8020.00†	66.183	276.888	7636.77	192.10	1431.91	229.48	40°54'32.5360"N	104°32'30.1608"W	8.00	
8120.00†	73.888	274.595	7670.90	284.28	1441.26	136.03	40°54'32.6284"N	104°32'31.3778"W	8.00	
8220.00†	81.616	272.476	7692.10	379.35	1447.26	38.58	40°54'32.6877"N	104°32'32.6471"W	8.00	
8320.00†	89.354	270.439	7699.96	475.44	1449.78	-61.00	40°54'32.7126"N	104°32'33.9440"W	8.00	
8332.35	90.310	270.190	7700.00 ¹	487.29	1449.85	-73.35	40°54'32.7133"N	104°32'34.1048"W	8.00	LANDING
8420.00†	90.310	270.190	7699.53	571.32	1450.14	-161.00	40°54'32.7161"N	104°32'35.2463"W	0.00	



Planned Wellpath Report

LITTLE LADY 21-5NH PWP Rev-A.0

Page 5 of 8



REFERENCE WELLPATH IDENTIFICATION

Operator	UPLAND EXPLORATION	Well	LITTLE LADY 21-5NH
Field	WELD COUNTY (TRUE NORTH NAD 83)	API/Legal	
Facility	SEC.21-T11N-R64W	Wellbore	LITTLE LADY 21-5NH PWB
Slot	SLOT#07 LITTLE LADY 21-5NH (2245'FSL & 260'FEL,SC.21)		

WELLPATH DATA (138 stations) † = interpolated, ‡ = extrapolated station

MD [ft]	Inclination [°]	Azimuth [°]	TVD [ft]	Vert Sect [ft]	North [ft]	East [ft]	Latitude	Longitude	DLS [°/100ft]	Comments
8520.00†	90.310	270.190	7698.99	667.19	1450.47	-261.00	40°54'32.7194"N	104°32'36.5487"W	0.00	
8620.00†	90.310	270.190	7698.44	763.05	1450.80	-361.00	40°54'32.7227"N	104°32'37.8511"W	0.00	
8720.00†	90.310	270.190	7697.90	858.92	1451.13	-460.99	40°54'32.7259"N	104°32'39.1535"W	0.00	
8820.00†	90.310	270.190	7697.36	954.79	1451.46	-560.99	40°54'32.7292"N	104°32'40.4558"W	0.00	
8920.00†	90.310	270.190	7696.82	1050.65	1451.79	-660.99	40°54'32.7324"N	104°32'41.7582"W	0.00	
9020.00†	90.310	270.190	7696.28	1146.52	1452.12	-760.99	40°54'32.7356"N	104°32'43.0606"W	0.00	
9120.00†	90.310	270.190	7695.74	1242.39	1452.45	-860.99	40°54'32.7389"N	104°32'44.3629"W	0.00	
9220.00†	90.310	270.190	7695.20	1338.25	1452.78	-960.98	40°54'32.7421"N	104°32'45.6653"W	0.00	
9320.00†	90.310	270.190	7694.66	1434.12	1453.12	-1060.98	40°54'32.7453"N	104°32'46.9677"W	0.00	
9420.00†	90.310	270.190	7694.12	1529.99	1453.45	-1160.98	40°54'32.7486"N	104°32'48.2701"W	0.00	
9520.00†	90.310	270.190	7693.58	1625.86	1453.78	-1260.98	40°54'32.7518"N	104°32'49.5724"W	0.00	
9620.00†	90.310	270.190	7693.04	1721.72	1454.11	-1360.98	40°54'32.7550"N	104°32'50.8748"W	0.00	
9720.00†	90.310	270.190	7692.49	1817.59	1454.44	-1460.97	40°54'32.7582"N	104°32'52.1772"W	0.00	
9820.00†	90.310	270.190	7691.95	1913.46	1454.77	-1560.97	40°54'32.7614"N	104°32'53.4796"W	0.00	
9920.00†	90.310	270.190	7691.41	2009.32	1455.10	-1660.97	40°54'32.7646"N	104°32'54.7819"W	0.00	
10020.00†	90.310	270.190	7690.87	2105.19	1455.43	-1760.97	40°54'32.7678"N	104°32'56.0843"W	0.00	
10120.00†	90.310	270.190	7690.33	2201.06	1455.76	-1860.97	40°54'32.7710"N	104°32'57.3867"W	0.00	
10220.00†	90.310	270.190	7689.79	2296.92	1456.09	-1960.96	40°54'32.7742"N	104°32'58.6890"W	0.00	
10320.00†	90.310	270.190	7689.25	2392.79	1456.42	-2060.96	40°54'32.7774"N	104°32'59.9914"W	0.00	
10420.00†	90.310	270.190	7688.71	2488.66	1456.75	-2160.96	40°54'32.7806"N	104°33'1.2938"W	0.00	
10520.00†	90.310	270.190	7688.17	2584.52	1457.09	-2260.96	40°54'32.7838"N	104°33'2.5962"W	0.00	
10620.00†	90.310	270.190	7687.63	2680.39	1457.42	-2360.96	40°54'32.7869"N	104°33'3.8985"W	0.00	
10720.00†	90.310	270.190	7687.09	2776.26	1457.75	-2460.95	40°54'32.7901"N	104°33'5.2009"W	0.00	
10820.00†	90.310	270.190	7686.55	2872.13	1458.08	-2560.95	40°54'32.7933"N	104°33'6.5033"W	0.00	
10920.00†	90.310	270.190	7686.00	2967.99	1458.41	-2660.95	40°54'32.7964"N	104°33'7.8056"W	0.00	
11020.00†	90.310	270.190	7685.46	3063.86	1458.74	-2760.95	40°54'32.7996"N	104°33'9.1080"W	0.00	
11120.00†	90.310	270.190	7684.92	3159.73	1459.07	-2860.95	40°54'32.8028"N	104°33'10.4104"W	0.00	
11220.00†	90.310	270.190	7684.38	3255.59	1459.40	-2960.94	40°54'32.8059"N	104°33'11.7128"W	0.00	
11320.00†	90.310	270.190	7683.84	3351.46	1459.73	-3060.94	40°54'32.8091"N	104°33'13.0151"W	0.00	
11420.00†	90.310	270.190	7683.30	3447.33	1460.06	-3160.94	40°54'32.8122"N	104°33'14.3175"W	0.00	



Planned Wellpath Report

LITTLE LADY 21-5NH PWP Rev-A.0

Page 6 of 8



REFERENCE WELLPATH IDENTIFICATION

Operator	UPLAND EXPLORATION	Well	LITTLE LADY 21-5NH
Field	WELD COUNTY (TRUE NORTH NAD 83)	API/Legal	
Facility	SEC.21-T11N-R64W	Wellbore	LITTLE LADY 21-5NH PWB
Slot	SLOT#07 LITTLE LADY 21-5NH (2245'FSL & 260'FEL,SC.21)		

WELLPATH DATA (138 stations) † = interpolated, ‡ = extrapolated station

MD [ft]	Inclination [°]	Azimuth [°]	TVD [ft]	Vert Sect [ft]	North [ft]	East [ft]	Latitude	Longitude	DLS [°/100ft]	Comments
11520.00†	90.310	270.190	7682.76	3543.19	1460.39	-3260.94	40°54'32.8153"N	104°33'15.6199"W	0.00	
11620.00†	90.310	270.190	7682.22	3639.06	1460.72	-3360.94	40°54'32.8185"N	104°33'16.9223"W	0.00	
11720.00†	90.310	270.190	7681.68	3734.93	1461.06	-3460.93	40°54'32.8216"N	104°33'18.2246"W	0.00	
11820.00†	90.310	270.190	7681.14	3830.80	1461.39	-3560.93	40°54'32.8247"N	104°33'19.5270"W	0.00	
11920.00†	90.310	270.190	7680.60	3926.66	1461.72	-3660.93	40°54'32.8279"N	104°33'20.8294"W	0.00	
12020.00†	90.310	270.190	7680.05	4022.53	1462.05	-3760.93	40°54'32.8310"N	104°33'22.1318"W	0.00	
12120.00†	90.310	270.190	7679.51	4118.40	1462.38	-3860.93	40°54'32.8341"N	104°33'23.4341"W	0.00	
12220.00†	90.310	270.190	7678.97	4214.26	1462.71	-3960.92	40°54'32.8372"N	104°33'24.7365"W	0.00	
12320.00†	90.310	270.190	7678.43	4310.13	1463.04	-4060.92	40°54'32.8403"N	104°33'26.0389"W	0.00	
12420.00†	90.310	270.190	7677.89	4406.00	1463.37	-4160.92	40°54'32.8434"N	104°33'27.3412"W	0.00	
12520.00†	90.310	270.190	7677.35	4501.86	1463.70	-4260.92	40°54'32.8465"N	104°33'28.6436"W	0.00	
12620.00†	90.310	270.190	7676.81	4597.73	1464.03	-4360.92	40°54'32.8496"N	104°33'29.9460"W	0.00	
12720.00†	90.310	270.190	7676.27	4693.60	1464.36	-4460.91	40°54'32.8527"N	104°33'31.2484"W	0.00	
12820.00†	90.310	270.190	7675.73	4789.47	1464.69	-4560.91	40°54'32.8558"N	104°33'32.5507"W	0.00	
12920.00†	90.310	270.190	7675.19	4885.33	1465.03	-4660.91	40°54'32.8589"N	104°33'33.8531"W	0.00	
13020.00†	90.310	270.190	7674.65	4981.20	1465.36	-4760.91	40°54'32.8620"N	104°33'35.1555"W	0.00	
13120.00†	90.310	270.190	7674.11	5077.07	1465.69	-4860.90	40°54'32.8650"N	104°33'36.4579"W	0.00	
13139.46	90.310	270.190	7674.00‡	5095.72	1465.75	-4880.36	40°54'32.8656"N	104°33'36.7112"W	0.00	TD

HOLE & CASING SECTIONS

- Ref Wellbore: LITTLE LADY 21-5NH PWB Ref Wellpath: LITTLE LADY 21-5NH PWP Rev-A.0

String/Diameter	Start MD [ft]	End MD [ft]	Interval [ft]	Start TVD [ft]	End TVD [ft]	Start N/S [ft]	Start E/W [ft]	End N/S [ft]	End E/W [ft]
9.625in Casing Surface	20.00	1500.00	1480.00	20.00	1500.00	0.00	0.00	0.00	0.00



Planned Wellpath Report

LITTLE LADY 21-5NH PWP Rev-A.0

Page 7 of 8



REFERENCE WELLPATH IDENTIFICATION

Operator	UPLAND EXPLORATION	Well	LITTLE LADY 21-5NH
Field	WELD COUNTY (TRUE NORTH NAD 83)	API/Legal	
Facility	SEC.21-T11N-R64W	Wellbore	LITTLE LADY 21-5NH PWB
Slot	SLOT#07 LITTLE LADY 21-5NH (2245'FSL & 260'FEL,SC.21)		

TARGETS

Name	MD [ft]	TVD [ft]	North [ft]	East [ft]	Grid East [US ft]	Grid North [US ft]	Latitude	Longitude	Shape
SEC.21-T11N-R64W 330' SETBACKS	N/A	-1.00	119.76	-1.01	3264667.70	1574130.74	40°54'19.5710"N	104°32'33.1626"W	polygon
2D Polygon: dimensions not calculated									
SEC.21-T11N-R64W	N/A	12.00	119.76	-1.01	3264667.70	1574130.74	40°54'19.5710"N	104°32'33.1626"W	polygon
2D Polygon: dimensions not calculated									
2) LITTLE LADY 21-5NH BHL (1650'FNL & 230'FWL,SEC.21)	13139.46	7674.00	1465.75	-4880.36	3259774.00	1575424.00	40°54'32.8656"N	104°33'36.7112"W	point
1) LITTLE LADY 21-5NH LP (1650'FNL & 330'FEL,SEC.21)	8332.35	7700.00	1449.85	-73.35	3264581.00	1575460.00	40°54'32.7133"N	104°32'34.1048"W	point

SURVEY PROGRAM -

Ref Wellbore: LITTLE LADY 21-5NH PWB Ref Wellpath: LITTLE LADY 21-5NH PWP Rev-A.0

Start MD [ft]	End MD [ft]	Positional Uncertainty Model	Log Name/Comment	Wellbore
20.00	1500.00	BH NaviTrak (2019) (Axial)		LITTLE LADY 21-5NH PWB
1500.00	13139.47	BH AutoTrak Curve/eXpress (2019) (Short spacing)		LITTLE LADY 21-5NH PWB



Planned Wellpath Report

LITTLE LADY 21-5NH PWP Rev-A.0

Page 8 of 8



REFERENCE WELLPATH IDENTIFICATION

Operator	UPLAND EXPLORATION	Well	LITTLE LADY 21-5NH
Field	WELD COUNTY (TRUE NORTH NAD 83)	API/Legal	
Facility	SEC.21-T11N-R64W	Wellbore	LITTLE LADY 21-5NH PWB
Slot	SLOT#07 LITTLE LADY 21-5NH (2245'FSL & 260'FEL,SC.21)		

DESIGN COMMENTS

MD [ft]	Inclination [°]	Azimuth [°]	TVD [ft]	Comment
20.00	0.000	27.254	20.00	Tie On
1600.00	0.000	27.254	1600.00	End of Tangent
2688.59	16.329	27.254	2673.92	Build (J)
7111.73	16.329	27.254	6918.64	KOP
8332.35	90.310	270.190	7700.00	LANDING
13139.46	90.310	270.190	7674.00	TD



Closest Approach Clearance Summary Report

LITTLE LADY 21-5NH PWP Rev-A.0 - Baker Hughes
Stop Drilling (offset is HSE risk) (pre-2019)

Page 1 of 3



REFERENCE WELLPATH IDENTIFICATION

Operator	UPLAND EXPLORATION	Well	LITTLE LADY 21-5NH
Field	WELD COUNTY (TRUE NORTH NAD 83)	API/Legal	
Facility	SEC.21-T11N-R64W	Wellbore	LITTLE LADY 21-5NH PWB
Slot	SLOT#07 LITTLE LADY 21-5NH (2245'FSL & 260'FEL,SC.21)		

REPORT SETUP INFORMATION

Projection System	NAD83 / Lambert Colorado SP, Northern Zone (501), US feet	Software System	WellArchitect® 6.0
North Reference	True	User	Painsetr
Scale	1.000022	Report Generated	11/12/2020 at 10:02:14 AM
Convergence at slot	0.62° East	Database	WellArchitectDB

WELLPATH LOCATION

	Local coordinates		Grid coordinates		Geographic coordinates	
	North[ft]	East[ft]	Easting[US ft]	Northing[US ft]	Latitude	Longitude
Slot Location	1839.10	85.27	3264670.00	1574011.00	40°54'18.3877"N	104°32'33.1495"W
Facility Reference Pt			3264604.58	1572171.06	40°54'0.2160"N	104°32'34.2600"W
Field Reference Pt			3264604.58	1572171.06	40°54'0.2160"N	104°32'34.2600"W

WELLPATH DATUM

Calculation method	Minimum Curvature	Rig (20') (RT) to Facility Vertical Datum	5412.00ft
Horizontal Reference Pt	Slot	Rig (20') (RT) to Mean Sea Level	5412.00ft
Vertical Reference Pt	Rig (20') (RT)	Rig (20') (RT) to Ground Level at Slot (SLOT#07 LITTLE LADY 21-5NH (2245'FSL & 260'FEL,SC.21))	5412.00ft
MD Reference Pt	Rig (20') (RT)		
Field Vertical Reference	Mean Sea Level		

POSITIONAL UNCERTAINTY CALCULATION SETTINGS

Ellipse Confidence Limit	3.00 Std Dev	Ellipse Start MD	20.00ft	Surface Position Uncertainty	included
Declination	8.06° East of TN	Dip Angle	67.10°	Mag Field Strength	52445 nT
Slot Surface Uncertainty @1SD		Horizontal	0.100ft	Vertical	1.000ft
Facility Surface Uncertainty @1SD		Horizontal	8.200ft	Vertical	3.000ft

Positional Uncertainty values in the WELLPATH DATA table are the projection of the ellipsoid of uncertainty onto the vertical and horizontal planes



Closest Approach Clearance Summary Report

LITTLE LADY 21-5NH PWP Rev-A.0 - Baker Hughes
Stop Drilling (offset is HSE risk) (pre-2019)

Page 2 of 3



REFERENCE WELLPATH IDENTIFICATION

Operator	UPLAND EXPLORATION	Well	LITTLE LADY 21-5NH
Field	WELD COUNTY (TRUE NORTH NAD 83)	API/Legal	
Facility	SEC.21-T11N-R64W	Wellbore	LITTLE LADY 21-5NH PWB
Slot	SLOT#07 LITTLE LADY 21-5NH (2245'FSL & 260'FEL,SC.21)		

PROXIMITY-SCAN RULE

Rule Name	Baker Hughes Stop Drilling (offset is HSE risk) (pre-2019)	Rule Based On	Ratio
Plane of Rule	Closest Approach	Threshold Value	1.00
Include Casing & Hole Size	yes	Apply Cone of Safety	no

HOLE & CASING SECTIONS

- Ref Wellbore: LITTLE LADY 21-5NH PWB Ref Wellpath: LITTLE LADY 21-5NH PWP Rev-A.0

String/Diameter	Start MD [ft]	End MD [ft]	Interval [ft]	Start TVD [ft]	End TVD [ft]	Start N/S [ft]	Start E/W [ft]	End N/S [ft]	End E/W [ft]
9.625in Casing Surface	20.00	1500.00	1480.00	20.00	1500.00	0.00	0.00	0.00	0.00

SURVEY PROGRAM -

Ref Wellbore: LITTLE LADY 21-5NH PWB Ref Wellpath: LITTLE LADY 21-5NH PWP Rev-A.0

Start MD [ft]	End MD [ft]	Positional Uncertainty Model	Log Name/Comment	Wellbore
20.00	1500.00	BH NaviTrak (2019) (Axial)		LITTLE LADY 21-5NH PWB
1500.00	13139.47	BH AutoTrak Curve/eXpress (2019) (Short spacing)		LITTLE LADY 21-5NH PWB



Closest Approach Clearance Summary Report

LITTLE LADY 21-5NH PWP Rev-A.0 - Baker Hughes
Stop Drilling (offset is HSE risk) (pre-2019)

Page 3 of 3



REFERENCE WELLPATH IDENTIFICATION

Operator	UPLAND EXPLORATION	Well	LITTLE LADY 21-5NH
Field	WELD COUNTY (TRUE NORTH NAD 83)	API/Legal	
Facility	SEC.21-T11N-R64W	Wellbore	LITTLE LADY 21-5NH PWB
Slot	SLOT#07 LITTLE LADY 21-5NH (2245'FSL & 260'FEL,SC.21)		

CALCULATION RANGE & CUTOFF

From: 20.00ft MD	To: 13139.46ft MD	C-C Cutoff: (none)
------------------	-------------------	--------------------

OFFSET WELL CLEARANCE SUMMARY (13 Offset Wellpaths selected) Ratios are calculated in Closest Approach plane

Offset Facility	Offset Slot	Offset Well	Offset Wellbore	Offset Wellpath	Wellbore Status	C-C Clearance Distance			Rule Separation Ratio			
						Ref MD [ft]	Min C-C Clear Dist [ft]	Diverging from MD [ft]	Ref MD of Min Ratio [ft]	Min Ratio	Min Ratio Dvrg from [ft]	Rule Status
SEC.21-T11N-R64W	SLOT#08 LITTLE LADY 21-6CH (2215'FSL & 260'FEL,SC.21)	LITTLE LADY 21-6CH	LITTLE LADY 21-6CH PWB	LITTLE LADY 21-6CH PWP Rev-A.0	Planned	20.00	30.00	8332.35	13129.89	0.87	13129.89	FAIL
SEC.21-T11N-R64W	SLOT#06 LITTLE LADY 21-4CH (2275'FSL & 260'FEL,SC.21)	LITTLE LADY 21-4CH	LITTLE LADY 21-4CH PWB	LITTLE LADY 21-4CH PWP Rev-A.0	Planned	20.00	30.02	1520.00	13139.46	0.90	13139.46	FAIL
SEC.21-T11N-R64W	SLOT#05 LITTLE LADY 21-3NH (2305'FSL & 260'FEL, SEC.21)	LITTLE LADY 21-3NH	LITTLE LADY 21-3NH PWB	LITTLE LADY 21-3NH PWP Rev-B.0	Planned	20.00	60.01	8332.35	13139.46	1.18	13139.46	PASS
SEC.21-T11N-R64W	SLOT#09 LITTLE LADY 21-7NH (2185'FSL & 260'FEL,SC.21)	LITTLE LADY 21-7NH	LITTLE LADY 21-7NH PWB	LITTLE LADY 21-7NH PWP Rev-A.0	Planned	20.00	60.01	1600.00	13129.10	1.21	13129.10	PASS
SEC.21-T11N-R64W	SLOT#04 LITTLE LADY 21-2CH (2335'FSL & 260'FEL,SEC.21)	LITTLE LADY 21-2CH	LITTLE LADY 21-2CH PWB	LITTLE LADY 21-2CH PWP Rev-A.0	Planned	20.00	90.02	1520.00	13139.46	1.92	13139.46	PASS
SEC.21-T11N-R64W	SLOT#01 LITTLE LADY 22-1NH (405'FSL & 355'FEL SEC.21)	LITTLE LADY 22-1NH	LITTLE LADY 22-1NH AWP	LITTLE LADY 22-1NH AWP	Drilling	7787.29	270.91	7787.29	7879.01	2.03	7879.01	PASS
SEC.21-T11N-R64W	SLOT#03 LITTLE LADY 21-1NH (2365'FSL & 260'FEL, SEC.21)	LITTLE LADY 21-1NH	LITTLE LADY 21-1NH PWB	LITTLE LADY 21-1NH PWP Rev-B.0	Planned	20.00	120.01	13139.46	13139.46	2.37	13139.46	PASS
SEC.21-T11N-R64W	SLOT#02 LITTLE LADY 22-2CH (435'FSL & 355'FEL SEC.21)	LITTLE LADY 22-2CH	LITTLE LADY 22-2CH AWP	LITTLE LADY 22-2CH AWP	Drilling	7720.00	635.28	7720.00	7896.31	4.68	7896.31	PASS
SEC.21-T11N-R64W	SLOT#10 LITTLE LADY 22-3NH (465'FSL & 355'FEL,SC.21)	LITTLE LADY 22-3NH	LITTLE LADY 22-3NH PWB	LITTLE LADY 22-3NH PWP Rev-A.0	Planned	7540.29	764.81	7540.29	7677.00	5.99	7677.00	PASS
SEC.21-T11N-R64W	SLOT#11 LITTLE LADY 22-4CH (495'FSL & 355'FEL,SC.21)	LITTLE LADY 22-4CH	LITTLE LADY 22-4CH PWB	LITTLE LADY 22-4CH PWP Rev-A.0	Planned	7559.10	1163.95	7559.10	7751.09	9.19	7751.09	PASS
SEC.21-T11N-R64W	SLOT#12 LITTLE LADY 22-5NH (525'FSL & 355'FEL,SC.21)	LITTLE LADY 22-5NH	LITTLE LADY 22-5NH PWB	LITTLE LADY 22-5NH PWP Rev-A.0	Planned	7420.00	1370.63	7420.00	7612.73	10.38	7612.73	PASS
SEC.21-T11N-R64W	SLOT#13 LITTLE LADY 22-6CH (555'FSL & 355'FEL,SC.21)	LITTLE LADY 22-6CH	LITTLE LADY 22-6CH PWB	LITTLE LADY 22-6CH PWP Rev-A.0	Planned	20.00	1691.29	7420.00	7693.47	13.40	7693.47	PASS
SEC.21-T11N-R64W	SLOT#14 LITTLE LADY 22-7NH (585'FSL & 355'FEL,SC.21)	LITTLE LADY 22-7NH	LITTLE LADY 22-7NH PWB	LITTLE LADY 22-7NH PWP Rev-A.0	Planned	20.00	1661.32	7420.00	7597.11	14.81	7597.11	PASS